

STATE OF ILLINOIS
DEPARTMENT OF TRANSPORTATION
DIVISION OF HIGHWAYS
PROPOSED
HIGHWAY PLANS

F.A.P. RTE.	SECTION	COUNTY	TOTAL SHEETS	SHEET NO.
46	(2, 2-1) Y	LASALLE	23	1
		ILLINOIS	CONTRACT NO. 66D06	

INDEX OF SHEETS

1	COVER SHEET
2	GENERAL NOTES
3-6	SUMMARY OF QUANTITIES
7	TYPICAL SECTIONS
8	SCHEDULES
9-10	PLAN VIEW
11-12	EROSION CONTROL PLAN
13-14	PAVEMENT MARKING PLAN
15-16	DETAILS
17-23	CROSS SECTIONS

STANDARDS

000001-06	STANDARD SYMBOLS, ABBREVIATIONS AND PATTERNS
001001-02	AREAS OF REINFORCEMENT BARS
001008	DECIMAL OF AN INCH AND OF A FOOT
280001-07	TEMPORARY EROSION CONTROL SYSTEMS
353001-04	PCC BASE COURSE WITH HMA BINDER AND SURFACE COURSES
420001-08	PAVEMENT JOINTS
482006-03	HMA SHOULDER ADJACENT TO RIGID PAVEMENT
606001-06	CONCRETE CURB TYPE B AND COMBINATION CONCRETE CURB AND GUTTER
606301-04	PC CONCRETE ISLANDS AND MEDIANS
630001-10	STEEL PLATE BEAM GUARDRAIL
630201-06	PCC/HMA STABILIZATION AT STEEL PLATE BEAM GUARDRAIL
630301-06	SHOULDER WIDENING FOR TYPE 1(SPECIAL) GUARDRAIL TERMINALS
631006-08	TRAFFIC BARRIER TERMINAL, TYPE 1B
635006-03	REFLECTOR AND TERMINAL MARKER PLACEMENT
635011-02	REFLECTOR MARKER AND MOUNTING DETAILS
701001-02	OFF-ROAD OPERATIONS 2L, 2W, MORE THAN 15' (4.5 m) AWAY
701006-05	OFF-ROAD OPERATIONS 2L, 2W, 15' (4.5 m) TO 24' (600 mm) FROM PAVEMENT EDGE
701306-03	LANE CLOSURE, 2L, 2W, SLOW MOVING OPERATIONS DAY ONLY, FOR SPEEDS ≥ 45 MPH
701311-03	LANE CLOSURE, 2L, 2W, MOVING OPERATIONS - DAY ONLY
701326-04	LANE CLOSURE, 2L, 2W, PAVEMENT WIDENING, FOR SPEEDS ≥ 45 MPH
701901-04	TRAFFIC CONTROL DEVICES
720001-01	SIGN PANEL MOUNTING DETAILS
720006-04	SIGN PANEL ERECTION DETAILS
780001-05	TYPICAL PAVEMENT MARKINGS
781001-03	TYPICAL APPLICATIONS RAISED REFLECTIVE PAVEMENT MARKERS
782001	PRISMATIC CURB REFLECTORS

FAP ROUTE 46 (IL 251)
SECTION (2, 2-1) Y
PROJECT : ACHSIP-0046(027)
INTERSECTION SAFETY IMPROVEMENT
LASALLE COUNTY

C-93-018-15

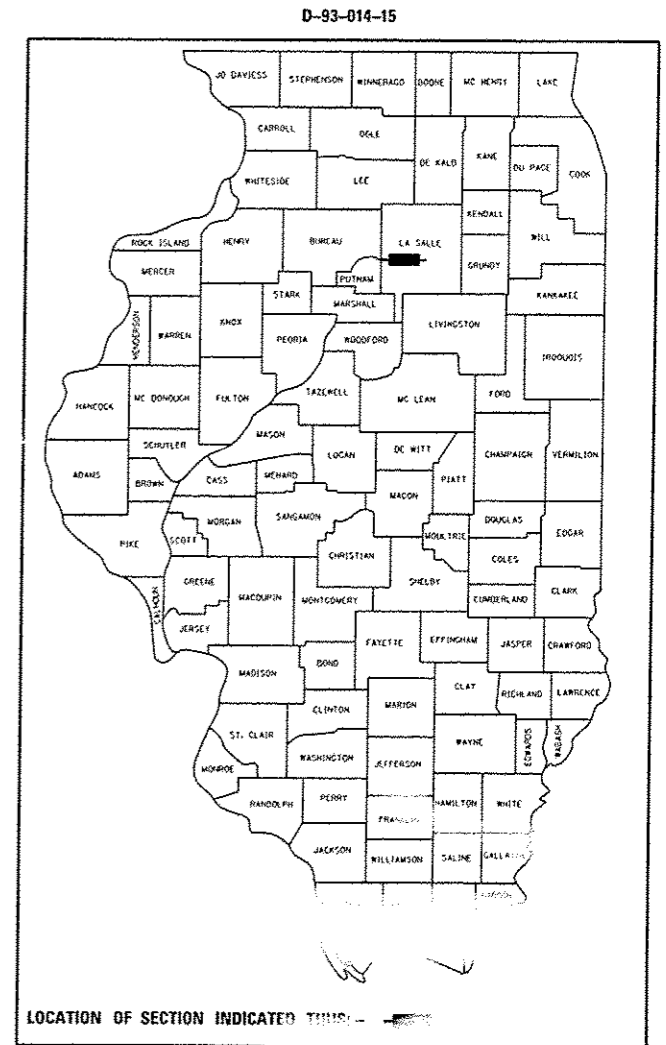

IL 251 - RURAL MINOR ARTERIAL
 2013 ADT=11,100, P.V.=90.5% S.S.=6.8% M.U.=2.7%

CEDAR CREEK RD - RURAL MINOR ARTERIAL
 2011 ADT=2,450, PERCENTAGES UNKNOWN

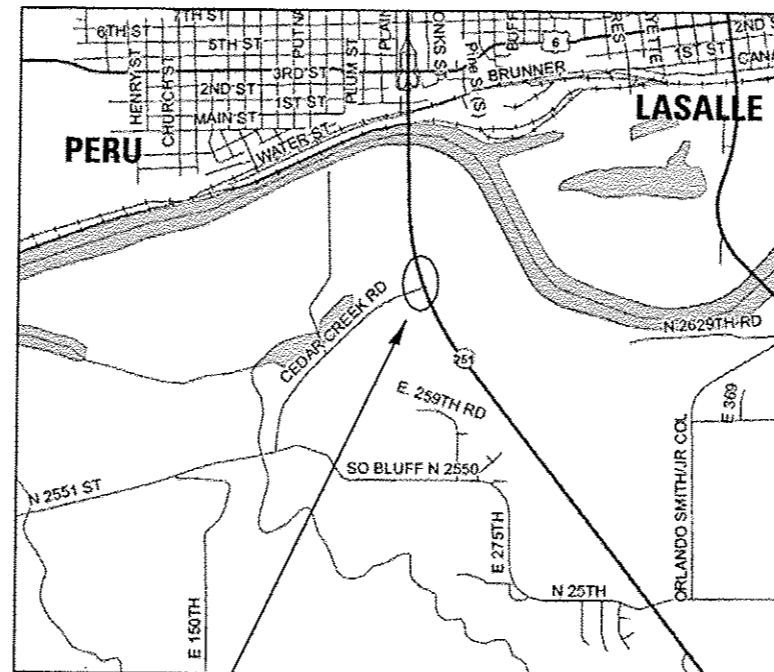

PROJECT LOCATION
 IL 251 AND CEDAR CREEK RD (N 2551ST RD)

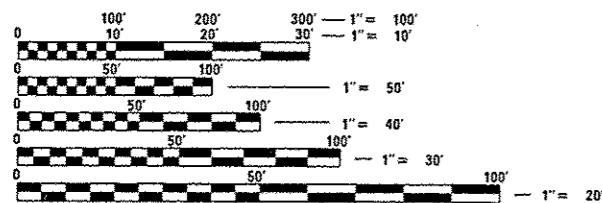

FULL SIZE PLANS HAVE BEEN PREPARED USING STANDARD ENGINEERING SCALES. REDUCED SIZED PLANS WILL NOT CONFORM TO STANDARD SCALES. IN MAKING MEASUREMENTS ON REDUCED PLANS, THE ABOVE SCALES MAY BE USED.

J.U.L.I.E.
 JOINT UTILITY LOCATION INFORMATION FOR EXCAVATION
 1-800-892-0123
 OR 811

PROJECT ENGINEER: SCOTT FERGUSON, P.E.
UNIT CHIEF: MARC BUDZYNSKI
DISTRICT NO. (815)-434-6131
CONTRACT NO. 66D06

GROSS AND NET LENGTH = 932 FT. = 0.177 MILE

STATE OF ILLINOIS
 DEPARTMENT OF TRANSPORTATION
 DIVISION OF HIGHWAYS

SUBMITTED March 27 2015
Paul Costello
 DEPUTY DIRECTOR OF HIGHWAYS, REGION ENGINEER

May 8 2015
Dun D. Baranzolli, P.E.
 ENGINEER OF DESIGN AND ENVIRONMENT

May 8 2015
Chris Osman, P.E.
 DIRECTOR OF HIGHWAYS, CHIEF ENGINEER

PRINTED BY THE AUTHORITY
OF THE STATE OF ILLINOIS

GENERAL NOTES

THE THICKNESS OF HMA SHOWN ON THE PLANS IS THE NOMINAL THICKNESS. DEVIATIONS FROM THE NOMINAL THICKNESS WILL BE PERMITTED WHEN SUCH DEVIATIONS OCCUR DUE TO IRREGULARITIES IN THE EXISTING SURFACE OR BASE ON WHICH THE HMA IS PLACED.

THE HMA SURFACE OF ALL MAILBOX TURNOUTS, PRIVATE ENTRANCES, COMMERCIAL ENTRANCES, AND SIDE ROADS SHALL BE MADE NEATLY, IN A WORKMANLIKE MANNER, AND SHALL ACCURATELY CONFORM TO THE SHAPES AND DIMENSIONS SHOWN ON THE PLAN DETAILS. IF REQUIRED BY THE ENGINEER, THE CONTRACTOR SHALL SAW CUT THE HMA SURFACE TO CONFORM TO THE SHAPES AND DIMENSIONS SHOWN ON THE PLAN DETAILS. THIS WORK WILL BE INCLUDED IN THE COST OF THE HMA SURFACE.

THE ENGINEER WILL BE THE SOLE JUDGE CONCERNING CURING TIME FOR THE VARIOUS HMA LIFTS.

FOR STABILIZATION, ALL TYPE III BARRICADES WILL REQUIRE A MINIMUM OF FOUR SAND BAGS PER BARRICADE.

SEEDING WILL NOT BE PERMITTED AT ANY TIME WHEN THE GROUND IS FROZEN, WET, OR IN AN UNTILLABLE CONDITION. LOCATIONS TO BE SEEDED WILL BE DETERMINED BY THE ENGINEER.

ONLY THOSE TREES DESIGNATED BY THE ENGINEER OR LISTED IN THE TREE REMOVAL SCHEDULE SHALL BE REMOVED. THE CONTRACTOR SHALL PROTECT ALL REMAINING TREES FROM DAMAGE DUE TO HIS OPERATIONS.

THE FINISHED EARTHWORK SHALL HAVE A VEGETATION SUSTAINING SOIL COVERING THE TOP FOUR INCHES (100 MILLIMETERS) IN AREAS TO BE SEEDED OR SODDED. THE VEGETATION SUSTAINING SOIL REQUIRED WILL NOT BE PAID FOR SEPARATELY BUT WILL BE INCLUDED IN THE COST OF FURNISHED EXCAVATION.

ON EXISTING PAVEMENT WHICH MAY BE SUPERELEVATED, THE NEW HMA PAVEMENT SHALL BE BUILT WITH THE SAME SUPERELEVATION UNLESS NEW SUPERELEVATION RATES ARE GIVEN ON THE PLANS.

ALL ELEVATIONS REFERRING TO U.S.G.S. MEAN SEA LEVEL DATUM, ABANDONED UNDERGROUND UTILITIES THAT CONFLICT WITH CONSTRUCTION SHALL BE DISPOSED OF OUTSIDE THE LIMITS OF THE RIGHT OF WAY ACCORDING TO ARTICLE 202.03 OF THE STANDARD SPECIFICATIONS AND AS DIRECTED BY THE ENGINEER. THIS WORK WILL NOT BE PAID FOR SEPARATELY, BUT WILL BE INCLUDED IN THE COST OF EARTH EXCAVATION.

ANY REFERENCE TO A STANDARD IN THESE PLANS SHALL BE INTERPRETED TO MEAN THE EDITION AS INDICATED BY THE SUBNUMBER SHOWN IN THE LIST OF STANDARDS OR THE COPY INCLUDED IN THESE PLANS.

THE FOLLOWING RATES OF APPLICATION HAVE BEEN USED IN CALCULATING PLAN QUANTITIES:

GRANULAR MATERIALS	2.05	TONS / CU YD
HMA RESURFACING	112	LBS / SQ YD / IN

THE CONTRACTOR SHALL CONTACT JULIE AT LEAST 48 HOURS PRIOR TO EXCAVATION TO DETERMINE WHICH UTILITIES ARE IN THE AREA.

COMMITMENTS:

HMA MIXTURE REQUIREMENT TABLE				
LOCATIONS:	STA. 230+51 TO STA. 239+83			
MIXTURE USE(S):	SURFACE COURSE	LEVELING BINDER	SHOULDER TOP LIFT (1 1/2")	SHOULDER BOTTOM LIFT(S) (6 1/2")
BINDER GRADE (PG):	PG 64-22	PG 64-22	PG 64-22	PG 64-22
DESIGN AIR VOIDS:	4.0% @ N70	4.0% @ N70	4.0% @ N70	4.0% @ N50
MIXTURE COMPOSITION (MIXTURE GRADATION):	IL 9.5	IL 9.5 FG	IL 9.5	IL 19.0
FRICTION AGGREGATE:	MIXTURE D	-	MIXTURE D	-
MIXTURE WEIGHT:	112.0 LB/SY/IN	112.0 LB/SY/IN	112.0 LB/SY/IN	112.0 LB/SY/IN
QUALITY MANAGEMENT PROGRAM:	QC/OA	QC/OA	QC/OA	QC/OA
SUBLOT SIZE:	N/A	N/A	N/A	N/A
DENSITY TEST METHOD:	CORES	GROWTH CURVE	CORES	CORES

STATE OF ILLINOIS
DEPARTMENT OF TRANSPORTATION
DISTRICT THREE

PREPARED BY: Don Beaulieu
DISTRICT STUDIES & PLANS ENGINEER

DATE: March 27, 2015

EXAMINED BY: Heab Jung
DISTRICT CONSTRUCTION ENGINEER

Wayne Phillips
DISTRICT MATERIALS ENGINEER

James A. Hester
DISTRICT OPERATIONS ENGINEER

FILE NAME: c:\pwork\pwork\budzynskim\0333515\03366286-shr-cover.dgn	USER NAME: budzynskim	DESIGNED: -	REVISED: -	STATE OF ILLINOIS DEPARTMENT OF TRANSPORTATION	GENERAL NOTES	F.A.P. RTE.:	SECTION:	COUNTY:	TOTAL SHEETS:	SHEET NO.:
PLOT SCALE: 1/8"=1'-0"	CHECKED: -	REVISED: -	46			(2, 2-1) Y	LASALLE	23	2	
PLOT DATE: 3/27/2015	DATE: -	REVISED: -	SCALE:			SHEET OF SHEETS	STA. TO STA.	CONTRACT NO. 66D06		
						ILLINOIS FED. AID PROJECT				

CONSTR. CODE

90% FED.
10% STATE

ROADWAY

0021

RURAL

CODE NO.	ITEM	UNIT	TOTAL QUANTITY	
20200100	EARTH EXCAVATION	CU YD	510	510
20400800	FURNISHED EXCAVATION	CU YD	2172	2172
25000210	SEEDING, CLASS 2A	ACRE	0.87	0.87
25000310	SEEDING, CLASS 4	ACRE	0.24	0.24
25000400	NITROGEN FERTILIZER NUTRIENT	POUND	100	100
25000500	PHOSPHORUS FERTILIZER NUTRIENT	POUND	100	100
25000600	POTASSIUM FERTILIZER NUTRIENT	POUND	100	100
25100630	EROSION CONTROL BLANKET	SQ YD	5372	5372
28000400	PERIMETER EROSION BARRIER	FOOT	1050	1050
28000500	INLET AND PIPE PROTECTION	EACH	2	2
31100910	SUBBASE GRANULAR MATERIAL, TYPE A 12"	SQ YD	1551	1551
31101900	SUBBASE GRANULAR MATERIAL, TYPE C	TON	46	46
35300200	PORTLAND CEMENT CONCRETE BASE COURSE 7"	SQ YD	997	997
40600275	BITUMINOUS MATERIALS (PRIME COAT)	POUND	2818	2818

* SPECIALTY ITEM

FILE NAME =	USER NAME = budzynskim	DESIGNED -	REVISED -	STATE OF ILLINOIS DEPARTMENT OF TRANSPORTATION	SUMMARY OF QUANTITIES	F.A.P. RTE.	SECTION	COUNTY	TOTAL SHEETS	SHEET NO.	
c:\pwork\pwork\budzynskim\4033351510	66006-sh1-500.dgn	DRAWN -	REVISED -			46	(2, 2-1) Y	LASALLE	23	3	
PLOT SCALE = 1/8" = 1' / in.	CHECKED -	REVISED -				SCALE: SHEET OF SHEETS STA. TO STA.		CONTRACT NO. 66006		ILLINOIS FED. AID PROJECT	
PLOT DATE = 3/27/2015	DATE -	REVISED -									

CONSTR. CODE

90% FED.
10% STATE

CODE NO.	ITEM	UNIT	TOTAL QUANTITY	ROADWAY
				0021 RURAL
40600637	LEVELING BINDER (MACHINE METHOD), 1L-9.5FG, N70	TON	85	85
40603340	HOT-MIX ASPHALT SURFACE COURSE, MIX "D", N70	TON	412	412
44000100	PAVEMENT REMOVAL	SQ YD	42	42
44000155	HOT-MIX ASPHALT SURFACE REMOVAL, 1 1/2"	SQ YD	3888	3888
44004250	PAVED SHOULDER REMOVAL	SQ YD	332	332
48101500	AGGREGATE SHOULDERS, TYPE B 6"	SQ YD	444	444
48203029	HOT-MIX ASPHALT SHOULDERS, 8"	SQ YD	584	584
60608600	COMBINATION CONCRETE CURB AND GUTTER, TYPE M-6.06	FOOT	27	27
60610400	COMBINATION CONCRETE CURB AND GUTTER, TYPE M-6.24	FOOT	50	50
60618300	CONCRETE MEDIAN SURFACE, 4 INCH	SQ FT	149	149
* 63000005	STEEL PLATE BEAM GUARDRAIL, TYPE B	FOOT	12.5	12.5
* 63100169	TRAFFIC BARRIER TERMINAL, TYPE 1 (SPECIAL) FLARED	EACH	1	1
63200310	GUARDRAIL REMOVAL	FOOT	330	330
67000400	ENGINEER'S FIELD OFFICE, TYPE A	CAL MO	3	3

* Specialty Items

FILE NAME *	USER NAME * budzynskm	DESIGNED -	REVISED -	STATE OF ILLINOIS DEPARTMENT OF TRANSPORTATION	SUMMARY OF QUANTITIES	F.A.P. RTE.	SECTION	COUNTY	TOTAL SHEETS	SHEET NO.
66006-111-500.dgn	DRAWN -	REVISED -	46			(2, 2-1) Y	LASALLE	23	4	
PLOT SCALE * 1/8" = 1'-0"	CHECKED -	REVISED -	CONTRACT NO. 66006							
PLOT DATE * 3/27/2015	DATE -	REVISED -	ILLINOIS FED. AID PROJECT							
				SCALE: SHEET OF SHEETS STA. TO STA.						

CONSTR. CODE

90% FED.
10% STATE

CODE NO.	ITEM	UNIT	TOTAL QUANTITY	ROADWAY	
				0021	RURAL
67100100	MOBILIZATION	L SUM	1	1	
70100460	TRAFFIC CONTROL AND PROTECTION, STANDARD 701306	L SUM	1	1	
70100500	TRAFFIC CONTROL AND PROTECTION, STANDARD 701326	L SUM	1	1	
70103815	TRAFFIC CONTROL SURVEILLANCE	CAL DA	40	40	
70300100	SHORT TERM PAVEMENT MARKING	FOOT	7226	7226	
70301000	WORK ZONE PAVEMENT MARKING REMOVAL	SQ FT	1204	1204	
* 72000100	SIGN PANEL - TYPE 1	SQ FT	6.25	6.25	
* 73000100	WOOD SIGN SUPPORT	FOOT	14	14	
* 78000100	THERMOPLASTIC PAVEMENT MARKING - LETTERS AND SYMBOLS	SQ FT	47	47	
* 78000200	THERMOPLASTIC PAVEMENT MARKING - LINE 4"	FOOT	1950	1950	
* 78000400	THERMOPLASTIC PAVEMENT MARKING - LINE 6"	FOOT	280	280	
* 78000500	THERMOPLASTIC PAVEMENT MARKING - LINE 8"	FOOT	923	923	
* 78000600	THERMOPLASTIC PAVEMENT MARKING - LINE 12"	FOOT	260	260	
* 78000650	THERMOPLASTIC PAVEMENT MARKING - LINE 24"	FOOT	26	26	

* SPECIALTY ITEM

FILE NAME *	USER NAME * budzynskm	DESIGNED -	REVISED -
c:\pwwork\pwwork\budzynskm\66006\66006.dwg	66006-shr-500.dgn	DRAWN -	REVISED -
	PLOT SCALE * 1/8" = 1' / in.	CHECKED -	REVISED -
	PLOT DATE * 3/27/2015	DATE -	REVISED -

STATE OF ILLINOIS
DEPARTMENT OF TRANSPORTATION

SUMMARY OF QUANTITIES

SCALE: SHEET OF SHEETS STA. TO STA.

F.A.P. RTE.	SECTION	COUNTY	TOTAL SHEETS	SHEET NO.
46	(2, 2-1) Y	LASALLE	23	5
ILLINOIS/FED. AID PROJECT			CONTRACT NO. 66006	

CODE NO.	ITEM	UNIT	TOTAL QUANTITY	CONSTR. CODE	
				ROADWAY 0021	RURAL
* 78100100	RAISED REFLECTIVE PAVEMENT MARKER	EACH	28		28
* 78200100	MONODIRECTIONAL PRISMATIC BARRIER REFLECTOR	EACH	2		2
* 78200300	PRISMATIC CURB REFLECTOR	EACH	12		12
* 78201000	TERMINAL MARKER - DIRECT APPLIED	EACH	1		1
78300200	RAISED REFLECTIVE PAVEMENT MARKER REMOVAL	EACH	20		20
X0321156	HIGH VISIBILITY TEMPORARY FENCING	FOOT	1050		1050
X2010505	CLEARING, SPECIAL	L SUM	1		1
Z0030850	TEMPORARY INFORMATION SIGNING	SO FT	42		42

* SPECIALTY ITEM

FILE NAME *	USER NAME * budzynskm	DESIGNED -	REVISED -	STATE OF ILLINOIS DEPARTMENT OF TRANSPORTATION	SUMMARY OF QUANTITIES				F.A.P. RTE.	SECTION	COUNTY	TOTAL SHEETS	SHEET NO.
c:\pwwork\pwwork\budzynskm\0033301010	66006-ah-500.pgn	DRAWN -	REVISED -		46	(2, 2-1) Y	LASALLE	23	6				
PLOT SCALE = 1/8" = 1'-0"	CHECKED -	REVISED -			SCALE: SHEET OF SHEETS STA. TO STA.				CONTRACT NO. 66006				
PLOT DATE = 3/27/2015	DATE -	REVISED -			ILLINOIS FED. AID PROJECT								

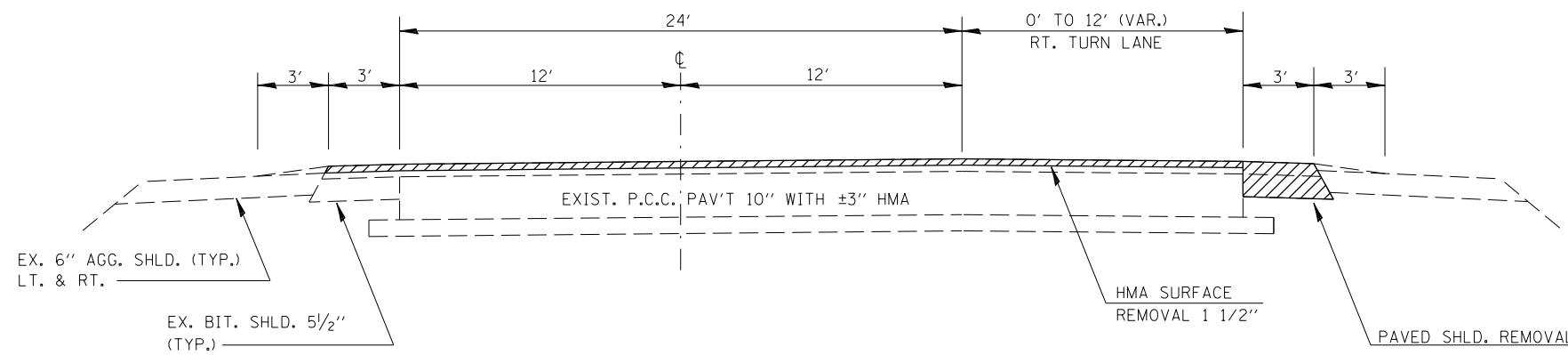

EXISTING TYPICAL SECTION

STA. 230+51 TO STA. 239+83

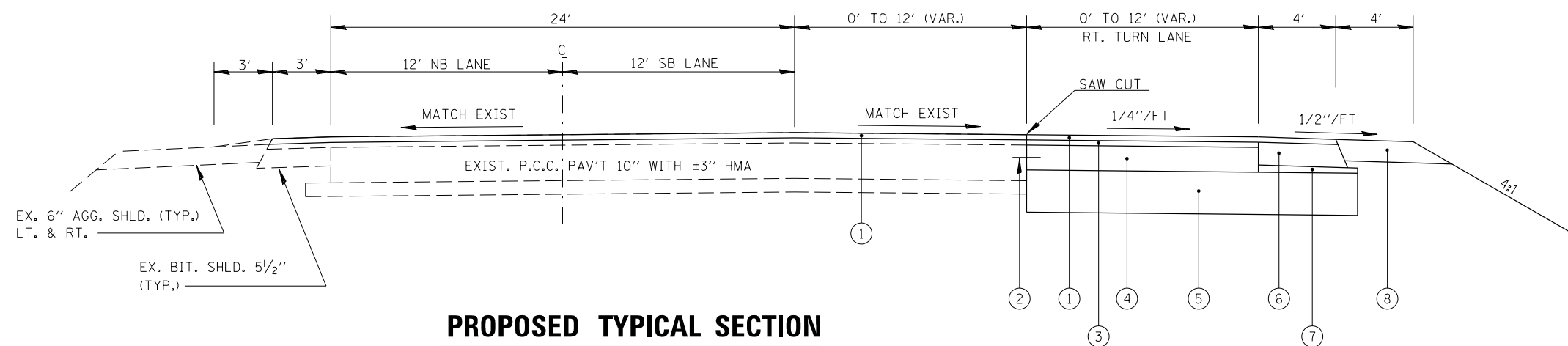

PROPOSED TYPICAL SECTION

STA. 230+51 TO STA. 239+83

- ① 1 1/2" HMA SURFACE COURSE, MIX "D", N70
- ② NO. 6 TIE BARS AT 30" CENTERS (SEE STANDARD)
- ③ 1 1/2" LEVELING BINDER, IL-9.5 FG, N70
- ④ PCC BASE COURSE, 7"
- ⑤ SUBBASE GRANULAR MATERIAL, TYPE A 12"
- ⑥ HMA SHOULDER, 8"
- ⑦ SUBBASE GRANULAR MATERIAL, TYPE C
- ⑧ AGGREGATE SHOULDER, TYPE B 6"

NOTE: SAW CUT WILL BE INCLUDED IN THE COST OF PAVED SHOULDER REMOVAL

FILE NAME =	USER NAME = budzynskim	DESIGNED -	REVISED -
ca:\pwork\pwork\budzynskim\d0333515\0366006-shd-typ1001.dgn		DRAWN -	REVISED -
PLOT SCALE = 100.0000' / 1in.		CHECKED -	REVISED -
PLOT DATE = 3/27/2015		DATE -	REVISED -

**STATE OF ILLINOIS
DEPARTMENT OF TRANSPORTATION**

TYPICAL SECTIONS

SCALE: SHEET OF SHEETS STA. TO STA.

F.A.P. RTE.	SECTION	COUNTY	TOTAL SHEETS	SHEET NO.
46	(2, 2-1) Y	LASALLE	23	7
CONTRACT NO. 66D06			ILLINOIS FED. AID PROJECT	

PAVEMENT WIDENING AND RESURFACING SCHEDULE												
LOCATION	LENGTH	WIDTH	SUBBASE GRANULAR MATL 12"	PCC BASE COURSE 7"	SUBBASE GRAN MATL TY C	LEV BIND IL-9.5 FG N70 1 1/2"	HMA SC MIX "D" N70 1 1/2"	BIT MATLS PRIME COAT	HMA SHOULDER 8"	AGG SHOULDER TY B, 6"	PAVED SHOULDER REMOVAL	HMA SURFACE REM, 1 1/2"
	FOOT	FOOT	SQ YD	SQ YD	TON	TON	TON	POUND	SQ YD	SQ YD	SQ YD	SQ YD
NORTHBOUND LANE & SHOULDER	932	15					131	699				1553
SOUTHBOUND LANE	932	12					105	559				1243
TURN LANE AND INTERSECTION WIDENING		24 & VAR										
NW QUADRANT*			1112	706	34	60	125	1050	326	328	243	782
SW QUADRANT*			439	291	12	25	51	510	258	116	89	310
TOTAL			1551	997	46	85	412	2818	584	444	332	3888

*QUANTITIES INCLUDE THE WORK COMPLETED ON OR ADJACENT TO THE SIDEROAD

PAVEMENT MARKING SCHEDULE												
LOCATION	THERMOPLASTIC PAVEMENT MARKINGS						LETTERS & SYMBOLS	RAISED REF PVT MKR (AMBER)	RAISED REF PVT MKR (CRYSTAL)	RAISED REF PVT MKR REM	SHORT TERM PVMT MKING	WORK ZONE PAVT MK REM
	4"	6"	8"	12"	24"							
	WHITE	YELLOW	WHITE	WHITE	WHITE							
EDGELINES	1950										3700	617
IL 251 CENTERLINE		240					12		12		480	80
CEDAR CREEK RD CENTERLINE		40					2		2		80	13
TURN LANE HATCHED AREA			860	260				14	6		2240	373
TURN LANE ARROWS (3)						47					288	48
TURN LANE SKIP DASH			63								126	21
STOP BARS					26						312	52
TOTAL	1950	280	923	260	26	47		28	20		7226	1204

LANDSCAPING AND EROSION CONTROL SCHEDULE									
LOCATION	SEEDING CL 2A	SEEDING CL 4	NITROGEN FERT NUTR	PHOSPHORUS FERT NUTR	POTASSIUM FERT NUTR	EROSION CONTROL BLANKET	PERIMETER EROSION BARRIER	HIGH VIS TEMPORARY FENCING	INLET AND PIPE PROTECTION
	ACRE	ACRE	POUND	POUND	POUND	SQ YD	FOOT	FOOT	EACH
NW QUADRANT	0.64	0.16	72	72	72	3872	700	700	1
SW QUADRANT	0.23	0.08	28	28	28	1500	350	350	1
TOTAL	0.87	0.24	100	100	100	5372	1050	1050	2

EARTHWORK SCHEDULE				
LOCATION	EARTH EXCAVATION	EARTH EX ADJUSTED FOR SHRINKAGE (NOTE 1)	EMBANKMENT	EARTHWORK BALANCE WASTE (+) OR SHORTAGE (-)
	CU YD	CU YD	CU YD	CU YD
IL 251 MAINLINE	420	315	2275	-1960
SIDEROAD, LT & RT	90	68	280	-212
TOTAL	510	383	2555	-2172

NOTE 1. ESTIMATED SHRINKAGE FACTOR IS 25%

RAISED ISLAND SCHEDULE						
CONC MEDIAN SURFACE, 4"	COMB CC&G TYPE M-6.06	COMB CC&G TYPE M-6.24	PRISMATIC CURB REFL	PAVEMENT REMOVAL	SIGN PANEL TYPE 1	WOOD SIGN SUPPORT
SQ FT	FOOT	FOOT	EACH	SQ YD	SQ FT	FOOT
149	27	50	12	42	6.25	14

GUARDRAIL REMOVAL AND REPLACEMENT SCHEDULE				
STEEL PLATE BEAM GUARDRAIL TY B	TRAFFIC BARRIER TERMINAL, TY 1 (SPECIAL) FLARED	TERMINAL MARKER DIRECT APPLIED	MONODIRECTIONAL PRISMATIC BARRIER REFLECTOR	GUARDRAIL REMOVAL
FOOT	EACH	EACH	EACH	FOOT
13	1	1	2	330

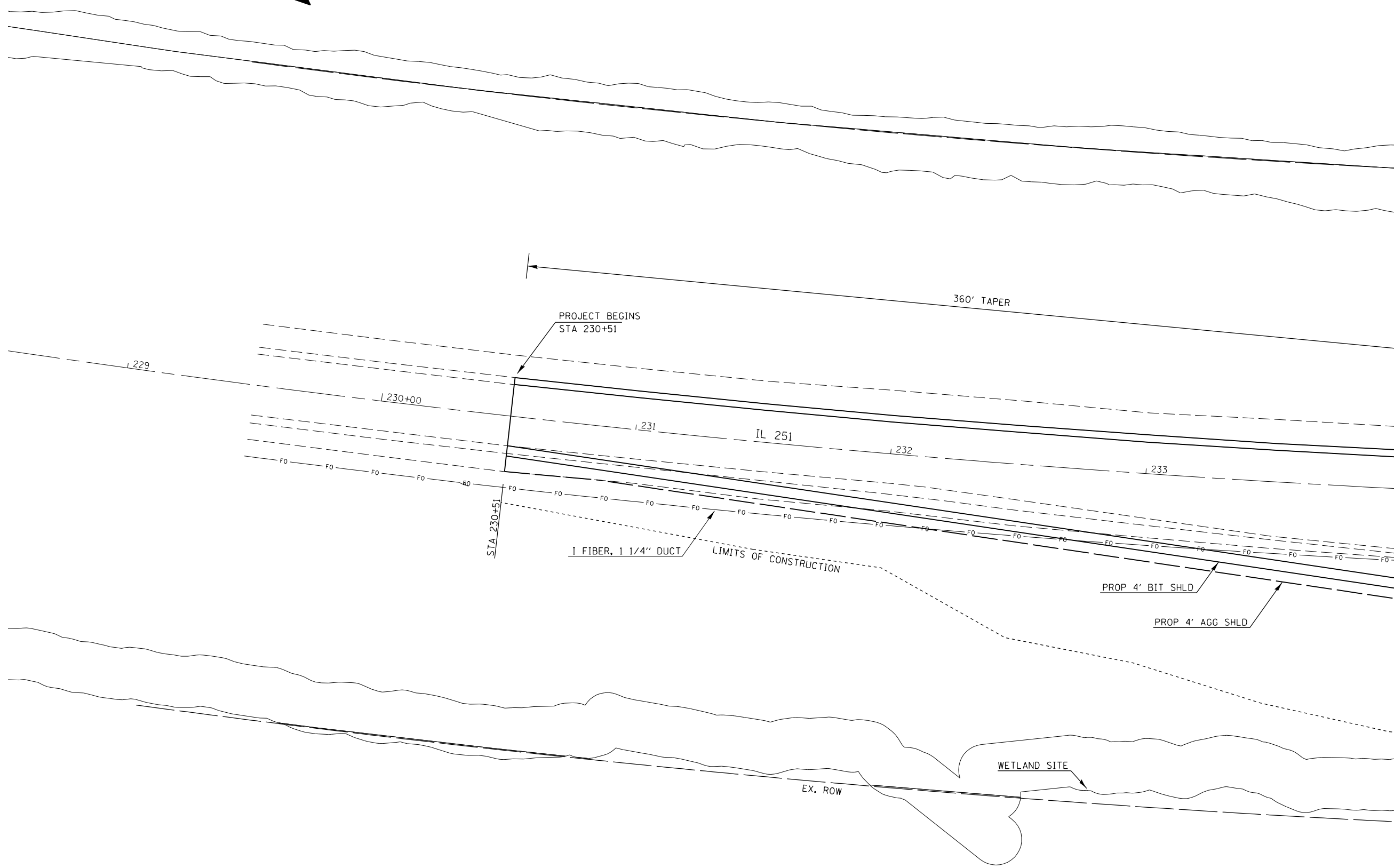

MATCHLINE STA. 234+00

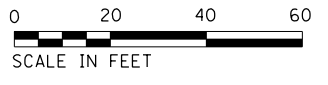

FILE NAME =	USER NAME = budzynskim	DESIGNED -	REVISED -
et:\pw\work\p\dot\budzynskim\d0333515\0366006-sht-plan.dgn		DRAWN -	REVISED -
	PLOT SCALE = 40.0000' / in.	CHECKED -	REVISED -
	PLOT DATE = 3/27/2015	DATE -	REVISED -

**STATE OF ILLINOIS
DEPARTMENT OF TRANSPORTATION**

PLAN VIEW			
SCALE:	SHEET	OF SHEETS	STA. TO STA.

F.A.P. RTE.	SECTION	COUNTY	TOTAL SHEETS	SHEET NO.
46	(2, 2-1) Y	LASALLE	23	9
CONTRACT NO. 66D06				
ILLINOIS FED. AID PROJECT				



MATCHLINE STA. 234+00

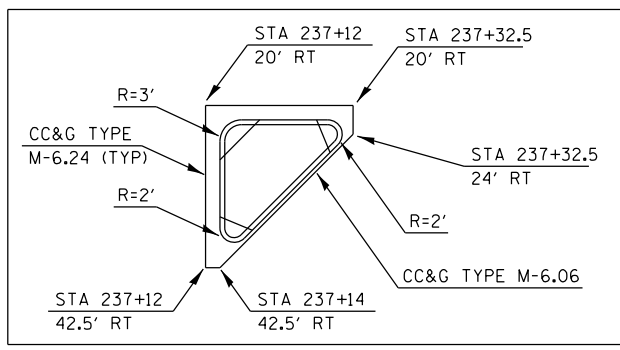
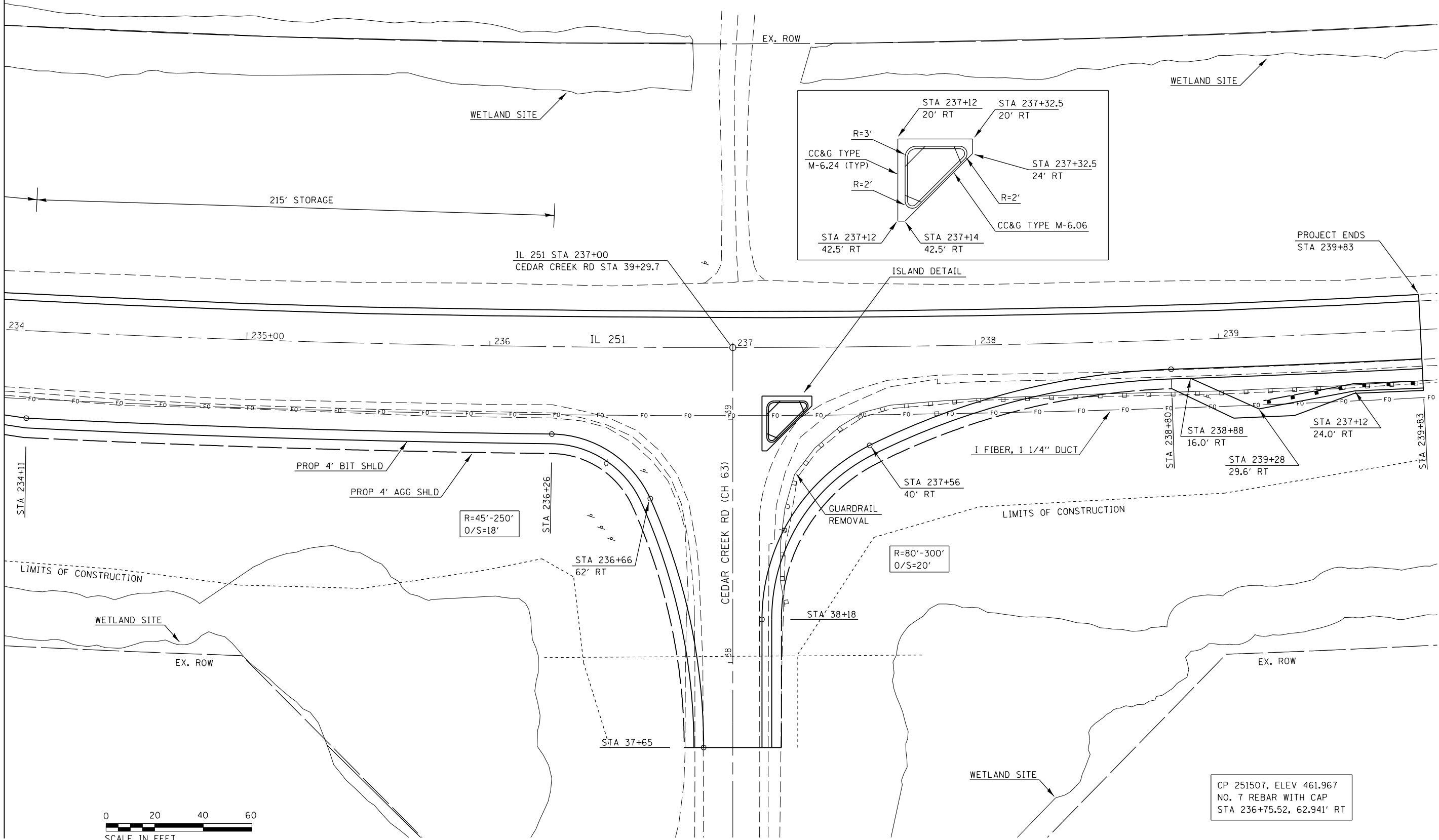

CP 251507, ELEV 461.967
NO. 7 REBAR WITH CAP
STA 236+75.52, 62.941' RT

FILE NAME =	USER NAME = budzynskim	DESIGNED -	REVISED -
ca:\pwork\pwork\budzynskim\d0333515\0366006-sht-plan.dgn		DRAWN -	REVISED -
	PLOT SCALE = 40.0000' / in.	CHECKED -	REVISED -
	PLOT DATE = 3/27/2015	DATE -	REVISED -

**STATE OF ILLINOIS
DEPARTMENT OF TRANSPORTATION**

PLAN VIEW			
SCALE:	SHEET	OF SHEETS	STA. TO STA.

F.A.P. RTE.	SECTION	COUNTY	TOTAL SHEETS	SHEET NO.
46	(2, 2-1) Y	LASALLE	23	10
CONTRACT NO. 66D06				
ILLINOIS FED. AID PROJECT				

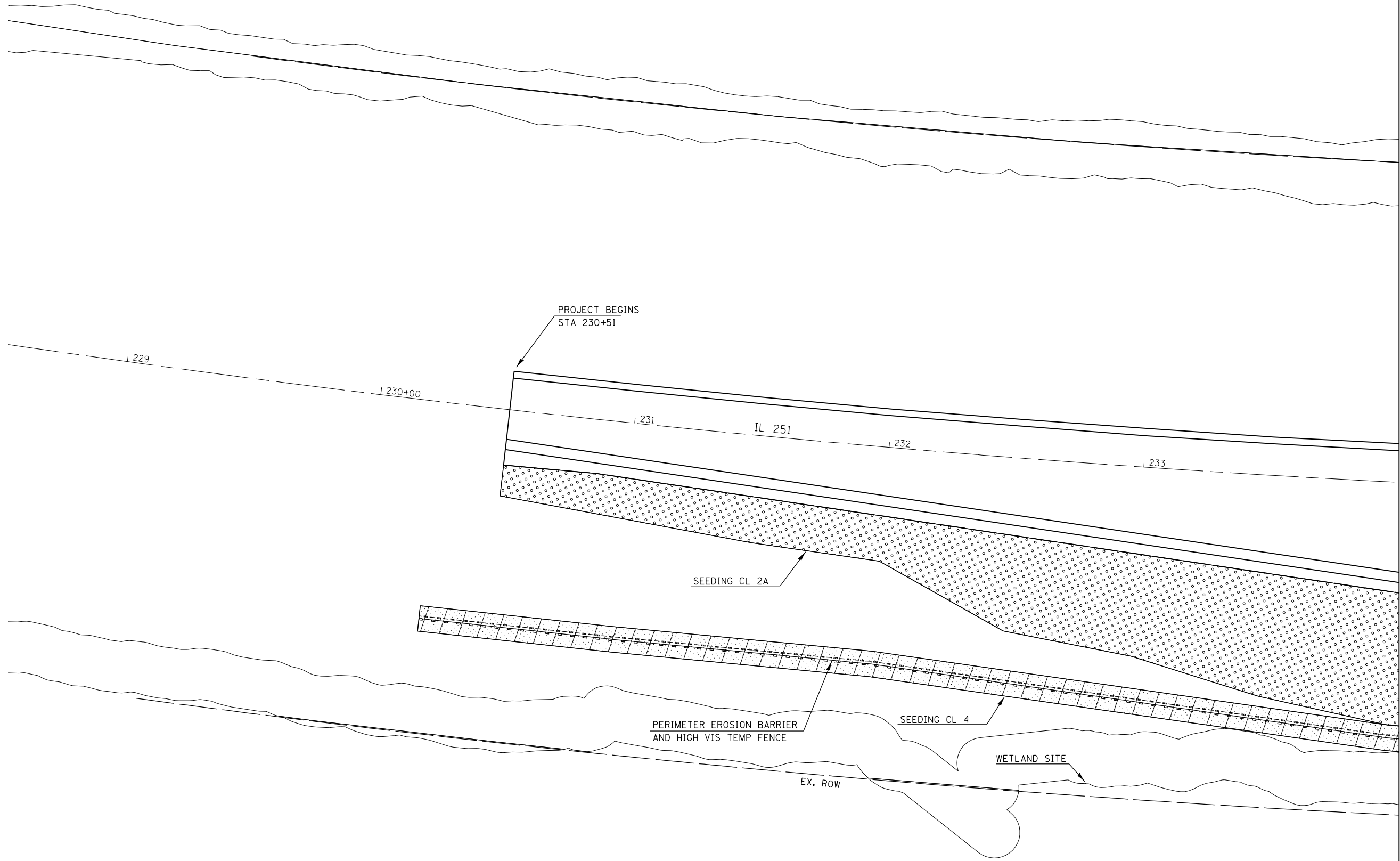

MATCHLINE STA. 234+00



FILE NAME =	USER NAME = budzynskim	DESIGNED -	REVISED -
et:\pw\work\p\dot\budzynskim\d0333515\0366006-sht-plan.dgn		DRAWN -	REVISED -
	PLOT SCALE = 40.0000' / in.	CHECKED -	REVISED -
	PLOT DATE = 3/27/2015	DATE -	REVISED -

**STATE OF ILLINOIS
DEPARTMENT OF TRANSPORTATION**

EROSION CONTROL PLAN

SCALE: SHEET OF SHEETS STA. TO STA.

F.A.P. RTE.	SECTION	COUNTY	TOTAL SHEETS	SHEET NO.
46	(2, 2-1) Y	LASALLE	23	11
CONTRACT NO. 66D06				
ILLINOIS FED. AID PROJECT				



MATCHLINE STA. 234+00

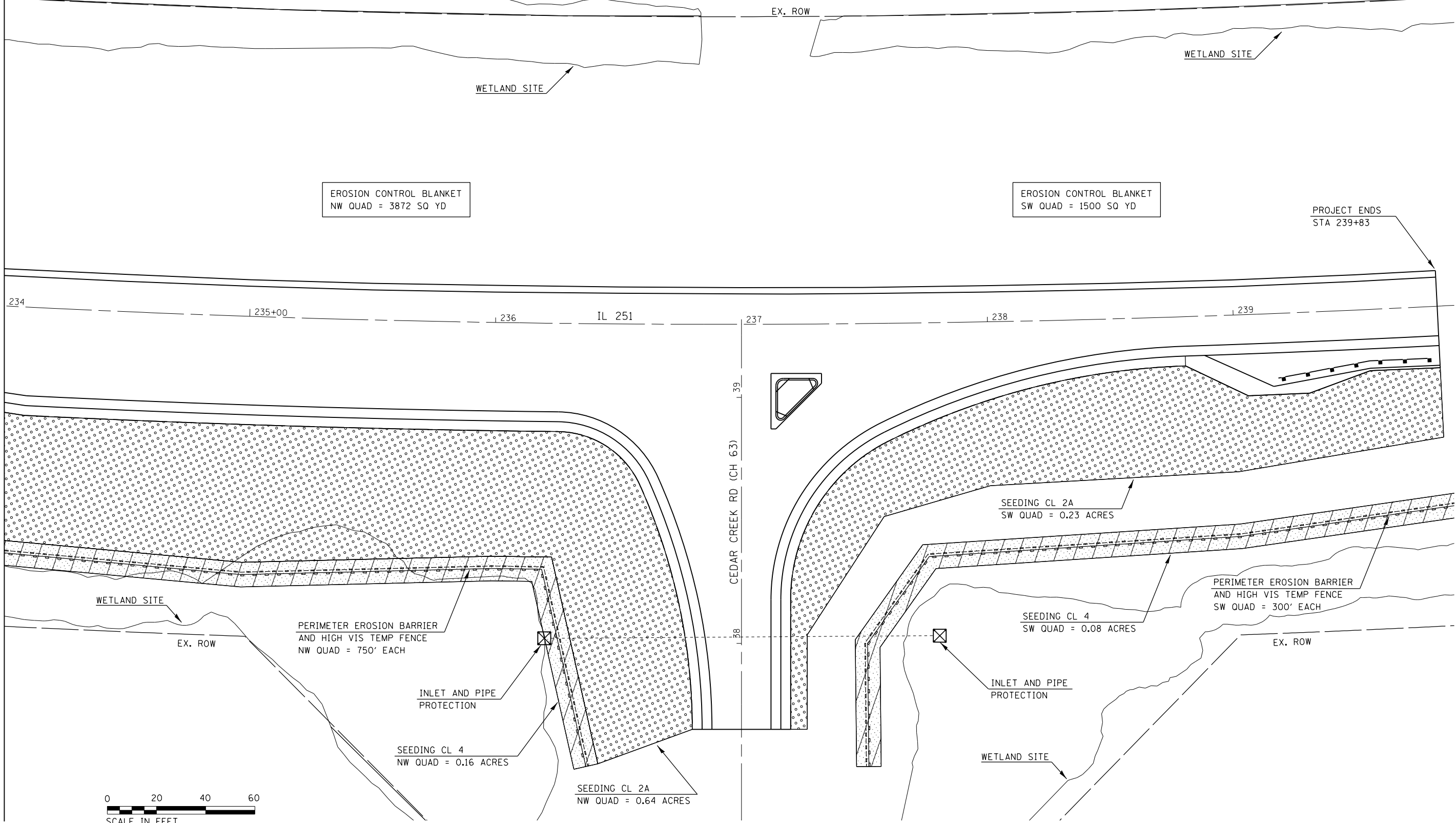

FILE NAME =	USER NAME = budzynskim	DESIGNED -	REVISED -
et:\pw\work\pwidot\budzynskim\d0333515\0366006-sht-plan.dgn		DRAWN -	REVISED -
		CHECKED -	REVISED -
		DATE -	REVISED -

**STATE OF ILLINOIS
DEPARTMENT OF TRANSPORTATION**

EROSION CONTROL PLAN				
SCALE:	SHEET	OF	SHEETS	STA. TO STA.

F.A.P. RTE.	SECTION	COUNTY	TOTAL SHEETS	SHEET NO.
46	(2, 2-1) Y	LASALLE	23	12
CONTRACT NO. 66006				
ILLINOIS FED. AID PROJECT				

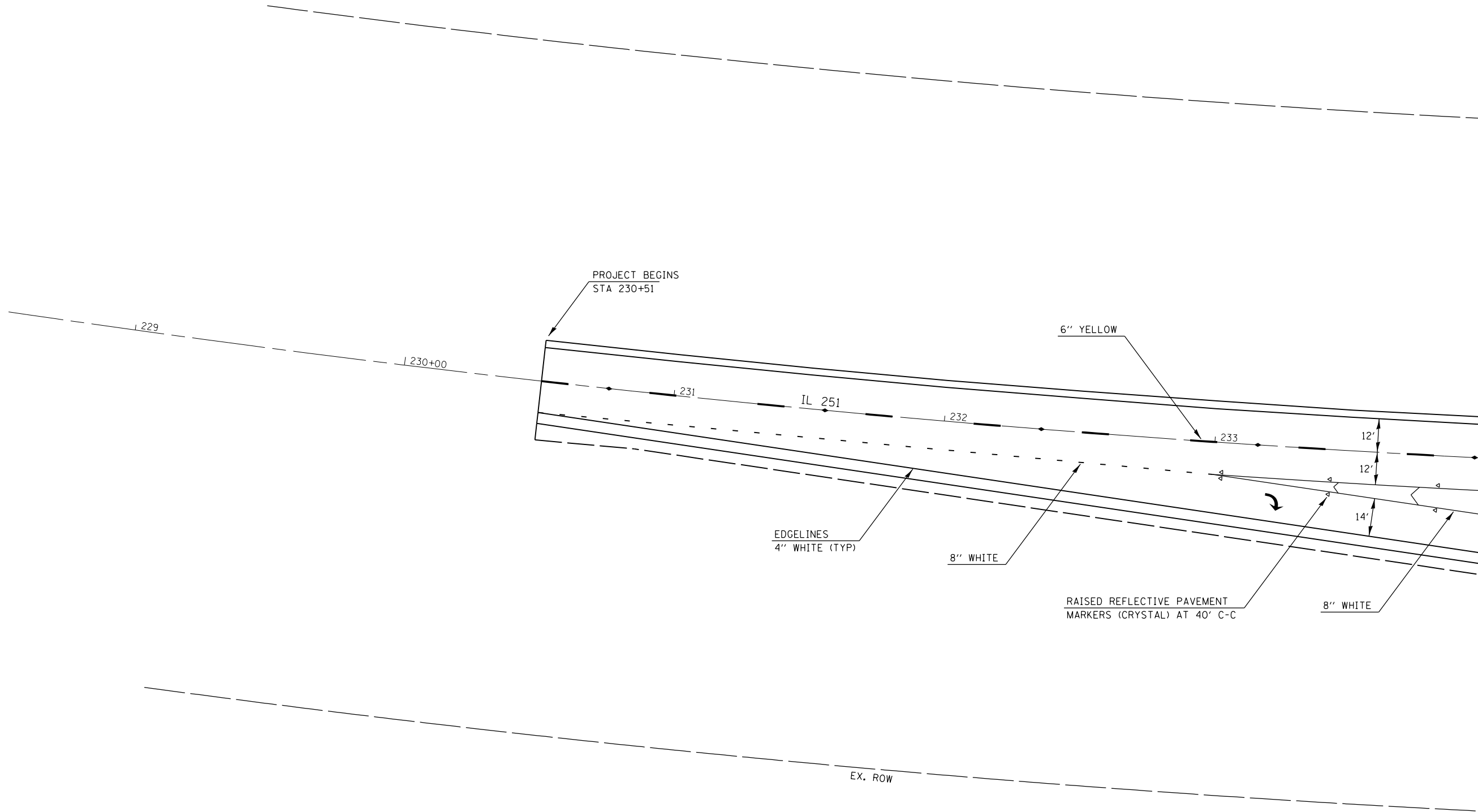

MATCHLINE STA. 234+00

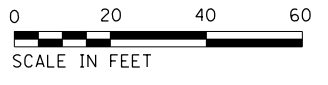

FILE NAME =	USER NAME = budzynskim	DESIGNED -	REVISED -
et:\pw\work\p\dot\budzynskim\d0333515\0366006-sht-plan.dgn		DRAWN -	REVISED -
	PLOT SCALE = 40.0000' / in.	CHECKED -	REVISED -
	PLOT DATE = 3/27/2015	DATE -	REVISED -

**STATE OF ILLINOIS
DEPARTMENT OF TRANSPORTATION**

PAVEMENT MARKING PLAN			
SCALE:	SHEET	OF SHEETS	STA. TO STA.

F.A.P. RTE.	SECTION	COUNTY	TOTAL SHEETS	SHEET NO.
46	(2, 2-1) Y	LASALLE	23	13
CONTRACT NO. 66D06				
ILLINOIS FED. AID PROJECT				



EX. ROW

PROJECT ENDS
STA 239+83

MATCHLINE STA. 234+00

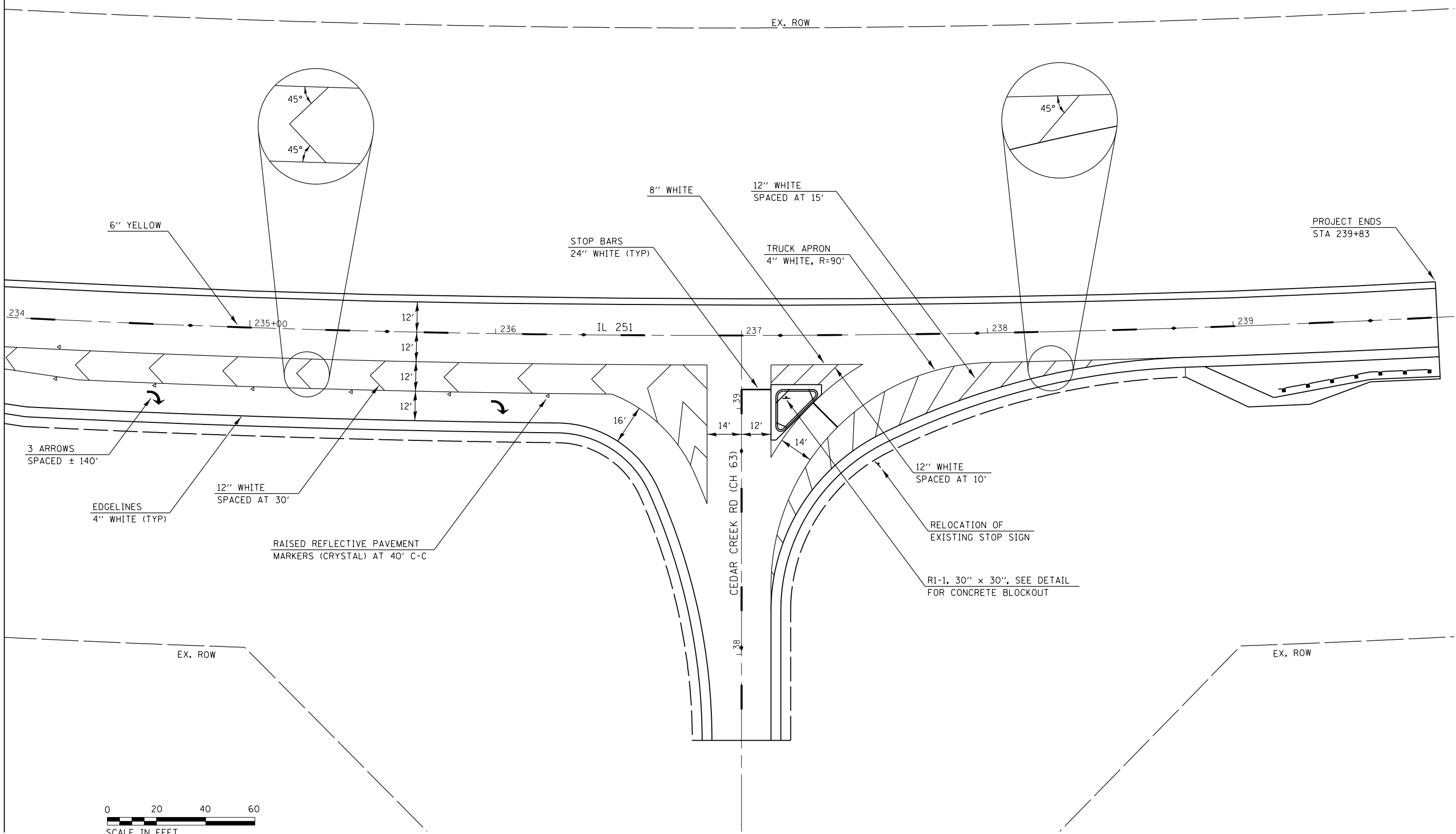

FILE NAME =	USER NAME = budzynskim	DESIGNED -	REVISED -
et:\pw_work\pwidot\budzynskim\d0333515\0366006-sht-plan.dgn		DRAWN -	REVISED -
	PLOT SCALE = 40.0000' / in.	CHECKED -	REVISED -
	PLOT DATE = 3/27/2015	DATE -	REVISED -

**STATE OF ILLINOIS
DEPARTMENT OF TRANSPORTATION**

PAVEMENT MARKING PLAN

SCALE: SHEET OF SHEETS STA. TO STA.

F.A.P. RTE.	SECTION	COUNTY	TOTAL SHEETS	SHEET NO.
46	(2, 2-1) Y	LASALLE	23	14
CONTRACT NO. 66D06				
ILLINOIS FED. AID PROJECT				

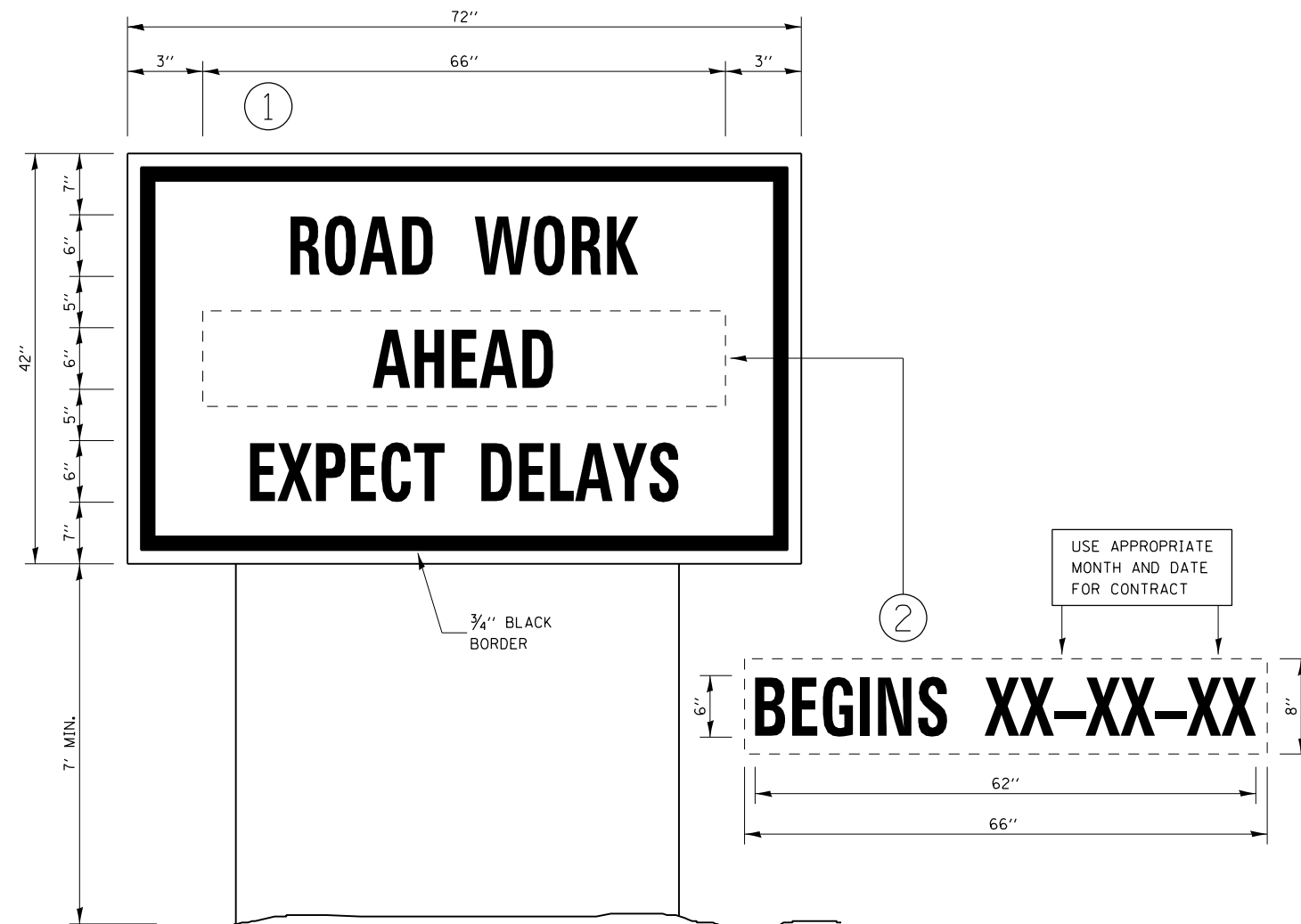

TEMPORARY INFORMATION SIGNING

NOTES:

1. USE 6" D BLACK LETTERING ON FLOURESENT ORANGE BACKGROUND.
2. ERECT SIGNS AT LOCATIONS IN ADVANCE OF THE "ROAD CONSTRUCTION AHEAD" SIGNS AS DIRECTED BY THE ENGINEER.
3. ERECT SIGN ① WITH INSTALLED PANEL ② A MINIMUM OF ONE WEEK PRIOR TO THE START OF THE LANE CLOSURE.
4. REMOVE PANEL ② ON THAT DATE.
5. SEE SPECIAL PROVISION "TEMPORARY INFORMATION SIGNING" FOR ADDITIONAL INFORMATION.
6. WILL BE PAID FOR PER SO FT AS "TEMPORARY INFORMATION SIGNING". EACH SIGN = 21 SO FT AND THE DATE PANEL ② WILL NOT BE MEASURED SEPARATELY FOR PAYMENT.

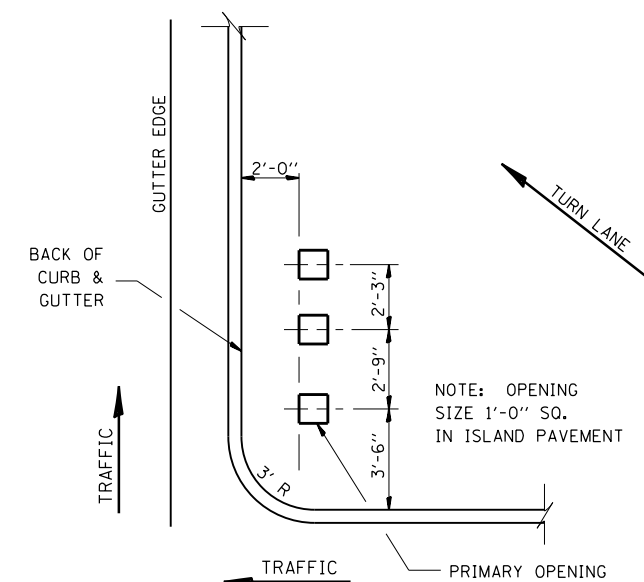

ISLAND SIGN POST SPACING DETAIL

NOTE: THE ENGINEER SHALL DETERMINE THE NUMBER OF OPENINGS REQUIRED.

FILE NAME =	USER NAME = budzynskim	DESIGNED -	REVISED -
e:\pw_work\p1dot\budzynskim\d0333515\0366006-sht-details.dgn		DRAWN -	REVISED -
	PLOT SCALE = 100.0000' / 1in.	CHECKED -	REVISED -
	PLOT DATE = 3/27/2015	DATE -	REVISED -

**STATE OF ILLINOIS
DEPARTMENT OF TRANSPORTATION**

DETAILS			
SCALE:	SHEET	OF SHEETS	STA. TO STA.

F.A.P. RTE.	SECTION	COUNTY	TOTAL SHEETS	SHEET NO.
46	(2, 2-1) Y	LASALLE	23	15
CONTRACT NO. 66D06			ILLINOIS FED. AID PROJECT	

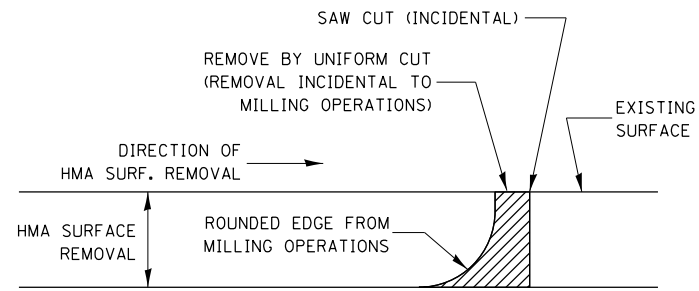

NOTE:
 WHEN MILLING OPERATIONS PRODUCE A ROUNDED EDGE, THEN A SAW CUT SHALL BE USED TO MANUFACTURE A PERPENDICULAR EDGE AS SHOWN IN THE DETAIL. THE ENGINEER SHALL BE THE SOLE JUDGE CONCERNING THE USE OF THIS DETAIL.

HMA DETAIL AT BUTT JOINTS

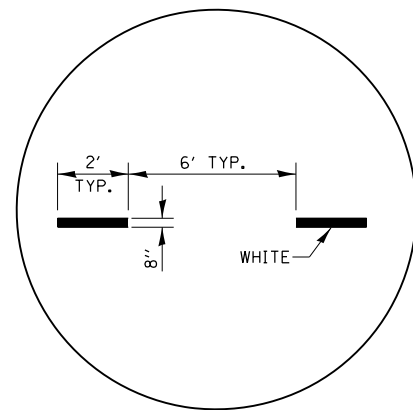

ADVANCE AND INTERSECTION LANE DIVIDER LINES

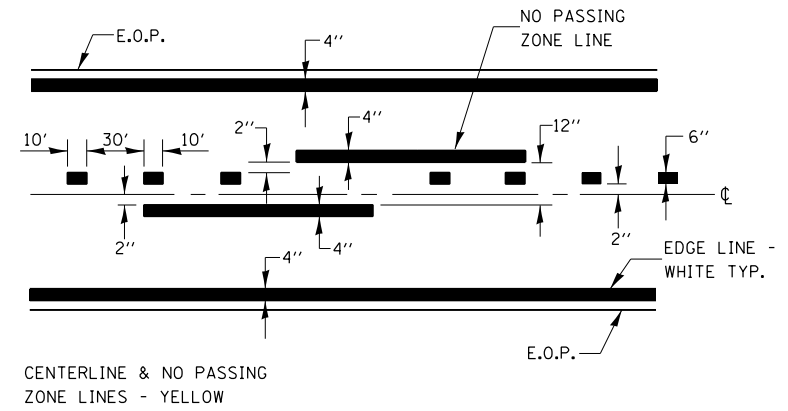

PAVEMENT MARKING

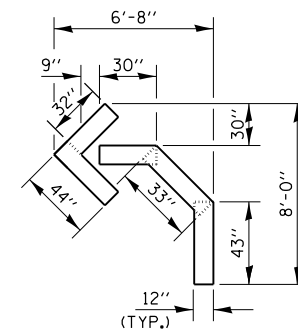

QUANTITY
 12" LINE = 16 LIN. FT.
 OR 4" LINE = 48 LIN. FT.

SHORT-TERM PAVEMENT MARKING

FILE NAME =	USER NAME = budzynskim	DESIGNED -	REVISED -	STATE OF ILLINOIS DEPARTMENT OF TRANSPORTATION	DETAILS				F.A.P. RTE.	SECTION	COUNTY	TOTAL SHEETS	SHEET NO.
et:\pw\work\p\dot\budzynskim\d0333515\0366006-sht-details.dgn		DRAWN -	REVISED -		46	(2, 2-1) Y	LASALLE	23	16				
PLOT SCALE = 100.0000' / 1in.		CHECKED -	REVISED -		CONTRACT NO. 66D06								
PLOT DATE = 3/27/2015		DATE -	REVISED -		SCALE:	SHEET	OF	SHEETS	STA.	TO	STA.	ILLINOIS FED. AID PROJECT	

ORIGINAL SURVEY	SURVEYED	BY	DATE
NOTE BOOK	PLOTTED		
	TEMPLATE		
	AREAS		
	CHECKED		

FINAL SURVEY	SURVEYED	BY	DATE
NOTE BOOK	PLOTTED		
	TEMPLATE		
	AREAS		
	CHECKED		

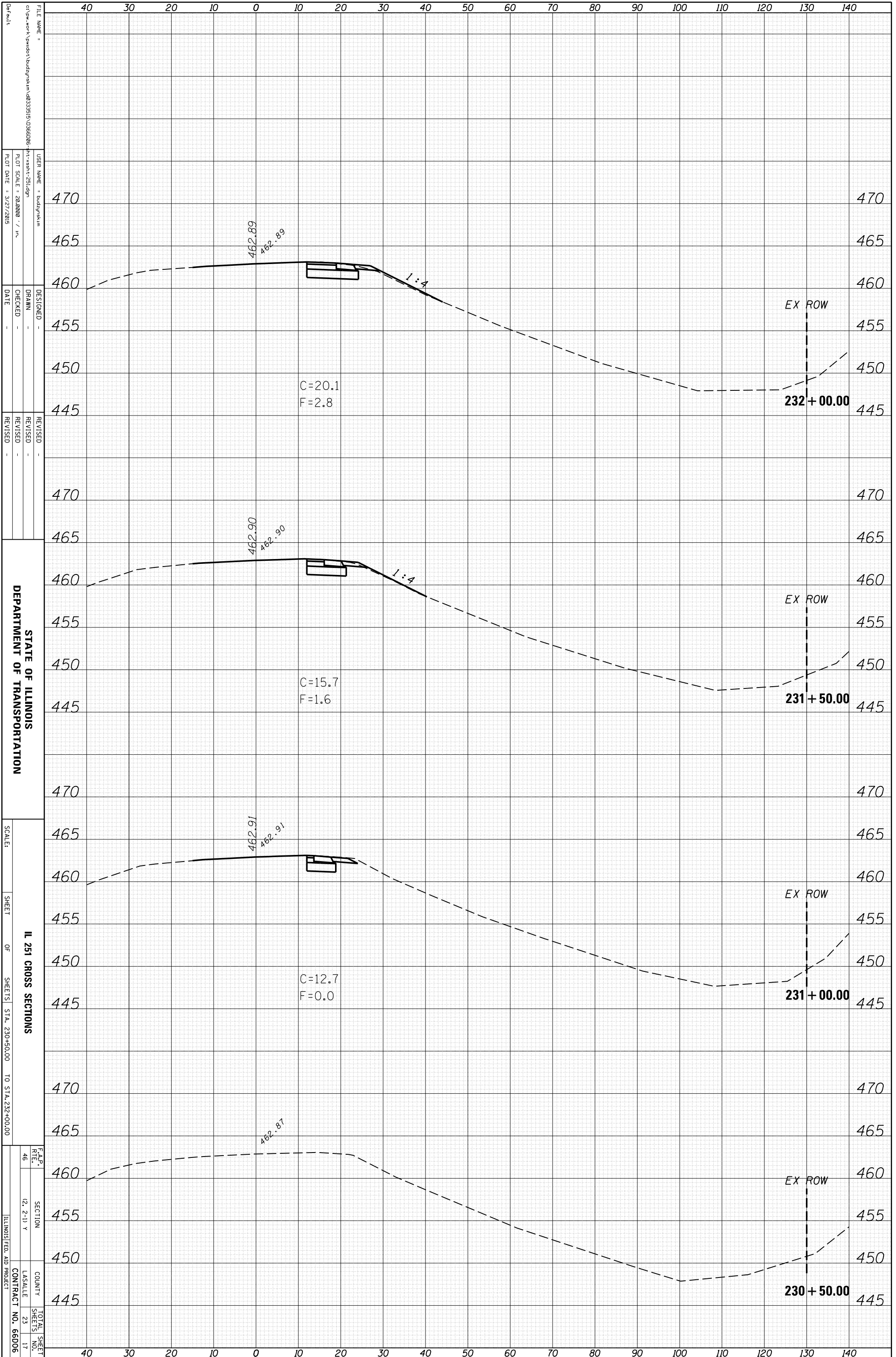

STATE OF ILLINOIS
DEPARTMENT OF TRANSPORTATION

IL 251 CROSS SECTIONS
SHEETS STA. 230+50.00 TO STA. 232+00.00

F.A.P. R.T.E.	SECTION	COUNTY	TOTAL SHEETS
46	(2, 2-1) Y	L.S.A.L.L.E	23
			17
		CONTRACT NO.	66506
		ILLINOIS FED. AID PROJECT	

FILE NAME	USER NAME	DESIGNED	REVISION
...
PLLOT SCALE	CHECKED	DATE	REVISION
...

Default

ORIGINAL SURVEY	SURVEYED	BY	DATE
NOTE BOOK	PLOTTED		
	TEMPLATE		
	AREAS		
	CHECKED		

FINAL SURVEY	SURVEYED	BY	DATE
NOTE BOOK	PLOTTED		
	TEMPLATE		
	AREAS		
	CHECKED		

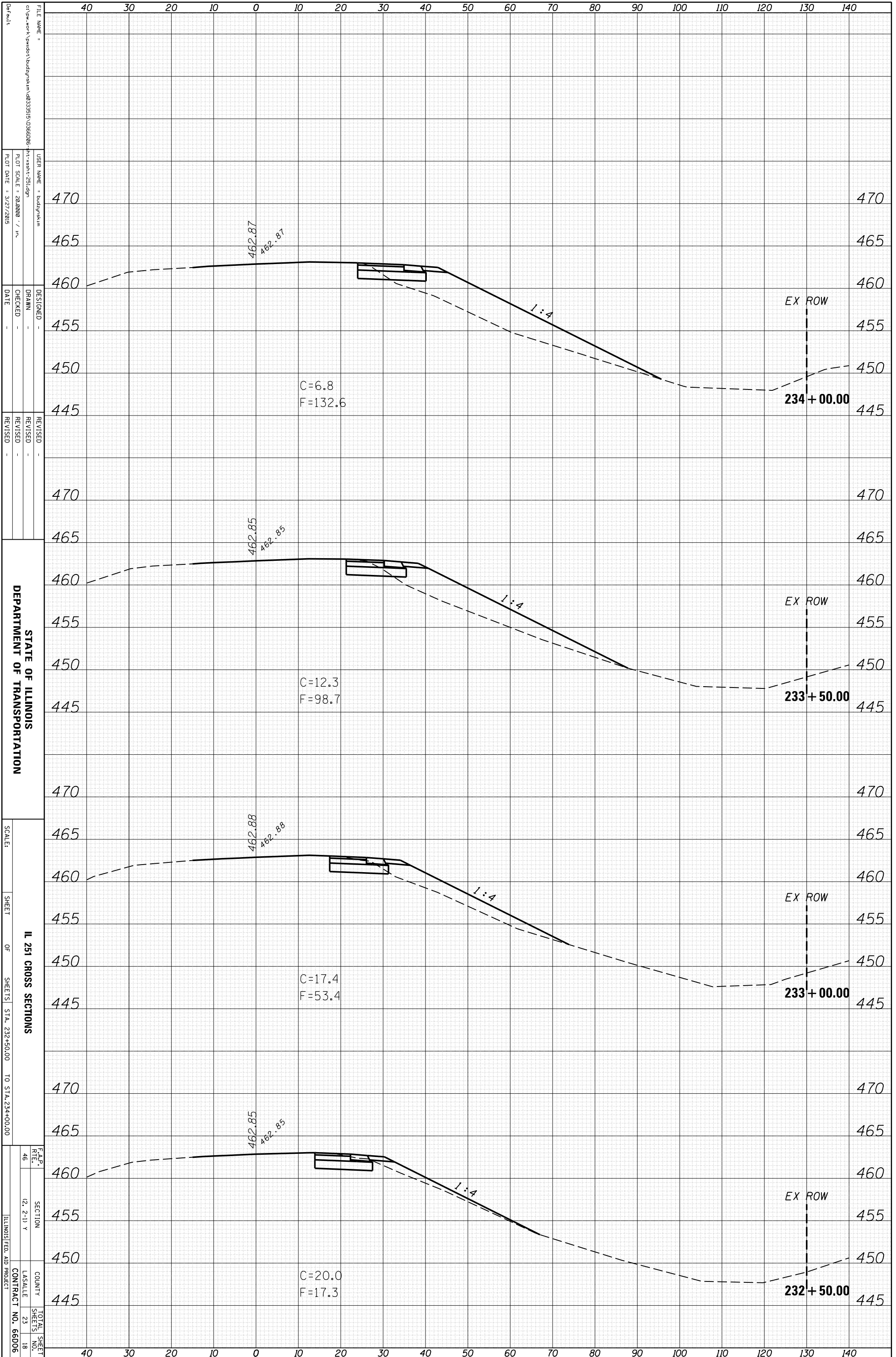

STATE OF ILLINOIS
DEPARTMENT OF TRANSPORTATION

SCALE: SHEET OF SHEETS STA. 232+50.00 TO STA. 234+00.00

IL 251 CROSS SECTIONS

F.A.P. R.T.E.	SECTION	COUNTY	TOTAL SHEETS
46	(2, 2-1) Y	LASALLE	23
			18

CONTRACT NO. 66D06
ILLINOIS FED. AID PROJECT

FILE NAME:
 USER NAME:
 PLOT SCALE:
 PLOT DATE:
 DESIGNED:
 DRAWN:
 CHECKED:
 DATE:
 REVISED:
 REVISED:
 REVISED:

ORIGINAL SURVEY	SURVEYED	BY	DATE
NOTE BOOK	PLOTTED		
	TEMPLATE		
	AREAS		
	CHECKED		

FINAL SURVEY	SURVEYED	BY	DATE
NOTE BOOK	PLOTTED		
	TEMPLATE		
	AREAS		
	CHECKED		

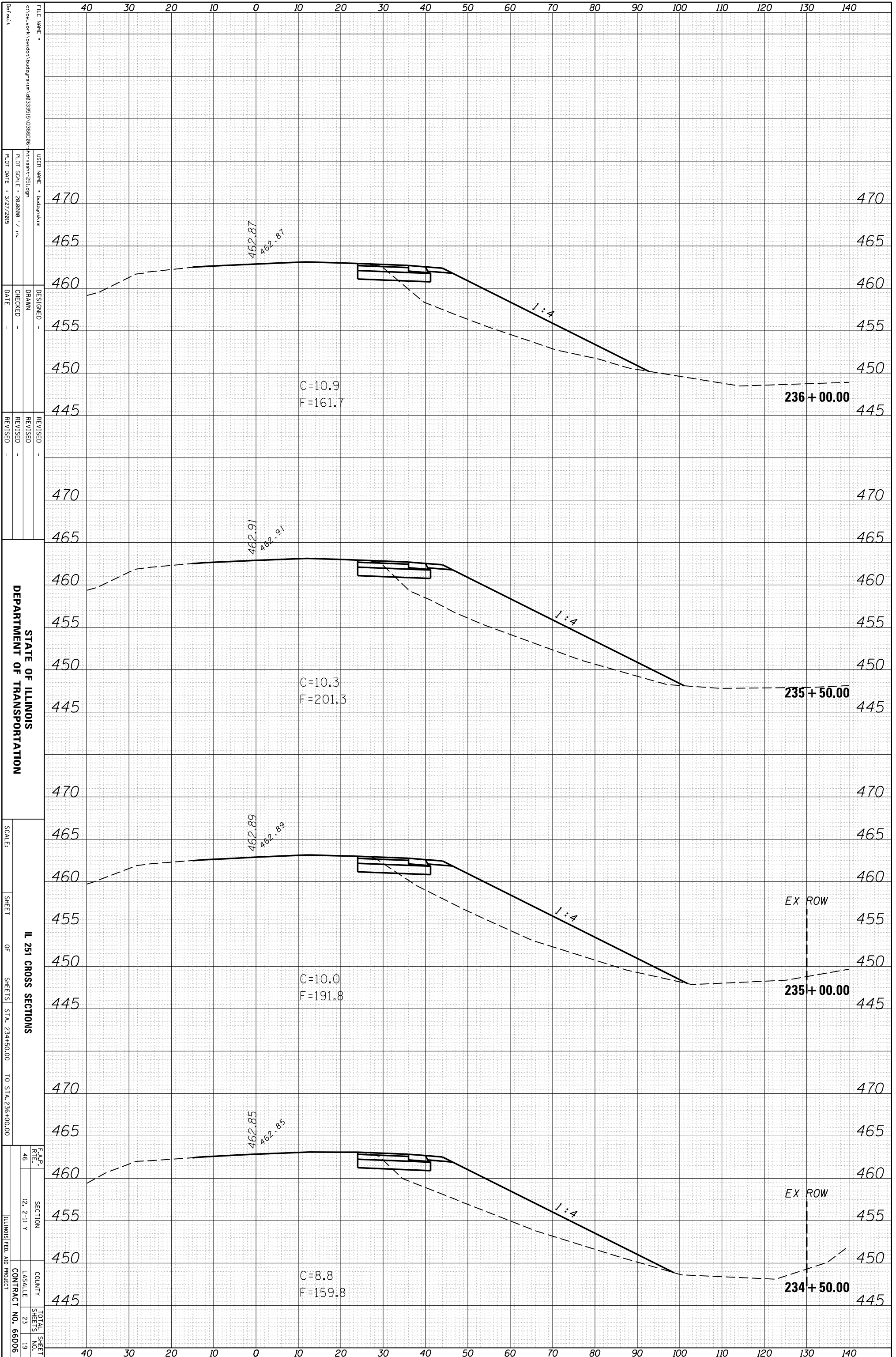

STATE OF ILLINOIS
DEPARTMENT OF TRANSPORTATION

SCALE: SHEET OF SHEETS STA. 234+50.00 TO STA. 236+00.00

IL 251 CROSS SECTIONS
F.A.P. R.T.E. 46 SECTION (2, 2-1) Y COUNTY L.S.A.L.L.E CONTRACT NO. 66D06 TOTAL SHEET SHEETS 23 NO. 19 ILLINOIS FED. AID PROJECT

FILE NAME: c:\pwworkspace\bdg\proj\m\48333515\0366006-111-111-251.dgn
USER NAME: bdg\jstakm
DESIGNED: DRAWN: CHECKED: DATE: REVISED: REVISED: REVISED:

FLY SCALE: 28,000 / in.
PLOT DATE: 3/27/2015

IL 251 CROSS SECTIONS

CONTRACT NO. 66D06

ORIGINAL SURVEY	SURVEYED	BY	DATE
NOTE BOOK	PLOTTED		
	TEMPLATE		
	AREAS		
	AREAS CHECKED		

FINAL SURVEY	SURVEYED	BY	DATE
NOTE BOOK	PLOTTED		
	TEMPLATE		
	AREAS		
	AREAS CHECKED		

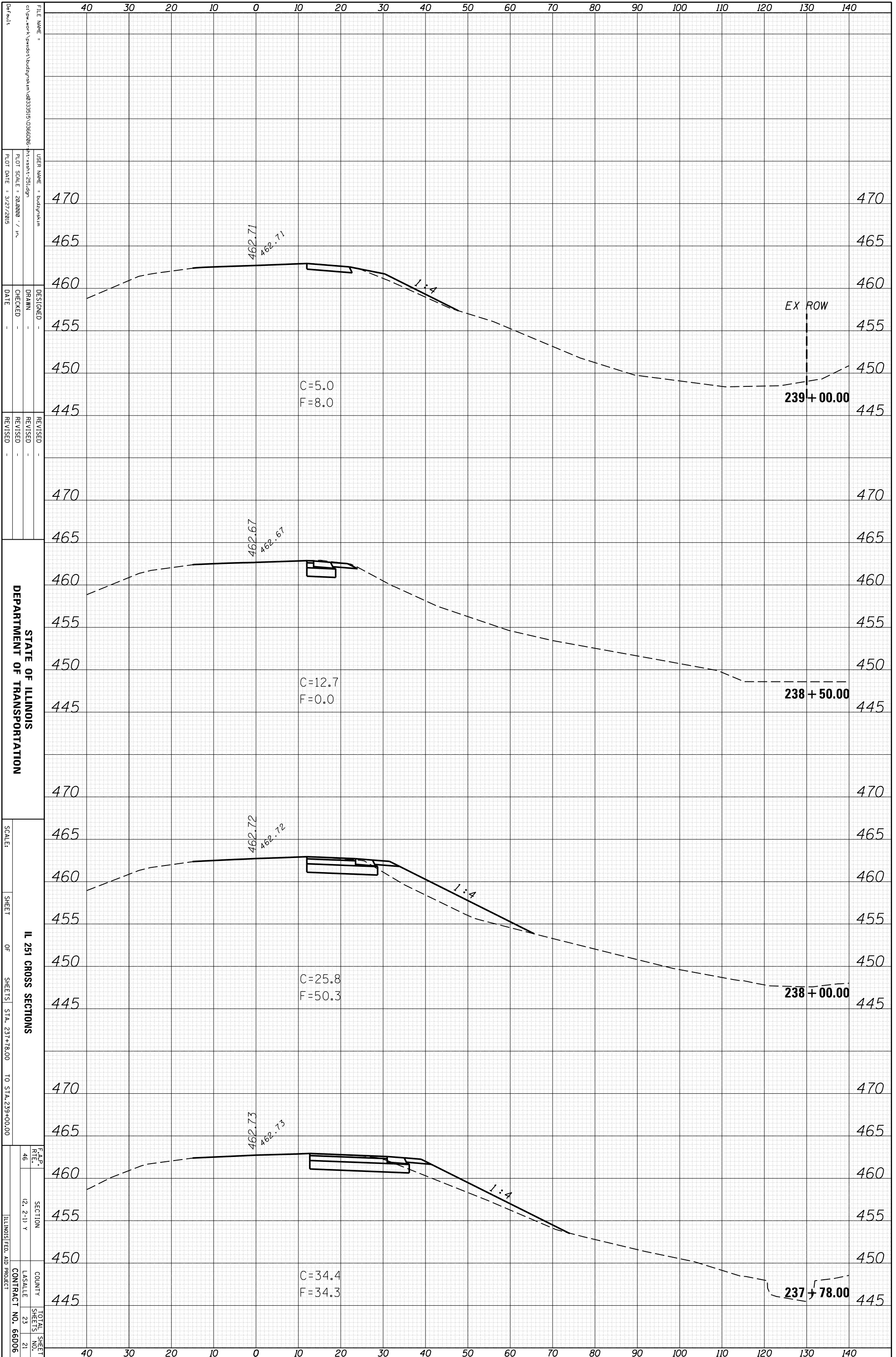

STATE OF ILLINOIS
DEPARTMENT OF TRANSPORTATION

IL 251 CROSS SECTIONS
SHEETS STA. 237+78.00 TO STA. 239+00.00

FILE NAME	USER NAME	DESIGNED	REVISOR
DATE	CHECKED	REVISOR	REVISOR
DATE	REVISOR	REVISOR	REVISOR

CONTRACT NO. 66D06

ORIGINAL SURVEY	SURVEYED	BY	DATE
NOTE BOOK	PLOTTED		
	TEMPLATE		
	AREAS		
	AREAS CHECKED		

FINAL SURVEY	SURVEYED	BY	DATE
NOTE BOOK	PLOTTED		
	TEMPLATE		
	AREAS		
	AREAS CHECKED		

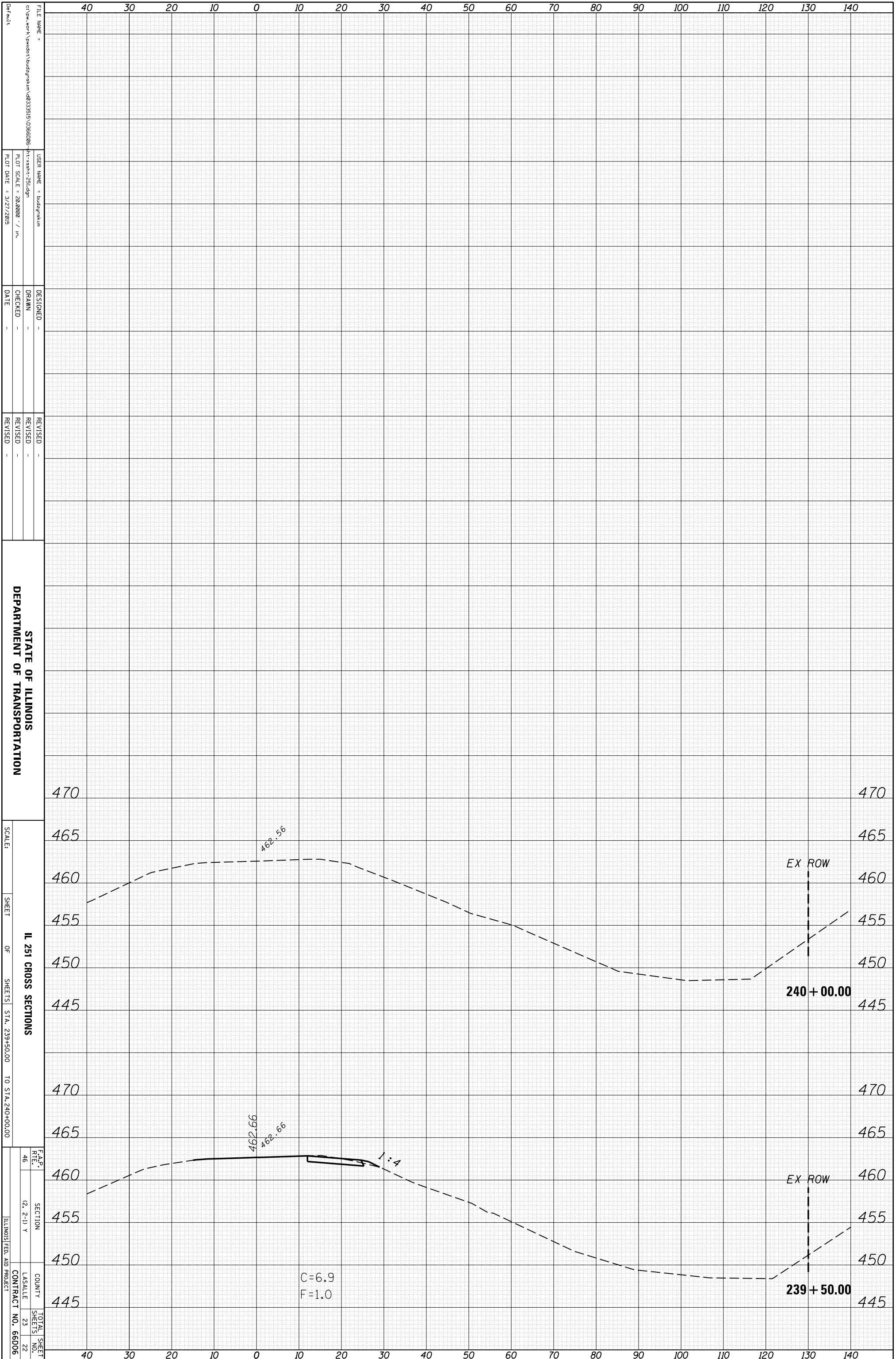

ORIGINAL SURVEY	SURVEYED	BY	DATE
NOTE BOOK	PLOTTED		
	TEMPLATE		
	AREAS		
	AREAS CHECKED		

FINAL SURVEY	SURVEYED	BY	DATE
NOTE BOOK	PLOTTED		
	TEMPLATE		
	AREAS		
	AREAS CHECKED		

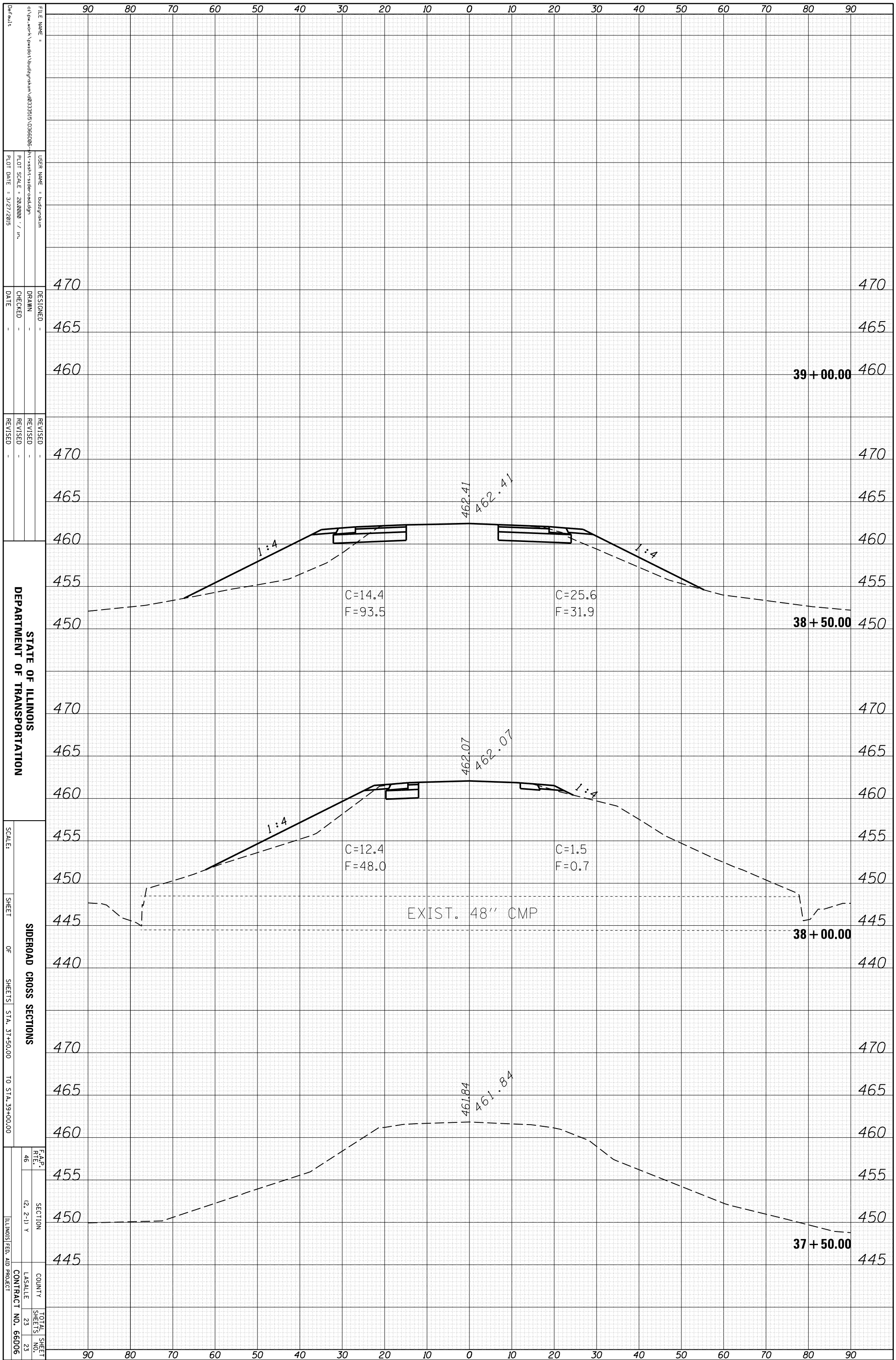

FILE NAME:
 USER NAME:
 DESIGNER:
 DRAWN:
 CHECKED:
 DATE:
 REVISIONS:
 REVISION:
 REVISION:
 REVISION:
 REVISION:
 SCALE:
 SHEET OF SHEETS:
 STA. 37+50.00 TO STA. 39+00.00
 STATE OF ILLINOIS DEPARTMENT OF TRANSPORTATION
 SIDEROAD CROSS SECTIONS
 F.A.P. R.F.E. SECTION COUNTY TOTAL SHEET NO.
 46 (2, 2-1) Y L.S.A.L.L.E. SHEETS 23 23
 ILLINOIS FED. AID PROJECT CONTRACT NO. 66D06