

PROPOSED HIGHWAY PLANS

FAP ROUTE 310 (US 67)
SECTION 39-1,RS-8;40-1,RS-6;41-1,RS-5
MISC. ROADWAY
MCDONOUGH COUNTY

C-94-098-14

F.A.P. RTE.	SECTION	COUNTY	TOTAL SHEETS	SHEET NO.
310	*	MCDONOUGH	24	1
ILLINOIS			CONTRACT NO. 68B99	

* 39-1,RS-8;40-1,RS-6;41-1,RS-5

D-94-041-14

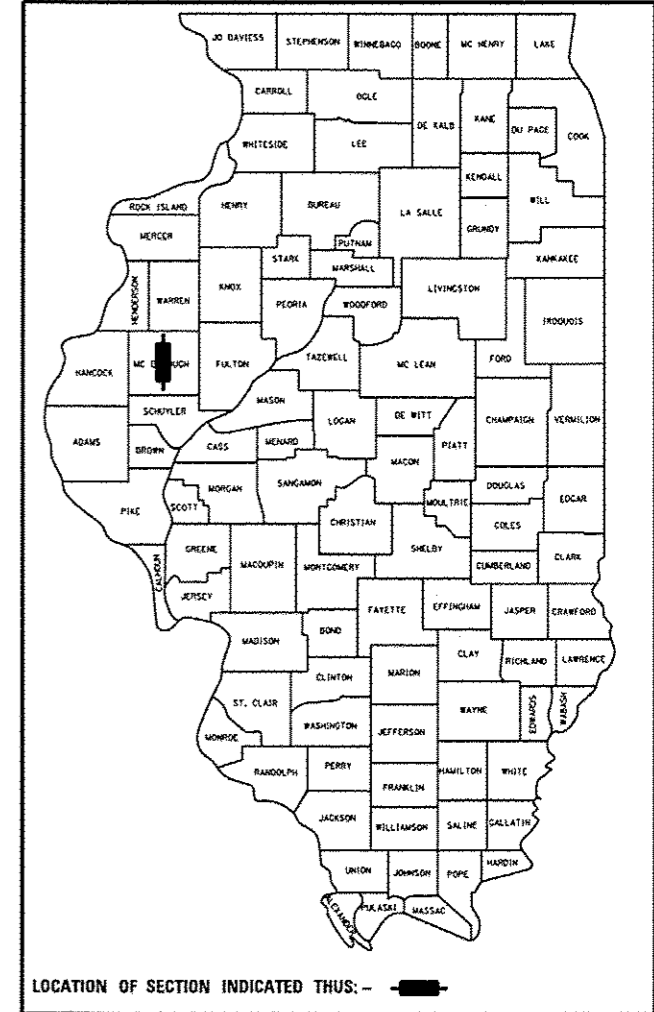

DESCRIPTION
PARTIAL DEPTH HMA PATCHING AND INTERMITTENT HMA OVERLAY FROM 2.6 MILES SOUTH OF US 136 TO 0.25 MILE NORTH OF TR 350, JUST NORTH OF INDUSTRY

STATE OF ILLINOIS
DEPARTMENT OF TRANSPORTATION
DIVISION OF HIGHWAYS

SUBMITTED April 1 2015
Kenneth A. Burnett
DEPUTY DIRECTOR OF HIGHWAYS, REGION ENGINEER

May 8 2015
John D. Baranzelli, P.E.
ENGINEER OF DESIGN AND ENVIRONMENT

May 8 2015
Orker Osman, P.E.
DIRECTOR OF HIGHWAYS, CHIEF ENGINEER

PRINTED BY THE AUTHORITY
OF THE STATE OF ILLINOIS

1. COVER SHEET
2. GENERAL NOTES / MIX REQUIREMENTS
- 3-4. SUMMARY OF QUANTITIES
5. SCHEDULE OF QUANTITIES
6. TYPICAL SECTIONS
7. LINE DIAGRAM
- 8.-18. PROPOSED PLAN SHEETS
- 19.-21. CADD STANDARD 406101-D4
22. CADD STANDARD 440001-D4
- 23.-24. CADD STANDARD 780001-D4

HIGHWAY STANDARDS

- 701306-03
- 701311-03
- 701336-06
- 701901-04
- 780001-05
- 781001-03

DESIGN DESIGNATION

OTHER PRINCIPAL ARTERIAL
2013 ADT = 2,850
MU = 225
SU = 120

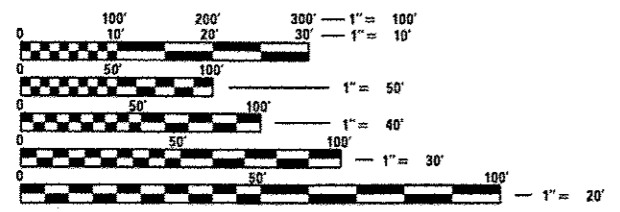

FULL SIZE PLANS HAVE BEEN PREPARED USING STANDARD ENGINEERING SCALES. REDUCED SIZED PLANS WILL NOT CONFORM TO STANDARD SCALES. IN MAKING MEASUREMENTS ON REDUCED PLANS, THE ABOVE SCALES MAY BE USED.

J.U.L.I.E.
JOINT UTILITY LOCATION INFORMATION FOR EXCAVATION
1-800-892-0123
OR 811

PROJECT ENGINEER: RICH DOTSON (309)671-3455
PROJECT MANAGER: RON NOLTE (309)671-3470

CONTRACT NO. 68B99

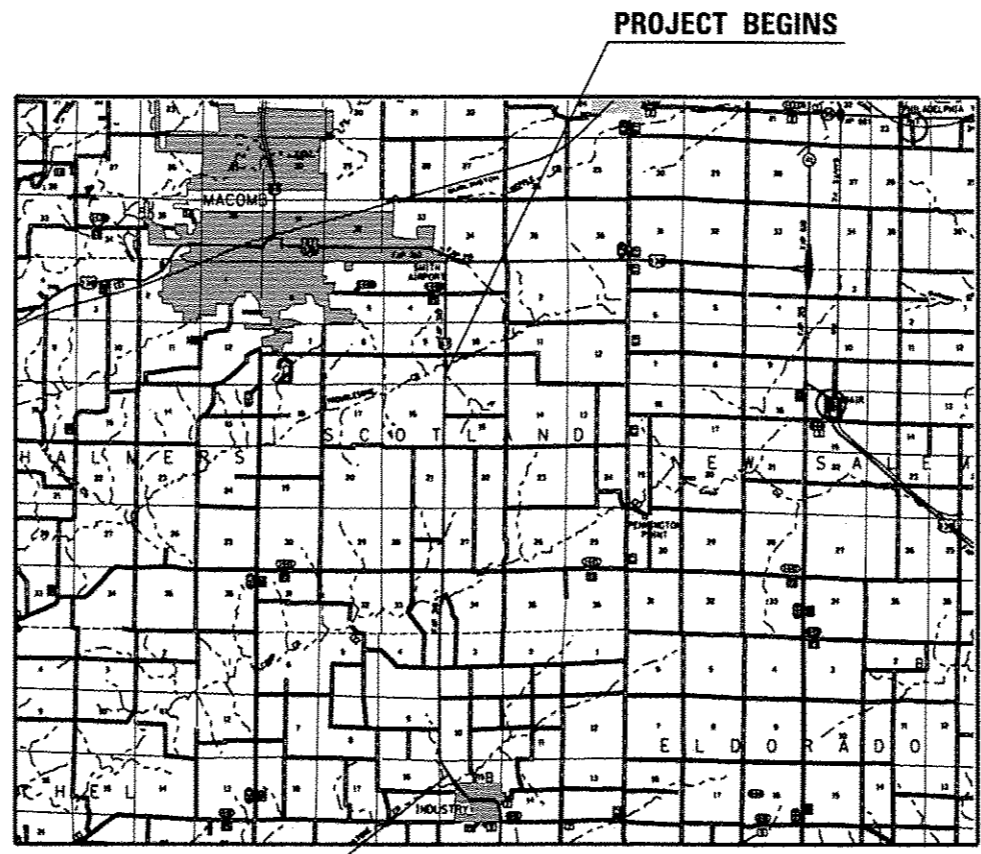

GROSS LENGTH = 33,264 FT. = 6.3 MILE
NET LENGTH = 33,264 FT. = 6.3 MILE

PAVING SURFACE COURSE

Continuous paving operations on the main roadway shall be maintained at all times during the construction of the hot-mix asphalt surface. No interruptions for side roads, entrances, turn lanes, etc. will be allowed.

CROSSING EXISTING STRUCTURES WITH EQUIPMENT

The following structure, SN 055-0006 over Camp Creek, shall be verified by the resident prior to beginning work that it may be crossed with:

Options:

- a. loaded MTD
- b. unloaded MTD
- c. milling machine

PAVEMENT STATION NUMBERS & PLACEMENT

The Contractor shall provide labor and materials required to imprint pavement station numbers in the finished surface of the pavement and/or overlay. The numbers shall be approximately 3/4 inch (20 mm) wide, 5 inches (125 mm) high and 5/8 inch (15 mm) deep.

The pavement station numbers shall be installed as specified herein:

Interval – 200 feet (English stationing) or 100 meters (metric stationing)

Bottom of Numbers – 6 inches (150 mm) from the inside edge of the pavement marking

Location:

- 2, 3, & 5 Lane Pavements – right edge of pavement in direction of increasing stations
- Multi-Lane Divided Roadways – outside edge of pavement in both directions
- Ramps – along baseline edge of pavement

Position – stations shall be placed so they can be read from the adjacent shoulder

Format – English (Metric) pavement stations shall use this format *XXX (XX + X00)*,

where X represents the pavement station

This work will not be paid for separately, but will be included in the cost of the associated pavement and/or overlay pay items.

MIX DESIGN REQUIREMENTS

The following mixture requirements are applicable for this project:

Mixture Use(s):	Surface Course (2")	Partial Depth Patch (2")	Incidental Surface				
AC/PG:	PG 64-22	PG 64-22	PG 64-22				
Design Air Voids:	4.0% @ N=50	4.0% @ N=50	4.0% @ N=50				
Mixture Composition: (Mixture Gradation)	IL 9.5	IL 9.5	IL 9.5				
Friction Aggregate:	Mix D (Dolomite Only)	Mix D (Dolomite Only)	Mix D (Dolomite Only)				
Quality Management Program:	OCCA	OCCA	OCCA				

- Note: 1) Individual lift thickness of each mix type will be no less than 3 times nominal maximum aggregate size and no more than 6 times nominal maximum aggregate size, unless otherwise approved by the Engineer.
- 2) For design purposes, mixture weight for all mixes is determined to be 112.0 lb/s.y./in., unless otherwise noted.
- 3) Sublot sizes for PFP and OCP mixes will be 1000 tons, unless otherwise agreed to by the Engineer and the paving contractor.

ENVIRONMENTAL REVIEWS

Prior to the use of any proposed borrow areas, use areas (temporary access roads, detours, run-arounds, etc.) and/or waste areas, the Contractor shall file the required environmental resource request surveys according to Section 107.22 of the Standard Specifications. These surveys are required in order for the Department to conduct cultural and biological resource surveys for the proposed site.

Prior to any waste materials being removed from the construction site the required environmental resource surveys will need to be obtained and filed by the Contractor. Excess waste products removed from the construction site shall be disposed of as required in Section 202.03 of the Standard Specifications.

Any protruding metal bars shall be removed prior to the disposal of broken concrete at approved disposal sites.

The required environmental resource documentation shall include the following:

- * BDE Form 2289 (Environmental Survey Request)
- * BDE Form 2290 (Waste/Use Area Review)
- * A location map showing the size limits and location of the use area
- * Color photographs depicting the use area
- * Borrow Area Entry Agreement form-D4 PI0101

Please note that a minimum of four weeks shall be allowed for the District to obtain the required environmental clearances and six weeks for the required borrow site environmental clearances.

NO PASSING ZONE VERIFICATION

The resident shall contact Operations to verify the location of no passing zones prior to placement of centerline striping.

COMMITMENTS

There are no Commitments

FILE NAME : 0468899-shs-typical.dgn	USER NAME : subreggs	DESIGNED : -	REVISED : -	STATE OF ILLINOIS DEPARTMENT OF TRANSPORTATION	GENERAL NOTES & MIX REQUIREMENTS	F.A.P. RTE. 310	SECTION .	COUNTY MCDONOUGH	TOTAL SHEETS 24	SHEET NO. 2		
Default	PLOT SCALE : 100.0000' / 1" =	DRAWN : -	REVISED : -			SCALE:	SHEET OF SHEETS	STA. TO STA.	CONTRACT NO. 68899			
	PLOT DATE : 4/1/2015	CHECKED : -	REVISED : -							ILLINOIS FED. AID PROJECT		

* 39-1,RS-8;40-1,RS-6;41-1,RS-5

CODE NO.	ITEM	UNIT	TOTAL QUANTITY	CONST. CODE
				100% STATE FAP 310 McDonough Rural 0005
40600285	POLYMERIZED BITUMINOUS MATERIALS (PRIME COAT)	POUND	4053	4053
40600982	HOT - MIX ASPHALT SURFACE REMOVAL - BUTT JOINT	SQ YD	297	297
40603335	HOT - MIX ASPHALT SURFACE COURSE, MIX "D", N50	TON	997	997
40800050	INCIDENTAL HOT - MIX ASPHALT SURFACING	TON	12	12
44000157	HOT - MIX ASPHALT SURFACE REMOVAL, 2 "	SQ YD	8709	8709
48101200	AGGREGATE SHOULDERS, TYPE B	TON	56	56
67100100	MOBILIZATION	L SUM	1	1
70100460	TRAFFIC CONTROL AND PROTECTION, STANDARD 701306	L SUM	1	1
70100600	TRAFFIC CONTROL AND PROTECTION, STANDARD 701336	L SUM	1	1
70300100	SHORT-TERM PAVEMENT MARKING	FOOT	485	485
70301000	WORK ZONE PAVEMENT MARKING REMOVAL	SQ FT	160	160
* 78001110	PAINT PAVEMENT MARKING - LINE 4"	FOOT	11219	11219
* 78100100	RAISED REFLECTIVE PAVEMENT MARKER	EACH	56	56
78300200	RAISED REFLECTIVE PAVEMENT MARKER REMOVAL	EACH	56	56

* SPECIALTY ITEM

FILE NAME : D458899-sh1-typical.dgn	USER NAME : soubraige	DESIGNED -	REVISED -
		DRAWN -	REVISED -
		CHECKED -	REVISED -
		DATE -	REVISED -

**STATE OF ILLINOIS
DEPARTMENT OF TRANSPORTATION**

SUMMARY OF QUANTITIES

F.A.P. RTE. 310	SECTION *	COUNTY MCDONOUGH	TOTAL SHEETS 24	SHEET NO. 3
CONTRACT NO. 68899			ILLINOIS FED. AID PROJECT	

* 39-1,RS-8;40-1,RS-6;41-1,RS-5

LOCATION	DESCRIPTION	LENGTH	**WIDTH	AREA	HMA SURFACE REMOVAL - BUTT JOINT (10' - EACH LANE/EACH END)	HMA SURFACE REMOVAL, 2"	POLY. BITUMINOUS MATERIALS (PRIME COAT)	HMA SURFACE COURSE, MIX "D", N50 - 2"	MATERIAL TRANSFER DEVICE	INCIDENTAL HMA SURFACING	*AGG. SHLDS., TY B Lx(W)2'x(D)1"
		FOOT	FOOT	SQ. YD.	SQ. YD.	SQ. YD.	POUND	TON	TON	TON	TON
	STATIONS ARE APPROXIMATE										
1	STA. 268+50 TO 284+00 - NB LANE ONLY	1550	13	2239	28.9	2210.0	1007.5	250.8	250.755556		19.5
2	STA. 289+50 TO 294+75 - NB & SB LANES	525	24	1400	53.3	1346.7	630	156.8	156.8		6.6
3	STA. 349+50 TO 355+50 - SB LANE ONLY	600	13	866.7	28.9	838	390	97.1	97.1		7.6
4	STA. 378+00 TO 393+00 - NB & SB LANES	1500	24	4000	53.3	3946.7	1800	448	448		18.9
5	STA. 402+25 TO 405+00 - SB LANE ONLY	275	13	397.2	28.9	368.3	178.75	44.5	44.5		3.5
5	SIDEROAD - TR 450N (RADIUS)		25	104	104		47			11.6	
PROJECT TOTAL					297	8709	4053	997	997	12	56

- QUANTITY ADDED FOR CORRECTION OF LOW SHOULDERS, IF NEEDED, AFTER COMPLETION OF OVERLAY.
- DUE TO POOR CONDITION OF THE CENTERLINE JOINT, 13' LANE WIDTH WAS ASSUMED TO ALLOW QUANTITY FOR REPAIRS TO IT.

LOCATION	DESCRIPTION	LENGTH	SHORT TERM PAVEMENT MARKING	WORK ZONE PAVEMENT MARKING REMOVAL	PAINT PAVEMENT MARKING- LINE 4"			RAISED REFLECTIVE PAVEMENT MARKER REMOVAL	RAISED REFLECTIVE PAVEMENT MARKER
			YELLOW SKIP-DASH		CENTERLINE		E.O.P.		
					FOOT	FOOT	FOOT		
	STATIONS ARE APPROXIMATE	FOOT	FOOT	SQ. FT.	FOOT	FOOT	FOOT	EACH	EACH
1	STA. 268+50 TO 284+00 - NB LANE ONLY	1550	163	53.8		1550	1550	19	19
2	STA. 289+50 TO 294+75 - NB & SB LANES	525	60.5	20		1050	1050	7	7
3	STA. 349+50 TO 355+50 - SB LANE ONLY	600	68	22.4	150		600	8	8
4	STA. 378+00 TO 393+00 - NB & SB LANES	1500	158	52.1	375		3000	19	19
5	STA. 402+25 TO 405+00 - SB LANE ONLY	275	35.5	11.7	68.75		275	3	3
SUB-TOTAL					594	4150	6475		
PROJECT TOTAL			485	160		11219		56	56

TRAFFIC CONTROL AND PROTECTION		
LOCATION	STANDARD 701306	STANDARD 701336
	L. SUM	L. SUM
JOBSITE	1	1
TOTAL	1	1

**PARTIAL DEPTH PATCHING		
LOCATION	HMA REMOVAL PAID AS:	HMA PLACEMENT PAID AS:
	PARTIAL DEPTH PATCHING (SPECIAL)	PARTIAL DEPTH PATCHING•
	SQ. YD.	TON
JOBSITE	*VAR. WIDTHS & LENGTHS	(800 x 2" x 112)/ 2000
TOTAL	800	90

- WIDTHS RANGE 4' TO 13'
- FOR USE OUTSIDE LOCATIONS OF INTERMITTENT OVERLAYS

MOBILIZATION	
LOCATION	L. SUM
JOBSITE	1

* 39-1,RS-8;40-1,RS-6;41-1,RS-5

FILE NAME = D468B99-sht-typical.dgn	USER NAME = aubreys	DESIGNED -	REVISED -	STATE OF ILLINOIS DEPARTMENT OF TRANSPORTATION	SCHEDULE OF QUANTITIES				F.A.P. RTE.	SECTION	COUNTY	TOTAL SHEETS	SHEET NO.
Default	PLOT DATE = 4/1/2015	DRAWN -	REVISED -						310	*	MCDONOUGH	24	5
		CHECKED -	REVISED -						CONTRACT NO. 68B99				
		DATE -	REVISED -		SCALE: SHEET OF SHEETS STA. TO STA.				ILLINOIS FED. AID PROJECT				

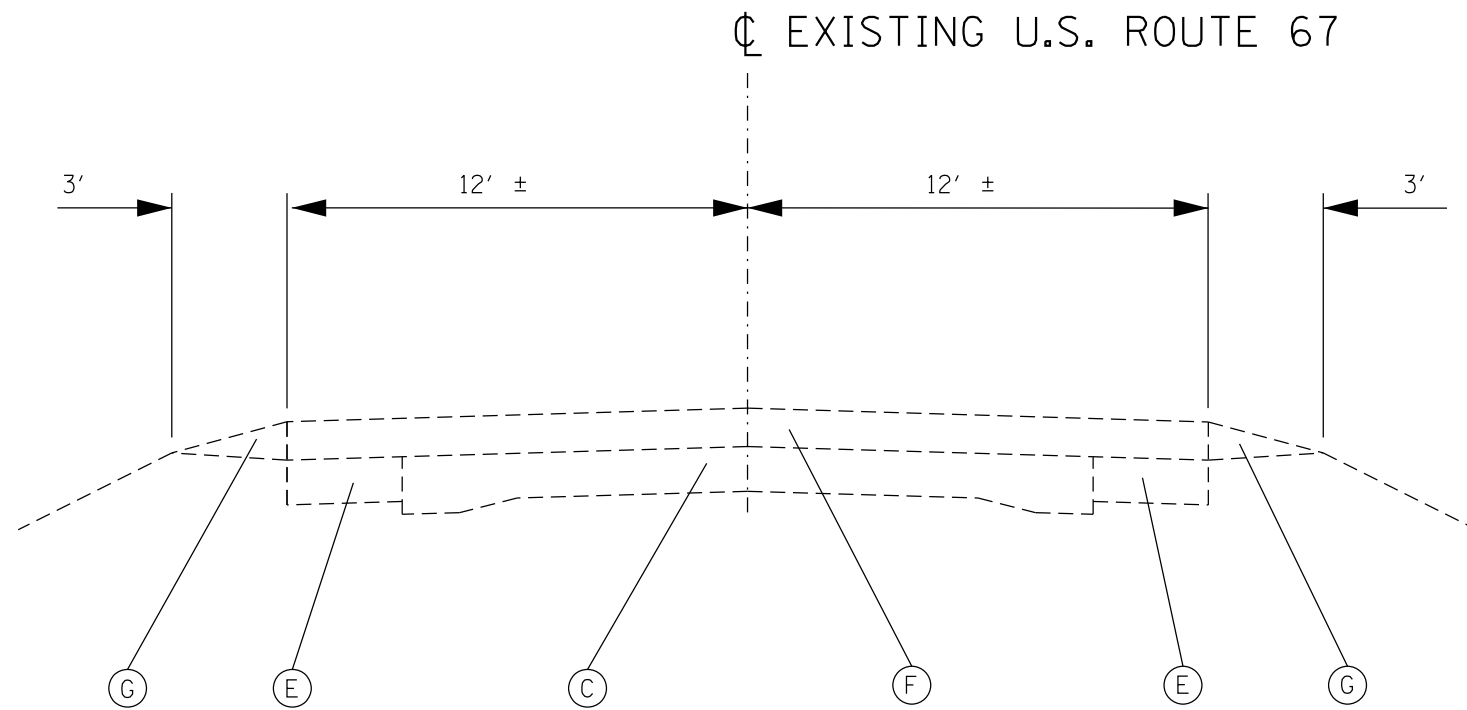

LEGEND

- ⓐ EXISTING TYPE B-6.24 CURB & GUTTER
- ⓑ EXISTING STABILIZED SHOULDER
- ⓒ EXISTING P.C.C. PAVEMENT
- ⓓ EXISTING EARTH SHOULDER
- ⓔ EXISTING P.C.C. BASE COURSE WIDENING
- ⓕ EXISTING BITUMINOUS OVERLAY
- ⓖ EXISTING AGGREGATE SHOULDER
- ⓓ EXISTING BITUMINOUS BASE COURSE

EXISTING TYPICAL SECTION U.S. ROUTE 67

FILE NAME = D468B99-sh-typical.dgn	USER NAME = aubreygs	DESIGNED -	REVISED -
Default	PLOT SCALE = 100.0000' / in.	DRAWN -	REVISED -
	PLOT DATE = 4/1/2015	CHECKED -	REVISED -
		DATE -	REVISED -

**STATE OF ILLINOIS
DEPARTMENT OF TRANSPORTATION**

EXISTING TYPICAL SECTION

SCALE: SHEET OF SHEETS STA. TO STA.

* 39-1,RS-8;40-1,RS-6;41-1,RS-5

F.A.P. RTE.	SECTION	COUNTY	TOTAL SHEETS	SHEET NO.
310	*	MCDONOUGH	24	6
CONTRACT NO. 68B99				
ILLINOIS FED. AID PROJECT				

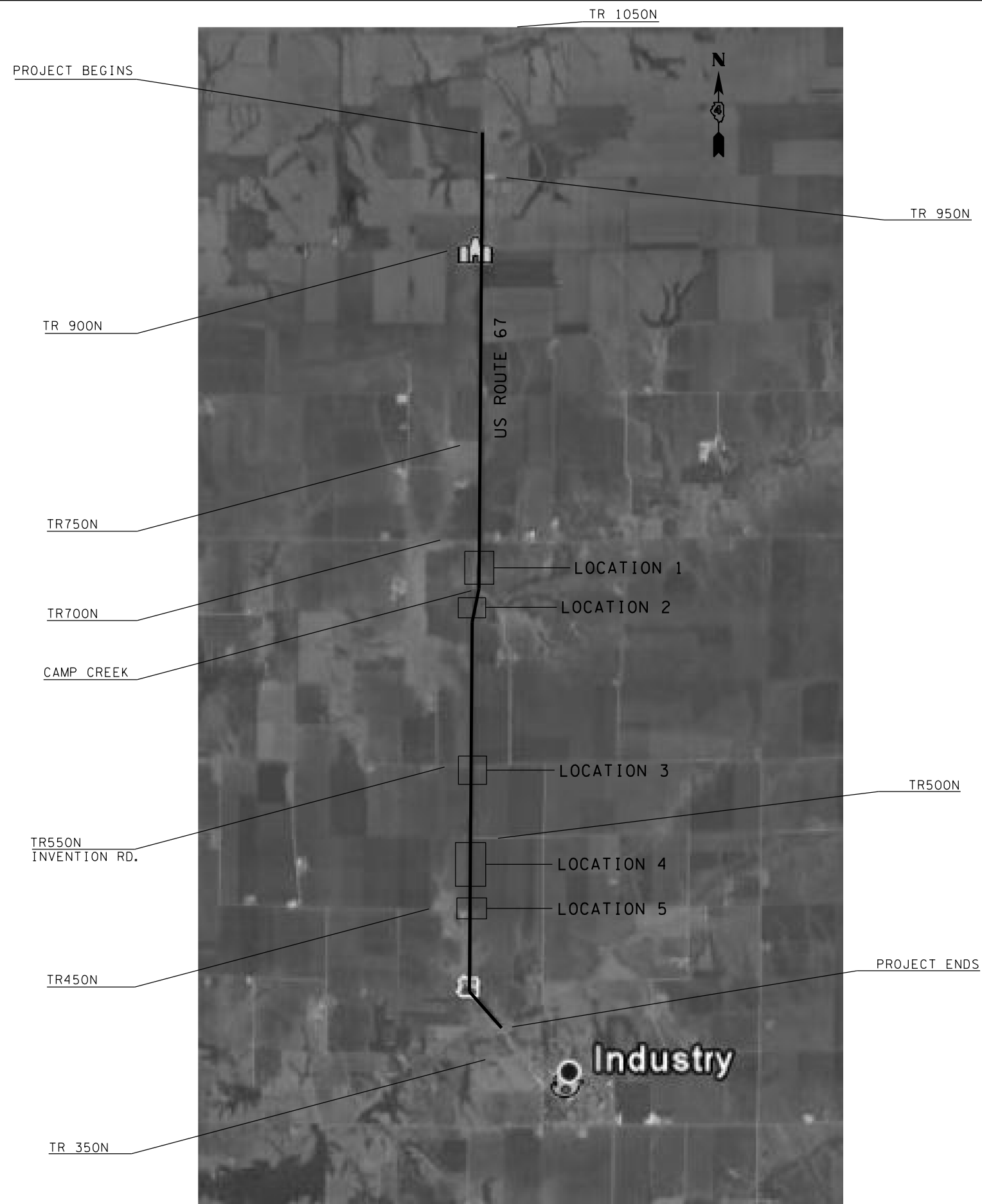

* 39-1,RS-8;40-1,RS-6;41-1,RS-5

FILE NAME = D468B99-sht-typical.dgn	USER NAME = aubreygs	DESIGNED -	REVISED -
Default	PLOT SCALE = 100.0000' / in.	DRAWN -	REVISED -
	PLOT DATE = 4/1/2015	CHECKED -	REVISED -
		DATE -	REVISED -

**STATE OF ILLINOIS
DEPARTMENT OF TRANSPORTATION**

LINE DIAGRAM

SCALE: SHEET OF SHEETS STA. TO STA.

F.A.P. RTE.	SECTION	COUNTY	TOTAL SHEETS	SHEET NO.
310	*	MCDONOUGH	24	7
				CONTRACT NO. 68B99
ILLINOIS FED. AID PROJECT				

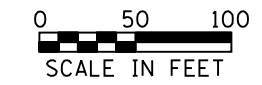
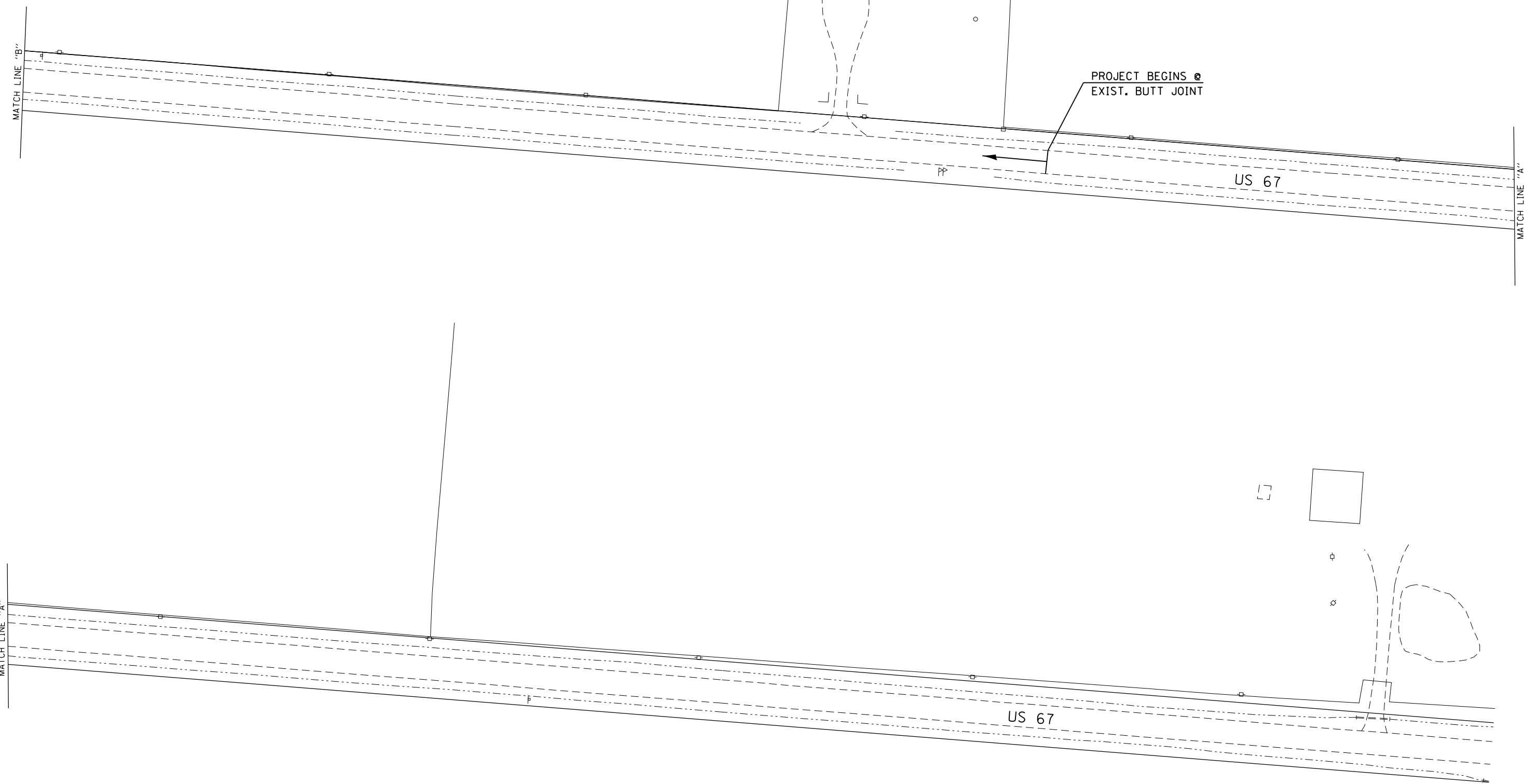
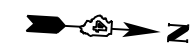

* 39-1,RS-8;40-1,RS-6;41-1,RS-5

FILE NAME = D468B99-sht-removal.dgn	USER NAME = aubreygs	DESIGNED -	REVISED -
Default		DRAWN -	REVISED -
	PLOT SCALE = 100.0000' / in.	CHECKED -	REVISED -
	PLOT DATE = 4/1/2015	DATE -	REVISED -

**STATE OF ILLINOIS
DEPARTMENT OF TRANSPORTATION**

PROPOSED PLAN

SCALE:	SHEET	OF	SHEETS	STA.	TO	STA.
--------	-------	----	--------	------	----	------

F.A.P. RTE.	SECTION	COUNTY	TOTAL SHEETS	SHEET NO.
310	*	MCDONOUGH	24	8
CONTRACT NO. 68B99				
ILLINOIS FED. AID PROJECT				

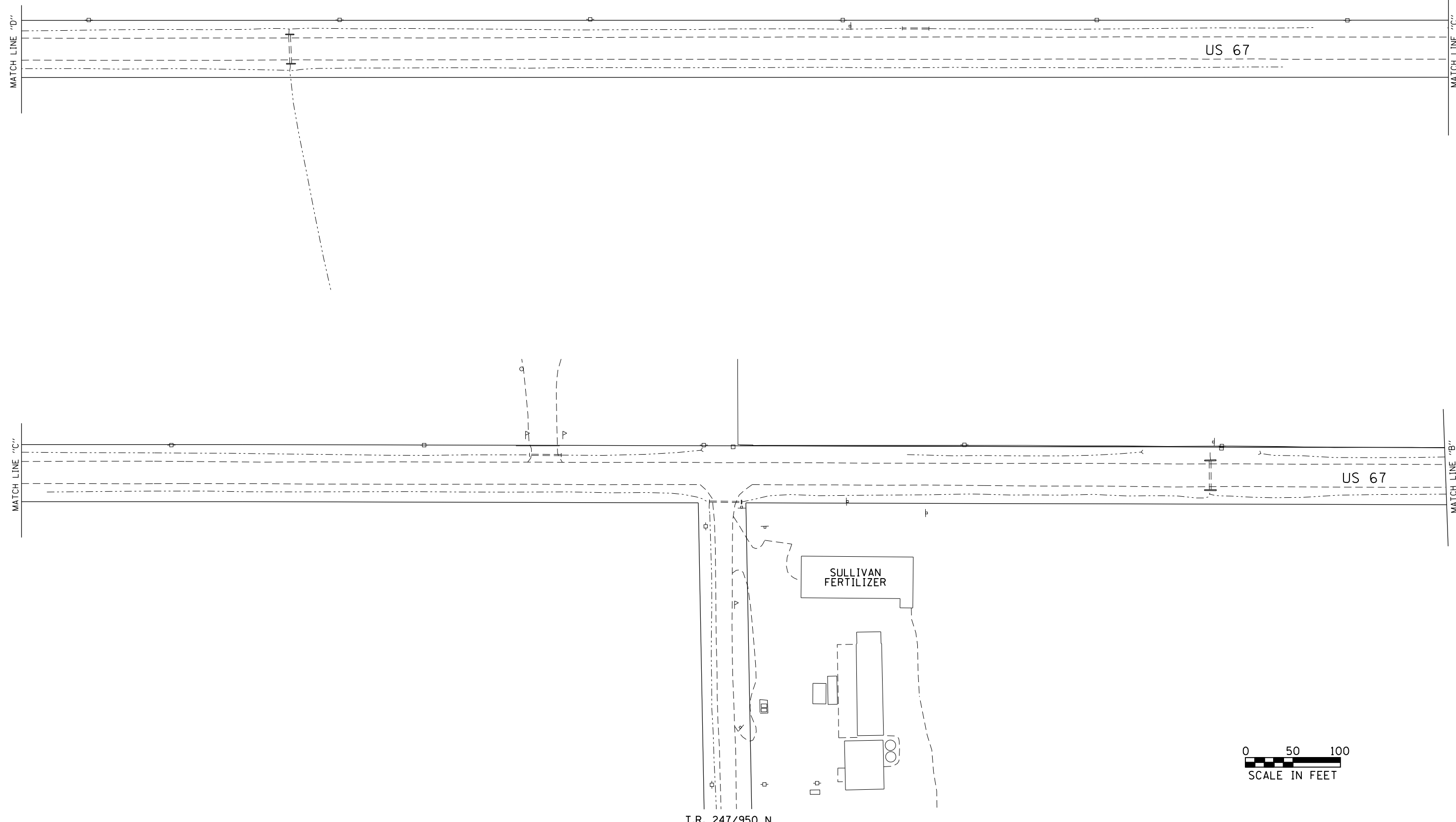

FILE NAME = D468B99-shr-removal.dgn	USER NAME = aubreygs	DESIGNED -	REVISED -
Default	PLOT SCALE = 100.0000' / in.	DRAWN -	REVISED -
	PLOT DATE = 4/1/2015	CHECKED -	REVISED -
		DATE -	REVISED -

**STATE OF ILLINOIS
DEPARTMENT OF TRANSPORTATION**

PROPOSED PLAN

SCALE: SHEET OF SHEETS STA. TO STA.

F.A.P. RTE.	SECTION	COUNTY	TOTAL SHEETS	SHEET NO.
310	*	MCDONOUGH	24	9
CONTRACT NO. 68B99				
ILLINOIS FED. AID PROJECT				

* 39-1,RS-8;40-1,RS-6;41-1,RS-5

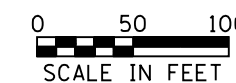
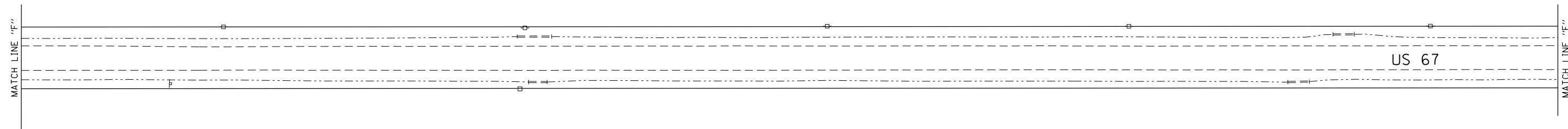

* 39-1,RS-8;40-1,RS-6;41-1,RS-5

FILE NAME = D468B99-sht-removal.dgn	USER NAME = aubreygs	DESIGNED -	REVISED -
Default	PLOT SCALE = 100.0000' / in.	DRAWN -	REVISED -
	PLOT DATE = 4/1/2015	CHECKED -	REVISED -
		DATE -	REVISED -

**STATE OF ILLINOIS
DEPARTMENT OF TRANSPORTATION**

PROPOSED PLAN

SCALE: SHEET OF SHEETS STA. TO STA.

F.A.P. RTE.	SECTION	COUNTY	TOTAL SHEETS	SHEET NO.
310	*	MCDONOUGH	24	10
				CONTRACT NO. 68B99
ILLINOIS FED. AID PROJECT				

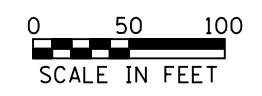
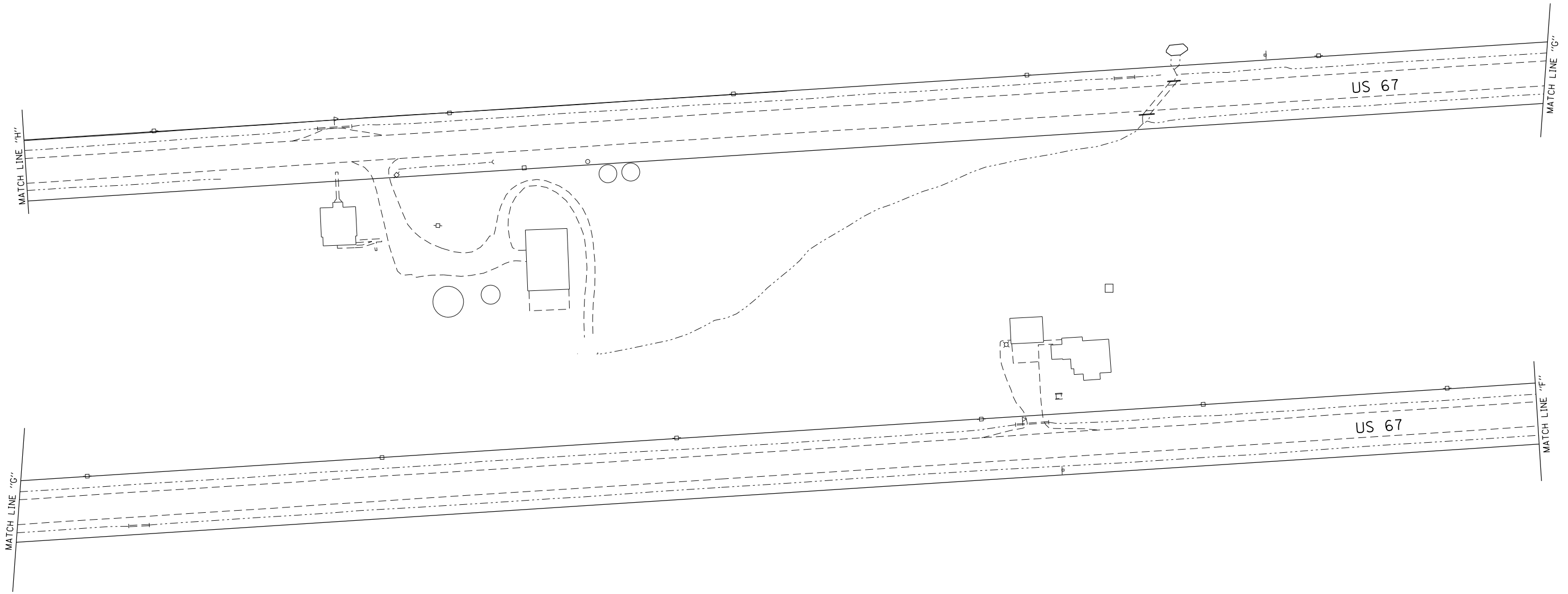

FILE NAME = D468B99-sht-removal.dgn	USER NAME = aubreygs	DESIGNED -	REVISED -
Default	PLOT SCALE = 100.0000' / in.	DRAWN -	REVISED -
	PLOT DATE = 4/1/2015	CHECKED -	REVISED -
		DATE -	REVISED -

**STATE OF ILLINOIS
DEPARTMENT OF TRANSPORTATION**

PROPOSED PLAN			
SCALE:	SHEET	OF	SHEETS
	STA.		TO STA.

F.A.P. RTE.	SECTION	COUNTY	TOTAL SHEETS	SHEET NO.
310	*	MCDONOUGH	24	11
CONTRACT NO. 68B99				
ILLINOIS FED. AID PROJECT				

* 39-1,RS-8;40-1,RS-6;41-1,RS-5

TOWNSHIP ROAD



US 67

US 67

MATCH LINE "J"

MATCH LINE "I"

MATCH LINE "I"

MATCH LINE "H"



* 39-1,RS-8;40-1,RS-6;41-1,RS-5

FILE NAME =
D468B99-sht-removal.dgn
Default

USER NAME = aubreygs
PLOT SCALE = 100.0000' / in.
PLOT DATE = 4/1/2015

DESIGNED -
DRAWN -
CHECKED -
DATE -

REVISED -
REVISED -
REVISED -
REVISED -

**STATE OF ILLINOIS
DEPARTMENT OF TRANSPORTATION**

PROPOSED PLAN

SCALE: SHEET OF SHEETS STA. TO STA.

F.A.P. RTE.	SECTION	COUNTY	TOTAL SHEETS	SHEET NO.
310	*	MCDONOUGH	24	12
CONTRACT NO. 68B99			ILLINOIS FED. AID PROJECT	

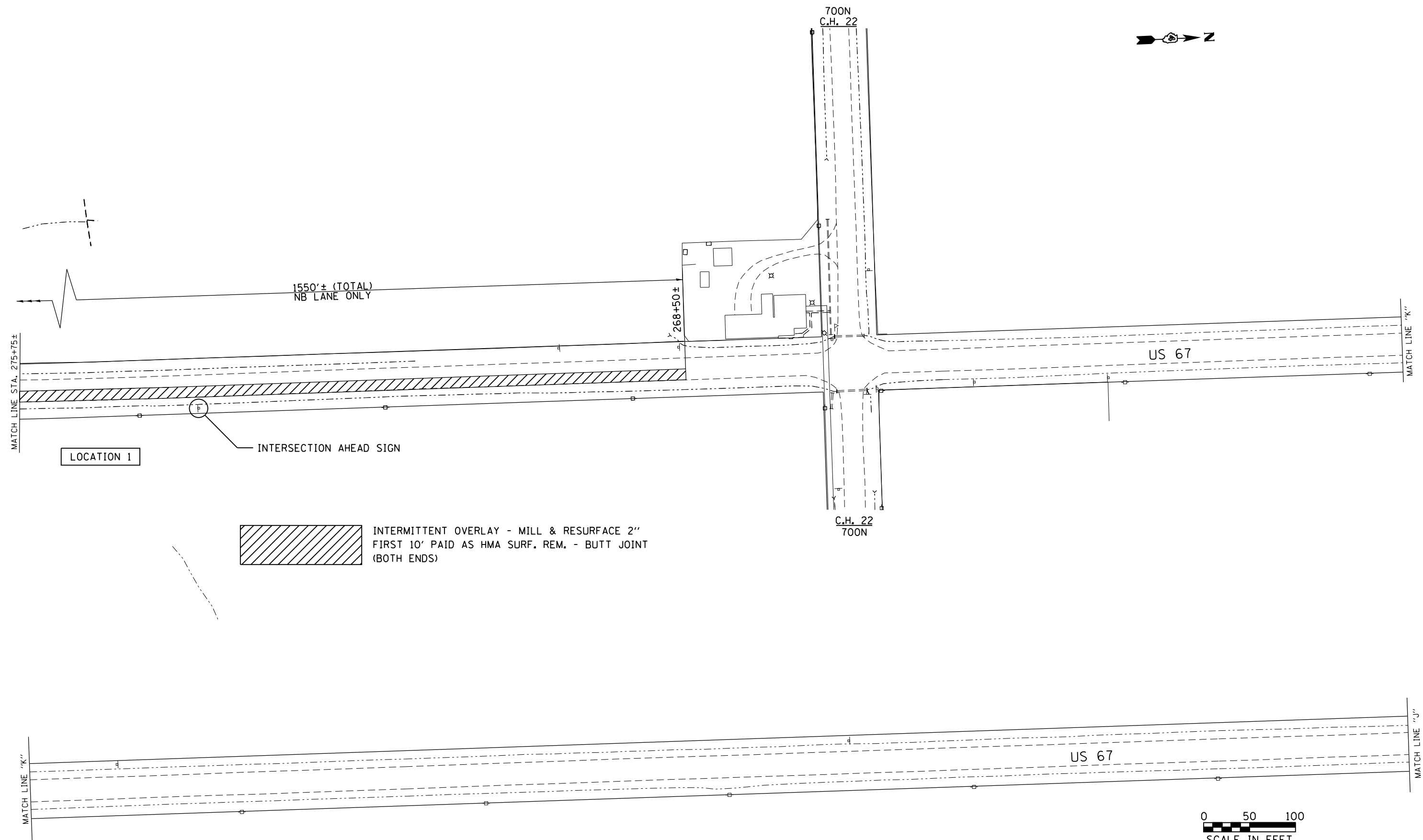

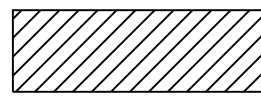
 INTERMITTENT OVERLAY - MILL & RESURFACE 2"
 FIRST 10' PAID AS HMA SURF. REM. - BUTT JOINT
 (BOTH ENDS)

0 50 100
 SCALE IN FEET

FILE NAME = D468B99-sht-removal.dgn	USER NAME = aubreygs	DESIGNED -	REVISED -
Default	PLOT SCALE = 100.0000' / in.	DRAWN -	REVISED -
	PLOT DATE = 4/1/2015	CHECKED -	REVISED -
		DATE -	REVISED -

STATE OF ILLINOIS
DEPARTMENT OF TRANSPORTATION

PROPOSED PLAN			
SCALE:	SHEET	OF SHEETS	STA. TO STA.

* 39-1,RS-8;40-1,RS-6;41-1,RS-5				
F.A.P. RTE.	SECTION	COUNTY	TOTAL SHEETS	SHEET NO.
310	*	MCDONOUGH	24	13
CONTRACT NO. 68B99				
ILLINOIS FED. AID PROJECT				

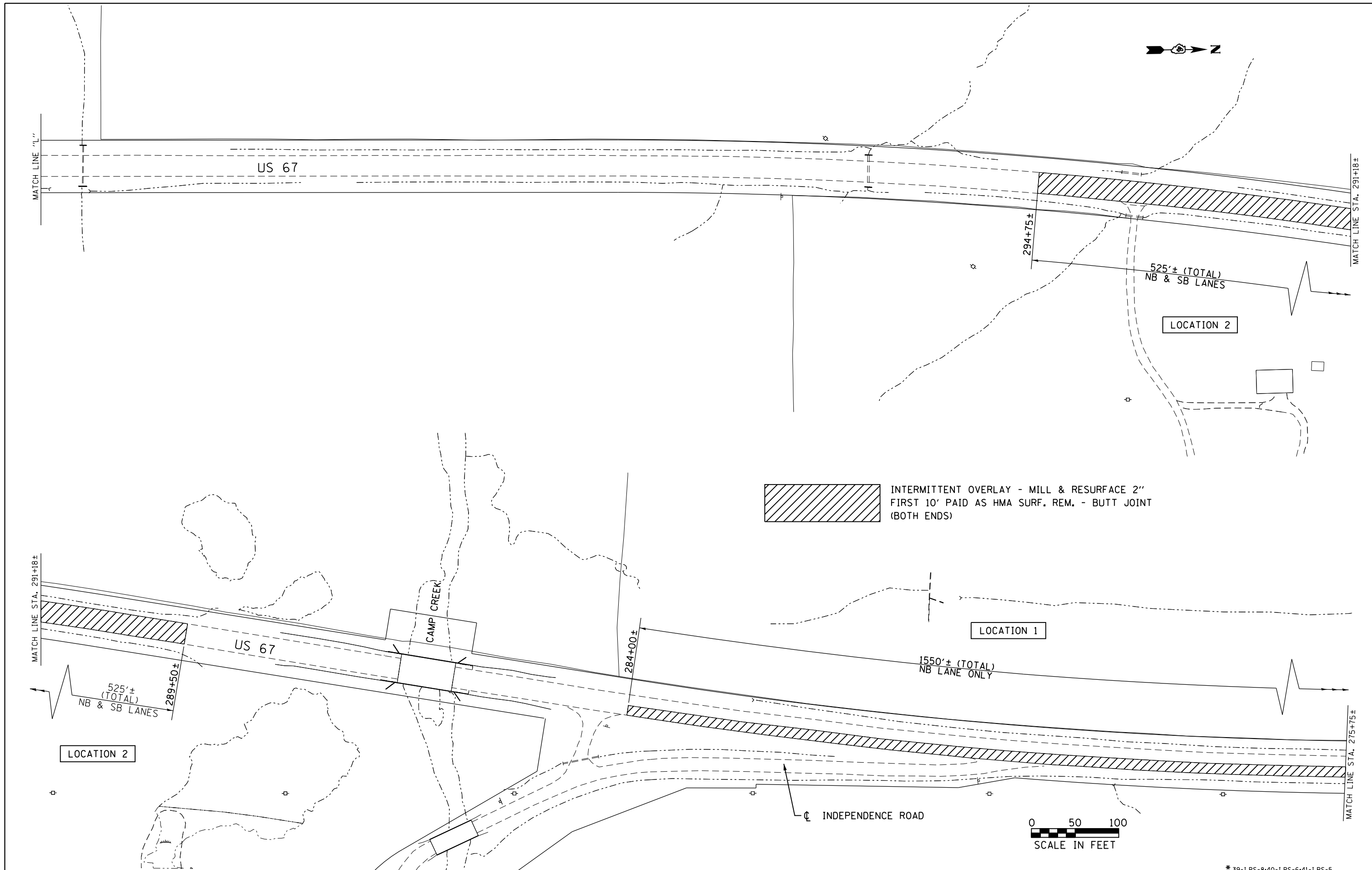

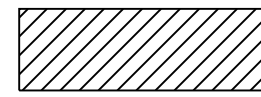
 INTERMITTENT OVERLAY - MILL & RESURFACE 2"
FIRST 10' PAID AS HMA SURF. REM. - BUTT JOINT
(BOTH ENDS)

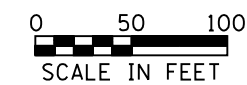

FILE NAME = D468B99-sht-removal.dgn	USER NAME = aubreys	DESIGNED -	REVISED -
Default	PLOT SCALE = 100.0000' / in.	DRAWN -	REVISED -
	PLOT DATE = 4/1/2015	CHECKED -	REVISED -
		DATE -	REVISED -

**STATE OF ILLINOIS
DEPARTMENT OF TRANSPORTATION**

PROPOSED PLAN			
SCALE:	SHEET	OF SHEETS	STA. TO STA.

F.A.P. RTE.	SECTION	COUNTY	TOTAL SHEETS	SHEET NO.
310	*	MCDONOUGH	24	14
CONTRACT NO. 68B99				
ILLINOIS FED. AID PROJECT				

* 39-1,RS-8;40-1,RS-6;41-1,RS-5

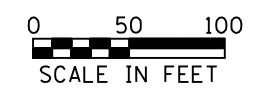
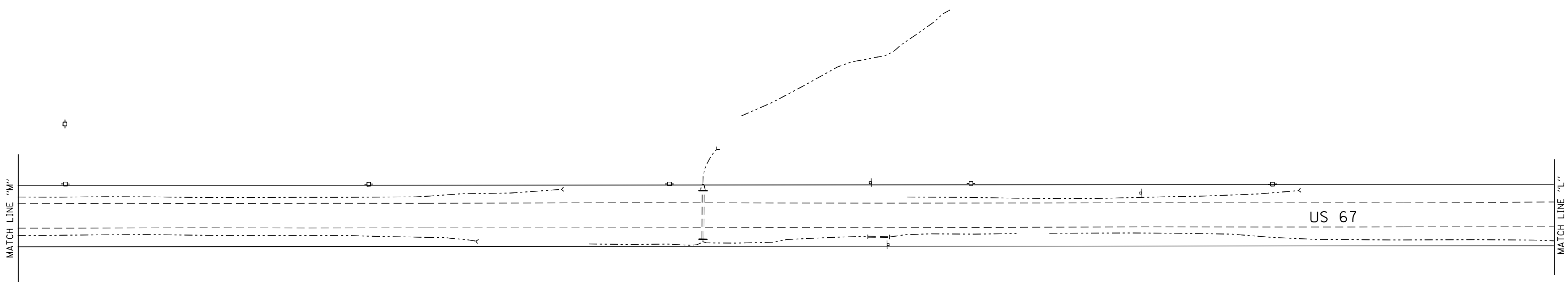
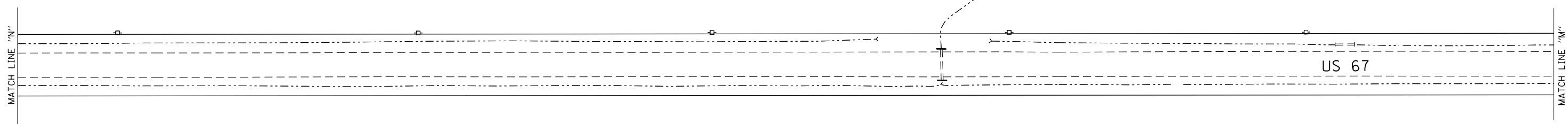

* 39-1,RS-8;40-1,RS-6;41-1,RS-5

FILE NAME = D468B99-shr-removal.dgn	USER NAME = aubreygs	DESIGNED -	REVISED -	STATE OF ILLINOIS DEPARTMENT OF TRANSPORTATION	PROPOSED PLAN			F.A.P. RTE.	SECTION	COUNTY	TOTAL SHEETS	SHEET NO.
	PLOT SCALE = 100.0000' / in.	CHECKED -	REVISED -					310	*	MCDONOUGH	24	15
Default	PLOT DATE = 4/1/2015	DATE -	REVISED -		SCALE:	SHEET	OF	SHEETS	STA.	TO STA.	ILLINOIS FED. AID PROJECT CONTRACT NO. 68B99	

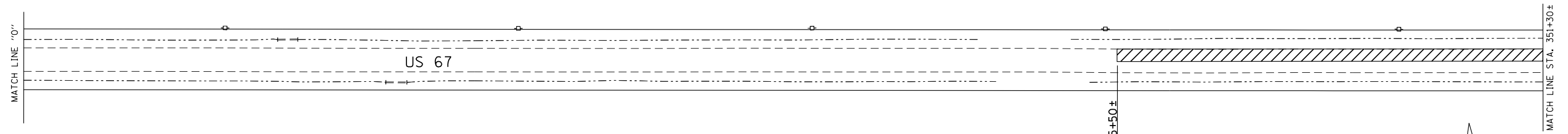

LOCATION 3

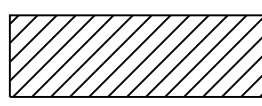

INTERMITTENT OVERLAY - MILL & RESURFACE 2"
 FIRST 10' PAID AS HMA SURF. REM. - BUTT JOINT
 (BOTH ENDS)

INVENTION ROAD

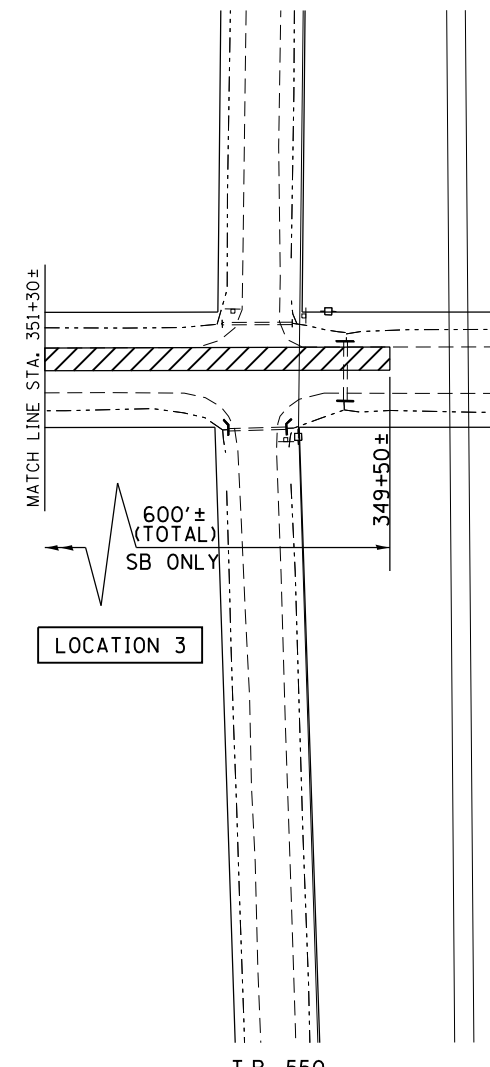

LOCATION 3

T.R. 550

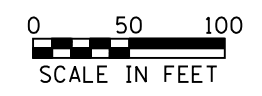

FILE NAME = D468B99-sht-removal.dgn	USER NAME = aubreys	DESIGNED -	REVISED -
Default	PLOT SCALE = 100.0000' / in.	DRAWN -	REVISED -
	PLOT DATE = 4/1/2015	CHECKED -	REVISED -
		DATE -	REVISED -

STATE OF ILLINOIS
 DEPARTMENT OF TRANSPORTATION

SCALE:		SHEET	OF	SHEETS	STA.	TO STA.

PROPOSED PLAN

F.A.P. RTE.	SECTION	COUNTY	TOTAL SHEETS	SHEET NO.
310	*	MCDONOUGH	24	16
CONTRACT NO. 68B99				
ILLINOIS FED. AID PROJECT				

* 39-1,RS-8;40-1,RS-6;41-1,RS-5

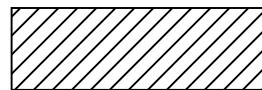
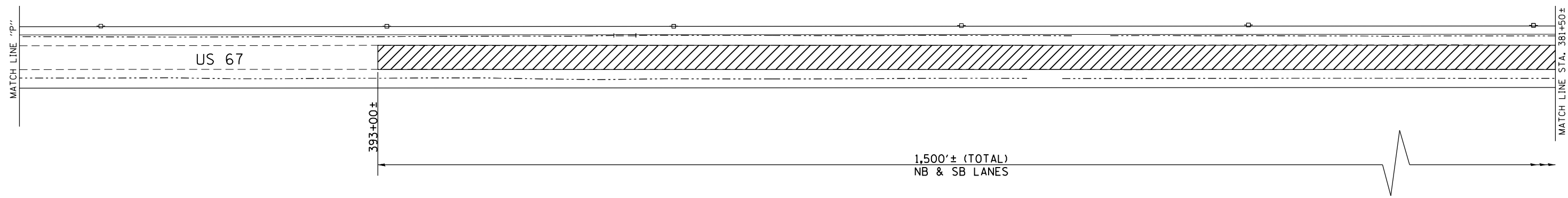

INTERMITTENT OVERLAY - MILL & RESURFACE 2"
FIRST 10' PAID AS HMA SURF. REM. - BUTT JOINT
(BOTH ENDS)

LOCATION 4

1,500'± (TOTAL)
NB & SB LANES

393+00±

MATCH LINE STA. 381+50±

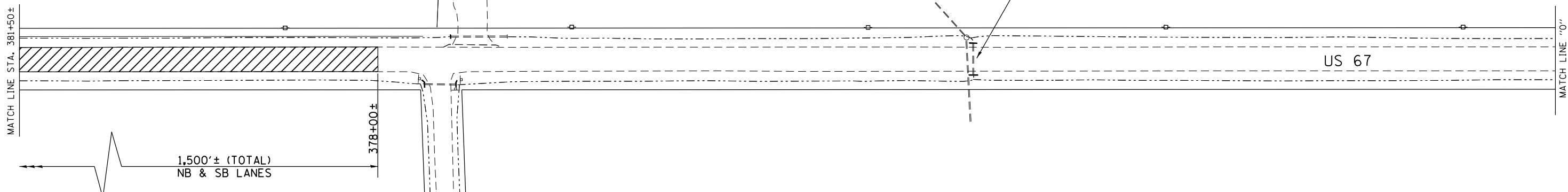

THIS LOCATION SHOULD BE CONSIDERED
FOR A PARTIAL DEPTH PATCH.
TO BE DETERMINED BY THE ENGINEER.

LOCATION 4

1,500'± (TOTAL)
NB & SB LANES

378+00±

MATCH LINE "0"

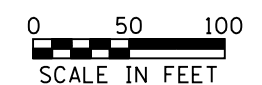

T.R. 500

FILE NAME = D468B99-sht-removal.dgn	USER NAME = aubreys	DESIGNED -	REVISED -
Default	PLOT SCALE = 100.0000' / in.	DRAWN -	REVISED -
	PLOT DATE = 4/1/2015	CHECKED -	REVISED -
		DATE -	REVISED -

STATE OF ILLINOIS
DEPARTMENT OF TRANSPORTATION

PROPOSED PLAN			
SCALE:	SHEET	OF	SHEETS
	STA.		TO STA.

F.A.P. RTE.	SECTION	COUNTY	TOTAL SHEETS	SHEET NO.
310	*	MCDONOUGH	24	17
CONTRACT NO. 68B99				
ILLINOIS FED. AID PROJECT				

* 39-1,RS-8;40-1,RS-6;41-1,RS-5

SHEETS ARE UNAVAILABLE FROM THIS POINT TO THE SOUTH

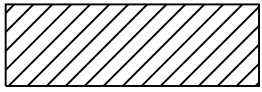
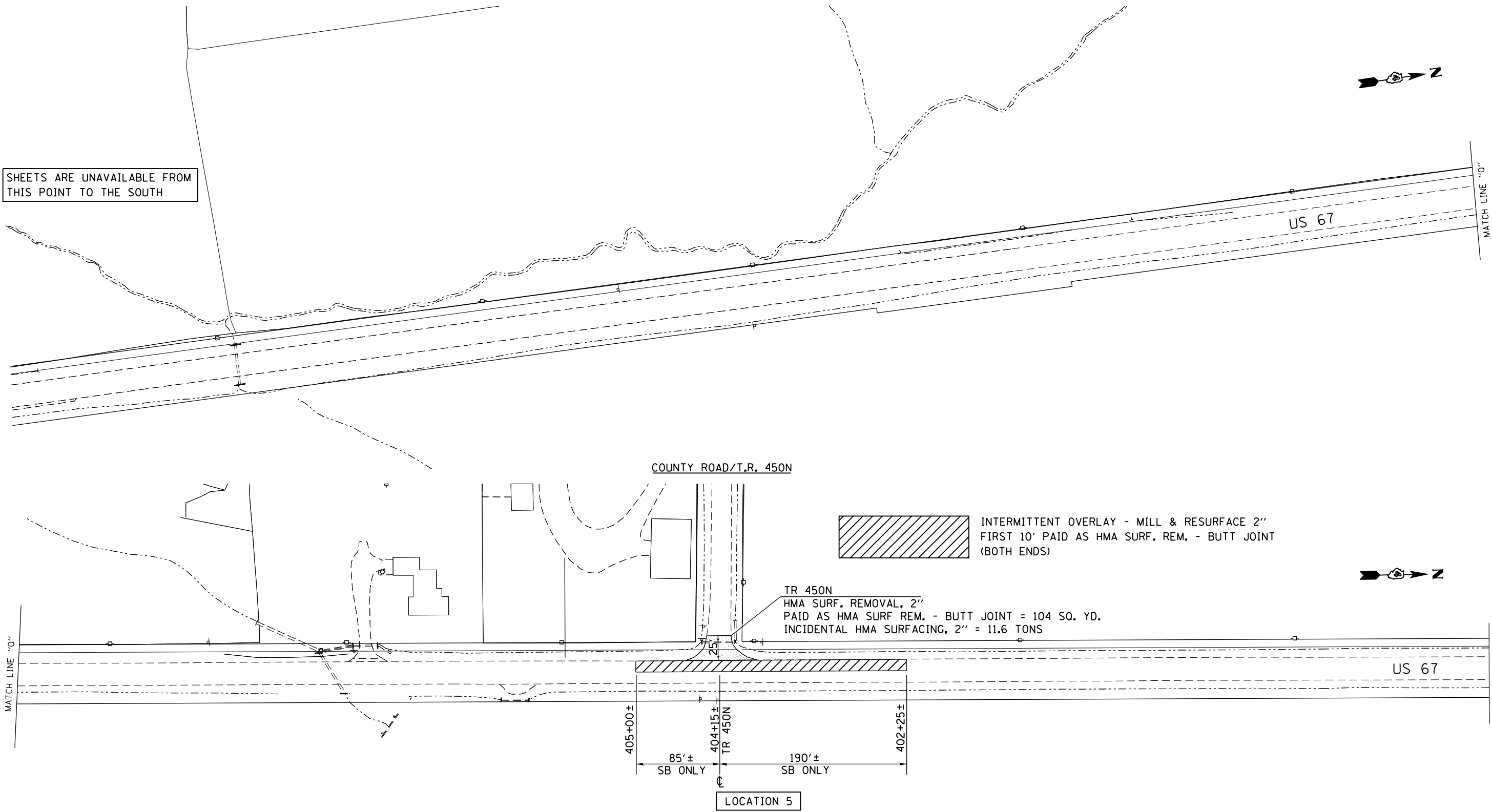

INTERMITTENT OVERLAY - MILL & RESURFACE 2"
FIRST 10' PAID AS HMA SURF. REM. - BUTT JOINT (BOTH ENDS)

TR 450N
HMA SURF. REMOVAL, 2"
PAID AS HMA SURF. REM. - BUTT JOINT = 104 SQ. YD.
INCIDENTAL HMA SURFACING, 2" = 11.6 TONS



* 39-1,RS-8;40-1,RS-6;41-1,RS-5

FILE NAME = D468899-sht-removal.dgn	USER NAME = aubreys	DESIGNED -	REVISED -
Default	PLOT SCALE = 100.0000' / in.	DRAWN -	REVISED -
	PLOT DATE = 4/1/2015	CHECKED -	REVISED -
		DATE -	REVISED -

**STATE OF ILLINOIS
DEPARTMENT OF TRANSPORTATION**

PROPOSED PLAN			
SCALE:	SHEET	OF SHEETS	STA. TO STA.

F.A.P. RTE.	SECTION	COUNTY	TOTAL SHEETS	SHEET NO.
310	*	MCDONOUGH	24	18
CONTRACT NO. 68B99				
ILLINOIS FED. AID PROJECT				

DESIGNER NOTES:
 1. Include District Special Provision for Butt Joints & for Hot Mix Asphalt Removal (Cold Milling).
 2. The butt joints pay item includes the saw cut & temporary ramp. Payment for the Butt Joint applies whether or not the project features Hot Mix Asphalt Removal (Cold Milling).

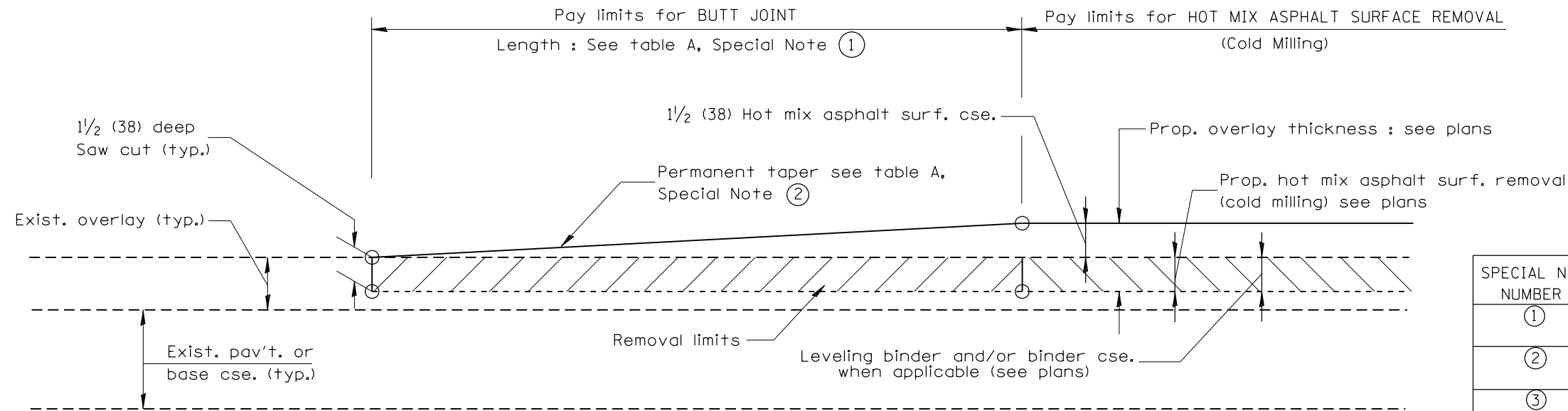

CASE 1 : WITH HOT MIX ASPHALT SURFACE REMOVAL (COLD MILLING)

TABLE A
(LENGTHS AND TAPER RATES)

SPECIAL NOTE NUMBER	ELEMENT	MAINLINE INTERSTATES & 4-LANE EXPRESSWAYS	ALL OTHERS
①	LENGTH OF BUTT JOINT	60'(18.0 m)	30'(9.0 m)
②	PERMANENT TAPER RATE	1:480	1:240
③	TEMPORARY RAMP TAPER RATE	1:80	1:40
④	TEMPORARY RAMP LENGTH	10'(3.0 m)	5'(1.5 m)
⑤	LENGTH OF BUTT JOINT	10'(3.0 m)	10'(3.0 m)

GENERAL NOTES

- The work shall be done in accordance with Article 406.08 and the Special Provision for Butt Joints.
- The pavement surface to be removed may be either bituminous or P.C. concrete. The work shall be performed in accordance with Article 440.04 and the Special Provisions for Butt Joints.
- The saw cut joints shall be primed just prior to the placing of bituminous material. The work will be in accordance with the applicable portions of Article 406.05.

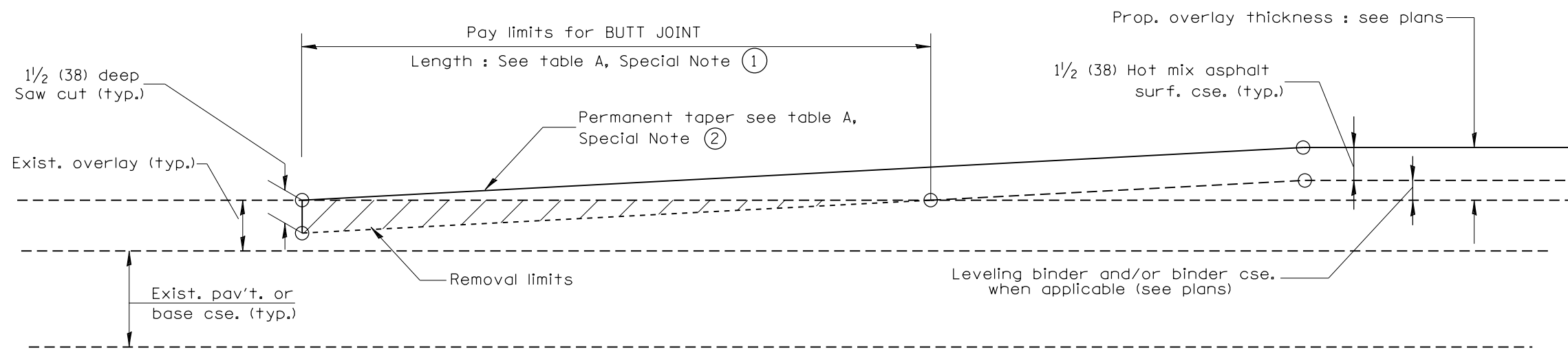

CASE 2 : NO HOT MIX ASPHALT SURFACE REMOVAL (COLD MILLING)

* 39-1,RS-8;40-1,RS-6;41-1,RS-5

All dimensions are in inches (millimeters) unless otherwise noted.

01-01-97	RENUM. C-23.01, NEW REVISION BOX	T.P.			
04-01-97	CORRECTION TO DEPTH	J.A.			
09-15-05	REVISED DESIGNER NOTE	M.M.A.			
10-16-06	REVISED TO 2007 SPEC.	M.A.			

STATE OF ILLINOIS
DEPARTMENT OF TRANSPORTATION

NOT TO SCALE

BUTT JOINTS

SHT. 1 OF 3
CADD STD. 406101-D4

F.A.P. RTE.	SECTION	COUNTY	TOTAL SHEETS	SHEET NO.
310		MCDONOUGH	24	19
FED. ROAD DIST. NO. ILLINOIS FED. AID PROJECT			CONTRACT NO. 68B99	

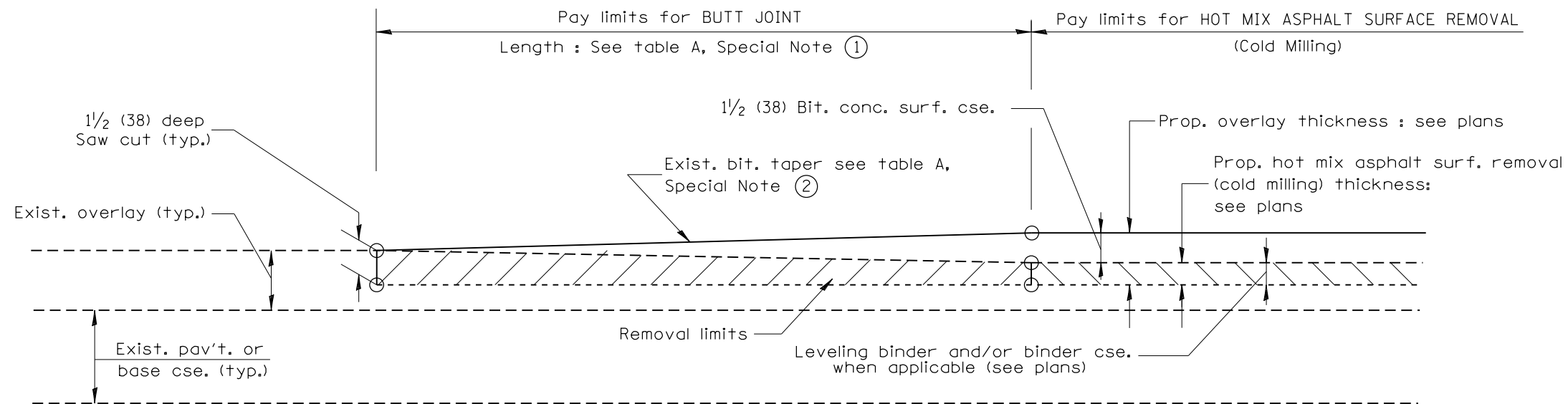

**CASE 3 : WITH HOT MIX ASPHALT SURFACE REMOVAL (COLD MILLING)
TIE-IN TO EXISTING BITUMINOUS TAPER**

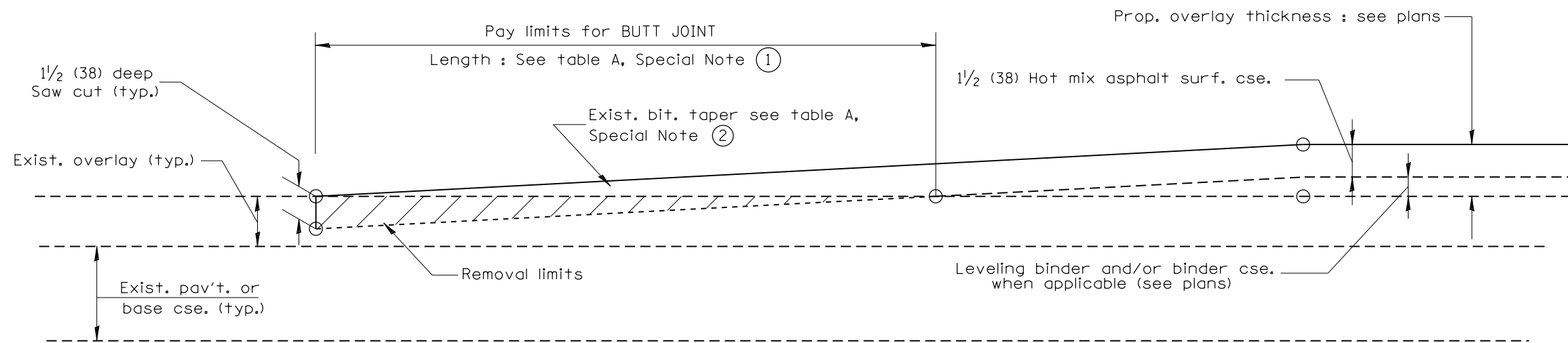

**CASE 4 : NO HOT MIX ASPHALT SURFACE REMOVAL (COLD MILLING)
TIE-IN TO EXISTING BITUMINOUS TAPER**

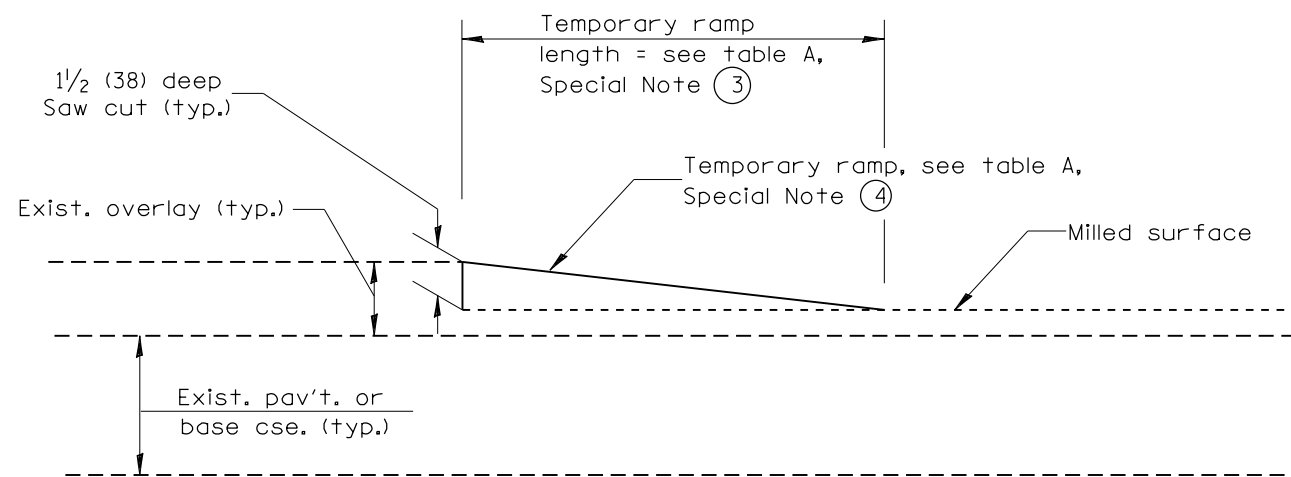

DETAIL TEMPORARY RAMP

* 39-1,RS-8;40-1,RS-6;41-1,RS-5

All dimensions are in inches (millimeters) unless otherwise noted.

--	--	--	--	--	--	--	--	--	--

**STATE OF ILLINOIS
DEPARTMENT OF TRANSPORTATION**

NOT TO SCALE

BUTT JOINTS

SHT. 2 OF 3
CADD STD. 406101-D4

F.A.P. RTE.	SECTION	COUNTY	TOTAL SHEETS	SHEET NO.
310	.	MCDONOUGH	24	20
FED. ROAD DIST. NO. ILLINOIS FED. AID PROJECT			CONTRACT NO. 68B99	

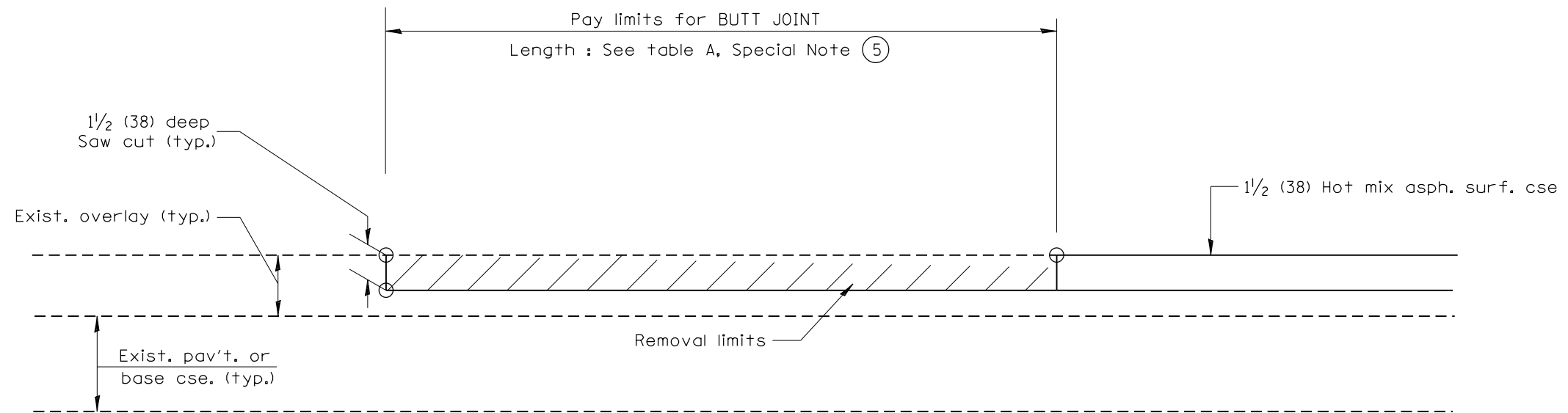

CASE 5 : WITH HOT MIX ASPHALT SURFACE REMOVAL (COLD MILLING)
TIE-IN TO EXISTING BITUMINOUS TAPER

* 39-1,RS-8;40-1,RS-6;41-1,RS-5
 All dimensions are in inches (millimeters) unless otherwise noted.

--	--	--	--	--	--	--	--	--	--

**STATE OF ILLINOIS
 DEPARTMENT OF TRANSPORTATION**

NOT TO SCALE

BUTT JOINTS

SHT. 3 OF 3
 CADD STD. 406101-D4

F.A.P. RTE.	SECTION	COUNTY	TOTAL SHEETS	SHEET NO.
310	•	MCDONOUGH	24	21
CONTRACT NO. 68B99				
FED. ROAD DIST. NO.		ILLINOIS FED. AID PROJECT		

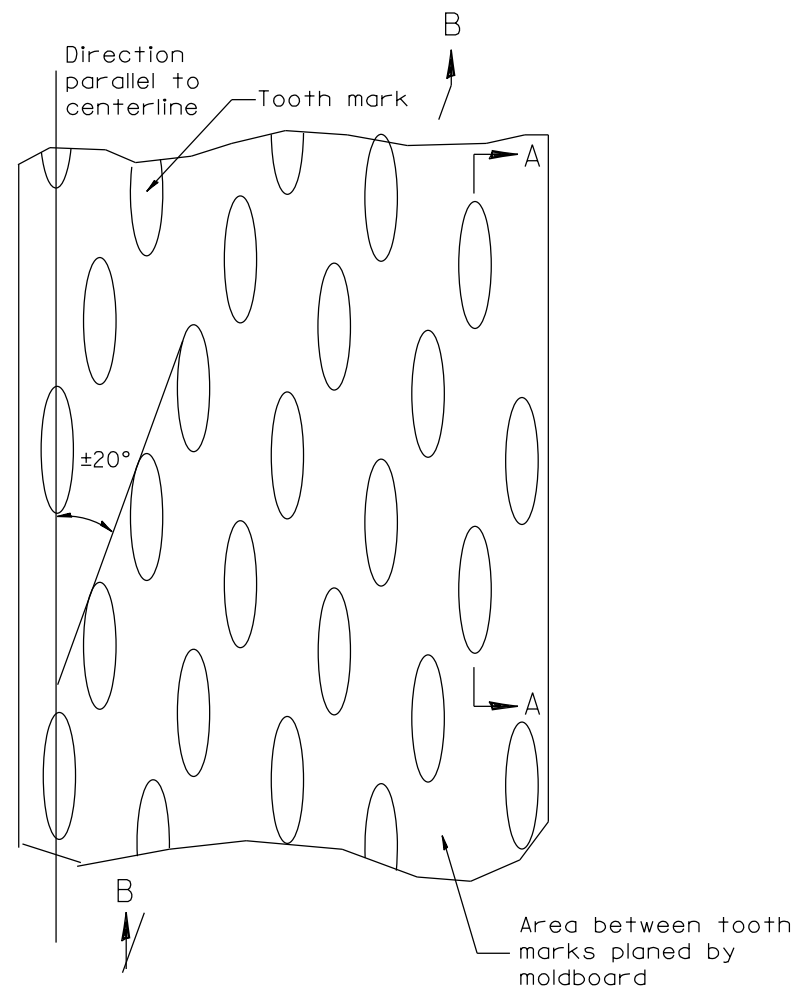

PLAN

General notes:

1. Coldmilling shall consist of two processes: Cutting with carbide teeth mounted on a rotating drum, and planing with a moldboard mounted immediately behind the cutting drum.
2. Other similar patterns will be acceptable if they consist of a smooth, flat, planed surface interspersed with a pattern of discontinuous longitudinal striations.

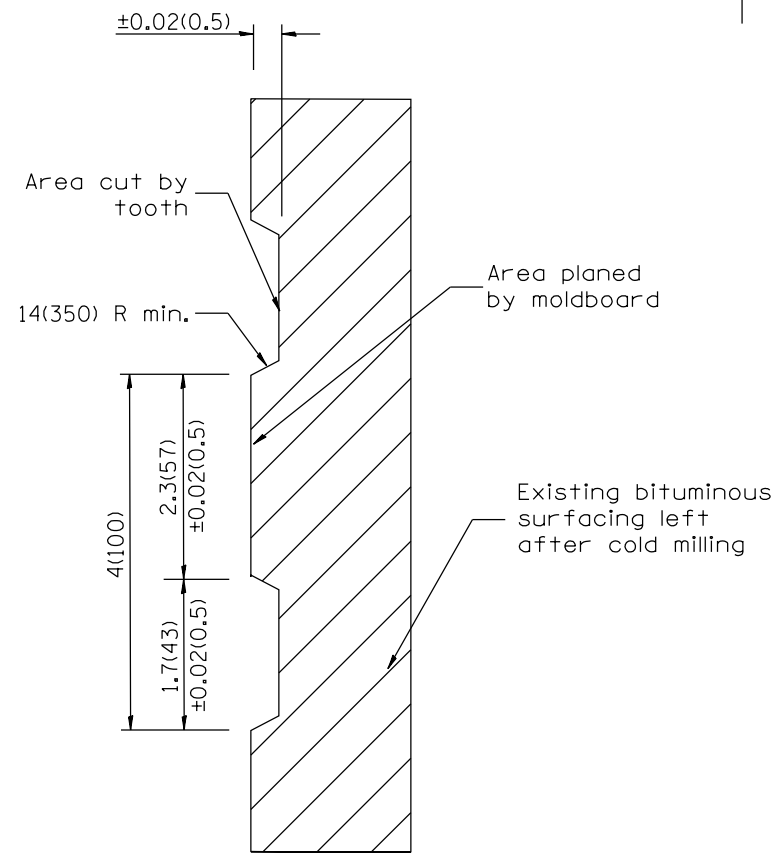

SECTION A-A

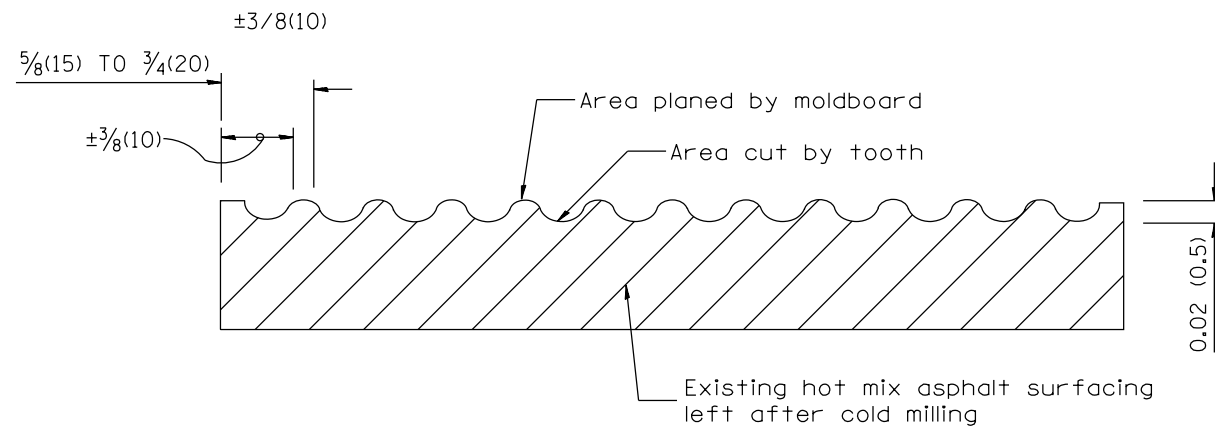

SECTION B-B PROJECTED PERPENDICULAR TO CENTERLINE

DESIGNER NOTES:
1. INCLUDE DISTRICT SPECIAL PROVISION, IF APPLICABLE.

* 39-1,RS-8;40-1,RS-6;41-1,RS-5

All dimensions are in inches (millimeters) unless otherwise noted.

01-01-97	RENUM. C-104.01, NEW REVISION BOX	T.P.
04-20-98	REMOVED MILLING DETAIL FROM STANDARD	J.A.
09-08-98	CORRECT NOTE LEADER PLACEMENT	R.W.
10-16-06	REVISED TO 2007 SPEC.	M.A.

STATE OF ILLINOIS
DEPARTMENT OF TRANSPORTATION

HOT MIX ASPHALT SURFACE REMOVAL (COLD MILLING)

NOT TO SCALE

CADD STD. 440001-D4

F.A.P. RTE.	SECTION	COUNTY	TOTAL SHEETS	SHEET NO.
310	.	MCDONOUGH	24	22
FED. ROAD DIST. NO. ILLINOIS FED. AID PROJECT			CONTRACT NO. 68B99	

DESIGNER NOTES:
1. Include State Standard 780001 (Typical Pavement Markings)

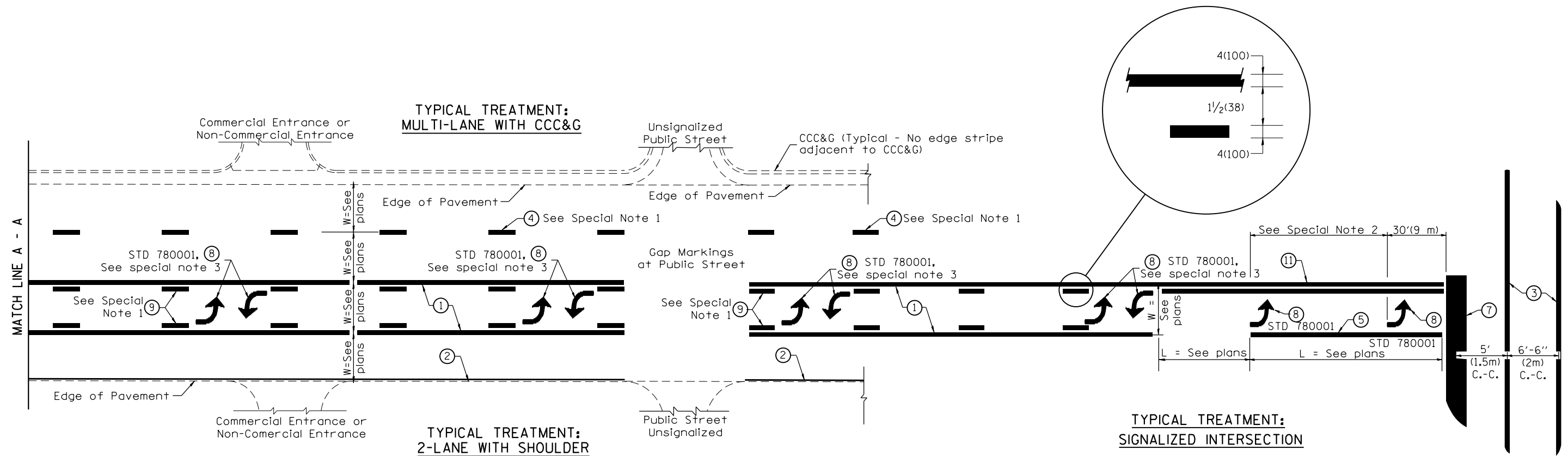

FLUSH PAVED MEDIAN: TWO-WAY LEFT TURN LANE WITH ONE-WAY LEFT TURN LANE AT SIGNALIZED INTERSECTION

TYPICAL PAVEMENT MARKING LEGEND

(Note: This is a District Standard Legend. Some elements may not apply to specific project.)

- ① 4(100) Solid (Yellow)
- ② 4(100) Solid (White)
- ③ 2-6(150) Crosswalk @ 6'-6" (2m)min C.-C. (White)
2-8(200) Crosswalk @ 6'-6" (2m)min C.-C. (White) (When traffic signals are present.)
- ④ 6(150) Skip-Dash (White) (See Special Note 1)
- ⑤ 8(200) Solid (White)
- ⑥ 12(300) Diagonal (White) (Item ⑥ is shown on Std. 780001)
- ⑦ 24(600) Stop Bar (White)
- ⑧ Letters & Arrows (See Std. 780001 and Special Notes 2 & 3)
- ⑨ 4(100) Skip-Dash (Yellow) (See Special Note 1)
- ⑩ 12(300) Diagonal (Yellow) (See Table A)
- ⑪ 4(100) Double Solid (Yellow) (See Table A)

SPECIAL NOTES

1. Skip-Dash markings will be centered between both ends of city blocks and shall be placed in alignment transversely across the pavement.
2. The following shall apply to arrows located in one-way left turn lanes:
 - A. A minimum of two (2) arrows is required.
 - B. The maximum spacing between arrows is 80' (24 m).
 - C. Arrows shall be evenly spaced if three (3) or more are required.
3. The following shall apply to arrow pairs located in two-way left turn lanes:
 - A. A minimum of two (2) arrow pairs is required.
 - B. The maximum spacing between arrow pairs is 200' (61 m).
 - C. Arrow pairs shall be evenly spaced if three (3) or more are required.
 - D. The spacing between Bi Directional Left Turn Arrows is 33' (10 m).

GENERAL NOTES

1. Refer to State Standard 780001 for additional Pavement Markings including letters & arrows.
2. See Plans for Pavement Markings adjacent to curbed islands and medians, and through lane reductions.

* 39-1,RS-8;40-1,RS-6;41-1,RS-5

01-01-97	RENUM. F-8.03, NEW REVISION BOX	T.P.	10-16-06	REVISED TO 2007 SPEC.	STATE OF ILLINOIS DEPARTMENT OF TRANSPORTATION	TYPICAL PAVEMENT MARKINGS	NOT TO SCALE	SHT. 1 OF 2 CADD STD. 780001-D4	F.A.P. RTE.	SECTION	COUNTY	TOTAL SHEETS	SHEET NO.
02-07-97	ADD BI DIRECTIONAL DIMENSION	J.A.							310		MCDONOUGH	24	23
10-97	CORRECT BI DIRECTIONAL DIMENSION	J.A.											CONTRACT NO. 68B99
08-02	ADD CROSSWALK DMNS. WITH T.S.	M.A.									FED. ROAD DIST. NO.	ILLINOIS FED. AID PROJECT	

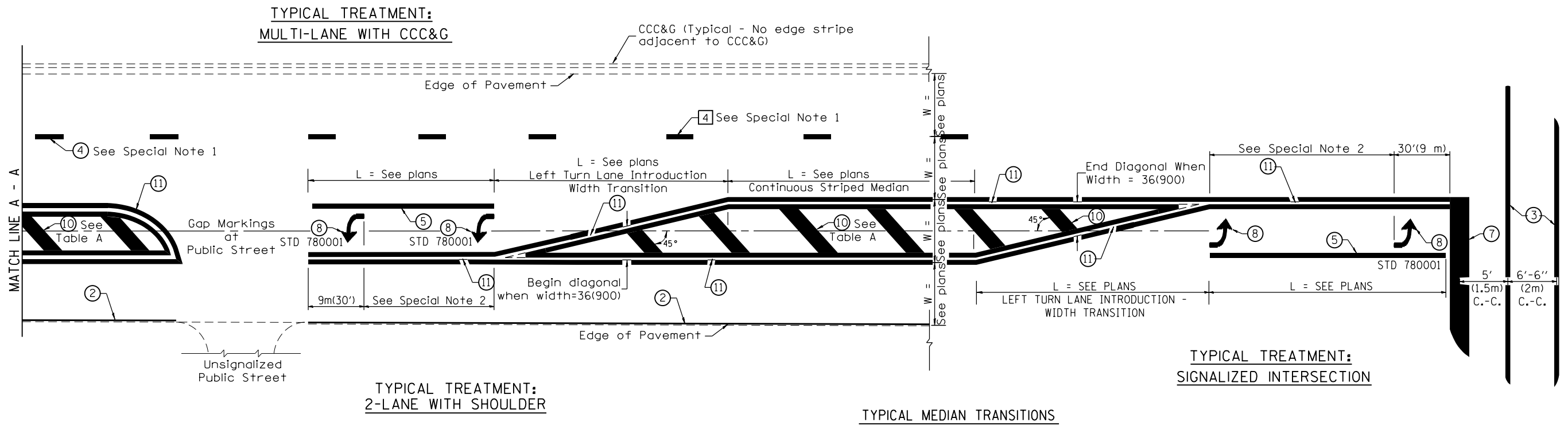

FLUSH PAVED MEDIAN: RESTRICTED LEFT TURN LANE

TABLE A
RECOMMENDED SPACING BETWEEN DIAGONAL LINES

SPEED LIMIT RANGE	INTERSECTION CHANNELIZATION (Includes Width Transitions for Median and Left Turn Lane Introductions)	
	CONTINUOUS	
Less Than 30 mph (50 km/h)	50' (15m)	15' (5m)
30 - 45 mph (50 - 70 km/h)	75' (23m)	20' (6m)
Over 45 mph (70 km/h)	150' (46m)	30' (9m)

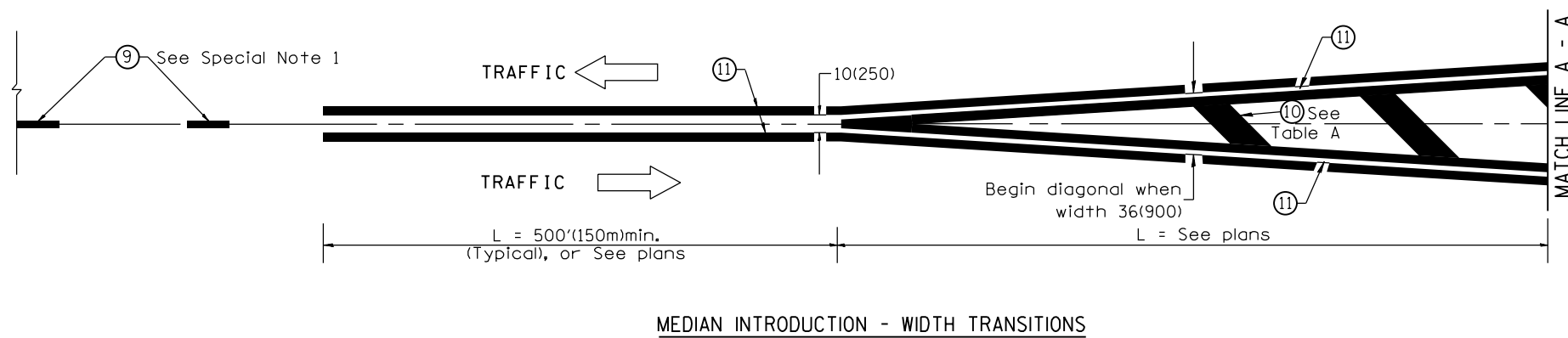

* 39-1,RS-8;40-1,RS-6;41-1,RS-5

All dimensions are in inches (millimeters) unless otherwise noted.