

STATE OF ILLINOIS
DEPARTMENT OF TRANSPORTATION
DIVISION OF HIGHWAYS

F.A.U. ROUTE	SECTION	COUNTY	TOTAL SHEETS	SHEET NUMBER
9249	14-00021-00-CG	ST. CLAIR	24	1
		STA. 11+16.92 TO STA. 23+24.44		
FEDERAL AID PROJECT		CONTRACT 97592		

**PLANS FOR PROPOSED
LOCAL AGENCY PROJECT**

**FAU ROUTE 9249 (SCHUETZ STREET)
SECTION 14-00021-00-CG
PROJECT NO. M-5011 (417)
CITY OF LEBANON, ILLINOIS
ST. CLAIR COUNTY
JOB NO. C-98-335-14**

INDEX OF SHEETS

- 1. COVER SHEET
- 2. SUMMARY OF QUANTITIES & GENERAL NOTES & STANDARDS
- 3.-4. TYPICAL SECTIONS
- 5.-6. CONSTRUCTION SCHEDULES
- 7.-9. ROADWAY PLAN AND PROFILES
- 10. ADVANCE WARNING SIGNS
- 11. REMOVAL PLANS
- 12.-13. DRAINAGE PROFILES
- 14. EROSION CONTROL PLANS
- 15.-16. SIDEWALK RAMPS DETAILS
- 17.-18. MISCELLANEOUS DETAILS
- 19.-24. CROSS SECTIONS

SCALES:

PLAN	
PROFILE HORZ.	
PROFILE VERT.	
CROSS SECTION HORZ.	
CROSS SECTION VERT.	

UTILITY TYPE	NAME OF UTILITY	PHONE NUMBER
ELECTRIC	AMEREN IP	1-800-755-5000
GAS	AMEREN IP	1-800-755-5000
WATER	CITY OF LEBANON	1-618-537-4976
TELEPHONE	AT&T	1-800-480-8088
CABLE	CHARTER COMMUNICATIONS	1-888-438-2427
SANITARY SEWER	CITY OF LEBANON	1-618-537-4976

SCHUETZ STREET

ROADWAY DESIGNATION: URBAN COLLECTOR
DESIGN SPEED: 30 M.P.H.
DESIGN YEAR: (2023) ADT: 850



BEGIN PROJECT STA. 11+16.92 END PROJECT STA. 23+24.44

LOCATION MAP
NOT TO SCALE

LENGTH OF IMPROVEMENT 1,207.52 FT. = 0.229 MI.

= IMPROVEMENT AREA



LOCATION OF PROJECT INDICATED THUS:

STATE OF ILLINOIS
DEPARTMENT OF TRANSPORTATION

APPROVED 3/11/15 DATE
Rich Wilken - Mayor
RICH WILKEN, MAYOR

PASSED April 7, 2015 DATE
[Signature]
DISTRICT 8 ENGINEER OF LOCAL ROADS & STREETS

RELEASED FOR BID
BASED ON LIMITED REVIEW April 7, 2015 DATE
[Signature]
DEPUTY DIRECTOR OF HIGHWAYS
REGION FIVE ENGINEER

PRINTED BY AUTHORITY OF THE STATE OF ILLINOIS

HOLD IT ! CALL BEFORE YOU DIG !
Phone J.U.L.I.E.

The owner would like to remind you that underground utility facilities can be damaged by shovel blades or other digging equipment. You can prevent damage or possible personal danger by phoning 800/892-0123 at least 48 hours before you dig. That's the toll-free number for "J.U.L.I.E.", which stands for Joint Utilities Location Information for Excavators.

If there are any pipes, cables, lines or mains in the excavation area, utility personnel will be out to mark the facilities so you can work around them.

Toll Free 800/892-0123



RHUTASEL and ASSOCIATES, INC.
CONSULTING ENGINEERS • LAND SURVEYORS

CORPORATE OFFICE
4 INDUSTRIAL DRIVE
FREEBURG, ILLINOIS 62243
(618) 539-3178

REGIONAL OFFICE
201 SOUTH LOCUST STREET
CENTRALIA, ILLINOIS 62801
(618) 532-1992

PREPARED BY:



Christopher A. Smith
Christopher A. Smith
3/11/2015
Date of Signing
11/30/2015
Date of License Expiration

SUMMARY OF QUANTITIES

CODE NO.	ITEM	UNIT	TOTAL QUANTITY
20100210	TREE REMOVAL (OVER 15 UNITS DIAMETER)	UNIT	102
20200100	EARTH EXCAVATION	CU YD	1375
20800150	TRENCH BACKFILL	CU YD	574
25000100	SEEDING, CLASS 1	ACRE	0.2
25000400	NITROGEN FERTILIZER NUTRIENT	POUND	18
25000500	PHOSPHORUS FERTILIZER NUTRIENT	POUND	18
25000600	POTASSIUM FERTILIZER NUTRIENT	POUND	18
25100115	MULCH, METHOD 2	ACRE	0.2
28000250	TEMPORARY EROSION CONTROL SEEDING	POUND	20
28000400	PERIMETER EROSION BARRIER	FOOT	600
28000500	INLET AND PIPE PROTECTION	EACH	28
30200650	PROCESSING MODIFIED SOIL 12"	SQ YD	5407
30201500	LIME	TON	104
40201000	AGGREGATE FOR TEMPORARY ACCESS	TON	150
40600275	BITUMINOUS MATERIALS (PRIME COAT)	POUND	119
40603085	HOT-MIX ASPHALT BINDER COURSE, IL-19.0, N70	TON	1070
40603340	HOT-MIX ASPHALT SURFACE COURSE, MIX "D", N70	TON	535
42001300	PROTECTIVE COAT	SQ YD	400
42300200	PORTLAND CEMENT CONCRETE DRIVEWAY PAVEMENT, 6 INCH	SQ YD	75
42400100	PORTLAND CEMENT CONCRETE SIDEWALK 4 INCH	SQ FT	9043
42400800	DETECTABLE WARNINGS	SQ FT	179
44000100	PAVEMENT REMOVAL	SQ YD	81
44000200	DRIVEWAY PAVEMENT REMOVAL	SQ YD	84
44000500	COMBINATION CURB AND GUTTER REMOVAL	FOOT	2434
44000600	SIDEWALK REMOVAL	SQ FT	6965
50100100	REMOVE EXISTING STRUCTURE	EACH	1
54010303	PRECAST CONCRETE BOX CULVERTS 3'X3'	FOOT	717
55042320	STORM SEWERS, RUBBER GASKETED, CLASS A, TYPE 1 12"	FOOT	216
55042330	STORM SEWERS, RUBBER GASKETED, CLASS A, TYPE 1 15"	FOOT	31
55042360	STORM SEWERS, RUBBER GASKETED, CLASS A, TYPE 1 24"	FOOT	414
55042400	STORM SEWERS, RUBBER GASKETED, CLASS A, TYPE 1 36"	FOOT	45
55080070	STORM SEWERS, CLASS B, TYPE 1 15"	FOOT	3
55100500	STORM SEWER REMOVAL 12"	FOOT	137
55100700	STORM SEWER REMOVAL 15"	FOOT	11
55100900	STORM SEWER REMOVAL 18"	FOOT	28
55101100	STORM SEWER REMOVAL 21"	FOOT	379
55101200	STORM SEWER REMOVAL 24"	FOOT	25
55101600	STORM SEWER REMOVAL 36"	FOOT	390
56109210	WATER VALVES TO BE ADJUSTED	EACH	3
60218500	MANHOLES, TYPE A, 4'-DIAMETER, TYPE 3 FRAME AND GRATE	EACH	1
60221100	MANHOLES, TYPE A, 5'-DIAMETER, TYPE 1 FRAME, CLOSED LID	EACH	1
60237000	INLETS, TYPE A, TYPE 15 FRAME AND LID	EACH	5
60237460	INLETS, TYPE A, TYPE 23 FRAME AND GRATE	EACH	3
60240220	INLETS, TYPE B, TYPE 3 FRAME AND GRATE	EACH	1
60240320	INLETS, TYPE B, TYPE 15 FRAME AND LID	EACH	1
60255500	MANHOLES TO BE ADJUSTED	EACH	3
60404300	FRAME AND GRATE, TYPE 3	EACH	4
60500040	REMOVING MANHOLES	EACH	3
60500060	REMOVING INLETS	EACH	12
60604400	COMBINATION CONCRETE CURB AND GUTTER, TYPE B-6.18	FOOT	2425
* 63100167	TRAFFIC BARRIER TERMINAL, TYPE 1 (SPECIAL) TANGENT	EACH	1
* 63200310	GUARDRAIL REMOVAL	FOOT	87.5
67100100	MOBILIZATION	L SUM	1
* 66900200	NON-SPECIAL WASTE DISPOSAL	CU YD	10
* 66900450	SPECIAL WASTE PLANS AND REPORTS	L SUM	1

SUMMARY OF QUANTITIES

CODE NO.	ITEM	UNIT	TOTAL QUANTITY
* 66900530	SOIL DISPOSAL ANALYSIS	EACH	1
72000100	SIGN PANEL-TYPE 1	SQ FT	49.5
72900200	METAL POST-TYPE B	FOOT	81
* 78009006	MODIFIED URETHANE PAVEMENT MARKING-LINE 6"	FOOT	482
* 78009012	MODIFIED URETHANE PAVEMENT MARKING-LINE 12"	FOOT	264
* 78009024	MODIFIED URETHANE PAVEMENT MARKING-LINE 24"	FOOT	13
* 78204000	TERMINAL MARKER - DIRECT APPLIED	EACH	1
XX003424	CONNECTION TO EXISTING STRUCTURE	EACH	1
X0323964	ROOF DRAIN COLLECTION NETWORK	FOOT	35
X0327235	LOCATING UNDERGROUND UTILITIES	FOOT	50
X6024242	INLETS, SPECIAL NO. 1	EACH	4
X6024244	INLETS, SPECIAL NO. 2	EACH	1
X6024246	INLETS, SPECIAL NO. 3	EACH	5
X6024248	INLETS, SPECIAL NO. 4	EACH	1
X7010216	TRAFFIC CONTROL AND PROTECTION, (SPECIAL)	L SUM	1
Z0012455	CONCRETE STEP REMOVAL	EACH	3
Z0056608	STORM SEWER (WATER MAIN REQUIREMENTS) 12 INCH	FOOT	46

*SPECIALTY ITEM

GENERAL NOTES

- ALL CONSTRUCTION SHALL BE DONE ACCORDING TO THE ILLINOIS DEPARTMENT OF TRANSPORTATION STANDARD SPECIFICATIONS FOR ROAD AND BRIDGE CONSTRUCTION, ADOPTED JANUARY 1, 2012.
- THE PROPOSED EMBANKMENT SHALL BE BENCHED INTO THE EXISTING SLOPES TO THE SATISFACTION OF THE ENGINEER.
- "ROAD CONSTRUCTION AHEAD" SIGNS SHALL BE PLACED AT THE BEGINNING AND END OF THE PROJECT PLUS THE INTERSECTING SIDE ROADS AND WILL BE INCLUDED IN THE TRAFFIC CONTROL PAY ITEMS. ALL CONSTRUCTION SIGNS SHALL BE FLUORESCENT ORANGE 48"x48".
- ALL AREAS DISTURBED FOR ANY REASON WITHIN THE CONSTRUCTION LIMITS SHALL BE SEEDED WITH CLASS 1 SEEDING. NUTRIENTS SHALL CONFORM TO ARTICLE 250.04. AREAS DISTURBED BEYOND THE CONSTRUCTION LIMITS SHALL BE SEEDED BY THE CONTRACTOR AT HIS/HER OWN EXPENSE.
- THE CONTRACTOR SHALL VERIFY ALL DIMENSIONS AND CONDITIONS IN THE FIELD PRIOR TO CONSTRUCTION AND ORDERING OF MATERIALS.
- THE CONTRACTOR SHALL COORDINATE WITH RESIDENTS PRIOR TO REMOVAL AND REPLACEMENT OF DRIVEWAYS.
- PROTECTIVE COAT SHALL BE APPLIED TO ALL GUTTER FLAGS AND FACE OF CURBS.
- THE EXISTING PROPERTY LINES SHOWN HEREON HAS BEEN PROTRACTED FROM EXISTING RECORDS AND IS TO BE USED FOR REFERENCE PURPOSES ONLY. FURTHERMORE, NO COMPLETE SURVEY OF SAID PROPERTY LINES IS IMPLIED BY THESE DRAWINGS.
- AN ESTIMATED QUANTITY OF 150 TONS OF AGGREGATE FOR TEMPORARY ACCESS HAS BEEN INCLUDED IN THE PLANS FOR THE PURPOSE OF MAINTAINING ACCESS TO PRIVATE PROPERTY AND LOCAL TRAFFIC THROUGHOUT CONSTRUCTION OPERATIONS.
- FACTORS USED FOR APPLICATION RATES AND QUANTITY CALCULATIONS ARE AS FOLLOWS:
PAVING
 ALL HOT-MIX ASPHALT 0.056 TONS/SQ. YD./INCH
 BITUMINOUS MATERIALS (PRIME COAT) 0.025 LB/SQ. FT. (FOG COAT)
 BITUMINOUS MATERIALS (PRIME COAT) 0.05 LB/SQ. FT. (HMA BASE)
 BITUMINOUS MATERIALS (PRIME COAT) 0.25 LB/SQ. FT. (AGGREGATE BASE)
 AGGREGATE BASE COURSE 0.0555 TONS/SQ. YD./INCH
SEEDING
 NITROGEN FERTILIZER NUTRIENT 90 LBS/ACRE
 PHOSPHORUS FERTILIZER NUTRIENT 90 LBS/ACRE
 POTASSIUM FERTILIZER NUTRIENT 90 LBS/ACRE
 MULCH 2 TONS/ACRE
LIME MODIFIED SOILS
 SOIL 1.4445 TONS/CU. YD.
 LIME (4% OF SOIL) 0.01926 TONS/SQ. YD./12 IN.
 WATER 15 GAL./SQ. YD./12 IN.
- CHANGES IN THE VERTICAL OR HORIZONTAL DIMENSIONS OF GUTTERS, CURBS, OR CURB AND GUTTERS, WHEN TRANSITIONS FROM ONE TYPE TO ANOTHER AS SHOWN IN THE PLANS, WILL BE PAID FOR AT THE CONTRACT PRICE PER FOOT FOR THE TYPE SPECIFIED IN THE PLAN SCHEDULE.
- THE REMOVAL OF ANY CURB AND GUTTER SHALL ALSO INCLUDE THE DISCONNECTION OF THE EXISTING CURB AND GUTTER FROM ANY REINFORCEMENT OR COLLATERAL MATERIAL THAT MAY BE PRESENTLY ATTACHED. THERE SHALL NOT BE ANY ADDITIONAL REMUNERATION BUT THIS WORK SHALL BE CONSIDERED AS INCLUDED IN THE REMOVAL ITEM.
- IF ASH TREES ARE REMOVED ON THE PROJECT, THE CONTRACTOR SHALL BECOME FAMILIAR WITH AND COMPLY WITH MEASURES SPECIFIED BY THE ILLINOIS DEPARTMENT OF AGRICULTURE (IDOA) TO PREVENT THE SPREAD OF THE EMERALD ASH BORER. THE IDOA INFORMATION FOR ASH TREE REMOVAL CAN BE FOUND ON THE IDOA WEBSITE AT WWW.AGR.STATE.IL.US/EAB.
- THE TOP 6 INCHES OF ALL NECESSARY BACKFILL SHALL BE FREE FROM ALL ROCKS OR FOREIGN DEBRIS.
- ALL PIPE DRAINS/ROOF DRAINS, BOTH EXPOSED AND UNEXPOSED, THAT DISCHARGE OVER TOP THE EXISTING CURB SHALL BE DISCHARGED INTO THE NEAREST INLET OR STORM SEWER PIPE. THE PIPE SHALL BE INSTALLED AT A MINIMUM GRADE OF 0.50% IN AREAS WHERE NO STORM SEWER IS PRESENT PIPE DRAINS/ROOF DRAINS SHALL BE PLACED UNDER PROPOSED SIDEWALK AND DAYLIGHTED. ALL EQUIPMENT, MATERIALS, AND LABOR REQUIRED TO COMPLETE THIS WORK SHALL BE PAID FOR AT THE CONTRACT UNIT PRICE PER FOOT FOR ROOF DRAIN COLLECTION NETWORK AND NO ADDITIONAL COMPENSATION WILL BE ALLOWED.
- LANDSCAPING ITEMS WITHIN THE LIMITS OF CONSTRUCTION WHICH MUST BE REMOVED SHALL BE SALVAGED FOR RE-USE OR DISPOSAL AS DIRECTED BY THE ENGINEER. REMOVAL AND/OR SALVAGE OF LANDSCAPING ITEMS SHALL BE INCLUDED IN THE COST OF THE CONTRACT.
- ALL EXISTING SIGNS WHICH INTERFERE WITH THE IMPROVEMENTS NOT NOTED FOR REMOVAL SHALL BE REMOVED AND REINSTALLED AT THEIR PERMANENT LOCATIONS AS DIRECTED BY THE ENGINEER IN THE FIELD. THIS WORK SHALL BE INCLUDED IN THE COST OF THE CONTRACT.
- AN ESTIMATED QUANTITY OF 50 FEET FOR "LOCATING UNDERGROUND UTILITIES" HAS BEEN INCLUDED IN THE PLANS FOR THE PURPOSE OF UTILITY EXPLORATION AT LOCATIONS OF POTENTIAL CONFLICTS AS DIRECTED BY THE ENGINEER.
- ANY WASTE GENERATED AS A SPECIAL WASTE OR A WASTE NOT CERTIFIED AS A NON-SPECIAL WASTE FROM THIS PROJECT SHOULD BE MANIFESTED OFF-SITE USING THE GENERATOR NUMBER ASSOCIATED WITH ST. CLAIR COUNTY. THE GENERATOR NUMBER FOR ST. CLAIR COUNTY IS 1638995004.

COMMITMENTS

NONE AT THIS TIME.

F.A.U. ROUTE	SECTION	COUNTY	TOTAL SHEETS	SHEET NUMBER
9249	14-00021-00-CG	ST. CLAIR	24	2
STA TO		STA.		
FEDERAL AID PROJECT		CONTRACT 97592		

APPLICABLE IDOT HIGHWAY STANDARDS:

424001-08	602601-03	701501-06	729001-01
424021-03	602701-02	701801-05	780001-05
602301-04	604001-04	701901-04	BLR 22-7
602306-03	604066-02	720006-04	
602401-03	606001-06	720011-01	

F.A.U. ROUTE	SECTION	COUNTY	TOTAL SHEETS	SHEET NUMBER
9249	14-00021-00-CG	ST. CLAIR	24	3
FEDERAL AID PROJECT		CONTRACT 97592		

LEGEND

- ① EXISTING OIL AND CHIP PAVEMENT, 4 ±"
- ② EXISTING CURB AND GUTTER
- ③ EXISTING SIDEWALK

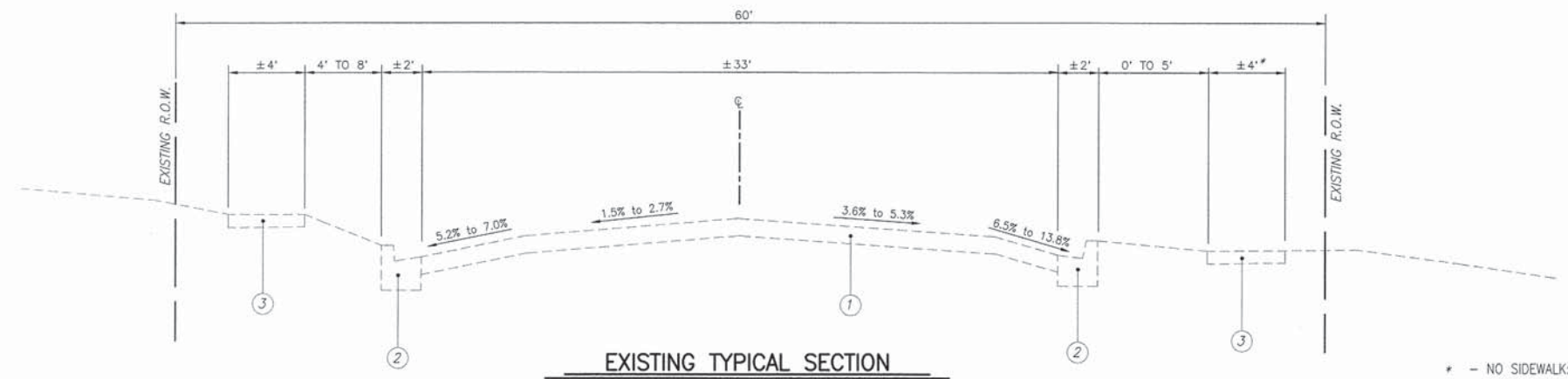

EXISTING TYPICAL SECTION

N.T.S.
STA. 11+00 TO STA. 19+41
SCHUETZ STREET

* - NO SIDEWALK: STA. 11+63 TO 15+12 RT.

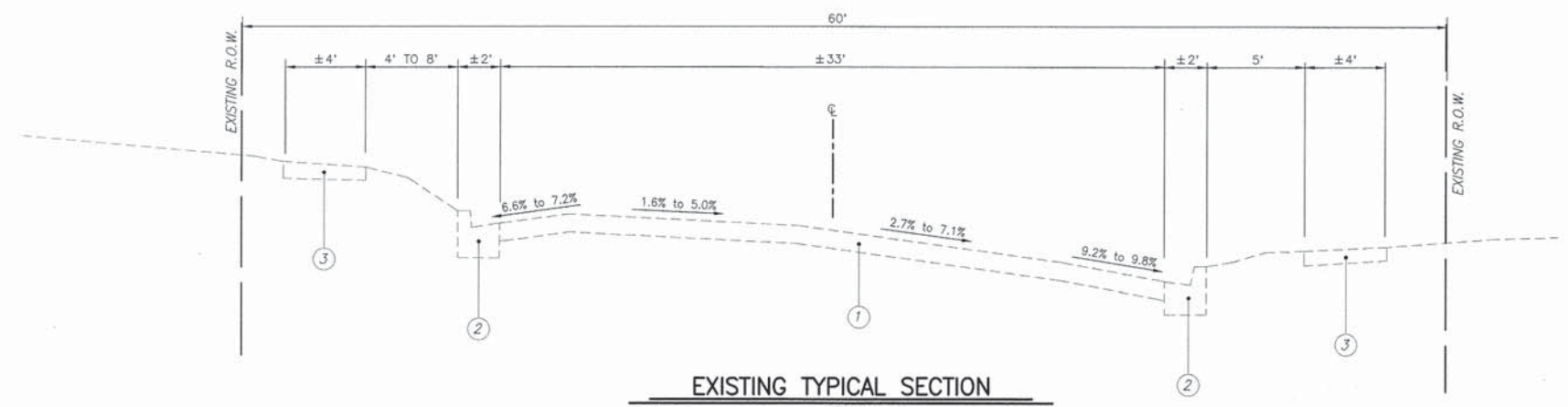

EXISTING TYPICAL SECTION

N.T.S.
STA. 19+41 TO STA. 23+24
SCHUETZ STREET

A:\0814\Subarea\3\Subarea\14-00021-00-CG\14-00021-00-CG.dwg 3/11/2015 5:55:55 PM P:\11\11.dwg

F.A.U. ROUTE	SECTION	COUNTY	TOTAL SHEETS	SHEET NUMBER
9249	14-00021-00-CG	ST. CLAIR	24	4
FEDERAL AID PROJECT		CONTRACT 97592		

LEGEND

- ① HOT-MIX ASPHALT SURFACE COURSE, MIX "D", N70, 2"
- ② HOT-MIX ASPHALT BINDER COURSE, IL-19.0, N70, 4"
- ③ LIME MODIFIED SOILS, 12"
- ④ COMBINATION CONCRETE CURB & GUTTER, TYPE B-6.18
- ⑤ P.C.C. SIDEWALK, 4"
- ⑥ BITUMINOUS MATERIALS (PRIME COAT)

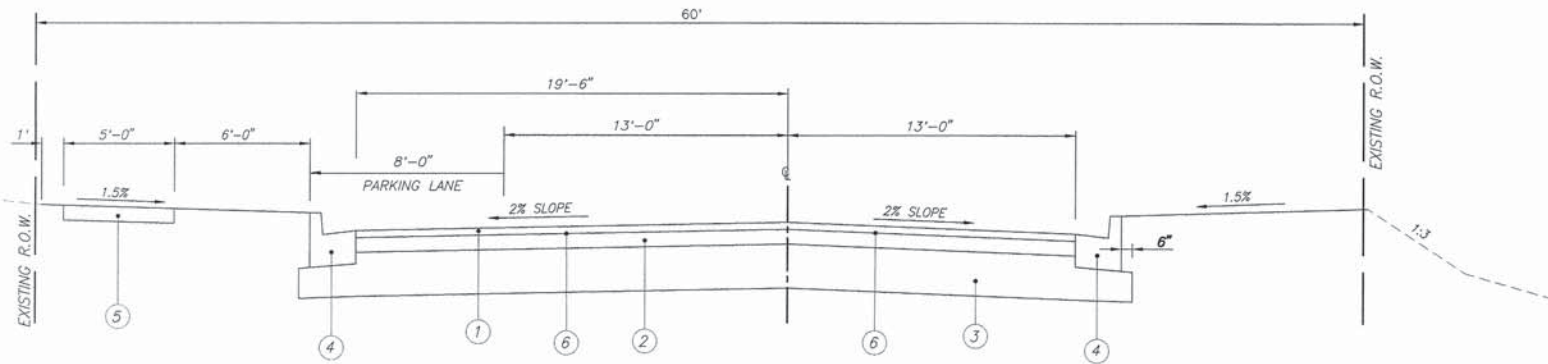

PROPOSED TYPICAL SECTION

N.T.S.
STA. 11+16.92 TO STA. 14+87
SCHUETZ STREET

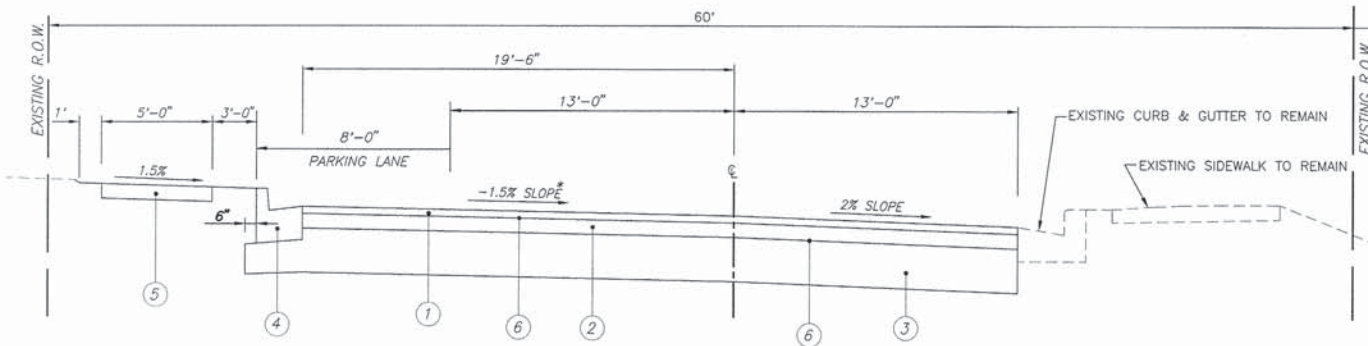

PROPOSED TYPICAL SECTION

N.T.S.
STA. 14+87 TO STA. 15+80
SCHUETZ STREET

* - Transition cross slope from 2% to -1.5%
From Station 14+42.75 to 15+46.15

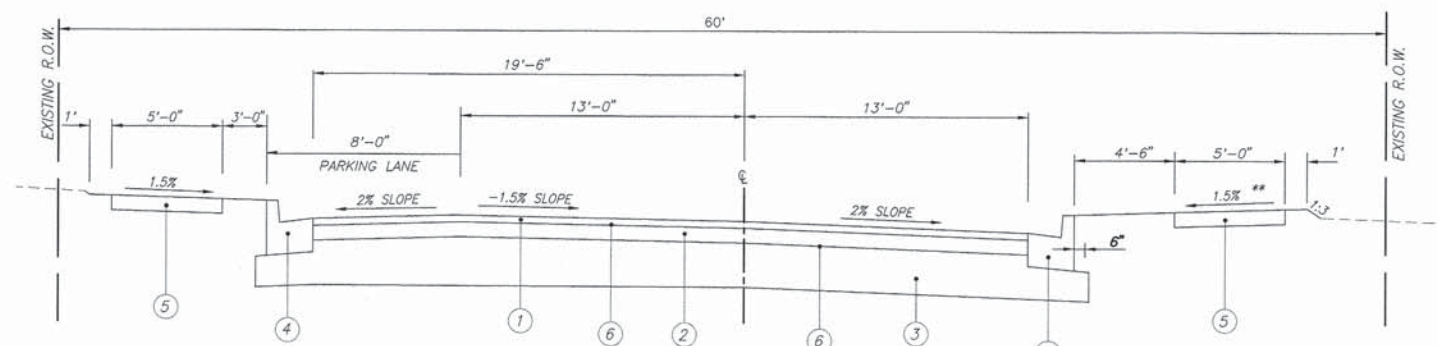

PROPOSED TYPICAL SECTION

N.T.S.
STA. 17+55.59 TO STA. 19+07.64
SCHUETZ STREET

* - Transition cross slope of parking lane from 2% to -1.5%
From Station 18+00 to 18+30
** - Slope Sidewalk away from road at 1.5%
From Station 18+00 to 21+20

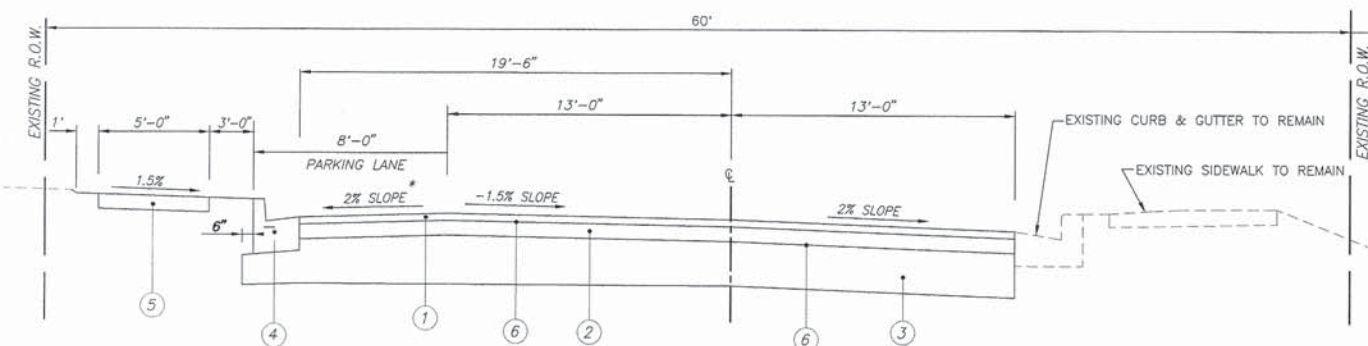

PROPOSED TYPICAL SECTION

N.T.S.
STA. 15+80 TO STA. 17+55.59
SCHUETZ STREET

* - Transition cross slope of parking lane from -1.5% to 2%
From Station 15+80 to 16+10

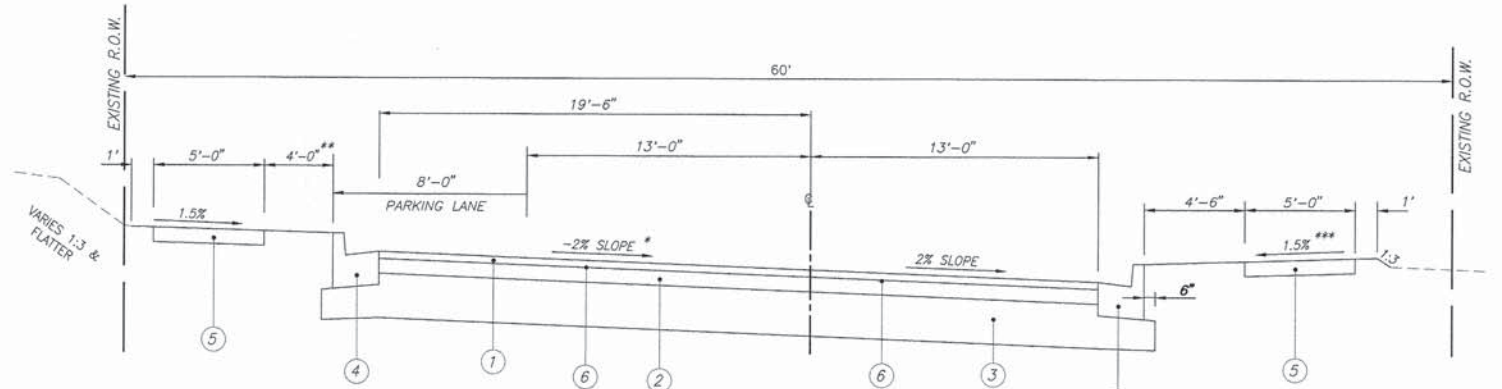

PROPOSED TYPICAL SECTION

N.T.S.
STA. 19+07.64 TO STA. 23+24.44
SCHUETZ STREET

* - Transition cross slope from -1.5% to -2%
From Station 19+07.64 to 19+41.23
** - Transition from 3' to 4'-0"
From Station 19+75 to 21+00
*** - Slope Sidewalk away from road at 1.5%
From Station 18+00 to 21+20
From Station 21+67 to 23+12

F.A.U. ROUTE	SECTION	COUNTY	TOTAL SHEETS	SHEET NUMBER
9249	14-00021-00-CG	ST. CLAIR	24	5
STA		TO	STA.	
FEDERAL AID PROJECT			CONTRACT 97592	

EARTHWORK SCHEDULE

LOCATION	EARTH EXCAVATION	EARTH EXCAVATION ADJUSTED FOR SHRINKAGE (25%)	EMBANKMENT	EARTHWORK BALANCE SURPLUS (+) OR SHORTAGE (-)
	CU YD	CU YD	CU YD	CU YD
STA. 11+16.89 TO 23+24.44	1,375	1,031	148	+883
TOTAL	1,375	1,031	148	+883

NOTE: EXISTING OIL & CHIP AND AGGREGATE INCLUDED IN EARTH EXCAVATION.

PAVING SCHEDULE

LOCATION	PROCESSING MODIFIED SOILS	LIME	HMA BINDER CRSE. IL-19.0, N70, 4"	BIT. MATERIALS (PRIME COAT)	HMA SURFACE CRSE., MIX "D", N70, 2"
	SQ YD	TON	TON	POUND	TON
STA. 11+16.89 TO 23+24.44	5,407	104	1,070	119	535
TOTAL	5,407	104	1,070	119	535

ENTRANCE SCHEDULE

STATION	EXISTING SURFACE	TYPE	"L"	"W"	DRIVEWAY PVM'T REMOVAL	PCC DRIVEWAY PAVEMENT, 6"	AGG. SURFACE COURSE, TY B, 6"	COMMENTS
			FOOT	FOOT	SQ. YD.	SQ. YD.	TON	
13+35.22, LT.	AGGREGATE	P.E.	11.6	14.0	---	20.3	X.X	
14+43.15, LT.	P.C.C.	P.E.	11.0	12.0	13.7	16.7	---	
16+42.37, LT.	AGGREGATE	P.E.	8.0	12.0	6.8	11.7	---	
22+38.68, LT.	P.C.C.	C.E.	---	---	13.1	---	---	ABANDONED
22+76.86, RT.	P.C.C.	C.E.	9.4	24.0	49.9	26.3	---	
TOTAL					83.5	75.0		

PAVEMENT MARKING SCHEDULE

LOCATION	TYPE	MODIFIED URETHANE PAVEMENT MARKINGS		
		6" WHITE	12" WHITE	24" WHITE
		FOOT	FOOT	FOOT
INTERSECTION OF SCHUETZ/MONROE	STOP BAR CROSS WALK		59	194
INTERSECTION OF SCHUETZ/ST. CLAIR	STOP BAR CROSS WALK		17	142
INTERSECTION OF SCHUETZ/PEARL	STOP BAR CROSS WALK		17	146
INTERSECTION OF SCHUETZ/MADISON (IL RTE 4)	STOP BAR CROSS WALK		171	13
TOTAL		482	264	13

SEEDING SCHEDULE

LOCATION	SEEDING CLASS 1	MULCH METHOD 2	FERTILIZER NUTRIENTS			TEMPORARY EROSION CONTROL SEEDING
	ACRE	ACRE	NITROGEN POUND	PHOSPHORUS POUND	POTASSIUM POUND	POUND
	STA. 11+16 TO 23+24	0.2	0.2	18	18	18
TOTAL	0.2	0.2	18	18	18	20

TREE REMOVAL SCHEDULE

LOCATION	TREE REMOVAL (OVER 15 UNITS DIAMETER)
	UNITS
STA. 12+91, 18' LT.	36
STA. 20+35, 19' RT.	30
STA. 21+86, 18' RT.	36
TOTAL	102

CURB AND GUTTER SCHEDULE

LOCATION	COMBINATION CONCRETE C & G TY. B-6.18
	FOOT
STA. 11+20 TO 11+33, LT.	21
STA. 11+21 TO 11+30, RT.	9
STA. 11+39 TO 11+43, RT.	10
STA. 11+62 TO 15+33, RT.	390
STA. 11+65 TO 15+30, LT.	395
STA. 15+13 TO 15+36, RT.	189
STA. 15+63 TO 19+25, LT.	397
STA. 17+68 TO 23+25, RT.	600
STA. 19+58 TO 23+25, LT.	403
STA. 23+70 TO 23+83, LT.	13
TOTAL	2,425

PROTECTIVE COAT SCHEDULE

LOCATION	PROTECTIVE COAT AREA
	SQ YD
FACE AND FLAG OF CURB & GUTTER	400
TOTAL	400

SIGN SCHEDULE

LOCATION	LT/RT	PROPOSED OFFSET (FOOT)	SIGN PANEL--TYPE 1 (SQ. FT.)	METAL POST--TYPE B (FOOT)	DESCRIPTION
STA 12+90	RT	17	8.25	13.5	W11-2 & W-16-9p
STA 14+96	RT	17	8.25	13.5	W11-2 & W-16-7p
STA 15+11	LT	23	8.25	13.5	W11-2 & W-16-7p
STA 19+73	RT	17	8.25	13.5	W11-2 & W-16-7p
STA 19+85	LT	23	8.25	13.5	W11-2 & W-16-7p
STA 21+10	LT	23	8.25	13.5	W11-2 & W-16-9p
TOTAL			49.5	81	

EROSION CONTROL SCHEDULE

LOCATION	INLET & PIPE PROTECTION	PERIMETER EROSION BARRIER
	EACH	FOOT
STA. 11+17 TO STA. 23+25	28	
STA. 11+80 TO STA. 15+00, RT.		320
STA. 17+55 TO STA. 18+35, RT.		80
STA. 19+60 TO STA. 20+43, RT.		83
STA. 20+49 TO STA. 20+79, RT.		30
STA. 20+90 TO STA. 21+43, RT.		53
STA. 21+80 TO STA. 22+14, RT.		34
TOTAL	28	600

* INLET & PIPE PROTECTION AT EACH PROPOSED INLET AS DEPICTED ON EROSION CONTROL PLAN.

PCC SIDEWALK SCHEDULE

LOCATION	P.C.C. SIDEWALK, 4"	DETECTABLE WARNINGS
	SQ FT	SQ FT
STA. 11+02 TO 11+42 RT.	230	
STA. 11+16 TO 11+30 LT.	90	
STA. 11+25, LT.		21
STA. 11+25, RT.		10
STA. 11+39, RT.		10
STA. 11+65 TO 11+70 RT.	34	
STA. 11+69, RT.		10
STA. 11+70 TO 13+30 LT.	795	
STA. 11+75, LT.		10
STA. 13+42 TO 14+37 LT.	478	
STA. 14+49 TO 15+27 LT.	463	
STA. 15+06 TO 15+36 RT.	241	
STA. 15+09, LT.		10
STA. 15+09, RT.		10
STA. 15+23, LT.		9
STA. 15+66 TO 16+36 LT.	368	
STA. 16+48 TO 19+20 LT.	1370	
STA. 17+56 TO 23+11 RT.	2850	
STA. 19+15, LT.		10
STA. 19+61 TO 22+65 LT.	1590	
STA. 19+67, LT.		10
STA. 19+78, LT.		10
STA. 19+78, RT.		10
STA. 22+89 TO 23+20 LT.	265	
STA. 23+04, RT.		16
STA. 23+06, LT.		9
STA. 23+62 TO 23+84 LT.	152	
STA. 23+64 TO 23+78 RT.	117	
STA. 23+66, RT.		8
STA. 23+74, RT.		8
STA. 23+75, LT.		8
TOTAL	9,043	179

ADJUSTMENT SCHEDULE

LOCATION	WATER VALVES TO BE ADJUSTED	MANHOLE TO BE ADJUSTED
	EACH	EACH
STA. 11+54, 6' LT.		1
STA. 15+45, 4' LT.		1
STA. 15+57, 20' LT.	1	
STA. 15+64, 17' LT.	1	
STA. 18+30, 6' LT.	1	
STA. 19+44, 1' LT.		1
TOTAL	3	3

NOTE: EXISTING AND PROPOSED ELEVATION SHALL BE OBSERVED IN THE FIELD AND ADJUSTED ACCORDINGLY.

F.A.U. ROUTE	SECTION	COUNTY	TOTAL SHEETS	SHEET NUMBER
9249	14-00021-00-CG	ST. CLAIR	24	6
FEDERAL AID PROJECT		CONTRACT 97592		

STORM SEWER & DRAINAGE STRUCTURE SCHEDULE

PT	LOCATION STATION / OFFSET	DESCRIPTION	RIM	INVERTS
1	11+70.55 40.41'L	INLET SPECIAL, NO. 2	464.21	461.10 W
2	14+99.73 17.00'R	INLET SPECIAL, NO. 3	460.97	458.16 N
3	14+99.99 23.00'L	INLET SPECIAL, NO. 2	461.13	458.50 S 458.60 E
3A	15+14.79 23.11'L	INLETS, TYPE A, TYPE 15 FRAME & LID	462.92	459.01 NE 458.91 W
3B	15+26.15 37.67'L	INLETS, TYPE A, TYPE 15 FRAME & LID	461.35	459.19 SW
4	15+00.02 3.41'R	MANHOLES, TYPE A, 5'-DIA., TYPE 1 FRAME & CLOSED LID	460.82	456.26 E 456.36 W 458.00 N 458.00 S
5	15+50.65 4.08'R	INLET SPECIAL, NO. 1	460.61	455.81 W 455.71 E 457.25 N
6	15+66.48 39.28'L	INLET SPECIAL, NO. 3	461.40	458.80 SE
7	15+81.59 4.59'R	HOLE CAST IN CONCRETE BOX CULVERT	460.46	456.29 N
8	15+82.00 20.08'L	INLETS, TYPE B, TYPE 3 FRAME & GRATE	461.15	458.35 NW 458.25 S
9	18+01.80 22.23'L	INLETS, TYPE A, TYPE 15 FRAME & LID	460.51	457.58 S
10	18+02.08 17.00'R	INLET SPECIAL, NO. 3	460.05	455.50 N
11	18+02.11 4.69'R	INLET, SPECIAL, NO. 1	459.81	454.86 E 454.96 W 455.36 N 455.36 S
12	19+06.88 20.48'L	MANHOLES, TYPE A, 4'-DIA., TYPE 3 FRAME & GRATE	460.52	456.55 NE 456.45 S
13	19+06.90 13.53'R	INLET SPECIAL, NO. 1	460.09	454.56 W 454.46 E 455.50 N
14	19+20.06 39.68'L	MANHOLES, TYPE A, 4'-DIA., TYPE 3 FRAME & GRATE	460.76	457.00 SW 457.50 E 457.10 N
15	19+61.66 38.97'L	INLET SPECIAL, NO. 3	460.79	458.00 W
16	20+24.81 22.23'L	INLETS, TYPE A, TYPE 15 FRAME & LID	460.33	457.50 S
17	20+25.03 13.51'R	FRAME AND GRATE, TYPE 3	459.78	455.12 N
18	21+46.81 22.23'L	INLETS, TYPE A, TYPE 15 FRAME & LID	459.74	457.18 E
19	21+46.86 14.00'R	FRAME AND GRATE, TYPE 3	459.09	
20	21+66.94 21.65'L	INLETS, TYPE B, TYPE 15 FRAME & LID	459.68	456.98 W 456.69 S
21	21+66.94 14.00'R	FRAME AND GRATE, TYPE 3	459.02	454.70 N
22	22+86.38 13.47'R	INLET SPECIAL, NO. 1	459.14	453.34 W 455.83 NE 453.34 SE
23	23+02.46 20.25'L	INLETS, TYPE A, TYPE 23 FRAME & GRATE	459.34*	456.66 SW
24	23+19.85 34.63'L	INLETS, TYPE A, TYPE 23 FRAME & GRATE	459.74*	457.04 E
25	23+78.17 14.10'R	INLETS, TYPE A, TYPE 23 FRAME & GRATE	457.91*	456.00 W

* ELEVATION AT THE EDGE OF PAVEMENT

DRAINAGE REMOVAL SCHEDULE

LOCATION	DESCRIPTION	STORM SEWER REMOVAL, 12"	STORM SEWER REMOVAL, 15"	STORM SEWER REMOVAL, 18"	STORM SEWER REMOVAL, 21"	STORM SEWER REMOVAL, 24"	STORM SEWER REMOVAL, 36"	REMOVE EXISTING STRUCTURE	REMOVING INLETS	REMOVING MANHOLES	TRENCH BACKFILL
		FOOT	FOOT	FOOT	FOOT	FOOT	FOOT	EACH	EACH	EACH	CU YD
STA. 11+33 TO 15+12, RT.	21" RCCP				379						
STA. 11+66, LT.	EXISTING INLET								1		
STA. 15+10 TO 15+15, LT.	12" RCCP	23									
STA. 15+14, RT.	EXISTING MANHOLE									1	0.7
STA. 15+14 TO 15+15, RT.	15" PVC		11								2.0
STA. 15+15, RT.	EXISTING INLET								1		1.6
STA. 15+16, LT.	EXISTING INLET								1		
STA. 15+16 TO 18+95, RT.	36" RCCP					379					48.8
STA. 15+57 TO 15+72, LT.	12" RCCP	29									5.2
STA. 15+71, LT.	EXISTING INLET								1		0.5
STA. 18+96, RT.	EXISTING MANHOLE									1	3.9
STA. 18+96 TO 19+04, RT.	36" RCCP					11					4.4
STA. 19+00 TO 22+90, RT.	3'X3' CONC. BOX							1*			
STA. 19+04, RT.	EXISTING INLET								1		
STA. 19+06 TO 19+18, LT.	12" RCCP	12									1.8
STA. 19+07, LT.	EXISTING INLET								1		
STA. 19+18 TO 19+21, LT.	18" RCCP			28							1.7
STA. 19+19 TO 19+21, LT.	24" RCCP				25						8.0
STA. 19+20, LT.	EXISTING MANHOLE									1	0.7
STA. 19+22 TO 19+62, LT.	12" RCCP	42									5.7
STA. 19+62, LT.	EXISTING INLET								1		0.7
STA. 19+93, RT.	EXISTING INLET								1		
STA. 22+79 TO 22+80, LT.	12" RCCP	31									5.0
STA. 22+80, LT.	EXISTING INLET								1		
STA. 22+80, RT.	EXISTING INLET								1		0.3
STA. 23+23, LT.	EXISTING INLET								1		
STA. 23+74, RT.	EXISTING INLET								1		
TOTAL		137	11	28	379	25	390	1	12	3	91

* REMOVE EXISTING 3'X3' BOX CULVERT (APPROXIMATE LENGTH IS 387 FEET)

STORM SEWER SCHEDULE

PIPE NO.	START PIPE STRUCTURE	END PIPE STRUCTURE	PIPE DESCRIPTION	PIPE SIZE	PIPE LENGTH	UPSTREAM INVERT ELEV.	DOWNSTREAM INVERT ELEV.	PIPE SLOPE	TRENCH BACKFILL
1	ES1	4	Storm Sewers, Class A, Type 1, Rubber Gasket	24"	367'	460.13	456.36	1.03%	64.1
2	1		HDPE Storm Sewer Connection	15"	3'	461.10	461.05	1.69%	0.3
3	2	4	Storm Sewers, Class A, Type 1, Rubber Gasket	15"	9'	458.16	458.00	1.76%	1.1
4	3	4	Storm Sewers, Class A, Type 1, Rubber Gasket	15"	22'	458.50	458.00	2.23%	2.5
4A	3A	3	Storm Sewers (Water Main Requirements)	12"	12'	458.91	458.60	2.55%	1.1
4B	3B	3A	Storm Sewers (Water Main Requirements)	12"	16'	459.19	459.01	1.09%	1.5
5	4	5	Storm Sewers, Class A, Type 1, Rubber Gasket	36"	45'	456.26	456.00	0.58%	16.9
6	6	8	Storm Sewers, Class A, Type 1, Rubber Gasket	12"	20'	458.80	458.35	2.25%	3.3
7	5	11	Precast Concrete Box Culvert, 3'x3' *	3'x3'	245'	455.90	455.09	0.33%	117.0
8	8	7	Storm Sewers, Class A, Type 1, Rubber Gasket	12"	22'	458.25	456.29	9.04%	4.5
9	10	11	Storm Sewers, Class A, Type 1, Rubber Gasket	12"	7'	455.50	455.36	1.91%	1.7
10	9	11	Storm Sewers, Class A, Type 1, Rubber Gasket	12"	23'	457.58	455.36	9.69%	5.2
11	11	13	Precast Concrete Box Culvert, 3'x3' *	3'x3'	99'	454.99	454.66	0.33%	67.0
12	13	22	Precast Concrete Box Culvert, 3'x3' *	3'x3'	373'	454.56	453.34	0.33%	157.0
13	12	13	Storm Sewers, Class A, Type 1, Rubber Gasket	24"	29'	456.45	455.50	3.27%	7.4
14	14	12	Storm Sewers, Class A, Type 1, Rubber Gasket	24"	18'	457.00	456.55	2.48%	3.5
15	15	14	Storm Sewers, Class A, Type 1, Rubber Gasket	12"	37'	458.00	457.50	1.35%	6.2
16	16	17	Storm Sewers, Class A, Type 1, Rubber Gasket	12"	34'	457.50	455.12	7.05%	7.8
17	18	20'	Storm Sewers (Water Main Requirements)	12"	18'	457.18	456.98	1.13%	2.2
18	20	21	Storm Sewers, Class A, Type 1, Rubber Gasket	12"	33'	456.69	454.70	6.00%	6.9
19	23	22	Storm Sewers, Class A, Type 1, Rubber Gasket	12"	33'	456.66	455.83	2.52%	4.9
20	24	EP11	Storm Sewers, Class A, Type 1, Rubber Gasket	12"	3'	457.04	456.99	1.52%	0.5
21	25	EP12	Storm Sewers, Class A, Type 1, Rubber Gasket	12"	4'	455.52	455.47	1.15%	0.5
TOTAL									483

* ASTM C 1577, 3'X3' BOX CULVERT > 30' < 5' FILL

MISCELLANEOUS REMOVAL SCHEDULE

LOCATION	PAVEMENT REMOVAL SQ. YD.	COMBINATION CURB AND GUTTER REMOVAL FOOT	CONCRETE STEP REMOVAL EACH	GUARDRAIL REMOVAL FOOT	SIDEWALK REMOVAL SQ. FT.
STA. 11+02 TO 11+26, RT.					64
STA. 11+16 TO 11+30, LT.					90
STA. 11+20 TO 11+33, LT.		21			
STA. 11+21 TO 11+30, RT.		9			
STA. 11+39 TO 11+43, RT.		10			
STA. 11+57 TO 14+38, LT.					1076
STA. 11+62 TO 15+33, RT.		379			
STA. 11+65 TO 15+30, LT.		395			
STA. 14+48 TO 15+26, LT.					363
STA. 15+13 TO 15+36, RT.		189			
STA. 15+63 TO 19+25, LT.		397			
STA. 15+66 TO 19+21, LT.					1184
STA. 17+56 TO 23+21, RT.					2526
STA. 17+68 TO 23+25, RT.		609			
STA. 19+58 TO 23+25, LT.		403			
STA. 19+62 TO 22+33, LT.					1163
STA. 20+84, LT.			1		
STA. 21+01, LT.			1		
STA. 21+76, LT.			1		
STA. 22+45 TO 22+63, LT.					69
STA. 23+05 TO 23+20, LT.					152
STA. 23+06 TO 23+25, C.	81				
STA. 23+25, LT.					87.5
STA. 23+60 TO 23+62, LT.					
STA. 23+63 TO 23+84, LT.					171
STA. 23+64 TO 23+77, RT.					107
STA. 23+70 TO 23+83, LT.					
TOTAL	81	2,434	3	87.5	6,965

TRENCH BACKFILL SCHEDULE

LOCATION	TRENCH BACKFILL CU YD
DRAINAGE REMOVAL SCHEDULE	91.0
STORM SEWER SCHEDULE	483.0
TOTAL	574.0

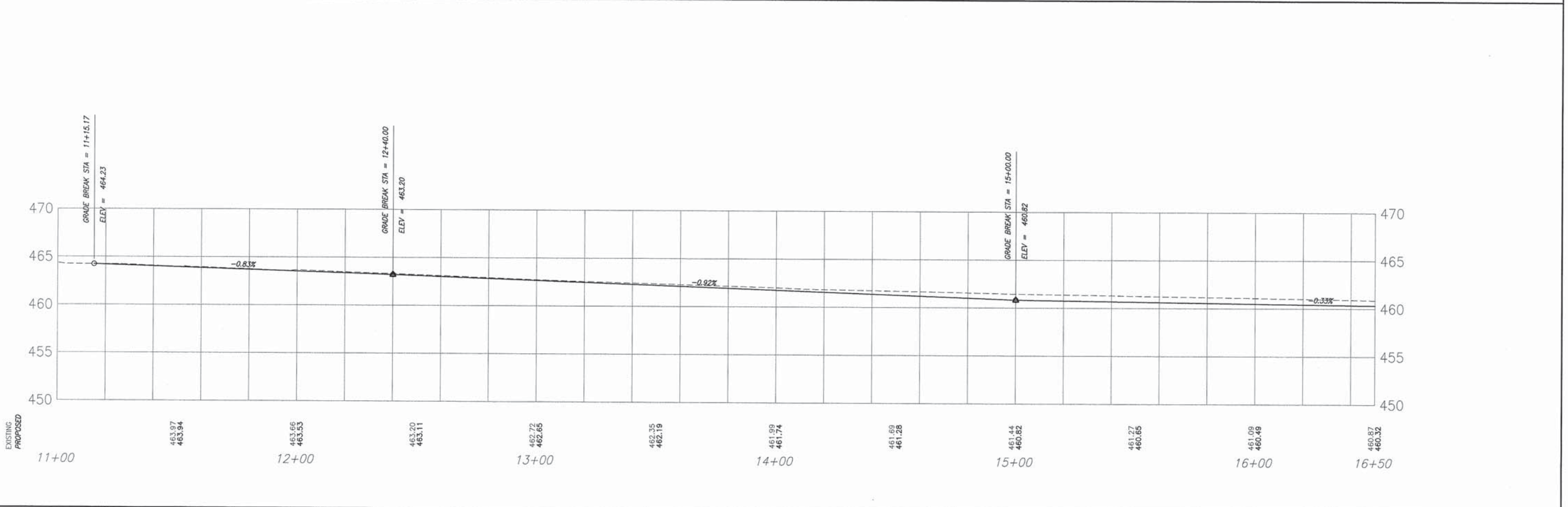
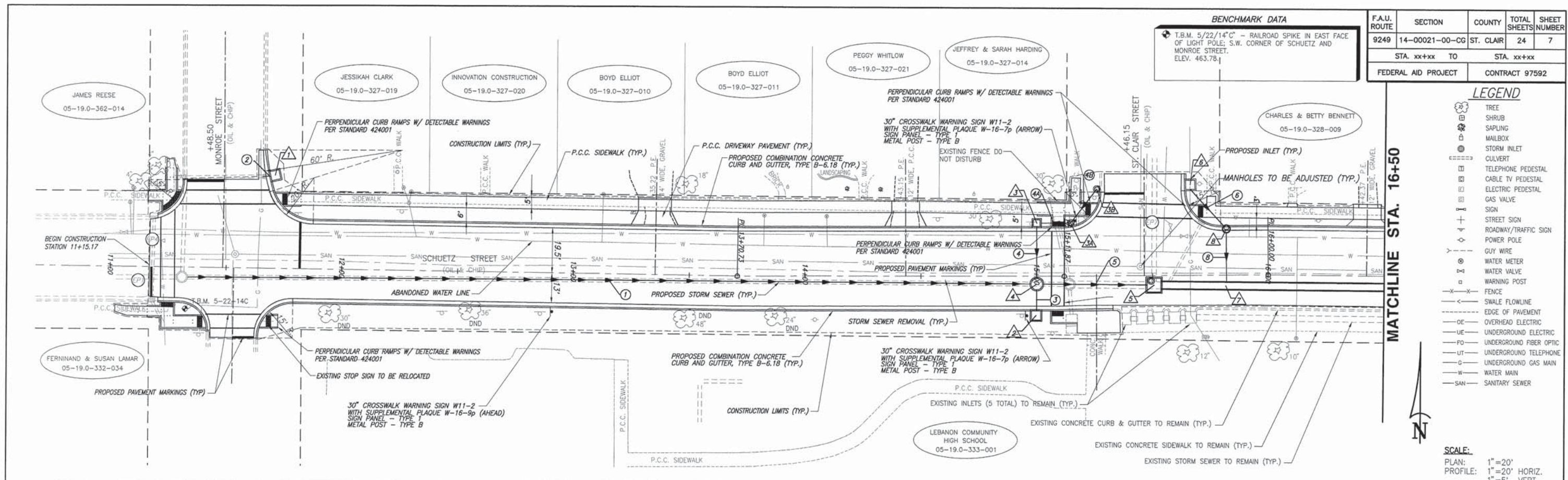

F.A.U. ROUTE	SECTION	COUNTY	TOTAL SHEETS/NUMBER	SHEET NUMBER
8249	14-00021-00-CG	ST. CLAIR	24	8
FEDERAL AID PROJECT		CONTRACT 97592		

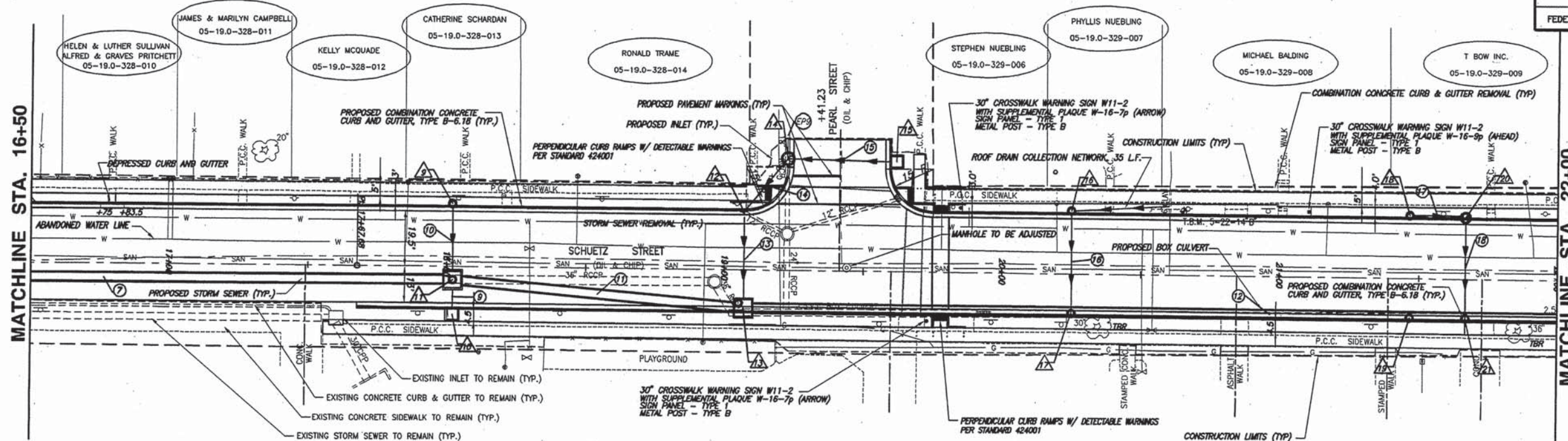

- LEGEND**
- TREE
 - SHRUB
 - SAPLING
 - MAILBOX
 - STORM INLET
 - CULVERT
 - TELEPHONE PEDESTAL
 - CABLE TV PEDESTAL
 - ELECTRIC PEDESTAL
 - GAS VALVE
 - SIGN
 - STREET SIGN
 - ROADWAY/TRAFFIC SIGN
 - POWER POLE
 - GUY WIRE
 - WATER METER
 - WATER VALVE
 - WARNING POST
 - FENCE
 - SWALE FLOWLINE
 - EDGE OF PAVEMENT
 - OVERHEAD ELECTRIC
 - UNDERGROUND ELECTRIC
 - UNDERGROUND FIBER OPTIC
 - UNDERGROUND TELEPHONE
 - UNDERGROUND GAS MAIN
 - WATER MAIN
 - SANITARY SEWER

BENCHMARK DATA

⊕ T.B.M. 5-22-14 "B" - RAILROAD SPIKE IN SOUTH FACE OF POWER POLE; NORTH SIDE SCHUETZ, 1ST POLE EAST OF PEARL. ELEV. 461.03

SCALE:
 PLAN: 1" = 20'
 PROFILE: 1" = 20' HORIZ.
 1" = 5' VERT.

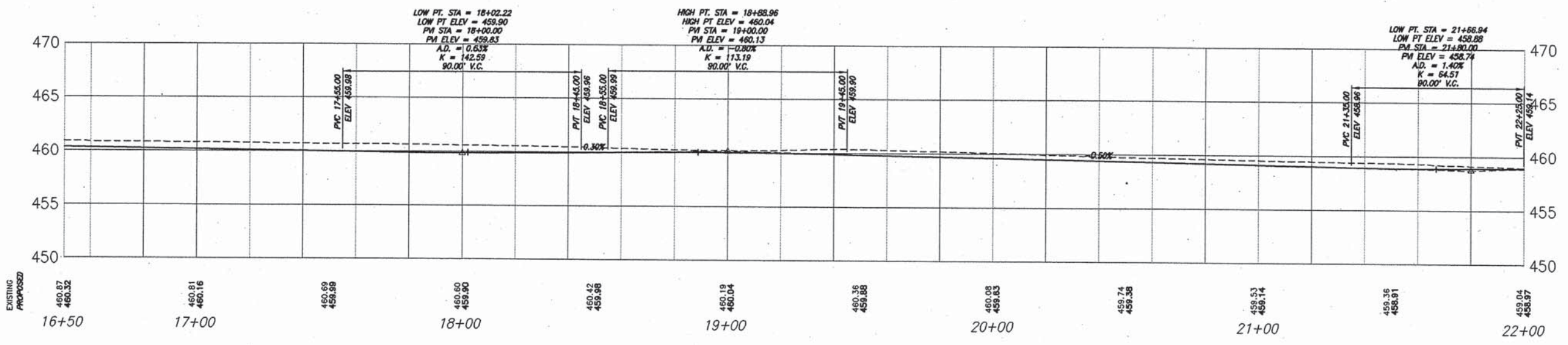

F.A.U. ROUTE	SECTION	COUNTY	TOTAL SHEETS	SHEET NUMBER
9249	14-00021-00-CG	ST. CLAIR	24	9
STA. xx+xx TO		STA. xx+xx		
FEDERAL AID PROJECT		CONTRACT 97592		

LEGEND

- TREE
- SHRUB
- SAPLING
- MAILBOX
- STORM INLET
- CULVERT
- TELEPHONE PEDESTAL
- CABLE TV PEDESTAL
- ELECTRIC PEDESTAL
- GAS VALVE
- SIGN
- STREET SIGN
- ROADWAY/TRAFFIC SIGN
- POWER POLE
- GUY WIRE
- WATER METER
- WATER VALVE
- WARNING POST
- FENCE
- SWALE FLOWLINE
- EDGE OF PAVEMENT
- OVERHEAD ELECTRIC
- UNDERGROUND ELECTRIC
- UNDERGROUND FIBER OPTIC
- UNDERGROUND TELEPHONE
- UNDERGROUND GAS MAIN
- WATER MAIN
- SANITARY SEWER

SCALE:
 PLAN: 1" = 20'
 PROFILE: 1" = 20' HORIZ.
 1" = 5' VERT.

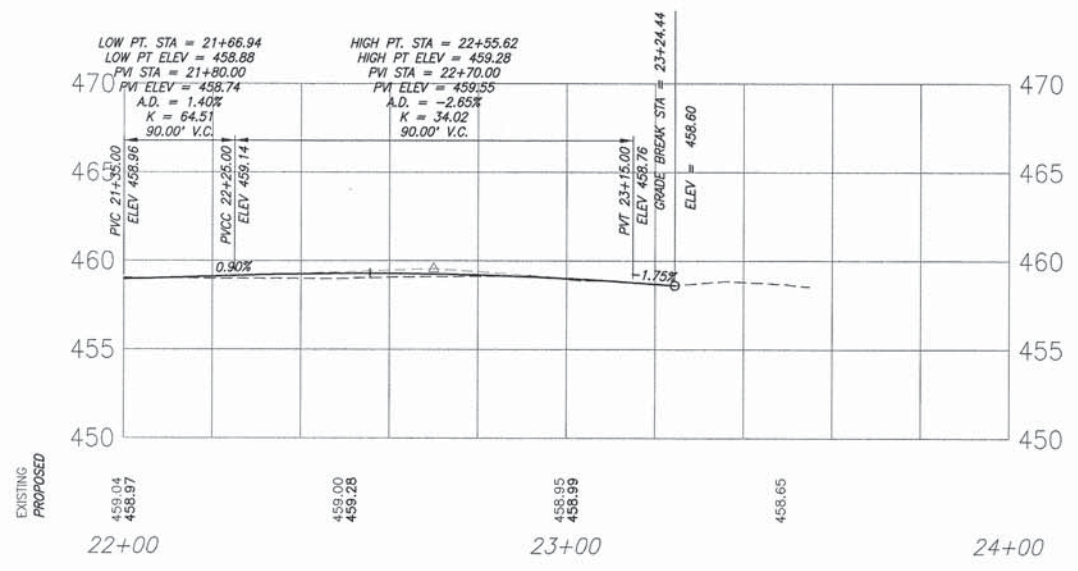
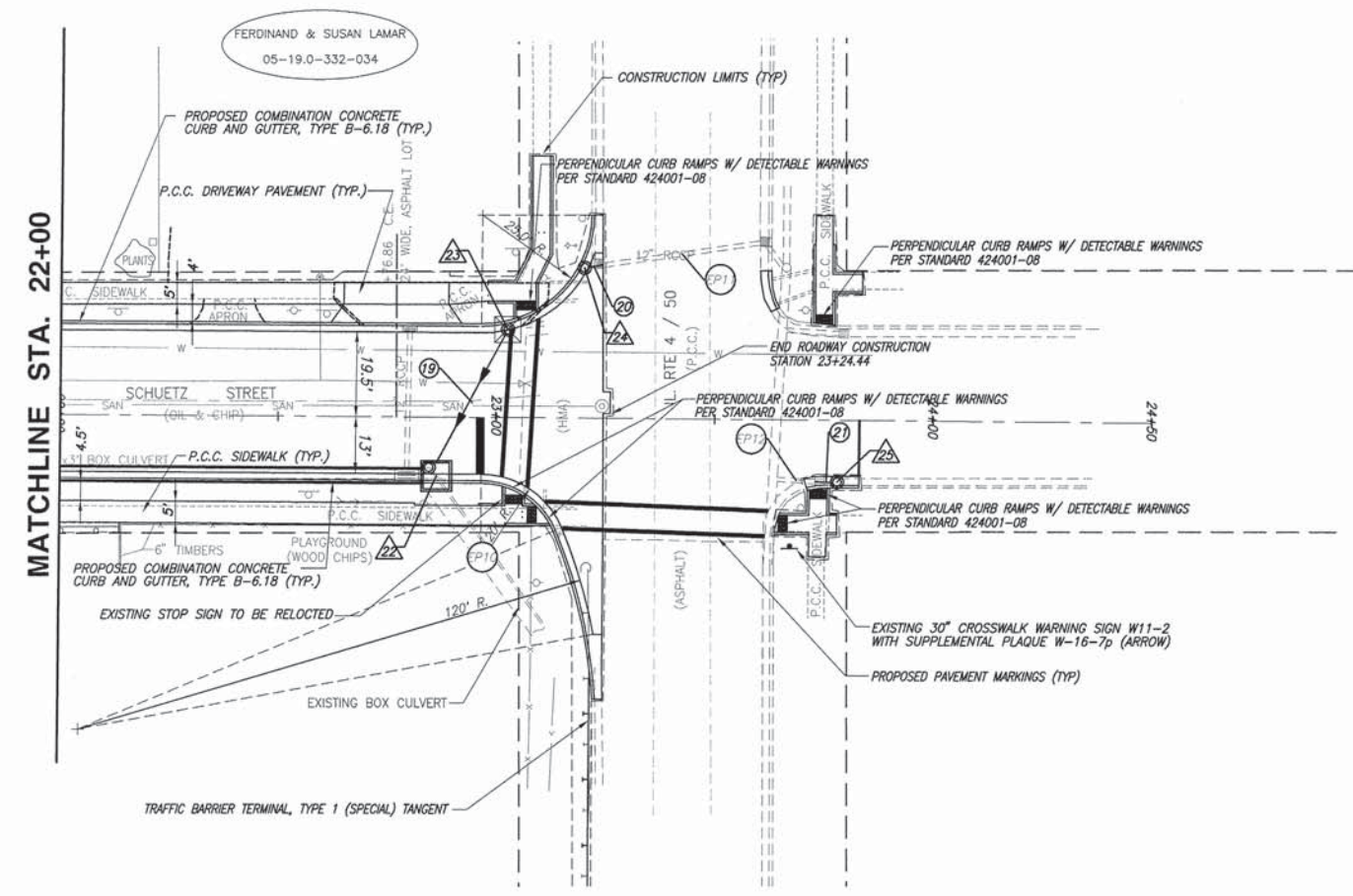

E:\0917\J_Harris_Schuetz_Straight\0917_Schuetz_Straight.dwg, 3/11/2015 8:30:30 AM, Plotter by VDI

F.A.U. ROUTE	SECTION	COUNTY	TOTAL SHEETS	SHEET NUMBER
9249	14-00021-00-CG	ST. CLAIR	24	10
FEDERAL AID PROJECT			CONTRACT 97592	



NOT TO SCALE

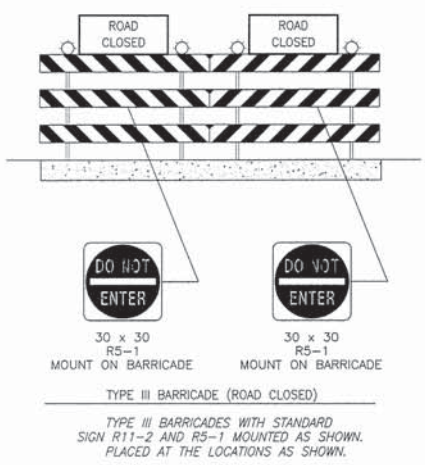

MAINTENANCE OF TRAFFIC & GENERAL NOTES

GENERAL
 THE CONTRACTOR SHALL USE TYPE III BARRICADES WITH FLASHING LIGHTS AND SIGNS "ROAD CLOSED" (R11-2) AT ALL CLOSURE POINTS. "ROAD CONSTRUCTION AHEAD" (W20-1(0)) AND "ROAD CLOSED AHEAD" (W20-3(0)) WARNING SIGNS WITH FLASHING LIGHTS SHALL BE PLACED IN CONFORMANCE WITH STANDARD BLR 22-6 AND AS DIRECTED BY THE ENGINEER TO ACCOMMODATE FIELD CONDITIONS.

PAYMENT
 ALL WORK DESCRIBED HEREIN SHALL BE INCLUDED IN THE CONTRACT LUMP SUM PRICE FOR TRAFFIC CONTROL AND PROTECTION, (SPECIAL).

NOTES:
 IF AT ANY TIME SIGNS ARE IN PLACE BUT ARE NOT APPLICABLE, THEY SHALL BE TURNED FROM THE VIEW OF THE MOTORISTS OR COVERED AS DIRECTED BY THE ENGINEER.

AREA OF IMPROVEMENTS - [Hatched Box]

ADVANCED WARNING SIGN DETAILS

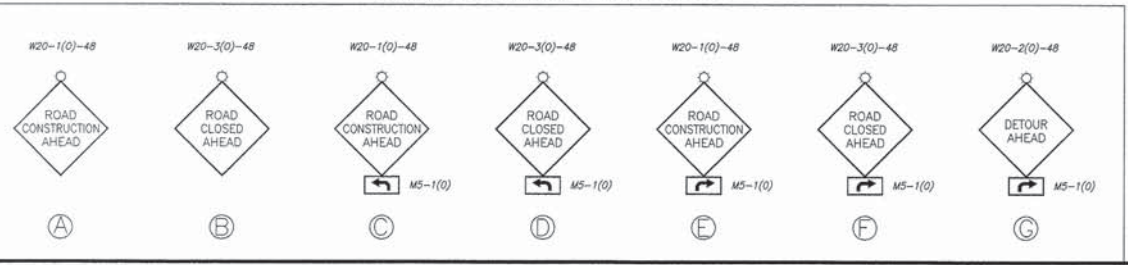

I:\19814_Lebanon_13\Drawings\13_00021_Signs\13_00021_Signs.dwg, 3/11/2014, 8:03:34 AM, P:\19814_Lebanon_13

F.A.U. ROUTE	SECTION	COUNTY	TOTAL SHEETS	SHEET NUMBER
9249	14-00021-00-CG	ST. CLAIR	24	11
STA. xx+xx TO		STA. xx+xx		
FEDERAL AID PROJECT		CONTRACT 97592		

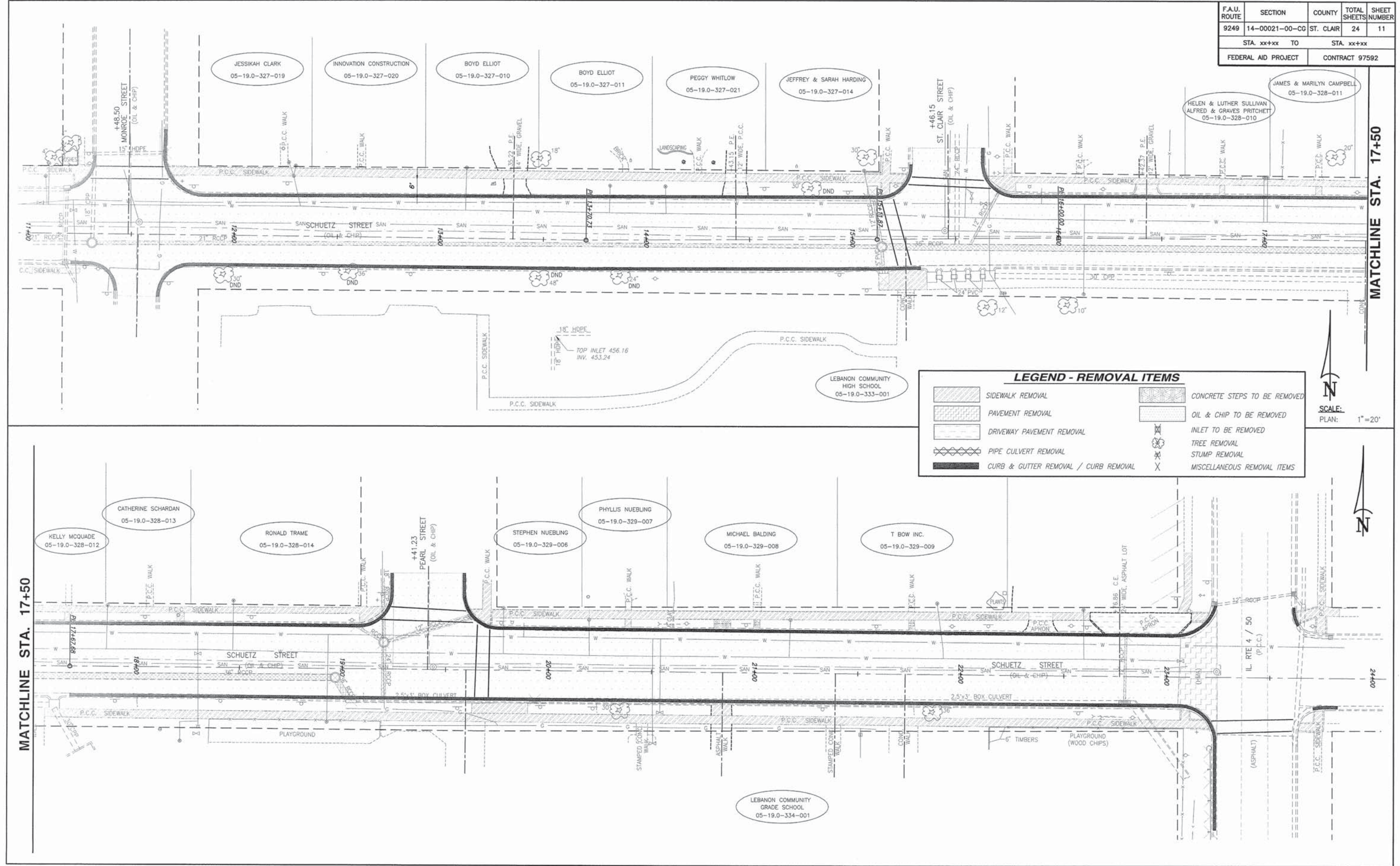

LEGEND - REMOVAL ITEMS

	SIDEWALK REMOVAL		CONCRETE STEPS TO BE REMOVED
	PAVEMENT REMOVAL		OIL & CHIP TO BE REMOVED
	DRIVEWAY PAVEMENT REMOVAL		INLET TO BE REMOVED
	PIPE CULVERT REMOVAL		TREE REMOVAL
	CURB & GUTTER REMOVAL / CURB REMOVAL		STUMP REMOVAL
			MISCELLANEOUS REMOVAL ITEMS

SCALE:
PLAN: 1"=20'

MATCHLINE STA. 17+50

MATCHLINE STA. 17+50

REMOVAL PLAN SCHUETZ STREET IMPROVEMENTS
SECTION 14-00021-00-CG LEBANON, ILLINOIS

P:\2014\14-00021-00-CG\14-00021-00-CG.dwg
 1/11/2015 10:32:54 AM
 P:\2014\14-00021-00-CG\14-00021-00-CG.dwg
 1/11/2015 10:32:54 AM
 P:\2014\14-00021-00-CG\14-00021-00-CG.dwg
 1/11/2015 10:32:54 AM

F.A.U. ROUTE	SECTION	COUNTY	TOTAL SHEETS	SHEET NUMBER
9249	14-00021-00-CG	ST. CLAIR	24	12
FEDERAL AID PROJECT		CONTRACT 97592		

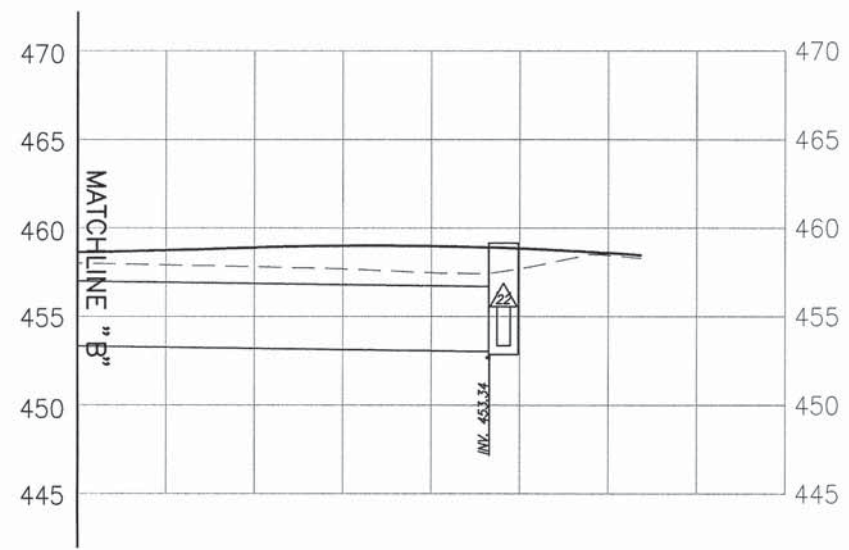
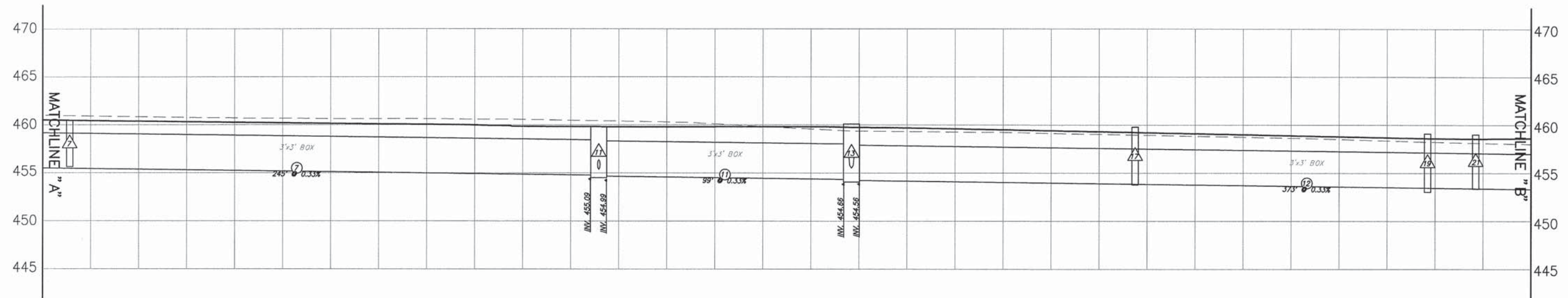
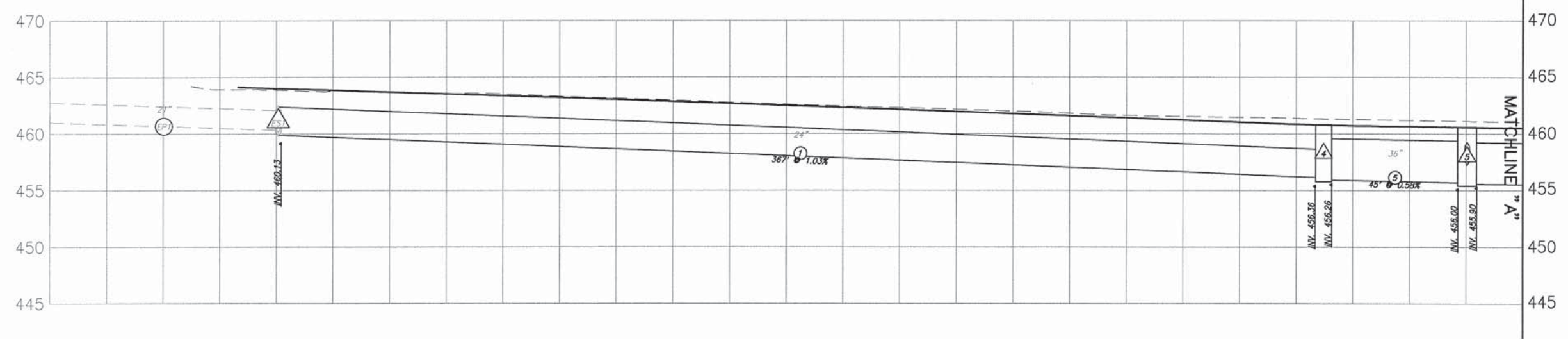

K:\13084-01\Drawings_Schuetz\Sheet\14-00021-00-CG.dwg, 3/11/2015, 8:10 AM, Plot by: MW

F.A.U. ROUTE	SECTION	COUNTY	TOTAL SHEETS	SHEET NUMBER
9249	14-00021-00-CG	ST. CLAIR	24	13
FEDERAL AID PROJECT		CONTRACT 97592		

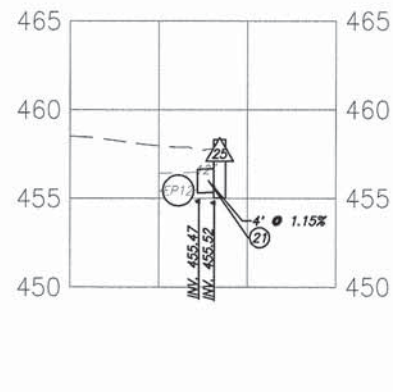
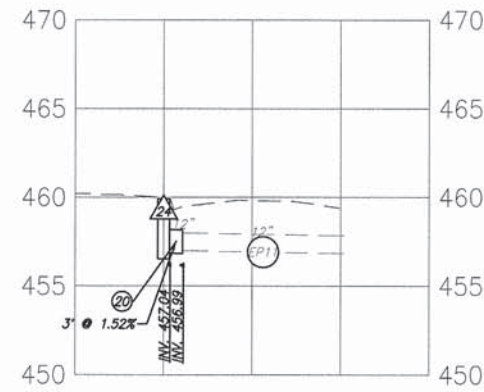
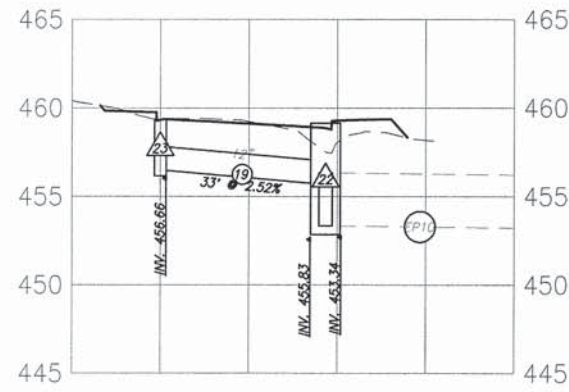
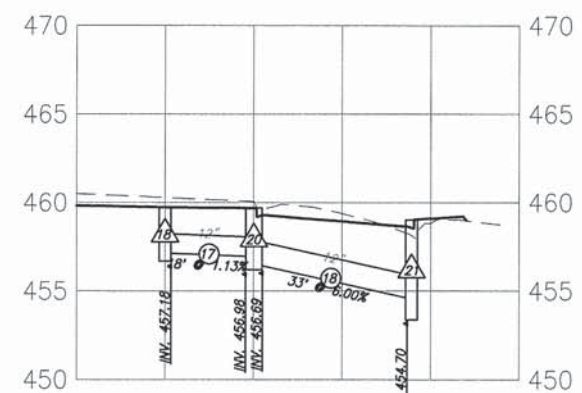
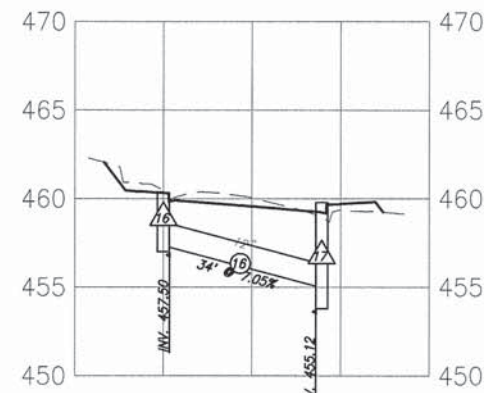
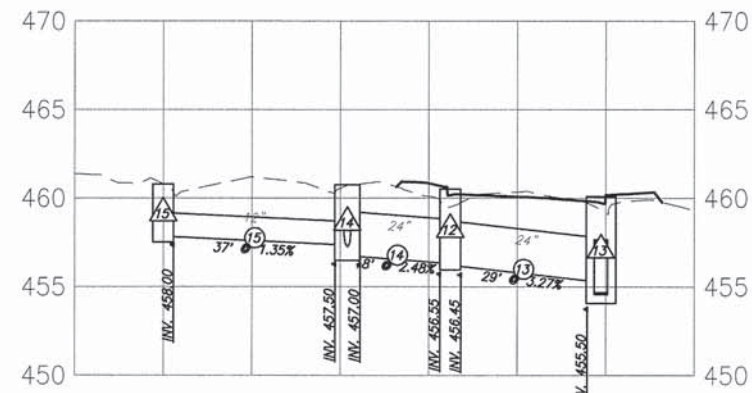
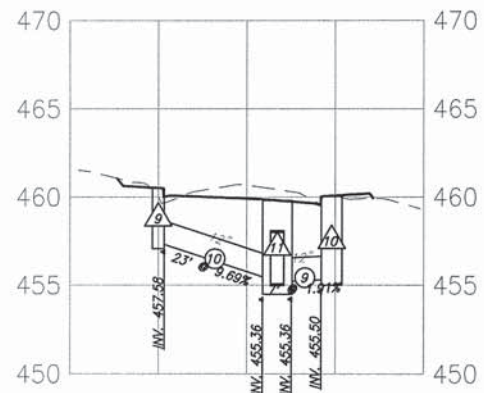
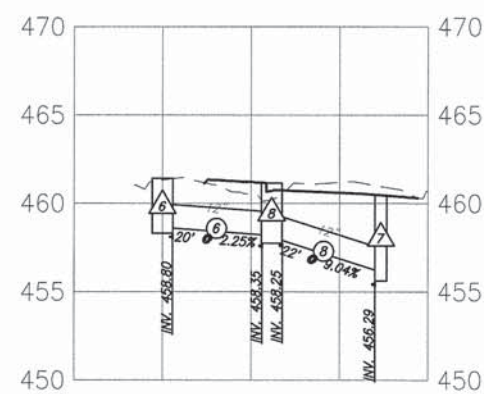
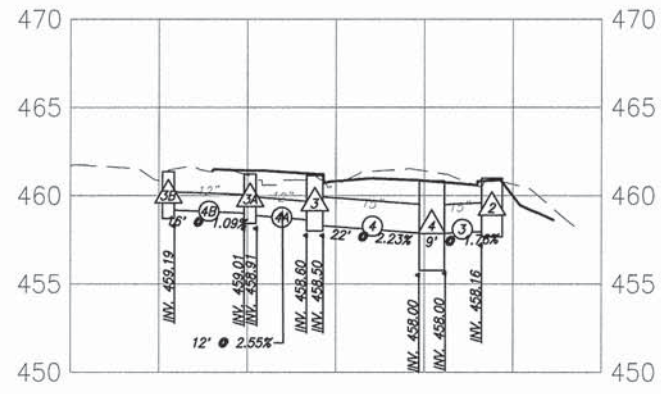
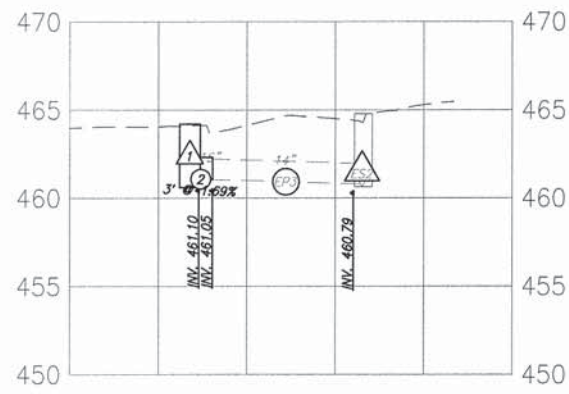

FAU. ROUTE	SECTION	COUNTY	TOTAL SHEETS	SHEET NUMBER
9249	14-00021-00-CG	ST. CLAIR	24	14
FEDERAL AID PROJECT			CONTRACT 97592	

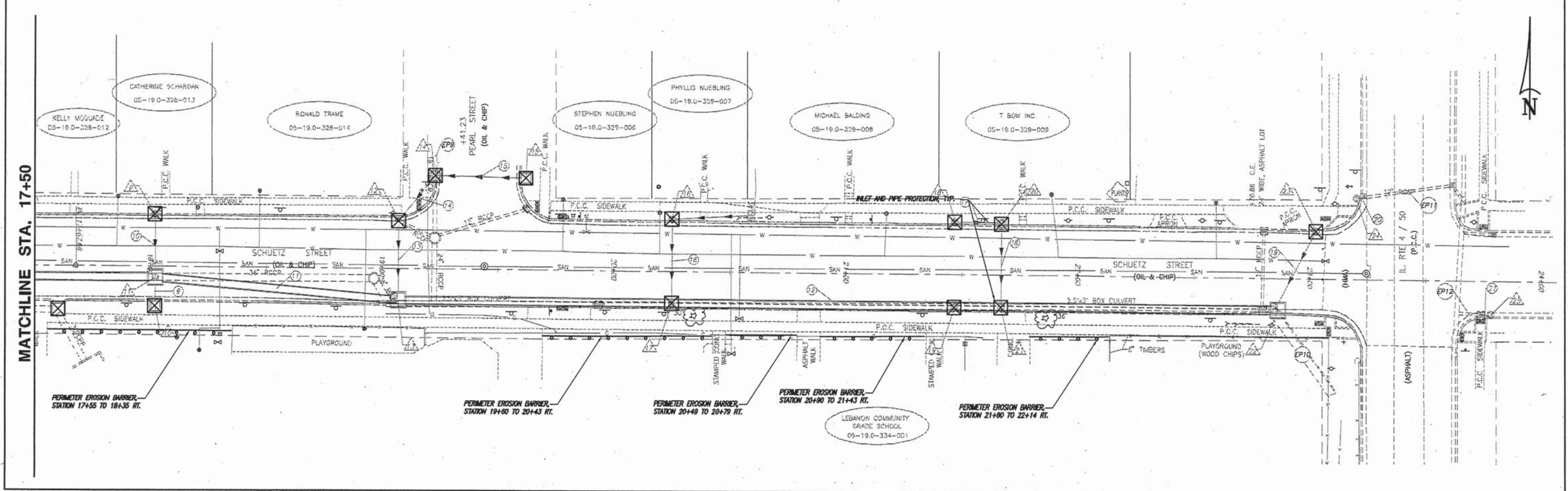
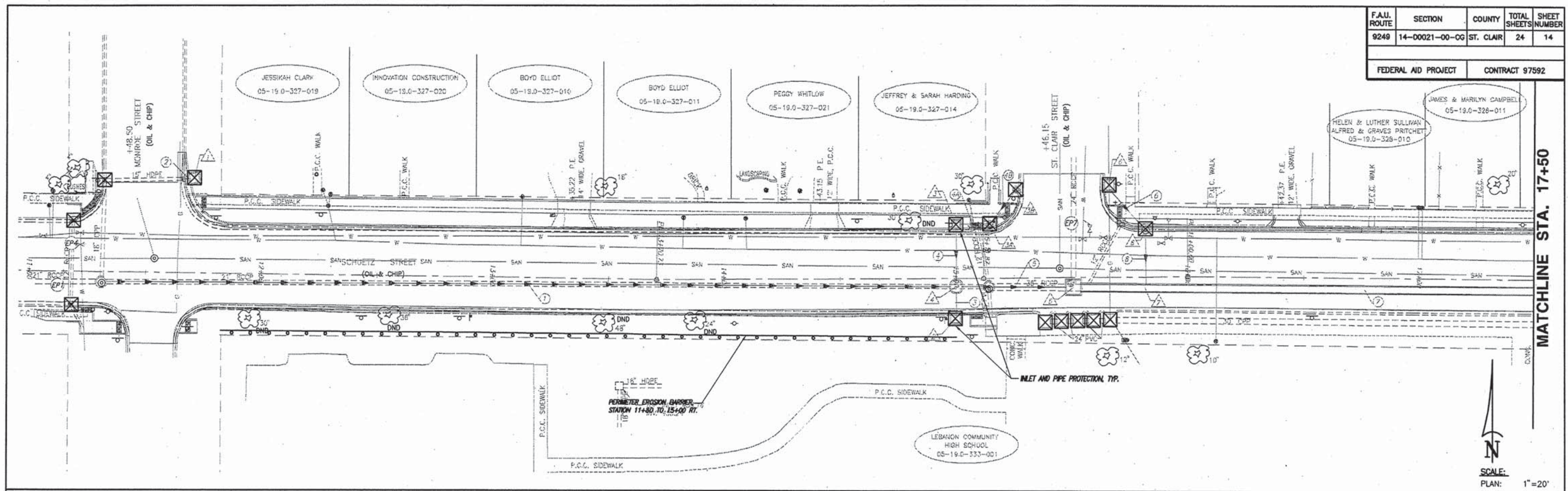

EROSION CONTROL PLAN SCHUETZ STREET IMPROVEMENTS
SECTION 14-00021-00-CG LEBANON, ILLINOIS

F.A.U. ROUTE	SECTION	COUNTY	TOTAL SHEETS	SHEET NUMBER
9249	14-00021-00-CG	ST. CLAIR	24	16
FEDERAL AID PROJECT			CONTRACT 97592	

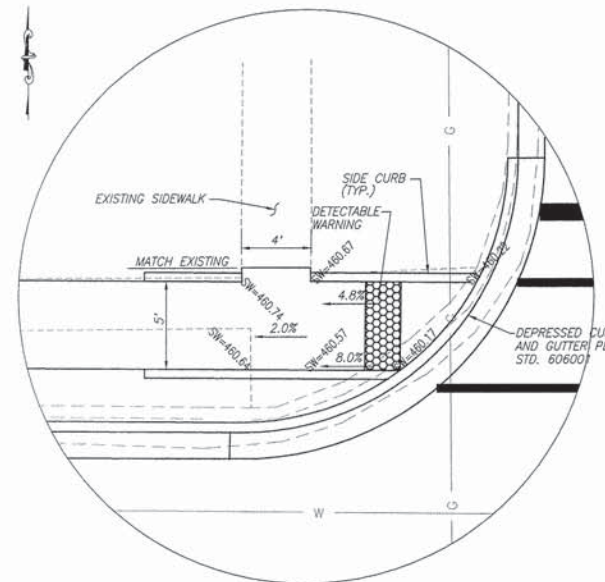

**NORTHWEST CORNER -
SCHUETZ STREET & PEARL STREET**
SCALE: 1"=5'

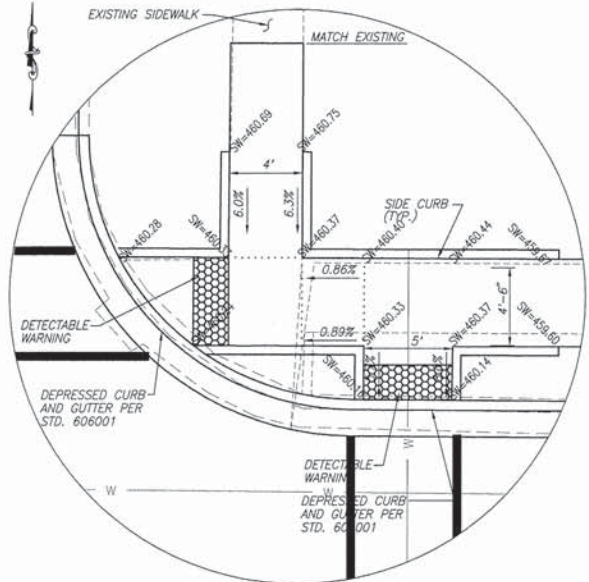

**NORTHEAST CORNER -
SCHUETZ STREET & PEARL STREET**
SCALE: 1"=5'

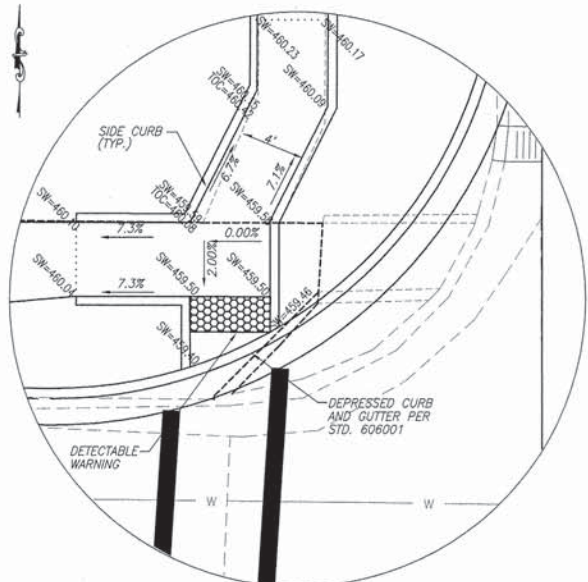

**NORTHWEST CORNER -
SCHUETZ STREET & IL. ROUTE 4**
SCALE: 1"=5'

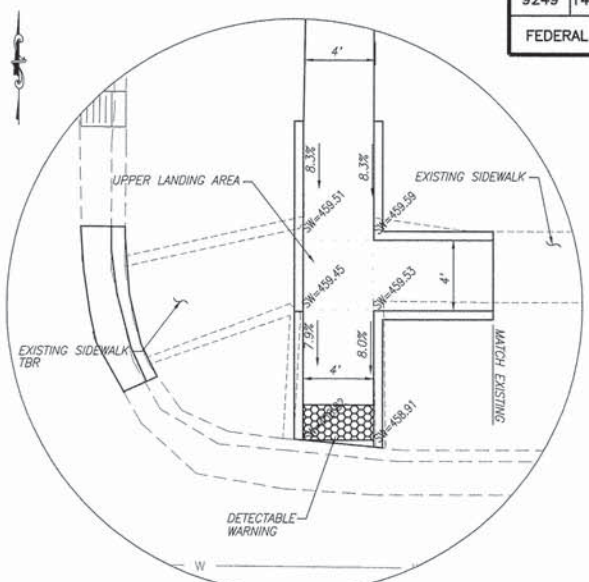

**NORTHEAST CORNER -
SCHUETZ STREET & IL. ROUTE 4**
SCALE: 1"=5'

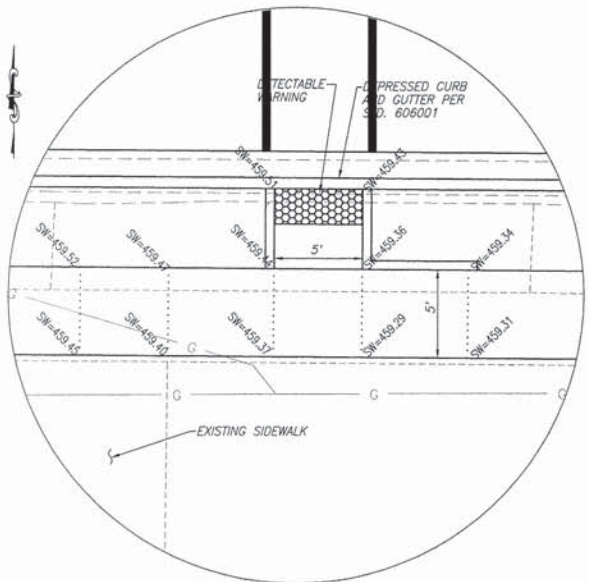

**SOUTH SIDE SCHUETZ STREET -
SCHUETZ & PEARL STREET INTERSECTION**
SCALE: 1"=5'

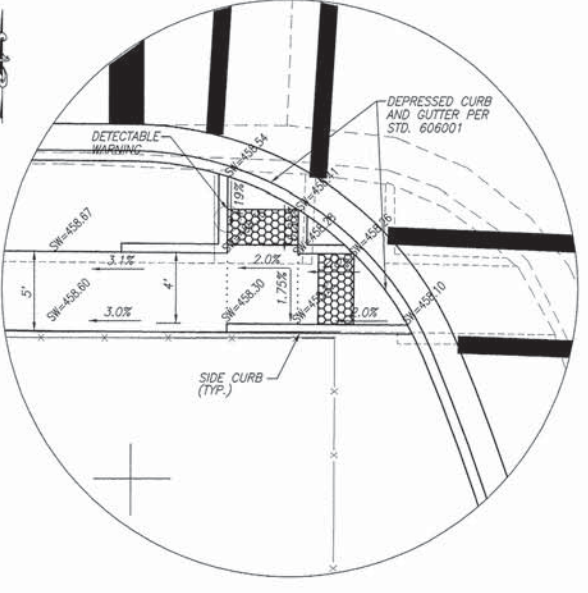

**SOUTHWEST CORNER -
SCHUETZ STREET & IL. ROUTE 4**
SCALE: 1"=5'

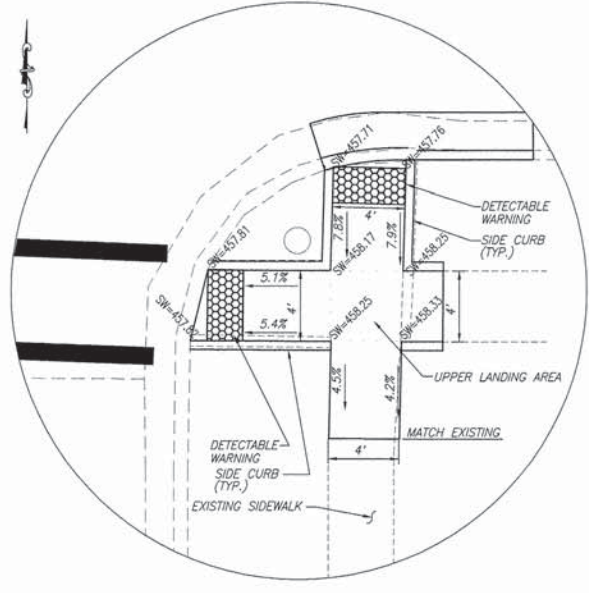

**SOUTHEAST CORNER -
SCHUETZ STREET & IL. ROUTE 4**
SCALE: 1"=5'

P:\V0872\Drawings\Drawings\14-00021-00-CG\14-00021-00-CG-16.dwg, 11/12/2015 12:13:40, Plotted by: kls

F.A.U. ROUTE	SECTION	COUNTY	TOTAL SHEETS	SHEET NUMBER
9249	14-00021-00-CG	ST. CLAIR	24	17
FEDERAL AID PROJECT			CONTRACT 97592	

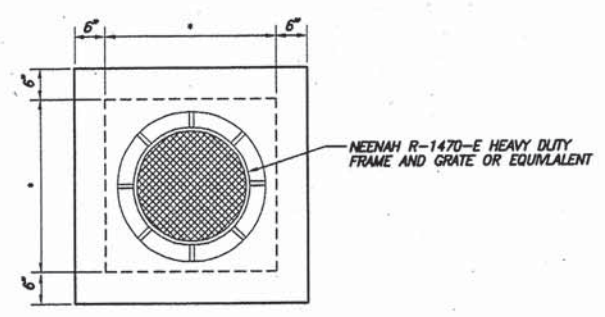

PRECAST LID DETAIL

INLET TYPE	INSIDE WIDTH
INLETS, SPECIAL NO. 1	6' X 6'

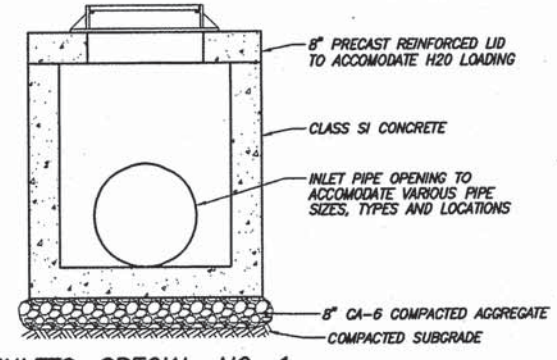

INLETS, SPECIAL, NO. 1
N.T.S.

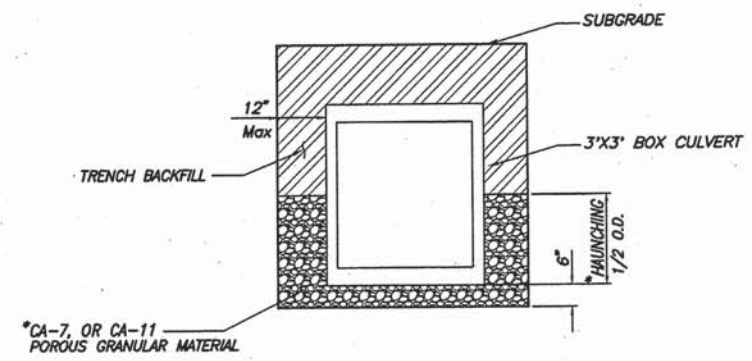

BOX CULVERT TRENCH DETAIL
N.T.S.

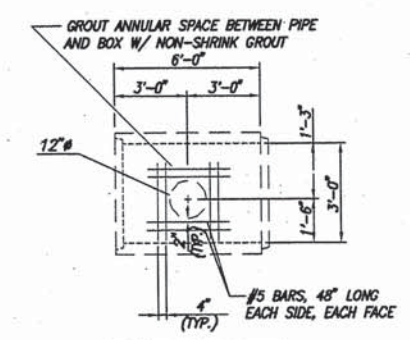

STORM SEWER CONNECTION DETAIL
N.T.S.

NOTE: THE REINFORCEMENT WILL BE THE SAME DESIGN AS THE TYP. BOX CULVERT SECTIONS WITH THE ADDITION OF THE REBAR AROUND THE HOLE.

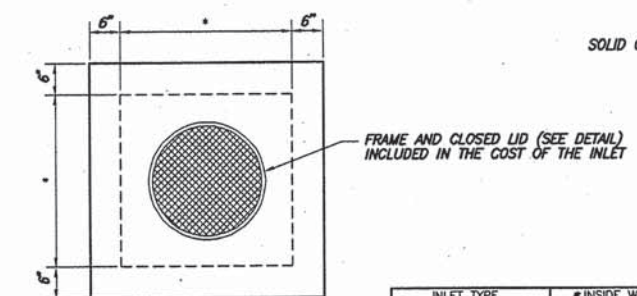

PRECAST LID DETAIL

INLET TYPE	INSIDE WIDTH
INLETS, SPECIAL NO. 2	3' X 3'
INLETS, SPECIAL NO. 3	4' X 4'

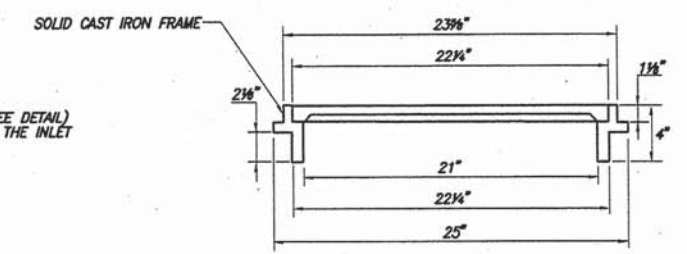

FRAME AND CLOSED LID

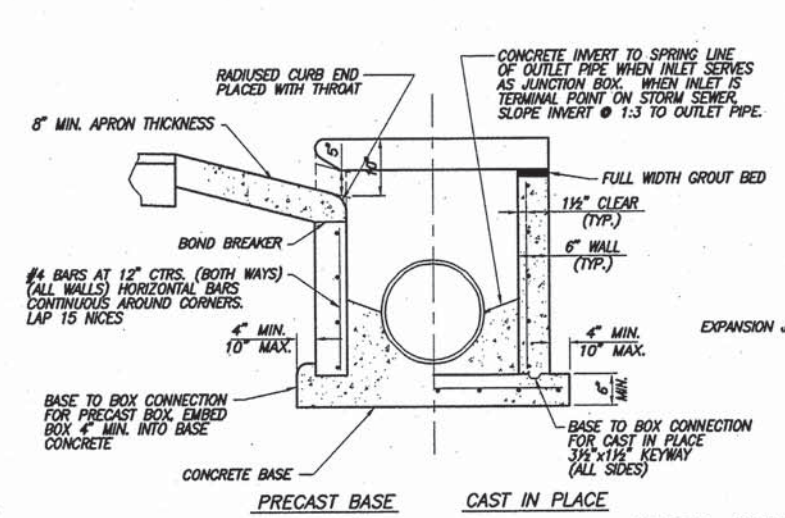

END VIEW

INLETS, SPECIAL, NO. 2, & 3
N.T.S.

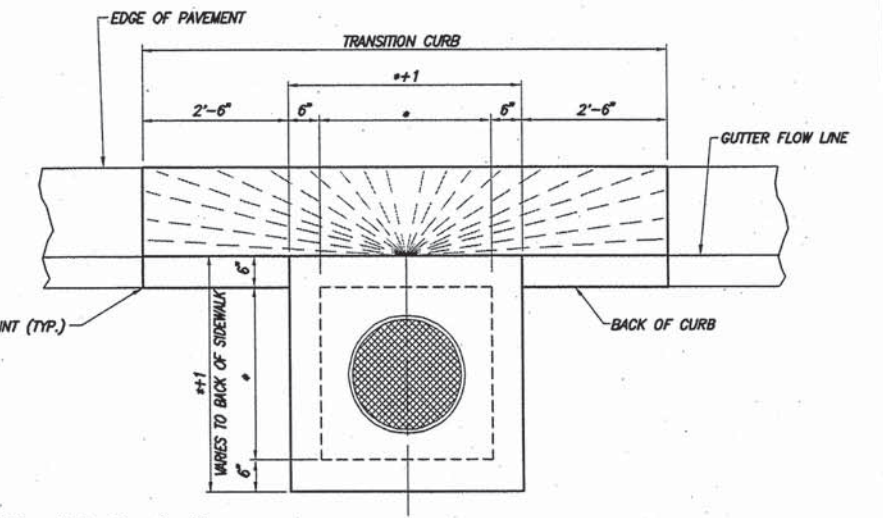

PLAN

F.A.U. ROUTE	SECTION	COUNTY	TOTAL SHEETS	SHEET NUMBER
9249	14-00021-00-CG	ST. CLAIR	24	18
FEDERAL AID PROJECT		CONTRACT 97592		

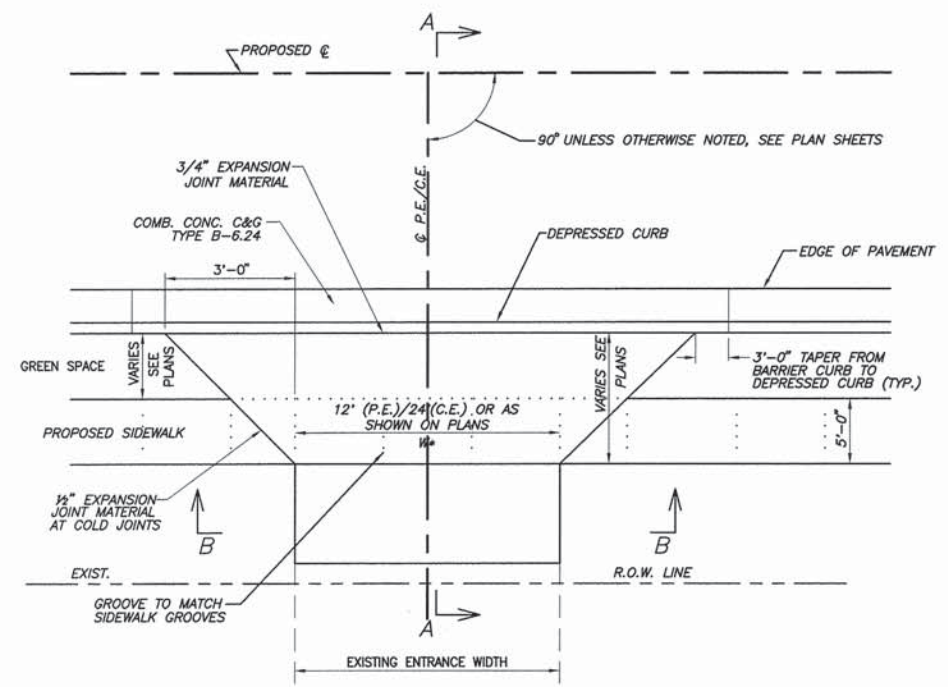

P.E. DETAIL "A"
 PRIVATE/COMMERCIAL ENTRANCE WITH SIDEWALK
 AND CONCRETE CURB &
 GUTTER TYPE B-6.18
 N.T.S.

EXISTING MATERIAL	NEW ENTRANCE MATERIAL (BEYOND SIDEWALK)			
	PCC DRIVEWAY PAVEMENT	INCIDENTAL ASPHALT SURFACING	HOT-MIX AGGREGATE BASE COURSE, TYPE B,	AGGREGATE SURFACE COURSE, TYPE B,
CONCRETE	X			
ASPHALT		X	X	
AGGREGATE				X

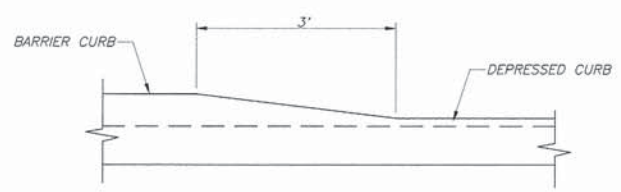

DETAIL OF CURB HEIGHT TRANSITION
 N.T.S.

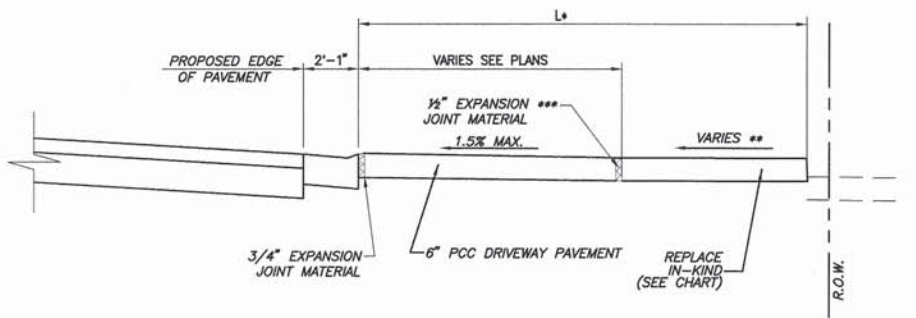

SECTION "A-A"

- * SEE ENTRANCE SCHEDULE FOR DISTANCES
- ** SEE CROSS SECTIONS FOR SLOPES
- *** EXPANSION REQUIRED ADJACENT TO CONCRETE PAVEMENT

F.A.U. ROUTE	SECTION	COUNTY	TOTAL SHEETS	SHEET NUMBER
9249	14-00021-00-CG	ST. CLAIR	24	19
FEDERAL AID PROJECT		CONTRACT 97592		

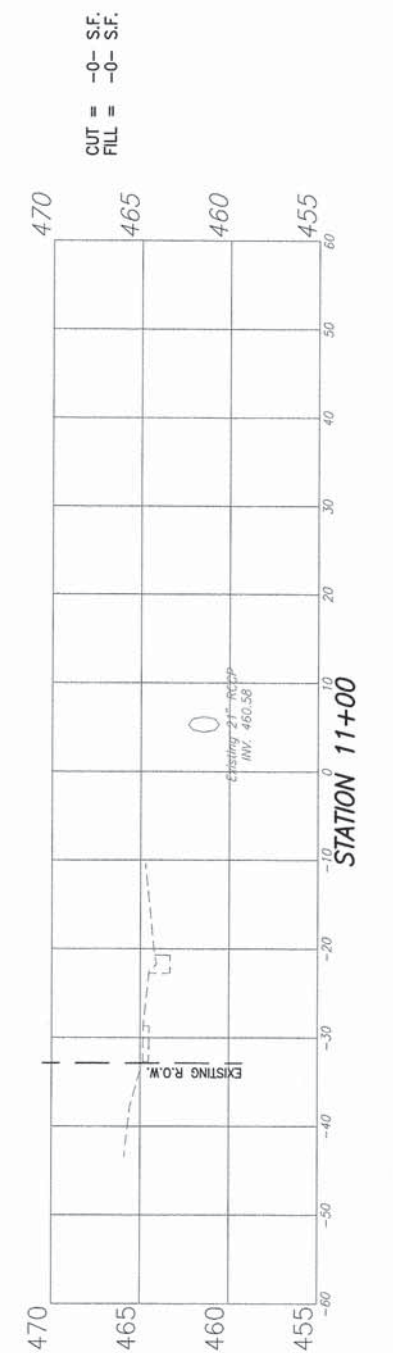
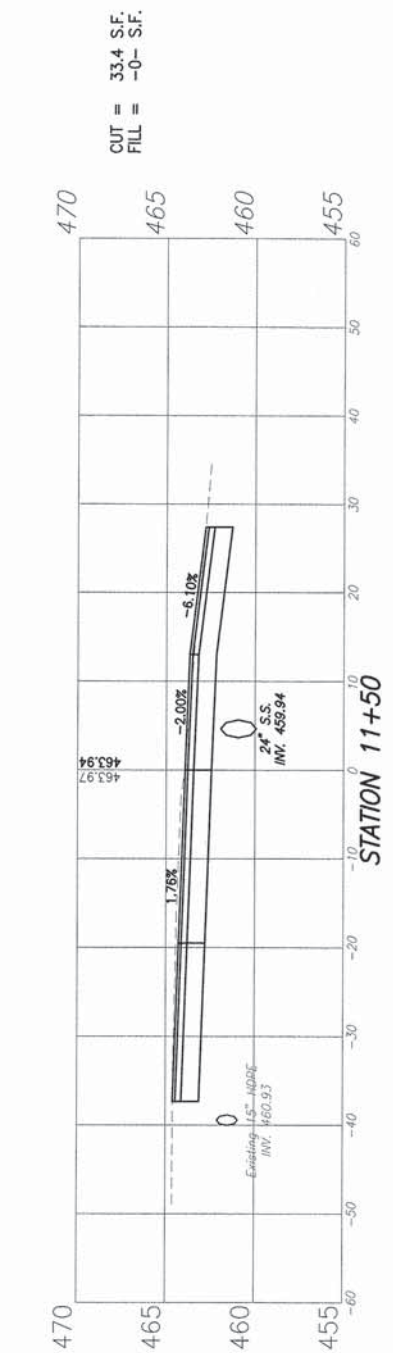
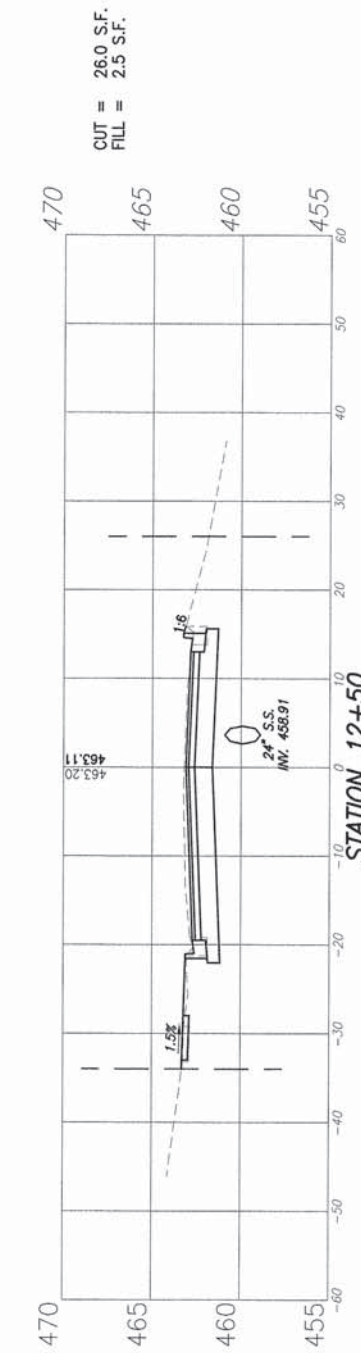
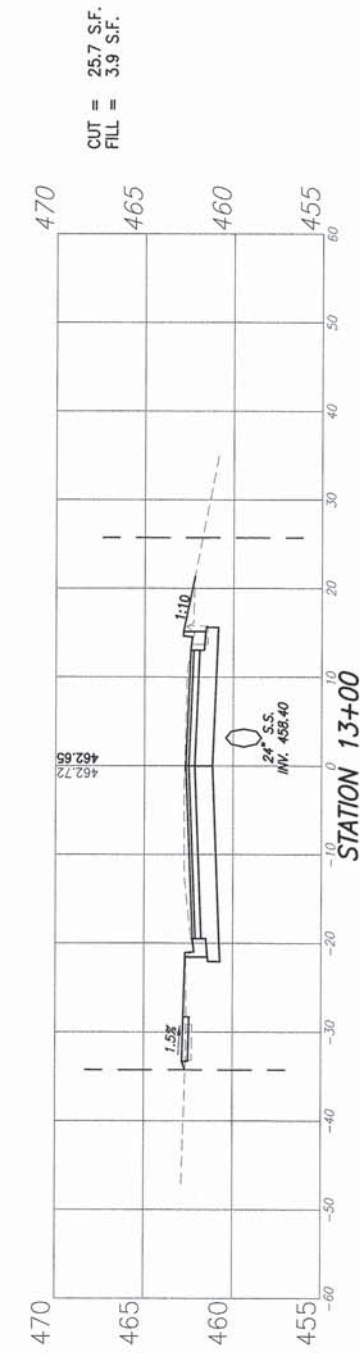
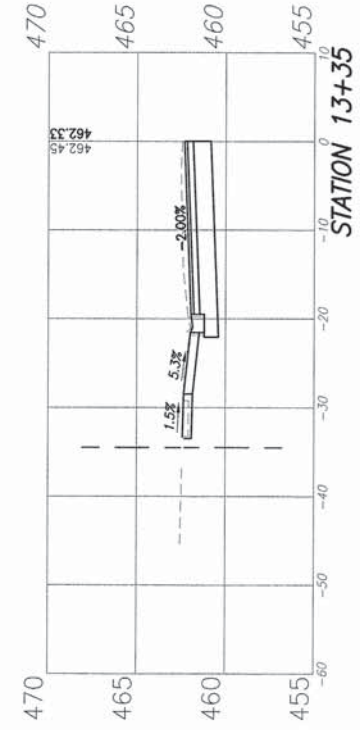
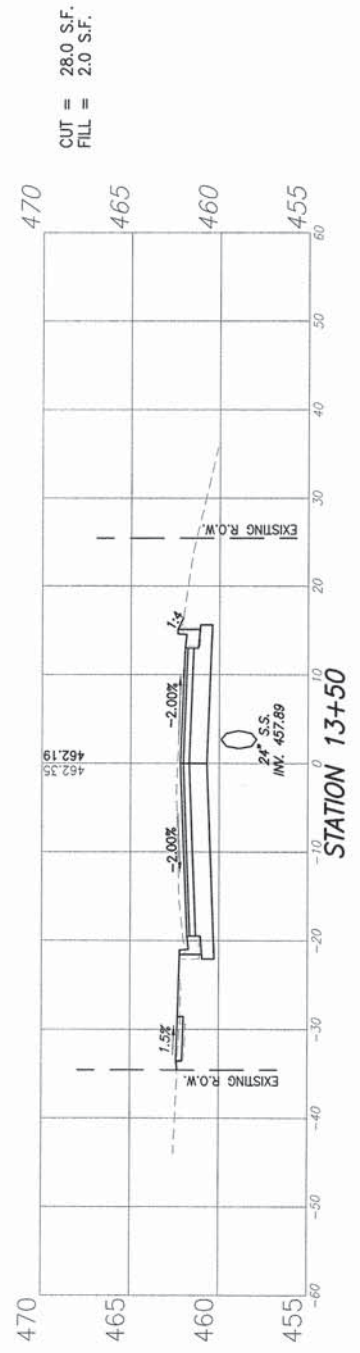

F.A.U. ROUTE	SECTION	COUNTY	TOTAL SHEETS	SHEET NUMBER
9249	14-00021-00-CG	ST. CLAIR	24	20
FEDERAL AID PROJECT		CONTRACT 97592		

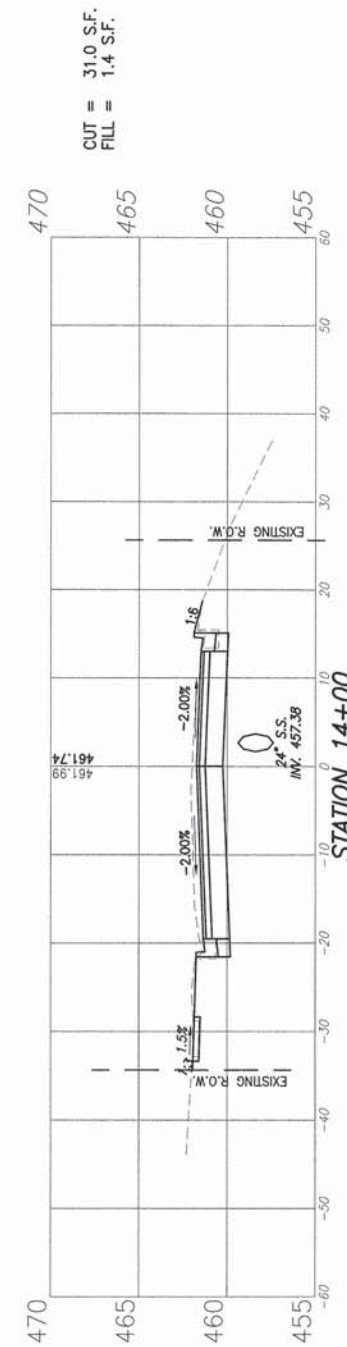
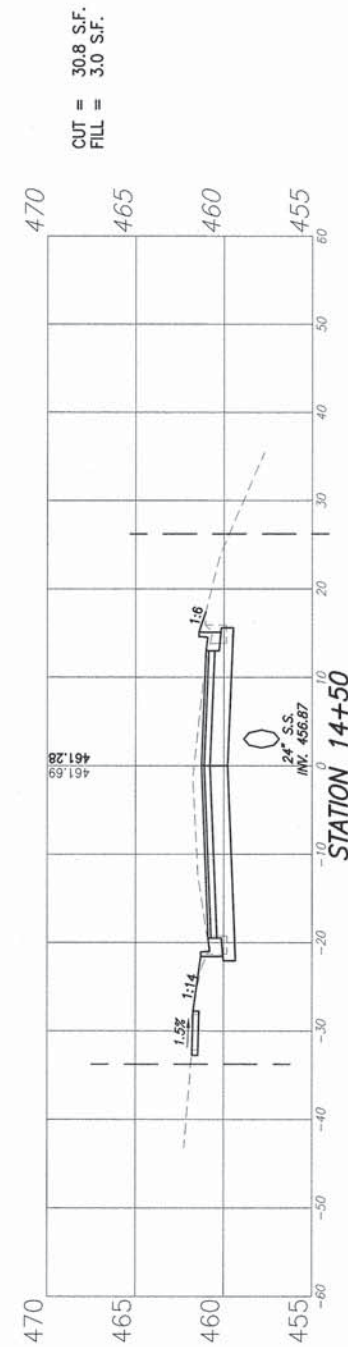
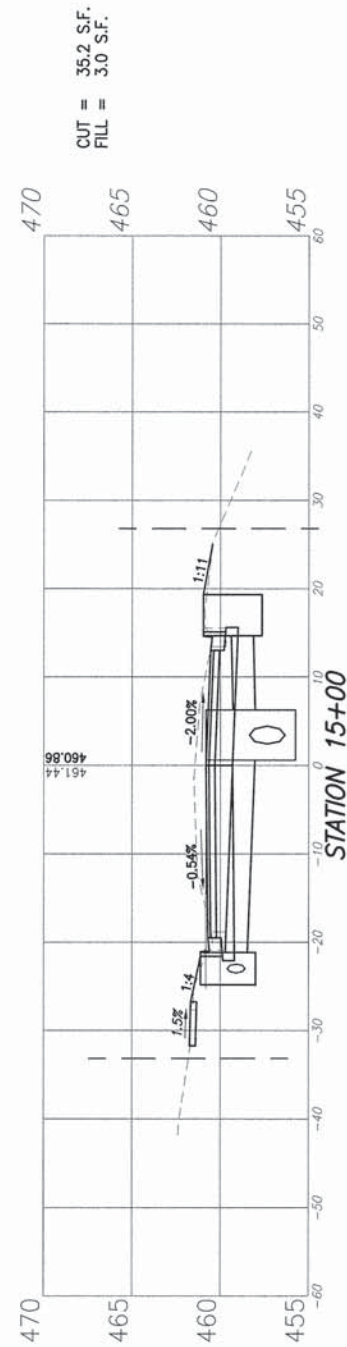
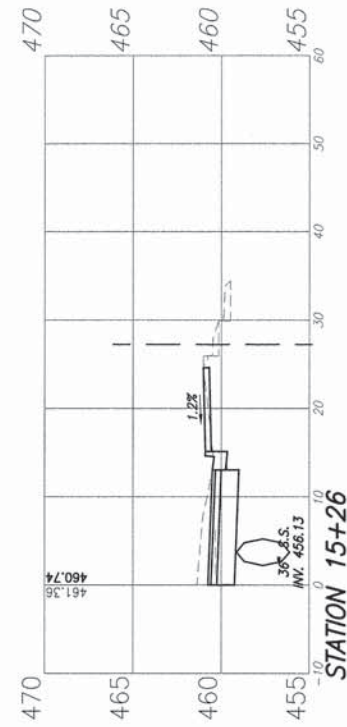
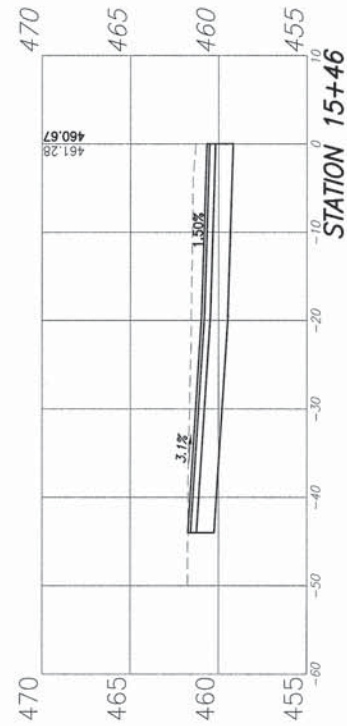
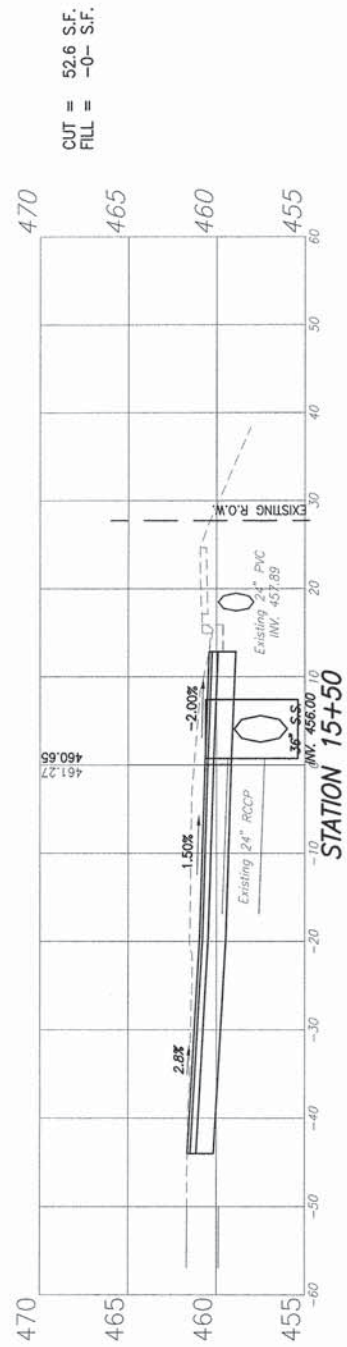

F.A.U. ROUTE	SECTION	COUNTY	TOTAL SHEETS	SHEET NUMBER
9249	14-00021-00-CG	ST. CLAIR	24	21
FEDERAL AID PROJECT		CONTRACT 97592		

CUT = 29.0 S.F.
FILL = 5.2 S.F.

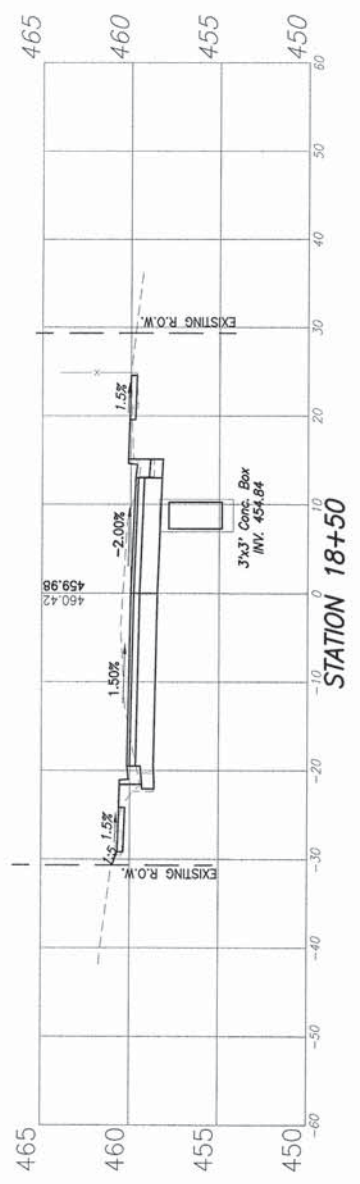

CUT = 36.9 S.F.
FILL = 2.8 S.F.

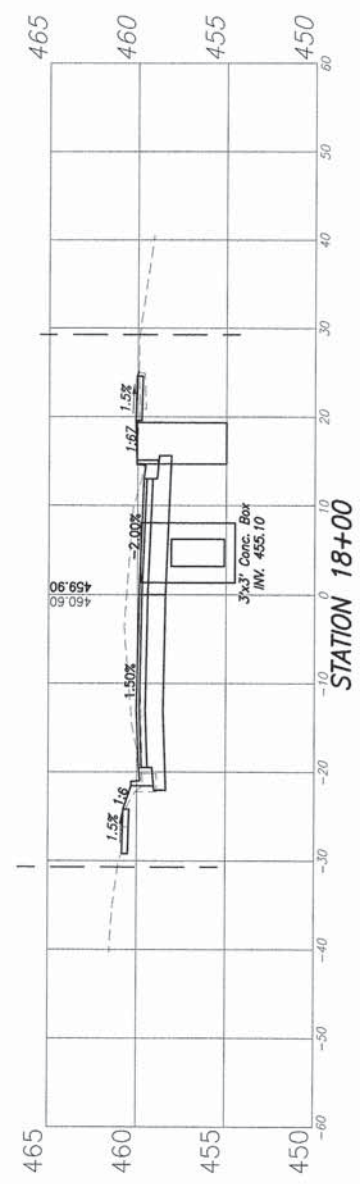

CUT = 35.6 S.F.
FILL = 1.1 S.F.

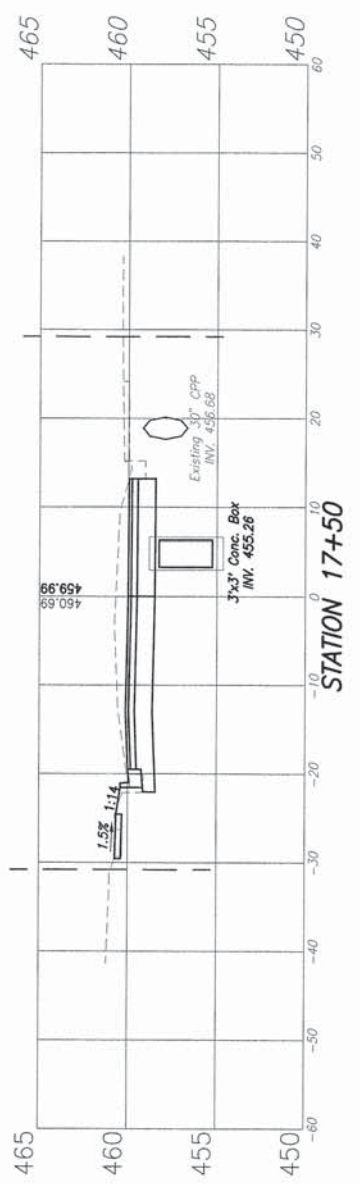

CUT = 32.6 S.F.
FILL = 1.8 S.F.

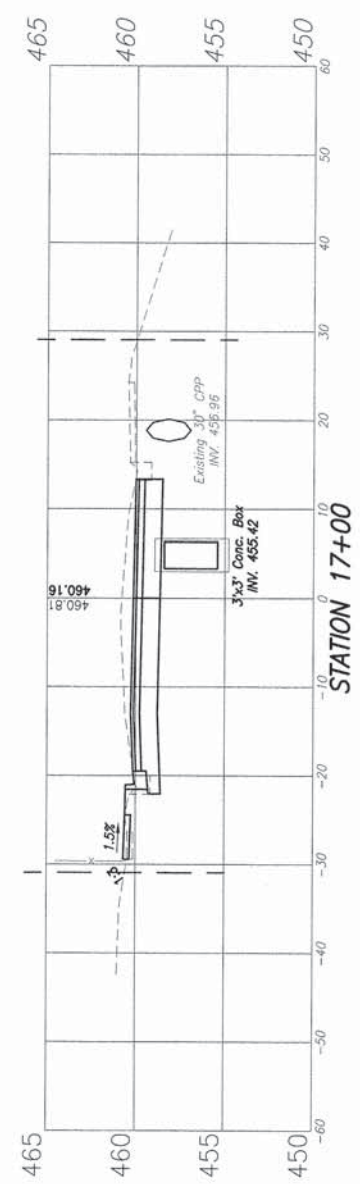

CUT = 30.2 S.F.
FILL = 0.7 S.F.

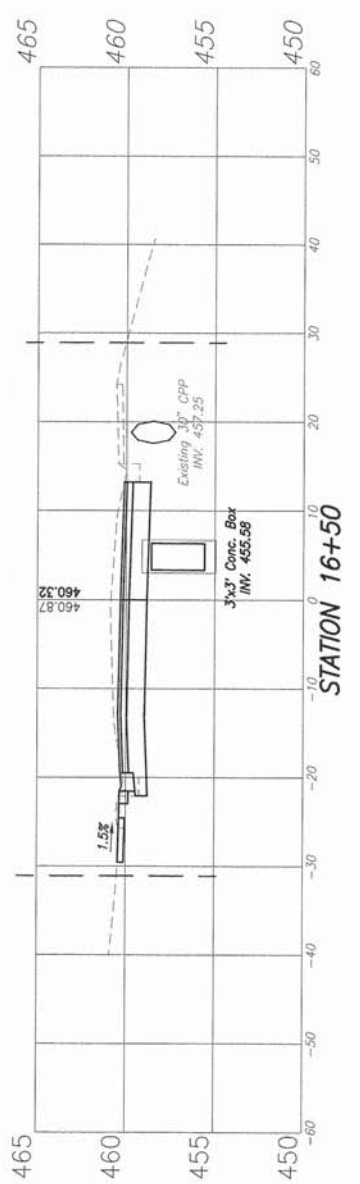

CUT = 29.9 S.F.
FILL = 3.0 S.F.

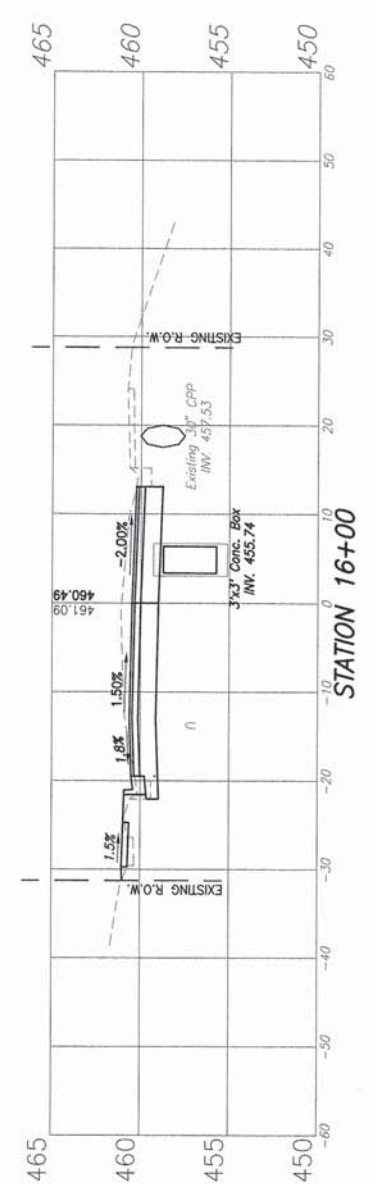
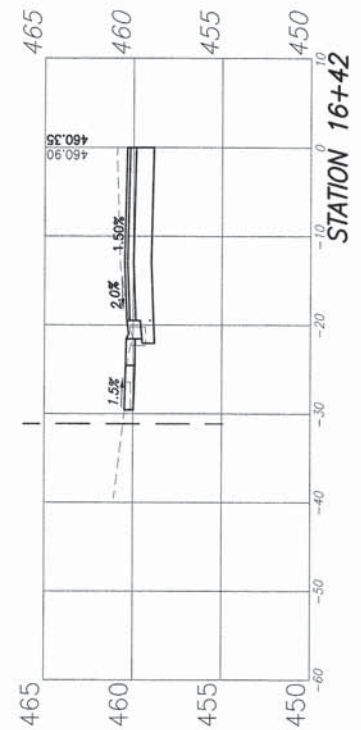

F.A.U. ROUTE	SECTION	COUNTY	TOTAL SHEETS	SHEET NUMBER
9249	14-00021-00-CG	ST. CLAIR	24	22
FEDERAL AID PROJECT		CONTRACT 97592		

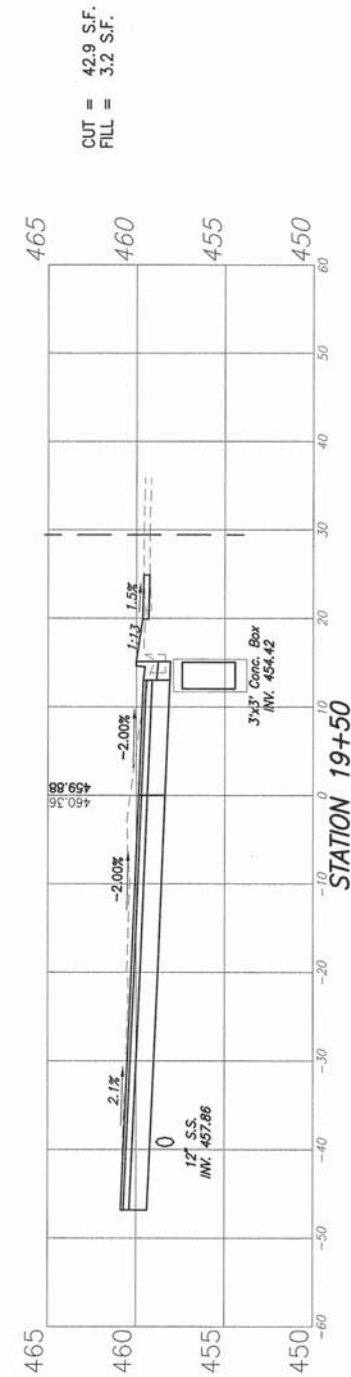
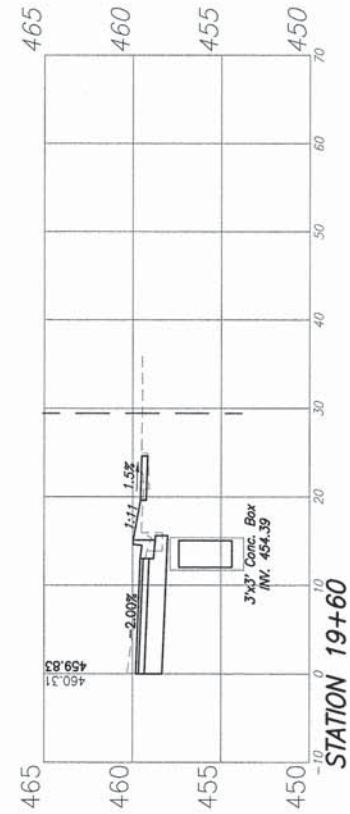
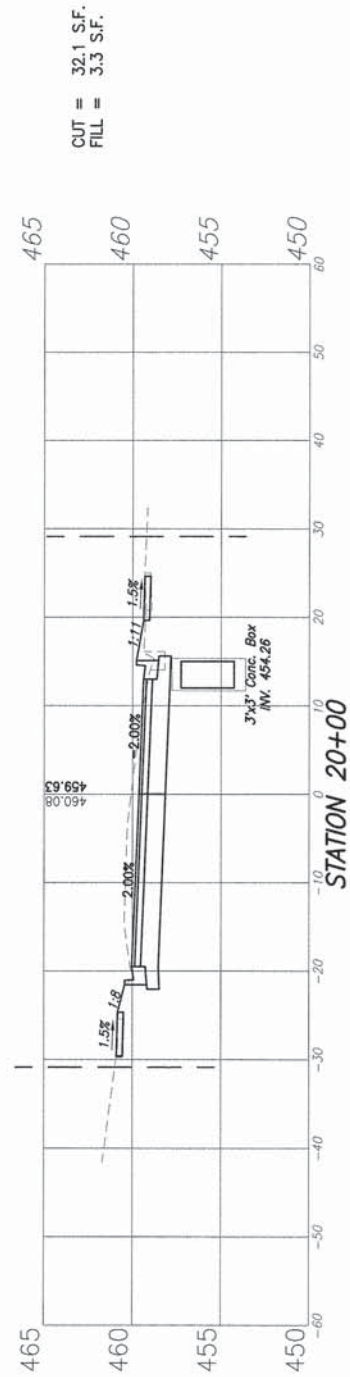
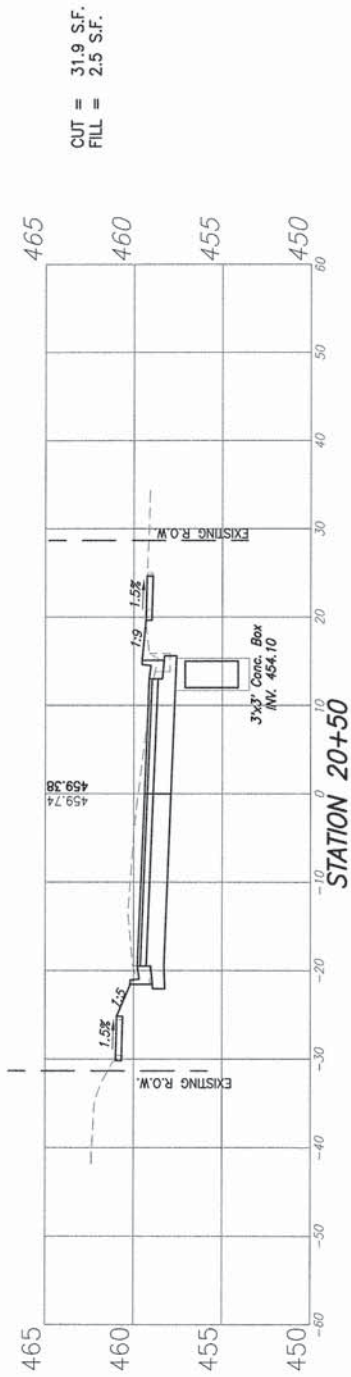
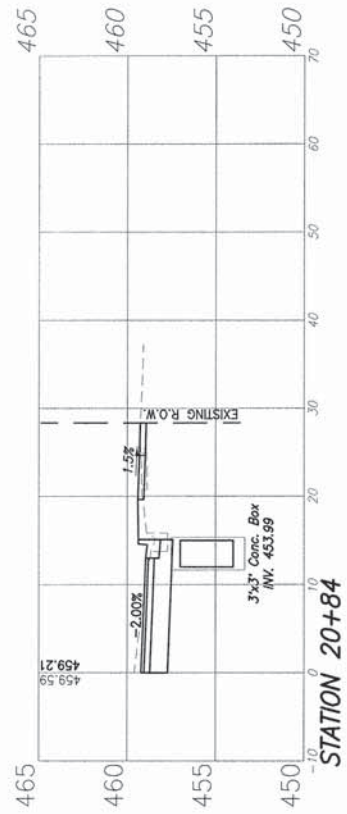

F.A.U. ROUTE	SECTION	COUNTY	TOTAL SHEETS	SHEET NUMBER
9249	14-00021-00-CG	ST. CLAIR	24	23
FEDERAL AID PROJECT		CONTRACT 97592		

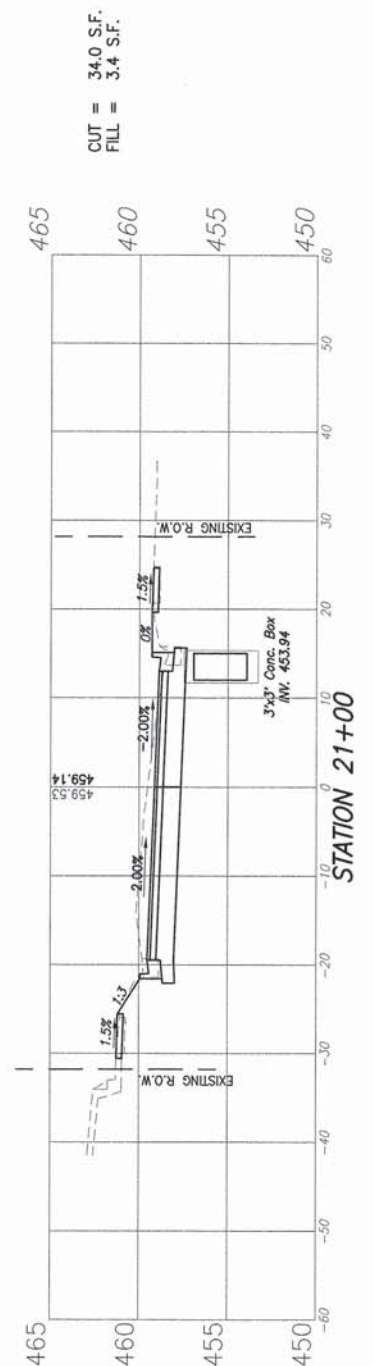
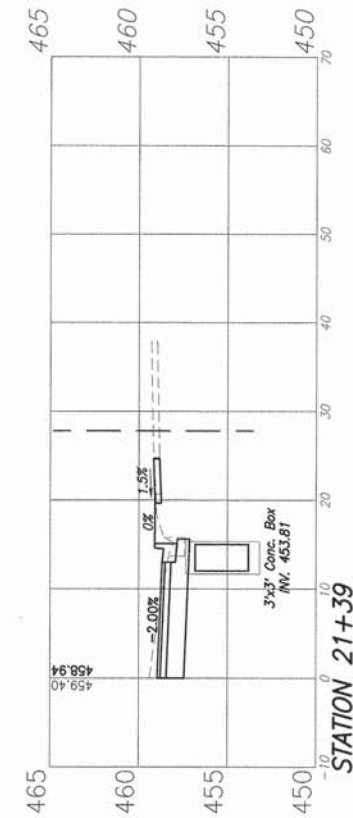
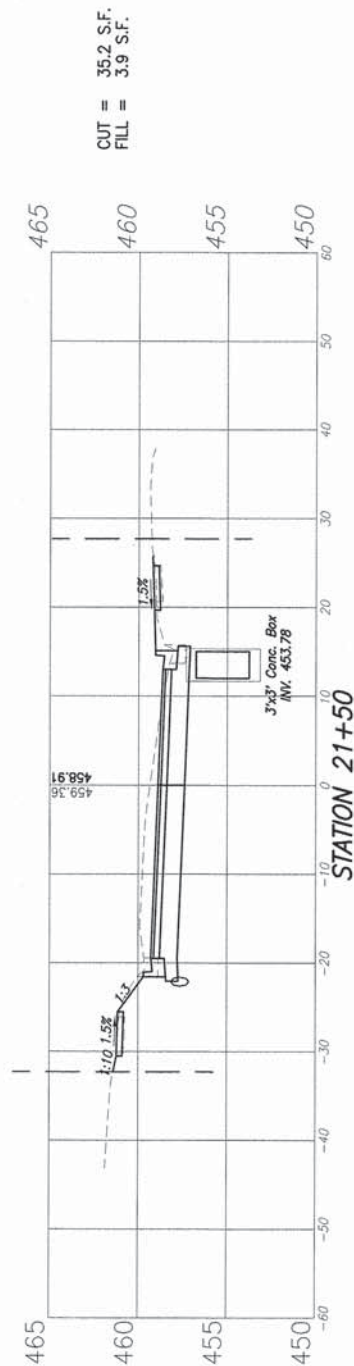
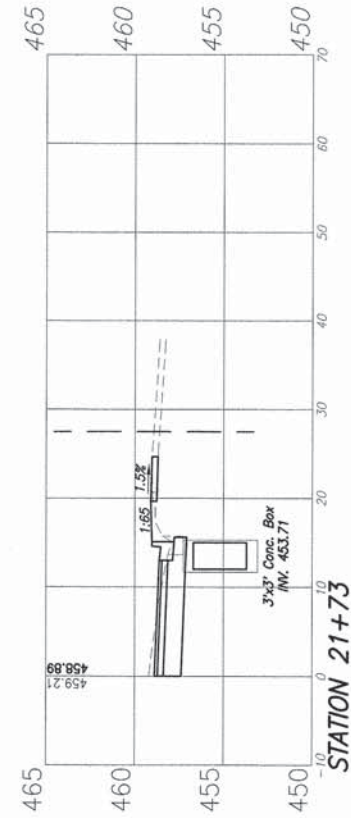
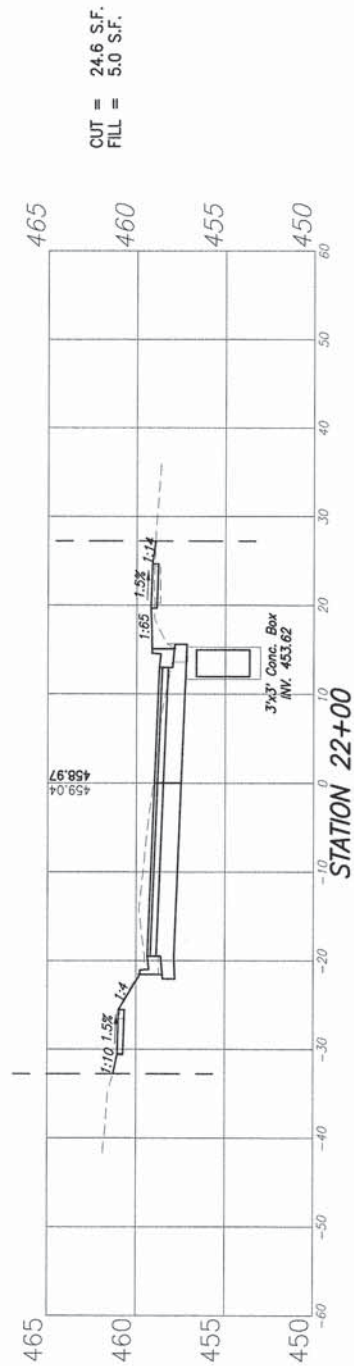
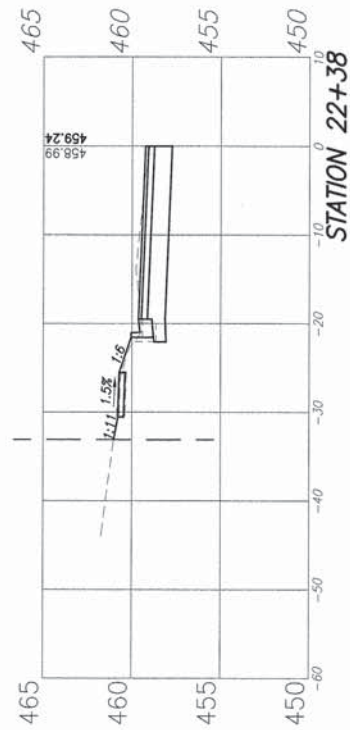
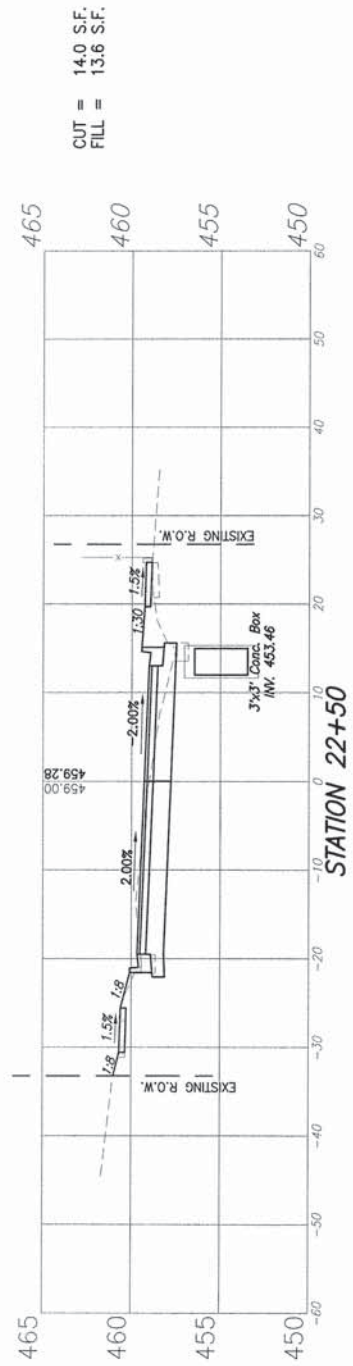

F.A.U. ROUTE	SECTION	COUNTY	TOTAL SHEETS	SHEET NUMBER
9249	14-00021-00-CG	ST. CLAIR	24	24
FEDERAL AID PROJECT			CONTRACT 97592	

