

06-12-2015 LETTING ITEM 184

ROUTE	SECTION	COUNTY	TOTAL SHEETS	SHEET NUMBER
VARIOUS	DAYLABOR D1 MILLING SVCS 16-18	VARIOUS	17	1

IMPROVEMENTS ARE LOCATED THROUGHOUT DISTRICT ONE

CONTRACT 46379

**STATE OF ILLINOIS  
DEPARTMENT OF TRANSPORTATION  
DIVISION OF HIGHWAYS  
DISTRICT ONE  
PROPOSED HIGHWAY PLANS**

VARIOUS ROUTES  
SECTION: DAYLABOR D1 MILLING SVCS 16-18  
VARIOUS COUNTIES  
C-60-018-16

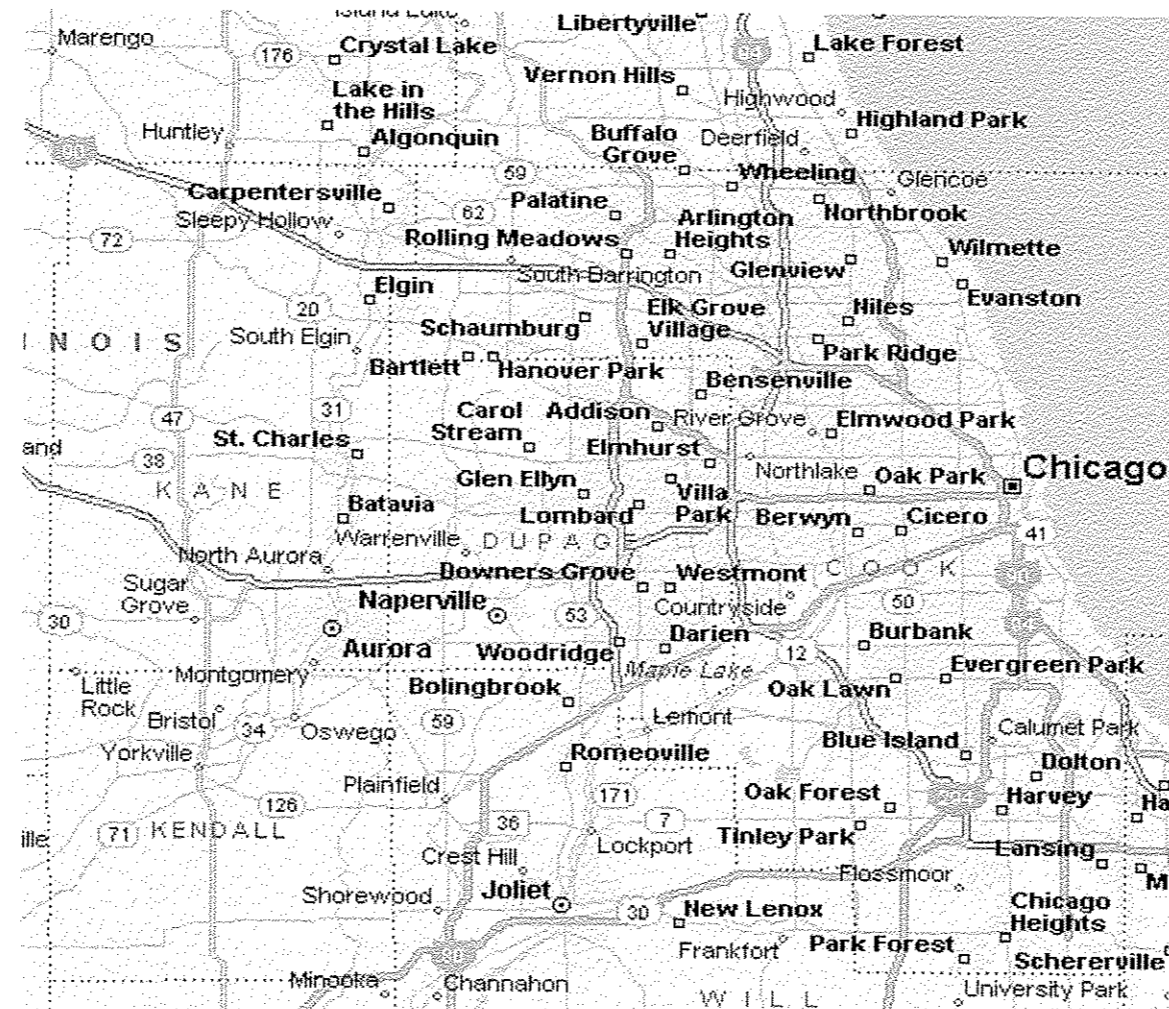
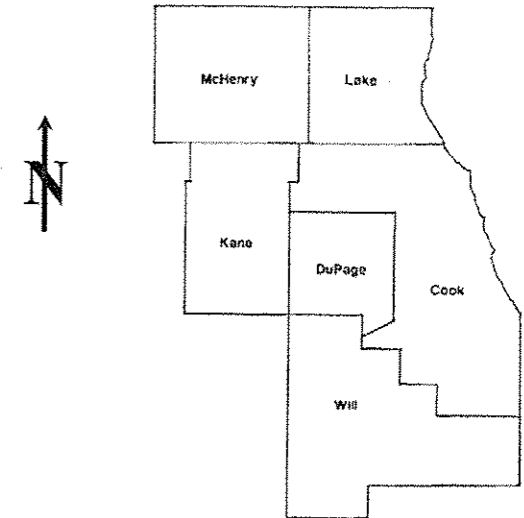

STATE OF ILLINOIS  
DEPARTMENT OF TRANSPORTATION  
DIVISION OF HIGHWAYS

SUBMITTED: March 31 20 15

Amy Eller  
DEPUTY DIRECTOR OF HIGHWAYS, REGION ENGINEER-  
OPERATIONS ENGINEER

May 8 20 15

John D. Baranzelli P.E.  
ENGINEER OF DESIGN AND ENVIRONMENT

May 8 20 15

Omer Osman P.E.  
DIRECTOR, DIVISION OF HIGHWAYS

**PRINTED BY THE AUTHORITY  
OF THE STATE OF ILLINOIS**

1. J.U.L.I.E. JOINT UTILITY LOCATION
  2. INFORMATION FOR EXCAVATION
- (800) 892 - 0123 OR 811

PROJECT ENGINEER: JERRY CAMERON (217) 524-0482  
PROJECT MANAGER: DAVID GREIFZU

CONTRACT 46379

ROUTE	SECTION	COUNTY	TOTAL SHEETS	SHEET NUMBER
VARIOUS	DAYLABOR D1 MILLING SVCS 16-18	VARIOUS	17	2

URBAN  
100% STATE

SUMMARY OF QUANTITIES			TOTAL	CONSTRUCTION TYPE CODE	
CODE NO.	ITEMS	UNITS	QUANTITIES	0 0 0 4	
X9900012	MILLING SERVICES	CAL DAY	15	15	

2015 Day Labor Locations List and Milling Area										
LOC. #	Location	Limits	Town	County	Milling Area	Overall length	HMA SURF. REM. 2"	HMA SURF. REM. VAR. DP.	PCC SURF-REM. VAR. DP.	WORKING DAYS
					SQ YD	FEET	SQUARE YARDS	SQUARE YARDS	SQUARE YARDS	CAL DAY
1	US Route 20	From West Street to IL Route 23	Marengo	McHenry	6189	1890	6189			1
2	Northwest Highway	EB West of intersection Ela Rd and US 14	Barrington	Cook	4237	1032	4237			1
3	Highland Ave	Route 38 to 20th Street	Lombard	DuPage	3231	4644	3231		6103	1
					6103					1
4	Butterfield road	EB and WB, from Route 53 to Gray Ave	Glen Ellyn/Lombard	DuPage	21684	2705	21684			2
5	Butterfield Road	EB and WB, from Spring Road to Prospect Ave	Elmhurst	DuPage	8608	1400	8608			1
6	US Route 30	North bound, from 111th St.	Plainfield	Will	1760	2640	1760			1
7	Main St.	from Archer ave. west to Old Bell Rd	Lemont	Cook	4533	700	4533			1
8	McCarthy St.	Lagrange east to Hobart St.	Palos Park	Cook	5678	1500	5678			1
9	Ruby Street	from N. Broadway St. to Structure over river	Joliet	Will	2774	540		2774		1
10	IL Route 59	Approximately 250' N and S of US route 52 (including intersection)	Shorewood	Will	3430	678	3430			2
11	US Route 6	from DuPage River to Bell Road	Channahon	Will	27749	5808	27749			1
12	Theodore Street	from Larkin avenue to US30	Joliet/Hill Crest	Will	7859	1205	7859			1
TOTALS							94958	2774	6103	15

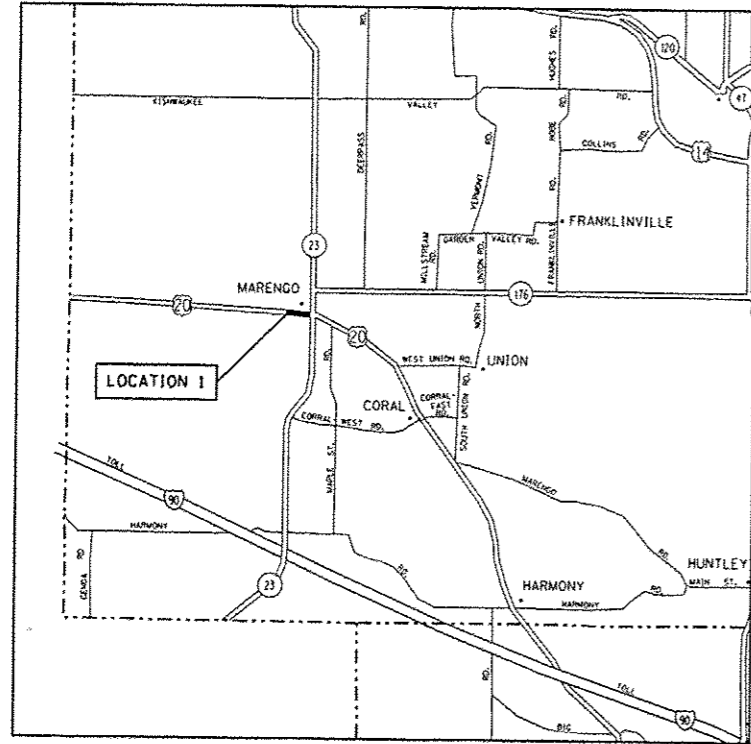

**LOCATION 1**

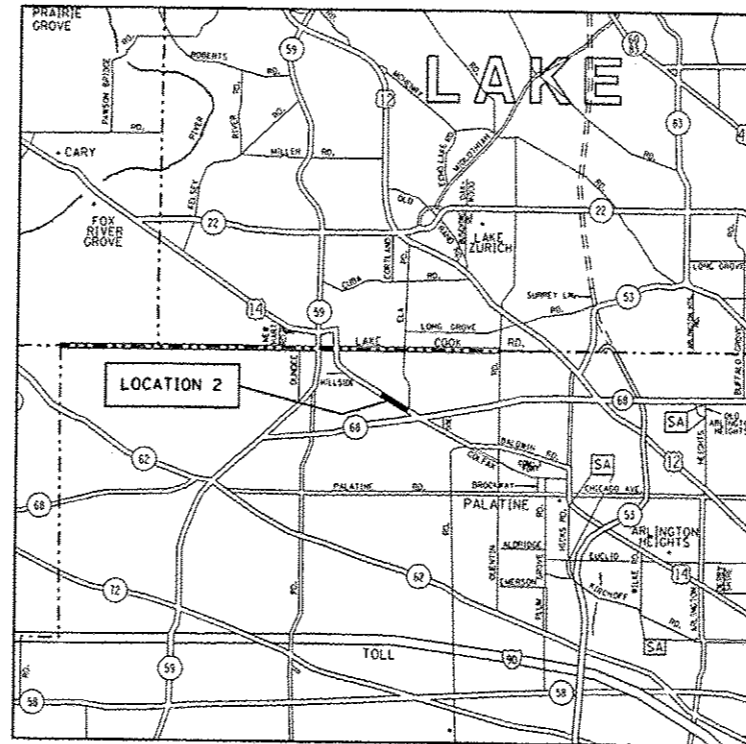

**LOCATION 2**

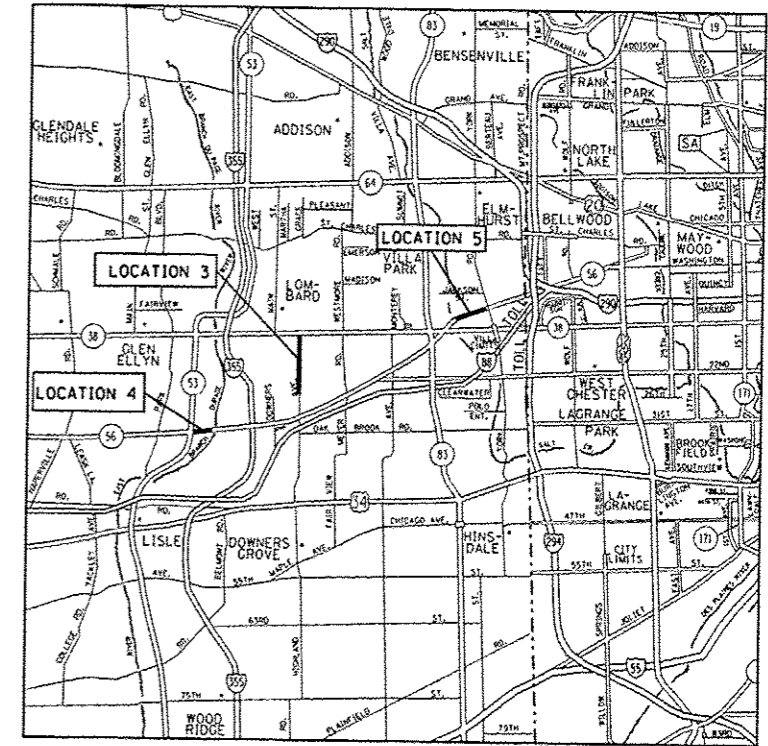

**LOCATIONS 3, 4 AND 5**

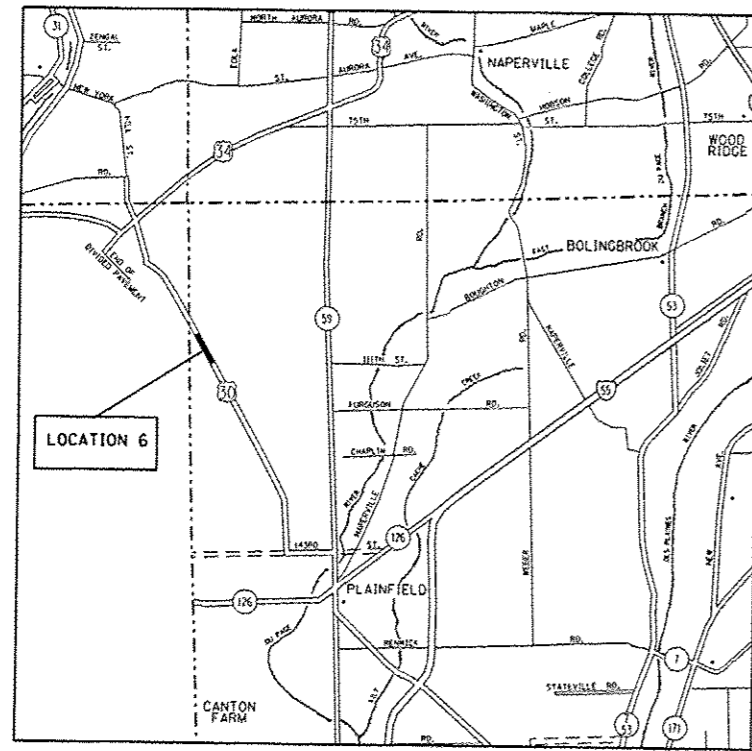

**LOCATION 6**

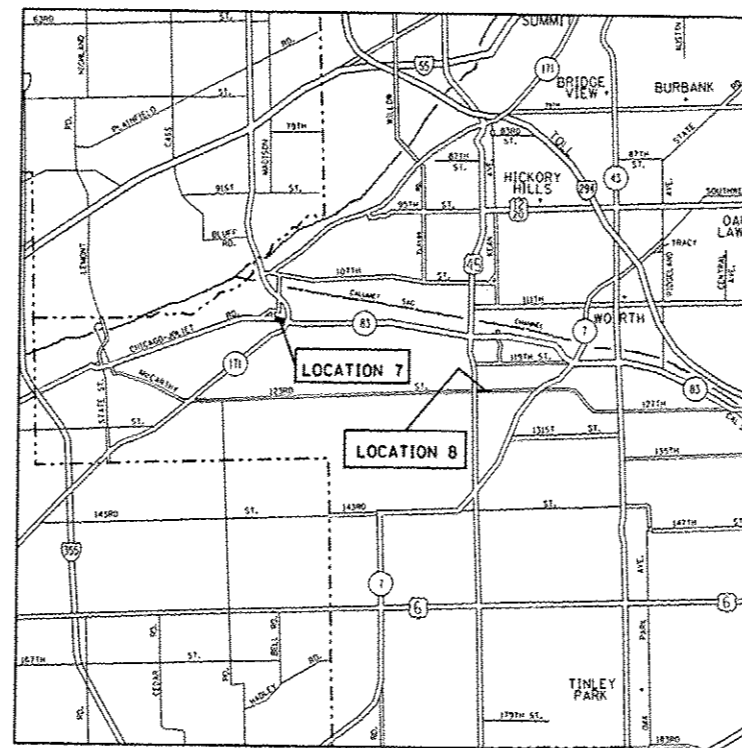

**LOCATIONS 7 AND 8**

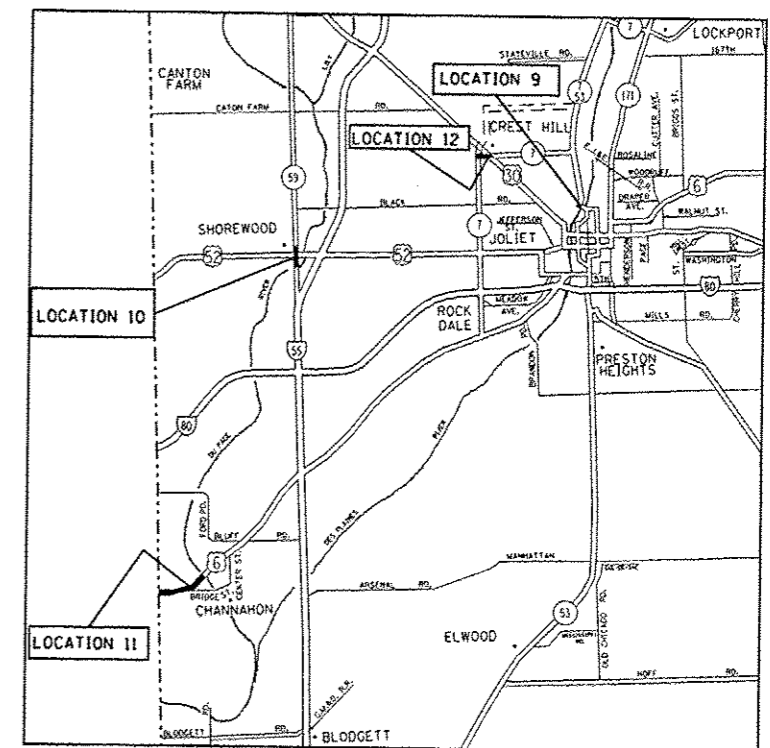

**LOCATIONS 9, 10, 11 AND 12**

FILE NAME :	USER NAME :	DESIGNED :	REVISED :	<b>STATE OF ILLINOIS DEPARTMENT OF TRANSPORTATION</b>	<b>LOCATION MAP</b>	RTE.	SECTION	COUNTY	TOTAL SHEETS	SHEET NO.	
\\dot0161s1\c\l.illinois.gov\Users\deharv	\\Desktop\2015 Paving Season Area Cels.dgn	DRAWN :	REVISED :			VAR	BAYLABOR D1	VARIOUS	VARIOUS	17	3
Default	PLOT SCALE : 100.0000' / 1"	CHECKED :	REVISED :			CONTRACT NO. 46379					
	PLOT DATE : 3/30/2015	DATE :	REVISED :			[ILLINOIS] FED. AID PROJECT					
SCALE:						SHEET OF SHEETS STA. TO STA.					

LIMITS: US 20 FROM WEST STREET TO WEST OF IL 23

2 ←

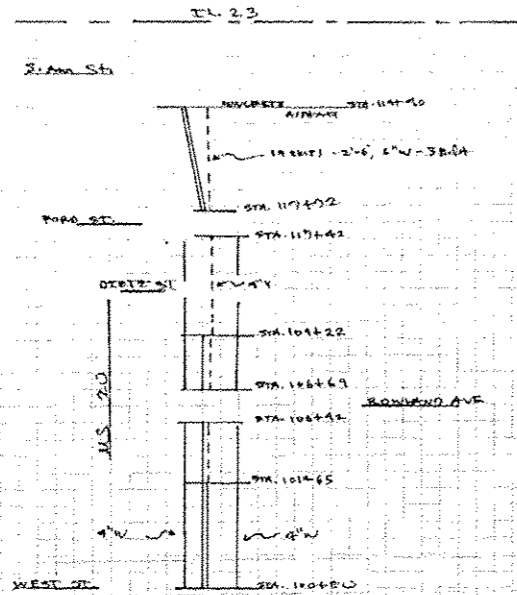

US 20  
 LIMITS: West Street to West of IL 23  
 STATION 100+50 TO STATION 119+40

STATION	(ft) LENGTH	(ft) WIDTH	(ft) AVG. WIDTH	(ft <sup>2</sup> ) AREA	(yd <sup>2</sup> ) AREA	(yd <sup>2</sup> ) CUMM. AREA
100+50		30.00				
	50		29.50	1475.00	163.89	163.89
101+00		29.00				
	400		29.00	11600.00	1288.89	1452.78
105+00		29.00				
	422		29.50	12449.00	1383.22	2836.00
109+22		30.00				
	800		29.00	23200.00	2577.78	5413.78
117+22		28.00				
	218		32.00	6976.00	775.11	6188.89
119+40		36.00				



FILE NAME :	USER NAME : dshhar	DESIGNED -	REVISED -	<b>STATE OF ILLINOIS DEPARTMENT OF TRANSPORTATION</b>	<b>LOCATION 1 - US ROUTE 20 FROM WEST STREET TO IL ROUTE 23</b>				RTE.	SECTION	COUNTY	TOTAL SHEETS	SHEET NO.		
\\dots@BIS\it\et.illinois.gov\DOT\user\dshhar	^Desktop\2015 Paving Season Area Calc.dgn	DRAWN -	REVISED -		SCALE:	SHEET	OF	SHEETS	STA.	TO STA.	VAR	DAYLABOR 01 MILLING SVCS 16-18	VARIOUS	17	4
Default	PLOT SCALE = 200.0000' / in.	CHECKED -	REVISED -		CONTRACT NO. 46379										
	PLOT DATE = 3/30/2015	DATE -	REVISED -		ILLINOIS FED. AID PROJECT										



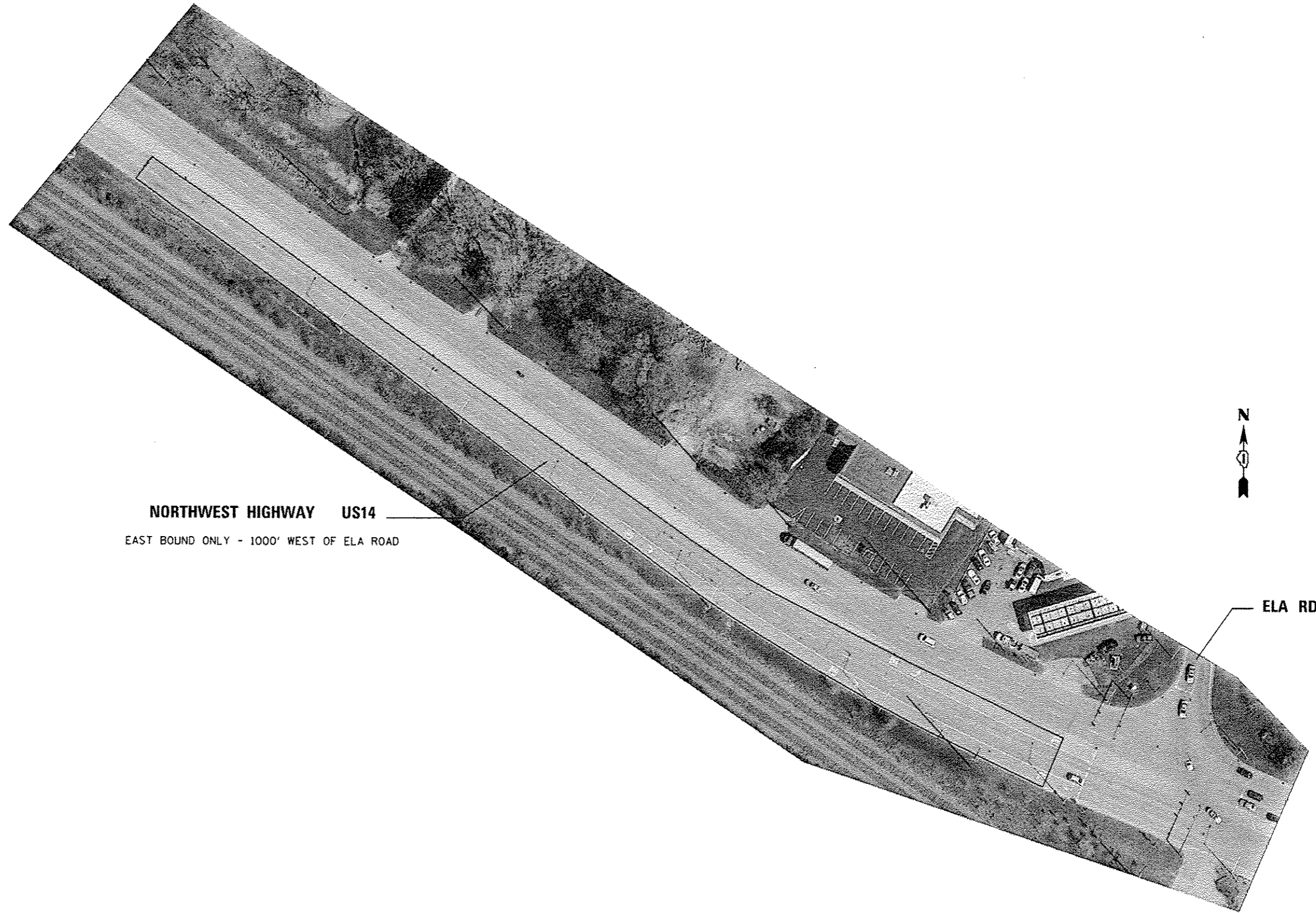

**NORTHWEST HIGHWAY US14**

EAST BOUND ONLY - 1000' WEST OF ELA ROAD



ELA RD

FILE NAME *	USER NAME * dahhanv	DESIGNED -	REVISED -
\\dot8161a1xcl1.illinois.gov\Users\dahhanv\Desktop\2015 Paving Season Area Colors.dgn		DRAWN -	REVISED -
Default	PLOT SCALE * 100.0000 1 / in.	CHECKED -	REVISED -
	PLOT DATE * 3/30/2015	DATE -	REVISED -

STATE OF ILLINOIS  
DEPARTMENT OF TRANSPORTATION

LOCATION 2 - NORTHWEST HIGHWAY  
EB WEST OF INTERSECTION ELA RD AND US 14

SCALE: SHEET OF SHEETS STA. TO STA.

RTE.	SECTION	COUNTY	TOTAL SHEETS	SHEET NO.
VAR	DAYLABOR 01 MILLING SVCS 16-18	VARIOUS	17	5
			CONTRACT NO. 46379	
ILLINOIS FED. AID PROJECT				



HIGHLAND AVE



FILE NAME >	USER NAME = dahhan	DESIGNED -	REVISED -	<b>STATE OF ILLINOIS DEPARTMENT OF TRANSPORTATION</b>	<b>LOCATION 3 - HIGHLAND AVE FROM ROUTE 38 TO 20TH STREET</b>		RTI.	SECTION	COUNTY	TOTAL SHEETS	SHEET NO.
\\dot016isistec1.illinois.gov\0Users\dahhan	^Desktop\2015 Paving Season Area Calc.dgn	DRAWN -	REVISED -				VAR	DAYLABOR 01	VARIOUS	17	6
Default	PLOT SCALE = 320.0000 / in.	CHECKED -	REVISED -		SCALE: SHEET OF SHEETS STA. TO STA.		CONTRACT NO. 46379				
	PLOT DATE = 3/30/2015	DATE -	REVISED -		ILLINOIS FED. AID PROJECT						

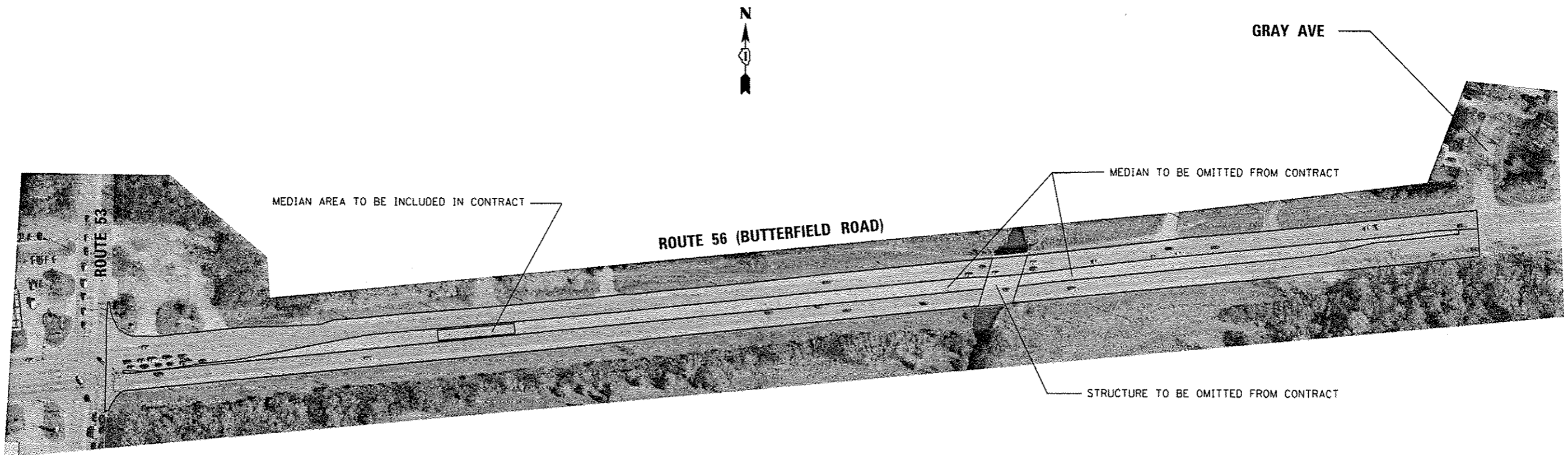

FILE NAME :	USER NAME : dahhar	DESIGNED -	REVISED -
\\dot0161stxcl.illinois.gov\Users\dahhar	NDesktop\2015 Paving Season Area Calcs.dgn	DRAWN -	REVISED -
Default	PLOT SCALE = 200.0000 ' / in.	CHECKED -	REVISED -
	PLOT DATE = 3/30/2015	DATE -	REVISED -

**STATE OF ILLINOIS  
DEPARTMENT OF TRANSPORTATION**

**LOCATION 4 -- BUTTERFIELD ROAD  
EB AND WB FROM ROUTE 53 TO GRAY AVE**

RTE.	SECTION	COUNTY	TOTAL SHEETS	SHEET NO.
VAR	DAYLABOR DJ MILLING SVCS 16-18	VARIOUS	17	7
			CONTRACT NO. 46379	
ILLINOIS FED. AID PROJECT				

SCALE: SHEET OF SHEETS STA. TO STA.



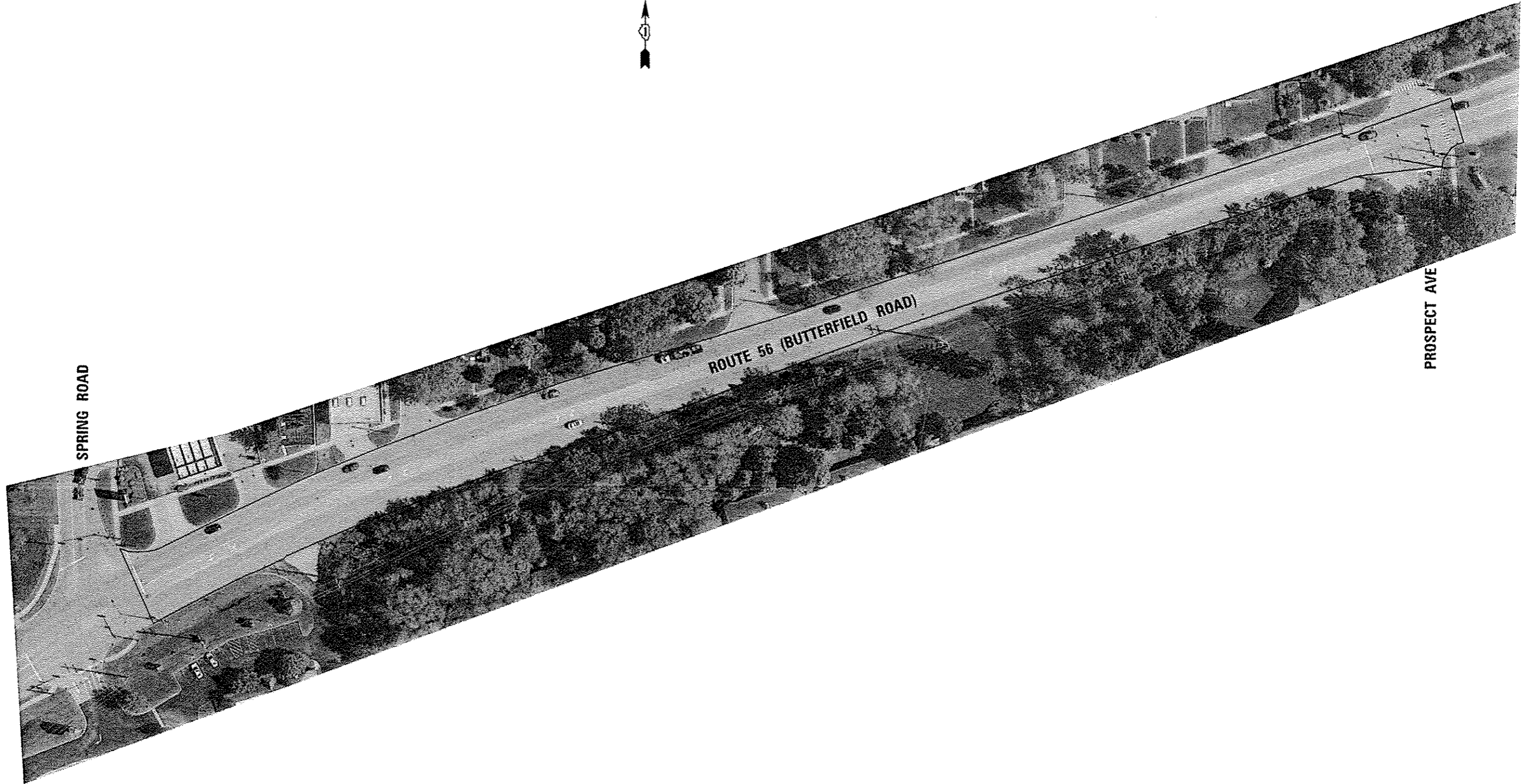

FILE NAME	USER NAME	DESIGNED	REVISED
\\dot@i6iss1-cl.illinois.gov\01User\dehorr\Desktop\2015 Paving Season Area Calcs.dgn	dehorr	-	-
		DRAWN	REVISED
		-	-
		CHECKED	REVISED
		-	-
		DATE	REVISED
		-	-

**STATE OF ILLINOIS  
DEPARTMENT OF TRANSPORTATION**

**LOCATION 5 - BUTTERFIELD ROAD  
EB AND WB FROM SPRING ROAD TO PROSPECT AVE**

RTE.	SECTION	COUNTY	TOTAL SHEETS	SHEET NO.
VAR	DAYLABOR 01 MILLING SYCS 16-18	VARIOUS	17	8
			CONTRACT NO. 46379	
[ILLINOIS] FED. AID PROJECT				

SCALE: SHEET OF SHEETS STA. TO STA.



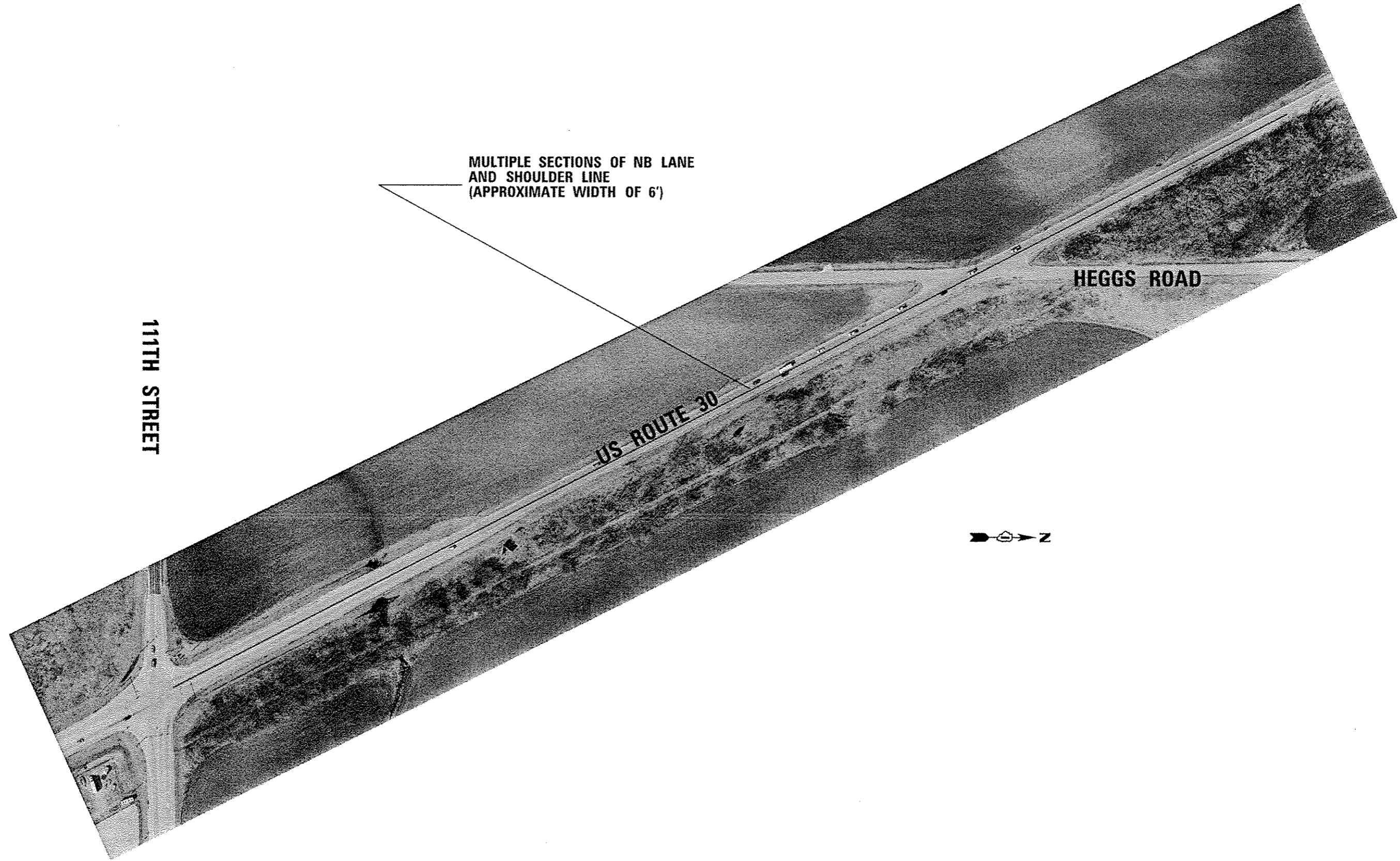

MULTIPLE SECTIONS OF NB LANE  
AND SHOULDER LINE  
(APPROXIMATE WIDTH OF 6')

111TH STREET

US ROUTE 30

HEGGS ROAD



FILE NAME :	USER NAME :	DESIGNED :	REVISED :	STATE OF ILLINOIS DEPARTMENT OF TRANSPORTATION	LOCATION 6 - US ROUTE 30 NB, FROM 111TH STREET		RTE.	SECTION	COUNTY	TOTAL SHEETS	SHEET NO.	
Default	Default	Default	Default				VAR	DAYLABOR 01 MILLING SVCS 16-18	VARIOUS	17	9	
					SCALE:	SHEET	OF	SHEETS	STA.	TO STA.	ILLINOIS FED. AID PROJECT	
											CONTRACT NO. 46379	

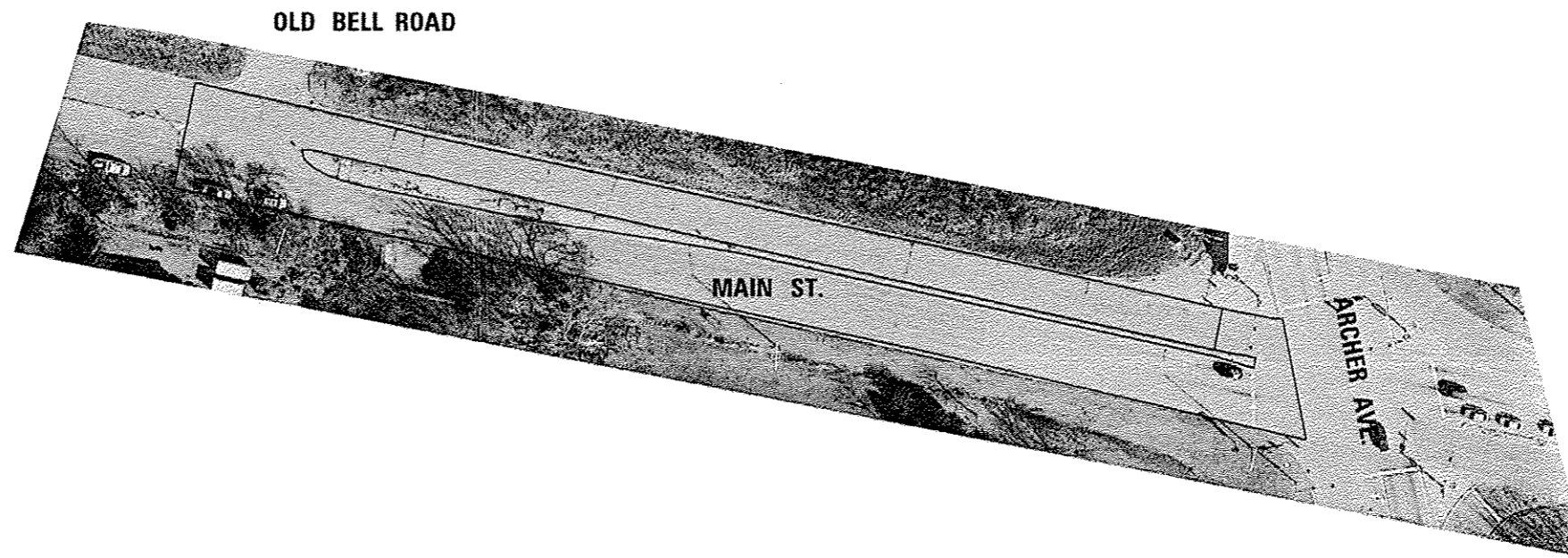

FILE NAME : \\dot0161stiacl\illinois.gov\DIUsers\dehenn	USER NAME : dehenn	DESIGNED -	REVISED -	<b>STATE OF ILLINOIS DEPARTMENT OF TRANSPORTATION</b>	<b>LOCATION 7 - MAIN STREET FROM ARCHER AVE. WEST TO OLD BELL ROAD</b>		RTE.	SECTION	COUNTY	TOTAL SHEETS	SHEET NO.	
	X:\Desktop\2015 Paving Season Area Calc.dgn	DRAWN -	REVISED -				VAR	DAY LABOR 01 MILLING SVCS 16-18	VARIOUS	17	10	
Default	PLOT SCALE = 100.0000' / 1"	CHECKED -	REVISED -		SCALE:	SHEET	OF	SHEETS	STA.	TO STA.	ILLINOIS FED. AID PROJECT CONTRACT NO. 46379	
	PLOT DATE = 3/30/2015	DATE -	REVISED -									



LaGRANGE ROAD

CONCRETE SECTION TO BE OMITTED FROM CONTRACT

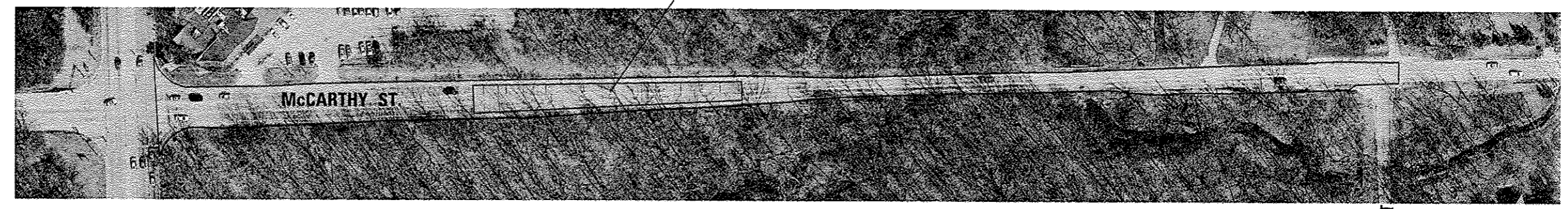

HOBART ST

FILE NAME =	USER NAME = dshahr	DESIGNED -	REVISED -	<b>STATE OF ILLINOIS DEPARTMENT OF TRANSPORTATION</b>	<b>LOCATION 8 - McARTHUR ST FROM LaGRANGE ROAD EAST TO HOBART ST.</b>	F.A. RTE.	SECTION	COUNTY	TOTAL SHEETS	SHEET NO.	
\\dot\GIS\is\cl\Illinois.gov\Users\dshahr	^Desk top\2015 Paving Season Area Calc.dgn	DRAWN -	REVISED -			VAR	DAYLABOR D1 MILLING SVCS 16-18	VARIOUS	17	11	
Default	PLOT SCALE = 150,0000 / in.	CHECKED -	REVISED -			SCALE: SHEET OF SHEETS STA. TO STA.		ILLINOIS FED. AID PROJECT CONTRACT NO. 46379			
	PLOT DATE = 3/30/2015	DATE -	REVISED -								

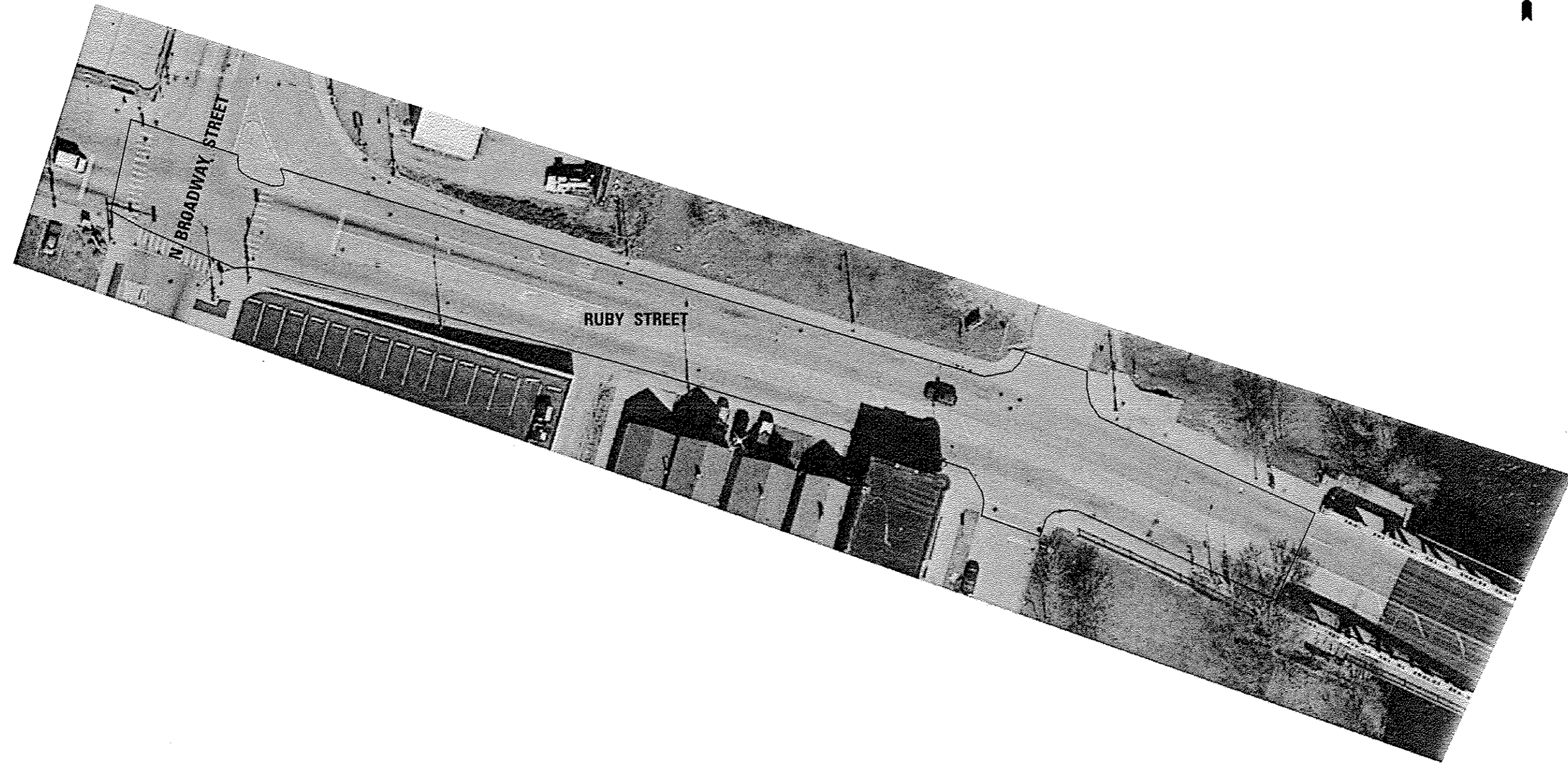

FILE NAME :	USER NAME : dahhar	DESIGNED -	REVISED -	<b>STATE OF ILLINOIS DEPARTMENT OF TRANSPORTATION</b>	<b>LOCATION 9 - RUBY STREET</b>		RT.	SECTION	COUNTY	TOTAL SHEETS	SHEET NO.
\\dot816\svictel.illinois.gov\0User\dahhar\	Desktop\2015 Paving Season Area Color.dgn	DRAWN -	REVISED -		<b>FROM N. BROADWAY ST. TO STRUCTURE OVER RIVER</b>		VAR	DAYLABOR 01 MILLING SVCS 16-18	VARIOUS	17	12
Default	PLOT SCALE = 50.0000 1/1 in.	CHECKED -	REVISED -				<b>CONTRACT NO. 46379</b>				
	PLOT DATE = 3/30/2015	DATE -	REVISED -		SCALE:	SHEET	OF	SHEETS	STA.	TO STA.	ILLINOIS FED. AID PROJECT





AREA TO BE OMITTED FROM CONTRACT



AREA TO BE OMITTED FROM CONTRACT

FILE NAME :	USER NAME : dathan	DESIGNED -	REVISED -	<b>STATE OF ILLINOIS DEPARTMENT OF TRANSPORTATION</b>	<b>LOCATION 10 - IL ROUTE 59 APPROXIMATELY 250 FT N AND S OF US 52</b>	RYE.	SECTION	COUNTY	TOTAL SHEETS	SHEET NO.
\\dot@isfact.illinois.gov\Users\dathan\Desktop\2015 Paving Season Area Calc.dgn		DRAWN -	REVISED -			VAR	DAYLABOR 01	VARIOUS	17	13
Defaults		CHECKED -	REVISED -			MILLING SVCS 16-18		CONTRACT NO. 46379		
		DATE -	REVISED -			SCALE:	SHEET	OF	SHEETS	STA.
						[ILLINOIS] FED. AID PROJECT				





FILE NAME =	USER NAME = dahhanv	DESIGNED -	REVISED -	<b>STATE OF ILLINOIS DEPARTMENT OF TRANSPORTATION</b>	<b>LOCATION 12 - THEODORE STREET FROM LARKIN AVENUE TO US30</b>		RTE.	SECTION	COUNTY	TOTAL SHEETS	SHEET NO.
\\dot016rasinet.illinois.gov\01user\dahhanv\Desk-top\2015 Paving Season Area Calcs.dgn	DRAWN -	REVISED -	VAR				DAY LABOR 01	VARIOUS	17	15	
PLOT SCALE = 100.0000' / in.	CHECKED -	REVISED -	SCALE: SHEET OF SHEETS STA. TO STA.		CONTRACT NO. 46379		ILLINOIS FED. AID PROJECT				
Default	PLOT DATE = 3/30/2015	DATE -	REVISED -								

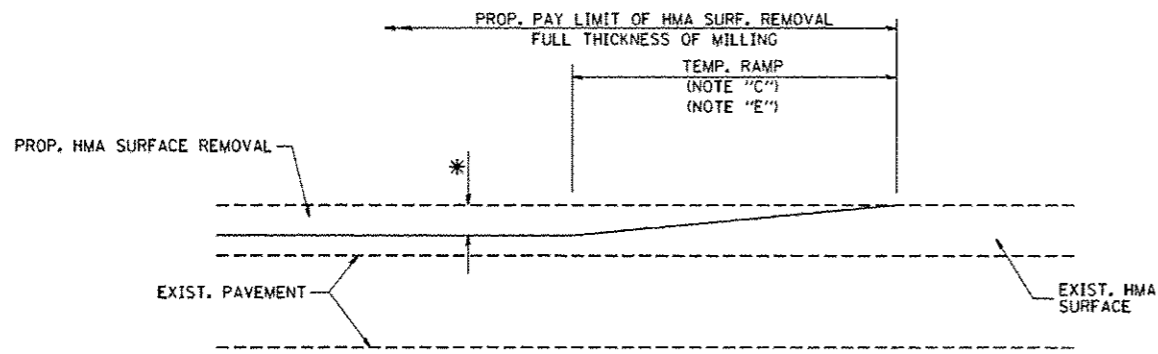

MILLED TEMPORARY RAMP  
(FOR BUTT JOINT AND HMA TAPER SEE DETAIL BELOW)

OPTION 1

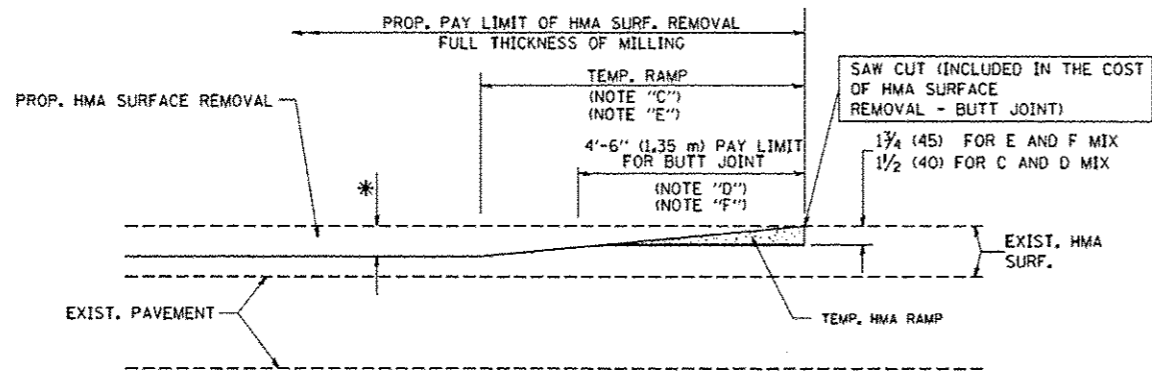

HMA CONSTRUCTED TEMPORARY RAMP  
(FOR BUTT JOINT AND HMA TAPER SEE DETAIL BELOW)

OPTION 2  
TYPICAL TEMPORARY RAMP

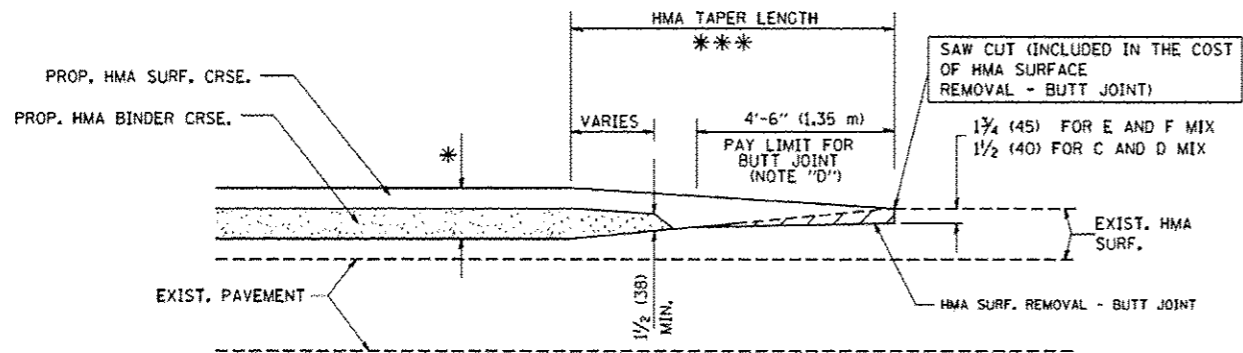

BUTT JOINT AND HMA TAPER  
TYPICAL BUTT JOINT AND HMA TAPER  
FOR MILLING AND RESURFACING

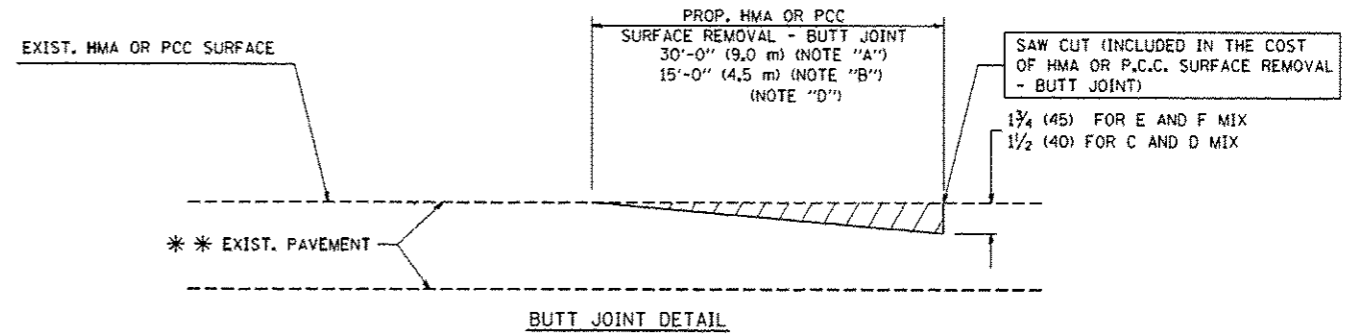

BUTT JOINT DETAIL

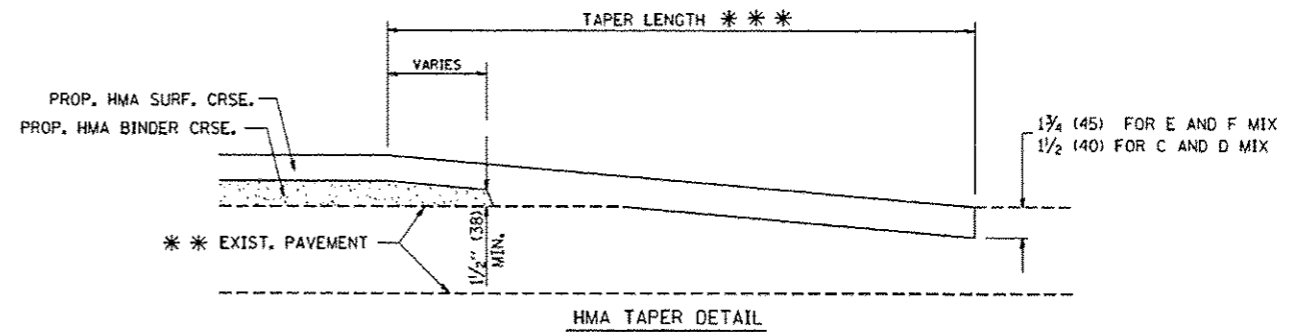

HMA TAPER DETAIL

TYPICAL BUTT JOINT AND HMA TAPER  
FOR RESURFACING ONLY

\*\*\* PC CONCRETE, HMA OR HMA RESURFACED PAVEMENT.

NOTES

- A: MAINLINE ROADWAYS AND MAJOR SIDE ROADS.
  - B: MINOR SIDE ROADS.
  - C: THE TEMP. RAMP SHALL BE CONSTRUCTED IMMEDIATELY UPON REMOVAL OF THE EXISTING HMA SURFACE.
  - D: THE BUTT JOINT SHALL BE CONSTRUCTED IMMEDIATELY PRIOR TO PLACING THE PROPOSED HMA COURSES.
  - E: TAPER THE TEMP. RAMP AT A RATE OF 3'-0" (900 mm) PER 1 INCH (25 mm) OF MILLING THICKNESS.
  - F: INSTALLATION AND REMOVAL OF THE 4'-6" (1.35 m) TEMP. RAMP IS INCLUDED IN COST OF HMA SURFACE REMOVAL - BUTT JOINT
  - G: SEE ARTICLE 406.08 AND 406.14 OF THE STANDARD SPECIFICATIONS FOR "HMA AND/OR PCC SURFACE REMOVAL, BUTT JOINT".
- \* SEE TYPICAL SECTIONS FOR MILLING THICKNESS.
- \*\*\* 20'-0" (6.1 m) PER 1 (25) RESURFACING (NOTE "A")  
10'-0" (3.0 m) PER 1 (25) RESURFACING (NOTE "B")

BASIS OF PAYMENT:

THE BUTT JOINT WILL BE PAID FOR AT THE CONTRACT UNIT PRICE PER SQUARE YARD (SQUARE METER) FOR "HOT-MIX ASPHALT SURFACE REMOVAL - BUTT JOINT" OR FOR "PORTLAND CEMENT CONCRETE SURFACE REMOVAL - BUTT JOINT".

ALL DIMENSIONS ARE IN INCHES (MILLIMETERS) UNLESS OTHERWISE SHOWN.

FILE NAME * W:\dst\td\22x34\bd32.dgn	USER NAME * gaglionobt	DESIGNED - M. DE YONG	REVISED - R. SHAH 10-25-94	<b>STATE OF ILLINOIS DEPARTMENT OF TRANSPORTATION</b>	<b>BUTT JOINT AND HMA TAPER DETAILS</b>		F.A. RTE.	SECTION	COUNTY	TOTAL SHEETS	SHEET NO.	
PLOT SCALE * 5/8"=1'-0"	CHECKED -	REVISOR - A. ABBAS 03-21-97	REVISOR - M. GOMEZ 04-06-01		SCALE: NONE	SHEET NO. 1 OF 1 SHEETS	STA.	TO STA.	VAR.	DAY/DATE OF MILLING SVCS 16-18	VARIOUS	17 16
PLOT DATE * 1/4/2000	DATE - 06-13-90	REVISOR - R. BORO 01-01-07							<b>BD400-05 BD32</b>		CONTRACT NO. 46379	
FED. ROAD DIST. NO. 1 ILLINOIS FED. AID PROJECT												



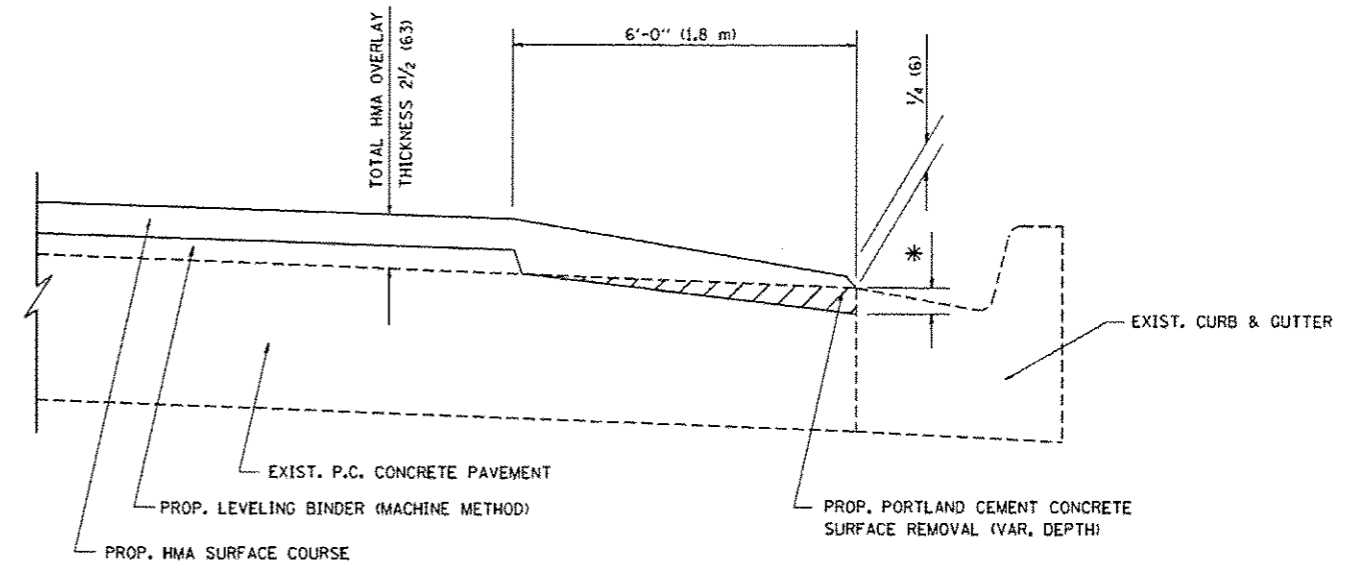

**HMA TAPER AT  
EDGE OF P.C.C PAVEMENT**

HMA SURFACE	LEVELING BINDER		* MILLING AT GUTTER FLAG
	MIX	THICKNESS	
C OR D	1 1/2 (38)	1 (25)	1/4 (33)
F	1 3/4 (44)	3/4 (19)	1/2 (38)

ALL DIMENSIONS ARE IN INCHES (MILLIMETERS) UNLESS OTHERWISE SHOWN.

FILE NAME * N:\dot\stsd\A22x34\bd33.dgn	USER NAME * gaglianobt	DESIGNED - R. SHAH	REVISED - R. SHAH 10-25-94
		DRAWN - JIS	REVISED - A. ABBAS 05-05-99
		CHECKED - A. ABBAS	REVISED - E. GOMEZ 12-21-00
		DATE - 09-10-94	REVISED - R. BORO 01-01-07

**STATE OF ILLINOIS  
DEPARTMENT OF TRANSPORTATION**

SCALE: NONE		SHEET NO. 1 OF 1 SHEETS		STA.	TO STA.
-------------	--	-------------------------	--	------	---------

F.A. RTE. VAR	SECTION DATE/CDR/PI MILLING SVCS 16-18	COUNTY VARIOUS	TOTAL SHEETS 17	SHEET NO. 17
BD400-06 (BD33)		CONTRACT NO. 46379		
FED. ROAD DIST. NO. 1 ILLINOIS FED. AID PROJECT				