

SCHEDULE OF QUANTITIES
GLEN ELLYN ROAD AT FULLERTON AVENUE

NO.	QUANT.	UNIT	DESCRIPTION
1.	1	EACH	MAINTENANCE OF EXISTING TRAFFIC SIGNAL INSTALLATION
2.	1	EACH	REMOTE CONTROLLED VIDEO SYSTEM
3.	1	EACH	LAYER II (DATALINK) SWITCH
4.	251	FOOT	OUTDOOR RATED NETWORK CABLE
5.	1	EACH	CAMERA MOUNTING ASSEMBLY

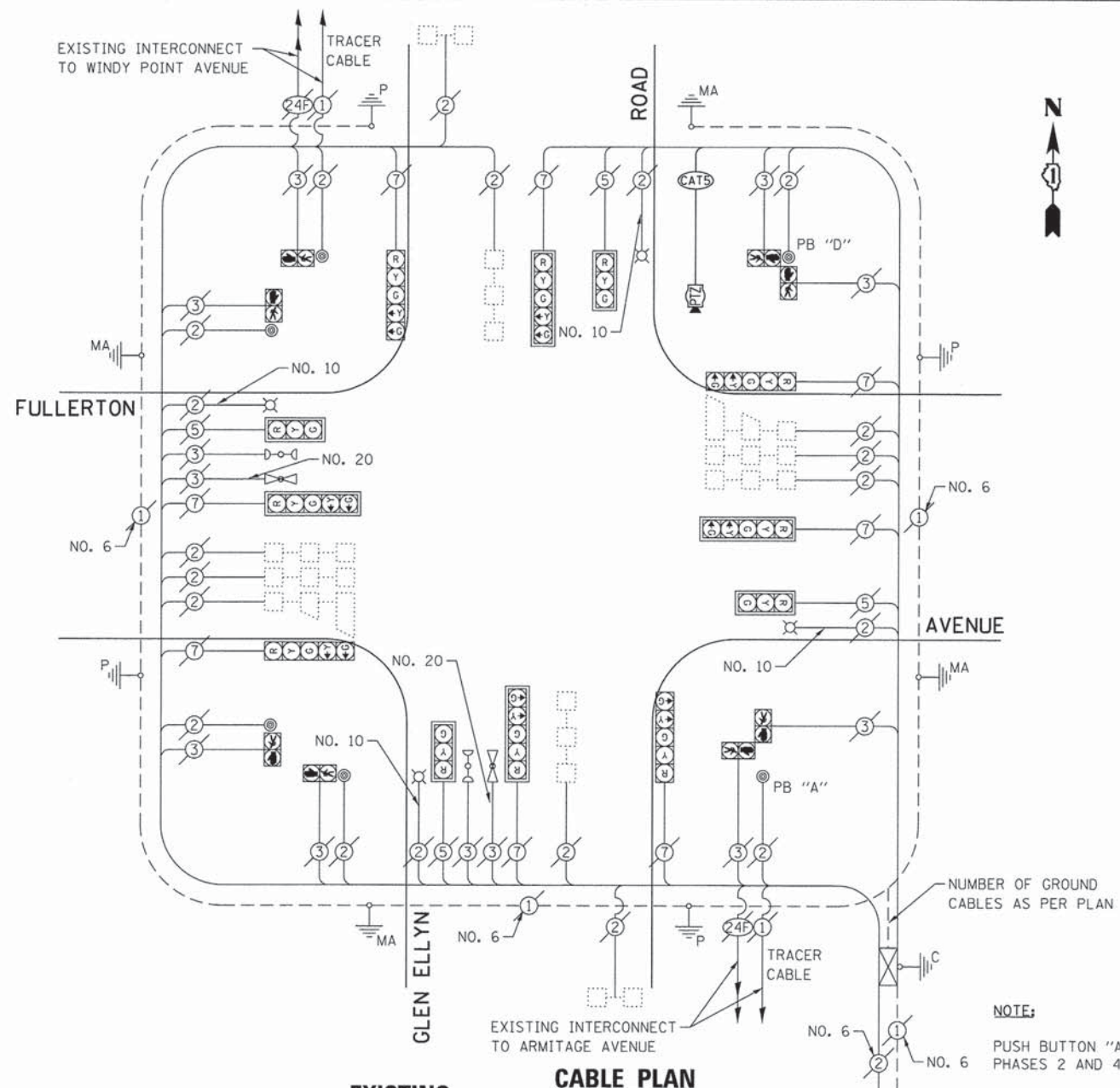

NOTE:
 PUSH BUTTON "A" SHALL PLACE A CALL IN PHASES 2 AND 4.
 PUSH BUTTON "D" SHALL PLACE A CALL IN PHASES 2 AND 8.
 THE EXISTING CONTROLLER IS AN ECONOLITE ASC3 IN A TS2 TYPE IV CABINET.

EXISTING CONTROLLER SEQUENCE

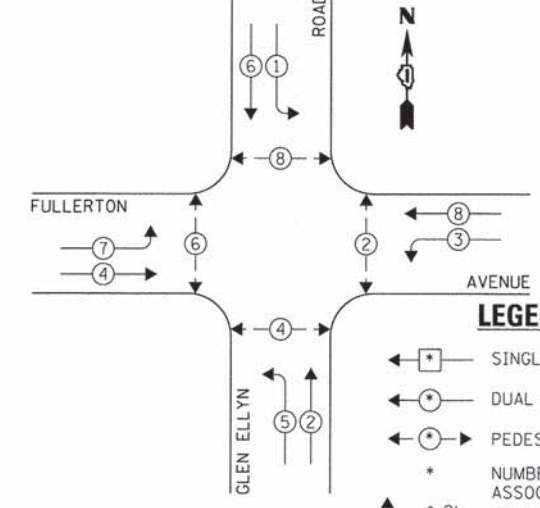

EXISTING EMERGENCY VEHICLE PREEMPTION SEQUENCE

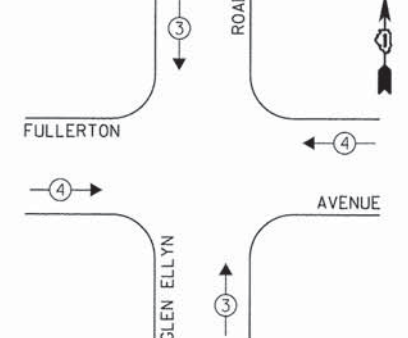

LEGEND:

- ◀ * → SINGLE ENTRY PHASE
- ◀ * → DUAL ENTRY PHASE
- ◀ * → PEDESTRIAN PHASE
- * NUMBER REFERS TO ASSOCIATED PHASE
- ◀ * → OVERLAP

EXISTING PHASE DESIGNATION DIAGRAM

EXISTING EMERGENCY VEHICLE PREEMPTORS	
EMERGENCY VEHICLE PREEMPTOR	3 4
MOVEMENT	↑ ↓ ← →

DUPAGE COUNTY DIVISION OF TRANSPORTATION TRAFFIC SIGNAL INSTALLATION ELECTRICAL SERVICE REQUIREMENTS					TOTAL WATTAGE
TYPE	NO. LAMPS	WATTAGE INCAND. L.E.D.	OPERATION		
SIGNAL (RED)	12	135	17	0.50	102.0
SIGNAL (YELLOW)	12	135	25	0.25	75.0
SIGNAL (GREEN)	12	135	15	0.25	45.0
ARROW	16	135	12	0.10	19.2
PED. SIGNAL	8	90	25	1.00	200.0
CONTROLLER	1	-	100	1.00	100.0
LUMINAIRE	4	-	250	0.50	500.0
L.E.D. ST. NAME SIGN	-	-	64	0.50	-
VIDEO SYSTEM	-	-	150	1.00	-
BATTERY BACKUP	-	-	25	1.00	-
ILLUMINATED SIGN	-	-	25	0.05	-
TOTAL =					1041.2

THE TRAFFIC SIGNAL CONTROL EQUIPMENT FOR THIS PROJECT SHALL BE "ECONOLITE" TO MATCH THE EXISTING ADJACENT SYSTEM.

ENERGY COSTS - BILLED TO: DUPAGE COUNTY D.O.T.
 (ADDRESS) 421 N. COUNTY FARM RD.
 (ADDRESS) WHEATON, IL 60187
 ENERGY SUPPLY - CONTACT: MR. JOE STACHO
 PHONE: (630) 424-5704
 COMPANY: COM-ED LOMBARD

FILE NAME =	USER NAME = zwallsten	DESIGNED -	JRD	REVISED -	
DIGIA92-101-TS.dgn		DRAWN -	ZCW	REVISED -	
Default		CHECKED -	KLB	REVISED -	
		DATE -		REVISED -	

STATE OF ILLINOIS
DEPARTMENT OF TRANSPORTATION

**SCHEDULE OF QUANTITIES, CABLE PLAN, PHASE DESIGNATION
 DIAGRAM, & EMERGENCY VEHICLE PREEMPTION SEQUENCE**
GLEN ELLYN ROAD AT FULLERTON AVENUE

F.A. RTE.	SECTION	COUNTY	TOTAL SHEETS	SHEET NO.
VAR.	11-DCCSS-00-TL	DuPAGE	123	101
			CONTRACT NO. 61A92	
ILLINOIS FED. AID PROJECT				

GHA #4281.810

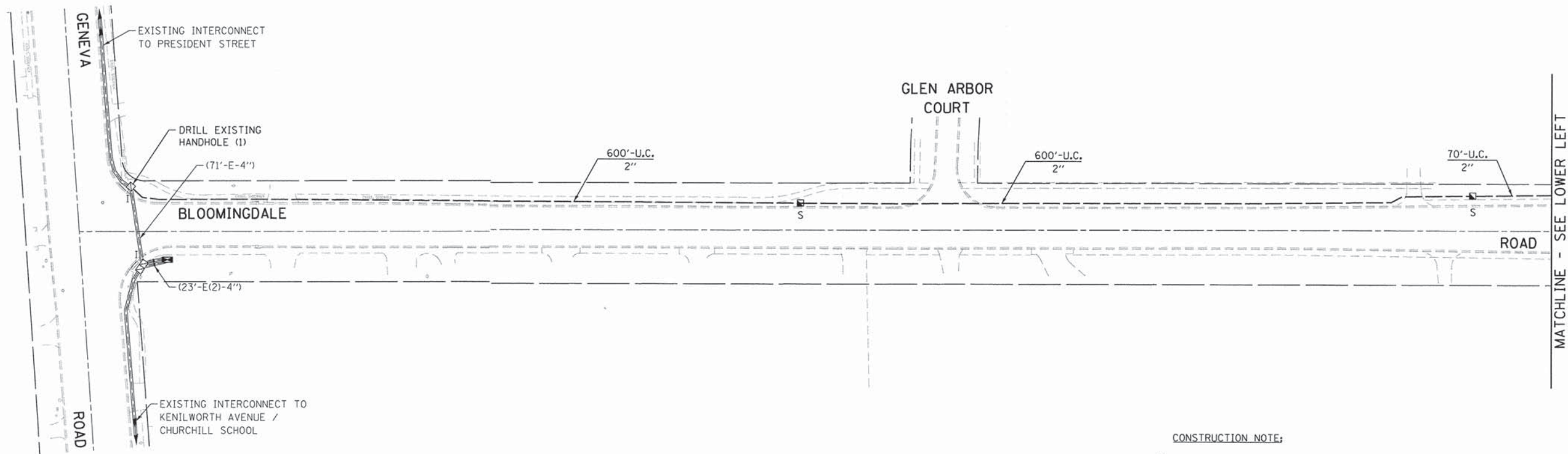

CONSTRUCTION NOTE:

① THE CONTRACTOR SHALL DISCONNECT THE EXISTING FIBER OPTIC CABLE IN THE CONTROLLER CABINETS AT ST. CHARLES ROAD AND SHOREWOOD DRIVE, THEN PULL THE EXISTING FIBER OPTIC CABLE FROM THE EXISTING CONDUIT, BUT THE EXISTING TRACER CABLE SHALL REMAIN IN PLACE AND REUSED. THE CONTRACTOR SHALL THEN PULL IN NEW FIBER OPTIC CABLE 24 FIBERS, SINGLE MODE.

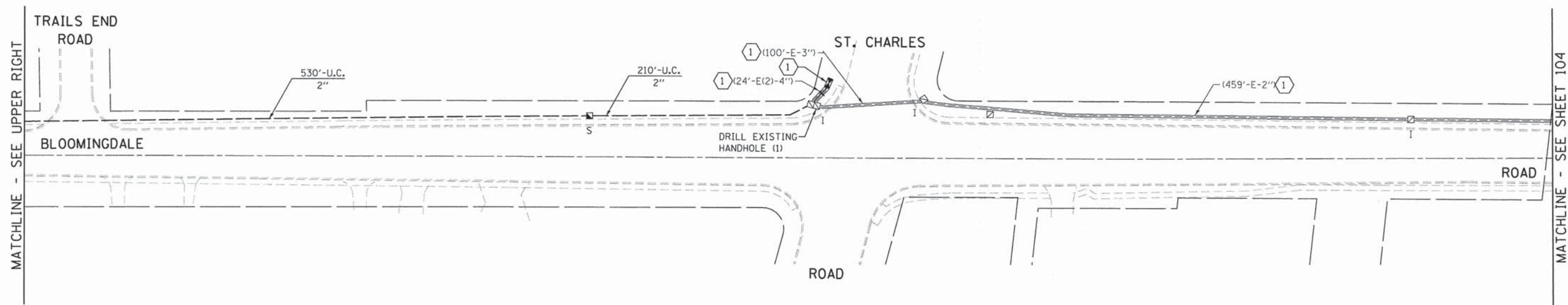

FILE NAME = D:\61A92-103-TS.dgn	USER NAME = zwallsten	DESIGNED - JRD	REVISED -	STATE OF ILLINOIS DEPARTMENT OF TRANSPORTATION	INTERCONNECT PLAN - (SHEET 1 OF 3) BLOOMINGDALE ROAD FROM GENEVA ROAD TO SIDNEY AVENUE				F.A. RTE.	SECTION	COUNTY	TOTAL SHEETS	SHEET NO.
	PLOT SCALE = 1:50	CHECKED - KLB	REVISED -		SCALE: 1"=50'	SHEET	OF	SHEETS	STA.	TO STA.	ILLINOIS FED. AID PROJECT	123	103
Default	PLOT DATE = 3/13/2015	DATE -	REVISED -								CONTRACT NO. 61A92		

GHA #4281.810

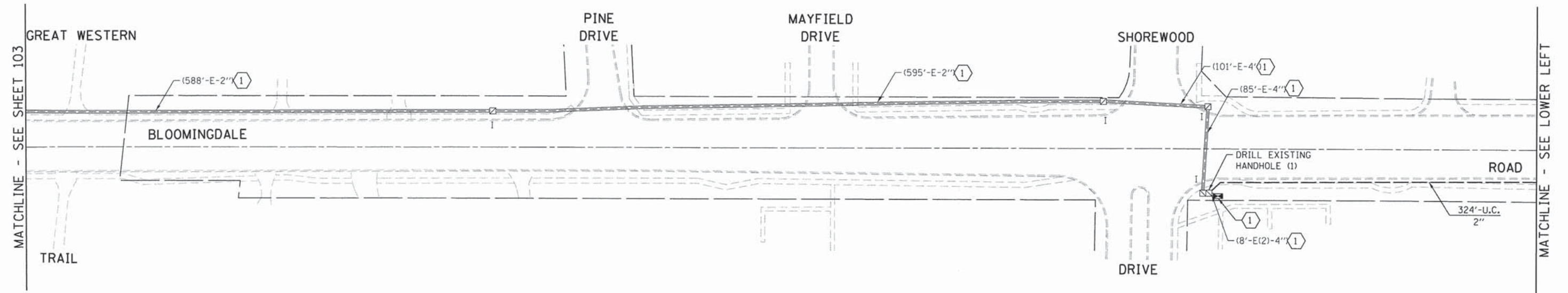

CONSTRUCTION NOTE:

① THE CONTRACTOR SHALL DISCONNECT THE EXISTING FIBER OPTIC CABLE IN THE CONTROLLER CABINETS AT ST. CHARLES ROAD AND SHOREWOOD DRIVE, THEN PULL THE EXISTING FIBER OPTIC CABLE FROM THE EXISTING CONDUIT, BUT THE EXISTING TRACER CABLE SHALL REMAIN IN PLACE AND REUSED. THE CONTRACTOR SHALL THEN PULL IN NEW FIBER OPTIC CABLE 24 FIBERS, SINGLE MODE.

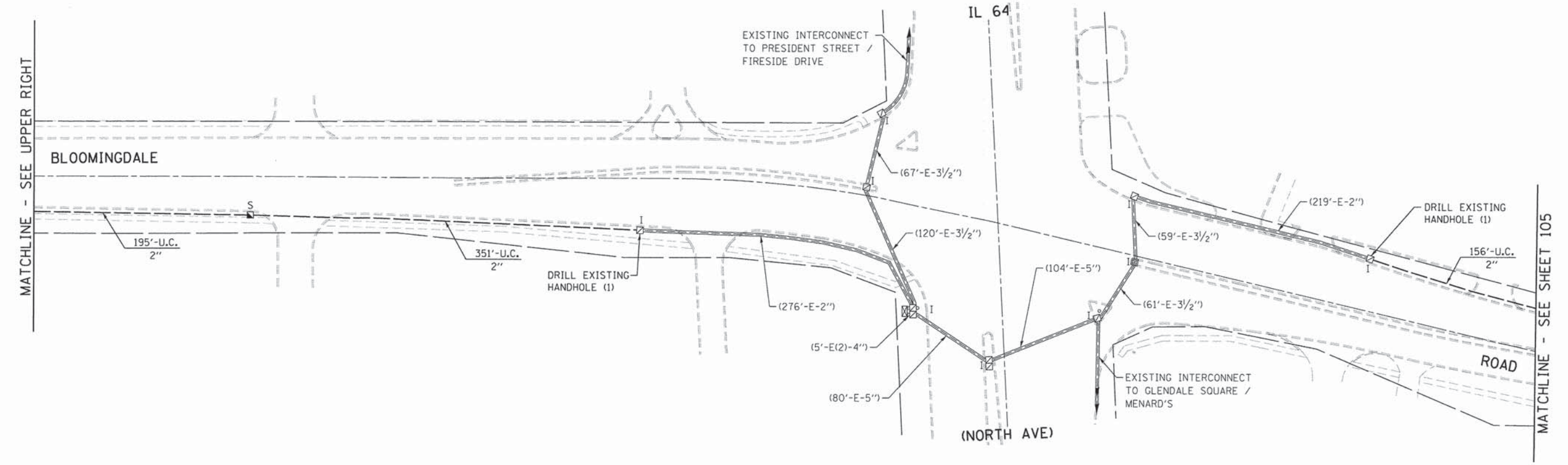

FILE NAME = D:\61A92-104-TS.dgn	USER NAME = zwallsten	DESIGNED - JRD	REVISED -
Default	PLOT SCALE = 1:50	DRAWN - ZCW	REVISED -
	PLOT DATE = 3/13/2015	CHECKED - KLB	REVISED -
		DATE -	REVISED -

**STATE OF ILLINOIS
DEPARTMENT OF TRANSPORTATION**

**INTERCONNECT PLAN - (SHEET 2 OF 3)
BLOOMINGDALE ROAD FROM GENEVA ROAD TO SIDNEY AVENUE**

SCALE: 1"=50' SHEET OF SHEETS STA. TO STA.

F.A. RTE.	SECTION	COUNTY	TOTAL SHEETS	SHEET NO.
VAR.	11-DCCSS-00-TL	DuPAGE	123	104
			CONTRACT NO. 61A92	
ILLINOIS FED. AID PROJECT				

GHA #4281.810

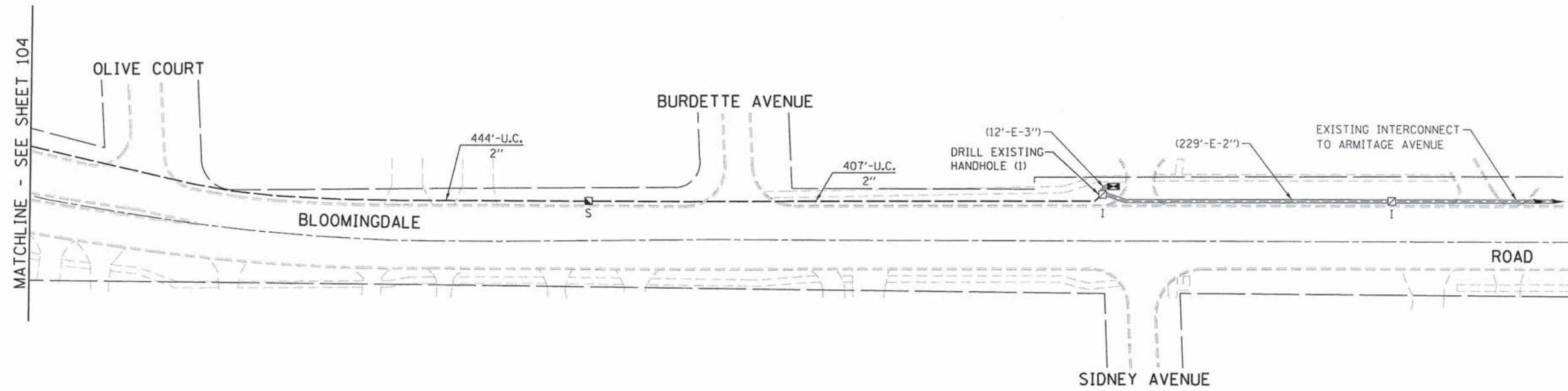

FILE NAME = D:\61A92-105-TS.dgn	USER NAME = zwellsten	DESIGNED - JRD	REVISED -
Default	PLOT SCALE = 1/50	DRAWN - ZCW	REVISED -
	PLOT DATE = 3/16/2015	CHECKED - KLB	REVISED -
		DATE -	REVISED -

**STATE OF ILLINOIS
DEPARTMENT OF TRANSPORTATION**

**INTERCONNECT PLAN - (SHEET 3 OF 3)
BLOOMINGDALE ROAD FROM GENEVA ROAD TO SIDNEY AVENUE**

SCALE: 1"=50' SHEET OF SHEETS STA. TO STA.

F.A. RTE.	SECTION	COUNTY	TOTAL SHEETS	SHEET NO.
VAR.	11-DCCSS-00-TL	DuPAGE	123	105
			CONTRACT NO. 61A92	
ILLINOIS FED. AID PROJECT				

GHA #4281.810

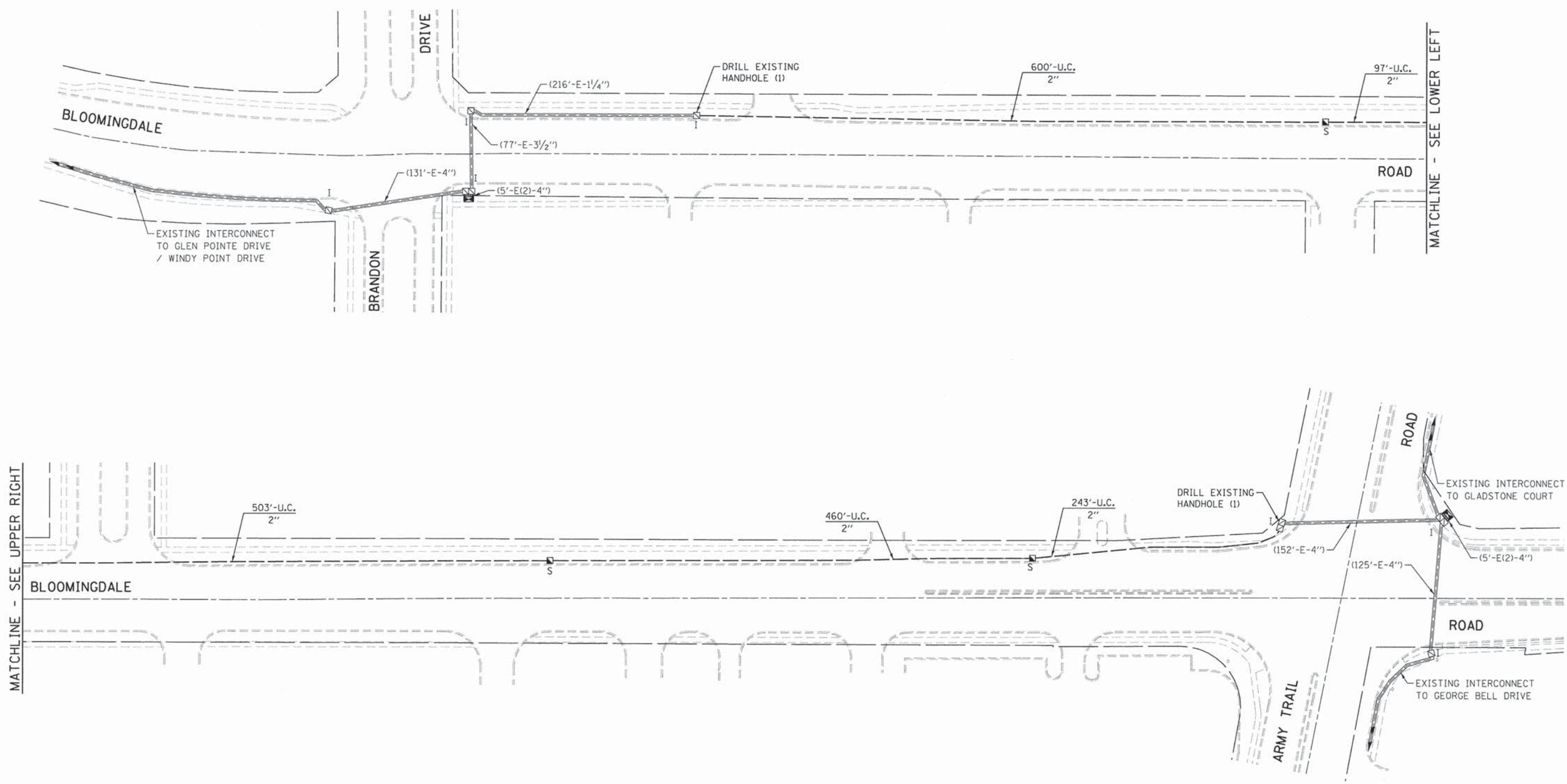

FILE NAME = D:\61A92-106-TS.dgn	USER NAME = zwallsten	DESIGNED - JRD	REVISED -	STATE OF ILLINOIS DEPARTMENT OF TRANSPORTATION	INTERCONNECT PLAN			F.A. RTE.	SECTION	COUNTY	TOTAL SHEET NO.
	PLOT SCALE = 1:50	DRAWN - ZCW	REVISED -		BLOOMINGDALE ROAD FROM BRANDON DRIVE TO ARMY TRAIL ROAD			VAR.	11-DCCSS-00-TL	DuPAGE	123 106
Default	PLOT DATE = 3/13/2015	CHECKED - KLB	REVISED -	SCALE: 1"=50' SHEET OF SHEETS STA. TO STA.			CONTRACT NO. 61A92				
							ILLINOIS FED. AID PROJECT				

GHA #4281.810

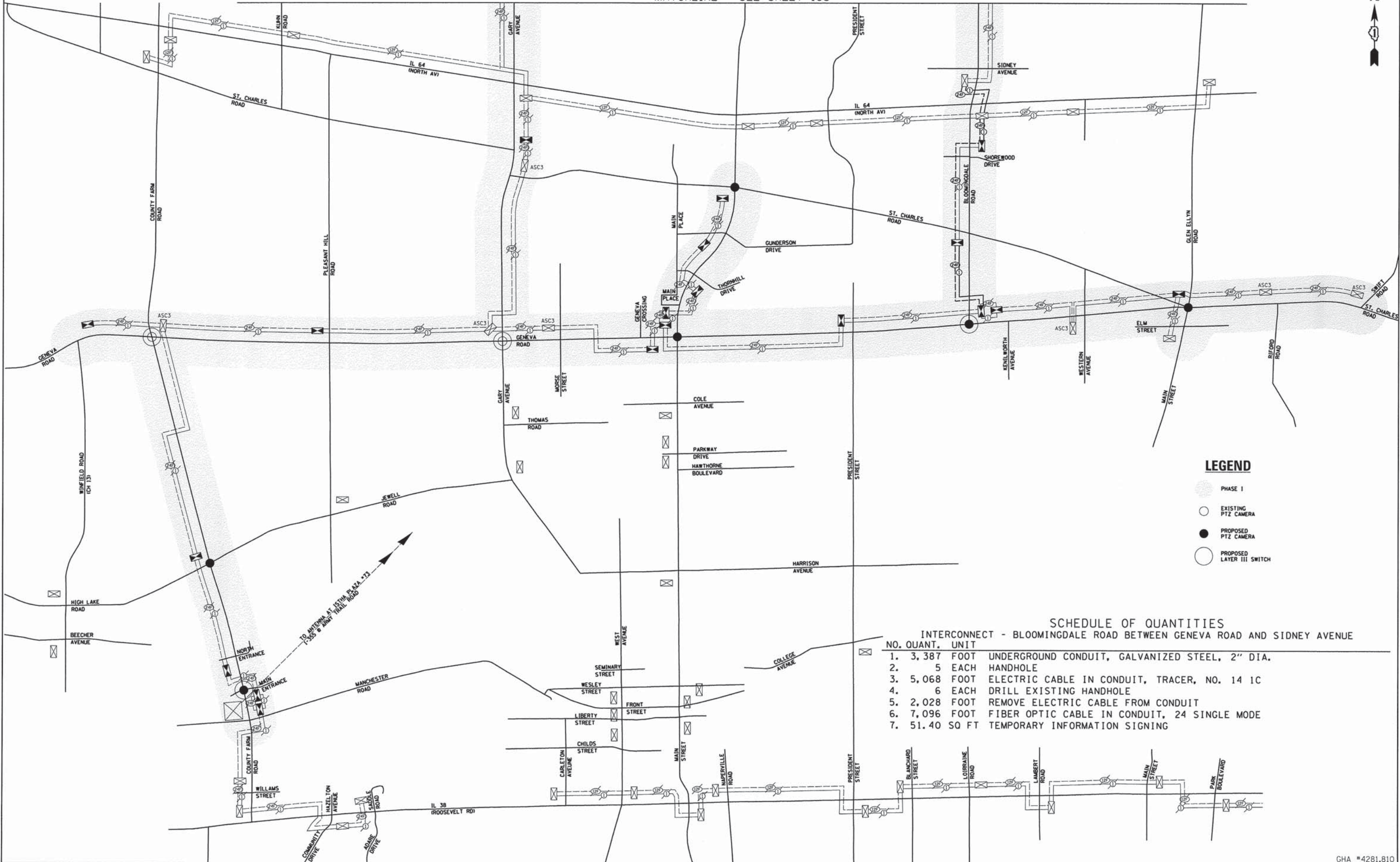

- LEGEND**
- PHASE I
 - EXISTING PTZ CAMERA
 - PROPOSED PTZ CAMERA
 - PROPOSED LAYER III SWITCH

SCHEDULE OF QUANTITIES
INTERCONNECT - BLOOMINGDALE ROAD BETWEEN GENEVA ROAD AND SIDNEY AVENUE

NO.	QUANT.	UNIT
1.	3,387	FOOT UNDERGROUND CONDUIT, GALVANIZED STEEL, 2" DIA.
2.	5	EACH HANDHOLE
3.	5,068	FOOT ELECTRIC CABLE IN CONDUIT, TRACER, NO. 14 1C
4.	6	EACH DRILL EXISTING HANDHOLE
5.	2,028	FOOT REMOVE ELECTRIC CABLE FROM CONDUIT
6.	7,096	FOOT FIBER OPTIC CABLE IN CONDUIT, 24 SINGLE MODE
7.	51.40	SQ FT TEMPORARY INFORMATION SIGNING

FILE NAME = DIG1A92-107-TS.dgn	USER NAME = zwallsten	DESIGNED - JRD	REVISED -
Default	PLOT SCALE = 1:50	DRAWN - ZCW	REVISED -
	PLOT DATE = 3/16/2015	CHECKED - KLB	REVISED -
		DATE -	REVISED -

**STATE OF ILLINOIS
DEPARTMENT OF TRANSPORTATION**

INTERCONNECT SCHEMATIC - (SHEET 1 OF 2)

SCALE: NONE	SHEET	OF	SHEETS	STA.	TO	STA.
-------------	-------	----	--------	------	----	------

F.A. RTE.	SECTION	COUNTY	TOTAL SHEET NO.
VAR.	11-DCCSS-00-TL	DuPAGE	123 107
			CONTRACT NO. 61A92
ILLINOIS FED. AID PROJECT			

GHA #4281.810

SCHEDULE OF QUANTITIES

INTERCONNECT - BLOOMINGDALE ROAD BETWEEN BRANDON DRIVE AND ARMY TRAIL ROAD

NO.	QUANT.	UNIT
1.	1,903	FOOT UNDERGROUND CONDUIT, GALVANIZED STEEL, 2" DIA.
2.	3	EACH HANDHOLE
3.	2,439	FOOT ELECTRIC CABLE IN CONDUIT, TRACER, NO. 14 1C
4.	2	EACH DRILL EXISTING HANDHOLE
5.	2,439	FOOT FIBER OPTIC CABLE IN CONDUIT, 24 SINGLE MODE
6.	51.40	SO FT TEMPORARY INFORMATION SIGNING

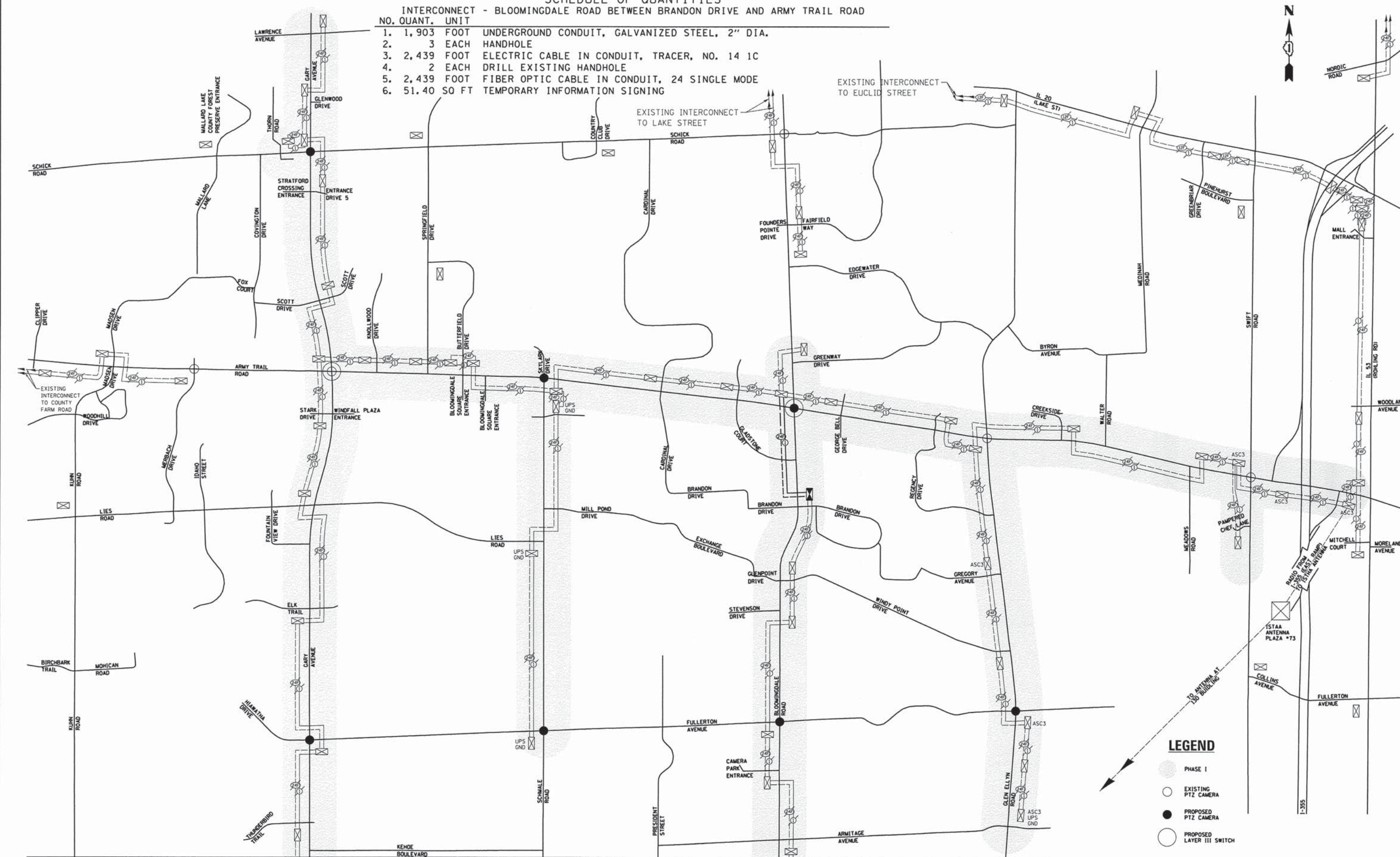

LEGEND

- PHASE I
- EXISTING PTZ CAMERA
- PROPOSED PTZ CAMERA
- PROPOSED LAYER III SWITCH

MATCHLINE - SEE SHEET 102

FILE NAME = D161A92-100-TS.dgn	USER NAME = zwo11sten	DESIGNED - JRD	REVISED -
Default	PLOT SCALE = 1:50	DRAWN - ZCW	REVISED -
	PLOT DATE = 3/16/2015	CHECKED - KLB	REVISED -
		DATE -	REVISED -









STATE OF ILLINOIS
DEPARTMENT OF TRANSPORTATION

INTERCONNECT SCHEMATIC - (SHEET 2 OF 2)

SCALE: NONE SHEET OF SHEETS STA. TO STA.

F.A. RTE.	SECTION	COUNTY	TOTAL SHEETS	NO.
VAR.	11-DCCSS-00-TL	DuPAGE	123	108
			CONTRACT NO. 61A92	
ILLINOIS FED. AID PROJECT				

GHA #4281.810

-  EXISTING CONNECTOR / EXISTING SM FIBER
-  NEW CONNECTOR / EXISTING SM FIBER
-  EXISTING FUSION SPLICE / EXISTING SM FIBER
-  NEW FUSION SPLICE / EXISTING SM FIBER
-  NEW CONNECTOR / NEW SM FIBER
-  NEW FUSION SPLICE / NEW SM FIBER
-  *EXISTING MM FIBER
-  *NEW MM FIBER

*MM FIBER EXISTS THROUGHOUT THE SYSTEM - IT IS SHOWN ONLY IN AREAS OF INTEREST

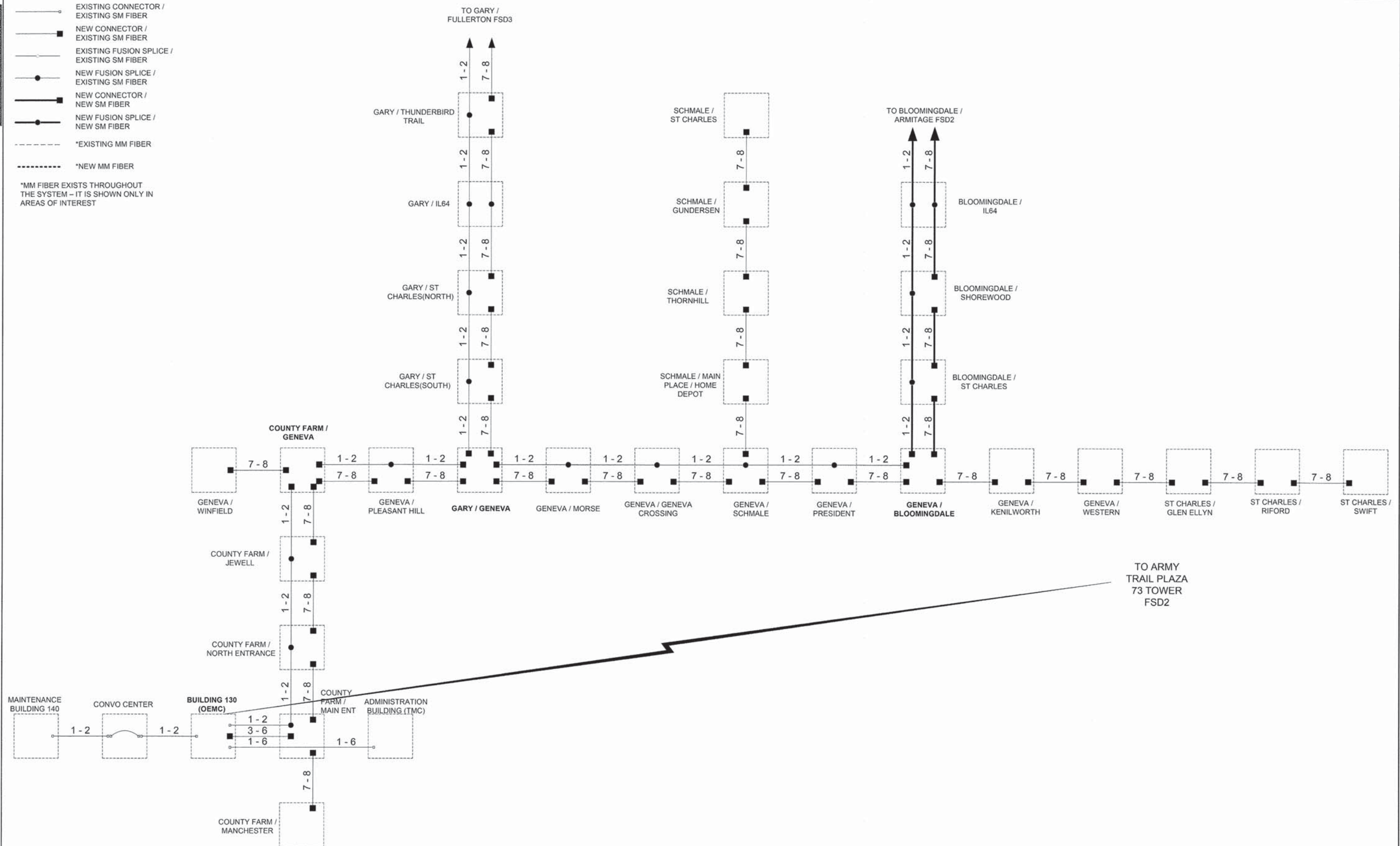

	DESIGNED - DG	REVISED -	DUPAGE COUNTY DIVISION OF TRANSPORTATION	FIBER SPLICING DIAGRAM 1 COUNTY FARM / MAIN ENTRANCE	ROUTE	SECTION	ROUTE SECTION	SHEET	SHEETS
	DRAWN - YM	REVISED -			VAR.		11-DCCSS-00-TL	109	123
	CHECKED - DG	REVISED -							
	DATE - 02/06/2015	REVISED -							
				SCALE N/A					61A92



- EXISTING CONNECTOR / EXISTING SM FIBER
 - NEW CONNECTOR / EXISTING SM FIBER
 - EXISTING FUSION SPLICE / EXISTING SM FIBER
 - NEW FUSION SPLICE / EXISTING SM FIBER
 - NEW CONNECTOR / NEW SM FIBER
 - NEW FUSION SPLICE / NEW SM FIBER
 - *EXISTING MM FIBER
 - *NEW MM FIBER
- *MM FIBER EXISTS THROUGHOUT THE SYSTEM - IT IS SHOWN ONLY IN AREAS OF INTEREST

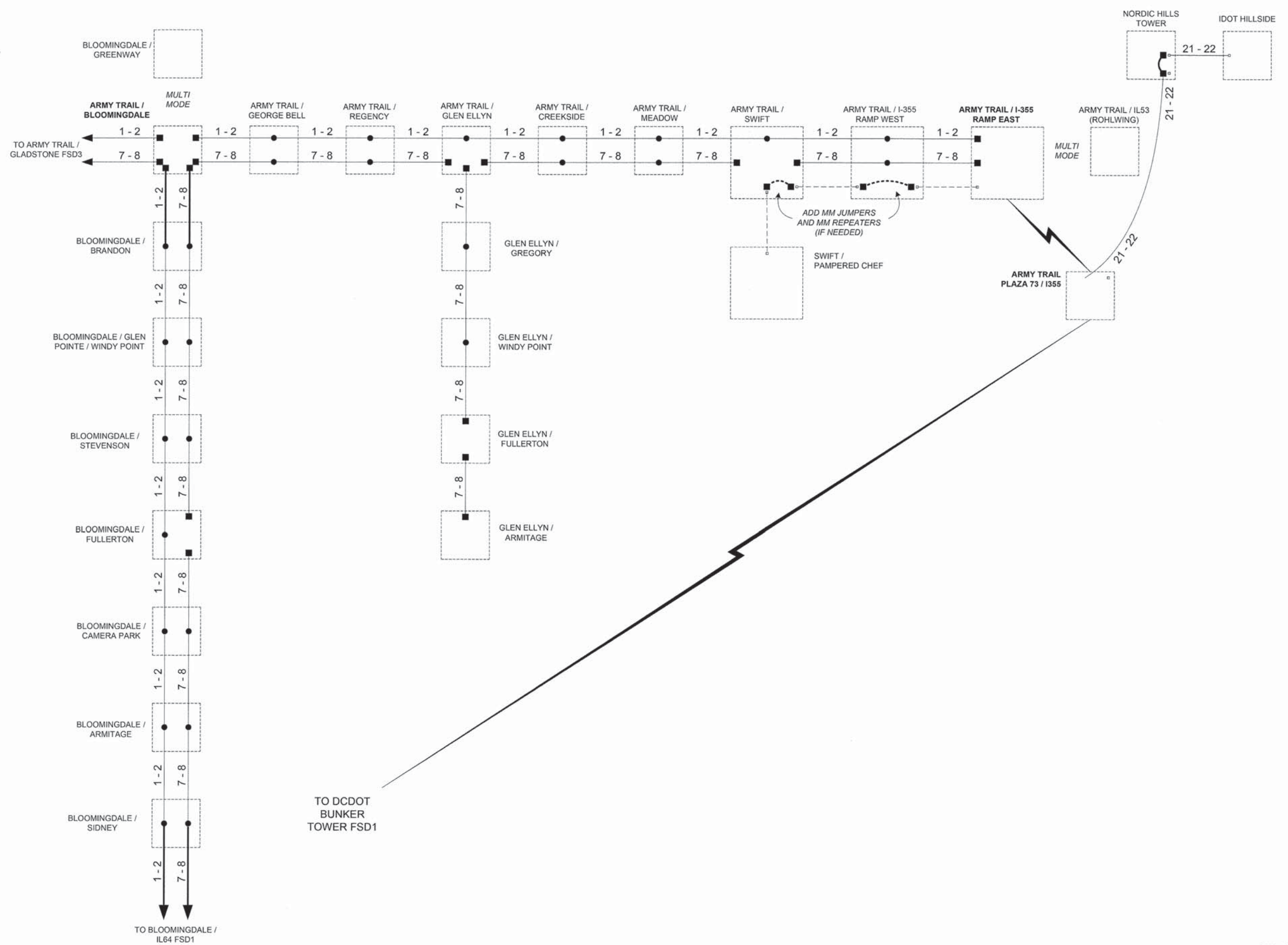

GHA #4281.810

	DESIGNED - DG	REVISED -	DUPAGE COUNTY DIVISION OF TRANSPORTATION	FIBER SPLICING DIAGRAM 2 ARMY TRAIL / BLOOMINGDALE	ROUTE	SECTION	ROUTE SECTION	SHEET	SHEETS
	DRAWN - YM	REVISED -			VAR.		11-DCC55-00-TL	110	123
	CHECKED - DG	REVISED -							
	DATE - 02/06/2015	REVISED -							
				SCALE N/A					61A92



- EXISTING CONNECTOR / EXISTING SM FIBER
- NEW CONNECTOR / EXISTING SM FIBER
- EXISTING FUSION SPLICE / EXISTING SM FIBER
- NEW FUSION SPLICE / EXISTING SM FIBER
- NEW CONNECTOR / NEW SM FIBER
- NEW FUSION SPLICE / NEW SM FIBER
- *EXISTING MM FIBER
- *NEW MM FIBER

*MM FIBER EXISTS THROUGHOUT THE SYSTEM - IT IS SHOWN ONLY IN AREAS OF INTEREST

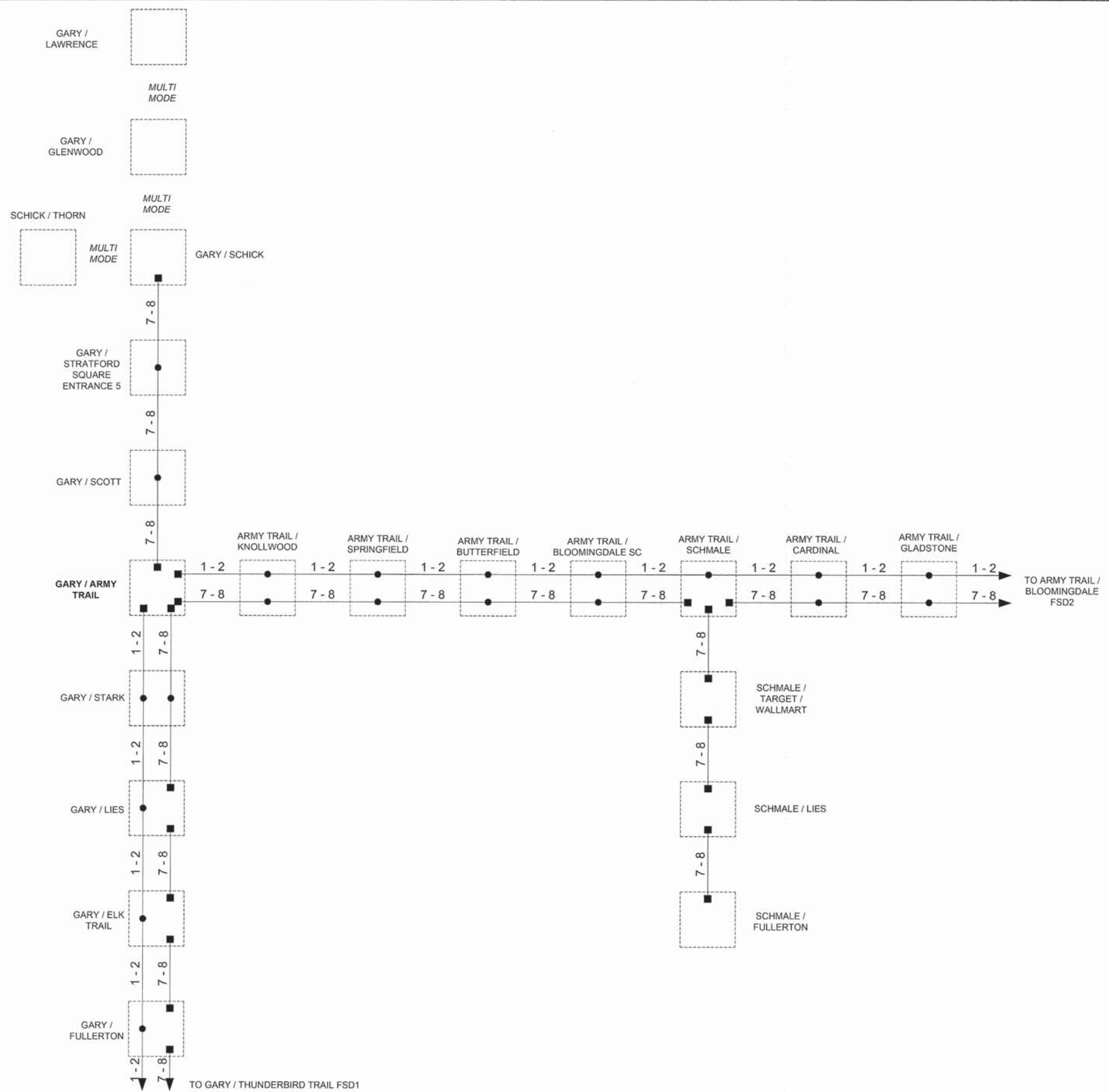

GHA #4281.810

	DESIGNED - DG	REVISED -	DUPAGE COUNTY DIVISION OF TRANSPORTATION	FIBER SPLICING DIAGRAM 3 GARY / ARMY TRAIL		ROUTE	SECTION	ROUTE SECTION	SHEET	SHEETS
	DRAWN - YM	REVISED -		SCALE N/A	VAR.		11-DCCSS-00-TL	111	123	
	CHECKED - DG	REVISED -								
	DATE - 02/06/2015	REVISED -							61A92	

- EXISTING MULTIMODE CONNECTION
- NEW MULTIMODE CONNECTION
- EXISTING SINGLEMODE CONNECTION
- NEW SINGLEMODE CONNECTION
- EXISTING EQUIPMENT
- NEW EQUIPMENT

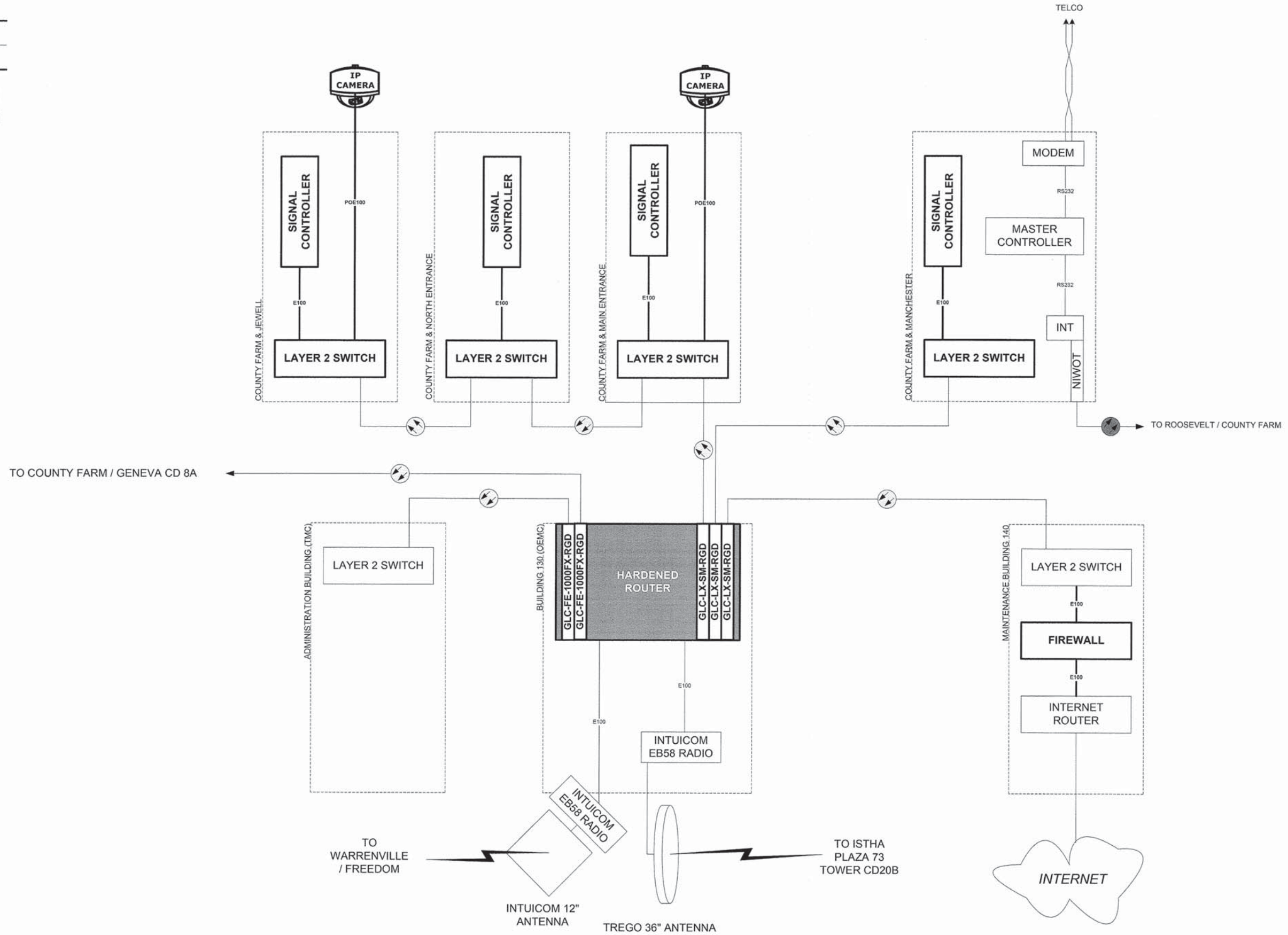

CHA #4281.810

	DESIGNED - DG	REVISED -	DUPAGE COUNTY DIVISION OF TRANSPORTATION	CABINET DETAIL 4A COUNTY FARM / MAIN ENTRANCE	ROUTE	SECTION	ROUTE SECTION	SHEET	SHEETS
	DRAWN - YM	REVISED -		SCALE N/A	VAR.		11-DCCSS-00-TL	112	123
	CHECKED - DG	REVISED -							
	DATE - 02/06/2015	REVISED -							61A92



- EXISTING MULTIMODE CONNECTION
- NEW MULTIMODE CONNECTION
- EXISTING SINGLEMODE CONNECTION
- NEW SINGLEMODE CONNECTION
- EXISTING EQUIPMENT
- NEW EQUIPMENT

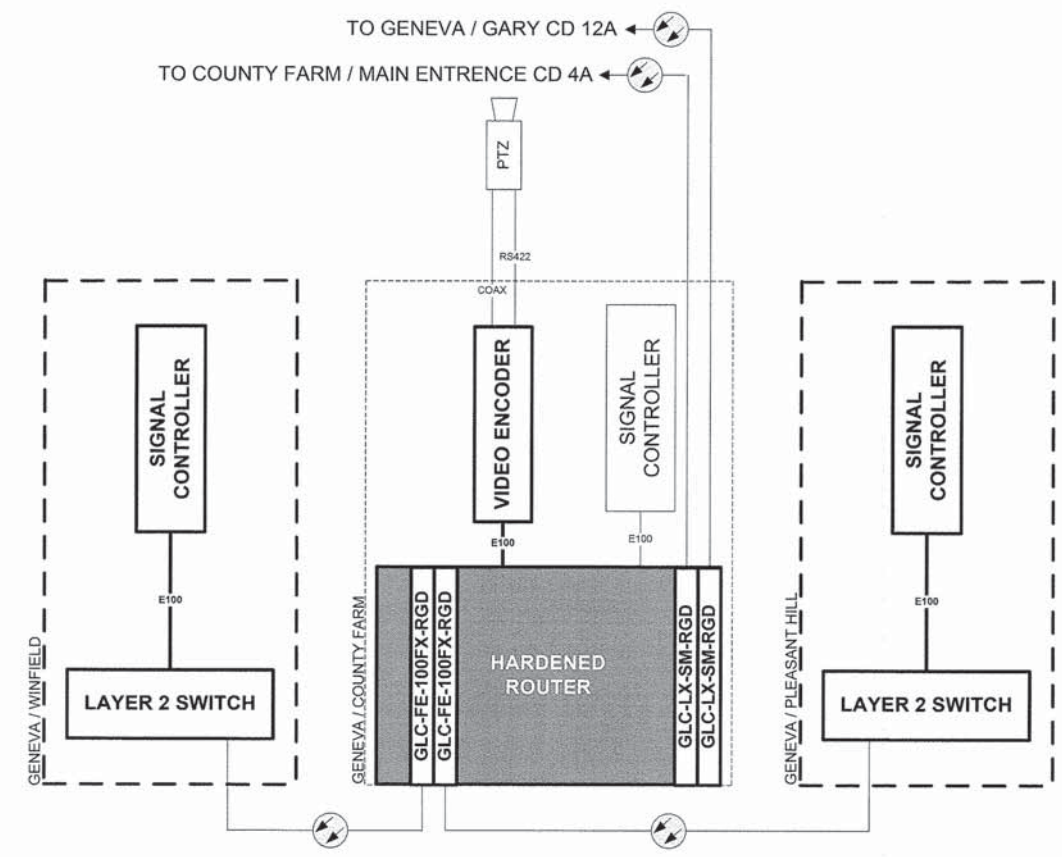

GHA #4281.810

	DESIGNED - DG	REVISED -	DUPAGE COUNTY DIVISION OF TRANSPORTATION	CABINET DETAIL 8A GENEVA / COUNTY FARM	ROUTE	SECTION	ROUTE SECTION	SHEET	SHEETS		
	DRAWN - YM	REVISED -			VAR.		11-DCCSS-00-TL	113	123		
	CHECKED - DG	REVISED -									
	DATE - 02/06/2015	REVISED -			61A92						
					SCALE N/A						

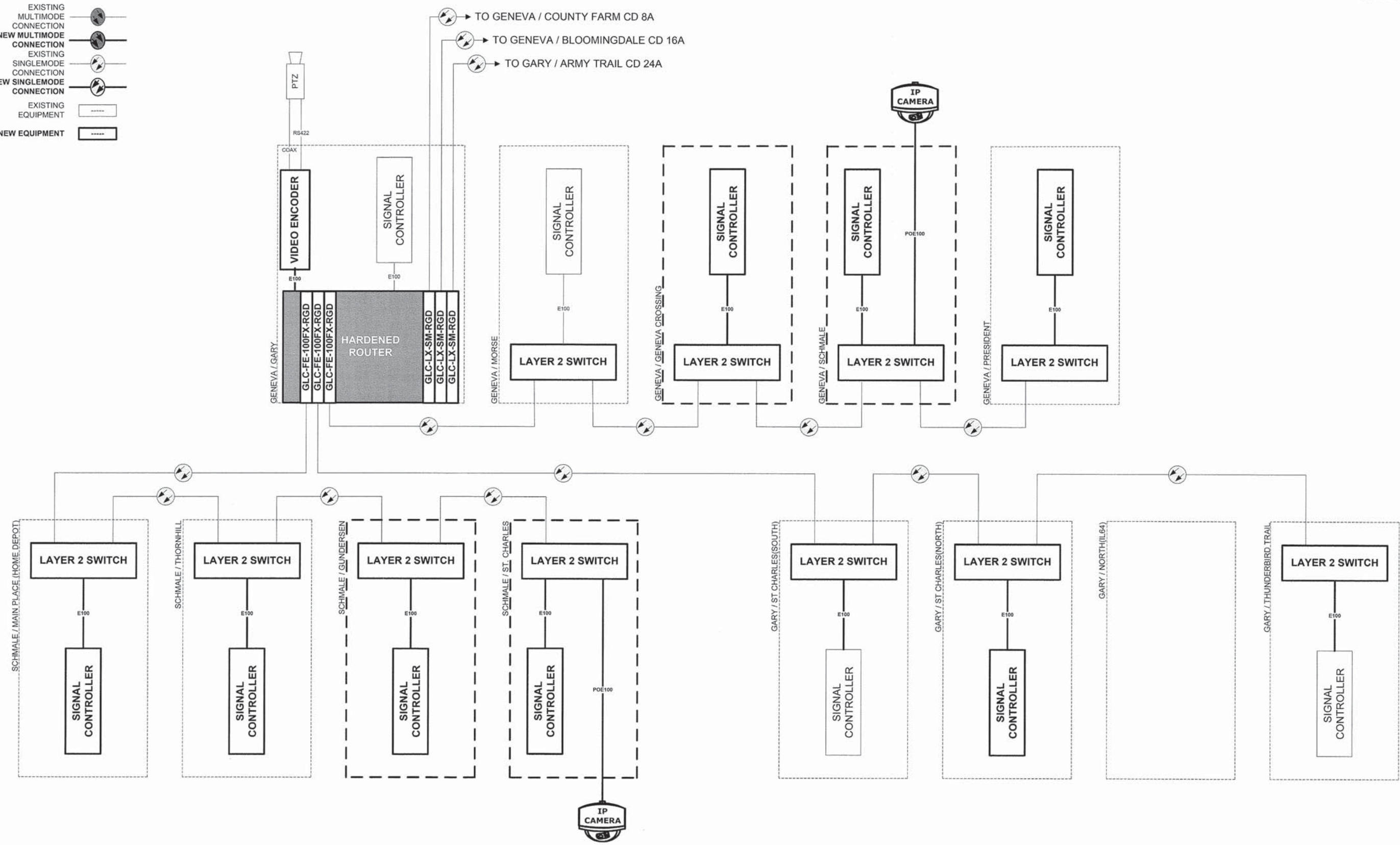
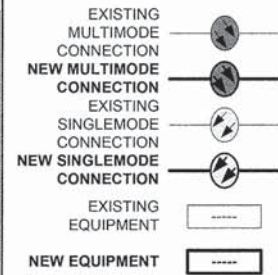

CHA #4281.810

DESIGNED - DG DRAWN - YM CHECKED - DG DATE - 02/06/2015	REVISED - REVISED - REVISED - REVISED -	DUPAGE COUNTY DIVISION OF TRANSPORTATION	CABINET DETAIL 12A GENEVA / GARY		ROUTE	SECTION	ROUTE SECTION	SHEET	SHEETS
			SCALE N/A	VAR.		11-DCCSS-00-TL	114	123	

- EXISTING MULTIMODE CONNECTION
- NEW MULTIMODE CONNECTION
- EXISTING SINGLEMODE CONNECTION
- NEW SINGLEMODE CONNECTION
- EXISTING EQUIPMENT
- NEW EQUIPMENT

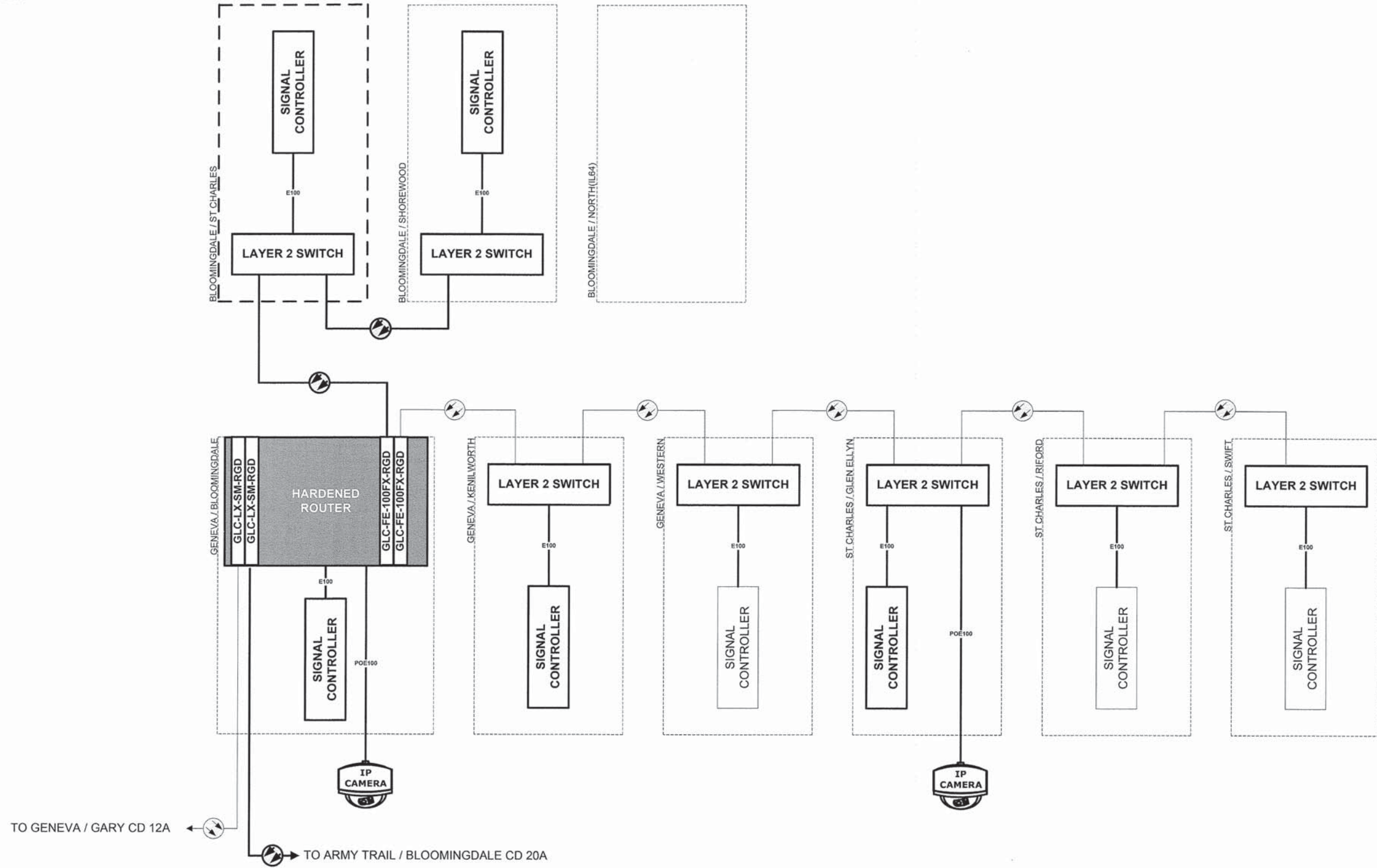

TO GENEVA / GARY CD 12A ←

← TO ARMY TRAIL / BLOOMINGDALE CD 20A

	DESIGNED - DG	REVISED -	DUPAGE COUNTY DIVISION OF TRANSPORTATION	CABINET DETAIL 16A GENEVA / BLOOMINGDALE	ROUTE	SECTION	ROUTE SECTION	SHEET	SHEETS
	DRAWN - YM	REVISED -			VAR.		11-DCCSS-00-TL	115	123
	CHECKED - DG	REVISED -							
	DATE - 02/06/2015	REVISED -							
				SCALE N/A				61A92	

- EXISTING MULTIMODE CONNECTION
- NEW MULTIMODE CONNECTION
- EXISTING SINGLEMODE CONNECTION
- NEW SINGLEMODE CONNECTION
- EXISTING EQUIPMENT
- NEW EQUIPMENT

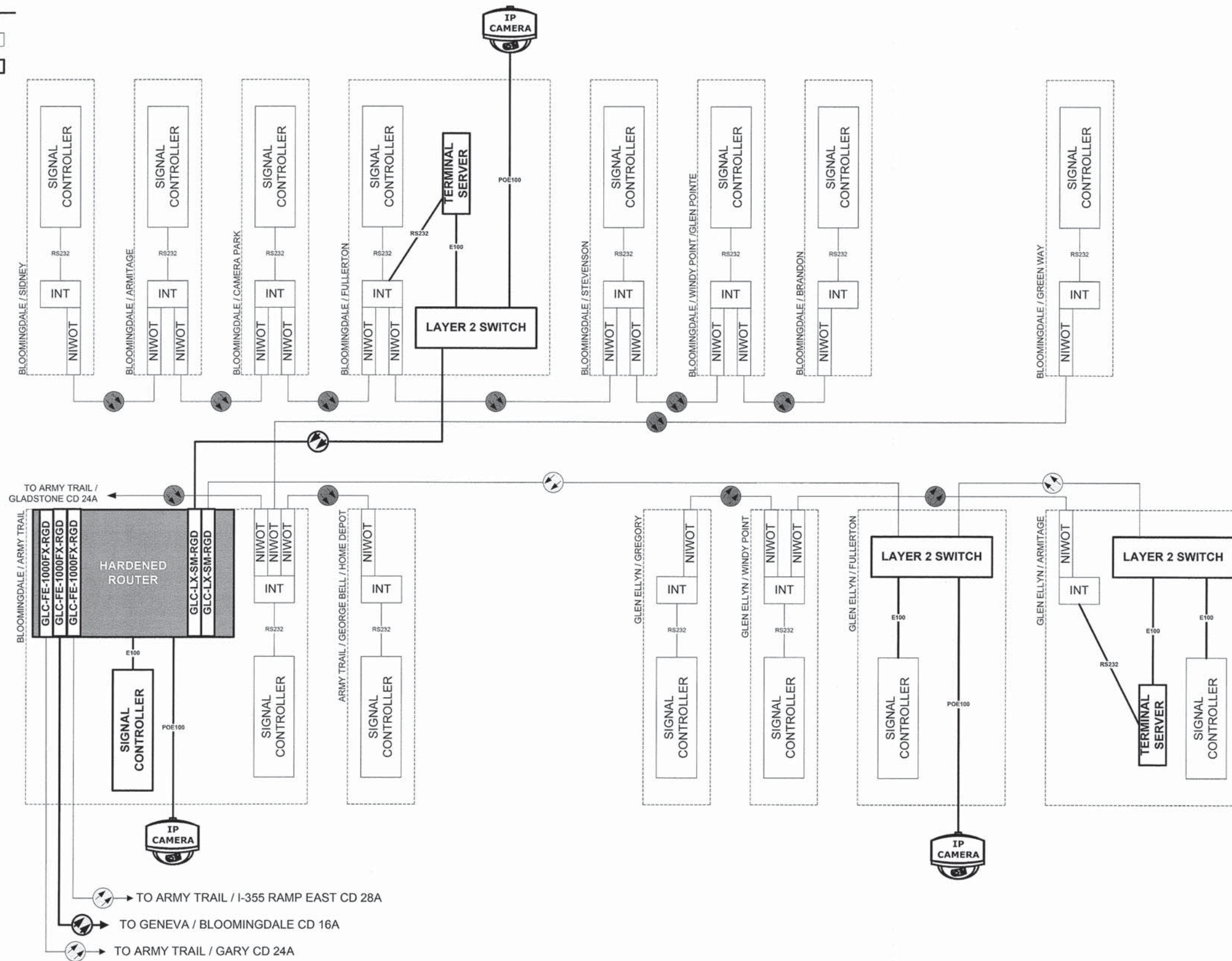

GHA #4281.810

	DESIGNED - DG	REVISED -	DUPAGE COUNTY DIVISION OF TRANSPORTATION	CABINET DETAIL 20A BLOOMINGDALE / ARMY TRAIL	ROUTE SECTION	ROUTE SECTION	SHEET	SHEETS
	DRAWN - YM	REVISED -			VAR.	11-DCC55-00-TL	116	123
	CHECKED - DG	REVISED -		SCALE N/A				
	DATE - 02/06/2015	REVISED -						61A92

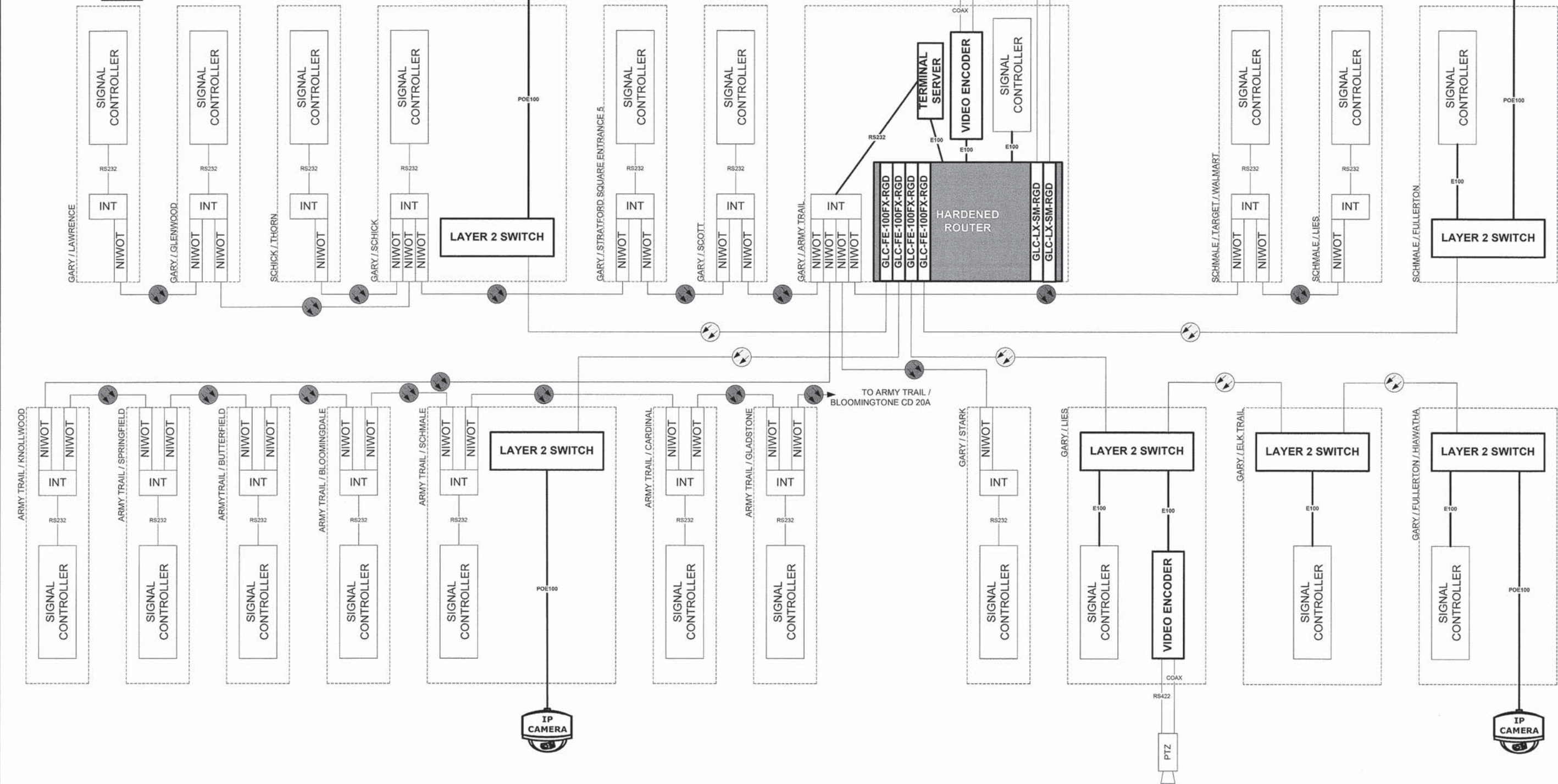
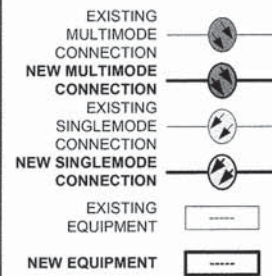

DESIGNED - DG		REVISED -		DUPAGE COUNTY DIVISION OF TRANSPORTATION		CABINET DETAIL 24A GARY / ARMY TRAIL		ROUTE	SECTION	ROUTE SECTION	SHEET	SHEETS			
DRAWN - YM		REVISED -						VAR.		11-DCCSS-00-TL	117	123			
CHECKED - DG		REVISED -													
DATE - 02/06/2015		REVISED -													

GHA #4281.810

SCALE N/A

61A92

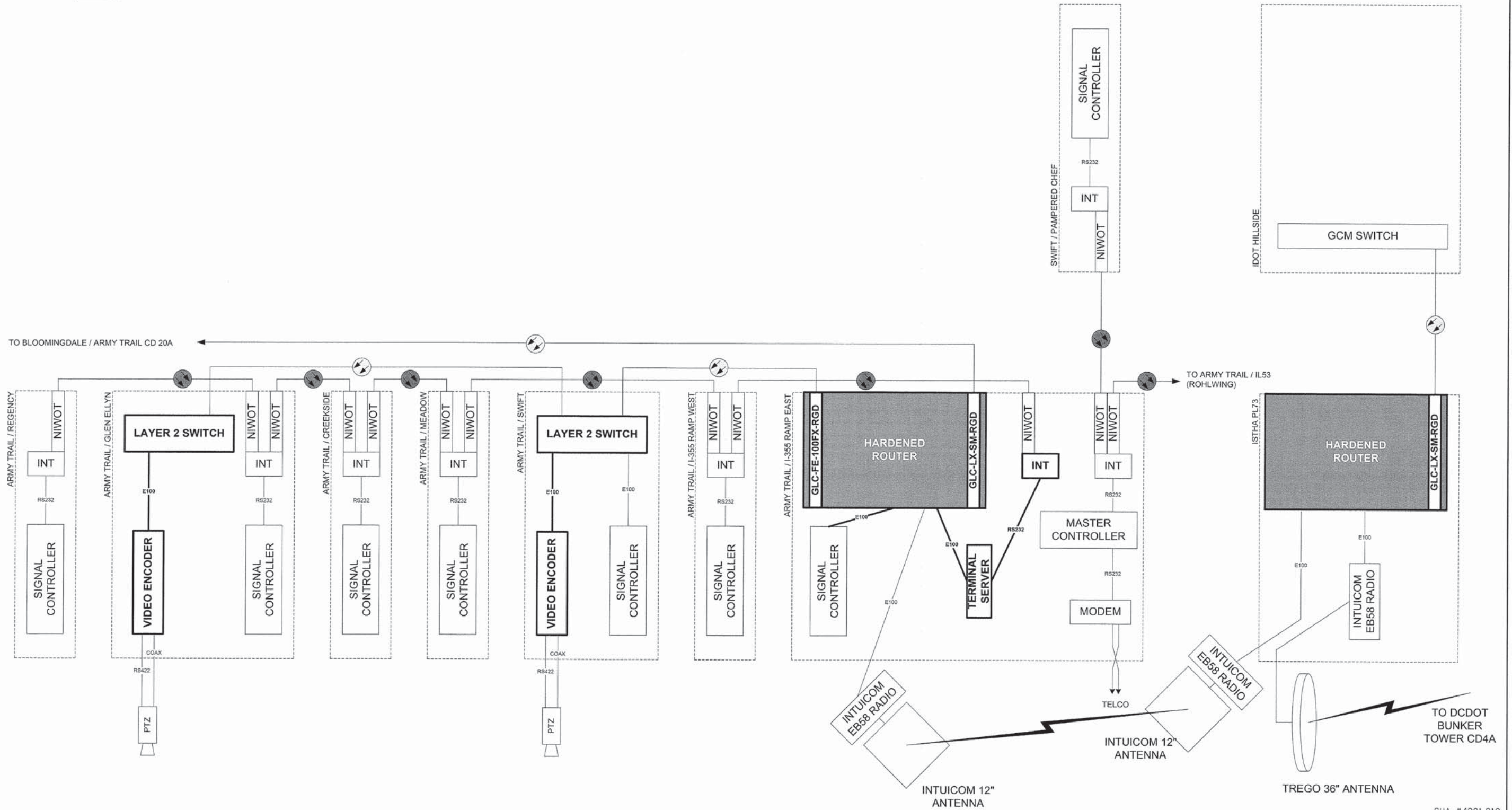
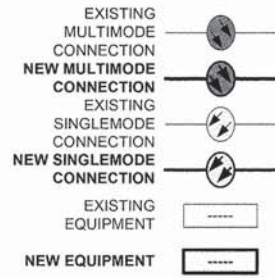

TO BLOOMINGDALE / ARMY TRAIL CD 20A

TO ARMY TRAIL / IL53 (ROHLWING)

TO DCDOT BUNKER TOWER CD4A

CHA #4281.810

	DESIGNED - DG	REVISED -	DUPAGE COUNTY DIVISION OF TRANSPORTATION	CABINET DETAIL 28A I355 / ARMY TRAIL	ROUTE	SECTION	ROUTE SECTION	SHEET	SHEETS	
	DRAWN - YM	REVISED -			VAR.		11-DCCSS-00-TL	118	123	
	CHECKED - DG	REVISED -								
	DATE - 02/06/2015	REVISED -								
					SCALE N/A					

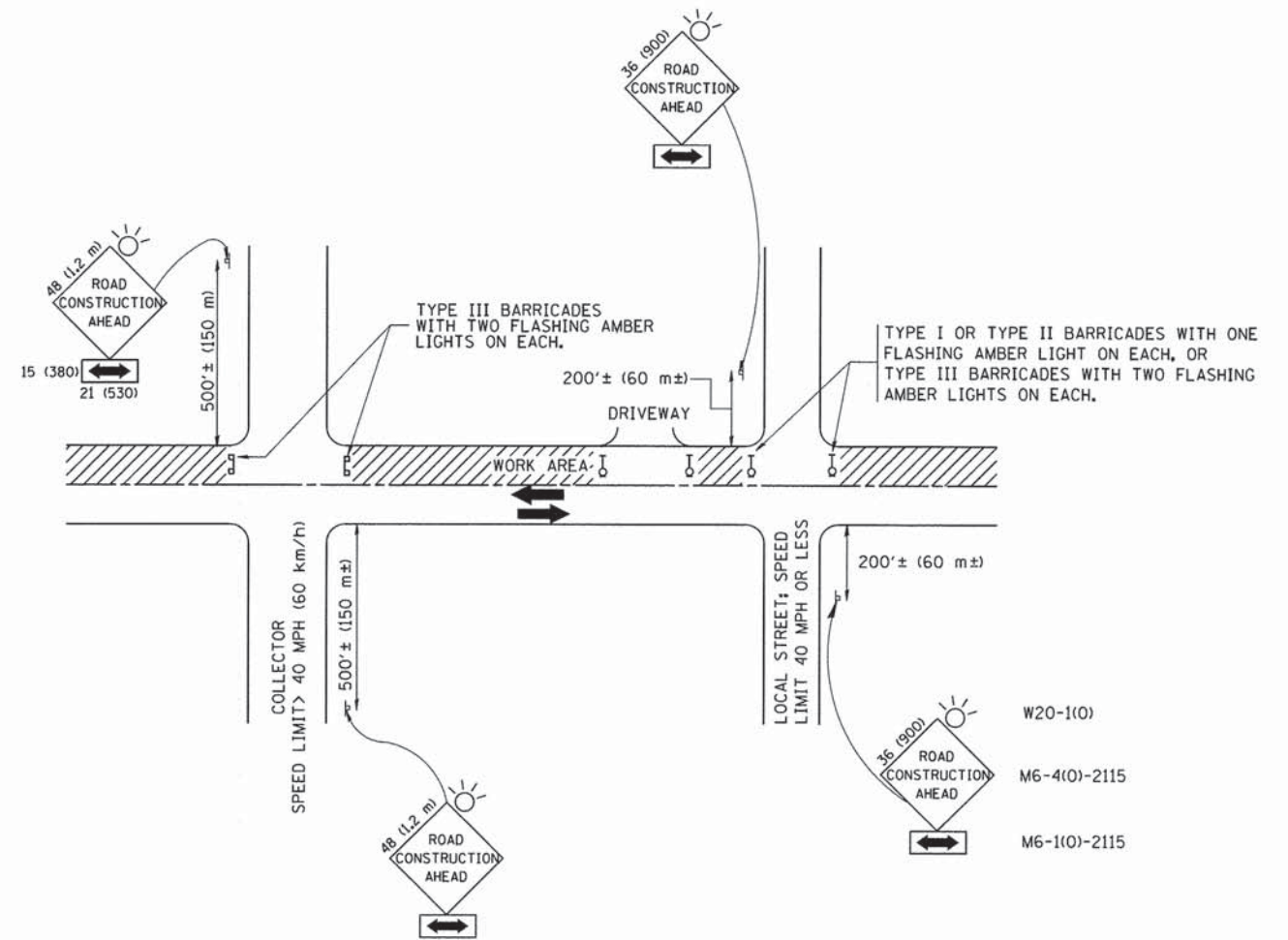

W20-1(0)
M6-4(0)-2115
M6-1(0)-2115

TRAFFIC CONTROL AND PROTECTION FOR SIDE ROADS, INTERSECTIONS, AND DRIVEWAYS

NOTES:

- A. FOR NO LANE RESTRICTION ON THE SIDE ROAD OR DRIVEWAYS
- SIDE ROAD WITH A SPEED LIMIT OF 40 MPH (60 km/h) OR LESS AS SHOWN ON THE DRAWING AND AS DIRECTED BY THE ENGINEER:
 - ONE ROAD CONSTRUCTION AHEAD SIGN 36 x 36 (900x900) WITH A FLASHER AND FLAG MOUNTED ON IT APPROXIMATELY 200' (60 m) IN ADVANCE OF THE MAIN ROUTE.
 - THE CLOSED PORTION OF THE MAIN ROUTE SHALL BE PROTECTED BY BLOCKING WITH TYPE I, TYPE II OR TYPE III BARRICADES, 1/3 OF THE CROSS SECTION OF THE CLOSED PORTION.
 - SIDE ROAD WITH A SPEED LIMIT GREATER THAN 40 MPH (60 km/h) AS SHOWN ON THE DRAWING AND AS DIRECTED BY THE ENGINEER:
 - ONE ROAD CONSTRUCTION AHEAD SIGN 48 x 48 (1.2 m x 1.2 m) WITH A FLASHER MOUNTED ON IT APPROXIMATELY 500' (150 m) IN ADVANCE OF THE MAIN ROUTE.
 - THE CLOSED PORTION OF THE MAIN ROUTE SHALL BE PROTECTED BY BLOCKING WITH TYPE III BARRICADES, 1/2 OF THE CROSS SECTION OF THE CLOSED PORTION.
 - WHEN THE SIDE ROAD LIES BETWEEN THE BEGINNING OF THE MAINLINE SIGNING AND THE WORK ZONE, A SINGLE HEADED ARROW (M6-1) SHALL BE USED IN LIEU OF THE DOUBLE HEADED ARROW (M6-4).
- B. FOR A LANE CLOSURE ON A SIDE ROAD OR DRIVEWAY:
- USE APPLICABLE PORTIONS OF THE TYPICAL APPLICATION OF TRAFFIC CONTROL DEVICES (STD. 701501, STD. 701606 OR THE APPROPRIATE STANDARD). THE SPACING OF SIGNS AND BARRICADES SHALL BE ADJUSTED FOR FIELD CONDITIONS AS DIRECTED BY THE ENGINEER. THE DIRECTIONAL ARROW SHALL BE COVERED OR REMOVED WHEN NO LONGER CONSISTENT WITH THE SIDE ROAD LANE CLOSURE.
- C. ADVANCE WARNING SIGNS ARE TO BE OMITTED ON DRIVEWAY UNLESS OTHERWISE NOTED.
- D. THE TRAFFIC CONTROL AND PROTECTION FOR SIDE ROADS, INTERSECTIONS, AND DRIVEWAYS SHALL BE INCIDENTAL TO THE COST OF SPECIFIED TRAFFIC CONTROL STANDARDS OR ITEMS.

All dimensions are in millimeters (inches) unless otherwise shown. GHA #4281.810

FILE NAME = D:\61A92-119-Details.dgn	USER NAME = zwollsten	DESIGNED - LHA	REVISED - J. OBERLE 10-18-95
		DRAWN -	REVISED - A. HOUSEH 03-06-96
	PLOT SCALE = 1:20	CHECKED -	REVISED - A. HOUSEH 10-15-96
Default	PLOT DATE = 3/13/2015	DATE - 06-89	REVISED - T. RAMMACHER 01-06-00

STATE OF ILLINOIS
DEPARTMENT OF TRANSPORTATION

TRAFFIC CONTROL AND PROTECTION FOR
SIDE ROADS, INTERSECTIONS, AND DRIVEWAYS

SCALE: NONE SHEET 1 OF 1 SHEETS STA. TO STA.

F.A.P. RTE.	SECTION	COUNTY	TOTAL SHEETS	SHEET NO.
VAR.	11-DCCSS-00-TL	DuPAGE	123	119
TC-10			CONTRACT NO. 61A92	
ILLINOIS FED. AID PROJECT				

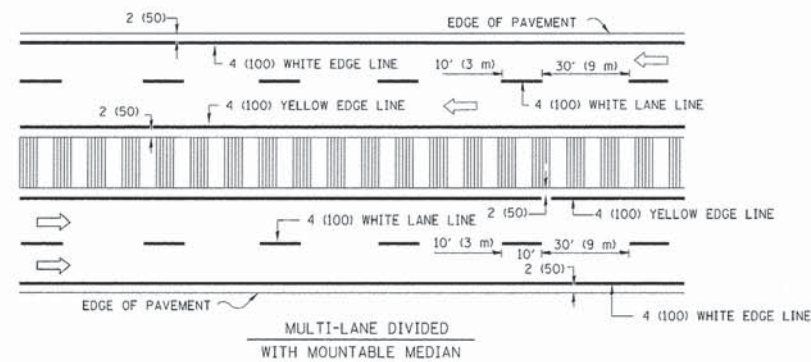
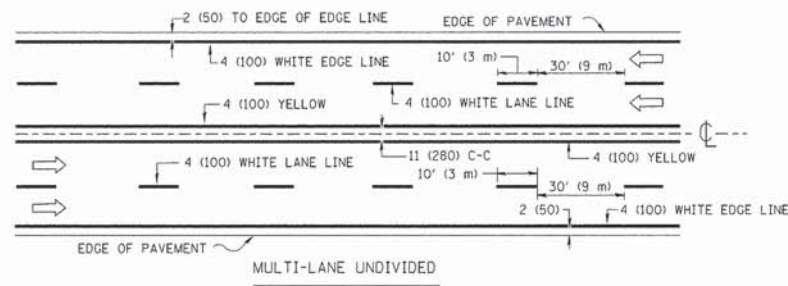
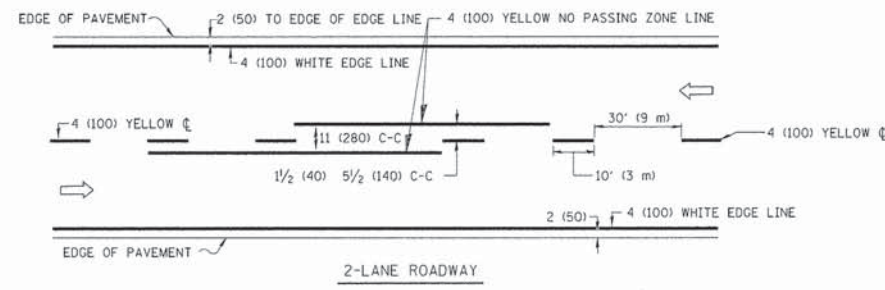

NOTE: MEDIANS WITH BARRIER CURB DO NOT REQUIRE AN EDGE LINE

TYPICAL LANE AND EDGE LINE MARKING

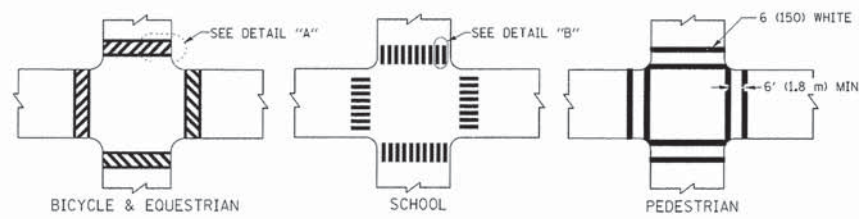

TYPICAL CROSSWALK MARKING

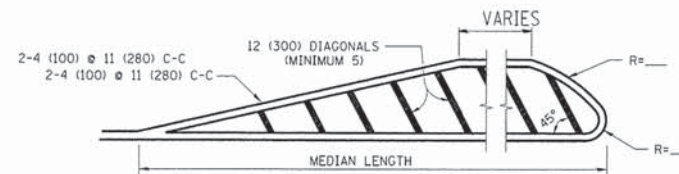
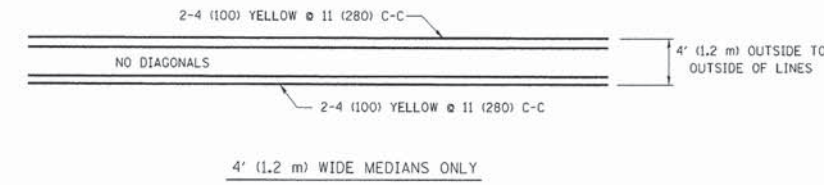

FOR MEDIAN LENGTHS WHERE DIAGONAL SPACING CANNOT BE ATTAINED, USE 5 (FIVE) EQUALLY SPACED DIAGONAL LINES.
 DIAGONAL LINE SPACING: 50' (15 m) C-C (LESS THAN 30MPH (50 km/h))
 75' (25 m) C-C 30MPH (50 km/h) TO 45MPH (70 km/h)
 150' (45 m) C-C (MORE THAN 45MPH (70 km/h))

MEDIANS OVER 4' (1.2 m) WIDE

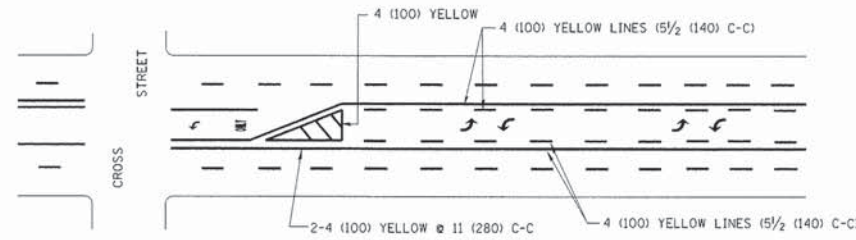

A MINIMUM OF TWO PAIRS OF TURN ARROWS SHALL BE USED, WHITE IN COLOR. ADDITIONAL PAIRS SHALL BE PLACED AT 200' (60 m) TO 300' (90 m) INTERVALS.



MEDIAN WITH TWO-WAY LEFT TURN LANE

TYPICAL PAINTED MEDIAN MARKING

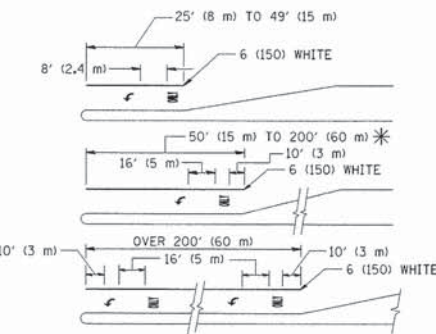

FULL SIZE LETTERS 8' (2.4 m) AND ARROWS SHALL BE USED.
 AREA = 15.6 SQ. FT. (1.5 m²) ONLY AREA = 20.8 SQ. FT. (1.9 m²)
 * TURN LANES IN EXCESS OF 400' (120 m) IN LENGTH MAY HAVE AN ADDITIONAL SET OF ARROW - "ONLY" INSTALLED MIDWAY BETWEEN THE OTHER TWO SETS OF ARROW - "ONLY".

TYPICAL LEFT (OR RIGHT) TURN LANE

TYPICAL TURN LANE MARKING

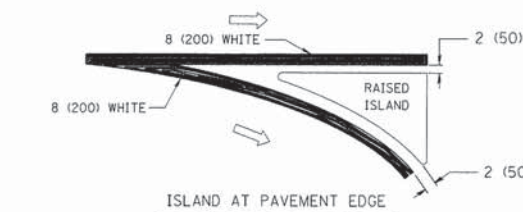
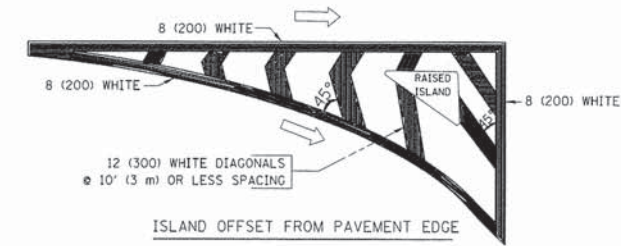

TYPICAL ISLAND MARKING

TYPE OF MARKING	WIDTH OF LINE	PATTERN	COLOR	SPACING / REMARKS
CENTERLINE ON 2 LANE PAVEMENT	4 (100)	SKIP-DASH	YELLOW	10' (3 m) LINE WITH 30' (9 m) SPACE
CENTERLINE ON MULTI-LANE UNDIVIDED PAVEMENT	2 @ 4 (100)	SOLID	YELLOW	11 (280) C-C
NO PASSING ZONE LINES FOR ONE DIRECTION	4 (100)	SOLID	YELLOW	5 1/2 (140) C-C FROM SKIP-DASH CENTERLINE
NO PASSING ZONE LINES FOR BOTH DIRECTIONS	2 @ 4 (100)	SOLID	YELLOW	11 (280) C-C OMIT SKIP-DASH CENTERLINE BETWEEN
LANE LINES	4 (100) 5 (125) ON FREEWAYS	SKIP-DASH SKIP-DASH	WHITE	10' (3 m) LINE WITH 30' (9 m) SPACE
DOTTED LINES (EXTENSIONS OF CENTER, LANE OR TURN LANE MARKINGS)	SAME AS LINE BEING EXTENDED	SKIP-DASH	SAME AS LINE BEING EXTENDED	2' (600) LINE WITH 6' (1.8 m) SPACE
EDGE LINES	4 (100)	SOLID	YELLOW-LEFT WHITE-RIGHT	OUTLINE MOUNTABLE MEDIANS IN YELLOW; EDGE LINES ARE NOT USED NEXT TO BARRIER CURB
TURN LANE MARKINGS	6 (150) LINE; FULL SIZE LETTERS & SYMBOLS (8' (2.4m))	SOLID	WHITE	SEE TYPICAL TURN LANE MARKING DETAIL
TWO WAY LEFT TURN MARKING	2 @ 4 (100) EACH DIRECTION	SKIP-DASH AND SOLID	YELLOW	10' (3 m) LINE WITH 30' (9 m) SPACE FOR SKIP-DASH; 5 1/2 (140) C-C BETWEEN SOLID LINE AND SKIP-DASH LINE
	8' (2.4m) LEFT ARROW	IN PAIRS	WHITE	SEE TYPICAL TWO-WAY LEFT TURN MARKING DETAIL
CROSSWALK LINES (PEDESTRIAN) A. DIAGONALS (BIKE & EQUESTRIAN) B. LONGITUDINAL BARS (SCHOOL)	2 @ 6 (150) 12 (300) @ 45° 12 (300) @ 90°	SOLID SOLID SOLID	WHITE WHITE WHITE	NOT LESS THAN 6' (1.8 m) APART 2' (600) APART 2' (600) APART SEE TYPICAL CROSSWALK MARKING DETAILS.
STOP LINES	24 (600)	SOLID	WHITE	PLACE 4' (1.2 m) IN ADVANCE OF AND PARALLEL TO CROSSWALK, IF PRESENT. OTHERWISE, PLACE AT DESIRED STOPPING POINT, PARALLEL TO CROSSROAD CENTERLINE, WHERE POSSIBLE
PAINTED MEDIANS	2 @ 4 (100) WITH 12 (300) DIAGONALS @ 45° NO DIAGONALS USED FOR 4' (1.2 m) WIDE MEDIANS	SOLID	YELLOW; TWO WAY TRAFFIC WHITE; ONE WAY TRAFFIC	11 (280) C-C FOR THE DOUBLE LINE SEE TYPICAL PAINTED MEDIAN MARKING.
GORE MARKING AND CHANNELIZING LINES	8 (200) WITH 12 (300) DIAGONALS @ 45°	SOLID	WHITE	DIAGONALS: 15' (4.5 m) C-C (LESS THAN 30MPH (50 km/h)) 20' (6 m) C-C 30MPH (50 km/h) TO 45MPH (70 km/h) 30' (9 m) C-C (OVER 45MPH (70 km/h))
RAILROAD CROSSING	24 (600) TRANSVERSE LINES; "RR" 15 (6' (1.8 m)) LETTERS; 16 (400) LINE FOR "X"	SOLID	WHITE	SEE STATE STANDARD 780001 AREA OF: "R"=3.6 SQ. FT. (0.33 m ²) EACH "X"=54.0 SQ. FT. (5.0 m ²)
SHOULDER DIAGONALS	12 (300) @ 45°	SOLID	WHITE - RIGHT YELLOW - LEFT	50' (15 m) C-C (LESS THAN 30MPH (50 km/h)) 75' (25 m) C-C (30 MPH (50 km/h) TO 45MPH (70 km/h)) 150' (45 m) C-C (OVER 45MPH (70 km/h))

FOR FURTHER DETAILS ON PAVEMENT MARKING REFER TO STANDARD SPECIFICATIONS FOR ROAD AND BRIDGE CONSTRUCTION AND STATE STANDARD 780001.

All dimensions are in inches (millimeters) unless otherwise shown.

FILE NAME = D:\61A92-120-Details.dgn	USER NAME = zwallsten	DESIGNED - EVERS	REVISED - T. RAMMACHER 10-27-94
		DRAWN -	REVISED - C. JUCIUS 09-09-09
Default	PLOT SCALE = 1:20	CHECKED -	REVISED -
	PLOT DATE = 3/13/2015	DATE - 03-19-90	REVISED -

STATE OF ILLINOIS
DEPARTMENT OF TRANSPORTATION

DISTRICT ONE			
TYPICAL PAVEMENT MARKINGS			
SCALE: NONE	SHEET 1	OF 1 SHEETS	STA. TO STA.

F.A.P. RTE.	SECTION	COUNTY	TOTAL SHEETS	SHEET NO.
VAR.	11-DCCSS-00-TL	DuPAGE	123	120
TC-13			CONTRACT NO. 61A92	
ILLINOIS FED. AID PROJECT				

GHA #4281.810

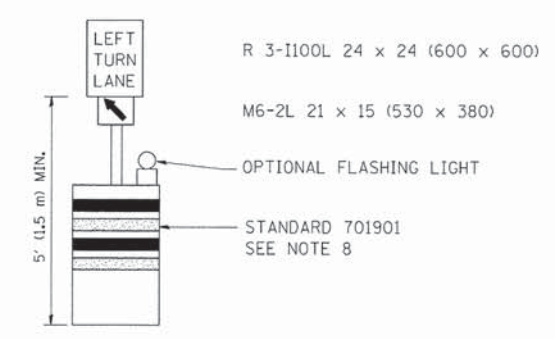
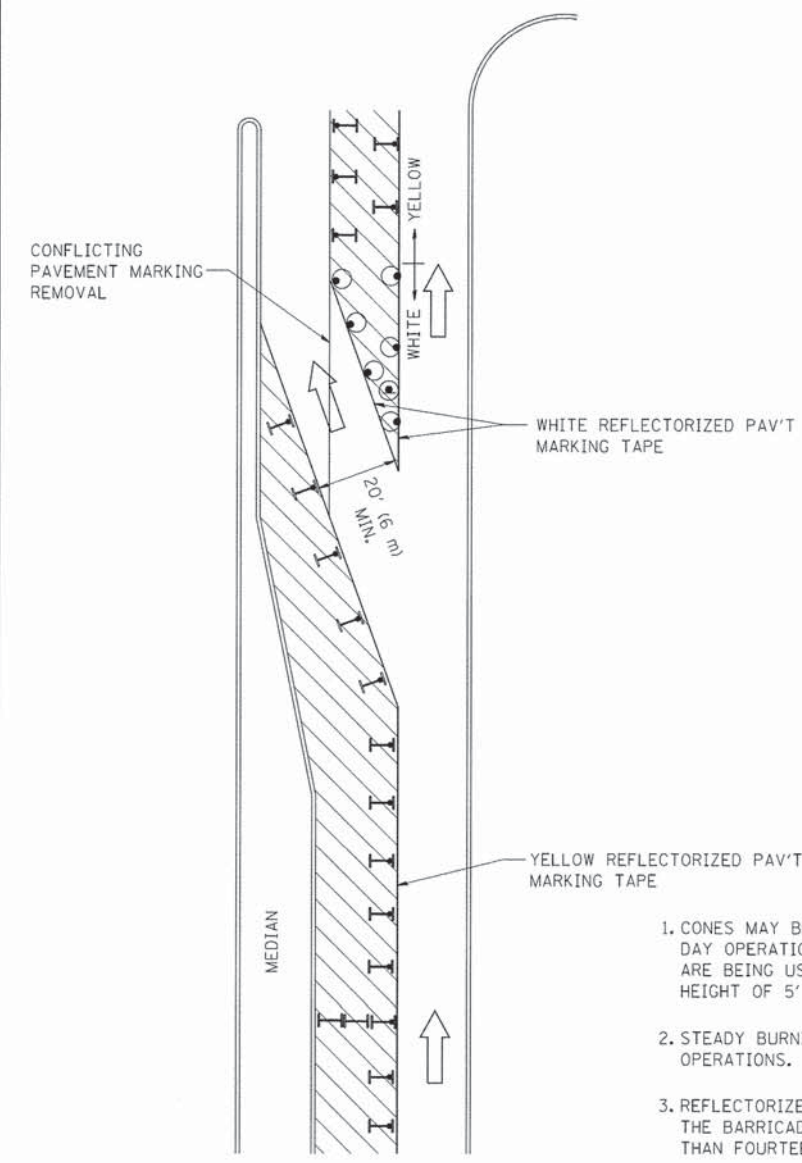

GENERAL NOTES

1. CONES MAY BE SUBSTITUTED FOR BARRICADES OR DRUMS AT HALF THE SPACING DURING DAY OPERATIONS. CONES SHALL BE A MINIMUM OF 28 (710) IN HEIGHT. WHEN CONES ARE BEING USED, THE "LEFT TURN LANE" SIGN MAY BE SKID MOUNTED AT A MINIMUM HEIGHT OF 5' (1.5 m).
2. STEADY BURNING LIGHTS WILL NOT BE REQUIRED ON BARRICADES OR DRUMS FOR DAY OPERATIONS. ALL LIGHTS SHALL BE MONODIRECTIONAL.
3. REFLECTORIZED TEMPORARY PAVEMENT MARKING TAPE SHALL BE PLACED THROUGHOUT THE BARRICADED AREA OF EACH TURN BAY WHERE THE CLOSURE TIME IS GREATER THAN FOURTEEN DAYS.
4. THIS APPLICATION ALSO APPLIES WHEN WORK IS BEING PERFORMED IN THE RIGHT LANE(S) AND THE RIGHT TURN BAY IS TO REMAIN OPEN. UNDER THIS CONDITION, "RIGHT TURN LANE" R3-100 24 x 24 (600 x 600) AND M6-2R 21 x 15 (530 x 380) SHALL BE USED.
5. THESE CONTROLS SHALL SUPPLEMENT MAINLINE TRAFFIC CONTROL FOR LANE CLOSURES.
6. LONGITUDINAL DIMENSIONS MAY BE ADJUSTED TO FIT FIELD CONDITIONS.
7. FORM OPER 725 IS REQUIRED.
8. IF A DRUM OR TYPE II BARRICADE WITH AN ATTACHED SIGN PANEL WHICH MEETS NCHRP 350 REQUIREMENTS IS NOT AVAILABLE, THE SIGNS SHALL BE MOUNTED, ABOVE THE BARRICADES, ON SEPARATE SIGNS SUPPORTS THAT MEET NCHRP 350 PREQUIREMENTS.
9. TRAFFIC CONTROL AND PROTECTION AT TURN BAYS (TO REMAIN OPEN TO TRAFFIC) SHALL BE INCLUDED IN THE COST SPECIFIED TRAFFIC CONTROL STANDARDS OR ITEMS.

All dimensions are in inches (millimeters) unless otherwise shown.

LEGEND

- WORK AREA
- LANE OPEN TO TRAFFIC
- TYPE I OR II BARRICADE WITH STEADY BURN LIGHT
- DRUM WITH STEADY BURN LIGHT
- DRUM WITH SIGN (WITH OPTIONAL FLASHING LIGHT) SEE DETAIL
- TYPE I OR II CHECK BARRICADE WITH FLASHING LIGHT

FILE NAME = D161A92-121-Details.dgn	USER NAME = zwallston	DESIGNED - T. RAMMACHER 09-08-94	REVISED - R. BORO 09-14-09
		DRAWN - A. HOUSEH 11-07-95	REVISED -
		CHECKED - A. HOUSEH 10-12-96	REVISED -
Default	PLOT DATE = 3/13/2015	DATE - T. RAMMACHER 01-06-00	REVISED -

**STATE OF ILLINOIS
DEPARTMENT OF TRANSPORTATION**

**TRAFFIC CONTROL AND PROTECTION AT TURN BAYS
(TO REMAIN OPEN TO TRAFFIC)**

SCALE: NONE SHEET 1 OF 1 SHEETS STA. TO STA.

F.A.P. RTE.	SECTION	COUNTY	TOTAL SHEETS	SHEET NO.
VAR.	11-DCCSS-00-TL	DuPAGE	123	121
TC-14			CONTRACT NO. 61A92	
ILLINOIS FED. AID PROJECT				

GHA #4281.810

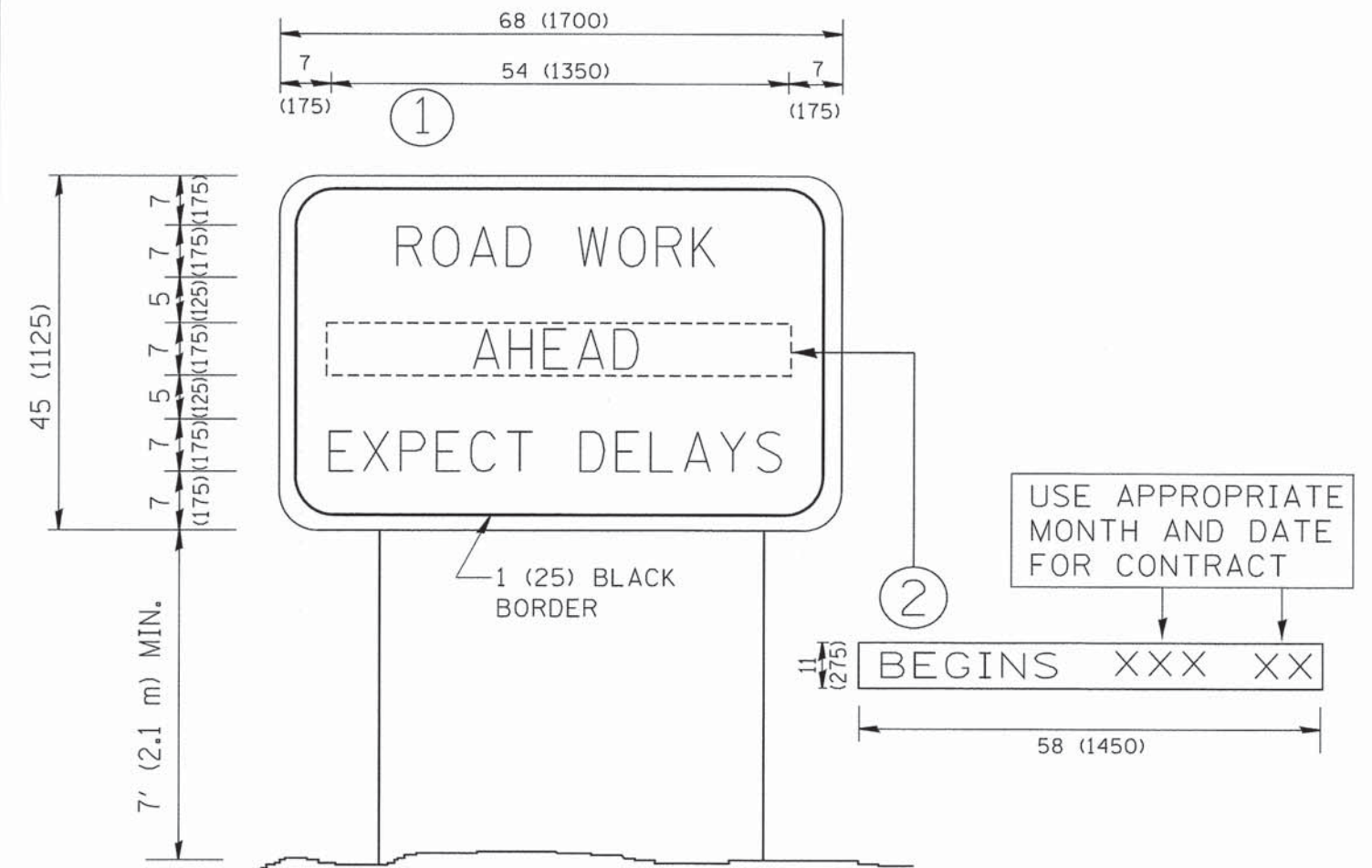

NOTES:

1. USE BLACK LETTERING ON ORANGE BACKGROUND.
2. ERECT SIGNS IN ADVANCE OF THE LOCATION FOR THE "ROAD CONSTRUCTION AHEAD" SIGN AT LOCATIONS AS DIRECTED BY THE ENGINEER.
3. ERECT SIGN ① WITH INSTALLED PANEL ② ONE WEEK PRIOR TO THE START OF CONSTRUCTION.
4. REMOVE PANEL ② SOON AFTER THE START OF CONSTRUCTION.
5. SEE SPECIAL PROVISION FOR "TEMPORARY INFORMATION SIGNING" FOR ADDITIONAL INFORMATION.
6. ONE SIGN ASSEMBLY EQUALS 25.70 SQ. FT. (2.3 SQ. M.)
7. SHALL BE PAID FOR AS TEMPORARY INFORMATION SIGNING.

ALL DIMENSIONS ARE IN INCHES (MILLIMETERS) UNLESS OTHERWISE SHOWN.

FILE NAME = D161A92-122-Details.dgn	USER NAME = zwallsten	DESIGNED -	REVISED - R. MIRS 09-15-97
		DRAWN -	REVISED - R. MIRS 12-11-97
	PLOT SCALE = 1:20	CHECKED -	REVISED - T. RAMMACHER 02-02-99
	PLOT DATE = 3/13/2015	DATE -	REVISED - C. JUCIUS 01-31-07

STATE OF ILLINOIS
DEPARTMENT OF TRANSPORTATION

ARTERIAL ROAD
INFORMATION SIGN

SCALE: NONE SHEET 1 OF 1 SHEETS STA. TO STA.

F.A.P. RTE.	SECTION	COUNTY	TOTAL SHEETS	SHEET NO.
VAR.	11-DCC55-00-TL	DuPAGE	123	122
TC-22			CONTRACT NO. 61A92	
ILLINOIS FED. AID PROJECT				

GHA #4281.810

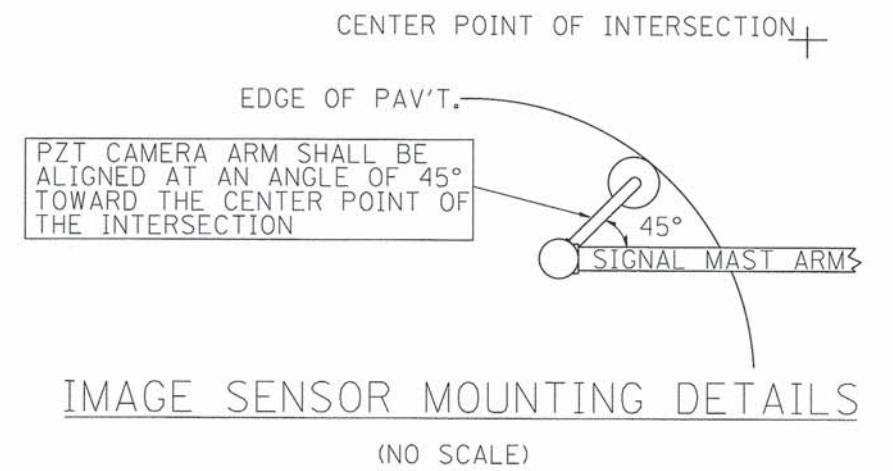
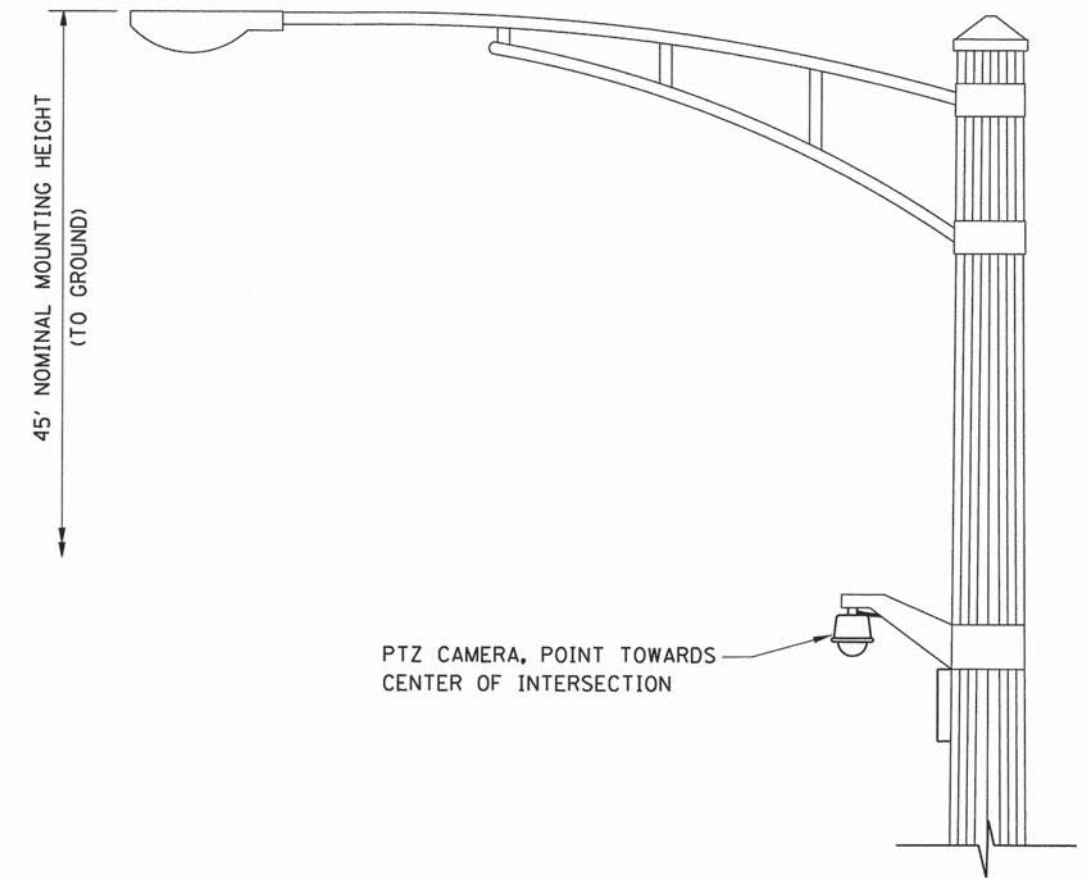
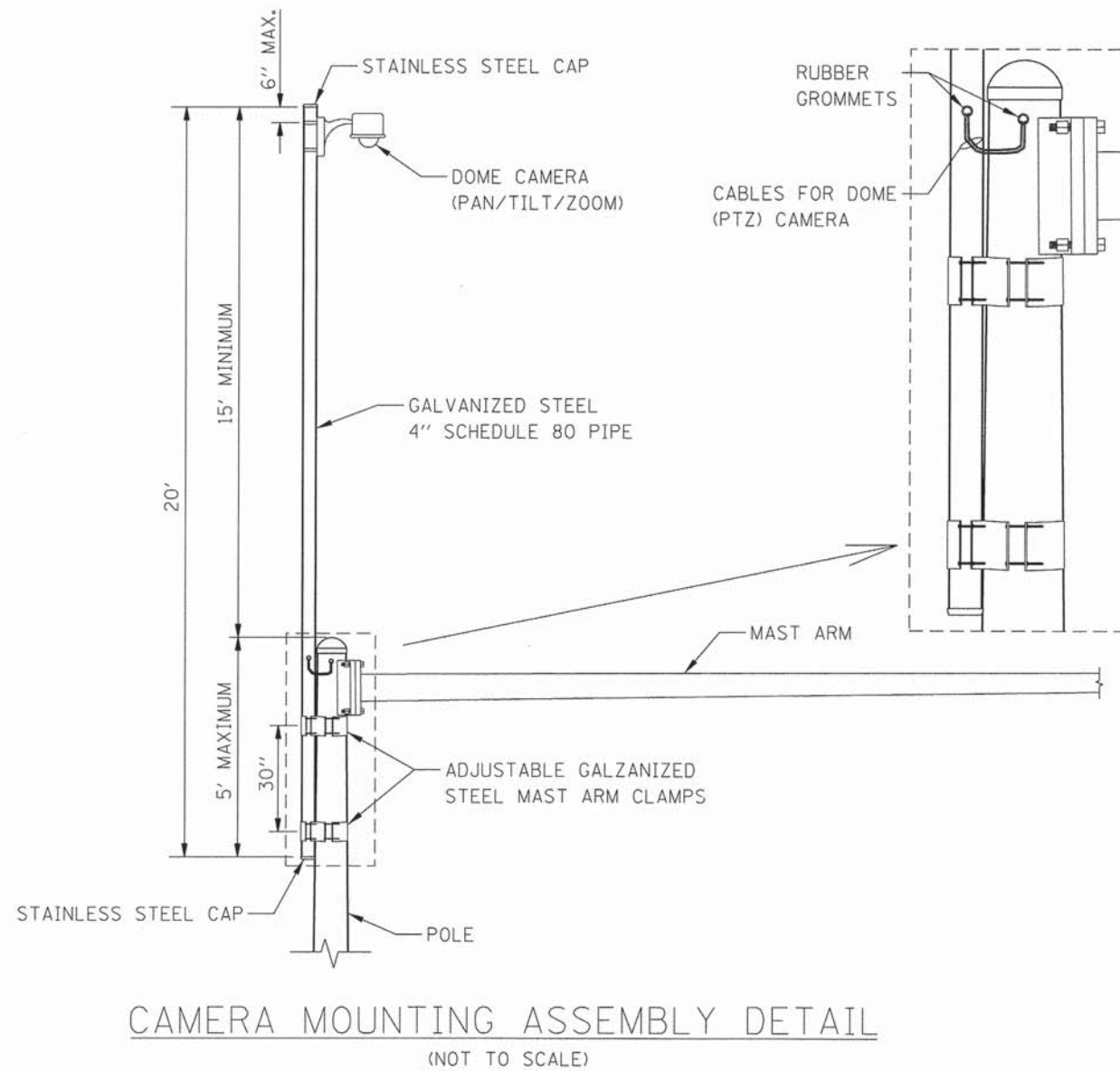

FILE NAME = 0161A92-123-Details.dgn	USER NAME = zwallsten	DESIGNED - JRD	REVISED -
		DRAWN - ZCW	REVISED -
		CHECKED - KLB	REVISED -
		DATE -	REVISED -
Default	PLOT DATE = 3/13/2015		

STATE OF ILLINOIS
DEPARTMENT OF TRANSPORTATION

CAMERA MOUNTING
DETAILS

SCALE: NONE SHEET 1 OF 1 SHEETS STA. TO STA.

F.A.P. RTE.	SECTION	COUNTY	TOTAL SHEETS	SHEET NO.
VAR.	11-DCCSS-00-TL	DuPAGE	123	123
			CONTRACT NO. 61A92	
ILLINOIS FED. AID PROJECT				

GHA #4281.810