

STATE OF ILLINOIS  
DEPARTMENT OF TRANSPORTATION  
DIVISION OF HIGHWAYS

PROPOSED PLANS FOR  
SURFACE TRANSPORTATION / RURAL PROGRAM  
HRRRP  
CH-8 (FAS 579)  
SECTION 05-00069-00-RS  
PROJECT RS-0579 (120)  
CASS COUNTY  
JOB NUMBER C-96-262-10

J.U.L.I.E.  
JOINT UTILITY LOCATION INFORMATION FOR EXCAVATION  
1-800-892-0123

INDEX OF SHEETS

- 1 COVER SHEET
- 2 GENERAL NOTES / SUMMARY OF QUANTITIES
- 3 TYPICAL SECTIONS
- 4-5 DETAIL SHEET
- 6-22 PLAN SHEETS

LIST OF STANDARDS

- 482001-02 HMA SHOULDER ADJACENT TO FLEXIBLE PAVEMENT
- 642006 SHOULDER RUMBLE STRIPS, 8"
- 701301-04 LANE CLOSURE, 2L, 2W, SHORT TIME OPERATIONS
- 701306-03 LANE CLOSURE, 2L, 2W SLOW MOVING OPERATION DAY ONLY, FOR SPEEDS  $\geq$  45 MPH
- 701311-03 LANE CLOSURE, 2L, 2W MOVING OPERATIONS DAY ONLY
- 701901-04 TRAFFIC CONTROL DEVICES
- 780001-05 TYPICAL PAVEMENT MARKINGS
- BLR 24-2 MAILBOX TURNOUTS FOR LOCAL ROADS

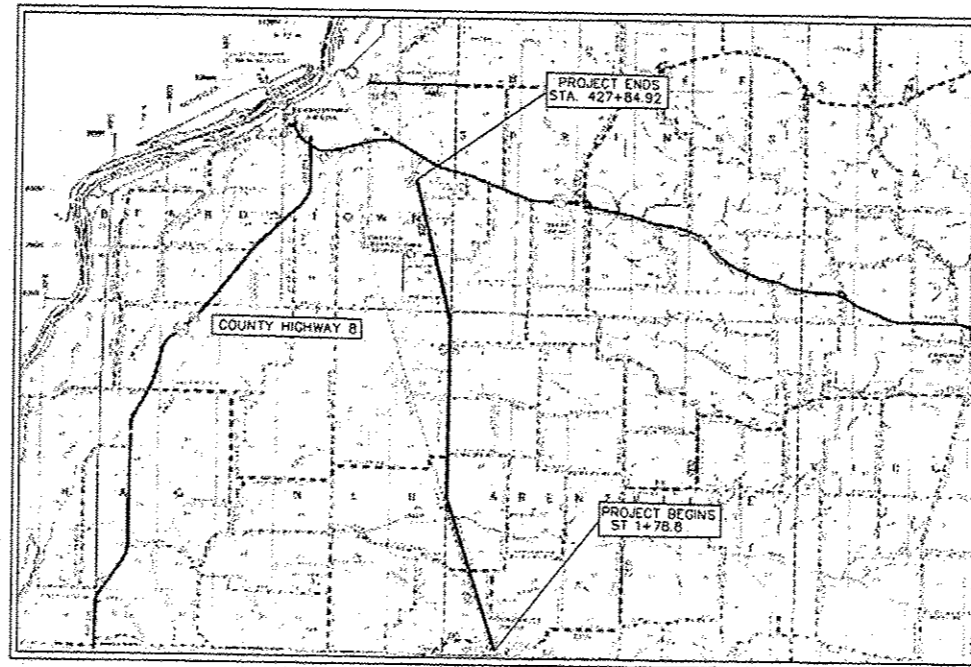

**DESCRIPTION OF WORK**  
THIS PROJECT CONSISTS OF RESURFACING AND COLD IN PLACE RECYCLING.  
OVERLAY THICKNESS 2 1/2" OF HMA.  
ALSO INCLUDED WILL BE HOT-MIX ASPHALT SHOULDERS, SIDEROAD/ENTRANCE IMPROVEMENTS AND PAVEMENT MARKING.  
SECTION ORIGINALLY CONSTRUCTED AS SECTION  
SEC 19 0  
SEC 19 B  
SEC 20 0  
SEC 27 ORS  
SEC 90-00055-00-RS  
SEC 92-00056-00-RS

**LOCATION MAP**  
NET LENGTH OF IMPROVEMENT = 42606 L.F. = ±8.069 MS  
1500' 750' 0 1500'  
(APPROXIMATE SCALE: 1" = 1500')  
DESIGN SPEED: 55 M.P.H.

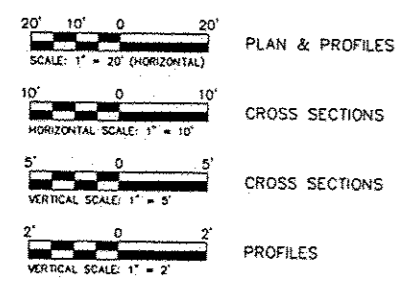

FULL SIZE PLANS HAVE BEEN PREPARED USING STANDARD ENGINEERING SCALES. REDUCED SIZED PLANS WILL NOT CONFORM TO STANDARD SCALES. IN MAKING MEASUREMENTS ON REDUCED PLANS, THE ABOVE SCALES MAY BE USED.

CONTRACT NO. 93650

APPROVED 4-1-2015  
*Timothy L. Icenogle*  
CASS COUNTY ENGINEER

PASSED April 7, 2015  
*Jeff Smith*  
DISTRICT 5 ENGINEER OF LOCAL ROADS AND STREETS

PASSED April 7, 2015  
*Ken Buchanan*  
DISTRICT 6 ENGINEER OF CONSTRUCTION

RELEASING FOR BID BASED ON LIMITED REVIEW April 7, 2015  
*Raymond J. Driskell*  
DEPUTY DIRECTOR OF HIGHWAYS, REGION FOUR ENGINEER

STATE OF ILLINOIS DEPARTMENT OF TRANSPORTATION

THESE PLANS WERE PREPARED BY MYSELF OR PERSONS WORKING UNDER MY PERSONAL SUPERVISION.

*Timothy L. Icenogle* 4-1-2015  
TIMOTHY L. ICENOGL, P.E.  
CASS COUNTY ENGINEER DATE

TIMOTHY L. ICENOGL  
082-048812  
REGISTERED  
PROFESSIONAL  
ENGINEER  
OF  
ILLINOIS

EXP 11-30-2015

FAS RTE. NO.	SECTION	COUNTY
579	05-00069-00-RS	CASS
STA. TO STA.		
ILLINOIS PROJECT: RS-0579 (120)		

**GENERAL NOTES**

THIS PROJECT SHALL BE CONSTRUCTED IN ACCORDANCE WITH THE "STANDARD SPECIFICATIONS FOR ROAD AND BRIDGE CONSTRUCTION" PREPARED BY IDOT, ADOPTED JANUARY 1, 2012. "SUPPLEMENTAL SPECIFICATIONS AND RECURRING SPECIAL PREVISIONS," CURRENT EDITION, AND THE "STANDARD PROVISIONS FOR WATER AND SEWER MAIN CONSTRUCTION IN ILLINOIS," CURRENT EDITION. SIGN CONSTRUCTION AND PAVEMENT MARKINGS SHALL CONFORM TO THE REQUIREMENTS OF THE "MANUAL ON UNIFORM TRAFFIC CONTROL DEVICES," CURRENT EDITION.

IN THE CASE OF CONFLICT BETWEEN THE ABOVE MENTIONED SPECIFICATIONS, THE ENGINEER SHALL DETERMINE WHICH OF THE SPECIFICATIONS SHALL GOVERN. THE ENGINEER'S DECISION SHALL BE FINAL AND NO ADDITIONAL COMPENSATION SHALL BE AWARDED UNLESS APPROVED BY THE ENGINEER.

ANY REFERENCE TO A STANDARD IN THESE PLANS SHALL BE INTERPRETED TO MEAN THE LATEST EDITION ISSUED BY ILLINOIS DEPARTMENT OF TRANSPORTATION OR THE COPY OF THE STANDARD INCLUDED IN THESE CONSTRUCTION DOCUMENTS AS DETERMINED BY THE ENGINEER.

THE ENGINEER SHALL HAVE THE AUTHORITY TO INSPECT, APPROVE, OR REJECT THE WORKMANSHIP AND/OR MATERIALS WHICH GO TO MAKE UP IMPROVEMENTS AS DETAILED IN THESE PLANS AND SPECIFICATIONS. THE CONTRACTOR SHALL NOTIFY THE ENGINEER AT LEAST 48 HOURS PRIOR TO PERFORMING ANY OF THE REQUIRED TESTS OR MATERIAL PLACEMENT SO THAT A REPRESENTATIVE MAY BE PRESENT DURING ANY TESTING PROCEDURE OR MATERIAL PLACEMENT.

THE PROPOSED IMPROVEMENTS MUST BE CONSTRUCTED IN ACCORDANCE WITH THE ENGINEERING PLANS. IMPROVEMENT REPRESENTATIONS AS SHOWN ON THESE PLANS ARE AS ACCURATE AS POSSIBLE FROM THE INFORMATION AVAILABLE. HOWEVER, SOME FIELD REVISIONS MAY BE REQUIRED TO ACCOMMODATE UNFORESEEN CIRCUMSTANCES. THE ENGINEER SHALL BE ADVISED OF ANY NECESSARY REVISIONS WITH SUFFICIENT LEAD TIME ALLOWED TO PROPERLY CONSIDER AND ACT UPON SUCH REQUESTS.

THE SCALE SHOWN ON THE DRAWINGS APPLIES ONLY TO THE FULL SIZE PLANS AND NOT TO REDUCED SIZE PLANS.

DO NOT SCALE PLANS FOR CONSTRUCTION DIMENSIONS.

WHERE SECTION OR SUBSECTION MONUMENTS ARE ENCOUNTERED, THE ENGINEER SHALL BE NOTIFIED BEFORE SUCH MONUMENTS ARE REMOVED. THE CONTRACTOR SHALL PROTECT AND CAREFULLY PRESERVE ALL MONUMENTS UNTIL AN AUTHORIZED SURVEYOR OR AGENT HAS WITNESSED OR OTHERWISE REFERENCED THEIR LOCATION. THE CONTRACTOR WILL BE RESPONSIBLE FOR HAVING AN AUTHORIZED SURVEYOR REESTABLISH ANY SECTION OR SUBSECTION MONUMENTS DESTROYED BY HIS OPERATIONS.

ANY AREAS DAMAGED OR DESTROYED DURING THE PROJECT AS A DIRECT OR INDIRECT RESULT OF CONTRACTING OPERATIONS SHALL BE RESTORED TO THAT CONDITION OR BETTER WHICH EXISTED PRIOR TO STARTING CONSTRUCTION. THE COST OF SAID RESTORATION OR REPAIR SHALL BE BORNE TOTALLY BY THE CONTRACTOR, WITH NO EXTRA COMPENSATION BEING AWARDED UNDER THIS CONTRACT. PRIOR TO ACCEPTANCE OF THIS REPAIR OR REPLACEMENT THE CONTRACTOR SHALL PRESENT THE OWNER WITH A SIGNOFF LETTER, SIGNED BY A RESPONSIBLE OFFICIAL OF THE OWNER OF THE DAMAGED PROPERTY STATING THAT THE REPAIR OR REPLACEMENT IS ACCEPTABLE.

THE CONTRACTOR SHALL FIELD VERIFY LOCATION, ELEVATION AND SIZE OF EXISTING UTILITIES, AND VERIFY PAVEMENT ELEVATIONS WHERE MATCHING INTO EXISTING WORK. NOTIFY ENGINEER OF DISCREPANCIES PRIOR TO PROCEEDING WITH WORK.

THE EXISTING SIGNS THAT INTERFERE WITH CONSTRUCTION SHALL BE REMOVED OR RELOCATED AS DIRECTED BY THE ENGINEER. AFTER THE CONSTRUCTION IS COMPLETED, THE CONTRACTOR SHALL REPLACE THE SIGNS AS DIRECTED BY THE ENGINEER. THIS WORK WILL NOT BE PAID FOR SEPARATELY BUT SHALL BE CONSIDERED INCIDENTAL TO THE CONTRACT AND NO ADDITIONAL COMPENSATION WILL BE ALLOWED.

ALL TRAFFIC CONTROL DEVICES USED FOR THE MAINTENANCE OF TRAFFIC SHALL BE REFLECTORIZED PRIOR TO INSTALLATION AND CLEANED AS NECESSARY THROUGH THE DURATION OF THE CONTRACT. ALL SIGNS SHALL BE FURNISHED, INSTALLED AND MAINTAINED BY THE CONTRACTOR. PAYMENT SHALL BE INCLUDED IN THE CONTRACT LUMP SUM PRICE FOR TRAFFIC CONTROL AND PROTECTION.

THE CONTRACTOR SHALL BE RESPONSIBLE FOR PROTECTING UTILITY PROPERTY FROM CONSTRUCTION OPERATIONS AS OUTLINED IN ARTICLE 107.31 OF THE STANDARD SPECIFICATIONS. THE J.U.L.I.E. NUMBER IS 800-892-0123. A MINIMUM OF FORTY-EIGHT HOURS ADVANCE NOTICE IS REQUIRED.

SUBGRADES, SUBBASES, AND BASE COURSES THE CONTRACTOR WILL BE REQUIRED TO SUBSTANTIATE BASE COURSE THICKNESSES AND FINISH PAVEMENT THICKNESSES. THE ENGINEER SHALL INSPECT BASE COURSE COREOUT PRIOR TO PLACING BASE COURSE TO ENSURE REQUIRED BASE COURSE DEPTH IS PRESENT.

PRIOR TO PLACING BASE COURSE MATERIAL, THE CONTRACTOR SHALL TEST ROLL THE SUBGRADE IN THE PRESENCE OF THE ENGINEER TO DEMONSTRATE THAT SAID SUBGRADE IS READY FOR BASE. PRIOR TO PLACEMENT OF HOT MIX ASPHALT SURFACE, THE SAME VERIFICATION PROCEDURE SHALL BE PERFORMED ON THE BASE COURSE MATERIAL.

THE ENGINEER SHALL WITNESS THE PLACEMENT OF HOT MIX ASPHALT BINDER AND SURFACE COURSE. CORE DRILLING MAY BE REQUIRED TO DEMONSTRATE THAT BASE COURSE AND PAVEMENT THICKNESSES CONFORM TO THE SPECIFICATIONS.

THE FOLLOWING MIXTURE REQUIREMENTS ARE APPLICABLE FOR THIS PROJECT:

MIXTURE USE(S)	HMA SUR CSE	LEVELING BINDER	HMA SHOULDER
AC/PG	PG 64-22	PG 64-22	PG 64-22
DESIGN AIR VOIDS	4.0% @ N50	4.0% @ N50	4.0% @ N50
MIX COMPOSITION: (GRADATION MIXTURE)	IL--9.5	IL--9.5	IL--19.0 or IL--19.0 CB
FRICTION AGGREGATE	MIX "C"	N/A	N/A

ILLINOIS DEPARTMENT OF TRANSPORTATION

COUNTY HIGHWAY 8  
GENERAL NOTES  
SUMMARY OF QUANTITIES

DRAWN BY: KK  
CHECKED BY: TI  
SHEET 2 OF 22

**SUMMARY OF QUANTITIES**

CODE NUMBER	PAY ITEM	UNIT	QUANTITY		
			TOTAL	STR	HRRRP
40600275	BITUMINOUS MATERIALS (PRIME COAT)	POUND	77,811	66,899	10,912
40600625	LEVELING BINDER (MACHINE METHOD), N50	TON	7,922	6,817	1,105
40600982	HOT-MIX ASPHALT SURFACE REMOVAL - BUTT JOINT	SQ YD	187	187	
40600990	TEMPORARY RAMP	SQ YD	80	80	
40603310	HOT-MIX ASPHALT SURFACE COURSE, MIX "C", N50	TON	9,894	8,515	1,379
48203017	HOT-MIX ASPHALT SHOULDERS, 5"	SQ YD	5,263		5,263
64200108	SHOULDER RUMBLE STRIPS, 8 INCH	FOOT	11,840		11,840
67100100	MOBILIZATION	L SUM	1	1	
70300100	SHORT TERM PAVEMENT MARKING	FOOT	4,300	3,700	600
70300230	TEMPORARY PAVEMENT MARKING - LINE 5"	FOOT	99,292	85,792	13,500
78000300	THERMOPLASTIC PAVEMENT MARKING - LINE 5"	FOOT	99,292	85,792	13,500
78100100	RAISED REFLECTIVE PAVEMENT MARKERS	EACH	75		75
X4401198	HOT-MIX ASPHALT SURFACE REMOVAL, VARIABLE DEPTH	SQ YD	605	320	285
X7010216	TRAFFIC CONTROL AND PROTECTION (SPECIAL)	L SUM	1	1	
LR400005	CIR-FDR EMULSIFIED ASPHALT	GALLON	158,428	136,327	22,101
LR400740	COLD IN-PLACE RECYCLING, 4.0"	SQ YD	113,163	97,376	15,787
# Z0076600	TRAINEES	HOURS	1,000		
# Z0076604	TRAINEES TRAINING PROGRAM GRADUATE	HOURS	1,000		

Δ Specialty Items

# 0042

**PERMANENT MARKING SCHEDULE**

STATION TO STATION	SIDE	DESCRIPTION	THERMOPLASTIC PAVEMENT MARKING			
			LINE 5"			
			YELLOW		WHITE	
		REGULAR FUNDING	HRRR FUNDING	REGULAR FUNDING	HRRR FUNDING	
<b>COUNTY HIGHWAY 8</b>						
1+78.84	7+78.84	CL	NB NO PASSING	600		
1+78.84	9+48.84	CL	SB NO PASSING	770		
1+78.84	125+00	LT/RT	EDGE LINES			24,642
7+78.84	125+00	CL	SKIP DASH	2,930		
125+00	185+00	CL	SKIP DASH		1,500	
125+00	185+00	LT/RT	EDGE LINES			12,000
185+00	334+80	CL	SKIP DASH	3,750		
185+00	427+84.92	LT/RT	EDGE LINES			48,570
334+80	347+30	CL	NB NO PASSING	1,250		
334+80	347+30	CL	SB SKIP DASH	310		
347+30	356+80	CL	SB NO PASSING	950		
347+30	356+80	CL	NB SKIP DASH	240		
356+80	427+84.92	CL	SKIP DASH	1,780		
<b>SUBTOTAL</b>				12,580	1,500	73,212
<b>TOTAL</b>				14,080		85,212

**PAVEMENT SCHEDULE**

STATION TO STATION	BITUMINOUS MATERIALS (PRIME COAT)	LEVELING BINDER (MACHINE METHOD), N50	HOT-MIX ASPHALT SURFACE COURSE, MIX "C", N50	CIR-FDR EMULSIFIED ASPHALT	COLD IN-PLACE RECYCLING, 4.0"	
						POUND
1+78.84	125+00.00	22,178.1	2,299.9	2,759.9	45,998.8	32,856.4
125+00.00	125+90.00	162.0	16.8	20.2	336.0	240.0
125+90.00	126+70.00	144.0		17.9		
126+70.00	185+00.00	10,494.0	1,088.3	1,305.9	21,765.2	15,546.7
185+00.00	353+30.00	30,294.0	3,141.6	3,769.9	62,832.0	44,880.0
353+30.00	354+20.00	162.0		20.2		
354+20.00	427+84.92	13,256.9	1,374.8	1,649.7	27,495.7	19,639.8
ENTRANCES, SIDEROADS & MAILBOX TURNOUTS		1,120.0		350.0		
<b>TOTALS</b>		77,811.0	7,921.4	9,893.8	158,427.7	113,162.9
<b>USE</b>		77,811	7,922	9,894	158,428	113,163

DATE: 03/9/2015

FAS RTE. NO.	SECTION	COUNTY
579	05-00069-00-RS	CASS
STA. TO STA.		
ILLINOIS		PROJECT: RS-0579 (120)

**TYPICAL CROSS SECTION**

STA 1+78.84 TO STA 125+00  
STA 185+00 TO STA 427+84.92

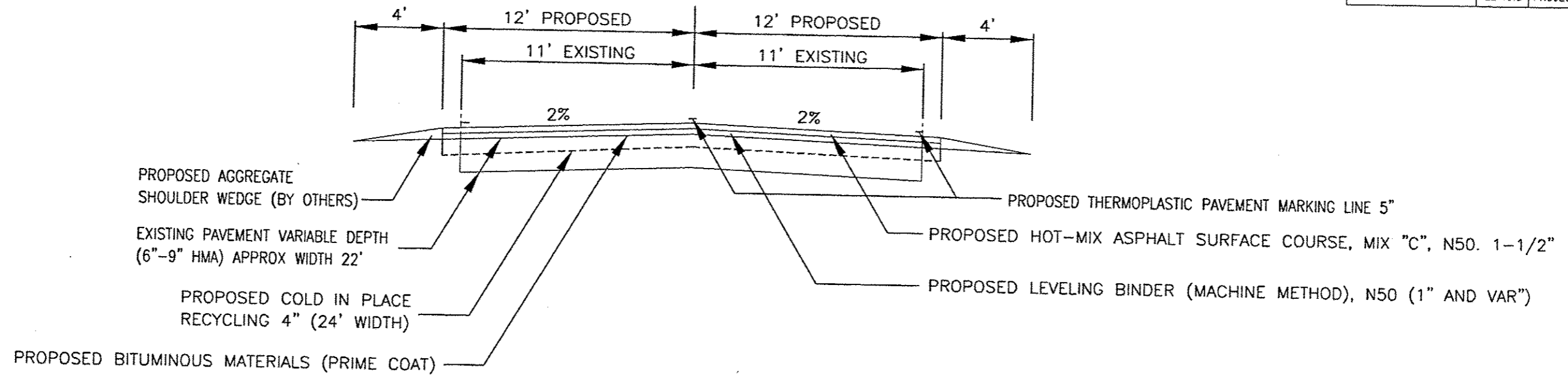

**TYPICAL CROSS SECTION**

STA 125+00 TO STA 125+90  
STA 126+70 TO STA 185+00

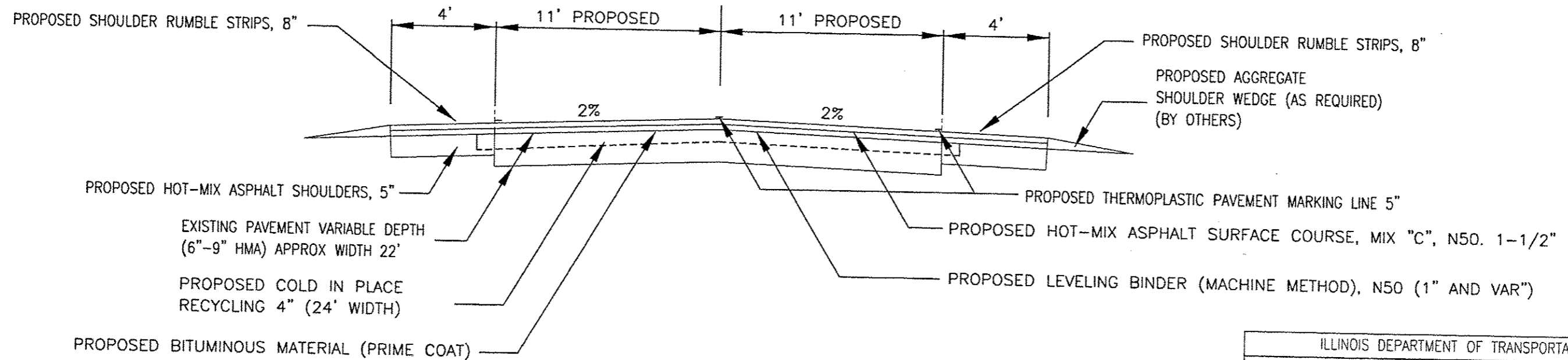

NOTE: 5" BITUMINOUS SHOULDER TO BE CONSTRUCTED PRIOR TO COLD IN PLACE RECYCLING

ILLINOIS DEPARTMENT OF TRANSPORTATION

COUNTY HIGHWAY 8  
TYPICAL SECTIONS  
DETAILS

DATE: 03/9/2015

DRAWN BY: KK  
CHECKED BY: TI  
SHEET 3 OF 22

ENTRANCE STATIONING			
STATION	ENTRANCE TYPE	SIDE	(SY)
9+18.3	C.E.	RT	59
11+18.4	P.E.	RT	21
14+49.1	SIDE ROAD - W NORTH STREET	RT	97
15+34.4	P.E.	RT	30
20+09.4	C.E.	RT	30
33+95.4	P.E.	RT	43
64+00.0	F.E.	RT	30
75+75.8	SIDE ROAD - ST. PETERS ROAD	LT & RT	125
118+88.8	P.E.	LT	30
145+10.5	F.E.	RT	30
151+67.3	F.E.	RT	30
174+50.0	P.E.	LT	30
182+35.5	C.E.	RT	43
182+58.8	SIDE ROAD - S HAGENER RD	LT	86
184+69.6	SIDE ROAD - E HAGENER RD	RT	43
205+00.0	P.E.	RT	30
229+87.5	C.E.	LT	30
237+95.2	SIDE ROAD - BUCK SCHOOL RD	LT & RT	86
249+00.0	P.E.	RT	30
255+50.0	P.E.	RT	30
257+79.8	P.E.	RT	30
269+43.0	P.E.	RT	30
290+71.1	SIDE ROAD - BETHEL CHURCH RD	RT	62
293+78.4	P.E.	LT	30
331+04.5	SIDE ROAD - STOCK LANE	LT	80
336+76.0	P.E.	RT	30
344+25.9	SIDE ROAD - 6 MILE RD	RT	43
350+74.4	P.E.	RT	30
360+50.0	P.E.	LT	30
365+36.6	P.E.	LT	30

ENTRANCE STATIONING (CONT.)			
STATION	ENTRANCE TYPE	SIDE	(SY)
366+17.2	P.E.	LT	30
367+14.2	P.E.	LT	30
368+74.4	P.E.	LT	94
370+50.0	P.E.	RT	30
372+09.9	SIDE ROAD - AIRPORT RD (LT) / ARENZ LN (RT)	LT & RT	130
376+13.3	P.E.	LT	30
376+38.5	P.E.	RT	30
377+50.0	P.E.	RT	30
378+09.5	P.E.	LT	30
379+22.1	P.E.	LT	30
381+45.2	P.E.	LT	42
384+00.0	P.E.	RT	30
385+06.7	P.E.	LT	30
386+00.0	P.E.	LT	30
386+05.3	P.E.	RT	30
386+86.0	P.E.	LT	30
386+92.8	P.E.	RT	30
392+58.0	P.E.	LT	30
397+09.3	P.E.	RT	30
398+00.0	P.E.	LT	30
399+75.3	P.E.	LT	30
399+82.9	P.E.	RT	38
404+12.2	P.E.	RT	30
405+99.2	P.E.	RT	42
407+21.9	P.E.	LT	30
408+38.7	P.E.	LT & RT	60
411+20.0	P.E.	LT	30
413+07.8	SIDE ROAD - FAIR LN	RT	65
415+32.4	P.E.	LT	30
423+32.5	P.E.	RT	30
TOTAL AREA =			2489

SHOULDER SCHEDULE			
STATION TO STATION		HOT-MIX ASPHALT SHOULDERS, 5"	SHOULDER RUMBLE STRIPS, 8 INCH
		SQ YD	FOOT
125+00.00	125+90.00	80.0	180.0
126+70.00	185+00.00	5,182.2	11,660.0
TOTALS		5,262.2	11,840.0
USE		5,263.0	11,840.0

MILLING SCHEDULE			
STATION TO STATION		HOT-MIX ASPHALT SURFACE REMOVAL, BUTT JOINT	HOT-MIX ASPHALT SURFACE REMOVAL, VARIABLE DEPTH
		SQ YD	
1+78.84	2+13.84	93.3	
125+90.00	126+70.00		284.4
353+30.00	354+20.00		320.0
427+49.92	427+84.92	93.3	
TOTALS		186.6	604.4
USE		187.0	605.0

FAS RTE. NO.	SECTION	COUNTY
579	05-00069-00-RS	CASS
STA. TO STA.		ILLINOIS PROJECT: RS-0579 (120)

RAISED REFLECTIVE PAVEMENT MARKERS SCHEDULE		
STATION TO STATION		RAISED REFLECTIVE PAVEMENT MARKERS TWO-WAY AMBER EACH
125+00.00	185+00.00	75
TOTAL		75

INTERSECTION DETAILS

ENTRANCE DETAILS

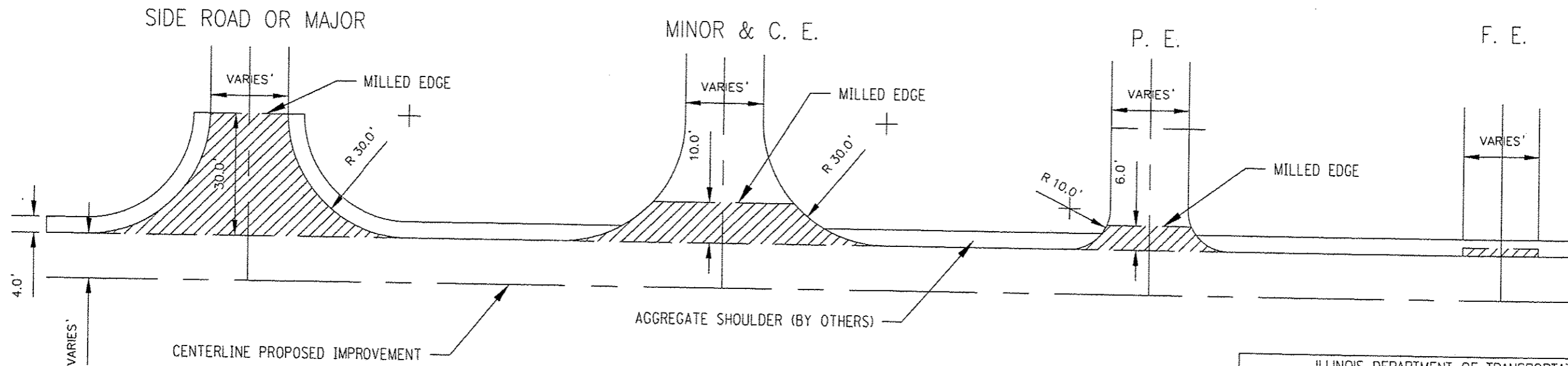

ILLINOIS DEPARTMENT OF TRANSPORTATION
COUNTY HIGHWAY 8 DETAILS
DRAWN BY: KK CHECKED BY: TI DATE: 03/9/2015
SHEET 4 OF 22

FAS RTE. NO.	SECTION	COUNTY
579	05-00069-00-RS	CASS
STA.	TO	STA.
	ILLINOIS	PROJECT: RS-0579 (120)

BRIDGE TRANSITION DETAIL

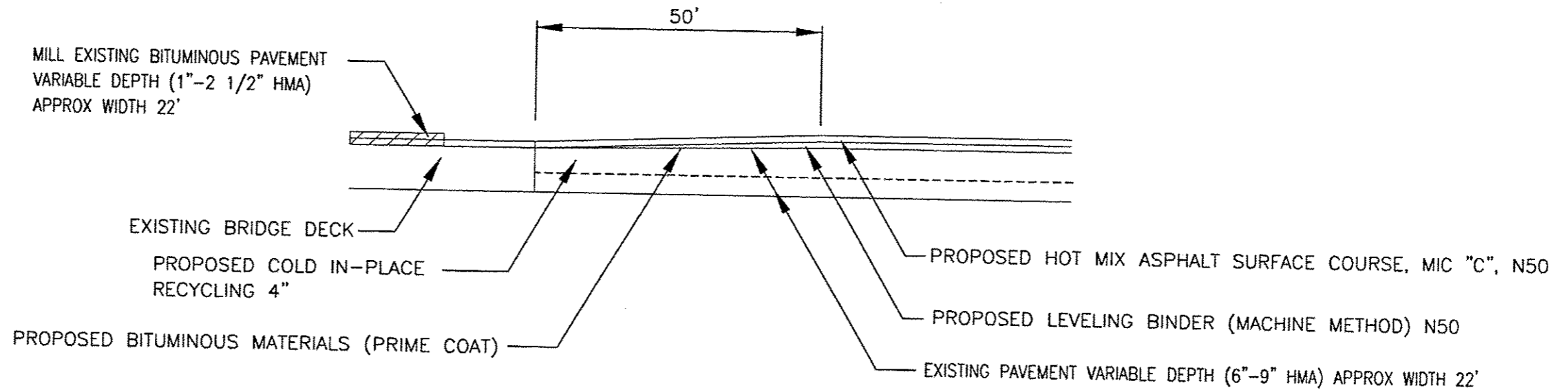

NOTE: BRIDGE DECK TO HAVE BITUMINOUS MATERIAL (PRIME COAT) APPLIED PRIOR TO SURFACE COURSE.

ENTRANCE BUTT JOINT DETAIL

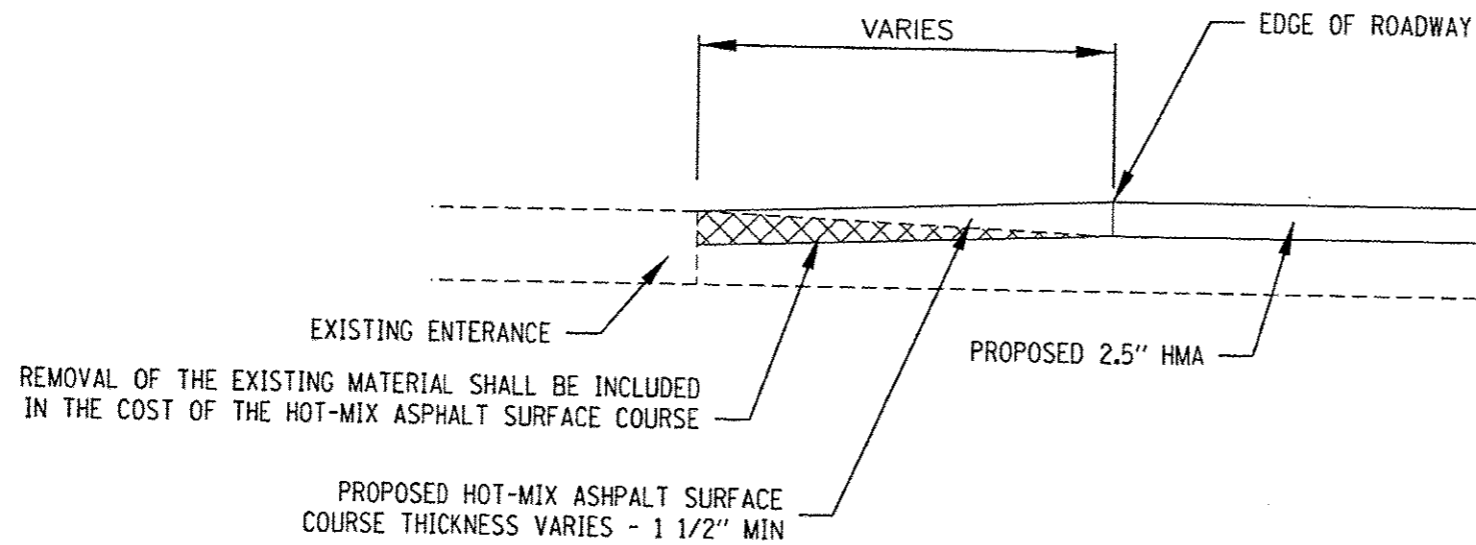

ILLINOIS DEPARTMENT OF TRANSPORTATION
COUNTY HIGHWAY 8 DETAILS
DRAWN BY: KK CHECKED BY: TI SHEET 5 OF 22
DATE: 03/9/2015

FAS RTE. NO.	SECTION	COUNTY
579	05-00069-00-RS	CASS
STA: 00+00 TO		STA: 29+50
ILLINOIS		PROJECT: RS-0579 (120)

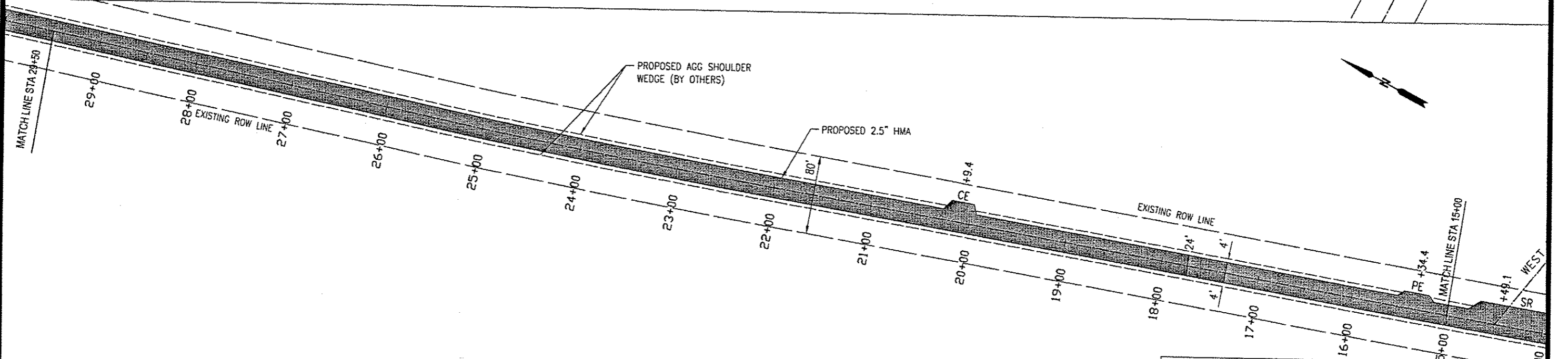
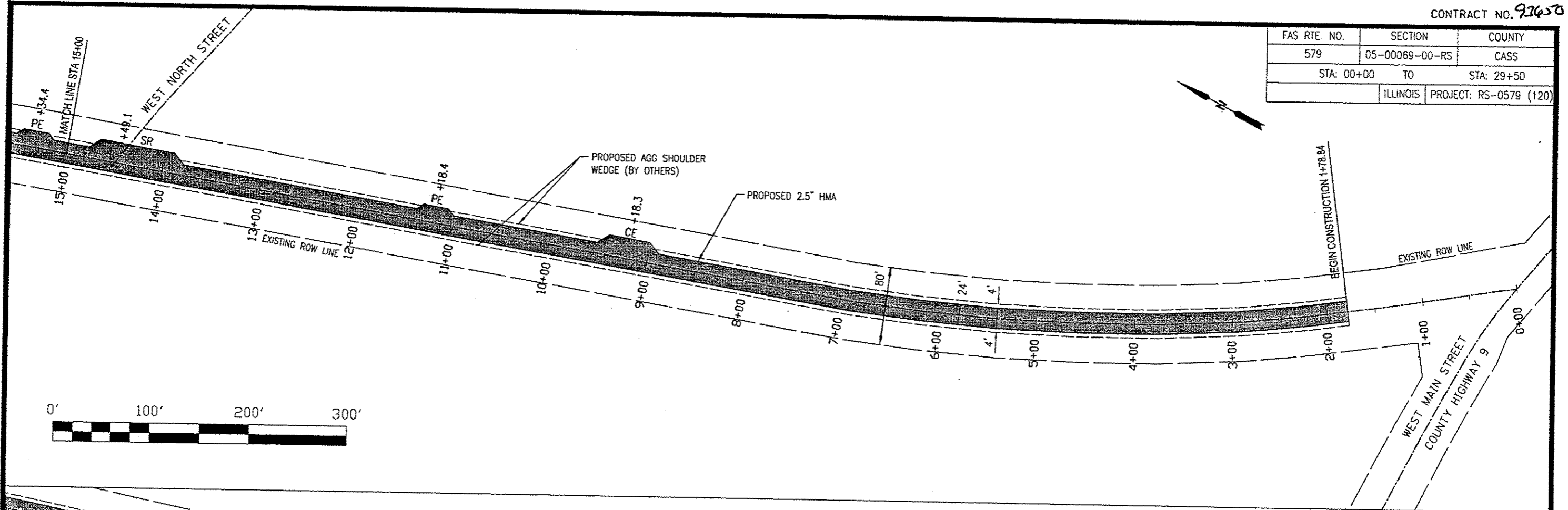

ILLINOIS DEPARTMENT OF TRANSPORTATION

COUNTY HIGHWAY 8  
PROPOSED PLAN

1"=100'  
DATE: 03/9/2015

DRAWN BY: KK  
CHECKED BY: TI  
SHEET 6 OF 22

FAS RTE. NO.	SECTION	COUNTY
579	05-00069-00-RS	CASS
STA: 29+50 TO		STA: 55+50
ILLINOIS		PROJECT: RS-0579 (120)

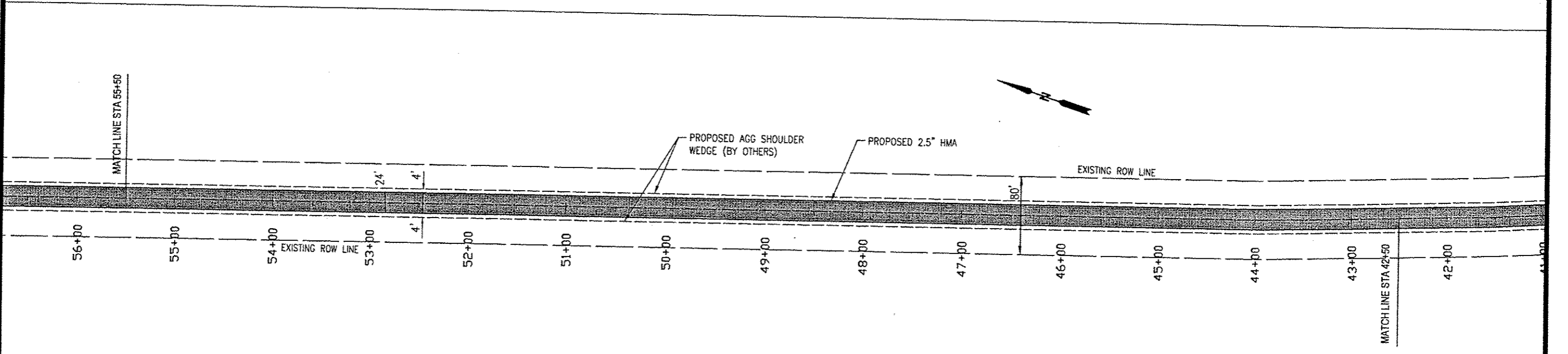
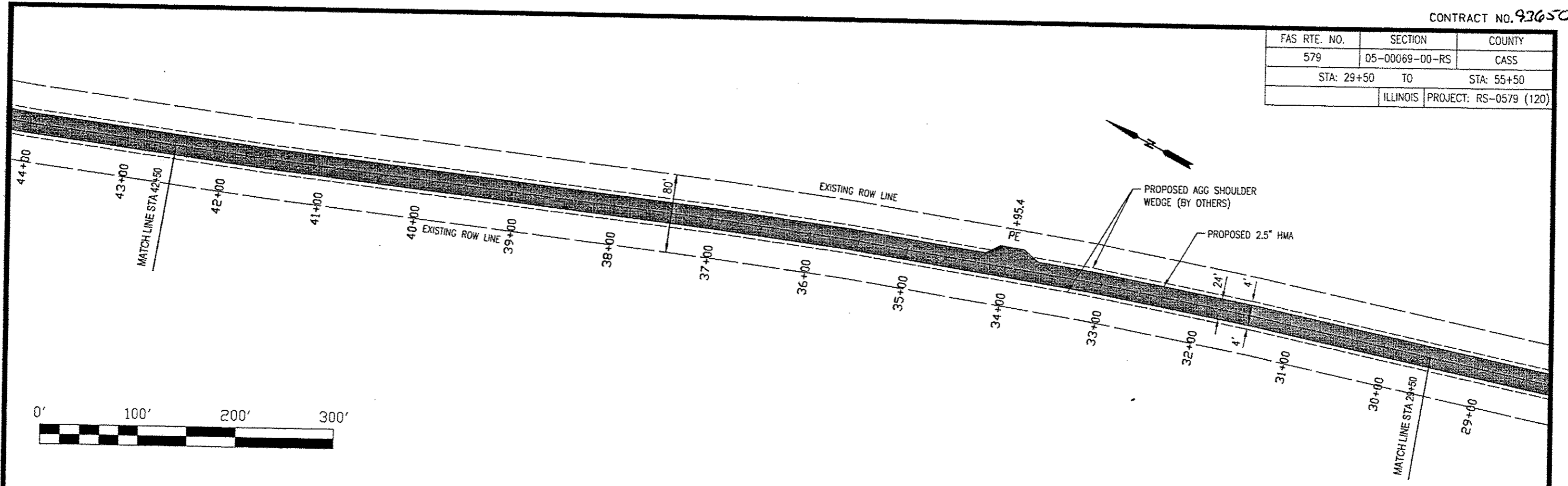

ILLINOIS DEPARTMENT OF TRANSPORTATION	
COUNTY HIGHWAY 8 PROPOSED PLAN	
1"=100'	DRAWN BY: KK
DATE: 03/9/2015	CHECKED BY: TI
	SHEET 7 OF 22

FAS RTE. NO.	SECTION	COUNTY
579	05-00069-00-RS	CASS
STA: 55+50 TO		STA: 78+50
ILLINOIS		PROJECT: RS-0579 (120)

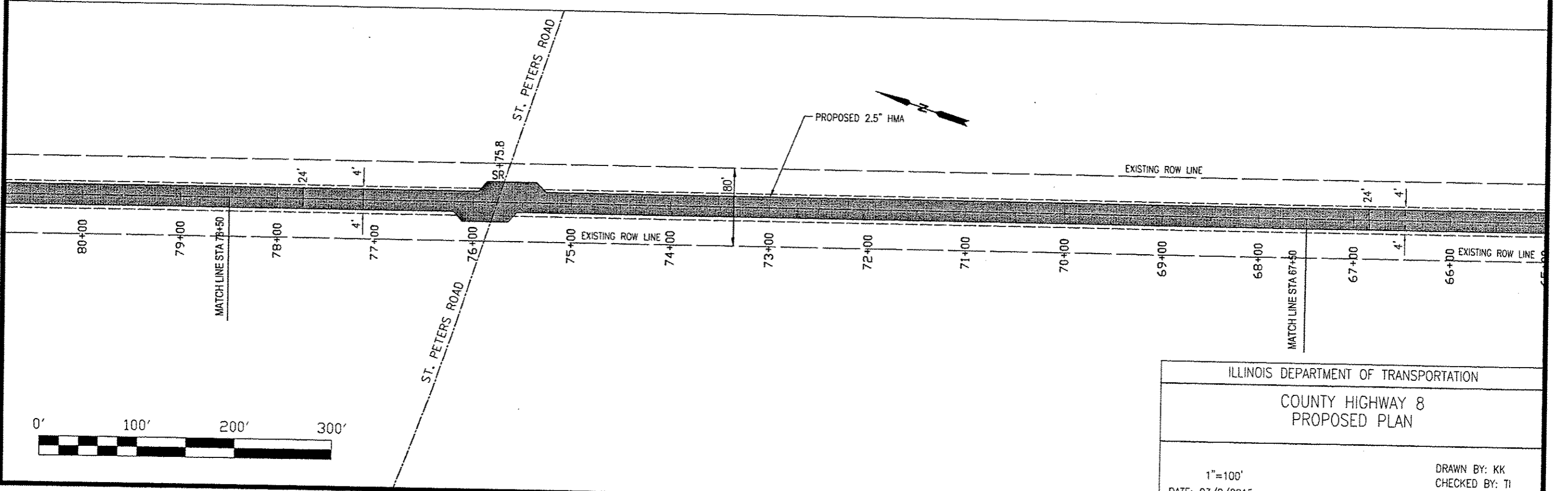
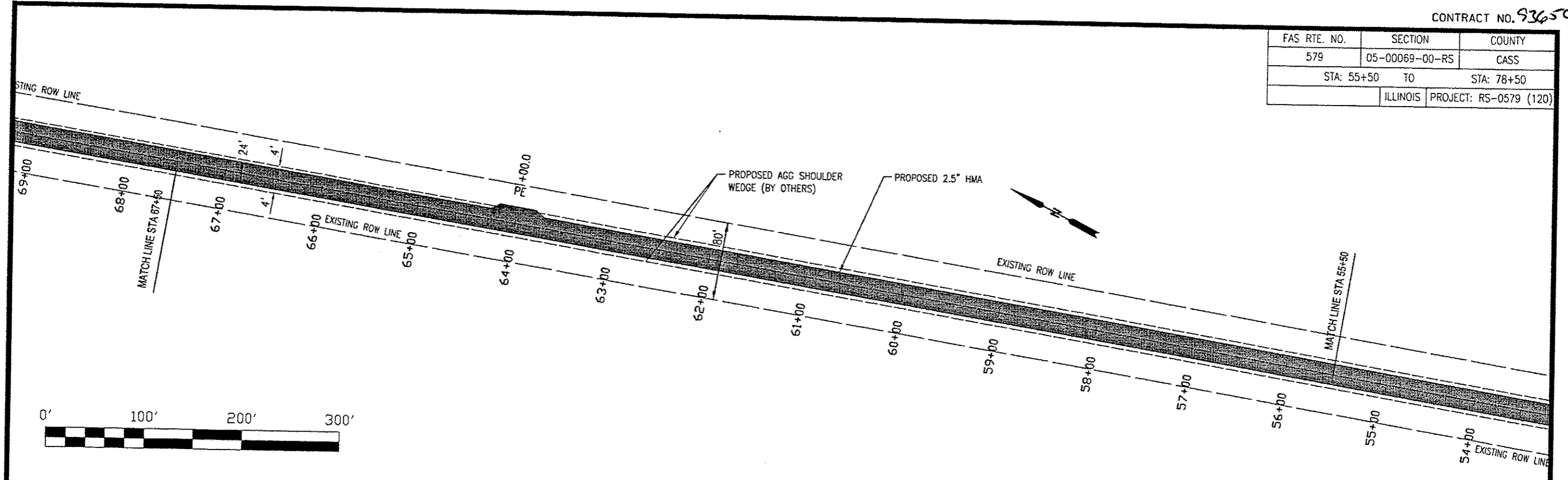

ILLINOIS DEPARTMENT OF TRANSPORTATION

COUNTY HIGHWAY 8  
PROPOSED PLAN

1"=100'  
DATE: 03/9/2015

DRAWN BY: KK  
CHECKED BY: TI  
SHEET 8 OF 22





FAS RTE. NO.	SECTION	COUNTY
579	05-00069-00-RS	CASS
STA: 104+00 TO		STA: 129+00
ILLINOIS		PROJECT: RS-0579 (120)

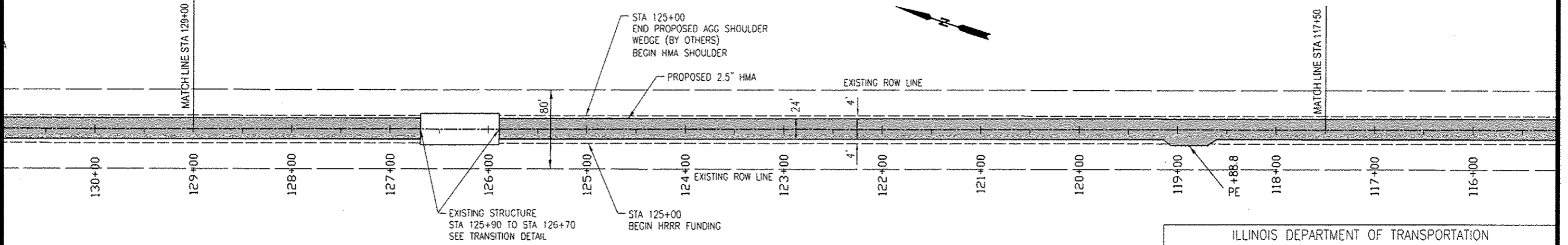
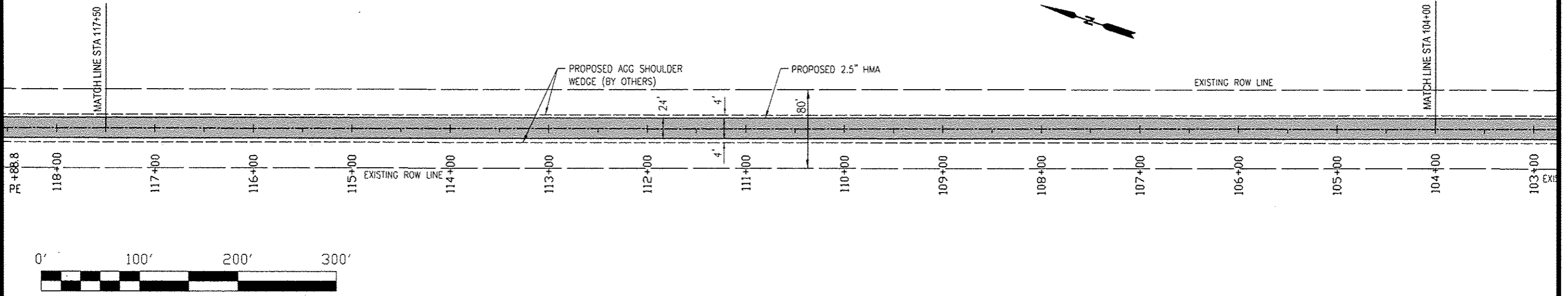

ILLINOIS DEPARTMENT OF TRANSPORTATION

**COUNTY HIGHWAY 8  
PROPOSED PLAN**

1"=100'  
DATE: 03/9/2015

DRAWN BY: KK  
CHECKED BY: TI  
SHEET 10 OF 22

FAS RTE. NO.	SECTION	COUNTY
579	05-00069-00-RS	CASS
STA: 129+00 TO		STA: 154+00
ILLINOIS		PROJECT: RS-0579 (120)

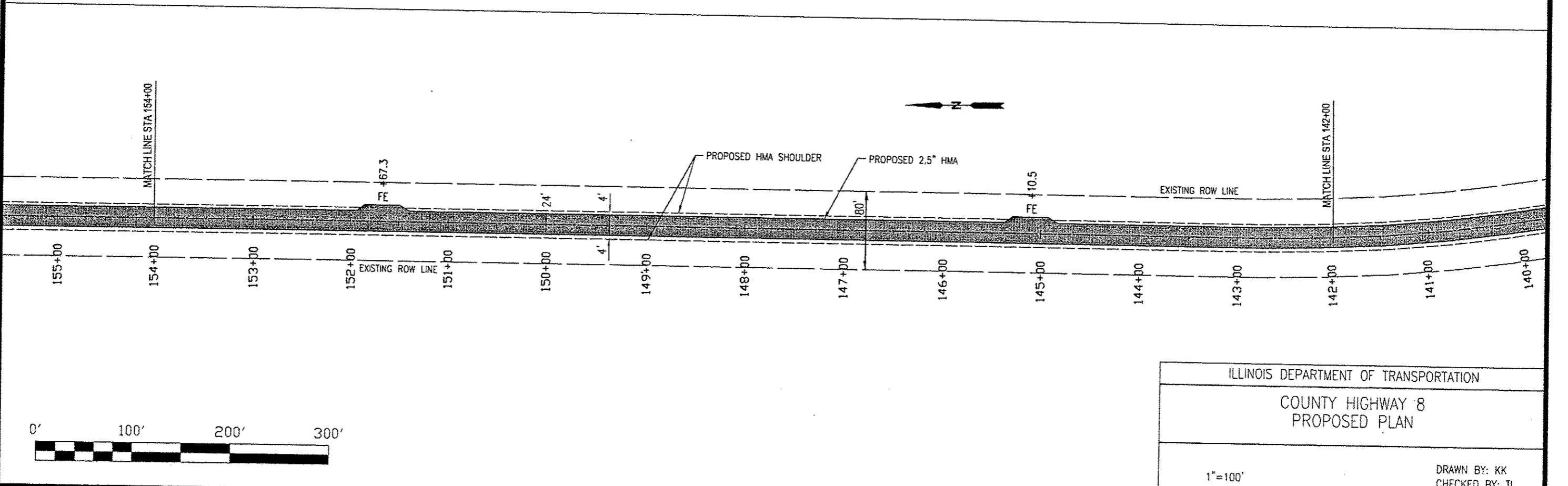
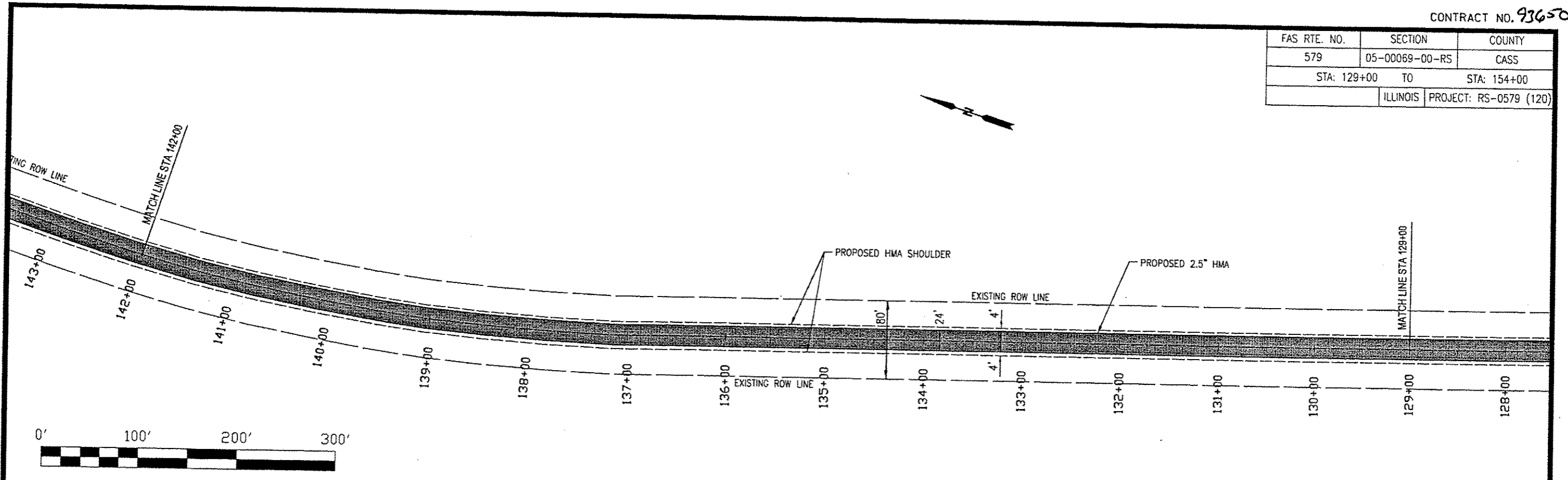

ILLINOIS DEPARTMENT OF TRANSPORTATION	
COUNTY HIGHWAY 8 PROPOSED PLAN	
1"=100' DATE: 03/9/2015	DRAWN BY: KK CHECKED BY: TI SHEET 11 OF 22

FAS RTE. NO.	SECTION	COUNTY
579	05-00069-00-RS	CASS
STA: 154+00 TO		STA: 179+50
ILLINOIS		PROJECT: RS-0579 (120)

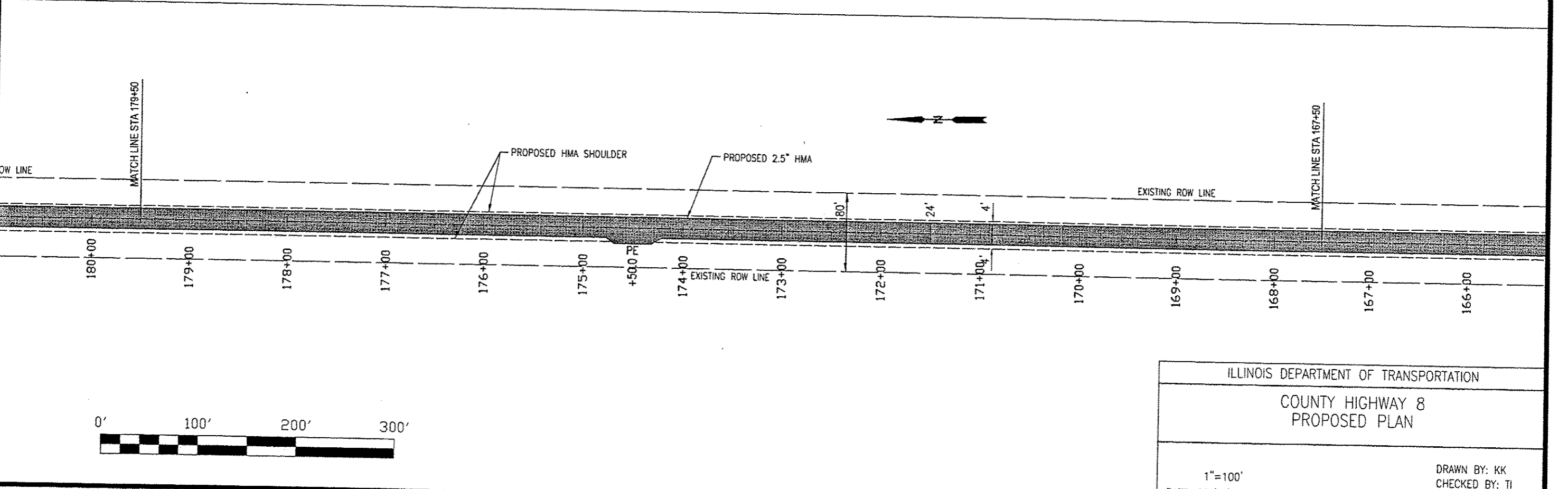
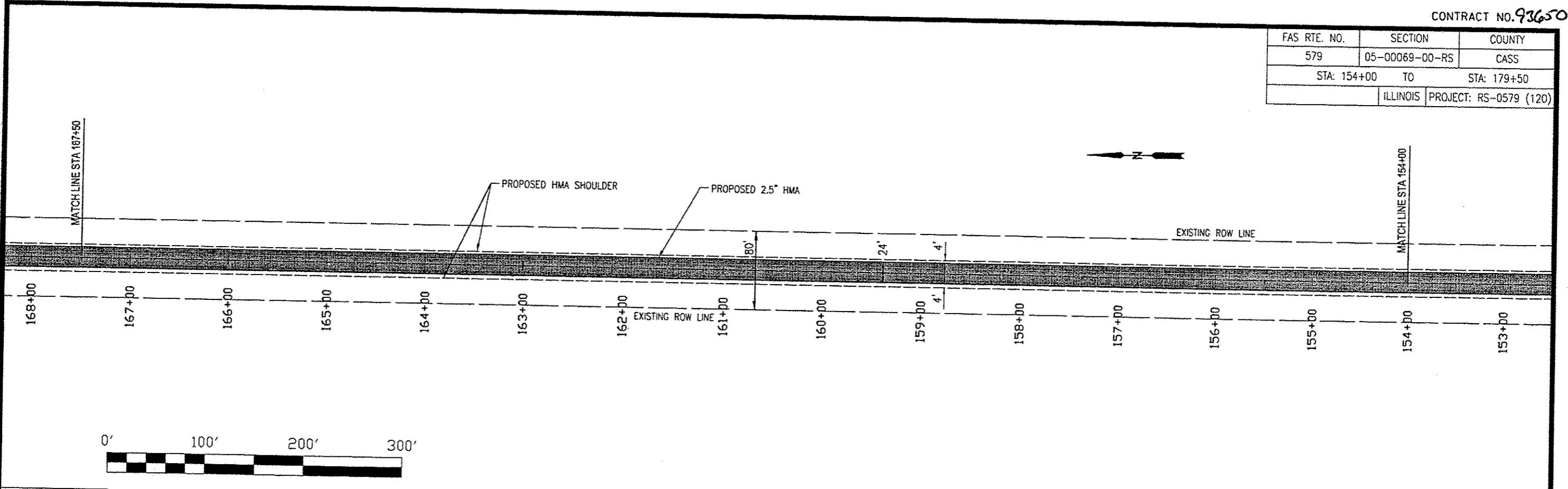

ILLINOIS DEPARTMENT OF TRANSPORTATION

COUNTY HIGHWAY 8  
PROPOSED PLAN

1"=100'  
DATE: 03/9/2015

DRAWN BY: KK  
CHECKED BY: TI  
SHEET 12 OF 22

FAS RTE. NO.	SECTION	COUNTY
579	05-00069-00-RS	CASS
STA: 179+50 TO		STA: 204+50
ILLINOIS PROJECT: RS-0579 (120)		

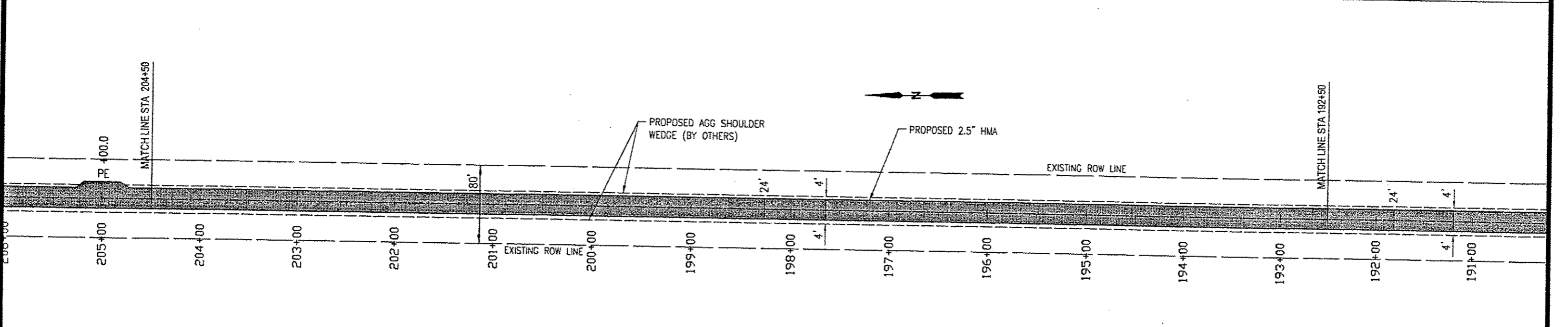
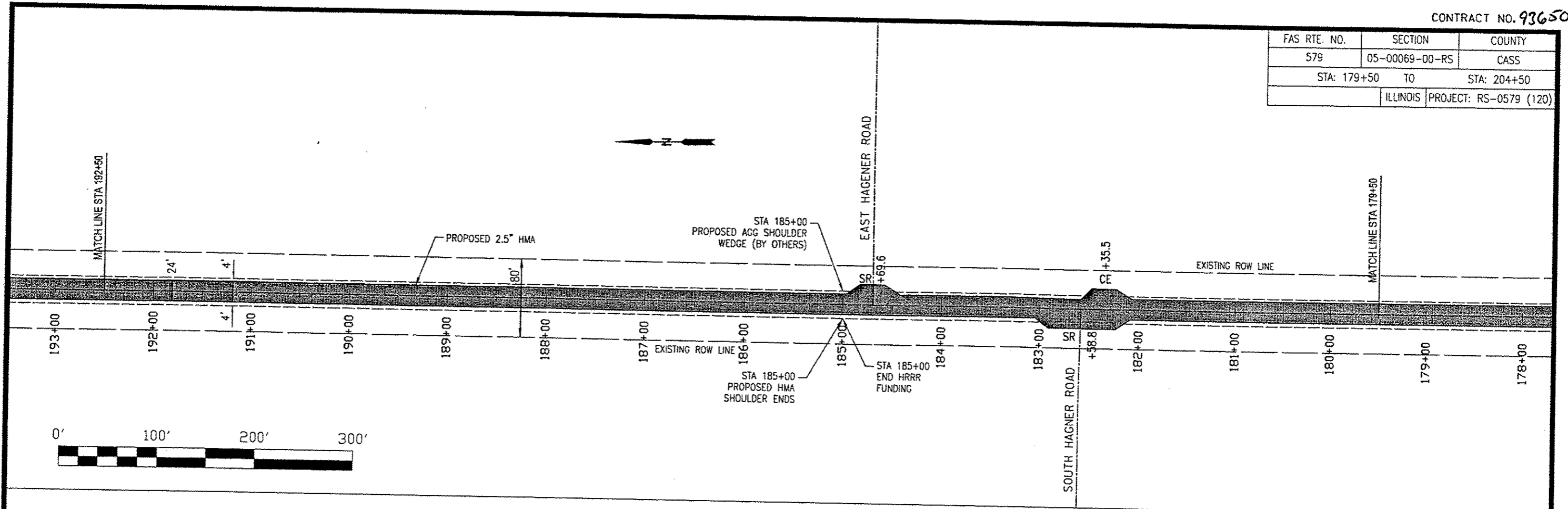

ILLINOIS DEPARTMENT OF TRANSPORTATION

COUNTY HIGHWAY 8  
PROPOSED PLAN

1"=100'  
DATE: 03/9/2015

DRAWN BY: KK  
CHECKED BY: TI  
SHEET 13 OF 22

FAS RTE. NO.	SECTION	COUNTY
579	05-00069-00-RS	CASS
STA: 204+50 TO		STA: 230+50
ILLINOIS		PROJECT: RS-0579 (120)

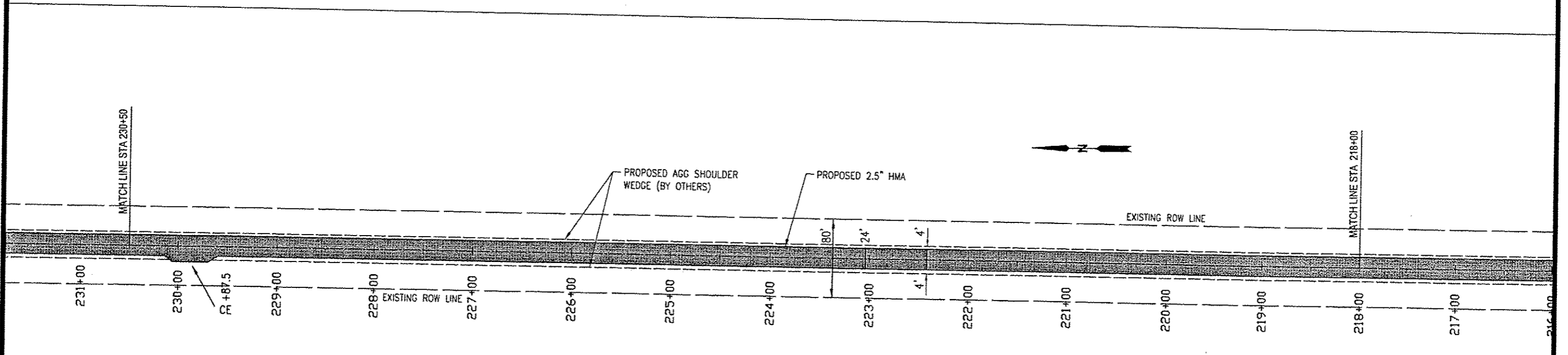
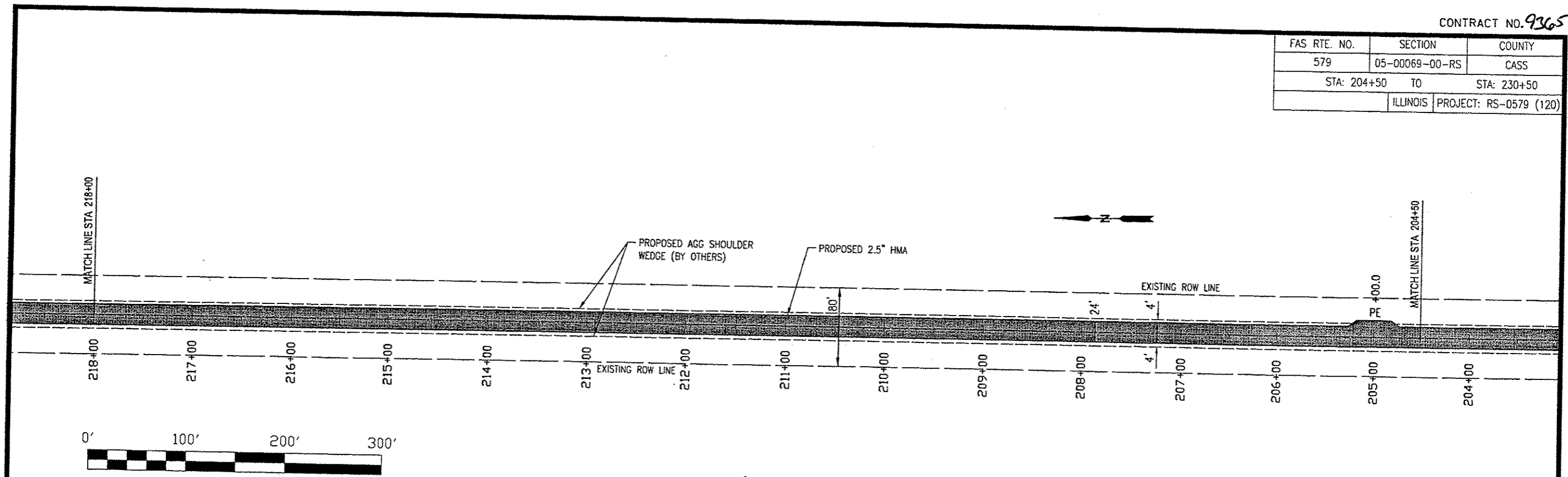

ILLINOIS DEPARTMENT OF TRANSPORTATION

COUNTY HIGHWAY 8  
PROPOSED PLAN

1"=100'  
DATE: 03/9/2015

DRAWN BY: KK  
CHECKED BY: TI  
SHEET 14 OF 22

FAS RTE. NO.	SECTION	COUNTY
579	05-00069-00-RS	CASS
STA: 230+50 TO		STA: 255+50
ILLINOIS		PROJECT: RS-0579 (120)

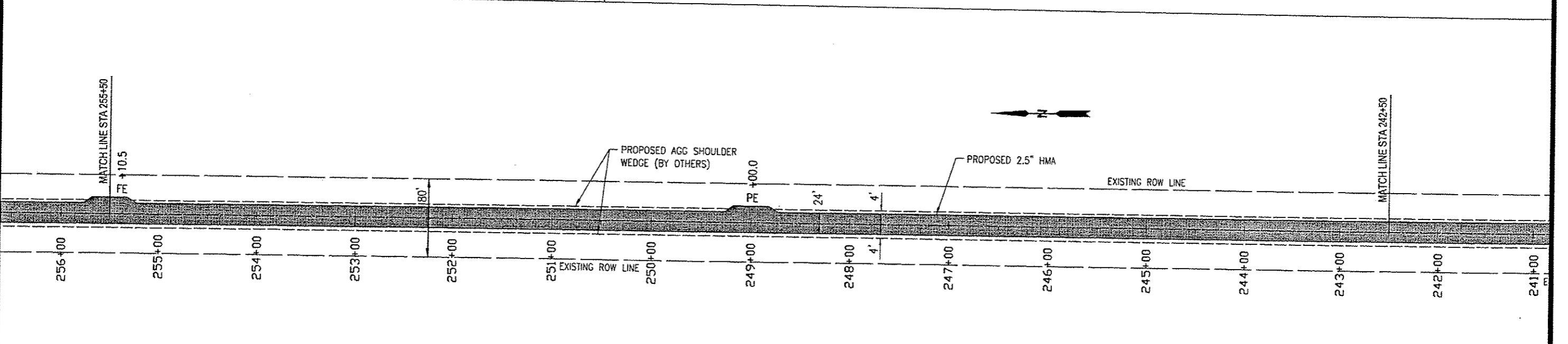
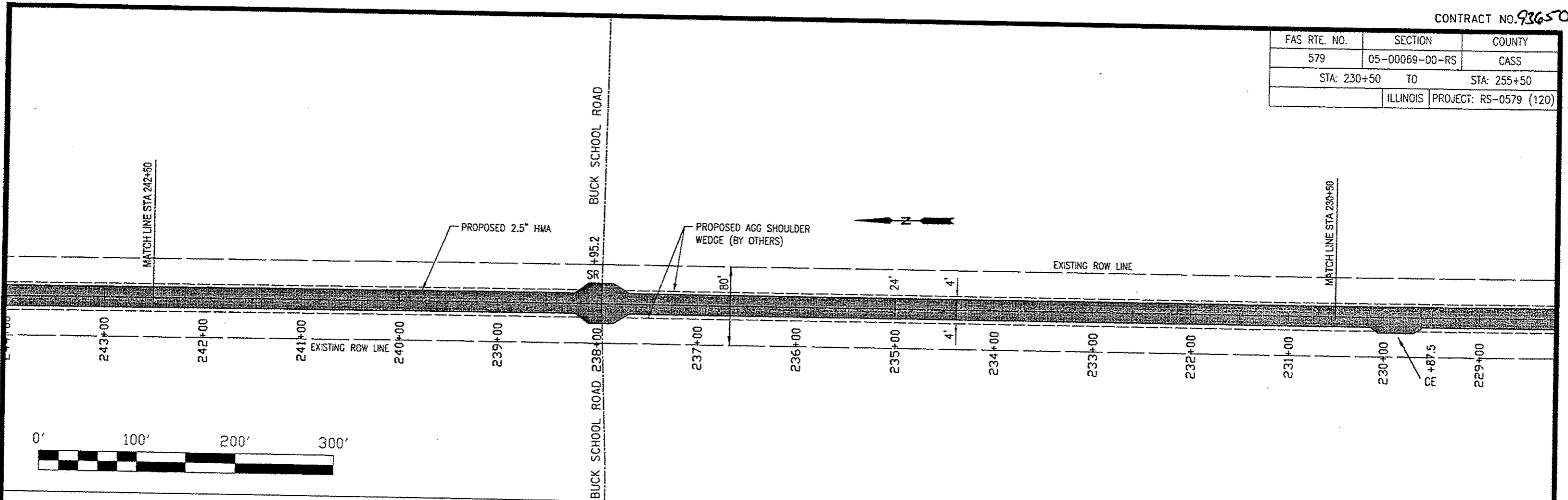

ILLINOIS DEPARTMENT OF TRANSPORTATION

COUNTY HIGHWAY 8  
PROPOSED PLAN

1"=100'  
DATE: 03/9/2015

DRAWN BY: KK  
CHECKED BY: TI  
SHEET 15 OF 22

FAS RTE. NO.	SECTION	COUNTY
579	05-00069-00-RS	CASS
STA: 255+50 TO		STA: 281+00
ILLINOIS		PROJECT: RS-0579 (120)

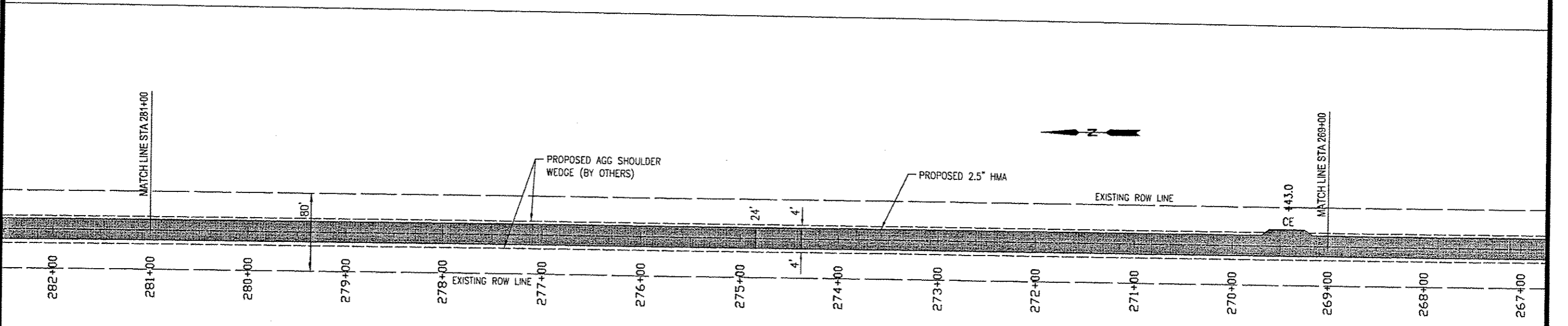
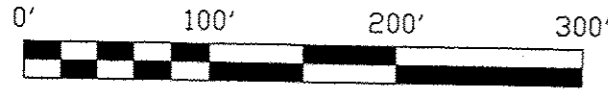
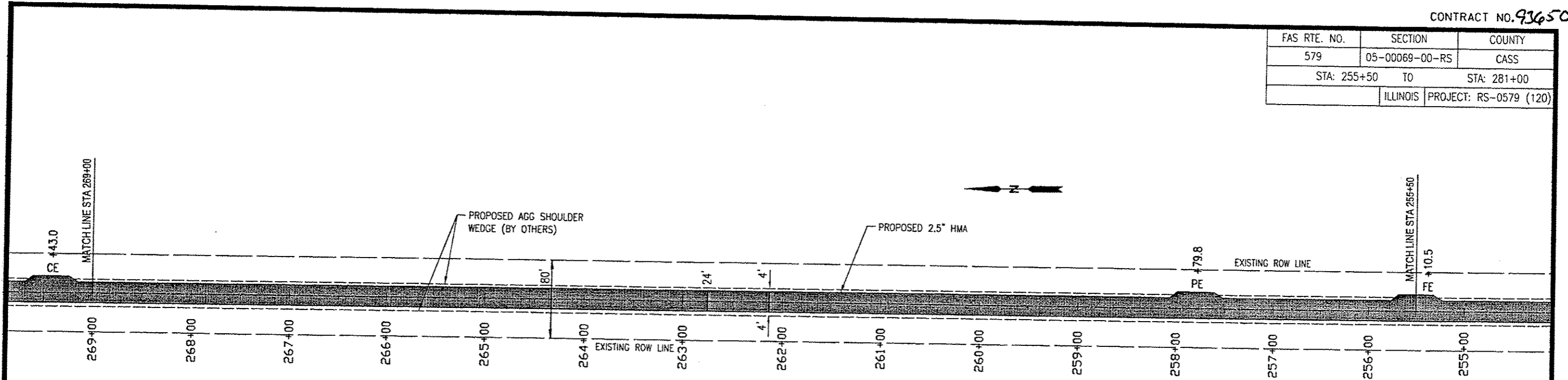

ILLINOIS DEPARTMENT OF TRANSPORTATION

COUNTY HIGHWAY 8  
PROPOSED PLAN

1"=100'

DATE: 03/9/2015

DRAWN BY: KK  
CHECKED BY: TI  
SHEET 16 OF 22



F.A. ROUTE	SECTION	COUNTY
579	05-00069-00-RS	CASS
STA: 281+00 TO		STA: 306+50
ILLINOIS		PROJECT: RS-0579 (120)

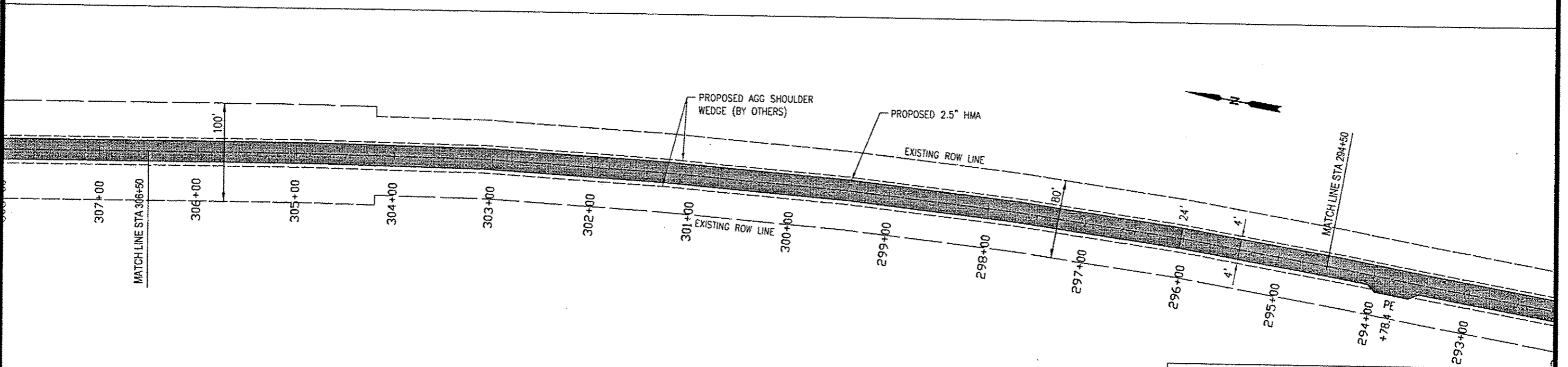
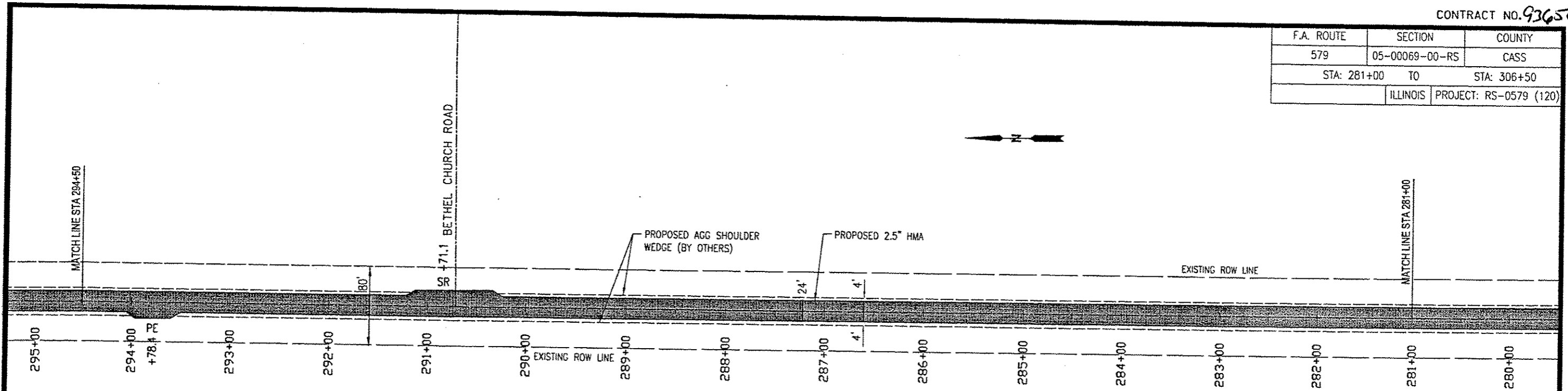

ILLINOIS DEPARTMENT OF TRANSPORTATION

COUNTY HIGHWAY 8  
PROPOSED PLAN

1"=100'  
DATE: 03/9/2015

DRAWN BY: KK  
CHECKED BY: TI  
SHEET 17 OF 22

FAS RTE. NO.	SECTION	COUNTY
579	05-00069-00-RS	CASS
STA: 306+50 TO		STA: 331+50
ILLINOIS		PROJECT: RS-0579 (120)

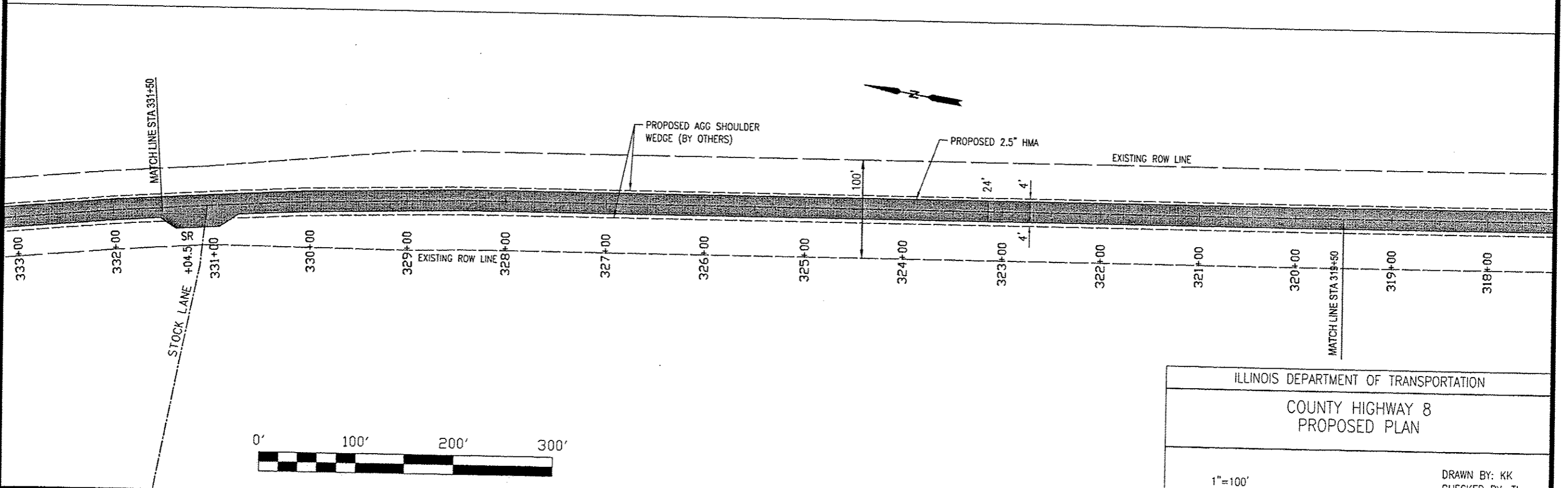
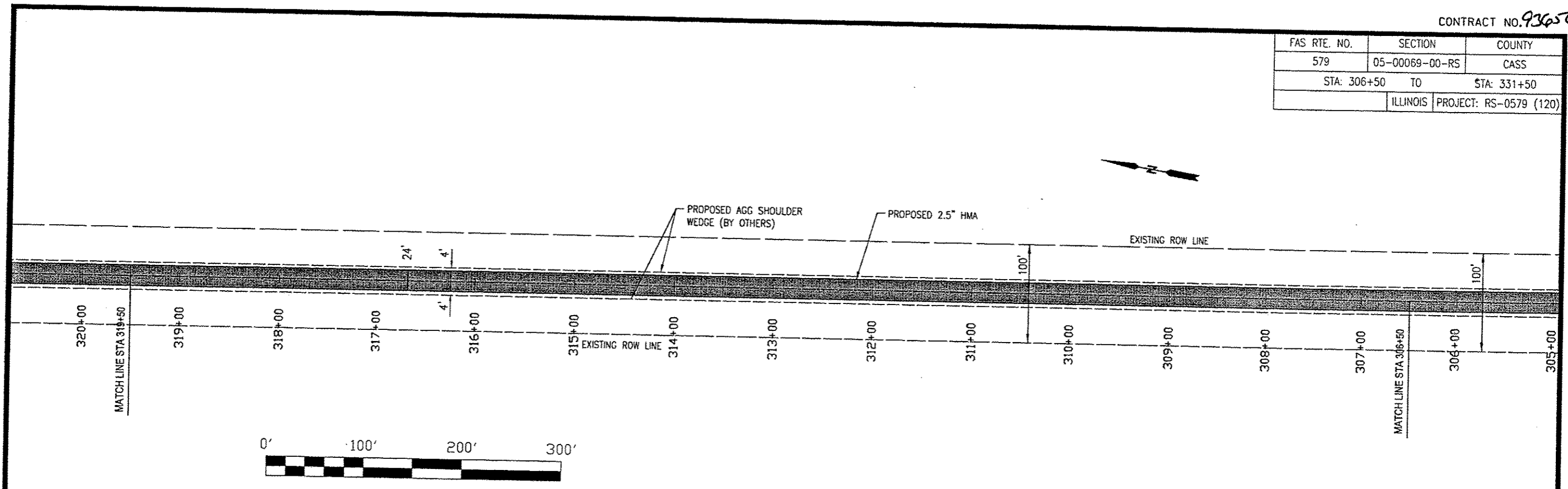

ILLINOIS DEPARTMENT OF TRANSPORTATION

COUNTY HIGHWAY 8  
PROPOSED PLAN

1"=100'  
DATE: 03/9/2015

DRAWN BY: KK  
CHECKED BY: TI  
SHEET 18 OF 22

FAS RTE. NO.	SECTION	COUNTY
579	05-00069-00-RS	CASS
STA: 331+50 TO		STA: 356+50
ILLINOIS		PROJECT: RS-0579 (120)

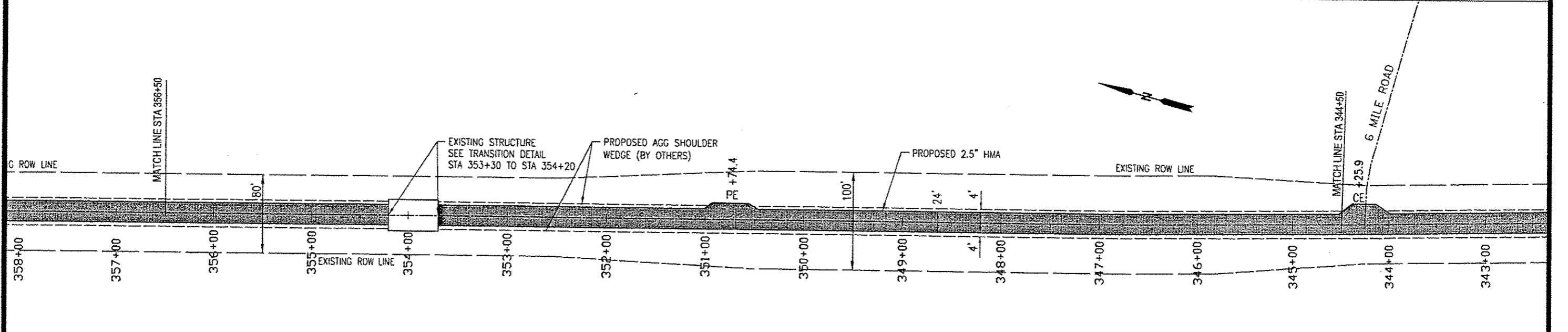
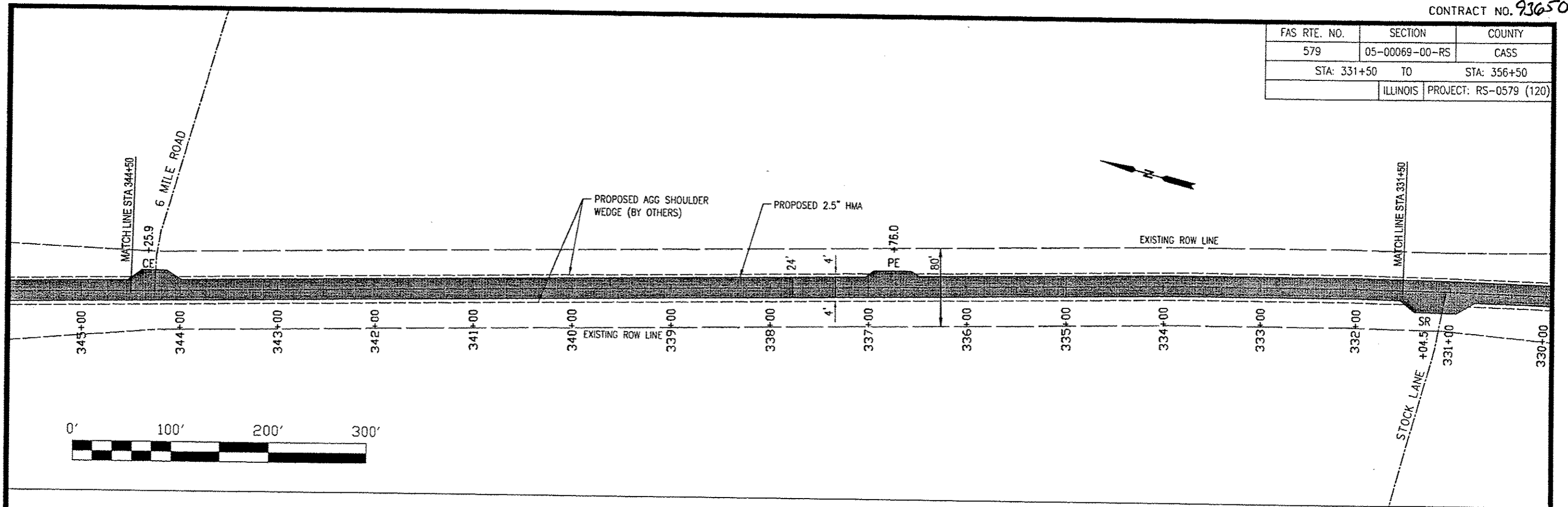

ILLINOIS DEPARTMENT OF TRANSPORTATION

COUNTY HIGHWAY 8  
PROPOSED PLAN

1"=100'  
DATE: 03/9/2015

DRAWN BY: KK  
CHECKED BY: TI  
SHEET 19 OF 22

FAS RTE. NO.	SECTION	COUNTY
579	05-00069-00-RS	CASS
STA: 356+50 TO		STA: 382+00
ILLINOIS		PROJECT: RS-0579 (120)

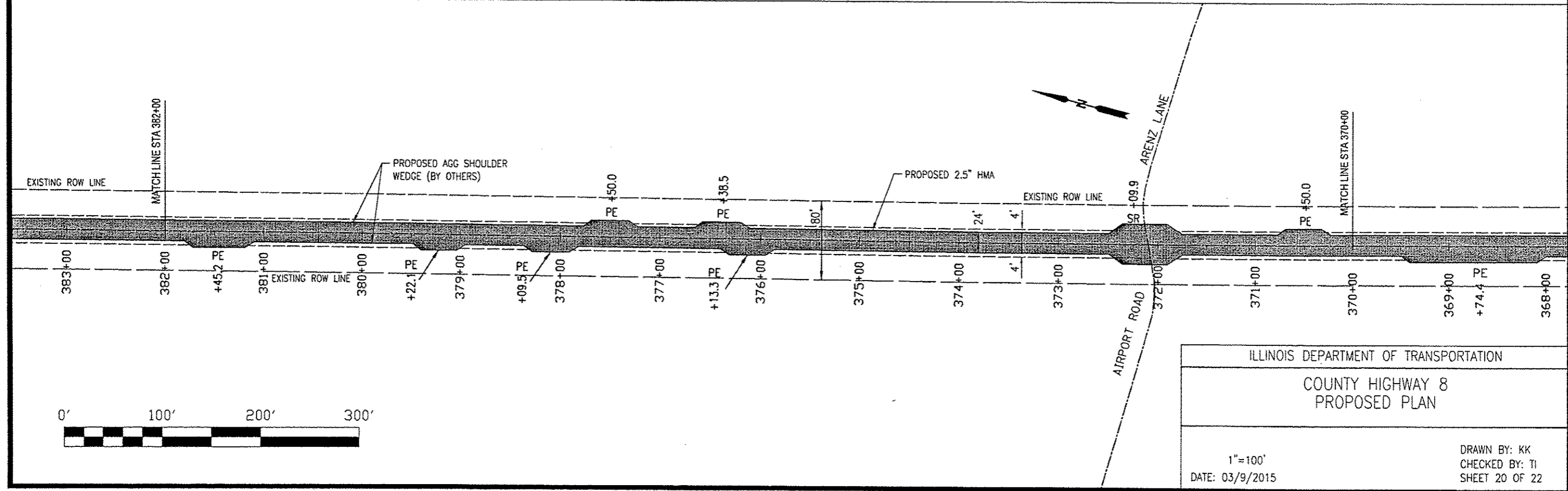
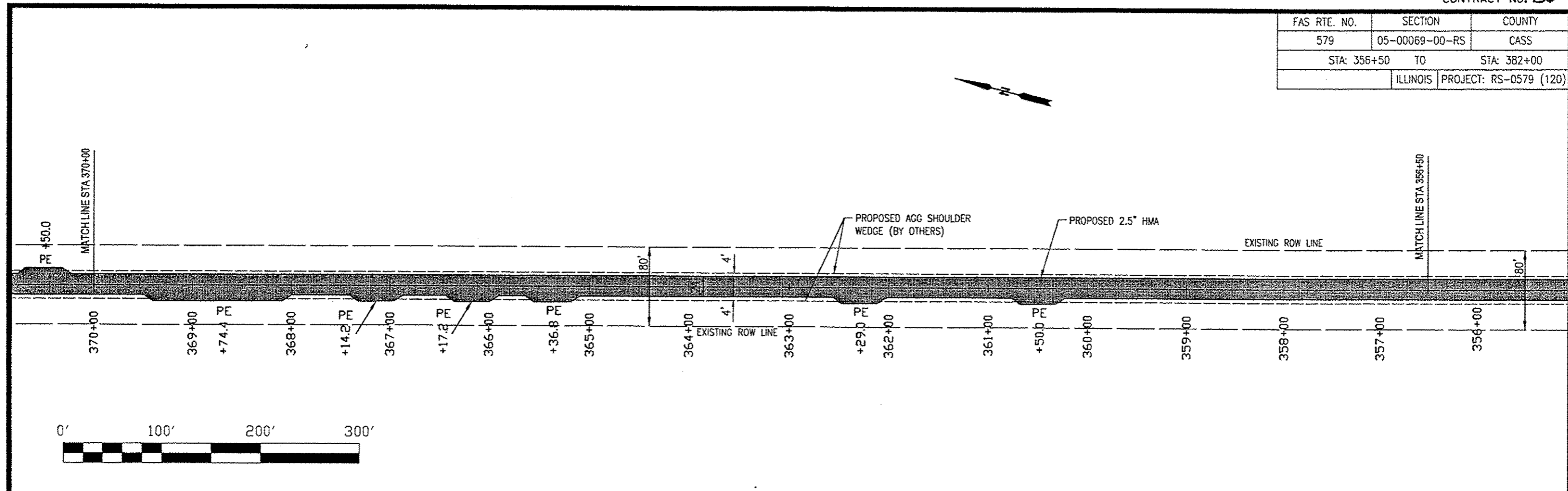

ILLINOIS DEPARTMENT OF TRANSPORTATION

COUNTY HIGHWAY 8  
PROPOSED PLAN

1"=100'  
DATE: 03/9/2015

DRAWN BY: KK  
CHECKED BY: TI  
SHEET 20 OF 22

FAS RTE. NO.	SECTION	COUNTY
579	05-00069-00-RS	CASS
STA: 382+00 TO		STA: 407+00
ILLINOIS		PROJECT: RS-0579 (120)

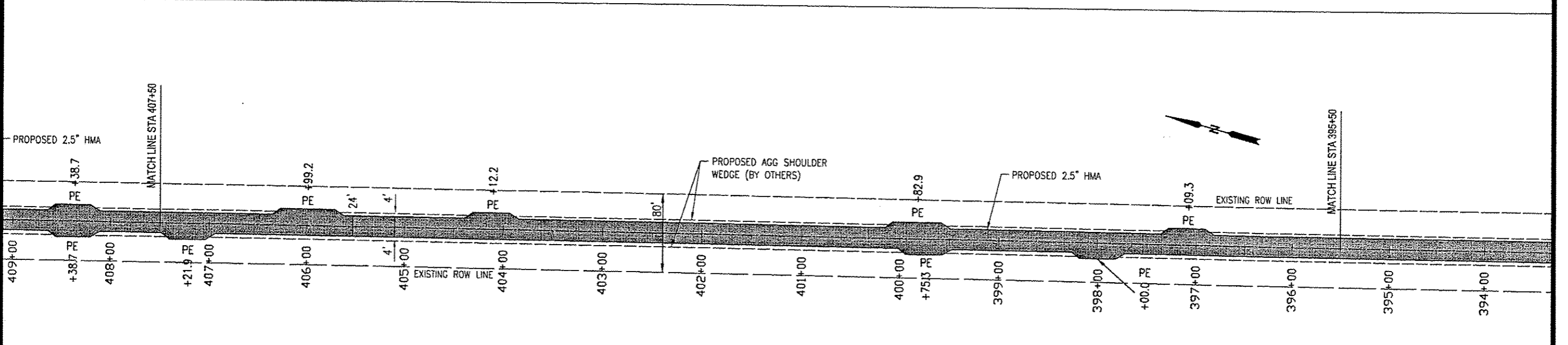
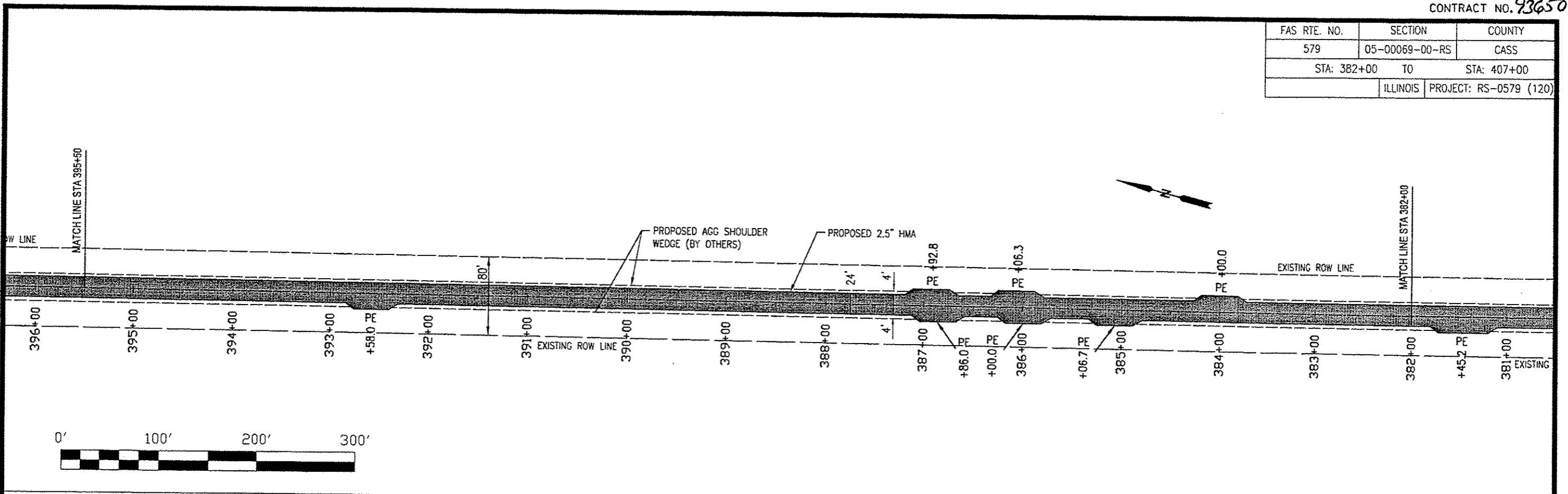

ILLINOIS DEPARTMENT OF TRANSPORTATION

COUNTY HIGHWAY 8  
PROPOSED PLAN

1"=100'  
DATE: 03/9/2015

DRAWN BY: KK  
CHECKED BY: TI  
SHEET 21 OF 22

FAS RTE. NO.	SECTION	COUNTY
579	05-00069-00-RS	CASS
STA: 407+00 TO		STA: 427+84.92
ILLINOIS		PROJECT: RS-0579 (120)

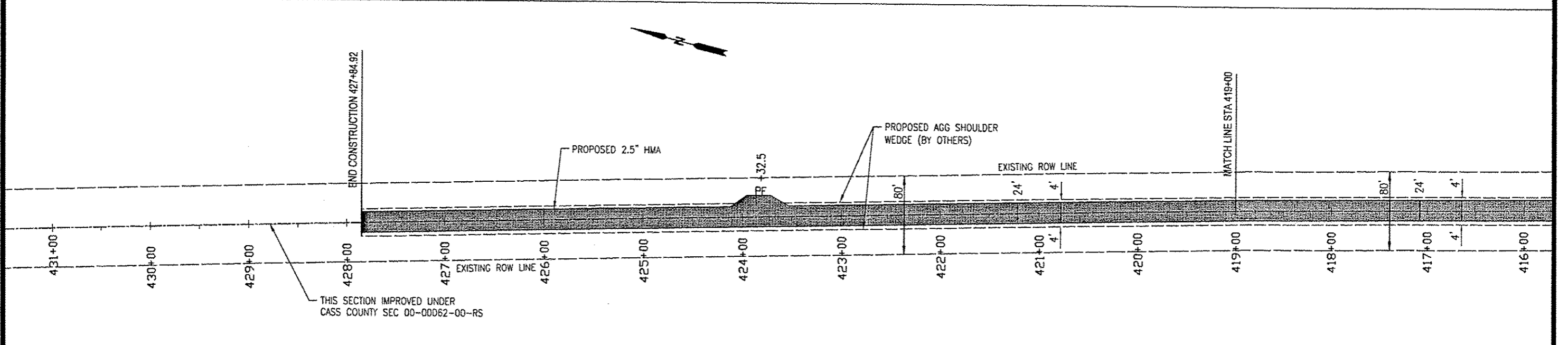
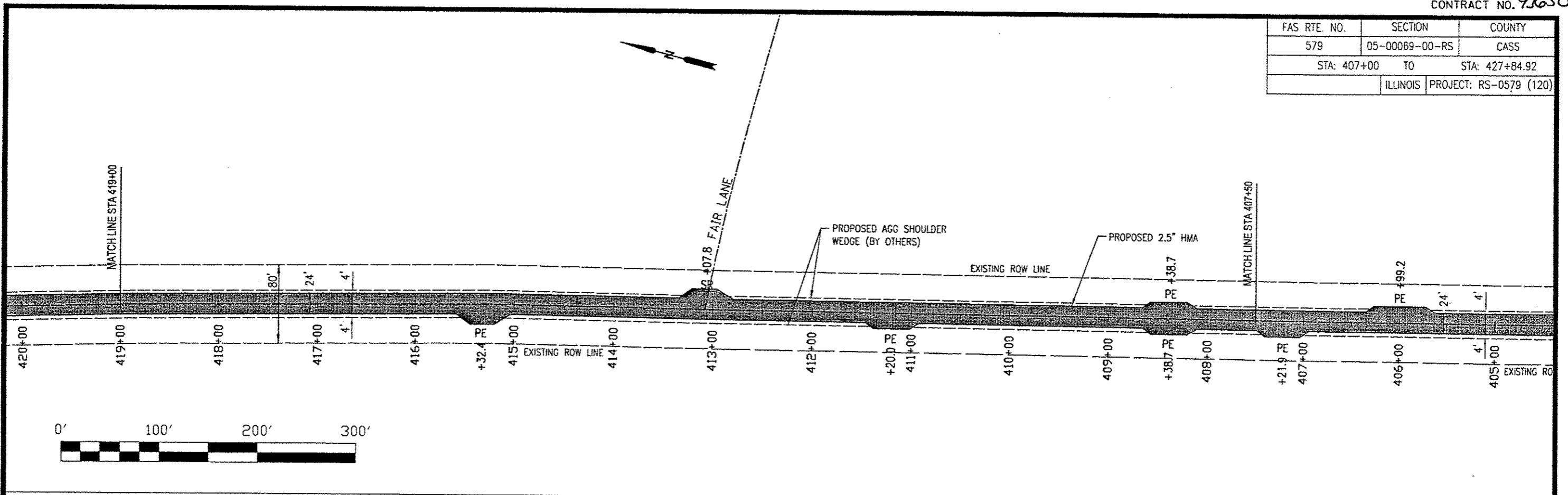

ILLINOIS DEPARTMENT OF TRANSPORTATION	
COUNTY HIGHWAY 8 PROPOSED PLAN	
1"=100' DATE: 03/9/2015	DRAWN BY: KK CHECKED BY: TI SHEET 22 OF 22