

STATE OF ILLINOIS  
DEPARTMENT OF TRANSPORTATION

F.A.P. RTE.	SECTION	COUNTY	TOTAL SHEETS	SHEET NO.
717	(103) BDR	LOGAN	9	1
ILLINOIS			CONTRACT NO. 72L74	

D-96-039-20

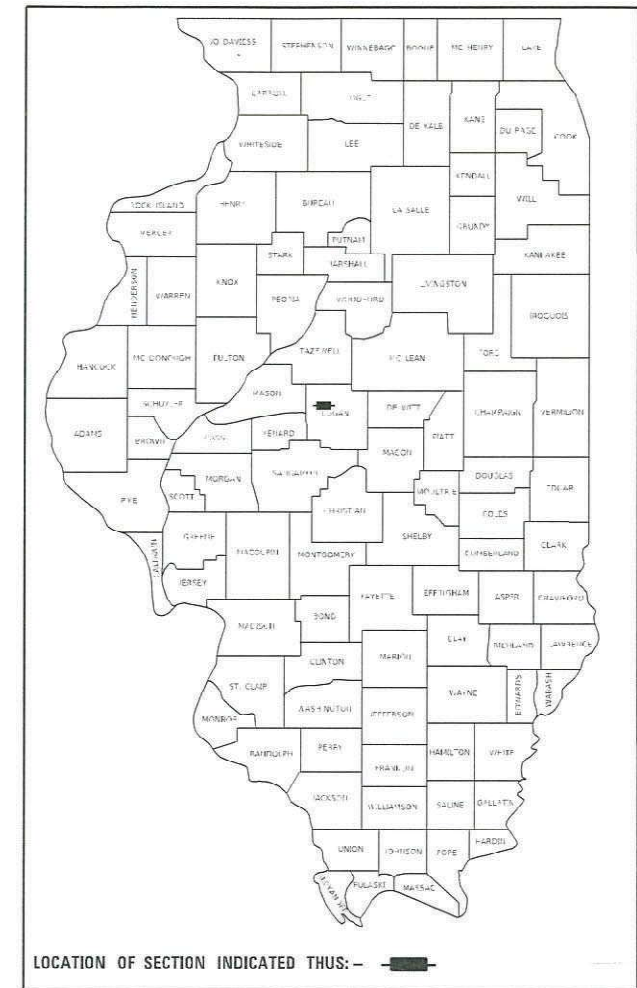

LOCATION OF SECTION INDICATED THUS: —■—

# PROPOSED CONTRACT MAINTENANCE

FAP ROUTE 717 (IL 10)  
SECTION (103) BDR  
PROJECT (STATE)  
BRIDGE DECK PATCHING  
LOGAN COUNTY

C-96-063-20

FOR INDEX OF SHEETS, SEE SHEET NO. 2

PROJECT LOCATION:  
SN 054-0105  
IL 10 KICKAPOO CREEK OVERFLOW  
LAT. 40.1616  
LONG. -89.4260

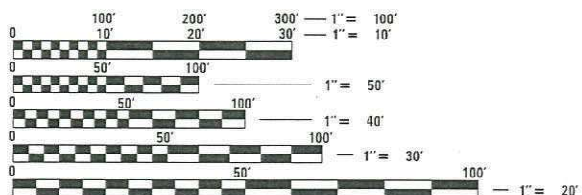

FULL SIZE PLANS HAVE BEEN PREPARED USING STANDARD ENGINEERING SCALES. REDUCED SIZED PLANS WILL NOT CONFORM TO STANDARD SCALES. IN MAKING MEASUREMENTS ON REDUCED PLANS, THE ABOVE SCALES MAY BE USED.

J.U.L.I.E.  
JOINT UTILITY LOCATION INFORMATION FOR EXCAVATORS  
1-800-892-0123  
OR 811

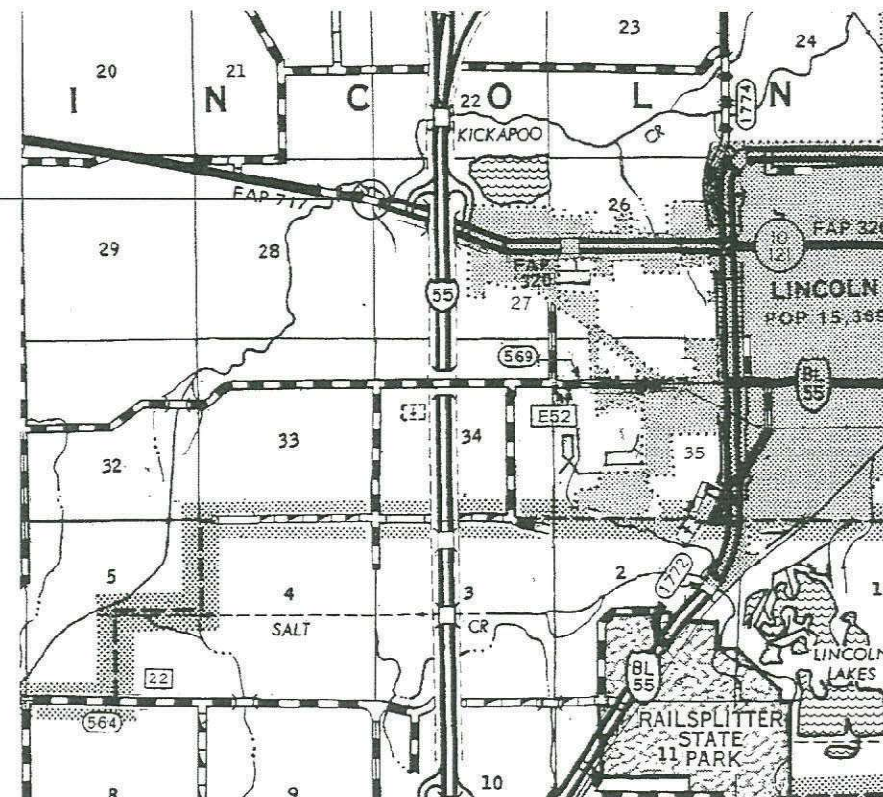

GROSS LENGTH = 2370 FT. = 0.45 MILE  
NET LENGTH = 296 FT. = 0.06 MILE

BRIDGE MAINTENANCE ENGINEER: BRANDON DUDLEY (217) 785-9290  
DESIGNER: CHRISTIAN RANDEL

CONTRACT NO. 72L74

STATE OF ILLINOIS  
DEPARTMENT OF TRANSPORTATION

SUBMITTED March 20, 2020  
*John P. May* REGIONAL ENGINEER

May 8, 2020 *Scott A. Elk*  
ENGINEER OF DESIGN AND ENVIRONMENT

May 8, 2020 *James J. Gu*  
DIRECTOR OF HIGHWAYS PROJECT IMPLEMENTATION

PRINTED BY THE AUTHORITY  
OF THE STATE OF ILLINOIS

INDEX OF SHEETS:



- 1 COVER SHEET
- 2 INDEX OF SHEETS
- 3 SUMMARY OF QUANTITIES
- 4 STAGING DETAILS
- 5-7 TRAFFIC CONTROL
- 8 GENERAL PLAN AND ELEVATION
- 9 DECK REPAIR PLAN

HIGHWAY STANDARDS:

- 000001-07
- 001006
- 701001-02
- 701006-05
- 701201-05
- 701301-04
- 701316-13
- 701001-02
- 701006-05
- 701901-08

GENERAL NOTES:

AREAS OF DECK REPAIRS SHOWN ARE ESTIMATED. THE ENGINEER SHALL SHOW ACTUAL LOCATIONS OF DECK REPAIRS ON AS-BUILT PLANS.

<b>STATE OF ILLINOIS DEPARTMENT OF TRANSPORTATION DIVISION OF HIGHWAYS DISTRICT 6</b>	
EXAMINED	March 16 20 20
 ENGINEER OF OPERATIONS	
EXAMINED	March 12 20 20
 ENGINEER OF PROJECT IMPLEMENTATION	
EXAMINED	March 18 20 20
 ENGINEER OF PROGRAM DEVELOPMENT	

REV. - MS

MODEL: Default  
 FILE NAME: C:\OPERATIONS\Bridges\Bridges\Bridges\CAD\72L74 - 0540105 deck patching\CAD\72L74 Design.dgn

USER NAME = dudleybm	DESIGNED - CAR	REVISED -
	DRAWN - CAR	REVISED -
PLOT SCALE = 90.0000' / in.	CHECKED -	REVISED -
PLOT DATE = 3/19/2020	DATE -	REVISED -

**STATE OF ILLINOIS  
DEPARTMENT OF TRANSPORTATION**

<b>INDEX OF SHEETS, GENERAL NOTES, HIGHWAY STANDARDS, &amp; SIGNATURES</b>	
SCALE:	SHEET OF SHEETS STA. TO STA.

F.A.P. RTE.	SECTION	COUNTY	TOTAL SHEETS	SHEET NO.
717	(103) BDR	LOGAN	9	2
CONTRACT NO. 72L74				
ILLINOIS				

RURAL

0-02174-6019

SN 054-0105

100% STATE

BRIDGE

0047

LOGAN

CODE NO.	ITEM	UNIT	TOTAL QUANTITY	
67100100	MOBILIZATION	LSUM	1.0	1.0
70100100	TRAFFIC CONTROL AND PROTECTION, STANDARD 701316	EACH	1.0	1.0
70100450	TRAFFIC CONTROL AND PROTECTION, STANDARD 701201	LSUM	1.0	1.0
70106500	TEMPORARY BRIDGE TRAFFIC SIGNALS	EACH	1.0	1.0
X5930100	CONTROLLED LOW-STRENGTH MATERIAL, SPECIAL	CU YD	4.0	4.0
Z0016200	DECK SLAB REPAIR (PARTIAL)	SQ YD	131.0	131.0
Z0001800	APPROACH SLAB REPAIR (PARTIAL DEPTH)	SQ YD	3.0	3.0
Z0032500	JOINT SEALING (PATCHES)	FOOT	924.0	924.0

MODEL: Default  
 FILE NAME: C:\OPERATIONS\Bridges\BridgesPlans\_CAD\72174 - 0540105\_deck\_patches\CAD\72174\_Design.dgn

USER NAME = dudleybm	DESIGNED - CAR	REVISED -
	DRAWN - CAR	REVISED -
PLOT SCALE = 90.0000 ' / in.	CHECKED -	REVISED -
PLOT DATE = 3/19/2020	DATE -	REVISED -

STATE OF ILLINOIS  
DEPARTMENT OF TRANSPORTATION

SUMMARY OF QUANTITIES			
SCALE:	SHEET	OF SHEETS	STA. TO STA.

F.A.P. RTE.	SECTION	COUNTY	TOTAL SHEETS	SHEET NO.
717	(103) BDR	LOGAN	9	3
			CONTRACT NO. 72L74	
ILLINOIS				

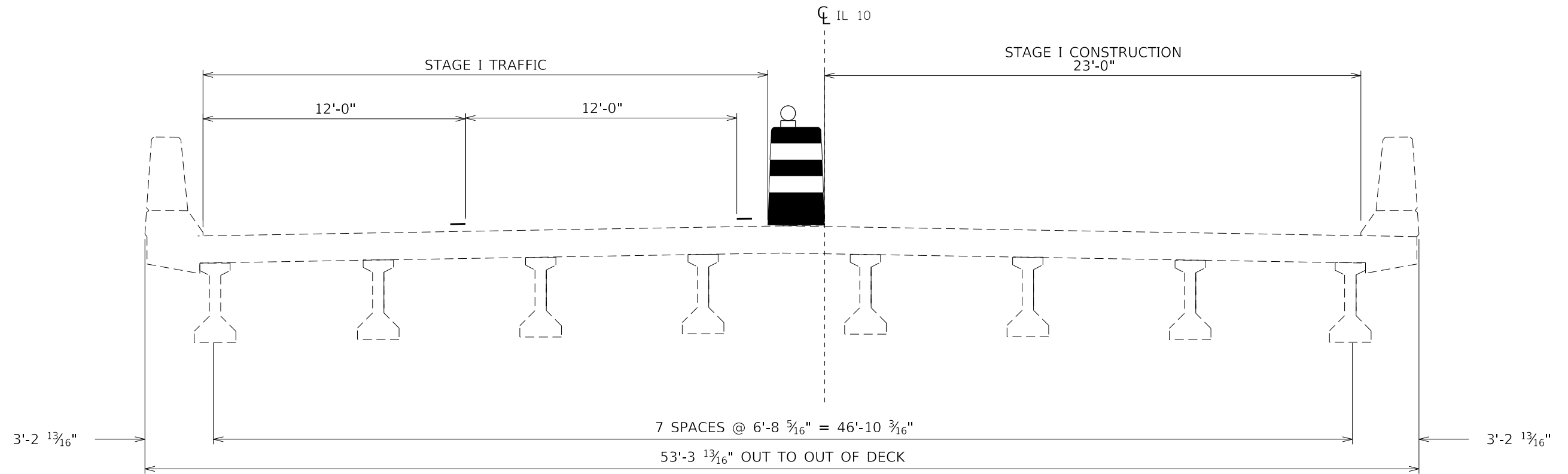

STAGE I CROSS SECTION TYPICAL (LOOKING EAST)

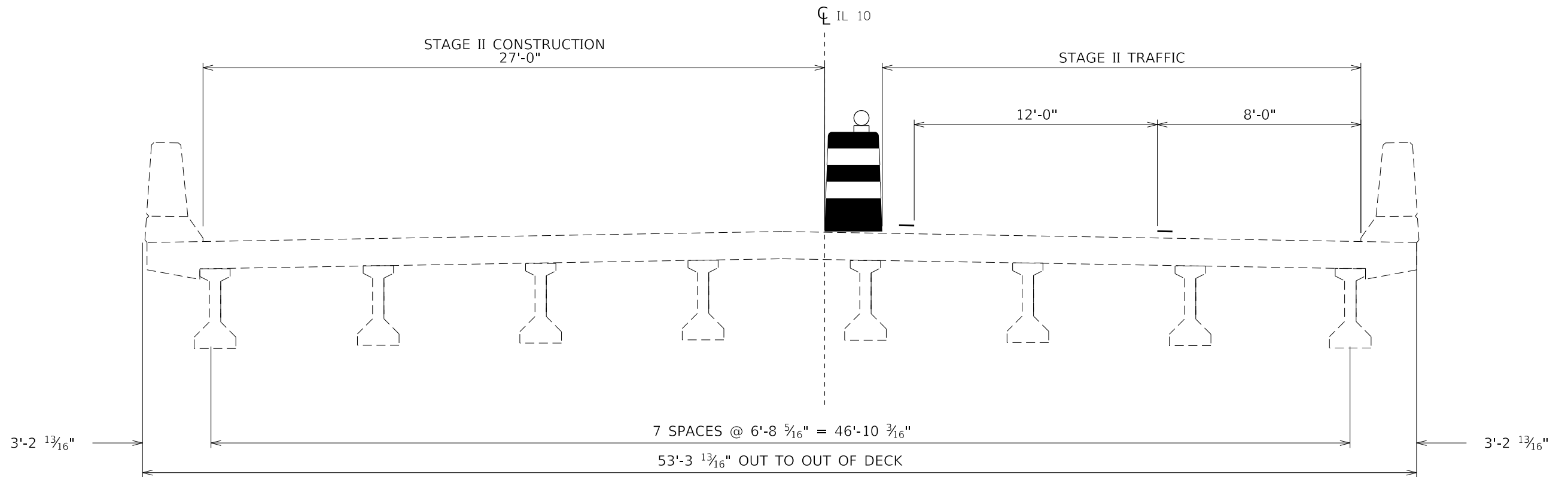

STAGE II CROSS SECTION TYPICAL (LOOKING EAST)

MODEL: Default  
FILE: \\MAILS-CO\OPERATIONS\Bridges\BDR\logans\_CAD\72L74 - 0540105\_deck\_patch\m\CAD\72L74\_Design.dgn

USER NAME = dudleybm	DESIGNED - CAR	REVISED -
	DRAWN - CAR	REVISED -
PLOT SCALE = 80.0000 ' / in.	CHECKED -	REVISED -
PLOT DATE = 3/19/2020	DATE -	REVISED -

STATE OF ILLINOIS  
DEPARTMENT OF TRANSPORTATION





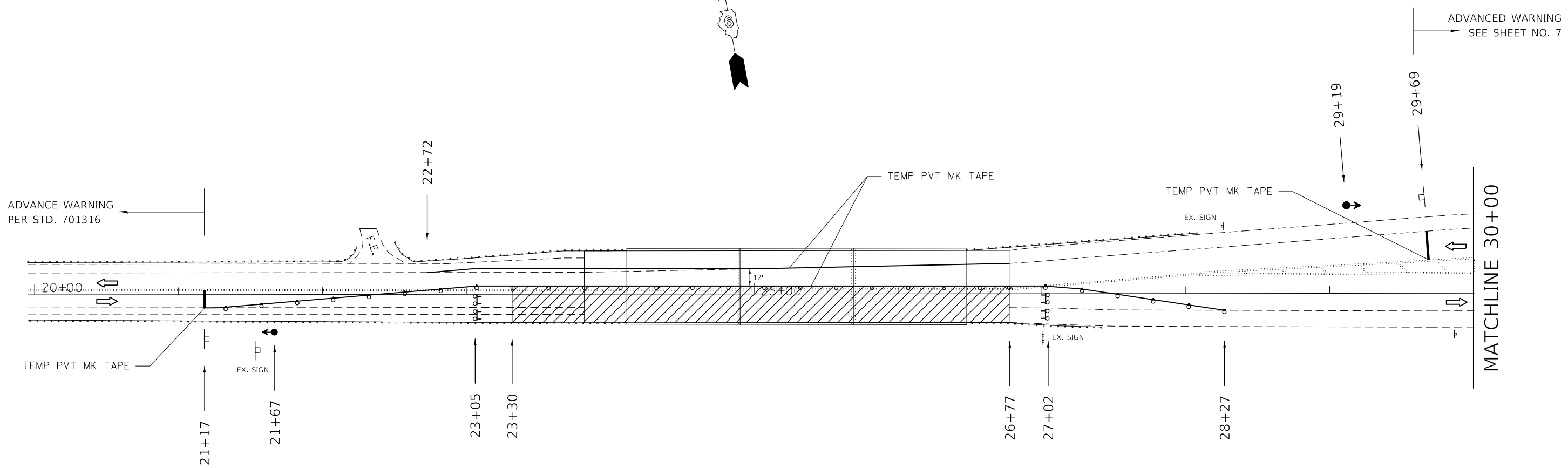

TRAFFIC STAGING  
SN 054-0105

SCALE: SHEET 1 OF 1 SHEETS STA. TO STA.

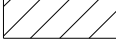
F.A.P. RTE. 717	SECTION (103) BDR	COUNTY LOGAN	TOTAL SHEETS 9	SHEET NO. 4
CONTRACT NO. 72L74			ILLINOIS	

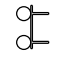

**SYMBOLS**

-  Work area
-  Sign
-  Traffic signal
-  Drum with steady burn bi-directional light
-  Type III barricade with flashing lights
-  Drum

**NOTES**

- TRAFFIC CONTROL SHALL CONFORM TO STANDARD 701316 AND AS SHOWN ON THIS SHEET.
- REMOVAL OF EXISTING PAVEMENT MARKINGS WILL NOT BE REQUIRED.
- RUMBLE STRIPS IN STANDARD 701316 WILL NOT BE REQUIRED.

MODEL: Default  
 FILE NAME: C:\OPERATIONS\Bridges\BDR\BDRplans\_CAD\72L74 - 0540105\_deck\_patch\72L74\_Design.dgn

USER NAME = dudleybm	DESIGNED - CAR	REVISED -
	DRAWN - CAR	REVISED -
PLOT SCALE = 72.0000' / in.	CHECKED -	REVISED -
PLOT DATE = 3/19/2020	DATE -	REVISED -

STATE OF ILLINOIS  
 DEPARTMENT OF TRANSPORTATION





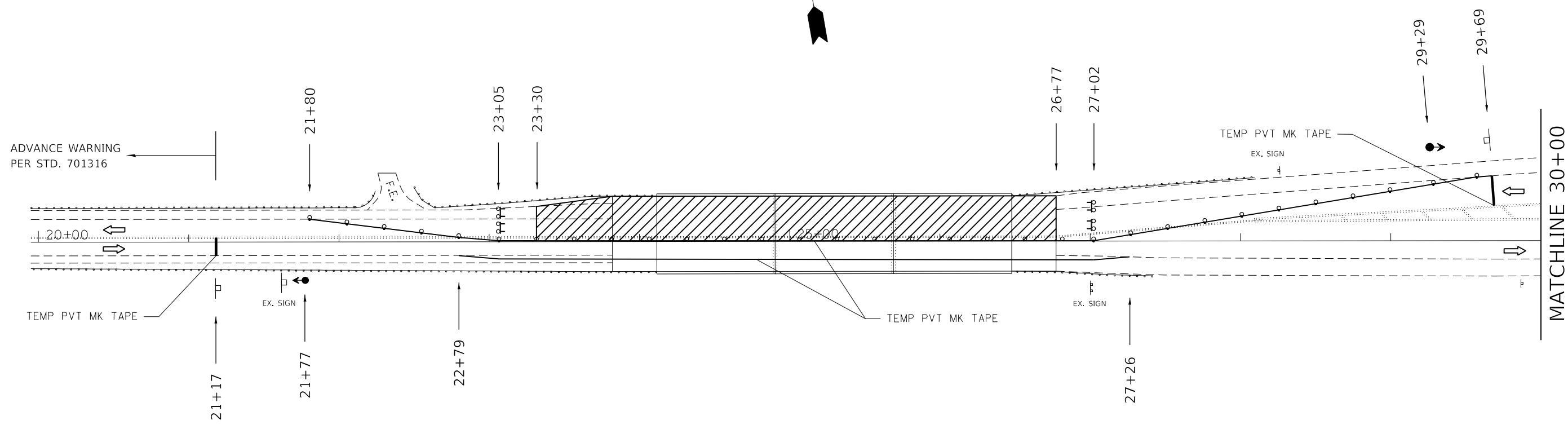

TRAFFIC CONTROL PLAN - STAGE I  
 SN 054-0105

SCALE: SHEET 1 OF 3 SHEETS STA. 20+00 TO STA. 30+00

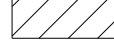
F.A.P. RTE.	SECTION	COUNTY	TOTAL SHEETS	SHEET NO.
717	(103) BDR	LOGAN	9	5
ILLINOIS			CONTRACT NO. 72L74	

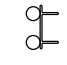

**SYMBOLS**

-  Work area
-  Sign
-  Traffic signal
-  Drum with steady burn bi-directional light
-  Type III barricade with flashing lights
-  Drum

**NOTES**

- TRAFFIC CONTROL SHALL CONFORM TO STANDARD 701316 AND AS SHOWN ON THIS SHEET.
- REMOVAL OF EXISTING PAVEMENT MARKINGS WILL NOT BE REQUIRED.
- RUMBLE STRIPS IN STANDARD 701316 WILL NOT BE REQUIRED.

MODEL: Default  
 FILE NAME: C:\OPERATIONS\Bridges\BDR\BDRplans\_CAD\72L74 - 0540105\_deck\_patch.dwg  
 USER: dudleybm  
 PLOT SCALE = 72.0000' / in.  
 PLOT DATE = 3/19/2020

USER NAME = dudleybm	DESIGNED - CAR	REVISED -
	DRAWN - CAR	REVISED -
PLOT SCALE = 72.0000' / in.	CHECKED -	REVISED -
PLOT DATE = 3/19/2020	DATE -	REVISED -

STATE OF ILLINOIS  
 DEPARTMENT OF TRANSPORTATION

TRAFFIC CONTROL PLAN - STAGE II		
SN 054-0105		
SCALE:	SHEET 2 OF 3 SHEETS	STA. 20+00 TO STA. 30+00

F.A.P. RTE. 717	SECTION (103) BDR	COUNTY LOGAN	TOTAL SHEETS 9	SHEET NO. 6
ILLINOIS			CONTRACT NO. 72L74	

MATCHLINE 33+00



9+67

W20-1(0)-48

POT STA 12+67.46

12+17

W12-1102(0)-48

W3-3(0)-48

34+69

W20-4(0)-48  
+  
W13-1(0)-2424

37+69

W12-1102(0)-48

42+69

W20-1(0)-48

47+69

POT Sta 34+41.15

STA 40+00.48 (IL 10) =  
10+00.000 OFF RAMP

PC STA 41+13.25

180°00'0.1"

80°05'34"

45+00

35+00

40+00

MODEL: Default  
FILE NAME: C:\OPERATIONS\Bids\Bids\plans\_CAD\72L74 - 0540105 Back matching\CAD\72L74 Design.dgn

USER NAME = dudleybm	DESIGNED - CAR	REVISED -
DRAWN - CAR	CHECKED -	REVISED -
PLOT SCALE = 92.4000' / in.	DATE -	REVISED -
PLOT DATE = 3/19/2020		

STATE OF ILLINOIS  
DEPARTMENT OF TRANSPORTATION

TRAFFIC CONTROL PLAN - STAGE I+II  
SN 054-0105

SCALE: SHEET 3 OF 3 SHEETS STA. 33+00 TO STA. 47+69

F.A.P. RTE.	SECTION	COUNTY	TOTAL SHEETS	SHEET NO.
717	(103) BDR	LOGAN	9	7
ILLINOIS			CONTRACT NO. 72L74	

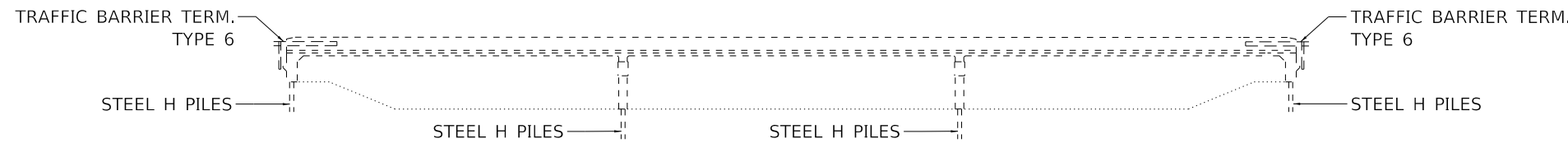

**ELEVATION**

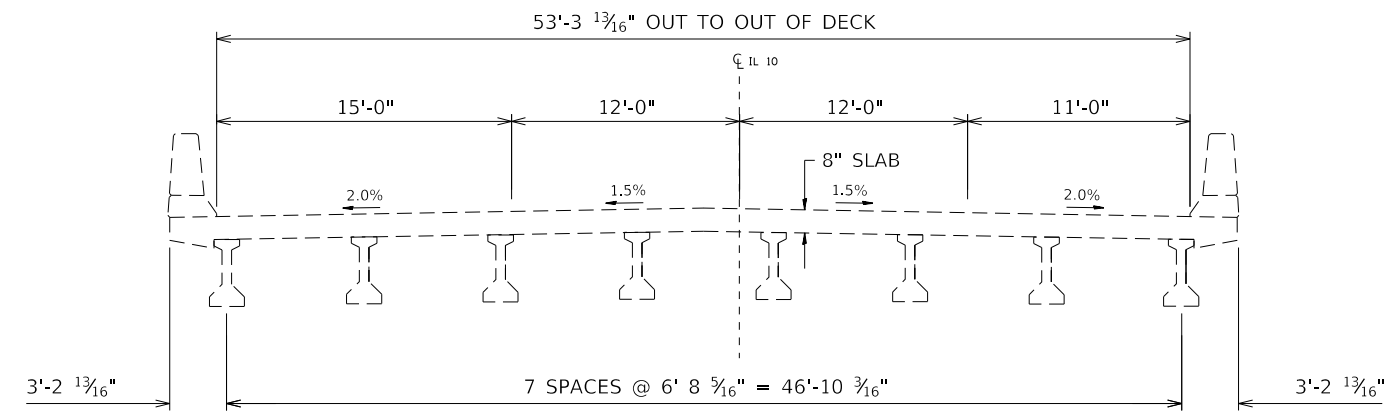

**CROSS SECTION  
(LOOKING EAST)**

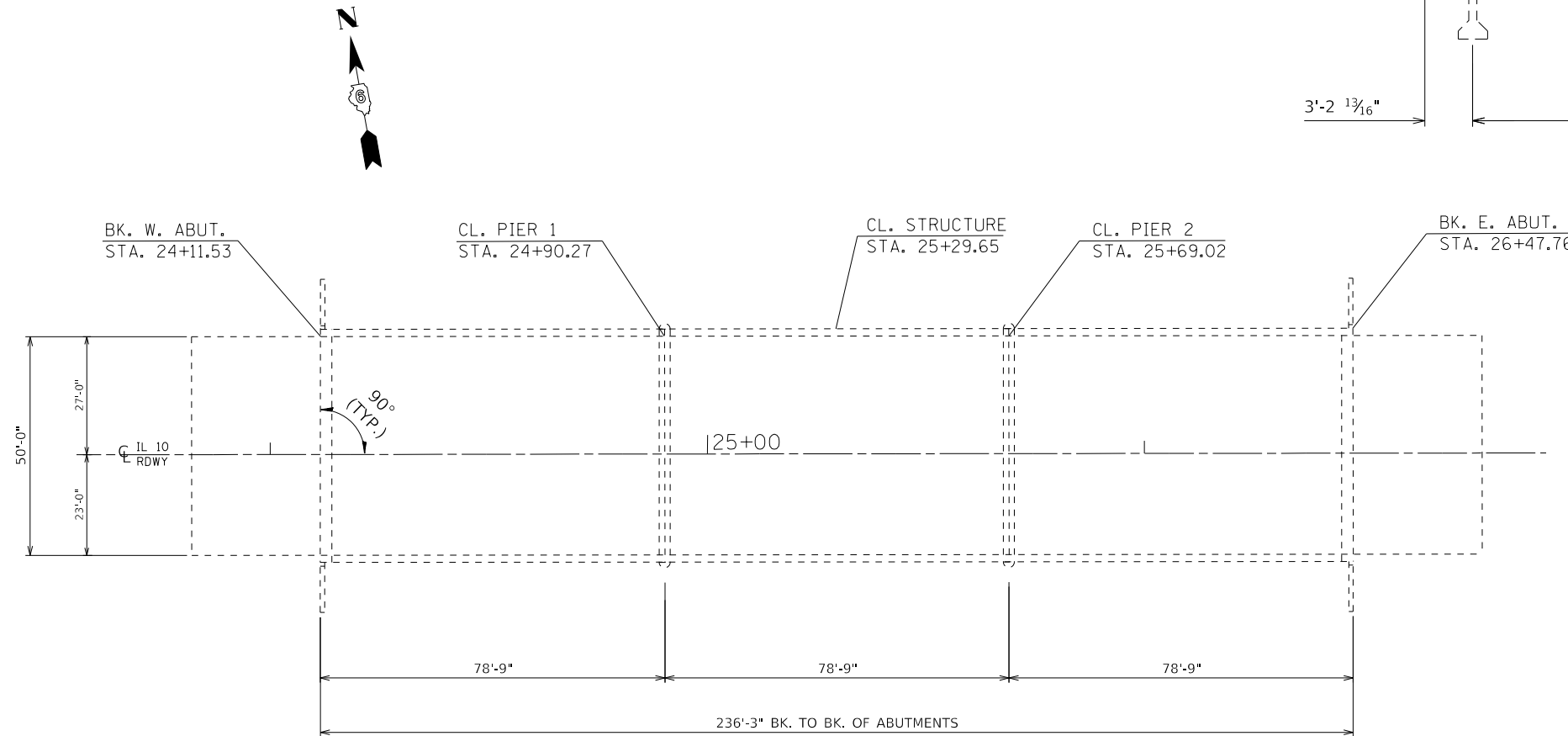

**PLAN**

TOTAL BILL OF MATERIAL - SN 054-0105		
ITEM	UNIT	TOTAL QUANTITY
DECK SLAB REPAIR (PARTIAL)	SQ YD	131
APPROACH SLAB REPAIR (PARTIAL DEPTH)	SQ YD	3
JOINT SEALING (PATCHES)	FT.	924
CONTROLLED LOW STRENGTH MATERIAL (SPL)	CU YD	4

**STRUCTURE GENERAL NOTES:**

JOINT SEALING (PATCHES) SHALL BE PLACED AS DESCRIBED IN THE SPECIAL PROVISIONS.

PRIOR TO POURING THE NEW CONCRETE PATCHES, ALL HEAVY OR LOOSE MILL SCALE AND OTHER LOOSE OR POTENTIALLY DETRIMENTAL FOREIGN MATERIAL SHALL BE REMOVED FROM THE SURFACES IN CONTACT WITH CONCRETE. TIGHTLY ADHERED PAINT MAY REMAIN UNLESS OTHERWISE NOTED. REMOVAL SHALL BE ACCOMPLISHED BY METHODS THAT WILL NOT DAMAGE THE STEEL AND THE COST WILL BE INCLUDED IN CONCRETE REMOVAL.

PLAN DIMENSIONS AND DETAILS RELATIVE TO EXISTING PLANS ARE SUBJECT TO NOMINAL CONSTRUCTION VARIATIONS. THE CONTRACTOR SHALL FIELD VERIFY EXISTING DIMENSIONS AND DETAILS AFFECTING NEW CONSTRUCTION AND MAKE NECESSARY APPROVED ADJUSTMENTS PRIOR TO CONSTRUCTION OR ORDERING OF MATERIALS. SUCH VARIATIONS SHALL NOT BE CAUSE FOR ADDITIONAL COMPENSATION FOR A CHANGE IN THE SCOPE OF WORK, HOWEVER, THE CONTRACTOR WILL BE PAID FOR THE QUANTITY ACTUALLY FURNISHED AT THE UNIT PRICE BID FOR THE WORK.

EXISTING REINFORCEMENT BARS EXTENDING INTO THE REMOVAL AREA SHALL BE CLEANED, STRAIGHTENED, AND INCORPORATED INTO THE NEW CONSTRUCTION. ANY REINFORCEMENT BARS THAT ARE DAMAGED DURING CONCRETE REMOVAL SHALL BE REPLACED WITH AN APPROVED BAR SPLICER OR ANCHORAGE SYSTEM. COST INCLUDED WITH CONCRETE REMOVAL.

BENCH MARK: BM#2. CHISELED "□" ON SOUTHWEST WINGWALL STATION 24+12, 32' RT ELEV. 170.35



Expires 11-30-2020

*David Carl Puze*

5/8/2020

GENERAL PLAN  
F.A.P. ROTE 717 OVER  
KICKAPOO CREEK OVERFLOW  
ILLINOIS ROUTE 10 - SECTION (103) BDR  
LOGAN COUNTY  
STATION 25+29.65  
STRUCTURE NO. 054-0105

STATE OF ILLINOIS  
DEPARTMENT OF TRANSPORTATION

GENERAL PLAN AND ELEVATION  
SN 054-0105

F.A.P. RTE.	SECTION	COUNTY	TOTAL SHEETS	SHEET NO.
717	(103) BDR	LOGAN	9	8
CONTRACT NO. 72L74				

SCALE: SHEET 1 OF 1 SHEETS STA. 24+11 TO STA. 26+48

MODEL: Default  
FILE NAME: C:\OPERATIONS\bridge\bridgeplans\_CAD\72L74 - 0540105 deck\_patching\CAD\72L74\_Design.dgn



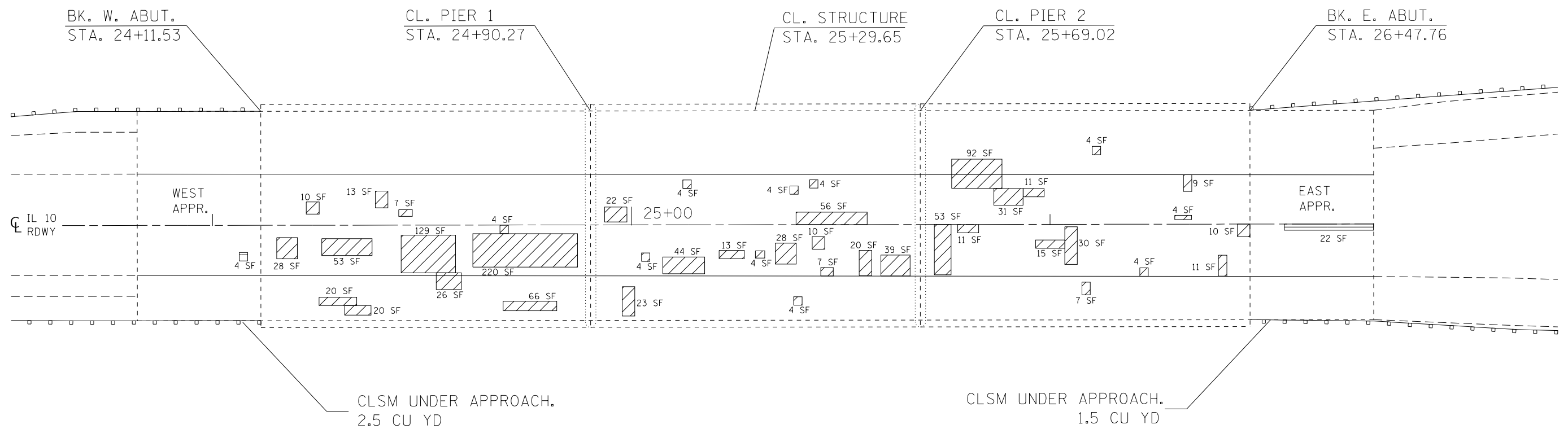

**SYMBOLS**

- PARTIAL DEPTH SLAB REPAIR AREAS
- APPROACH SLAB REPAIR AREAS

BILL OF MATERIAL - SN 054-0105		
ITEM	UNIT	TOTAL QUANTITY
DECK SLAB REPAIR (PARTIAL)	SQ YD	131
APPROACH SLAB REPAIR (PARTIAL DEPTH)	SQ YD	3
JOINT SEALING (PATCHES)	FT.	924
CONTROLLED LOW STRENGTH MATERIAL (SPL)	CU YD	4

**GENERAL NOTES:**

1. THE PATCH SIZES AND LOCATIONS SHOWN ON THE PLAN SHEETS ARE ESTIMATED. THE FINAL PATCH LOCATIONS SHALL BE DETERMINED BY THE ENGINEER IN THE FIELD.
2. ALL PATCHES SHALL BE SEALED AROUND THEIR PERIMETER.
3. EROSION OCCURING UNDER THE APPROACHES AT BACK OF ABUTMENTS. VOID WILL BE FILLED WITH CONTROLLED LOW STRENGTH MATERIAL (CLSM). QUANTITY IS AN ESTIMATE. SEE SPECIAL PROVISIONS.

MODEL: Default  
 FILE NAME: C:\OPERATIONS\Bridges\BDR\BDRPlans\_CAD\72L74 - 0540105\_deck\_patching\CAD\72L74\_Design.dgn

USER NAME = dudleybm	DESIGNED - CAR	REVISED -
DRAWN - CAR	REVISIONS	
PLOT SCALE = 87.3856' / in.	CHECKED -	REVISED -
PLOT DATE = 3/19/2020	DATE -	REVISED -

**STATE OF ILLINOIS**  
**DEPARTMENT OF TRANSPORTATION**

<b>DECK REPAIR PLAN</b>	
<b>SN 054-0105</b>	
SCALE:	SHEET 1 OF 1 SHEETS
STA. 24+11	TO STA. 26+48

F.A.P. RTE.	SECTION	COUNTY	TOTAL SHEETS	SHEET NO.
717	(103) BDR	LOGAN	9	9
CONTRACT NO. 72L74				