

"PRINTED BY THE AUTHORITY OF THE STATE OF ILLINOIS"

06-12-2020 LETTING ITEM 114

STATE OF ILLINOIS
DEPARTMENT OF TRANSPORTATION
DIVISION OF HIGHWAYS

ROUTE NO.	SECTION	COUNTY	TOTAL SHEETS	SHEET NO.
FAS 316	16-00289-00-RS	IROQUOIS	9	1
JOB #: C-93-002-21			PROJECT #: XDEL(136)	
CONTRACT 87716				

PLANS FOR PROPOSED IMPROVEMENT OF
FEDERAL AID SECONDARY HIGHWAY 316
SURFACE TRANSPORTATION PROGRAM - RURAL
"HMA RESURFACING PROJECT"
IROQUOIS COUNTY

FAS ROUTE 316 (CH 23)
SECTION: 16-00289-00-RS
PROJECT NO. XDEL(136)
JOB NO. C-93-002-21
CONTRACT NO. 87716

INDEX OF SHEETS	
SHEET NUMBER	DESCRIPTION
1	COVER SHEET -- LOCATION MAP
2	SUMMARY OF QUANTITIES, GENERAL NOTES, MIXTURE TABLE, AND BUTT JOINT DETAIL
3	EXISTING & PROPOSED X-SECTIONS - 0+50 TO 0+65
4	EXISTING & PROPOSED X-SECTIONS - 0+65 TO 102+00
5	EXISTING & PROPOSED X-SECTIONS - 102+00 TO 115+00
6	EXISTING & PROPOSED X-SECTIONS - 115+00 TO 187+05
7	TYPICAL ENTRANCES, SIDE ROAD INTERSECTIONS, MAIL BOX TURNOUTS & INCIDENTAL HMA SURFACING
8	QUANTITY TABLES
9	STRUCTURE #038-3606 RESURFACING & SUPER ELEVATION DATA

ILLINOIS HIGHWAY STANDARD DRAWINGS	
000001-07	SYMBOLS AND ABBREVIATIONS
701301-04	LANE CLOSURE, 2L 2W, SHORT TIME OPERATION, FOR SPEEDS > 45 MPH
701306-04	LANE CLOSURE, 2L 2W, SLOW MOVING DAY ONLY OPERATION, FOR SPEEDS > 45 MPH
701901-08	TRAFFIC CONTROL DEVICES
780001-05	TYPICAL PAVEMENT MARKINGS
BLR 24-2	MAILBOX TURNOUT FOR LOCAL ROADS

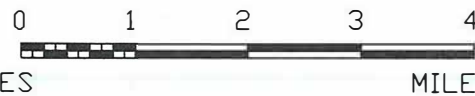

THESE PLANS WERE PREPARED BY ME OR BY A FULL TIME MEMBER OF MY STAFF WORKING UNDER MY DIRECT SUPERVISION

Joel V. Moore
JOEL V. MOORE, COUNTY ENGINEER
ILL. REG. PROF. ENG. #62056831
DATE EXPIRES: 11/30/21

TOLL FREE JOINT UTILITY LOCATING INFORMATION FOR EXCAVATORS (J.U.L.I.E.) TELEPHONE NUMBER 1-800-892-0123

CONTRACT 87716

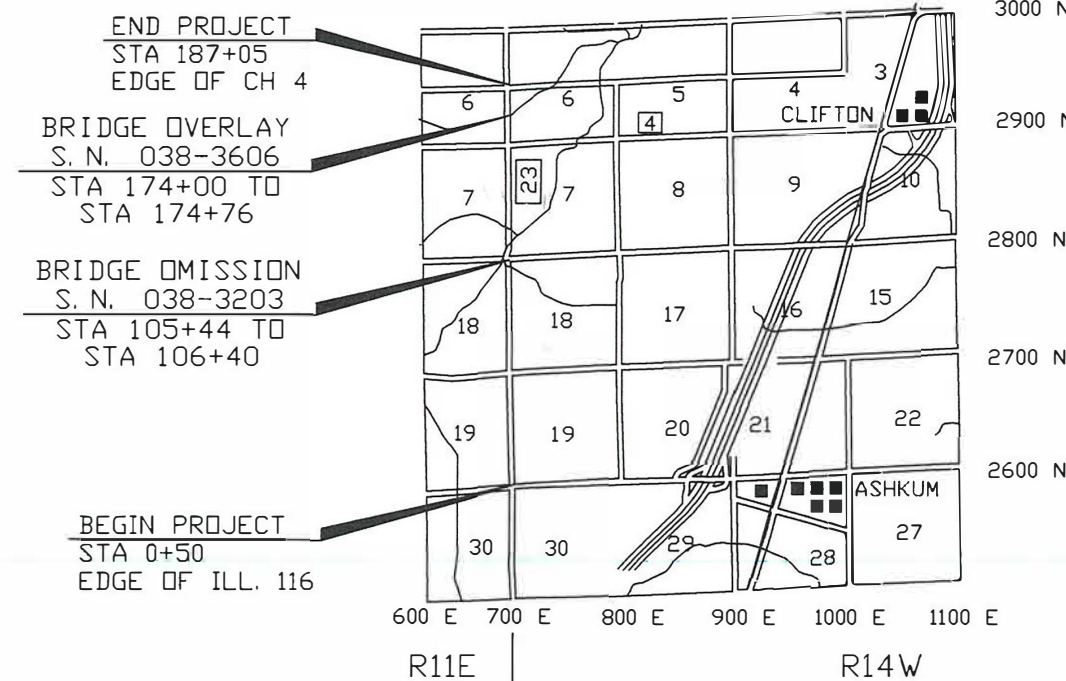

GROSS LENGTH = 18,655.00 FT. = 3.533 MILE
OMISSION LENGTH = 96.00 FT. = .018 MILE
NET LENGTH = 18,559.00 FT. = 3.515 MILE

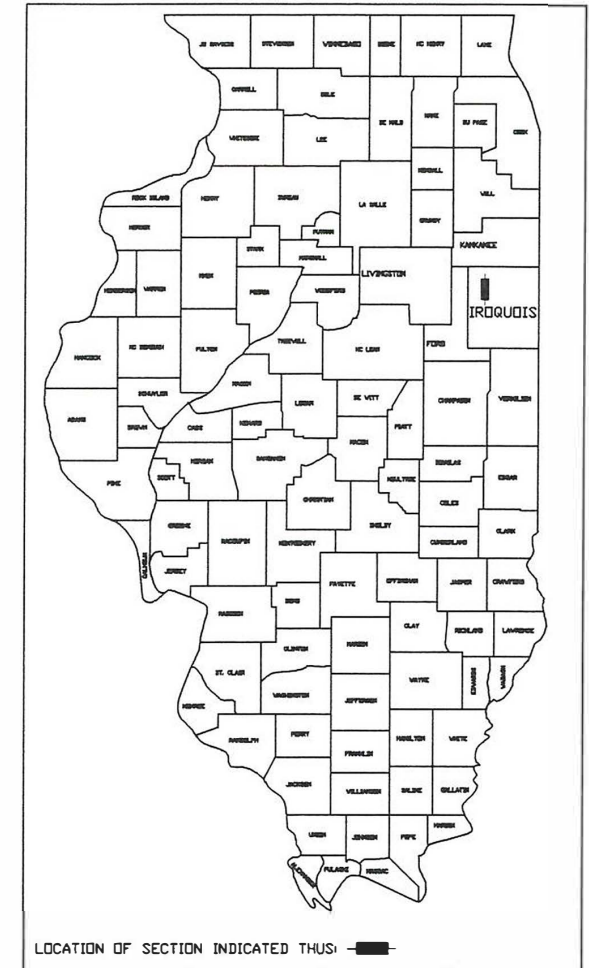

MAJOR COLLECTOR 2030 ADT = 715
PV = 88% SU = 7% MU = 5%
DESIGN SPEED = 55 M. P. H.

CONTRACT 87716

Approved March 24, 2020
JVM
County Engineer

Passed April 3, 2020
DP
DISTRICT THREE LOCAL ROADS AND STREETS ENGINEER
RELEASED FOR BID BASED ON LIMITED REVIEW April 3, 2020
W. Starnes
REGION TWO ENGINEER

STATE OF ILLINOIS
DEPARTMENT OF TRANSPORTATION

SUMMARY OF QUANTITIES			FUND CODE	0005
ITEM #	PAY ITEM #	PAY ITEM	UNIT	QUANTITY
* 1	X7010216	TRAFFIC CONTROL AND PROTECTION, (SPECIAL)	L SUM	1
* 2	X7830090	GROOVING FOR RECESSED PAVEMENT MARKING 25"	FOOT	22
* 3	20200500	EARTH EXCAVATION WIDENING	CU YD	22
4	40600290	BITUMINOUS MATERIALS (TACK COAT)	POUND	33,500
* 5	40600982	HOT-MIX ASPHALT SURFACE REMOVAL-BUTT JOINT	SQ YD	338
6	40600990	TEMPORARY RAMP	SQ YD	111
7	40602978	HOT-MIX ASPHALT BINDER COURSE, IL-9.5,N50	TON	22
8	40603080	HOT-MIX ASPHALT BINDER COURSE, IL-19.0,N50	TON	7,700
9	40604050	HOT-MIX ASPHALT SURFACE COURSE, IL-9.5, MIX "C", N50	TON	3,850
*10	40800050	INCIDENTAL HOT-MIX ASPHALT SURFACING	TON	174
*11	44000155	HOT-MIX ASPHALT SURFACE REMOVAL, 1 1/2"	SQ YD	691
*12	44201741	CLASS D PATCHES, TYPE II, 8 INCH	SQ YD	28
*13	44201745	CLASS D PATCHES, TYPE III, 8 INCH	SQ YD	41
*14	44201747	CLASS D PATCHES, TYPE IV, 8 INCH	SQ YD	243
*15	48101200	AGGREGATE SHOULDERS, TYPE B	TON	5,200
*16	48203100	HOT-MIX ASPHALT SHOULDERS	TON	45
*17	66700205	PERMANENT SURVEY MARKERS, TYPE I	EACH	4
18	67100100	MOBILIZATION	L SUM	1
19	70300100	SHORT TERM PAVEMENT MARKING	FOOT	4,395
20	70300150	SHORT TERM PAVEMENT MARKING REMOVAL	SQ FT	619
21	70300220	TEMPORARY PAVEMENT MARKING-LINE 4"	FOOT	17,226
*22	78001110	PAINT PAVEMENT MARKING - LINE 4"	FOOT	34,452
*23	78000650	THERMOPLASTIC PAVEMENT MARKING - LINE 24"	FOOT	22
*24	Z0033700	LONGITUDINAL JOINT SEALANT	FOOT	18,559
*25	Z0055300	RUMBLE STRIP	EACH	3

* SEE SPECIAL PROVISIONS

Δ SPECIALTY ITEMS

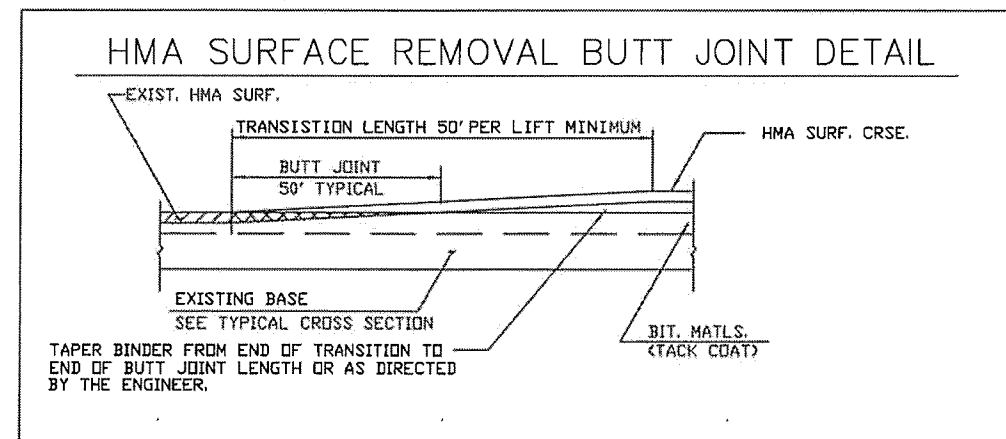

MIXTURE TABLE

	HMA BINDER	HMA BINDER	HMA SURFACE	INCIDENTAL HMA	HMA PATCHES
PG GRADE	PG64-22	PG64-22	PG64-22	PG64-22	PG64-22
DESIGN AIR VOIDS	4.0% @ N50	4.0% @ N50	4.0% @ N50	4.0% @ N50	4.0% @ N50
MIXTURE COMPOSITION	IL 19.0	IL 9.5	IL 9.5	IL 9.5	IL 19.0
FRICTION AGGREGATE		MIXTURE C	MIXTURE C	MIXTURE C	
DENSITY TEST METHOD	GROWTH CURVE	GROWTH CURVE	GROWTH CURVE	SATISFACTION OF ENGINEER	CORES/NUCLEAR
MIXTURE WEIGHT	112#/Sq. Yd./In.	112#/Sq. Yd./In.	112#/Sq. Yd./In.	112#/Sq. Yd./In.	112#/Sq. Yd./In.
QUALITY MANAGEMENT PROGRAM	QC/QA	QC/QA	QC/QA	QC/QA	QC/QA
SUBLOT SIZE	N/A	N/A	N/A	N/A	N/A
LOCATION(S)	ENTIRE PROJECT	STRUCTURE #038-3606	ENTIRE PROJECT	ENTIRE PROJECT	ENTIRE PROJECT

MATERIAL SHALL BE COMPACTED TO 93.0-97.4 PERCENT OF THE MAXIMUM THEORETICAL DENSITY, EXCEPT THAT WHEN PLACED AS FIRST LIFT ON AN UNIMPROVED SUBGRADE THE MINIMUM PERCENT COMPACTION SHALL BE 92.0 PERCENT. THE MAXIMUM THEORETICAL DENSITY SHALL BE DETERMINED FROM THE MOVING AVERAGE AS SPECIFIED IN THE QC/QA SPECIFICATION.

GENERAL NOTES

THE THICKNESS OF HOT-MIX ASPHALT MIXTURES SHOWN ON THE TYPICAL X-SECTION IS THE NOMINAL THICKNESS. DEVIATIONS FROM THE NOMINAL THICKNESS WILL BE PERMITTED WHEN SUCH DEVIATIONS OCCUR DUE TO IRREGULARITIES IN THE EXISTING SURFACE.

THE ENGINEER SHALL BE THE SOLE JUDGE CONCERNING CURING TIME FOR THE VARIOUS HOT-MIX ASPHALT LIFTS.

FOR PAVEMENT MARKINGS ON FINAL SURFACES (I.E., MAINLINE PAVEMENT), FOR THE PAY ITEM TEMPORARY PAVEMENT MARKING LINE 4", PAVEMENT MARKING TAPE SHALL BE USED.

ANY REFERENCE TO A STANDARD IN THESE PLANS SHALL BE INTERPRETED TO MEAN THE EDITION AS INDICATED BY THE SUB-NUMBER LISTED IN THE INDEX OF SHEETS OR THE COPY OF THE STANDARD INCLUDED IN THESE PLANS.

SECTION NOTES

THE PROPOSED IMPROVEMENT CONSISTS OF A HOT MIX ASPHALT SURFACE COURSE INCLUDING BINDER COURSE, SHOULDER STONE AND ALL WORK NECESSARY TO COMPLETE THE PROJECT ACCORDING TO THE PLANS AND SPECIFICATIONS.

COUNTY HIGHWAY 23 IS A COMBINATION OF SECTIONS: 77-15d, 97-15d, 00-00289-00-WR, 12-00229-00-SP, 229B-MFT

THE FOLLOWING RATES OF APPLICATION HAVE BEEN ASSUMED IN CALCULATING PLAN QUALITIES:		
GRANULAR MATERIALS	2.05	TONS/CU YD
BITUMINOUS MATERIALS PRIME COAT	0.05/.025	LBS/SQ FT
HOT MIX ASPHALT SURFACE COURSE	112	LBS/SQ YD/INCH
BINDER COURSE, IL-19.0, N50	112	LBS/SQ YD/INCH
SHORT TERM PAVEMENT MARKING	4	FT/40 FT OF APPLICATION
PAINT PAVEMENT MARKING - LINE 4"	10	FT/40 FT OF APPLICATION

PAVEMENT DESIGN - CH 23

STRUCTURAL DESIGN TRAFFIC:	YEAR 2030
PV= 629 (88%)	SU= 51 (7%) MU= 35 (5%)
ROAD CLASSIFICATION	CLASS III
TRAFFIC FACTOR:	ACTUAL TF = 0.19 AC TYPE = PG 64-22 MINIMUM TF = 1.70
PG GRADE:	BINDER = PG 64-22 SURFACE = PG 64-22
SUB GRADE SUPPORT RATING:	IBV = 2.0 (STA. 0+50 TO 115+00)

PAVEMENT DESIGN - CH 23

STRUCTURAL DESIGN TRAFFIC:	YEAR 2030
PV= 629 (88%)	SU= 51 (7%) MU= 35 (5%)
ROAD CLASSIFICATION	CLASS III
TRAFFIC FACTOR:	ACTUAL TF = 0.19 AC TYPE = PG 64-22 MINIMUM TF = 1.70
PG GRADE:	BINDER = PG 64-22 SURFACE = PG 64-22
SUB GRADE SUPPORT RATING:	IBV = 10.0 (STA. 115+00 TO 187+05)

EXISTING TYPICAL SECTION - 0+50 TO 0+65
 EXISTING TYPICAL SECTION 1

ROUTE NO.	SECTION	COUNTY	TOTAL SHEETS	SHEET NO.
FAS 316	16-00289-00-RS	IRROQUOIS	9	3
JOB #: C-93-002-21			PROJECT #: XDEL(136)	
CONTRACT 87716				

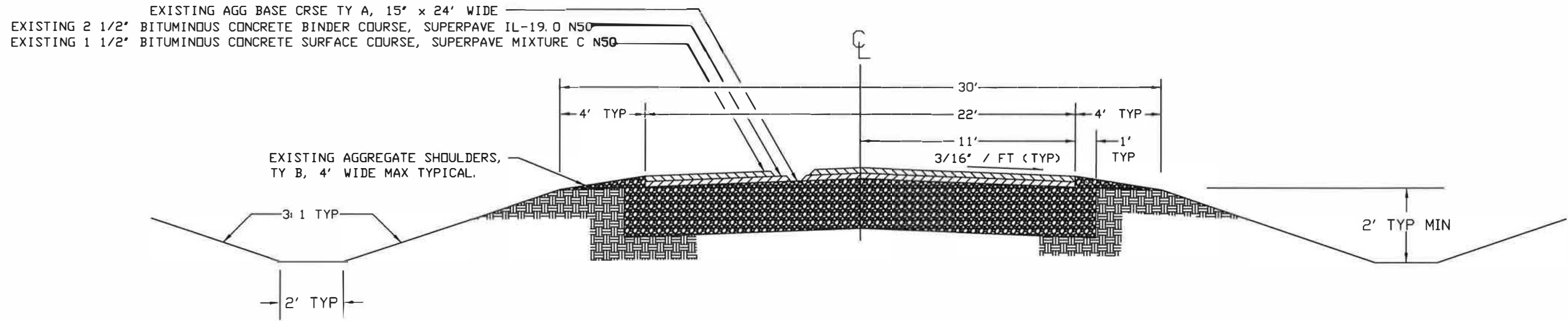

PROPOSED TYPICAL SECTION - 0+50 TO 0+65
 PROPOSED TYPICAL SECTION 1

* LONGITUDINAL JOINT SEALANT TO BE APPLIED BETWEEN BINDER COURSE AND SURFACE COURSE AT THESE LOCATIONS.

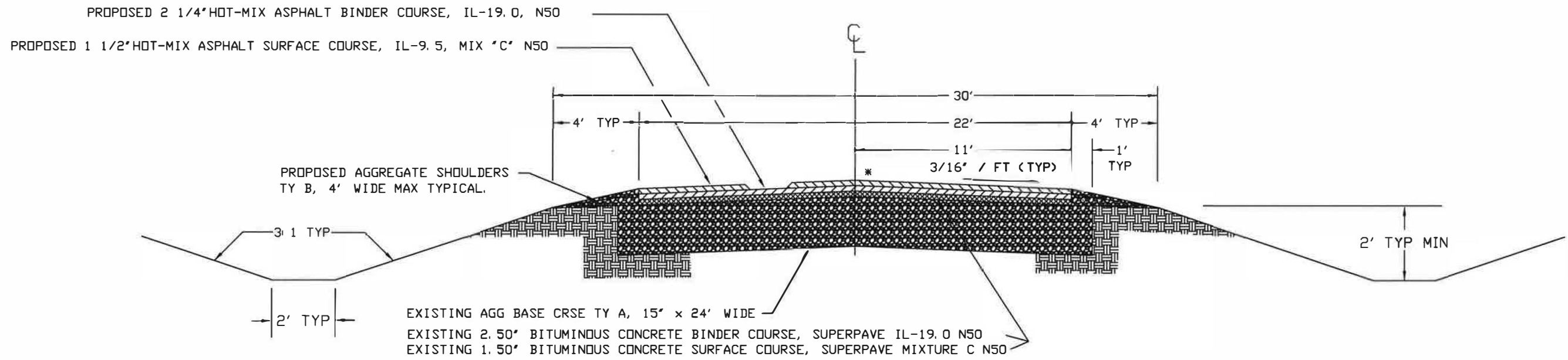

EXISTING TYPICAL SECTION - 0+65 TO 102+00
EXISTING TYPICAL SECTION 2

ROUTE NO.	SECTION	COUNTY	TOTAL SHEETS	SHEET NO.
FAS 316	16-00289-00-RS	IRROQUOIS	9	4
JOB # : C-93-002-21			PROJECT # : XDEL(136)	
CONTACT 87716				

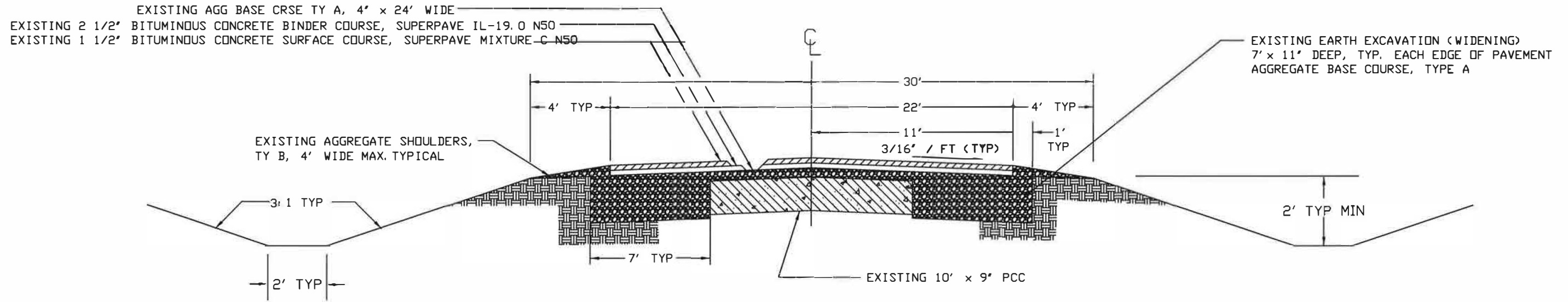

PROPOSED TYPICAL SECTION - 0+65 TO 102+00
PROPOSED TYPICAL SECTION 2

* LONGITUDINAL JOINT SEALANT TO BE APPLIED BETWEEN BINDER COURSE AND SURFACE COURSE AT THESE LOCATIONS.

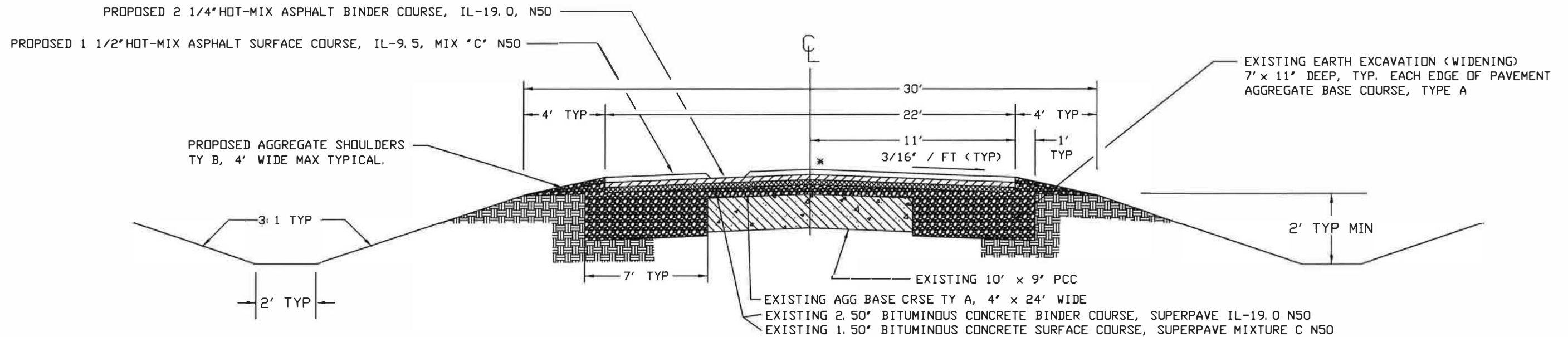

EXISTING TYPICAL SECTION - 102+00 TO 105+44 & 106+40 TO 115+00
 EXISTING TYPICAL SECTION 3

ROUTE NO.	SECTION	COUNTY	TOTAL SHEETS	SHEET NO.
FAS 316	16-00289-00-RS	IROQUOIS	9	5
JOB # C-93-002-21			PROJECT # XDEL(136)	
CONTRACT 87716				

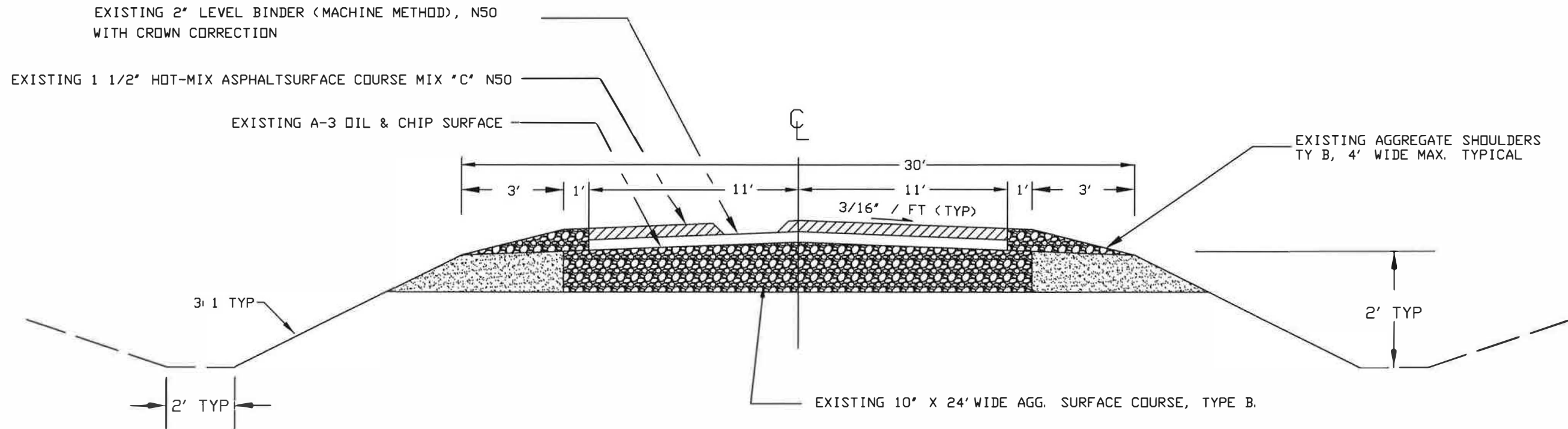

PROPOSED TYPICAL SECTION - 102+00 TO 105+44 & 106+40 TO 115+00
 PROPOSED TYPICAL SECTION 3

▲ SUPER ELEVATION AT 0.08

101+93 TO 102+95
 107+00 TO 110+05
 114+10 TO 115+06

* LONGITUDINAL JOINT SEALANT TO BE APPLIED BETWEEN BINDER COURSE AND SURFACE COURSE AT THESE LOCATIONS.

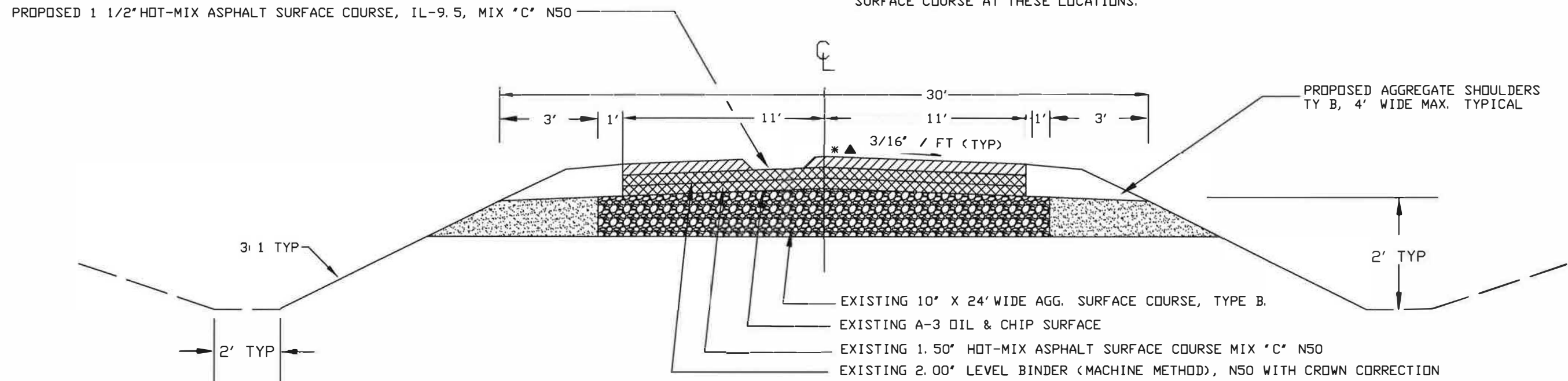

EXISTING TYPICAL SECTION - 115+00 TO 187+05
 EXISTING TYPICAL SECTION 4

ROUTE NO.	SECTION	COUNTY	TOTAL SHEETS	SHEET NO.
FAS 316	16-00289-00-RS	IROQUOIS	9	6
JOB #: C-93-002-21			PROJECT #: XDEL(136)	
CONTRACT 87716				

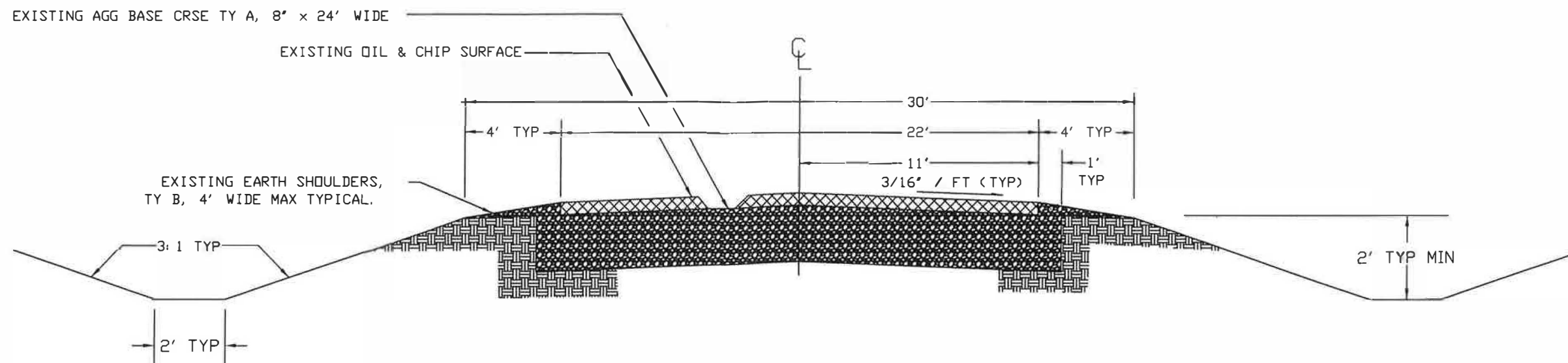

PROPOSED TYPICAL SECTION - 115+00 TO 187+05
 PROPOSED TYPICAL SECTION 4

* LONGITUDINAL JOINT SEALANT
 TO BE BETWEEN BINDER COURSE AND
 SURFACE COURSE AT THESE LOCATIONS.

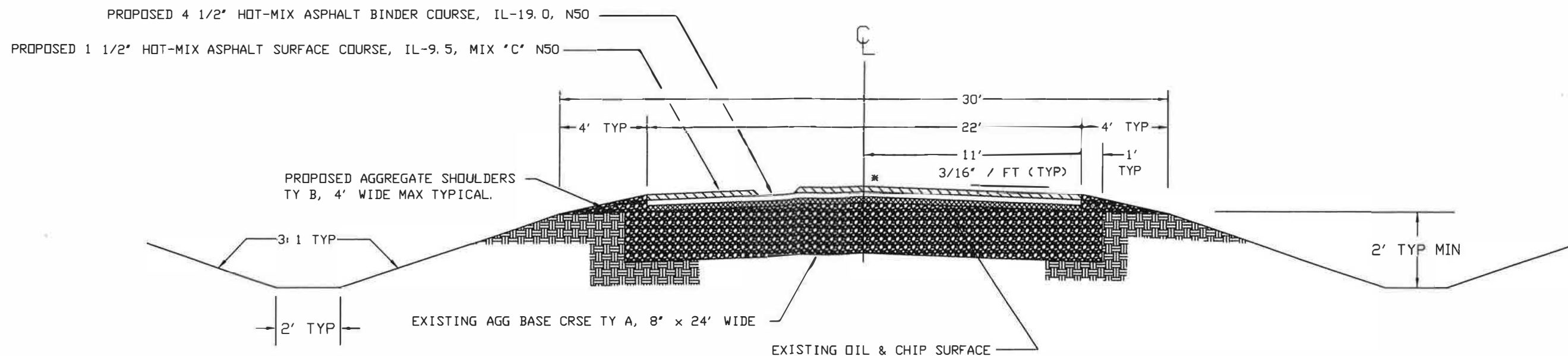

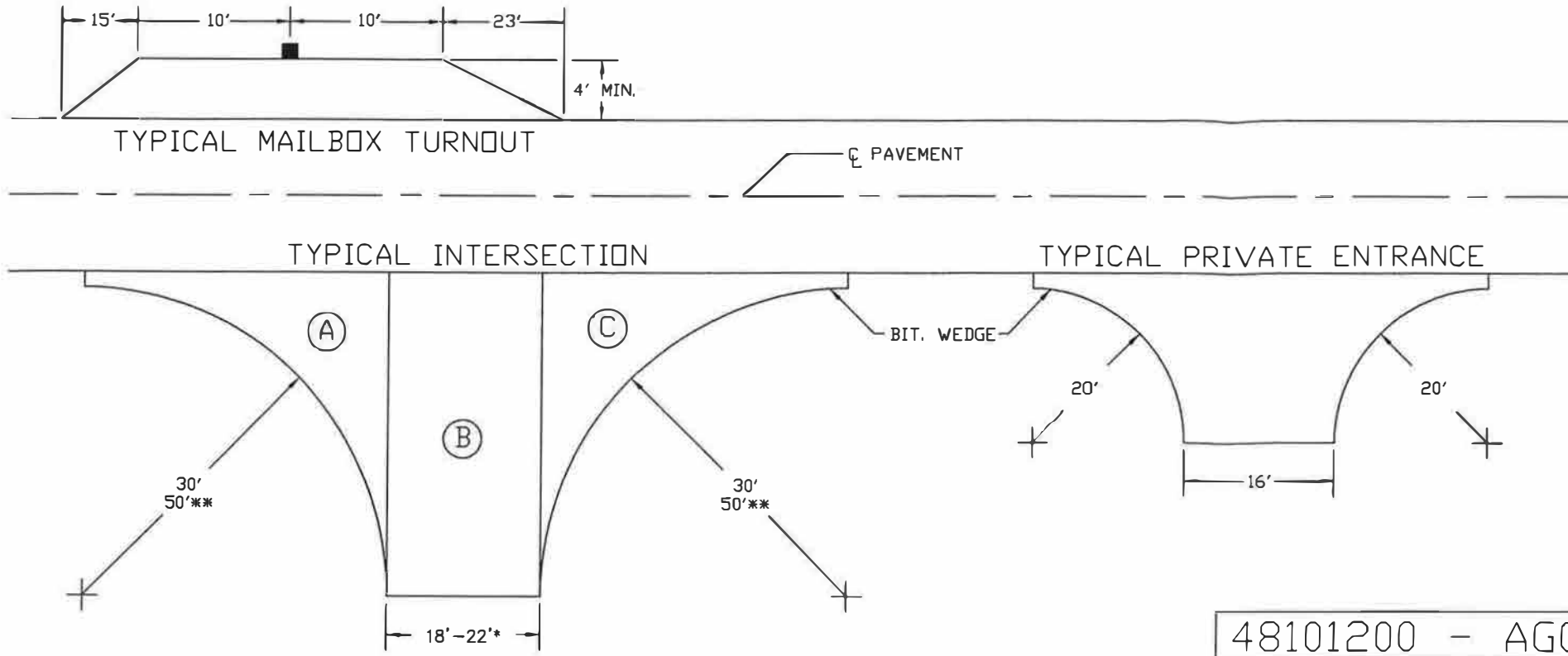

A+C = RADIUS ON MAINLINE SHOWN AS SIDE = VAR
 ALL INTERSECTION ARE 18' WIDE UNLESS INDICATED WITH A *.
 A+B+C = TYPICAL SIDE ROAD INTERSECTION

NOTE: ALL PRIVATE ENTRANCES, MAIL BOX TURNOUTS AND SIDE ROAD INTERSECTIONS SHALL BE PAID FOR AS INCIDENTAL BITUMINOUS SURFACING - TOTAL 174 TON.

TOTAL AGGREGATE FOR FIELD ENTRANCES = 115 TONS
 THIS QUANTITY IS INCLUDED IN AGGREGATE SHOULDERS, TYPE B TOTAL QUANTITY.

NOTE: AGGREGATE SHALL BE PLACED AROUND ALL PRIVATE ENTRANCES, MAIL BOX TURNOUTS AND SIDE ROAD INTERSECTIONS AND SHALL BE CONSIDERED INCIDENTAL TO AGGREGATE SHOULDERS, TYPE B AND PLACED AS AS DIRECTED BY THE ENGINEER.

40800050 - INCIDENTAL HMA SURFACING

TYPICAL INTERSECTION - SIDE ROADS				
STATION	RT/LT	SQ. YD.	LOCATION	TON
53+19.60	RT	103	700E/2700N	20 TON
53+19.60	LT	103	700E/2700N	20 TON
104+46	RT	100	700E/2800N	15 TON
107+13	LT	100	700E/2800N	15 TON
160+40.77	LT	103	700E/2900N	20 TON
160+40.77	RT	103	700E/2900N	20 TON
TOTALS		612		110 TON

TYPICAL PRIVATE ENTRANCE			
STATION	RT/LT	SQ. YD.	TON
15+77	LT	98	12 TON
33+00	LT	55	10 TON
73+93	LT	98	30 TON
83+58	LT	55	6 TON
TOTALS		306	58 TON

TYPICAL MAILBOX TURNOUT			
STATION	RT/LT	SQ. YD.	TON
32+87	LT	20	3 TON
73+44	LT	20	3 TON
TOTALS			6 TON

INCIDENTAL HMA SURFACING TOTALS	
TYPICAL INT.'S & SIDE ROADS	110 TONS
PRIVATE ENTRANCES	58 TONS
TYPICAL MAILBOX TURNOUT	6 TONS
TOTAL = 174 TONS	

48101200 - AGGREGATE SHOULDERS, TYPE B

TYPICAL FIELD ENTRANCES				
STATION	RT/LT	TYPE	PROPOSED	TON
26+36	RT	FE	AGG	5 TON
26+75	LT	FE	AGG	5 TON
28+50	RT	FE	AGG	5 TON
33+39	LT	FE	AGG	5 TON
73+15	RT	FE	AGG	5 TON
79+89	RT	FE	AGG	5 TON
89+82	RT	FE	AGG	5 TON
89+90	LT	FE	AGG	10 TON
121+55	RT	FE	AGG	5 TON
122+08	LT	FE	AGG	5 TON
123+30	RT	FE	AGG	5 TON
133+98	RT	FE	AGG	5 TON
146+44	LT	FE	AGG	5 TON
147+00	LT	FE	AGG	5 TON
159+86	LT	FE	AGG	5 TON
167+26	RT	FE	AGG	5 TON
173+72	LT	FE	AGG	5 TON
173+87	RT	FE	AGG	5 TON
175+17	RT	FE	AGG	5 TON
184+60	RT	FE	AGG	5 TON
186+73	LT	FE	AGG	5 TON
186+75	RT	FE	AGG	5 TON
TOTALS =				115 TONS

AGGREGATE SHOULDERS, TY B TOTALS	
MAINLINE QUANTITIES	5085 TONS
FIELD ENTRANCE QUANTITIES	115 TONS
TOTAL = 5200 TONS	

44201741-CLASS D PATCHES, TY II, 8 INCH
SCHEDULE - CLASS D PATCHING 8"

STATION	NORTHBOUND LANE	SOUTHBOUND LANE	PATCH LOCATION
	PATCH TYPE II SQ YD	PATCH TYPE II SQ YD	
160+14 LT		6	OIL & CHIP PAVEMENT
160+14 RT	6		OIL & CHIP PAVEMENT
169+61 LT		8	OIL & CHIP PAVEMENT
169+61 RT	8		OIL & CHIP PAVEMENT
TOTALS	14	14	
TYPE II TOTALS	= 28 SQ YD		

44201745-CLASS D PATCHES, TY III, 8 INCH
SCHEDULE - CLASS D PATCHING 8"

STATION	NORTHBOUND LANE	SOUTHBOUND LANE	PATCH LOCATION
	PATCH TYPE III SQ YD	PATCH TYPE III SQ YD	
138+86 TO 139+19 LT		19	OIL & CHIP PAVEMENT
147+00 TO 147+25 RT	22		OIL & CHIP PAVEMENT
TOTALS	22	19	
TYPE III TOTALS	= 41 SQ YD		

44201747-CLASS D PATCHES, TY IV, 8 INCH
SCHEDULE - CLASS D PATCHING 8"

STATION	NORTHBOUND LANE	SOUTHBOUND LANE	PATCH LOCATION
	PATCH TYPE IV SQ YD	PATCH TYPE IV SQ YD	
73+25 TO 73+90 RT	29		ALONG SLAB PAVEMENT
116+90 TO 117+35 RT	30		OIL & CHIP PAVEMENT
142+00 TO 142+80 LT		98	OIL & CHIP PAVEMENT
147+18 TO 147+42 LT		30	OIL & CHIP PAVEMENT
147+83 TO 148+29 LT		56	OIL & CHIP PAVEMENT
TOTALS	59	184	
TYPE IV TOTALS	= 243 SQ YD		

PAVEMENT SCHEDULE

PAY ITEM	40603080	40604050	48101200	40600290	40602978
UNIT	(TON)	(TON)	(TON)	(POUND)	(TON)
STATION TO STATION	HMA BINDER COURSE IL-19.0, N50	HMA SURFACE COURSE IL-9.5 MIX 'C' N50	AGGREGATE SHOULDERS TYPE B	BITUMINOUS MATERIALS (TACK COAT)	HMA BINDER COURSE, IL-9.5, N50
115+00 TO 186+55	2,200			4,394	
1+00 TO 186+05	5,370			18,898	
0+50 TO 187+05		3,850	5,200	10,208	
121+50 TO 123+50	130				
174+00 TO 174+76					22
TOTAL =	7,700	3,850	5,200	33,500	22

78001110 - PAINT PAVEMENT MARKING - LINE 4"
70300220 - TEMPORARY PAVEMENT MARKING - LINE 4"

TYPE	STATION TO STATION	FEET	LINE 4"
CENTERLINE (YELLOW)			
SKIP DASH	0+50 TO 89+75	8,925'	2,232'
SKIP DASH	127+50 TO 131+45	395'	99'
SKIP DASH	166+35 TO 187+05	2070'	518'
TOTAL =			2,849'
NO PASSING ZONE (YELLOW)			
SINGLE NO PASS & SKIP DASH	89+75 TO 99+47 RT	972'	1,215'
DOUBLE NO PASS	99+47 TO 117+50 LT & RT	1,803'	3,606'
SINGLE NO PASS & SKIP DASH	117+50 TO 127+50 LT	1000'	1,250'
SINGLE NO PASS & SKIP DASH	131+45 TO 147+50 RT	1,605'	2,006'
DOUBLE NO PASS	147+50 TO 152+00 LT & RT	450'	900'
SINGLE NO PASS & SKIP DASH	152+00 TO 166+35 LT	1,435'	1,794'
TOTAL =			10,771'
EDGE LINE (WHITE)			
EDGE LINE	99+47 TO 117+50 RT/LT	1,803'	3,606'
TOTAL =			3,606'

TOTAL ALL STRIPING FOR PAINT PAVEMENT MARKING LINE 4" (TWO APPLICATIONS) = 34,452'
TOTAL FOR TEMPORARY PAVEMENT MARKING = 17,226'

X7830090
GROOVING FOR RECESSED PAVEMENT MARKING 25"

STATION TO STATION	FOOT
0+52 LT	11
186+85 RT	11
TOTAL =	22

48203100
HMA SHOULDERS

STATION TO STATION	TONS
72+00 TO 75+00 RT	45
TOTAL =	45

78000650
THERMOPLASTIC PAVEMENT MARKING LINE - 24"

STATION TO STATION	FOOT
0+52 LT	11
186+85 RT	11
TOTAL =	22

Z0033700
LONGITUDINAL JOINT SEALANT

STATION TO STATION	FOOT
0+50 TO 187+05	18,559
TOTAL =	18,559

Z0055300
RUMBLE STRIPS

STATION	EACH
175+75 TO 176+00 RT	1
181+75 TO 182+00 RT	1
183+75 TO 184+00 RT	1
TOTAL =	3

20200500
EARTH EXCAVATION WIDENING

STATION TO STATION	CU. YDS.
72+00 TO 75+00 RT	22
TOTAL =	22

40600982
HMA SURFACE REMOVAL BUTT JOINT

STATION TO STATION	SQ. YDS.
0+50 TO 1+00	122
104+46 RT	47
107+13 LT	47
186+55 TO 187+05	122
TOTAL =	338

40600990
TEMPORARY RAMP

STATION	SQ. YDS.
0+50	17
104+46 RT	11
107+13 LT	10
187+05	39
105+44	17
106+40	17
TOTAL =	111

44000155
HMA SURFACE REMOVAL 1 1/2"

STATION TO STATION	SQ. YDS.
104+00 TO 105+44	352
106+40 TO 107+40	245
175+75 TO 176+00 RT	31
181+75 TO 182+00 RT	31
183+75 TO 184+00 RT	31
TOTAL =	691

66700205
PERMANENT SURVEY MARKERS

STATION	EACH
26+60	1
53+19.60	1
79+78.80	1
160+40.77	1
TOTAL =	4

STRUCTURE OVERLAY DETAIL - STRUCTURE #038-3606
 CONSTRUCTED UNDER BRIDGE #038-3606, STATION 174+00 TO 174+76

ROUTE NO.	SECTION	COUNTY	TOTAL SHEETS	SHEET NO.
FAS 316	16-00289-00-RS	IROQUOIS	9	9
JOB #: C-93-002-21			PROJECT #: XDEL(136)	
CONTRACT 87716				

EXISTING CROSS SECTION
 BRIDGE #038-3606

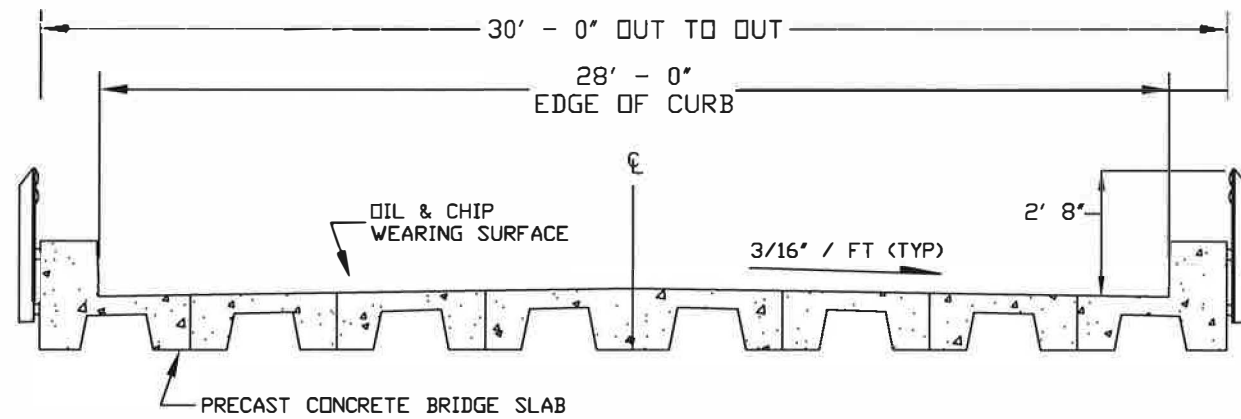

PROPOSED CROSS SECTION
 BRIDGE #038-3606

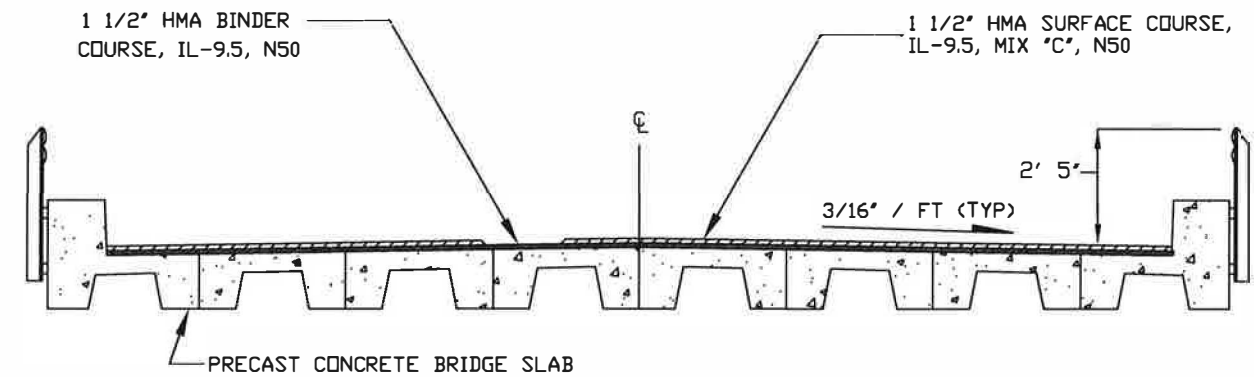

SUPER ELEVATION TABLES

CURVE #1 DATA

P. I.	102+46
D	12 ⁰ - 00'
R	477.50'
T	109.00'
L	214.30'
E	12.28'
P. C.	101+37
P. T.	103+51.30

CURVE #2 DATA

P. I.	108+66.78
D	12 ⁰ - 00'
R	477.50'
T	222.83'
L	416.94'
E	49.44'
P. C.	106+43.95
P. T.	110+60.89

CURVE #3 DATA

P. I.	114+59.38
D	12 ⁰ - 00'
R	477.50'
T	105.86'
L	208.33'
E	11.59'
P. C.	113+53.52
P. T.	115+61.85

BEGIN S. E.	100+25
FULL S. E.	101+93
FULL S. E.	102+95
END S. E.	104+63
SUPER ELEVATION = 8%	

BEGIN S. E.	105+32
FULL S. E.	107+00
FULL S. E.	110+05
END S. E.	111+73
SUPER ELEVATION = 8%	

BEGIN S. E.	112+41
FULL S. E.	114+10
FULL S. E.	115+06
END S. E.	116+74
SUPER ELEVATION = 8%	

HMA SHOULDERS &
 EARTH EXCAVATION
 WIDENING

HMA SHOULDERS
 EARTH EX WIDENING

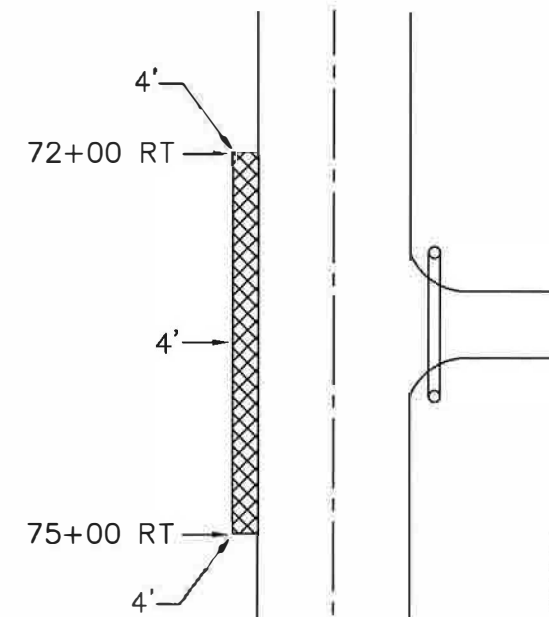

HMA SHOULDERS 6"
 DETAIL

