

STATE OF ILLINOIS DEPARTMENT OF TRANSPORTATION PLANS FOR PROPOSED ROADWAY RESURFACING

INDEX OF SHEETS

- 1 COVER SHEET
- 2 GENERAL NOTES, LEGEND, AND COMMITMENTS
- 3 SUMMARY OF QUANTITIES
- 4 TYPICAL SECTIONS
- 5 MISCELLANEOUS DETAILS
- 6 CONSTRUCTION SCHEDULES
- 7-19 IMPROVEMENT PLANS

HIGHWAY STANDARDS (SEE SPECIFICATIONS)

- 000001-07 STANDARD SYMBOLS, ABBREVIATIONS AND PATTERNS
- 442201-03 CLASS C AND D PATCHES
- 701011-04 OFF-RD MOVING OPERATIONS 2L, 2W, DAY ONLY
- 701201-05 LANE CLOSURE, 2L, 2W, DAY ONLY
- 701301-04 LANE CLOSURE, 2L, 2W, SHORT TIME OPERATIONS
- 701306-04 LANE CLOSURE, 2L, 2W, SLOW MOVING OPERATIONS DAY ONLY
- 701901-08 TRAFFIC CONTROL DEVICES
- 720006-04 SIGN PANEL ERECTION DETAILS
- 720011-01 METAL POSTS FOR SIGNS, MARKERS & DELINEATORS
- 780001-05 TYPICAL PAVEMENT MARKINGS
- BLR 22-7 TYPICAL APPLICATION OF TRAFFIC CONTROL DEVICES FOR CONSTRUCTION ON RURAL LOCAL HIGHWAYS
- BLR 24-2 MAILBOX TURNOUT FOR LOCAL ROADS

CH 8 (FAS 782) - MULBERRY GROVE ROAD (NORTH) BOND COUNTY STR FUNDS SECTION NO. 16-00089-00-SC PROJECT NO. 3EH5(693) JOB NO. C-98-343-16



DESIGN CLASSIFICATION: MAJOR COLLECTOR
ADT₂₀₁₅ : 950
DESIGN SPEED: 50 MPH

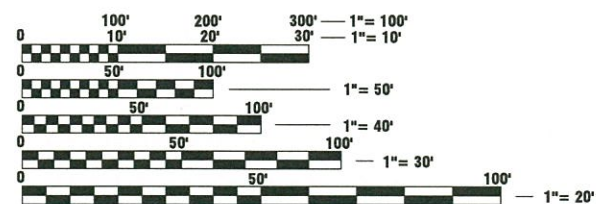

FULL SIZE PLANS HAVE BEEN PREPARED USING STANDARD ENGINEERING SCALES. REDUCED SIZED PLANS MAY NOT CONFORM TO STANDARD SCALES. IN MAKING MEASUREMENTS ON REDUCED PLANS, THE ABOVE SCALES MAY BE USED.

J.U.L.I.E.
JOINT UTILITY LOCATION INFORMATION FOR EXCAVATION
1-800-892-0123
OR 811

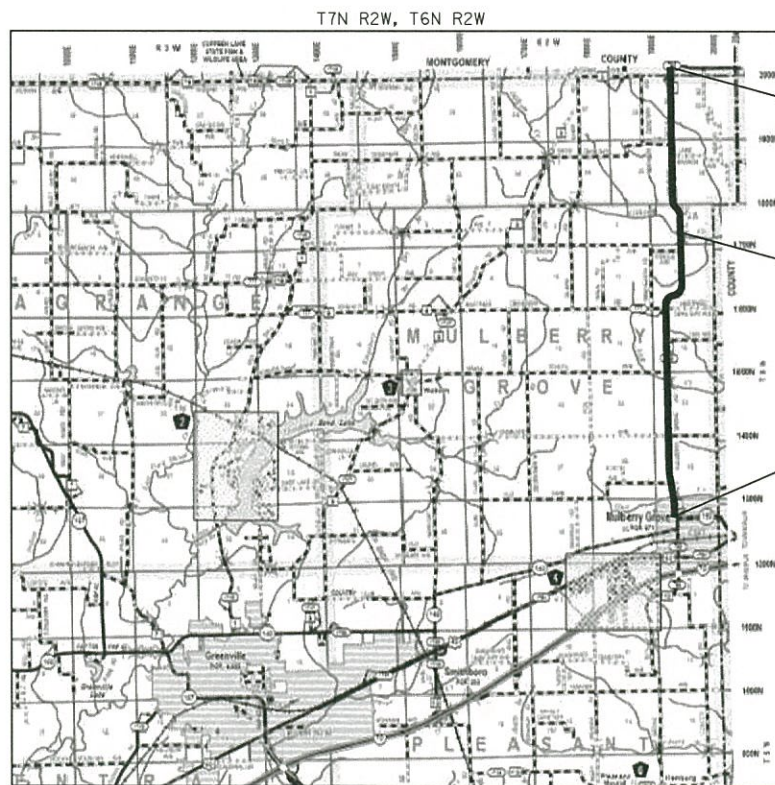

APPROXIMATE SCALE: 1" = 1.34 MI

LOCATION MAP

LOCATION: FROM MULBERRY GROVE NORTH TO HWY 185
GROSS LENGTH OF PROJECT: 38,639.500 FT = 7.318 MI
BRIDGE OMISSION: STA. 250+33.7 TO 251+27.0 = 93.300 FT
NET LENGTH OF PROJECT: 38,546.200 FT = 7.300 MI

SECTION ENDS
STA. 396+52.63

BRIDGE OMISSION
SN 003-3010
STA. 250+33.7 TO 251+27.0

SECTION BEGINS
STA. 10+13.14



Monica S. French 04-02-20

MONICA S. FRENCH
SALEM, ILLINOIS
ILLINOIS LICENSED PROFESSIONAL
ENGINEER NO. 062-055323
EXPIRES NOV. 30, 2021

BOND COUNTY HIGHWAY DEPARTMENT	
APPROVED	<i>[Signature]</i> BOND COUNTY, COUNTY ENGINEER
PASSED	<i>April 9, 2020</i> <i>[Signature]</i> DISTRICT EIGHT ENGINEER OF LOCAL ROADS & STREETS
RELEASING FOR BID BASED ON LIMITED REVIEW	<i>April 9, 2020</i> <i>[Signature]</i> REGION FIVE ENGINEER

**PRINTED BY THE AUTHORITY
OF THE STATE OF ILLINOIS**

RAAI JOB NO. 53119				
ROUTE	SECTION	COUNTY	TOTAL SHEETS	SHEET NO.
CH 8	16-00089-00-SC	BOND	19	1
			CONTRACT NO. 97739	

GENERAL NOTES

1. ALL CONSTRUCTION SHALL BE ACCORDING TO ILLINOIS DEPARTMENT OF TRANSPORTATION STANDARD SPECIFICATIONS FOR ROAD AND BRIDGE CONSTRUCTION, ADOPTED APRIL 1, 2016, AND THE SPECIAL PROVISIONS.
2. THE CONTRACTOR SHALL FIELD VERIFY ALL DIMENSIONS AND EXISTING CONDITIONS PRIOR TO CONSTRUCTION AND NOTIFY THE OWNER'S REPRESENTATIVE OF ANY DISCREPANCY IMMEDIATELY.
3. CURVE DATA SHOWN ON THE PLANS WAS CALCULATED FROM LIMITED EXISTING FIELD DATA AND SHOULD BE CONSIDERED APPROXIMATE.
4. THE CONTRACTOR SHALL BE RESPONSIBLE FOR LOCATING ALL UNDERGROUND UTILITIES. CONTACT J.U.L.I.E. AND ALL UTILITY COMPANIES.
5. THE EXISTING RIGHT OF WAY SHOWN HEREON HAS BEEN PROTRACTED FROM EXISTING RECORDS AND IS TO BE USED FOR REFERENCE PURPOSES ONLY. FURTHERMORE, NO COMPLETE SURVEY OF SAID R.O.W. IS IMPLIED BY THIS DRAWING.
6. ALL EARTH SURFACES DISTURBED BY THE CONTRACTOR OUTSIDE THE PROPOSED CONSTRUCTION LIMITS SHALL BE SEEDED AT THE CONTRACTOR'S EXPENSE.
7. THE CONTRACTOR SHALL MAINTAIN ADEQUATE DRAINAGE AT ALL TIMES. WATER SHALL NOT STAND OR POND. ANY DAMAGE TO STRUCTURES OR WORK ON SITE CAUSED BY INADEQUATE MAINTENANCE OF DRAINAGE PROVISIONS WILL BE THE RESPONSIBILITY OF THE CONTRACTOR. ANY COST ASSOCIATED WITH REPAIRS FOR SUCH DAMAGE WILL BE AT THE CONTRACTOR'S EXPENSE.
8. THE CONTRACTOR SHALL BE AWARE THAT NO EASEMENTS HAVE BEEN ACQUIRED FOR THESE IMPROVEMENTS AND SHALL KEEP ALL OPERATIONS CONFINED TO EXISTING R.O.W.
9. ALL CONSTRUCTION WILL BE PERFORMED UNDER TRAFFIC. THE CONTRACTOR SHALL PROVIDE ACCESS TO ALL ADJUTING PROPERTY AT ALL TIMES DURING CONSTRUCTION OF THE PROJECT.
10. A QUANTITY FOR TEMPORARY PAVEMENT MARKING EQUAL TO THE AMOUNT FOR PERMANENT PAVEMENT MARKING HAS BEEN ADDED TO THE PLANS TO ACCOMMODATE SEASONAL RESTRICTIONS.
11. THE ENGINEER SHALL BE THE SOLE JUDGE CONCERNING CURING TIME FOR THE VARIOUS HOT-MIX ASPHALT.

UTILITIES

<u>Name of Utility</u>	<u>Contact Name</u>	<u>Telephone Number</u>
Frontier Communications	Kalin Hinshaw	815-895-1515
Metro Communications Co., Inc. jkoonce@Metrocomm.com	Jason Koonce	217-728-3605
Southwestern Electric Coop natalie.goestenkers@sweci.com	Natalie Goestenkers	800-637-8667x5933
Ameren IP - (South) nhill2@ameren.com	Nathan Hill	618-301-5327
Energy Transfer Dakota Access (Sunoco)	Bob Sowers	701-421-2765
Marathon - Vernon wtmahon@marathonpetroleum.com	Todd Mahon	618-315-9038
Buckeye Partners dajones@buckeye.com	Dave Jones	610-904-4409
Village of Mulberry Grove	John Wieder	618-594-3711
EJ Water Cooperative, Inc. lbeckman@mgengineers.com	Lee Beckman	217-347-7262







COMMITMENTS

NONE AT THIS TIME.

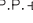
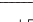
APPLICATION RATES

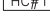
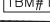
<u>PAVING</u>		
AGGREGATE		2.0 TONS/CU YD
ALL HOT-MIX ASPHALT		0.056 TONS/SQ. YD./INCH
BITUMINOUS MATERIALS (PRIME COAT)		0.05 LBS/SQ FT (HMA, PCC)
		0.25 LBS/SQ FT (AGG)
		0.025 LBS/SQ FT (FOG COAT-HMA)

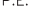
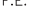
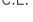
LEGEND

	EXISTING MAILBOX
	EXISTING POWER POLE
	EXISTING GUY WIRE
	IRON PIN
	HORIZONTAL CONTROL POINT
	VERTICAL CONTROL POINT
	PROPOSED PAVEMENT PATCH
	PRIVATE ENTRANCE
	FIELD ENTRANCE
	COMMERCIAL ENTRANCE
	RIGHT OF WAY

<u>MIXTURE USE(S)</u>	<u>SURFACE COURSE</u>	<u>INCIDENTAL HMA</u>	<u>PATCHING</u>
AC/PG	PG 64-22	PG 64-22	PG 64-22
RAP % (MAX.)	SEE SPECIFICATIONS	SEE SPECIFICATIONS	SEE SPECIFICATIONS
DESIGN AIR VOIDS	4.0% @ Ndes=50	4.0% @ Ndes=50	4.0% @ Ndes=50
MIX COMPOSITION (GRADATION MIXTURE)	IL-9.5	IL-9.5	IL-19.0
FRICTION AGG	MIXTURE "C"	MIXTURE "C"	NA
MIXTURE WEIGHT	112 LBS/SQ. YD./IN.	112 LBS/SQ. YD./IN.	112 LBS/SQ. YD./IN.

SUMMARY OF QUANTITIES

SP	CODE NUMBER	ITEM	UNIT	TOTAL QUANTITY
	40800290	BITUMINOUS MATERIALS (TACK COAT)	POUND	42,401
	40800982	HOT-MIX ASPHALT SURFACE REMOVAL- BUTT JOINT	SQ YD	877
	40800990	TEMPORARY RAMP	SQ YD	147
	40804050	HOT-MIX ASPHALT SURFACE COURSE, IL-9.5, MIX "C", N50	TON	11,869
	40800025	BITUMINOUS MATERIALS (PRIME COAT)	POUND	1,055
	40800029	BITUMINOUS MATERIALS (TACK COAT)	POUND	410
	40800050	INCIDENTAL HOT-MIX ASPHALT SURFACING	TON	135
*	44201789	CLASS D PATCHES, TYPE II, 12 INCH	SQ YD	40
*	44201794	CLASS D PATCHES, TYPE III, 12 INCH	SQ YD	36
*	44201796	CLASS D PATCHES, TYPE IV, 12 INCH	SQ YD	674
*	48102100	AGGREGATE WEDGE SHOULDER, TYPE B	TON	1,019
	67100100	MOBILIZATION	LSUM	1
	70300100	SHORT TERM PAVEMENT MARKINGS	FOOT	7,025
	70300150	SHORT TERM PAVEMENT MARKING REMOVAL	SQ FT	1,171
	70300220	TEMPORARY PAVEMENT MARKING LINE 4"	FOOT	39,225
	70300280	TEMPORARY PAVEMENT MARKING LINE 24"	FOOT	11
Δ	78000200	THERMOPLASTIC PAVEMENT MARKING LINE - 4"	FOOT	115,711
Δ	78000650	THERMOPLASTIC PAVEMENT MARKING LINE - 24"	FOOT	11
*	LR400520	HOT IN PLACE RECYCLING - SURFACE RECYCLING	SQ YD	93,771
*	X7010216	TRAFFIC CONTROL AND PROTECTION (SPECIAL)	LSUM	1
*	X7030005	TEMPORARY PAVEMENT MARKING REMOVAL	SQ FT	13,097
*	Z0033700	LONGITUDINAL JOINT SEALANT	FOOT	38,546
#	20076600	TRAINEES	Hour	1,000
#	20076604	TRAINEES TRAINING PROGRAM GRADUATE	Hour	1,000

Δ SPECIALTY ITEMS

0042

RAAI JOB NO. 53119

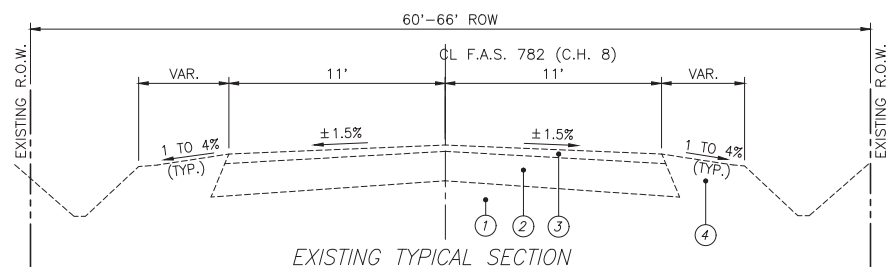

EXISTING TYPICAL SECTION
 STA. 10+13.14 TO 25+93.7
 STA. 26+21.8 TO 122+10.7
 STA. 122+96.2 TO 250+33.7
 STA. 251+27.0 TO 396+52.63
 BRIDGE OMISSION STA. 250+33.7 TO 251+27.0

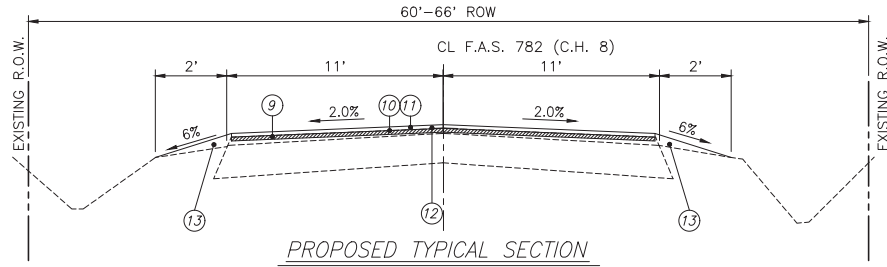

PROPOSED TYPICAL SECTION
 STA. 10+13.14 TO 25+93.7
 STA. 26+21.8 TO 122+10.7
 STA. 122+96.2 TO 250+33.7
 STA. 251+27.0 TO 396+52.63
 BRIDGE OMISSION STA. 250+33.7 TO 251+27.0

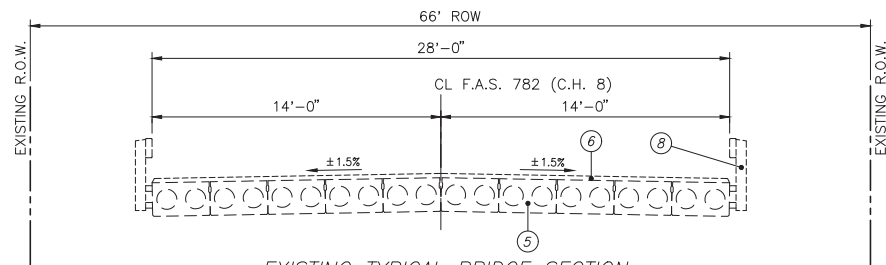

EXISTING TYPICAL BRIDGE SECTION
 STA. 122+10.7 TO 122+96.2

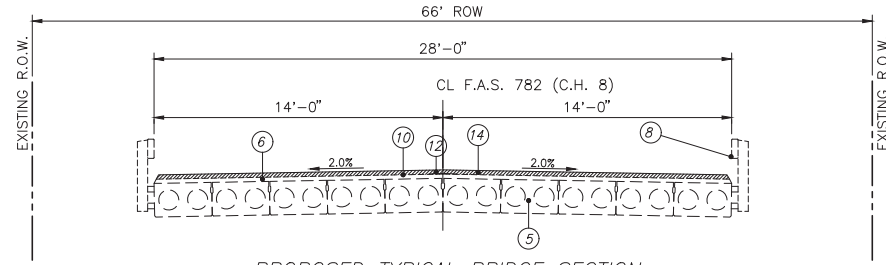

PROPOSED TYPICAL BRIDGE SECTION
 STA. 122+10.7 TO 122+96.2

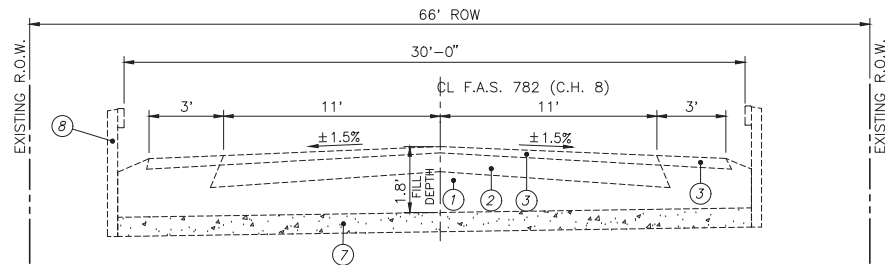

EXISTING TYPICAL SECTION
 STA. 25+93.7 TO 26+21.8

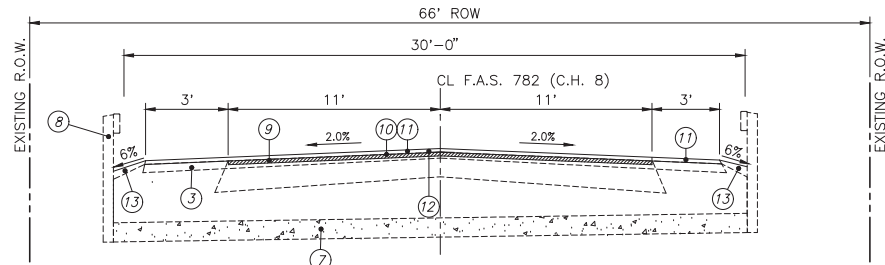

PROPOSED TYPICAL SECTION
 STA. 25+93.7 TO 26+21.8

LEGEND

- ① EXISTING SUBGRADE
- ② EXISTING BITUMINOUS BINDER ±6.5" to 14.5"
- ③ EXISTING BITUMINOUS SURFACE, ±2"
- ④ EXISTING AGGREGATE/EARTH SHOULDER
- ⑤ EXISTING PRECAST CONCRETE DECK BEAMS
- ⑥ EXISTING BITUMINOUS SURFACE, 1.5"±
- ⑦ EXISTING BOX CULVERT
- ⑧ EXISTING BRIDGE RAILING
- ⑨ PROPOSED HOT-IN-PLACE RECYCLING - SURFACE RECYCLING, 1.5"
- ⑩ PROPOSED BITUMINOUS MATERIALS (TACK COAT)
- ⑪ PROPOSED HMA SURFACE COURSE, IL-9.5, MIX C, N50, 2.25"
- ⑫ PROPOSED LONGITUDINAL JOINT SEALANT
- ⑬ PROPOSED AGGREGATE WEDGE SHOULDER, TYPE B
- ⑭ PROPOSED HMA SURFACE COURSE, IL-9.5, MIX C, N50, 1.5"

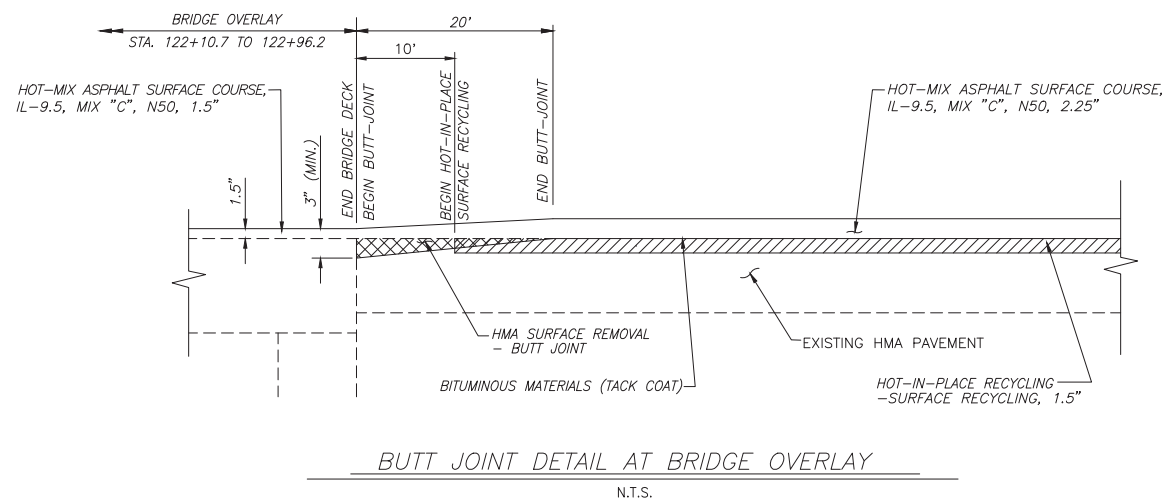

BUTT JOINT DETAIL AT BRIDGE OVERLAY

N.T.S.

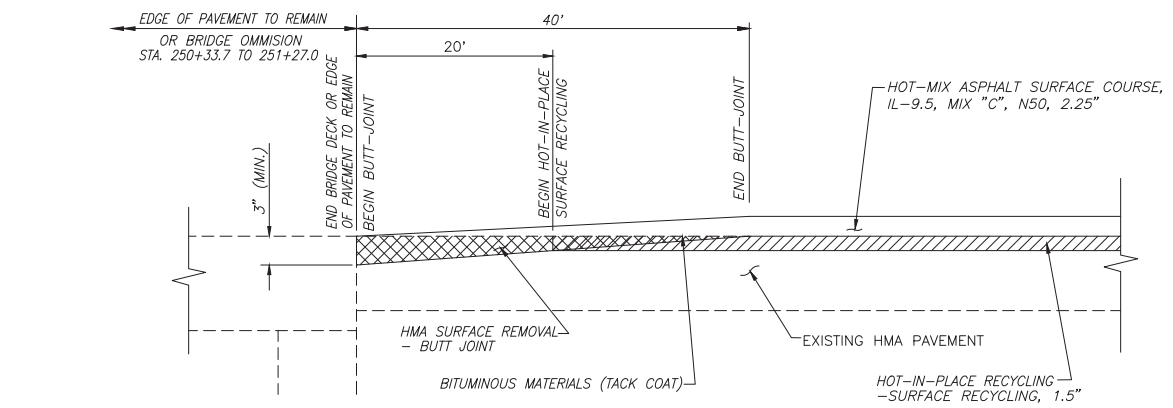

BUTT JOINT DETAIL AT BRIDGE OMISSION OR EDGE OF PAVEMENT TO REMAIN

N.T.S.

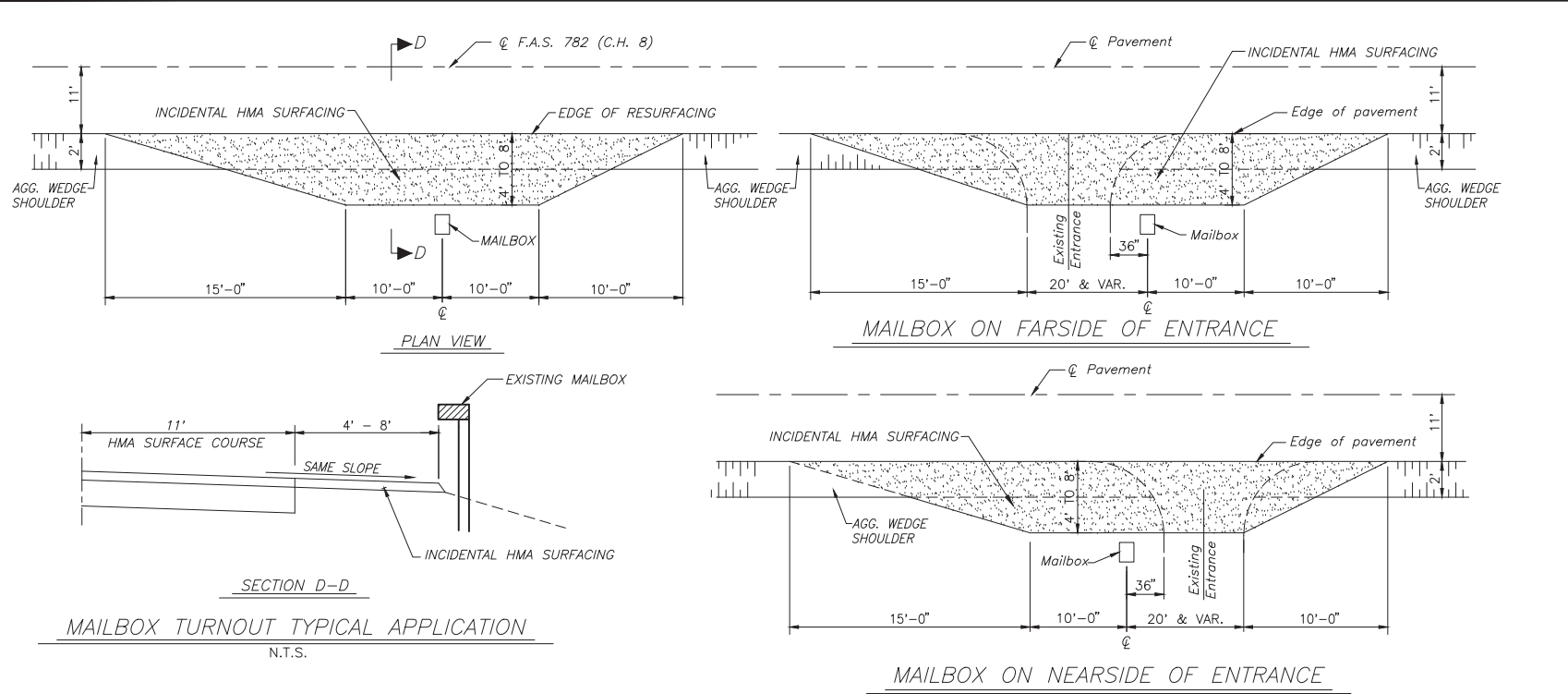
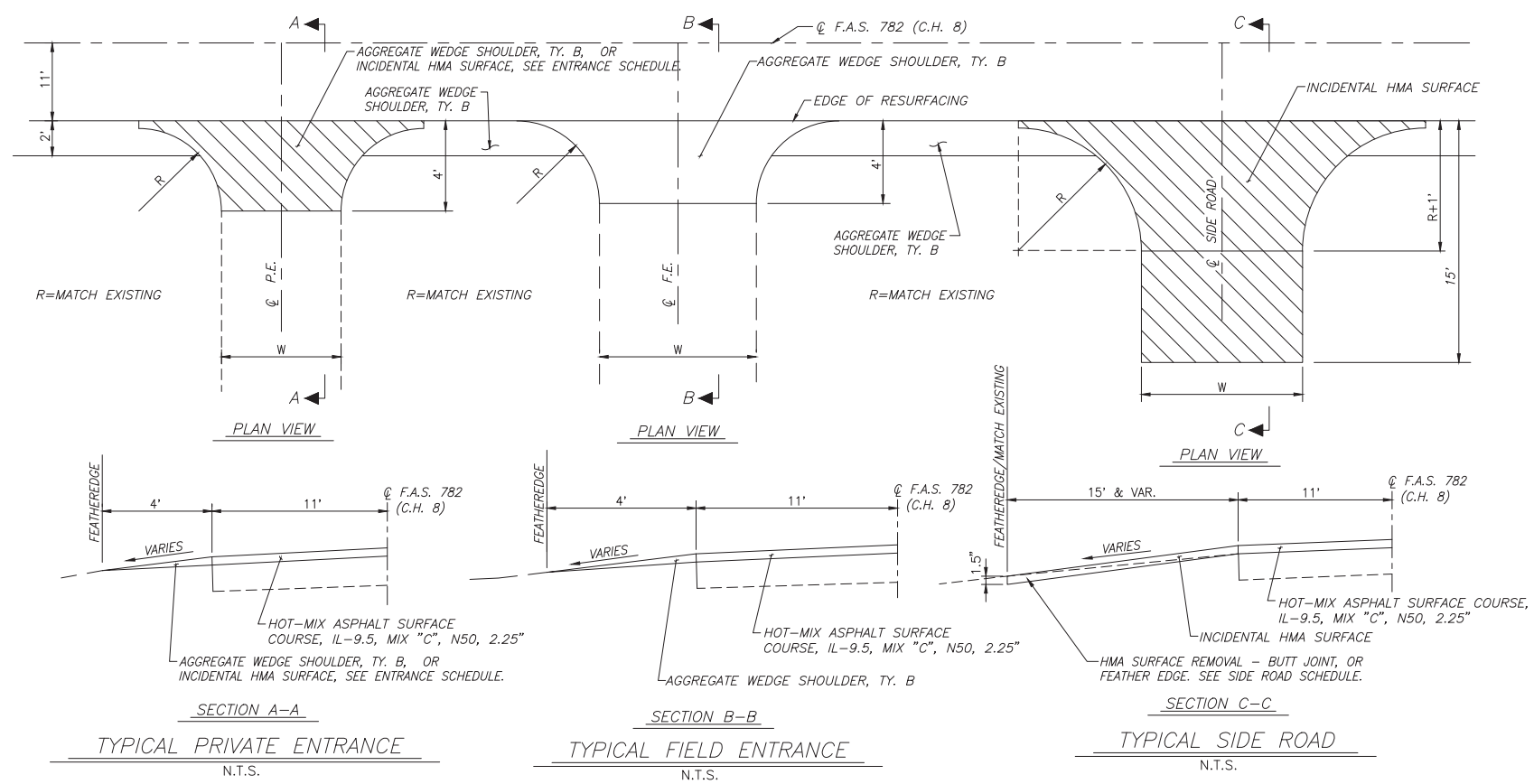

PAVEMENT MARKING SCHEDULE										
LOCATION (STATION TO STATION)	DESCRIPTION	THERMOPLASTIC PAVEMENT MARKING - LINE				TEMPORARY PAVEMENT MARKING - LINE 4"	TEMPORARY PAVEMENT MARKING - LINE 24"	TEMPORARY PAVEMENT MARKING REMOVAL	SHORT TERM PAVEMENT MARKING *	SHORT TERM PAVEMENT MARKING REMOVAL **
		4" WHITE SOLID (FOOT)	4" YELLOW SOLID (FOOT)	4" SKIP-DASH YELLOW (FOOT)	24" SOLID WHITE (FOOT)					
10+13 TO 14+98	SKIP DASH ALL	915		120	11	120		62	88	15
14+98 TO 21+00	SBL NO PASS - NBL SKIP DASH	1,204	602	150		752		251	109	18
21+00 TO 32+00	SKIP DASH ALL	2,200		275		275		92	200	33
32+00 TO 43+79	SBL SKIP DASH - NBL NO PASS	2,300	1,179	290		1,469		490	214	36
43+79 TO 44+73	SKIP DASH ALL	188		30		30		10	17	3
44+73 TO 59+00	SBL NO PASS - NBL SKIP DASH	2,854	1,427	360		1,787		596	259	43
59+00 TO 94+40	SKIP DASH ALL	7,080		880		880		293	644	107
94+40 TO 104+48	SBL SKIP DASH - NBL NO PASS	1,925	1,008	250		1,258		419	183	31
104+48 TO 110+43	NO PASS ALL	1,190	1,190			1,190		397	108	18
110+43 TO 117+00	SBL NO PASS - NBL SKIP DASH	1,314	657	160		817		272	119	20
117+00 TO 121+77	NO PASS ALL	954	954			954		318	87	14
121+77 TO 129+66	SBL SKIP DASH - NBL NO PASS	1,578	789	200		989		330	143	24
129+66 TO 131+38	SKIP DASH ALL	307		40		40		13	31	5
131+38 TO 144+00	SBL NO PASS - NBL SKIP DASH	2,428		320		320		107	229	38
144+00 TO 171+00	SKIP DASH ALL	5,325		670		670		223	491	82
171+00 TO 189+12	SBL SKIP DASH - NBL NO PASS	3,564		450		450		150	329	55
189+12 TO 223+60	NO PASS ALL	6,896	6,896			6,896		2,299	627	104
223+60 TO 229+00	SBL NO PASS - NBL SKIP DASH	880	440	110		550		183	80	13
229+00 TO 235+40	NO PASS ALL	1,480	1,480			1,480		493	135	22
235+40 TO 241+87	SBL SKIP DASH - NBL NO PASS	1,234	647	160		807		269	118	20
241+87 TO 244+55	NO PASS ALL	536	536			536		179	49	8
244+55 TO 249+50	SBL NO PASS - NBL SKIP DASH	990	495	120		615		205	90	15
249+50 TO 256+00	NO PASS ALL	1,300	1,300			1,300		433	118	20
256+00 TO 259+91	SBL SKIP DASH - NBL NO PASS	782	391	100		491		164	71	12
259+91 TO 285+07	NO PASS ALL	4,945	5,032			5,032		1,677	457	76
285+07 TO 298+00	SBL NO PASS - NBL SKIP DASH	2,586	1,293	320		1,613		538	235	39
298+00 TO 333+44	SKIP DASH ALL	6,913		890		890		297	644	107
333+44 TO 338+94	SBL SKIP DASH - NBL NO PASS	1,100	550	140		690		230	100	17
338+94 TO 342+00	SKIP DASH ALL	612		80		80		27	56	9
342+00 TO 351+00	SBL NO PASS - NBL SKIP DASH	1,800	900	225		1,125		375	164	27
351+00 TO 368+80	SBL SKIP DASH - NBL NO PASS	3,560	1,780	445		2,225		742	324	54
368+80 TO 377+20	SBL NO PASS - NBL SKIP DASH	1,680	840	210		1,050		350	153	25
377+20 TO 384+89	SKIP DASH ALL	1,538		190		190		63	140	23
384+89 TO 393+93	SBL SKIP DASH - NBL NO PASS	1,808	904	230		1,134		378	164	27
393+93 TO 396+53	NO PASS ALL	520	520			520		173	47	8
TOTAL		76,486	31,810	7,415	11	39,225.0	11.0	13,097	7,025	1,171

* Assumed two applications for centerline skip dash for corresponding work efforts.
 ** Removal will be paid for the surface application only.

SIDE ROAD / INTERSECTION SCHEDULE										
LOCATION (STATION, DIRECTION)	ENTRANCE TYPE	EXIST. SURFACE TYPE	LENGTH (FOOT)	TOTAL AREA (SQ YD)	HOT-MIX ASPHALT SURFACE REMOVAL - BUTT JOINT * (SQ YD)	BITUMINOUS MATERIALS (PRIME COAT)	BITUMINOUS MATERIALS (TACK COAT)	INCIDENTAL HMA SURFACE	AGGREGATE WEDGE SHOULDER, TY. B (TON)	
										(TON)
10+13.1 RT	MAIN ST.	HMA	32.3	28.0	28.0			12.6	2.7	
11+33 RT	PIERCE AVE.	OIL & CHIP	15.0	43.0				19.4	3.6	
11+40 LT	PIERCE AVE.	OIL & CHIP	15.0	37.4				16.8	3.1	
39+16 LT	OLD PARK AVE.	HMA	15.0	57.6	57.6			25.9	5.6	
79+18 RT	DUNKARD AVE.	OIL & CHIP	15.0	71.2				32.0	6.0	
79+22 LT	1400 N	AGGREGATE	15.0	36.5		59.5		3.1		
131+50 LT	MAHLE SCHOOL AVE.	OIL & CHIP	15.0	107.8	107.8			48.5	10.6	
158+49 RT	TRIX AVE.	OIL & CHIP	15.0	93.6				42.1	7.9	
185+22 LT	HASTING CEMETERY AVE.	HMA	15.0	71.7	71.7			32.3	7.0	
239+23 LT	PERSIMMON AVE.	HMA	15.0	68.6				30.9	5.8	
271+32 RT	3D AVE.	OIL & CHIP	15.0	109.7				49.4	9.2	
320+12 RT	LAKE BRANCH AVE.	HMA	15.0	64.5				29.0	5.4	
328+64 LT	SNOW CEMETERY AVE.	HMA	15.0	122.6	122.6			55.2	12.0	
TOTAL					388	60	394	82		

PAVEMENT PATCHING SCHEDULE										
LOCATION (STATION TO STATION)	LEFT	RIGHT	LENGTH (FOOT)	WIDTH (FOOT)	CLASS D PATCHES			AGGREGATE WEDGE SHOULDER, TYPE B **		
					TYPE II (5<15) (SQ YD)	TYPE III (15<25) (SQ YD)	TYPE IV (25<) (SQ YD)			
12+67 to 13+36	X		69	11				84.3		
13+36 to 14+07	X		71	5				39.4		
20+37 to 20+45		X	8	6	5.3					
21+08 to 21+67		X	59	5				32.8		
59+33 to 59+98	X		65	4				28.9		
80+19 to 81+25	X		106	5				58.9		
85+58 to 86+15	X		57	5				31.7		
86+15 to 86+85	X		70	11				85.6		
110+43 to 110+59	X		16	5	8.9					
111+97 to 113+00	X		103	4				45.8		
113+47 to 113+95	X		48	11				58.7		
125+87 to 126+54		X	67	4				29.8		
126+54 to 126+81	X		27	4	12.0					
130+00 to 130+30		X	30	4	13.3					
131+31 to 131+50	X		19	*5/11		18.7				
131+50 to 131+87	X		37	*5/11			41.1			
213+68 to 214+33	X		65	11			79.4			
319+36 to 319+67	X		31	5		17.2				
319+67 to 319+88	X		21	11			25.7			
386+59 to 387+31		X	72	4			32.0			
TOTAL					40	36	674			

*Triangular Wedge Included

ENTRANCE / MAILBOX SCHEDULE										
LOCATION (STATION, DIRECTION)	ENTRANCE TYPE	EXIST. SURFACE TYPE	WIDTH (FOOT)	LENGTH (FOOT)	BITUMINOUS MATERIALS (PRIME COAT) (POUND)	BITUMINOUS MATERIALS (TACK COAT) (POUND)	INCIDENTAL HMA SURFACE (TON)	AGGREGATE WEDGE SHOULDER, TY. B (TON)		
									(TON)	
10+99 LT	PE / MAILBOX	AGGREGATE	30.0	4.0	42.5			2.1	--	
11+39 RT	PE / MAILBOX	AGGREGATE	30.0	5.0	42.5			2.1	--	
12+09 LT	MAILBOX	AGGREGATE	20.0	5.0	32.4			1.7	--	
12+88 LT	PE	AGGREGATE	24.0	4.0	--			--	2.0	
14+44 LT	PE	AGGREGATE	20.0	4.0	--			--	2.0	
16+13 LT	PE	AGGREGATE	23.0	4.0	--			--	1.0	
18+54 RT	PE	AGGREGATE	20.0	4.0	--			--	1.0	
29+67 LT	FE	TURF	22.0	4.0	--			--	1.0	
29+67 RT	FE	TURF	22.0	4.0	--			--	1.0	
30+72 RT	FE	TURF	22.0	4.0	--			--	1.0	
35+04 LT	MAILBOX	AGGREGATE	20.0	4.0	32.4			1.7	--	
35+48 RT	PE	HMA	24.0	4.0	--	9.2		1.5	--	
44+47 RT	PE	AGGREGATE	24.0	4.0	--			--	1.0	
44+49 LT	MAILBOX	AGGREGATE	20.0	4.0	32.4			1.7	--	
50+57 LT	PE / MAILBOX	AGGREGATE	30.0	5.0	42.5			2.1	--	
53+98 LT	PE / MAILBOX	AGGREGATE	30.0	5.0	42.5			2.1	--	
59+63 LT	MAILBOX	AGGREGATE	20.0	4.0	32.4			1.7	--	
59+67 RT	FE	AGGREGATE	18.0	4.0	--			--	1.0	
59+98 LT	FE	TURF	12.0	4.0	--			--	1.0	
61+07 LT	MAILBOX	AGGREGATE	20.0	4.0	32.4			1.7	--	
61+08 RT	PE	AGGREGATE	13.0	4.0	--			--	1.0	
64+59 RT	FE	TURF	15.0	4.0	--			--	1.0	
66+29 LT	FE	TURF	18.0	4.0	--			--	1.0	
73+21 RT	CE	AGGREGATE	22.0	4.0	--			--	1.0	
81+58 RT	PE	AGGREGATE	16.0	4.0	--			--	1.0	
81+59 LT	PE / MAILBOX	AGGREGATE	30.0	4.0	42.5			2.1	--	
82+45 LT	MAILBOX	AGGREGATE	20.0	4.0	32.4			1.7	--	
82+47 RT	PE	AGGREGATE	24.0	4.0	--			--	1.0	
84+96 LT	PE / MAILBOX	AGGREGATE	30.0	4.0	42.5			2.1	--	
96+22 RT	PE	AGGREGATE	13.0	4.0	--			--	1.0	
97+61 LT	MAILBOX	AGGREGATE	20.0	4.0	32.4			1.7	--	
97+78 RT	PE	AGGREGATE	24.0	4.0	--			--	1.0	
101+30 RT	FE	TURF	24.0	4.0	--			--	1.0	
105+68 RT	PE	AGGREGATE	24.0	4.0	--			--	1.0	
110+43 LT	FE	TURF	13.0	4.0	--			--	1.0	
112+57 LT	MAILBOX	AGGREGATE	20.0	4.0	32.4			1.7	--	
112+91 RT	PE	AGGREGATE	24.0	4.0	--			--	1.0	
118+57 RT	PE	AGGREGATE	15.0	4.0	--			--	1.0	
120+44 LT	FE	AGGREGATE	13.0	4.0	--			--	1.0	
123+64 RT	FE	TURF	18.0	4.0	--			--	1.0	
129+42 RT	PE	AGGREGATE	12.0	4.0	--			--	1.0	
130+33 LT	MAILBOX	AGGREGATE	20.0	4.0	32.4			1.7	--	
130+42 RT	PE	HMA	20.0	4.0	--	7.2		1.5	--	
131+37 RT	PE	TURF	14.0	4.0	--			--	1.0	
137+54 RT	PE	AGGREGATE	17.0	4.0	--			--	1.0	
145+15 LT	FE	TURF	19.0	4.0	--			--	1.0	
147+48 LT	PE	AGGREGATE	18.0	4.0	--			--	1.0	
158+54 LT	FE	AGGREGATE	21.0	4.0	--			--	1.0	
165+50 RT	FE	TURF	14.0	4.0	--			--	1.0	
170+45 RT	FE	AGGREGATE	15.0	4.0	--			--	1.0	
185+20 RT	FE	AGGREGATE	16.0	4.0	--			--	1.0	
198+73 RT	FE	TURF	20.0	4.0	--			--	1.0	
205+71 RT	FE	AGGREGATE	14.0	4.0	--			--	1.0	
211+44 LT	FE	AGGREGATE	18.0	4.0	--			--	1.0	
211+45 RT	FE	AGGREGATE	18.0	4.0	--			--	1.0	
222+99 LT	FE	TURF	19.0	4.0	--			--	1.0	
223+60 RT	FE	TURF	16.0	4.0	--			--	1.0	
224+99 RT	FE	TURF	17.0	4.0	--			--	1.0	
232+21 RT	PE	AGGREGATE	24.0	4.0	--			--	1.0	
238+19 LT	PE	AGG/CONCRETE	22.0	18.5	118.2			5.9	--	
244+58 RT	PE	AGGREGATE	21.0	4.0	--			--	1.0	
257+56 LT	PE	AGGREGATE	20.0	4.0	--			--	1.0	
266+93 RT	PE / MAILBOX	AGGREGATE	30.0	4.0	42.5			2.1	--	
270+74 LT	PE	TURF	14.0	4.0	--			--	1.0	
274+47 LT	FE	TURF	13.0							

CURVE #1 DATA
 RADIUS PT. COORD.
 N=825130.11
 E=713013.54
 P.I. STA.=20+20.43
 Δ = 13°03'49"
 D= 01°08'16"
 R= 5035.55'
 T= 578.56'
 L= 1148.11'
 E= 32.90'
 P.C. STA.= 14+43.87
 P.T. STA.= 25+91.99

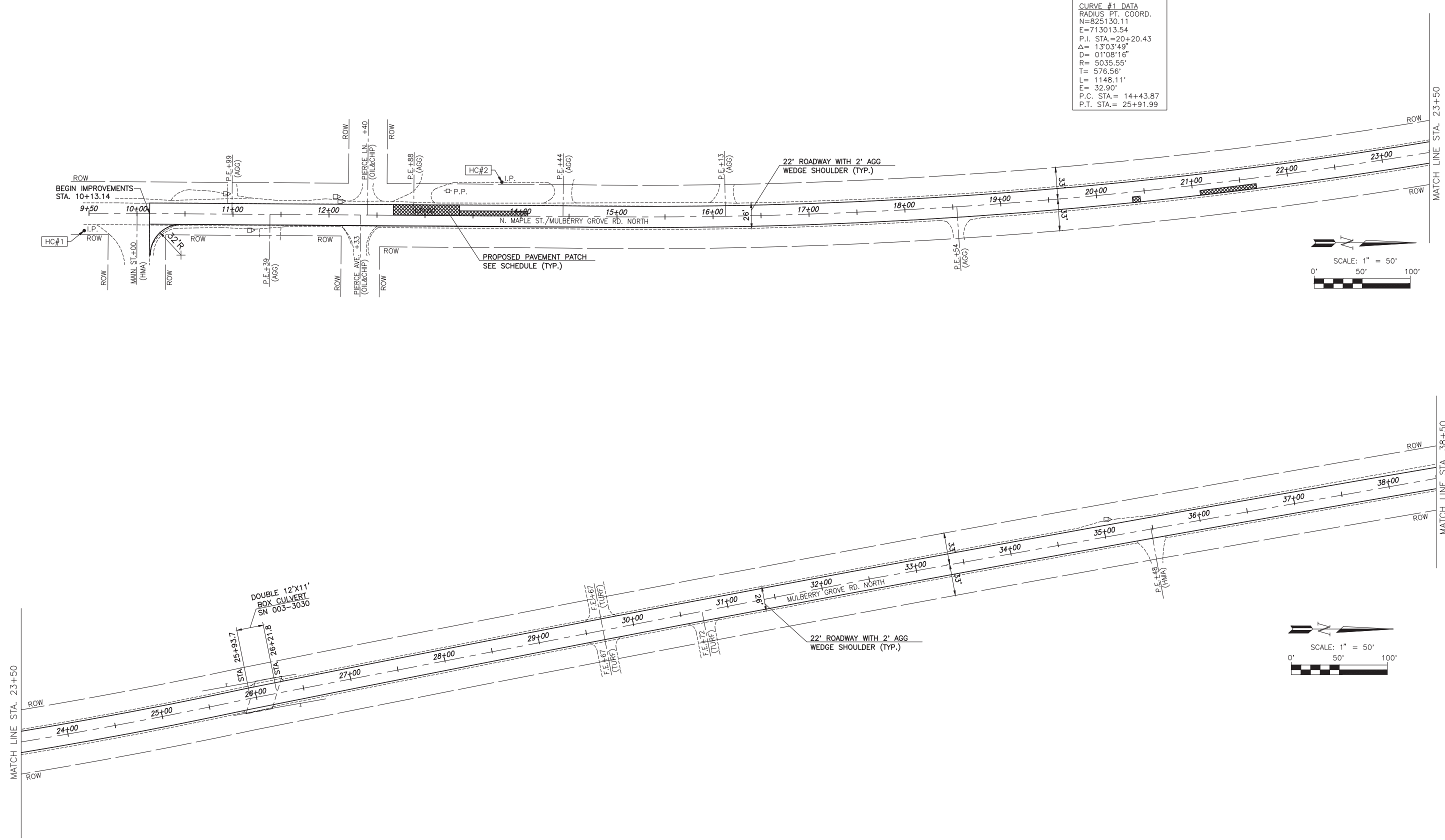

RHUTASEL and ASSOCIATES, INC.
 CONSULTING ENGINEERS • LAND SURVEYORS
 SALEM, ILLINOIS FREEBURG, ILLINOIS
 618-532-1992 618-539-3178
 ILLINOIS DESIGN FIRM LICENSE NO. 184-000287

DESIGNED - MSF	REVISED -
DRAWN - JMW	REVISED -
CHECKED - BLT	REVISED -
DATE - 04/02/2020	REVISED -

**STATE OF ILLINOIS
 DEPARTMENT OF TRANSPORTATION**

**IMPROVEMENT PLANS
 STA. 9+50 TO 38+50**

ROUTE	SECTION	COUNTY	TOTAL SHEETS	SHEET NO.
FAS 782	16-00089-00-SC	BOND	19	7
FEDERAL AID PROJECT		CONTRACT NO. 97739		
ILLINOIS				

RAAI JOB NO. 53119

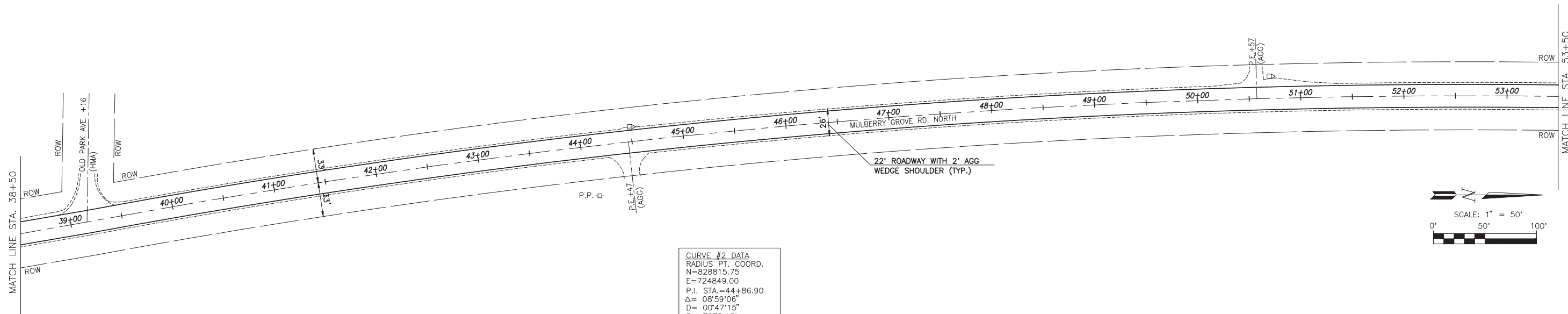

CURVE #2 DATA
 RADIUS PT. COORD.
 N=828815.75
 E=724849.00
 P.I. STA.=44+86.90
 $\Delta = 08^{\circ}59'06''$
 $D = 00^{\circ}47'15''$
 R= 7275.15'
 T= 571.61'
 L= 1140.87'
 E= 22.42'
 P.C. STA.= 39+15.29
 P.T. STA.= 50+56.16

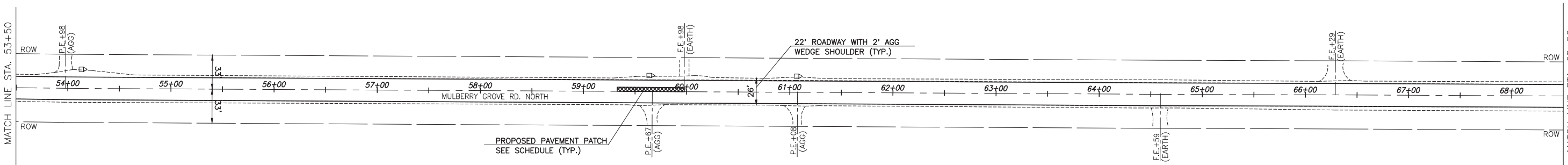

DESIGNED - MSF	REVISED -
DRAWN - JMW	REVISED -
CHECKED - BLT	REVISED -
DATE - 04/02/2020	REVISED -

ROUTE	SECTION	COUNTY	TOTAL SHEETS	SHEET NO.
FAS 782	16-00089-00-SC	BOND	19	8
FEDERAL AID PROJECT		CONTRACT NO. 97739		
ILLINOIS				

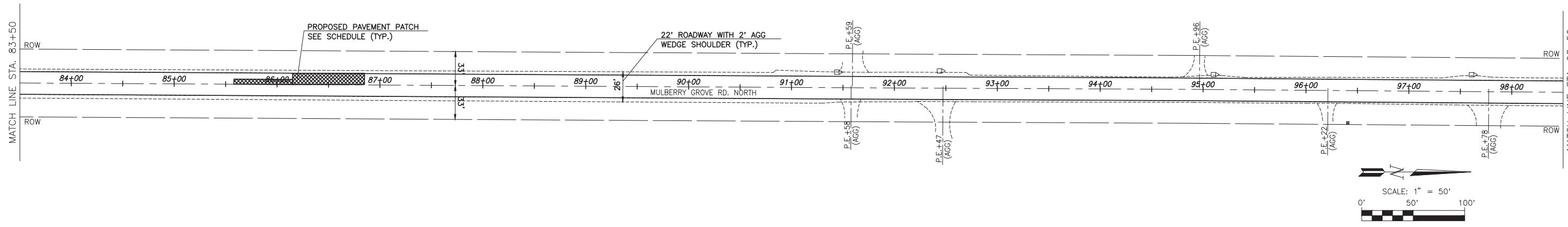
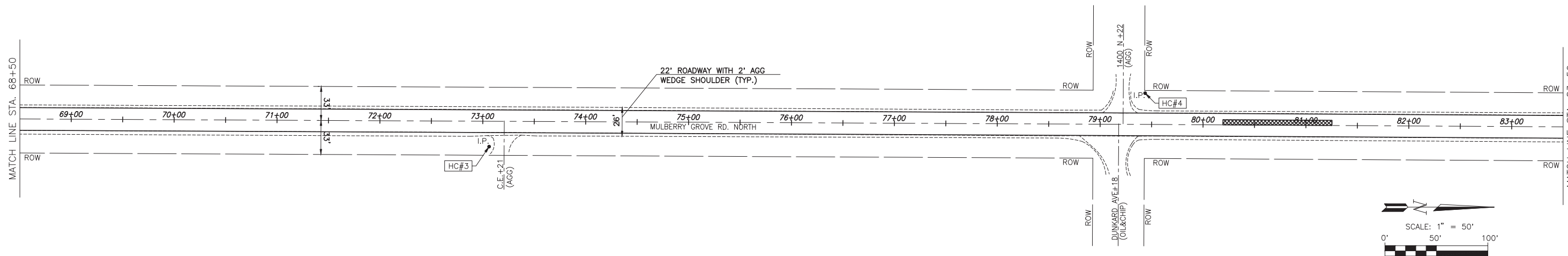

DESIGNED - MSF	REVISED -
DRAWN - JMW	REVISED -
CHECKED - BLT	REVISED -
DATE - 04/02/2020	REVISED -

ROUTE	SECTION	COUNTY	TOTAL SHEETS	SHEET NO.
FAS 782	16-00089-00-SC	BOND	19	9
FEDERAL AID PROJECT		CONTRACT NO. 97739		
ILLINOIS				

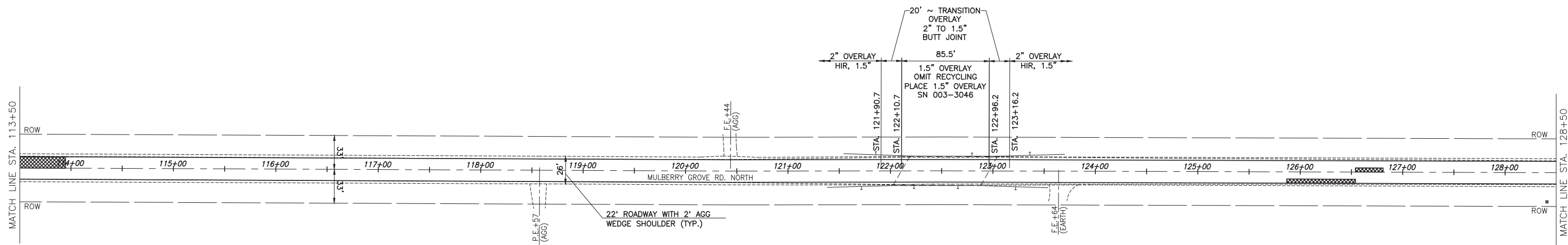
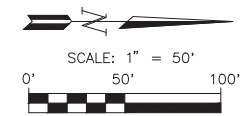
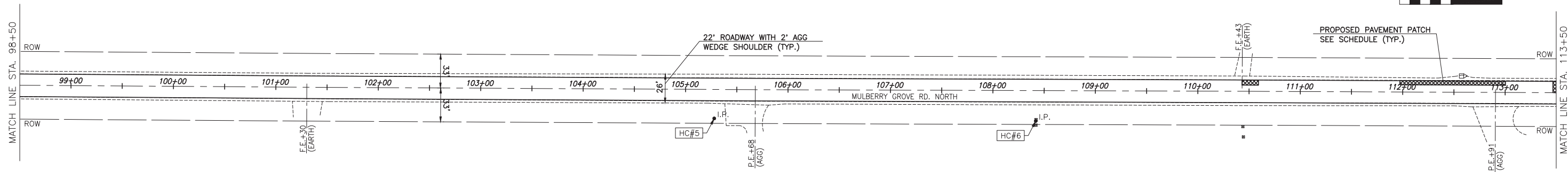

RHUTASEL and ASSOCIATES, INC.
 CONSULTING ENGINEERS • LAND SURVEYORS
 SALEM, ILLINOIS FREEBURG, ILLINOIS
 618-532-1992 618-539-3178
 ILLINOIS DESIGN FIRM LICENSE NO. 184-000287

DESIGNED - MSF	REVISED -
DRAWN - JMW	REVISED -
CHECKED - BLT	REVISED -
DATE - 04/02/2020	REVISED -

**STATE OF ILLINOIS
 DEPARTMENT OF TRANSPORTATION**

**IMPROVEMENT PLANS
 STA. 98+50 TO 128+50**

ROUTE	SECTION	COUNTY	TOTAL SHEETS	SHEET NO.
FAS 782	16-00089-00-SC	BOND	19	10
FEDERAL AID PROJECT		CONTRACT NO. 97739		
ILLINOIS				

RAAI JOB NO. 53119

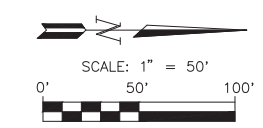
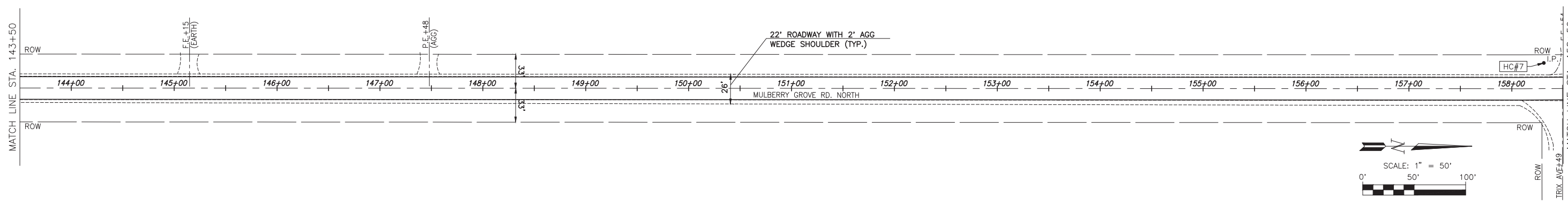
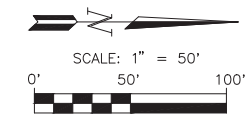
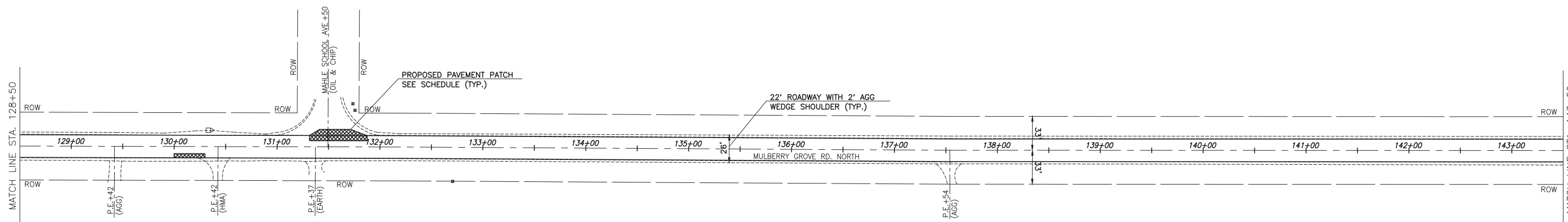

RHUTASEL and ASSOCIATES, INC.
 CONSULTING ENGINEERS • LAND SURVEYORS
 SALEM, ILLINOIS FREEBURG, ILLINOIS
 618-532-1992 618-539-3178
 ILLINOIS DESIGN FIRM LICENSE NO. 184-000287

DESIGNED - MSF	REVISED -
DRAWN - JMW	REVISED -
CHECKED - BLT	REVISED -
DATE - 04/02/2020	REVISED -

**STATE OF ILLINOIS
 DEPARTMENT OF TRANSPORTATION**

**IMPROVEMENT PLANS
 STA. 128+50 TO 158+50**

ROUTE	SECTION	COUNTY	TOTAL SHEETS	SHEET NO.
FAS 782	16-00089-00-SC	BOND	19	11
FEDERAL AID PROJECT		CONTRACT NO. 97739		
ILLINOIS				

RAAI JOB NO. 53119

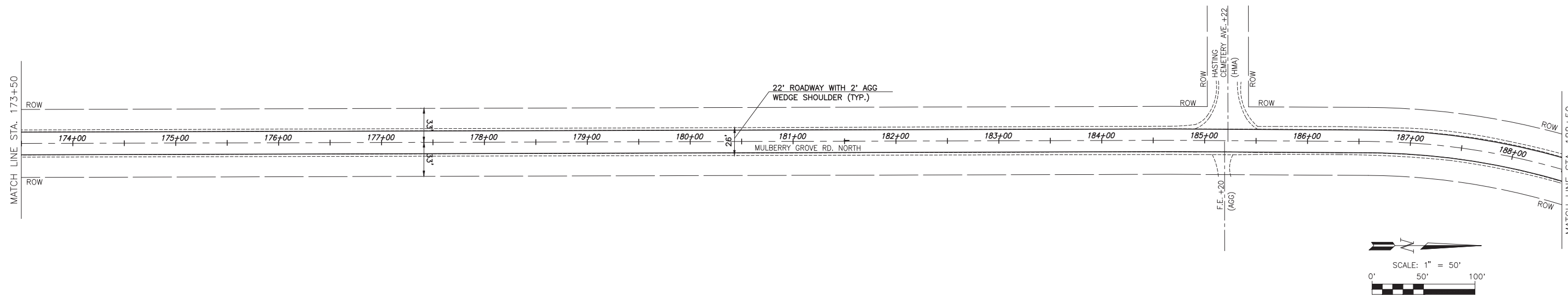
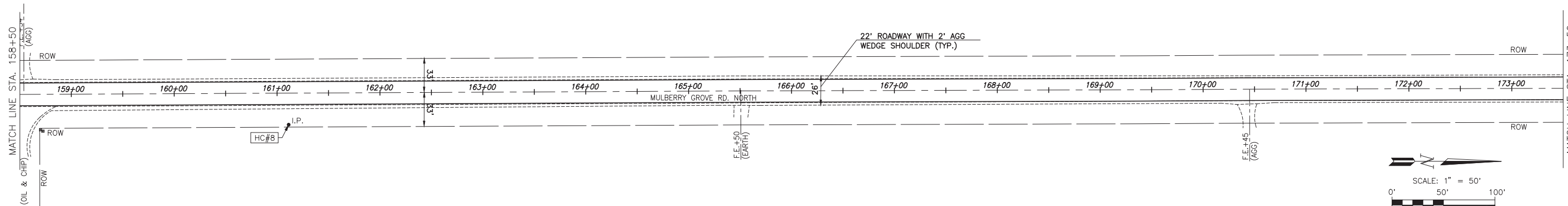

DESIGNED - MSF	REVISED -
DRAWN - JMW	REVISED -
CHECKED - BLT	REVISED -
DATE - 04/02/2020	REVISED -

ROUTE	SECTION	COUNTY	TOTAL SHEETS	SHEET NO.
FAS 782	16-00089-00-SC	BOND	19	12
FEDERAL AID PROJECT		CONTRACT NO. 97739		
ILLINOIS				

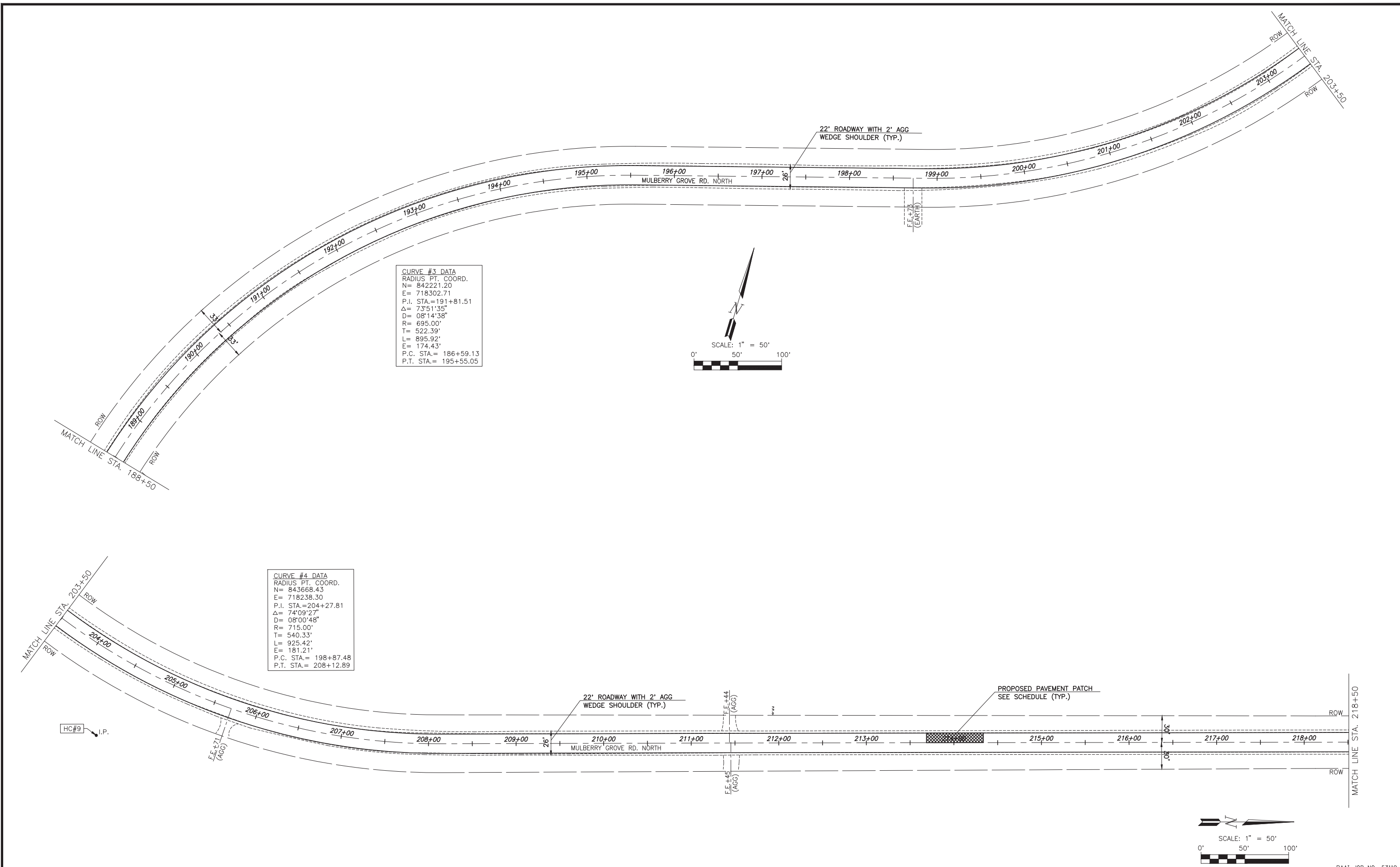

CURVE #3 DATA
 RADIUS PT. COORD.
 N= 842221.20
 E= 718302.71
 P.I. STA.=191+81.51
 Δ = 73°51'35"
 D= 08°14'38"
 R= 695.00'
 T= 522.39'
 L= 895.92'
 E= 174.43'
 P.C. STA.= 186+59.13
 P.T. STA.= 195+55.05

CURVE #4 DATA
 RADIUS PT. COORD.
 N= 843668.43
 E= 718238.30
 P.I. STA.=204+27.81
 Δ = 74°09'27"
 D= 08°00'48"
 R= 715.00'
 T= 540.33'
 L= 925.42'
 E= 181.21'
 P.C. STA.= 198+87.48
 P.T. STA.= 208+12.89

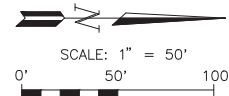
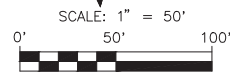

RHUTASEL and ASSOCIATES, INC.
 CONSULTING ENGINEERS • LAND SURVEYORS
 SALEM, ILLINOIS FREEBURG, ILLINOIS
 618-532-1992 618-539-3178
 ILLINOIS DESIGN FIRM LICENSE NO. 184-000287

DESIGNED - MSF	REVISED -
DRAWN - JMW	REVISED -
CHECKED - BLT	REVISED -
DATE - 04/02/2020	REVISED -

**STATE OF ILLINOIS
 DEPARTMENT OF TRANSPORTATION**

**IMPROVEMENT PLANS
 STA. 188+50 TO 218+50**

ROUTE	SECTION	COUNTY	TOTAL SHEETS	SHEET NO.
FAS 782	16-00089-00-SC	BOND	19	13
FEDERAL AID PROJECT		CONTRACT NO. 97739		
		ILLINOIS		

RAAI JOB NO. 53119

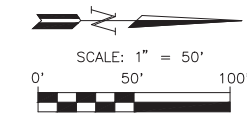
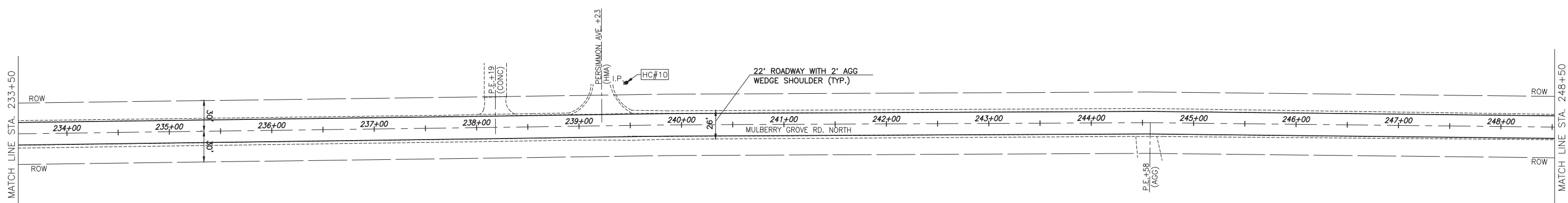
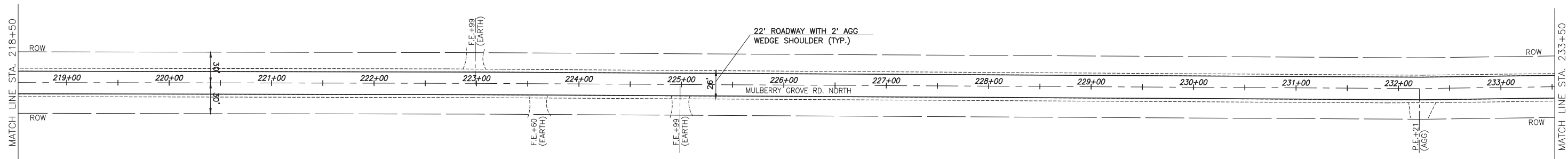

RHUTASEL and ASSOCIATES, INC.
 CONSULTING ENGINEERS • LAND SURVEYORS
 SALEM, ILLINOIS FREEBURG, ILLINOIS
 618-532-1992 618-539-3178
 ILLINOIS DESIGN FIRM LICENSE NO. 184-000287

DESIGNED - MSF	REVISED -
DRAWN - JMW	REVISED -
CHECKED - BLT	REVISED -
DATE - 04/02/2020	REVISED -

**STATE OF ILLINOIS
 DEPARTMENT OF TRANSPORTATION**

**IMPROVEMENT PLANS
 STA. 218+50 TO 248+50**

ROUTE	SECTION	COUNTY	TOTAL SHEETS	SHEET NO.
FAS 782	16-00089-00-SC	BOND	19	14
FEDERAL AID PROJECT		CONTRACT NO. 97739		
ILLINOIS				

RAAI JOB NO. 53119

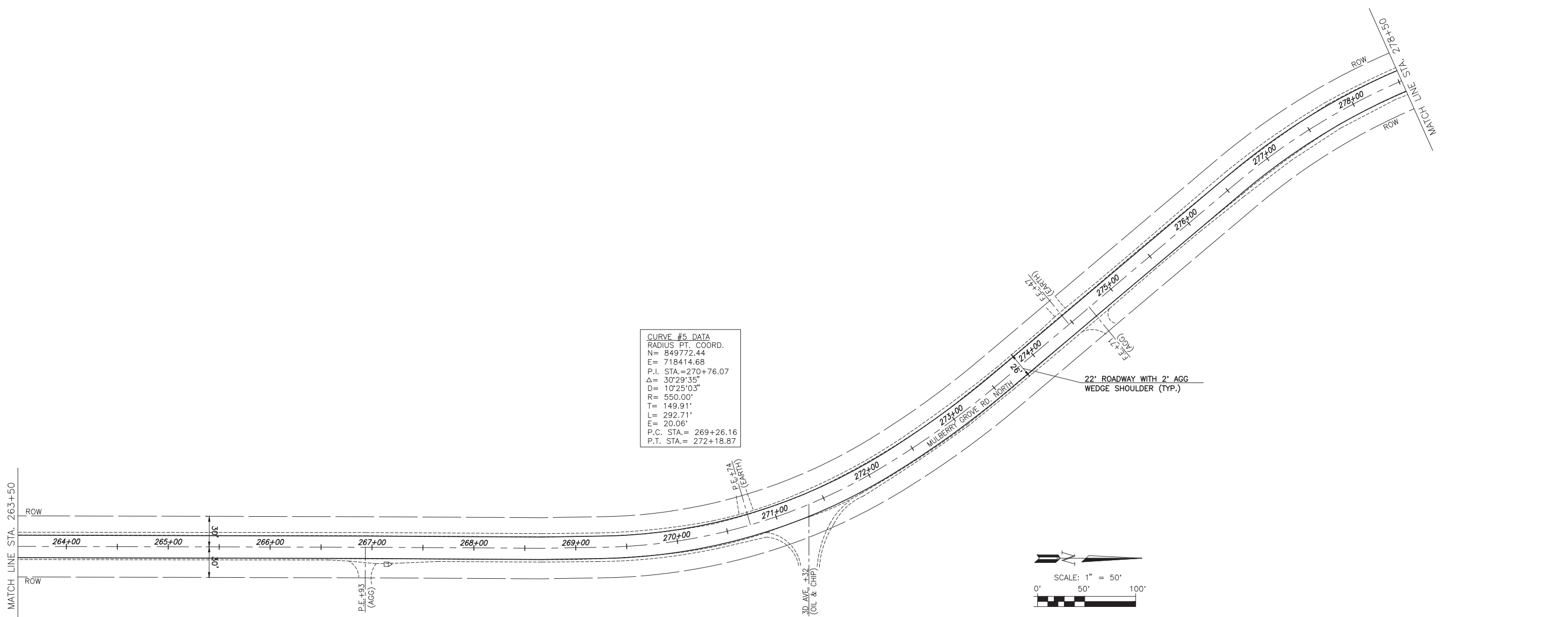
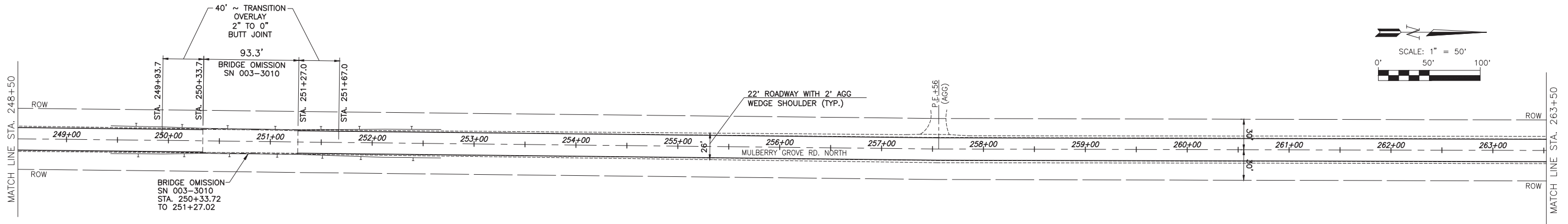

CURVE #5 DATA
 RADIUS PT. COORD.
 N = 849772.44
 E = 718414.68
 P.I. STA. = 270+76.07
 Δ = 30°29'35"
 D = 10°25'03"
 R = 550.00'
 T = 149.91'
 L = 292.71'
 E = 20.06'
 P.C. STA. = 269+26.16
 P.T. STA. = 272+18.87

RHUTASEL and ASSOCIATES, INC.
 CONSULTING ENGINEERS • LAND SURVEYORS
 SALEM, ILLINOIS FREEBURG, ILLINOIS
 618-532-1992 618-539-3178
 ILLINOIS DESIGN FIRM LICENSE NO. 184-000287

DESIGNED - MSF	REVISED -
DRAWN - JMW	REVISED -
CHECKED - BLT	REVISED -
DATE - 04/02/2020	REVISED -

STATE OF ILLINOIS
DEPARTMENT OF TRANSPORTATION

IMPROVEMENT PLANS
STA. 248+50 TO 278+50

ROUTE	SECTION	COUNTY	TOTAL SHEETS	SHEET NO.
FAS 782	16-00089-00-SC	BOND	19	15
FEDERAL AID PROJECT		CONTRACT NO. 97739		
ILLINOIS				

RAAI JOB NO. 53119

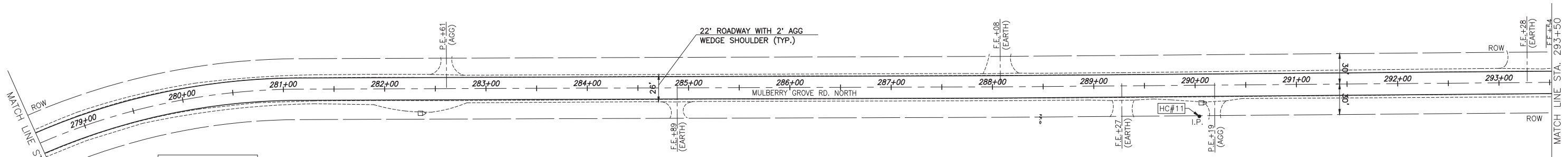

CURVE #6 DATA
 RADIUS PT. COORD.
 N= 850822.89
 E= 719103.59
 P.I. STA.=278+97.88
 Δ = 39°59'03"
 D= 08°48'53"
 R= 650.00'
 T= 236.48'
 L= 453.61'
 E= 41.68'
 P.C. STA.= 276+61.40
 P.T. STA.= 281+15.01

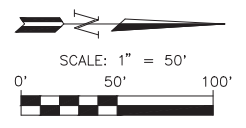
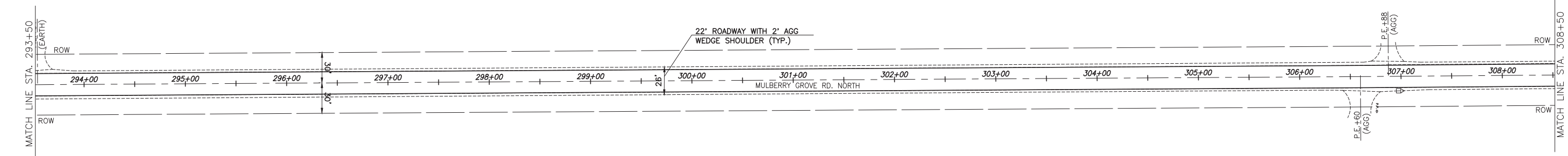
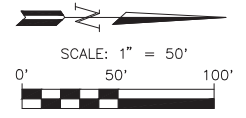

RHUTASEL and ASSOCIATES, INC.
 CONSULTING ENGINEERS • LAND SURVEYORS
 SALEM, ILLINOIS FREEBURG, ILLINOIS
 618-532-1992 618-539-3178
 ILLINOIS DESIGN FIRM LICENSE NO. 184-000287

DESIGNED	- MSF	REVISED	-
DRAWN	- JMW	REVISED	-
CHECKED	- BLT	REVISED	-
DATE	- 04/02/2020	REVISED	-

STATE OF ILLINOIS
DEPARTMENT OF TRANSPORTATION

IMPROVEMENT PLANS
STA. 278+50 TO 308+50

ROUTE	SECTION	COUNTY	TOTAL SHEETS	SHEET NO.
FAS 782	16-00089-00-SC	BOND	19	16
FEDERAL AID PROJECT		CONTRACT NO. 97739		
ILLINOIS				

RAAI JOB NO. 53119

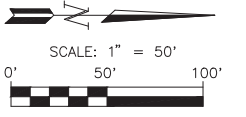
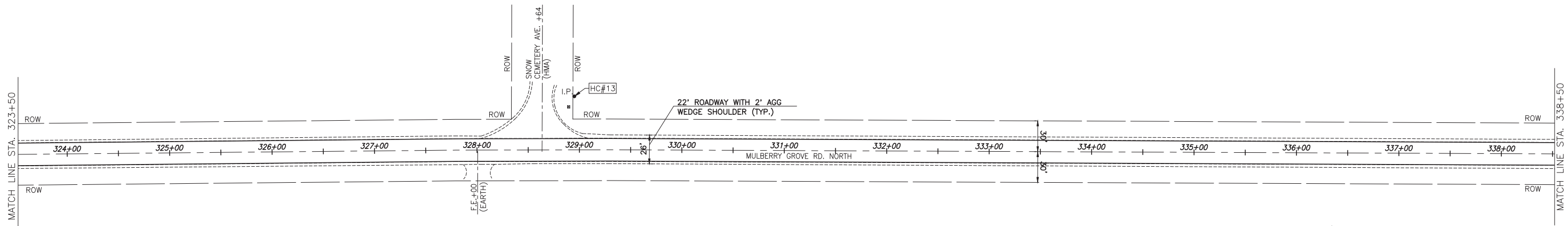
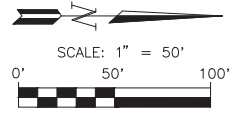
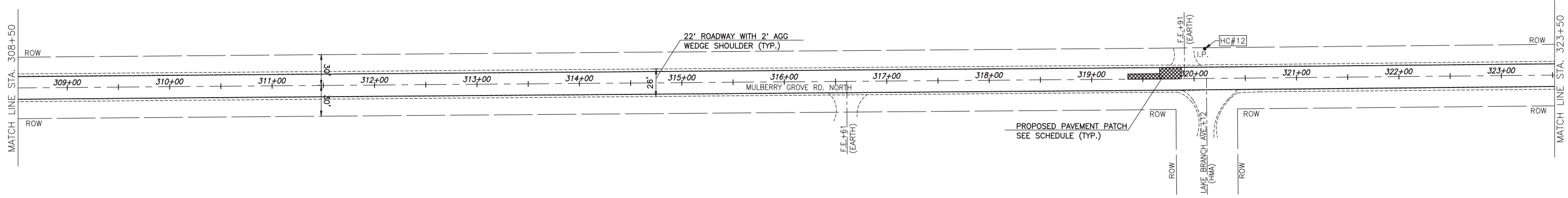

RAAI JOB NO. 53119

RHUTASEL and ASSOCIATES, INC.
 CONSULTING ENGINEERS • LAND SURVEYORS
 SALEM, ILLINOIS FREEBURG, ILLINOIS
 618-532-1992 618-539-3178
 ILLINOIS DESIGN FIRM LICENSE NO. 184-000287

DESIGNED - MSF	REVISED -
DRAWN - JMW	REVISED -
CHECKED - BLT	REVISED -
DATE - 04/02/2020	REVISED -

**STATE OF ILLINOIS
 DEPARTMENT OF TRANSPORTATION**

**IMPROVEMENT PLANS
 STA. 308+50 TO 338+50**

ROUTE	SECTION	COUNTY	TOTAL SHEETS	SHEET NO.
FAS 782	16-00089-00-SC	BOND	19	17
FEDERAL AID PROJECT		CONTRACT NO. 97739		
ILLINOIS				

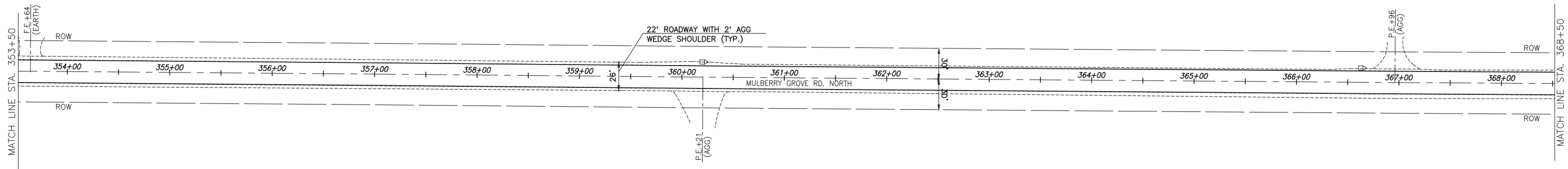
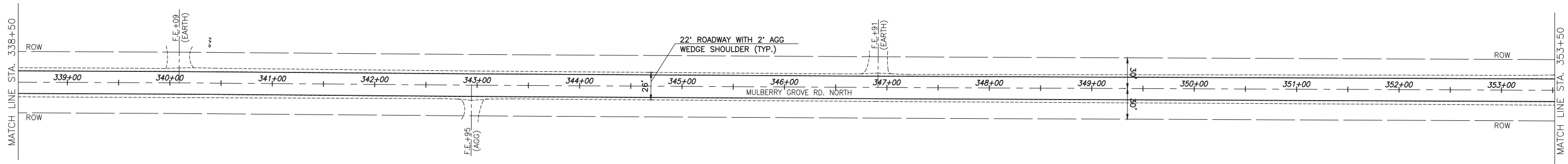

RHUTASEL and ASSOCIATES, INC.
 CONSULTING ENGINEERS • LAND SURVEYORS
 SALEM, ILLINOIS FREEBURG, ILLINOIS
 618-532-1992 618-539-3178
 ILLINOIS DESIGN FIRM LICENSE NO. 184-000287

DESIGNED - MSF	REVISED -
DRAWN - JMW	REVISED -
CHECKED - BLT	REVISED -
DATE - 04/02/2020	REVISED -

**STATE OF ILLINOIS
 DEPARTMENT OF TRANSPORTATION**

**IMPROVEMENT PLANS
 STA. 338+50 TO 368+50**

ROUTE	SECTION	COUNTY	TOTAL SHEETS	SHEET NO.
FAS 782	16-00089-00-SC	BOND	19	18
FEDERAL AID PROJECT		CONTRACT NO. 97739		
ILLINOIS				

RAAI JOB NO. 53119

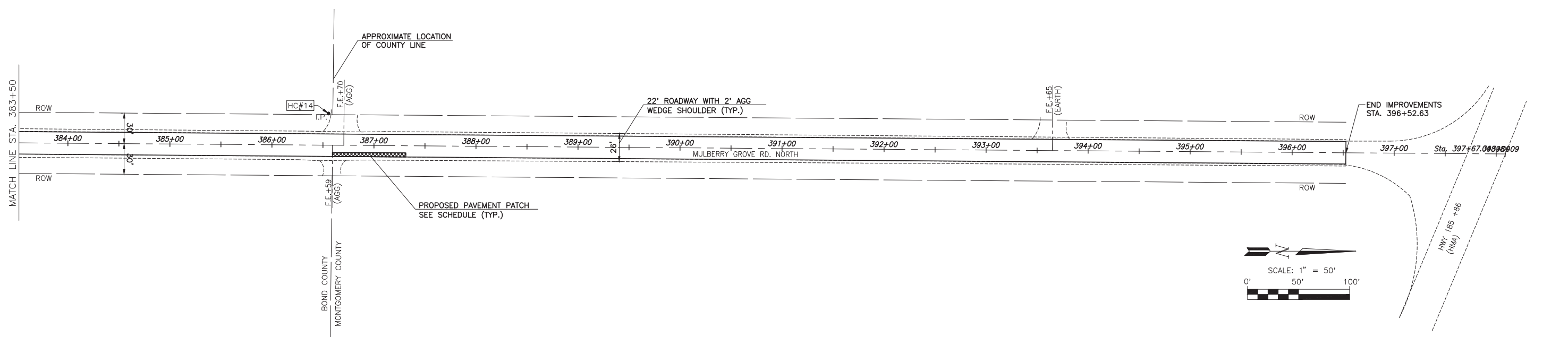
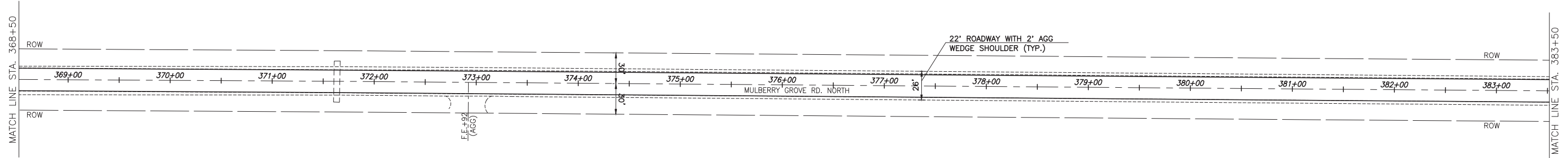

RHUTASEL and ASSOCIATES, INC.
 CONSULTING ENGINEERS • LAND SURVEYORS
 SALEM, ILLINOIS FREEBURG, ILLINOIS
 618-532-1992 618-539-3178
 ILLINOIS DESIGN FIRM LICENSE NO. 184-000287

DESIGNED - MSF	REVISED -
DRAWN - JMW	REVISED -
CHECKED - BLT	REVISED -
DATE - 04/02/2020	REVISED -

**STATE OF ILLINOIS
 DEPARTMENT OF TRANSPORTATION**

**IMPROVEMENT PLANS
 STA. 368+50 TO 398+00**

ROUTE	SECTION	COUNTY	TOTAL SHEETS	SHEET NO.
FAS 782	16-00089-00-SC	BOND	19	19
FEDERAL AID PROJECT		CONTRACT NO. 97739		
ILLINOIS				

RAAI JOB NO. 53119