

STATE OF ILLINOIS
DEPARTMENT OF TRANSPORTATION

**PLANS FOR PROPOSED
ROADWAY RESURFACING**

**CH 10 (FAS 782) - MULBERRY GROVE ROAD (SOUTH)
BOND COUNTY
STR FUNDS
SECTION 15-00088-00-RS
PROJECT NO. NODS(619)
JOB NO. C-98-311-16**



INDEX OF SHEETS

- 1 COVER SHEET
- 2 GENERAL NOTES, LEGEND, AND COMMITMENTS
- 3 SUMMARY OF QUANTITIES
- 4 TYPICAL SECTIONS
- 5 MISCELLANEOUS DETAILS
- 6 CONSTRUCTION SCHEDULES
- 7-9 IMPROVEMENT PLANS

HIGHWAY STANDARDS (SEE SPECIFICATIONS)

- 000001-07 STANDARD SYMBOLS, ABBREVIATIONS AND PATTERNS
- 420701-03 PAVEMENT WELDED WIRE REINFORCEMENT
- 442101-09 CLASS B PATCHES
- 701011-04 OFF-RD MOVING OPERATIONS 2L, 2W, DAY ONLY
- 701201-05 LANE CLOSURE, 2L, 2W, DAY ONLY
- 701301-04 LANE CLOSURE, 2L, 2W, SHORT TIME OPERATIONS
- 701306-04 LANE CLOSURE, 2L, 2W, SLOW MOVING OPERATIONS DAY ONLY
- 701901-08 TRAFFIC CONTROL DEVICES
- 720006-04 SIGN PANEL ERECTION DETAILS
- 720011-01 METAL POSTS FOR SIGNS, MARKERS & DELINEATORS
- 780001-05 TYPICAL PAVEMENT MARKINGS
- BLR 22-7 TYPICAL APPLICATION OF TRAFFIC CONTROL DEVICES FOR CONSTRUCTION ON RURAL LOCAL HIGHWAYS
- BLR 24-2 MAILBOX TURNOUT FOR LOCAL ROADS

DESIGN CLASSIFICATION: MAJOR COLLECTOR
ADT₂₀₁₅ : 2500
DESIGN SPEED: 50 MPH

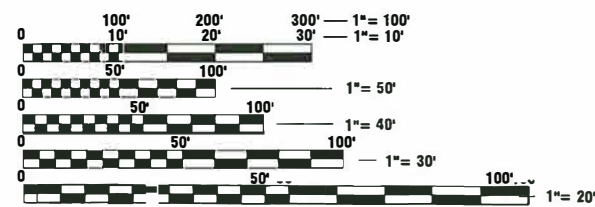

FULL SIZE PLANS HAVE BEEN PREPARED USING STANDARD ENGINEERING SCALES. REDUCED SIZED PLANS MAY NOT CONFORM TO STANDARD SCALES. IN MAKING MEASUREMENTS ON REDUCED PLANS, THE ABOVE SCALES MAY BE USED.

J.U.L.I.E.
JOINT UTILITY LOCATION INFORMATION FOR EXCAVATION
1-800-892-0123
OR 811

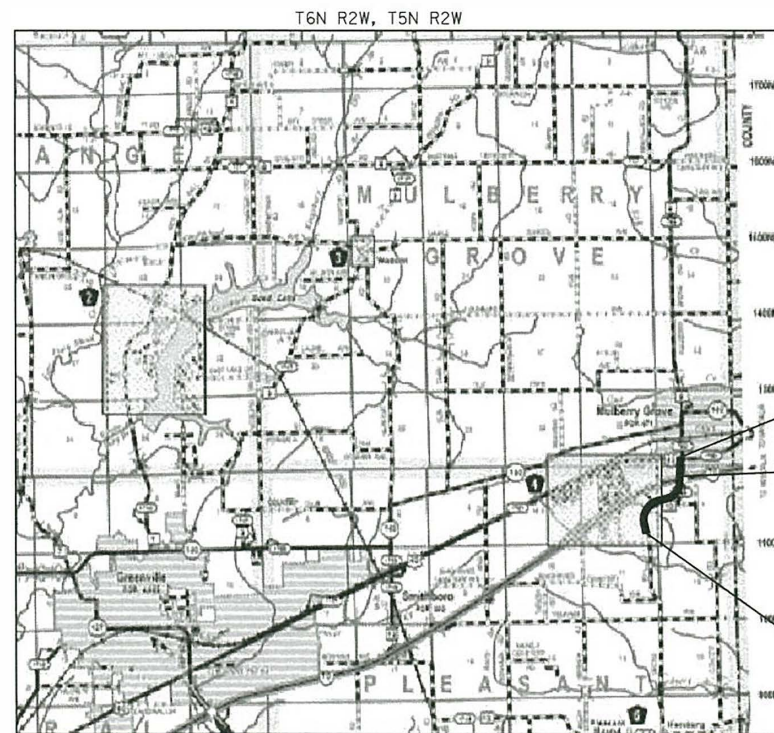

APPROXIMATE SCALE: 1" = 1.34 MI

LOCATION MAP

GROSS LENGTH OF PROJECT: 6,628.100 FT = 1.255 MI
BRIDGE OMISSION: STA. 561+23.1 TO 563+48.1 = 225.000 FT
NET LENGTH OF PROJECT: 6,403.100 FT = 1.213 MI



Monica S. French 04-02-20
MONICA S. FRENCH
SALEM, ILLINOIS
ILLINOIS LICENSED PROFESSIONAL ENGINEER NO. 062-055323
EXPIRES NOV. 30, 2021

BOND COUNTY HIGHWAY DEPARTMENT

APPROVED: *[Signature]*
BOND COUNTY, COUNTY ENGINEER

PASSED: *April 9, 2020*
[Signature]
DISTRICT EIGHT ENGINEER OF LOCAL ROADS & STREETS

RELEASING FOR BID BASED ON LIMITED REVIEW: *April 9, 2020*
[Signature]
REGION FIVE ENGINEER

**PRINTED BY THE AUTHORITY
OF THE STATE OF ILLINOIS**

ROUTE	SECTION	COUNTY	TOTAL SHEETS	SHEET NO.
CH 10	15-00088-00-RS	BOND	9	1
CONTRACT NO. 97741				

GENERAL NOTES

1. ALL CONSTRUCTION SHALL BE ACCORDING TO ILLINOIS DEPARTMENT OF TRANSPORTATION STANDARD SPECIFICATIONS FOR ROAD AND BRIDGE CONSTRUCTION, ADOPTED APRIL 1, 2016, AND THE SPECIAL PROVISIONS.
2. THE CONTRACTOR SHALL FIELD VERIFY ALL DIMENSIONS AND EXISTING CONDITIONS PRIOR TO CONSTRUCTION AND NOTIFY THE OWNER'S REPRESENTATIVE OF ANY DISCREPANCY IMMEDIATELY.
3. CURVE DATA SHOWN ON THE PLANS WAS CALCULATED FROM LIMITED EXISTING FIELD DATA AND SHOULD BE CONSIDERED APPROXIMATE.
4. THE CONTRACTOR SHALL BE RESPONSIBLE FOR LOCATING ALL UNDERGROUND UTILITIES. CONTACT J.U.L.I.E. AND ALL UTILITY COMPANIES.
5. THE EXISTING RIGHT OF WAY SHOWN HEREON HAS BEEN PROTRACTED FROM EXISTING RECORDS AND IS TO BE USED FOR REFERENCE PURPOSES ONLY. FURTHERMORE, NO COMPLETE SURVEY OF SAID R.O.W. IS IMPLIED BY THIS DRAWING.
6. ALL EARTH SURFACES DISTURBED BY THE CONTRACTOR OUTSIDE THE PROPOSED CONSTRUCTION LIMITS SHALL BE SEEDED AT THE CONTRACTOR'S EXPENSE.
7. THE CONTRACTOR SHALL MAINTAIN ADEQUATE DRAINAGE AT ALL TIMES. WATER SHALL NOT STAND OR POND. ANY DAMAGE TO STRUCTURES OR WORK ON SITE CAUSED BY INADEQUATE MAINTENANCE OF DRAINAGE PROVISIONS WILL BE THE RESPONSIBILITY OF THE CONTRACTOR. ANY COST ASSOCIATED WITH REPAIRS FOR SUCH DAMAGE WILL BE AT THE CONTRACTOR'S EXPENSE.
8. THE CONTRACTOR SHALL BE AWARE THAT NO EASEMENTS HAVE BEEN ACQUIRED FOR THESE IMPROVEMENTS AND SHALL KEEP ALL OPERATIONS CONFINED TO EXISTING R.O.W.
9. ALL CONSTRUCTION WILL BE PERFORMED UNDER TRAFFIC. THE CONTRACTOR SHALL PROVIDE ACCESS TO ALL ABUTTING PROPERTY AT ALL TIMES DURING CONSTRUCTION OF THE PROJECT.
10. NO OVERNIGHT LANE CLOSURES WILL BE PERMITTED.
11. THE ENGINEER SHALL BE THE SOLE JUDGE CONCERNING CURING TIME FOR THE VARIOUS HOT-MIX ASPHALT.

UTILITIES

<u>Name of Utility</u>	<u>Contact Name</u>	<u>Telephone Number</u>
Frontier Communications	Kalin Hinshaw	815-895-1515
AT&T Distribution	G11629@ATT.COM	
Metro Communications Co., Inc.	Jason Koonce	217-728-3605
jkoonce@metrocomm.com		
Ameren IP - (South)	Nathan Hill	618-301-5327
nhill2@ameren.com		
Village of Mulberry Grove	John Wieder	618-594-3711
City of Greenville	Brad Iberg	618-664-1644
bergbrad@yahoo.com		618-541-6037
Bluebird Network, MO Network	Jack Coles	816-237-2137
jack.coles@bluebirdnetwork.com		





COMMITMENTS

NONE AT THIS TIME.

APPLICATION RATES

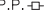
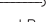
<u>PAVING</u>		
AGGREGATE		2.0 TONS/CU YD
ALL HOT-MIX ASPHALT		0.056 TONS/SQ. YD./INCH
BITUMINOUS MATERIALS (PRIME COAT)		0.05 LBS/SQ FT (HMA, PCC)
		0.25 LBS/SQ FT (AGG)
		0.025 LBS/SQ FT (FOG COAT-HMA)

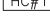
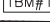
LEGEND

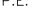
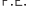
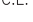
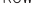
	EXISTING MAILBOX
	EXISTING POWER POLE
	EXISTING GUY WIRE
	IRON PIN
	HORIZONTAL CONTROL POINT
	VERTICAL CONTROL POINT
	PROPOSED PAVEMENT PATCH
	PRIVATE ENTRANCE
	FIELD ENTRANCE
	COMMERCIAL ENTRANCE
	RIGHT OF WAY

<u>MIXTURE USE(S)</u>	<u>BINDER COURSE</u>	<u>SURFACE COURSE</u>	<u>INCIDENTAL</u>
APPLICATION	HMA BC, IL-9.5, N50	HMA SC, IL-9.5, "C" N50	INCIDENTAL HMA SURF
AC/PG	PG 64-22	PG 64-22	PG 64-22
RAP % (MAX.)	SEE SPECIFICATIONS	SEE SPECIFICATIONS	SEE SPECIFICATIONS
DESIGN AIR VOIDS	4.0% @ Ndes=50	4.0% @ Ndes=50	4.0% @ Ndes=50
MIX COMPOSITION (GRADATION MIXTURE)	IL-9.5	IL-9.5	IL-9.5
FRICTION AGG	MIXTURE "C"	MIXTURE "C"	MIXTURE "C"
MIXTURE WEIGHT	112 LBS/SQ. YD./IN.	112 LBS/SQ. YD./IN.	112 LBS/SQ. YD./IN.

DESIGNED - MSF	REVISED -
DRAWN - JMW	REVISED -
CHECKED - BLT	REVISED -
DATE - 04/02/2020	REVISED -

ROUTE	SECTION	COUNTY	TOTAL SHEETS	SHEET NO.
FAS 782	15-00088-00-RS	BOND	9	2
FEDERAL AID PROJECT		CONTRACT NO. 97741		
ILLINOIS				

SUMMARY OF QUANTITIES				
SP	CODE NUMBER	ITEM	UNIT	TOTAL QUANTITY
	40800290	BITUMINOUS MATERIALS (TACK COAT)	POUND	11,060
	40800982	HOT-MIX ASPHALT SURFACE REMOVAL- BUTT JOINT	SQ YD	745
	40800985	PORTLAND CEMENT CONCRETE SURFACE REMOVAL- BUTT JOINT	SQ YD	725
	40800990	TEMPORARY RAMP	SQ YD	380
	40802978	HOT-MIX ASPHALT BINDER COURSE, IL- 9.5, N50	TON	1,376
	40804050	HOT-MIX ASPHALT SURFACE COURSE, IL-9.5, MIX "C", N50	TON	1,376
	40800025	BITUMINOUS MATERIALS (PRIME COAT)	POUND	202
	40800029	BITUMINOUS MATERIALS (TACK COAT)	POUND	2,010
	40800050	INCIDENTAL HOT-MIX ASPHALT SURFACING	TON	116
	44200050	WELDED WIRE REINFORCEMENT	SQ YD	372
	44200934	CLASS B PATCHES, TYPE II, 8 INCH	SQ YD	595
	44200942	CLASS B PATCHES, TYPE III, 8 INCH	SQ YD	64
	44200944	CLASS B PATCHES, TYPE IV, 8 INCH	SQ YD	82
	44201000	CLASS B PATCHES, TYPE IV, 12 INCH	SQ YD	225
	44201329	CLASS C PATCHES, TYPE II, 8 INCH	SQ YD	11
	44201335	CLASS C PATCHES, TYPE IV, 8 INCH	SQ YD	40
	44201287	DOWEL BARS 1"	EACH	1,482
	44201299	DOWEL BARS 1 1/2"	EACH	28
	44213200	SAW CUTS	FOOT	4,442
	44213204	TIE BARS 3/4"	EACH	151
	* 48102100	AGGREGATE WEDGE SHOULDER, TYPE B	TON	250
	67100100	MOBILIZATION	LSUM	1
	70300100	SHORT TERM PAVEMENT MARKINGS	FOOT	467
	70300150	SHORT TERM PAVEMENT MARKING REMOVAL	SQ FT	96
Δ	78000100	THERMOPLASTIC PAVEMENT MARKING - LETTERS AND SYMBOLS	SQ FT	24
Δ	78000200	THERMOPLASTIC PAVEMENT MARKING LINE - 4"	FOOT	21,222
Δ	78000650	THERMOPLASTIC PAVEMENT MARKING LINE - 24"	FOOT	32
	* X7010216	TRAFFIC CONTROL AND PROTECTION (SPECIAL)	LSUM	1
	* 29033700	LONGITUDINAL JOINT SEALANT	FOOT	6,360

Δ SPECIALTY ITEMS

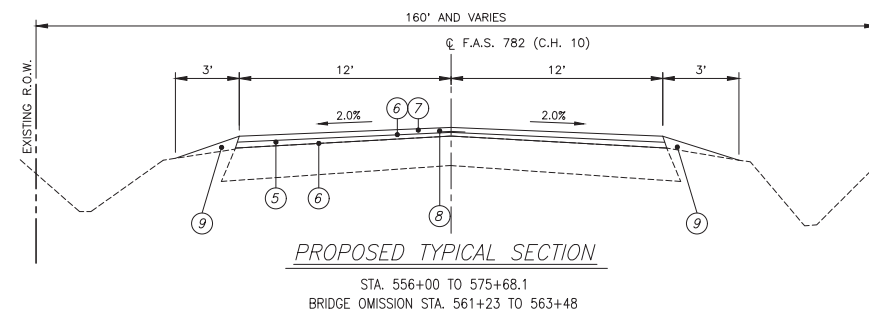
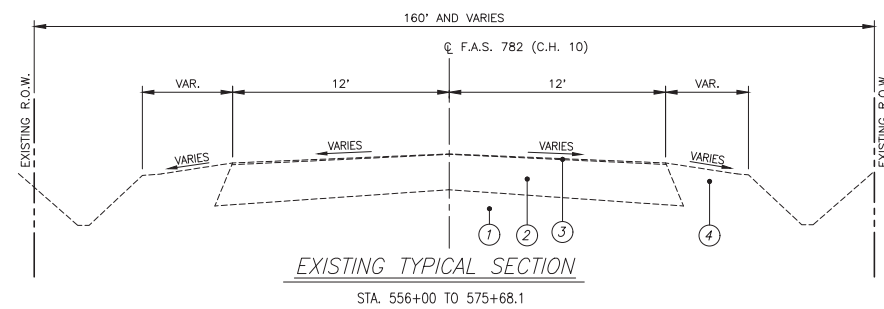
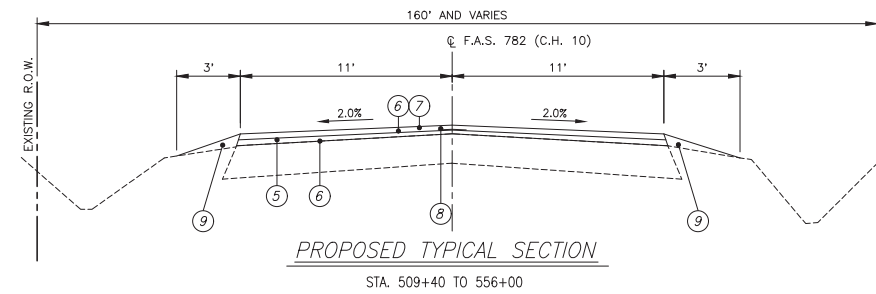
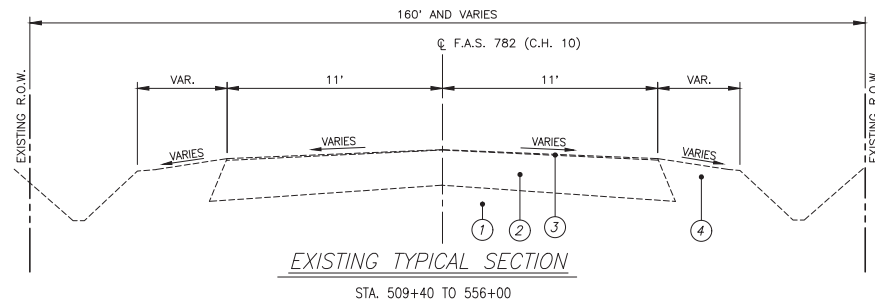

- LEGEND**
- ① EXISTING SUBGRADE
 - ② EXISTING CONCRETE PAVEMENT ±7.75"
 - ③ EXISTING CAPE SEAL SURFACE, ±0.25"
 - ④ EXISTING AGGREGATE/EARTH SHOULDER
 - ⑤ PROPOSED HMA BINDER COURSE, IL-9.5, N50, 1.5"
 - ⑥ PROPOSED BITUMINOUS MATERIALS (TACK COAT)
 - ⑦ PROPOSED HMA SURFACE COURSE, IL-9.5, MIX "C", N50, 1.5"
 - ⑧ PROPOSED LONGITUDINAL JOINT SEALANT
 - ⑨ PROPOSED AGGREGATE WEDGE SHOULDER, TYPE B

DESIGNED - MSF	REVISED -
DRAWN - JMW	REVISED -
CHECKED - BLT	REVISED -
DATE - 04/02/2020	REVISED -

ROUTE	SECTION	COUNTY	TOTAL SHEETS	SHEET NO.
FAS 782	15-00088-00-RS	BOND	9	4
FEDERAL AID PROJECT		CONTRACT NO. 97741		
ILLINOIS				

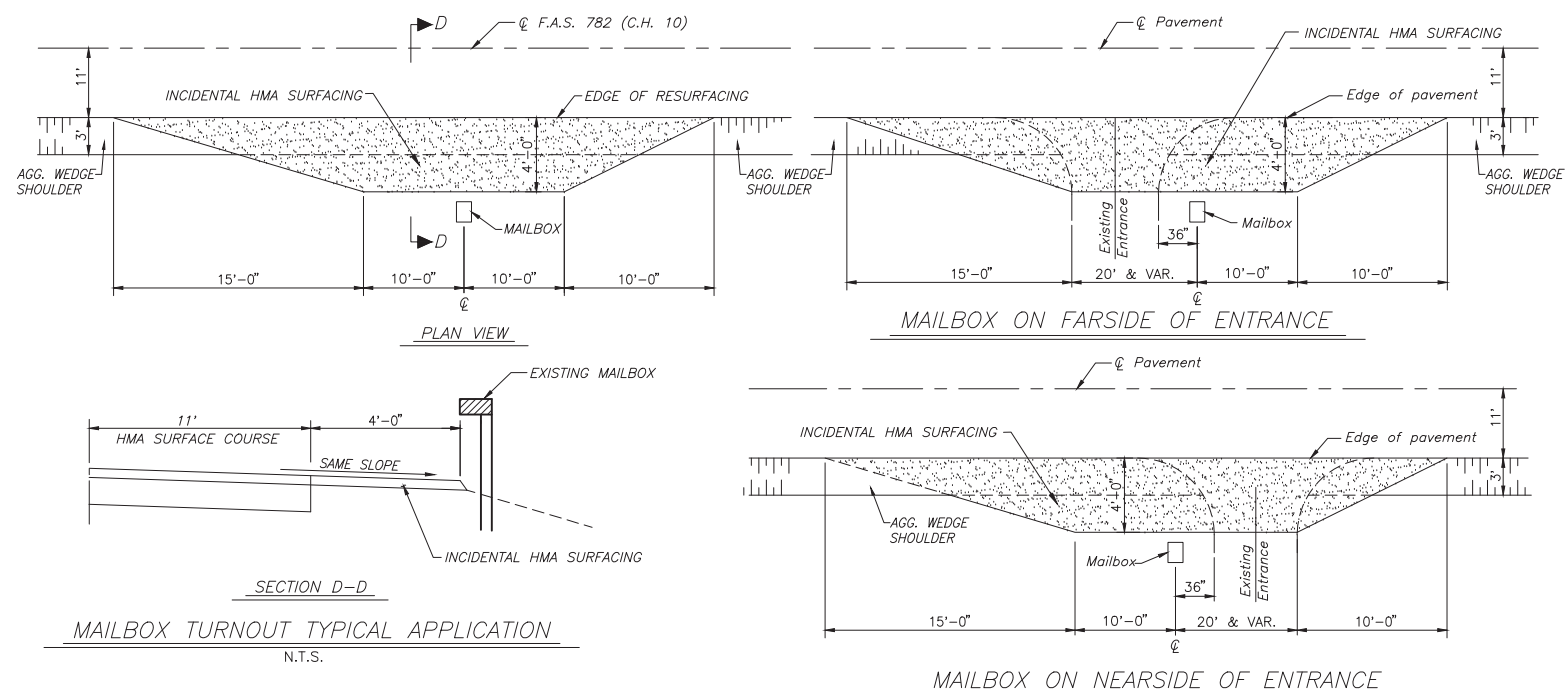
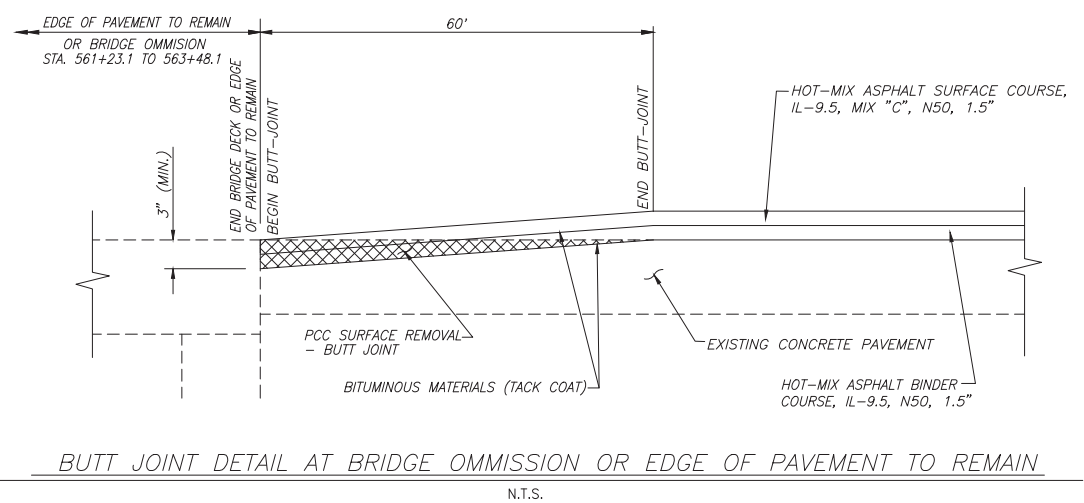
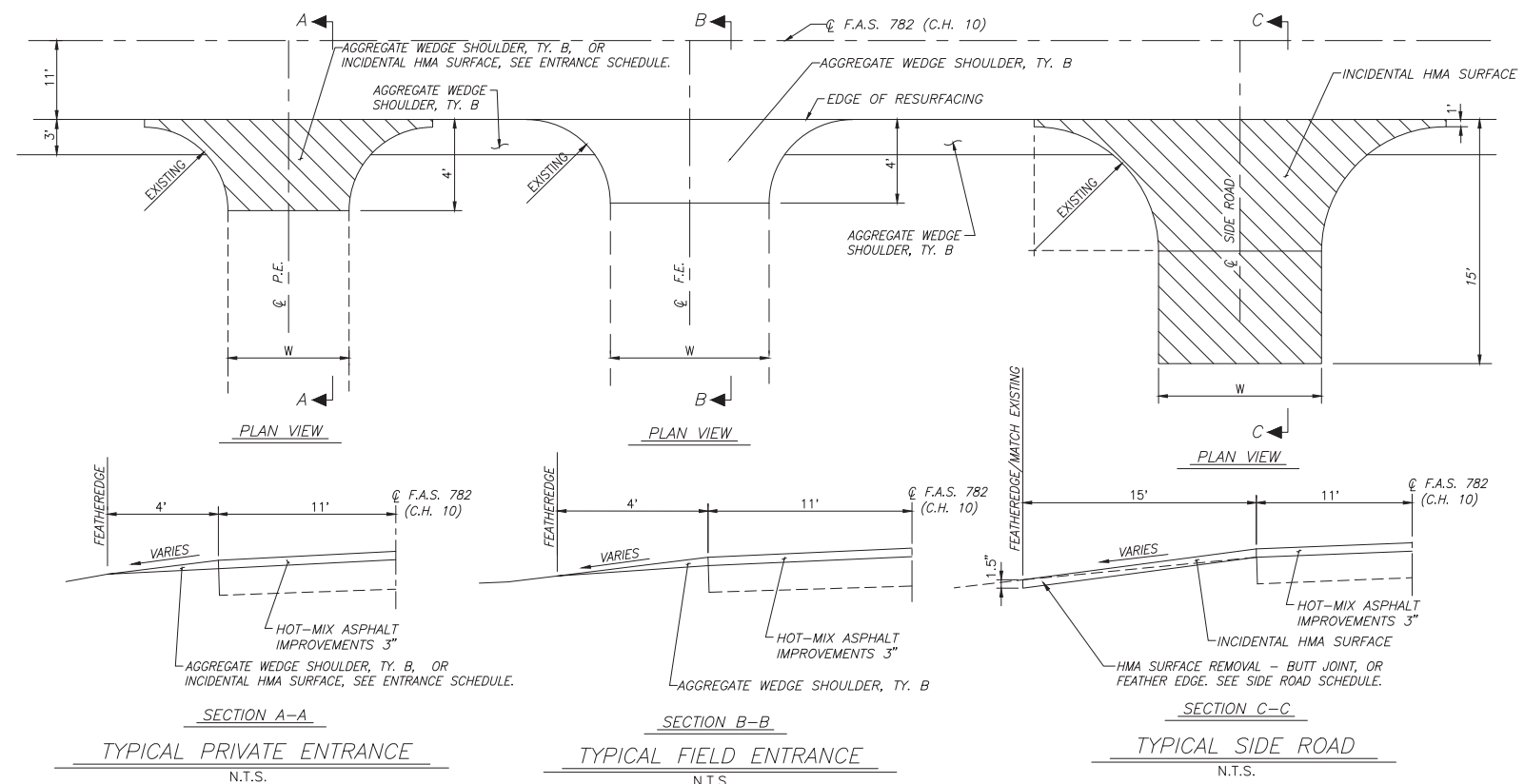

DESIGNED - MSF	REVISED -
DRAWN - JMW	REVISED -
CHECKED - BLT	REVISED -
DATE - 04/02/2020	REVISED -

ROUTE	SECTION	COUNTY	TOTAL SHEETS	SHEET NO.
FAS 782	15-00088-00-RS	BOND	9	5
FEDERAL AID PROJECT		CONTRACT NO. 97741		
ILLINOIS				

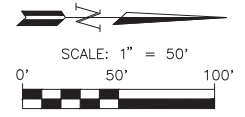
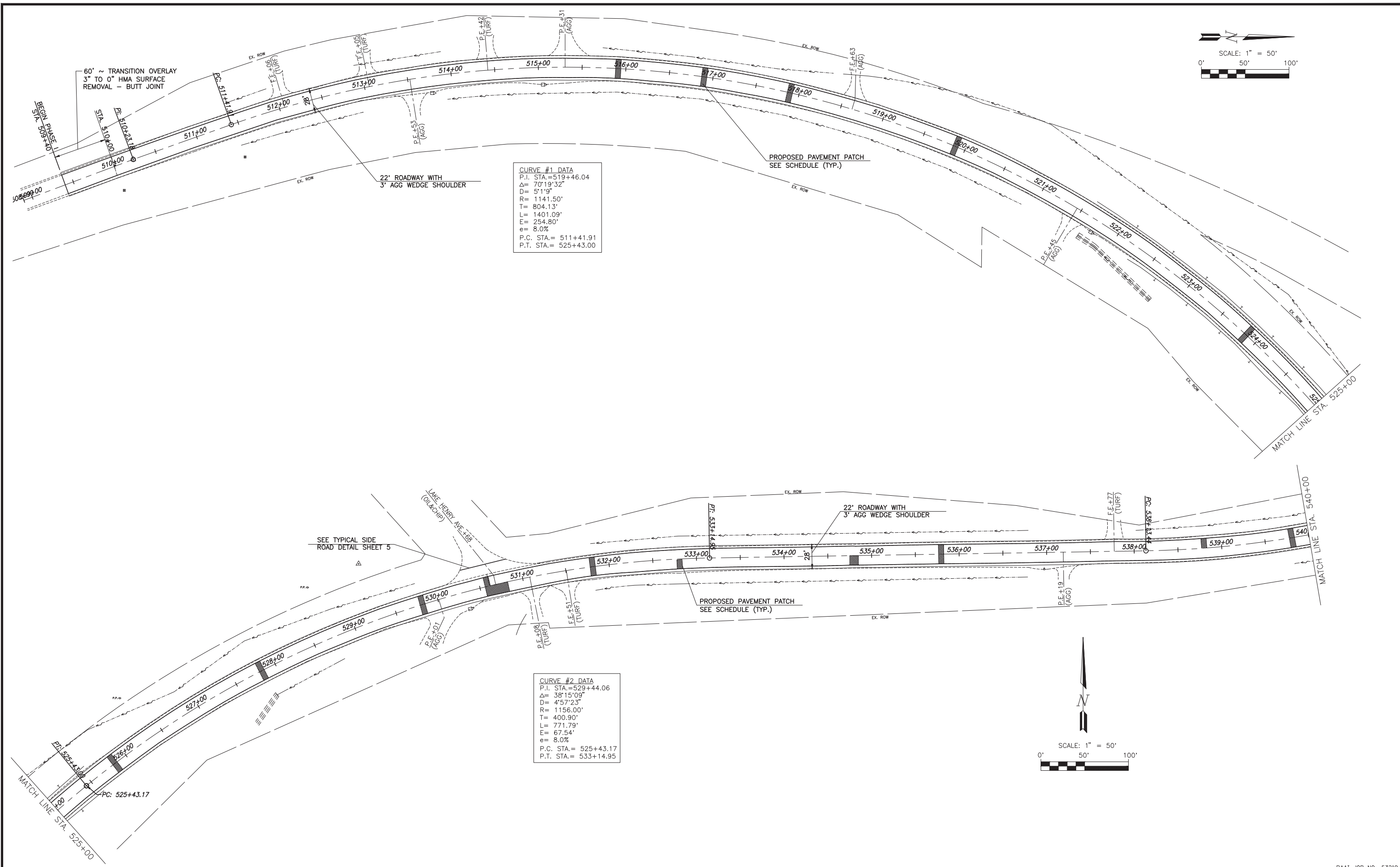

CURVE #1 DATA
 P.I. STA.=519+46.04
 $\Delta=70^{\circ}19'32''$
 $D=51'9''$
 $R=1141.50'$
 $T=804.13'$
 $L=1401.09'$
 $E=254.80'$
 $e=8.0\%$
 P.C. STA.= 511+41.91
 P.T. STA.= 525+43.00

CURVE #2 DATA
 P.I. STA.=529+44.06
 $\Delta=38^{\circ}15'09''$
 $D=457^{\circ}23''$
 $R=1156.00'$
 $T=400.90'$
 $L=771.79'$
 $E=67.54'$
 $e=8.0\%$
 P.C. STA.= 525+43.17
 P.T. STA.= 533+14.95

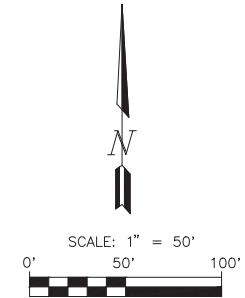

DESIGNED - MSF	REVISED -
DRAWN - JMW	REVISED -
CHECKED - BLT	REVISED -
DATE - 04/02/2020	REVISED -

ROUTE	SECTION	COUNTY	TOTAL SHEETS	SHEET NO.
FAS 782	15-00088-00-RS	BOND	9	7
FEDERAL AID PROJECT		CONTRACT NO. 97741		
ILLINOIS				

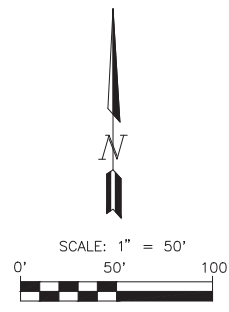

CURVE #3 DATA
 P.I. STA.=549+46.37
 Δ = 89°19'27"
 D= 4'59.53"
 R= 1146.367'
 T= 1132.922'
 L= 1787.185'
 E= 465.362'
 e= 8.0%
 P.C. STA.= 538+13.44
 P.T. STA.= 556+00.63

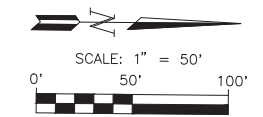
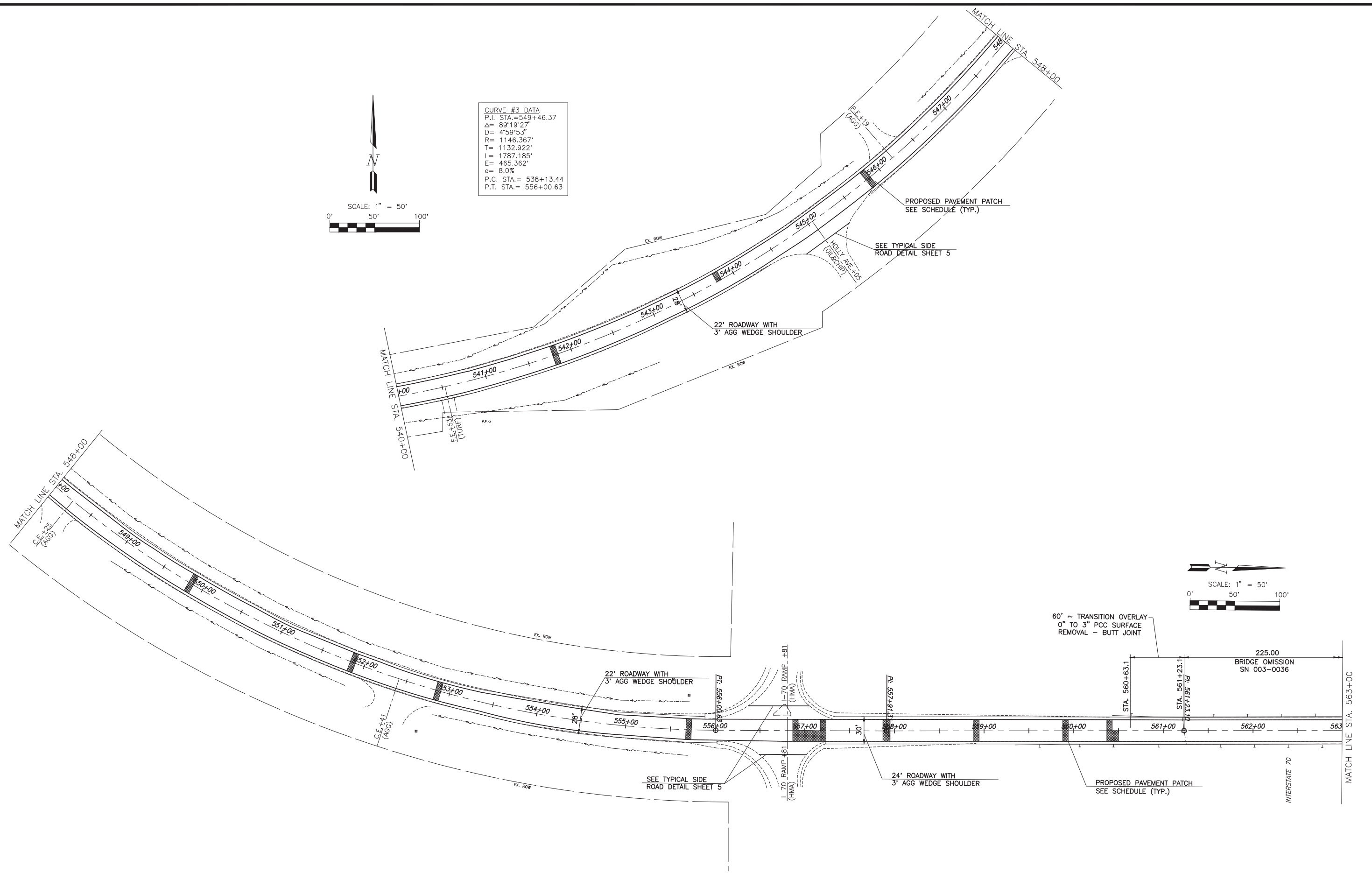

RHUTASEL and ASSOCIATES, INC.
 CONSULTING ENGINEERS • LAND SURVEYORS
 SALEM, ILLINOIS FREEBURG, ILLINOIS
 618-532-1992 618-538-3178
 ILLINOIS DESIGN FIRM LICENSE NO. 184-000287

DESIGNED - MSF	REVISED -
DRAWN - JMW	REVISED -
CHECKED - BLT	REVISED -
DATE - 04/02/2020	REVISED -

**STATE OF ILLINOIS
 DEPARTMENT OF TRANSPORTATION**

IMPROVEMENT PLANS
 STA. 540+00 TO 563+00

ROUTE	SECTION	COUNTY	TOTAL SHEETS	SHEET NO.
FAS 782	15-00088-00-RS	BOND	9	8
FEDERAL AID PROJECT		CONTRACT NO. 97741		
ILLINOIS				

RAAI JOB NO. 53219

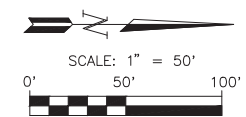
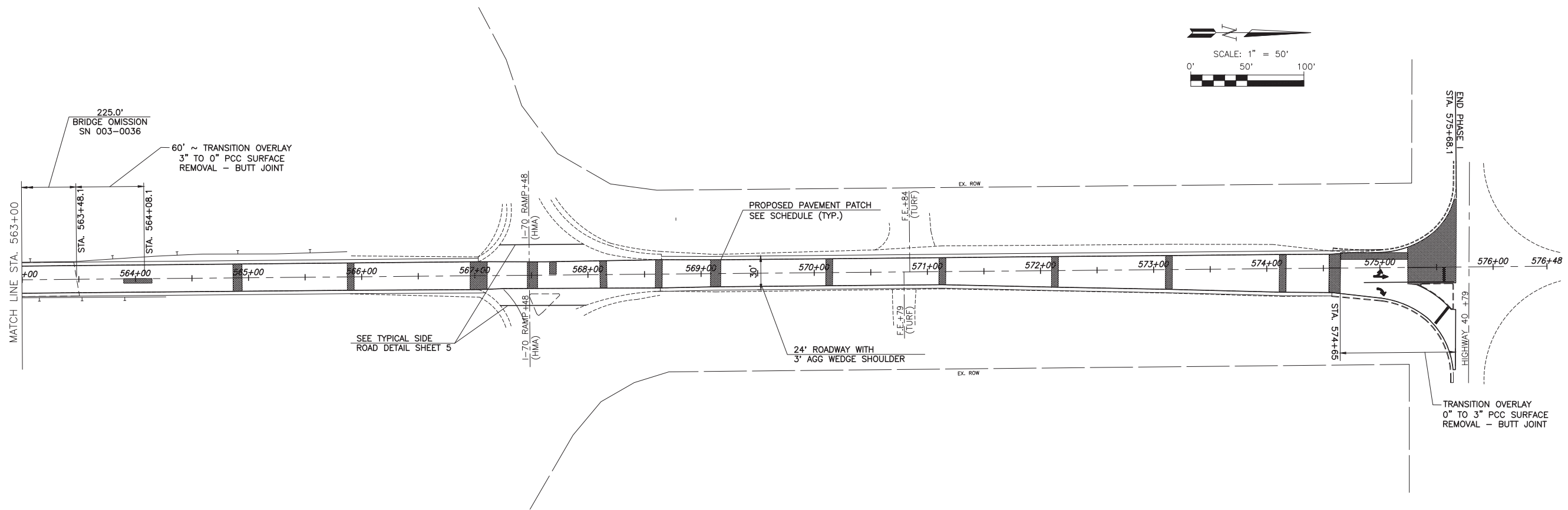

RHUTASEL and ASSOCIATES, INC.
 CONSULTING ENGINEERS • LAND SURVEYORS
 SALEM, ILLINOIS FREEBURG, ILLINOIS
 618-532-1992 618-539-3178
 ILLINOIS DESIGN FIRM LICENSE NO. 184-000287

DESIGNED - MSF	REVISED -
DRAWN - JMW	REVISED -
CHECKED - BLT	REVISED -
DATE - 04/02/2020	REVISED -

**STATE OF ILLINOIS
 DEPARTMENT OF TRANSPORTATION**

IMPROVEMENT PLANS
 STA. 563+00 TO 575+68.1

ROUTE	SECTION	COUNTY	TOTAL SHEETS	SHEET NO.
FAS 782	15-00088-00-RS	BOND	9	9
FEDERAL AID PROJECT		CONTRACT NO. 97741		
ILLINOIS				

RAAI JOB NO. 53219