

NOTES:

- ANY CONFLICTING PAVEMENT MARKING SHALL BE REMOVED.
- TRAFFIC CONTROL & PROTECTION FOR THE PROP. S.B. AND N.B. IL RTE 59 RAMP SHALL BE IN ACCORDANCE WITH STANDARD 701006.

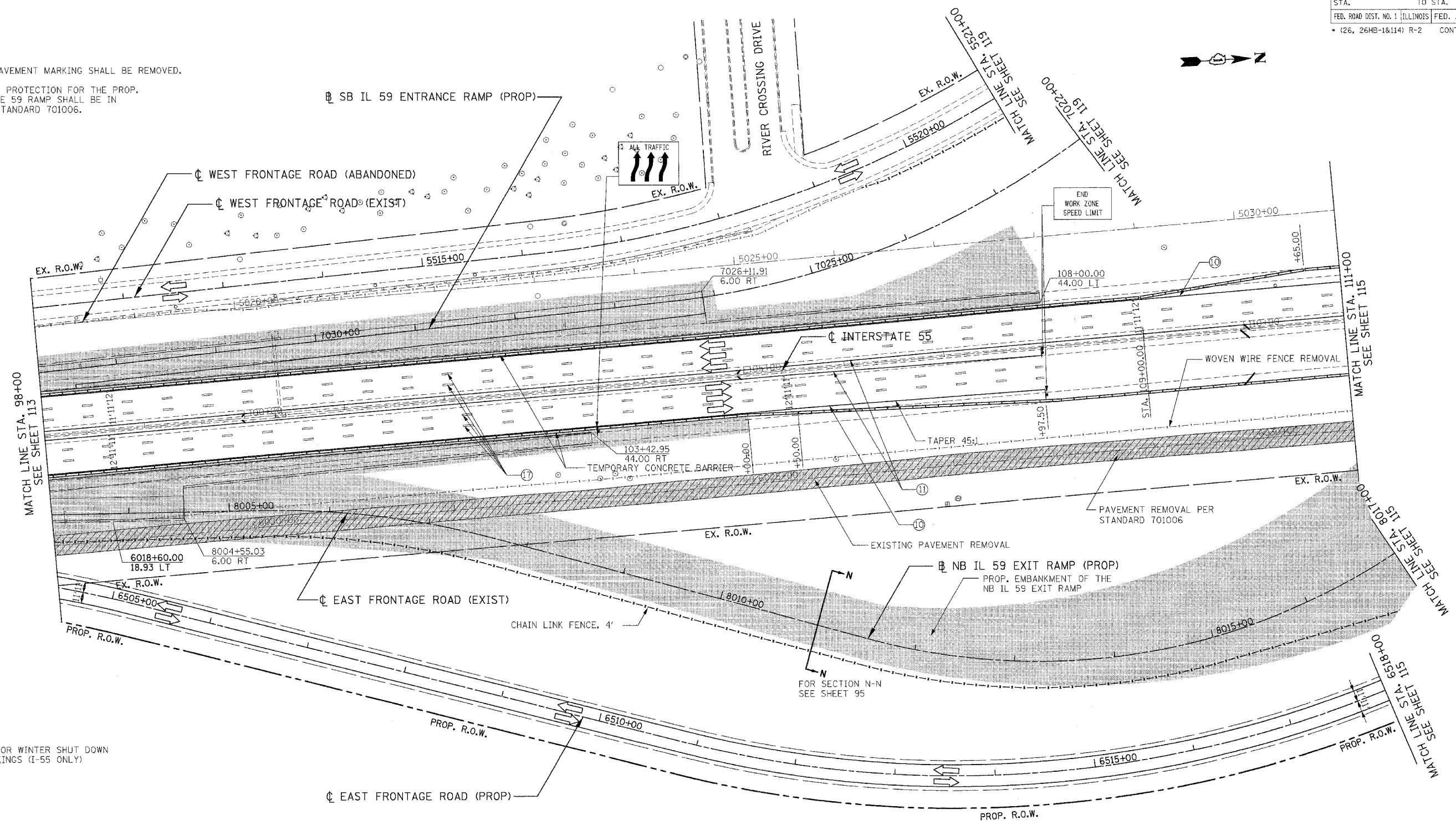

NOTE:

- SEE STAGE 2 FOR WINTER SHUT DOWN PAVEMENT MARKINGS (I-55 ONLY)

LEGEND

- WORK ZONE
- TEMPORARY PAVEMENT
- TEMP. PVMT - PREVIOUS STAGE
- CLASS D PATCHES (TYPE AND THICKNESS SPECIFIED AT EACH PATCH LOCATION)
- PAVEMENT REMOVAL
- PAVED SHOULDER REMOVAL (INCL. GORES)
- TRAFFIC FLOW
- ARROW BOARD
- VERTICAL PANELS
- BARRICADE, TYPE III
- PROP. TRAFFIC SIGN
- BARRICADES, TYPE II W/ FLASHING LIGHTS
- PLASTIC TYPE II BARRICADES OR DRUMS W/ STEADY BURN LIGHT
- TEMPORARY CONCRETE BARRIER

LEGEND

- ① EPOXY PAVEMENT MARKING - LINE 4" (WHITE)
- ② TEMPORARY PAVEMENT MARKING - 4" (WHITE)
- ③ TEMPORARY PAVEMENT MARKING - 4" (YELLOW)
- ④ EPOXY PAVEMENT MARKING - LINE 4" (YELLOW)
- ⑤ TEMPORARY PAVEMENT MARKING - 8" (WHITE)
- ⑥ TEMPORARY PAVEMENT MARKING - 12" (WHITE)
- ⑦ EPOXY PAVEMENT MARKING - LINE 5" (WHITE) 10' DASH-30' SKIP
- ⑧ TEMPORARY PAVEMENT MARKING - 24" (WHITE)
- ⑨ PAVEMENT MARKING TAPE, TYPE III - LETTERS AND SYMBOLS
- ⑩ PAVEMENT MARKING TAPE, TYPE III - 4" (WHITE)
- ⑪ PAVEMENT MARKING TAPE, TYPE III - 4" (YELLOW)
- ⑫ PAVEMENT MARKING TAPE, TYPE III - 6" (WHITE)
- ⑬ PAVEMENT MARKING TAPE, TYPE III - 8" (WHITE)
- ⑭ PAVEMENT MARKING TAPE, TYPE III - 12" (WHITE)
- ⑮ PAVEMENT MARKING TAPE, TYPE III - 12" (YELLOW)
- ⑯ PAVEMENT MARKING TAPE, TYPE III - 24" (WHITE)
- ⑰ PAVEMENT MARKING TAPE, TYPE III - 5" (WHITE), 10' DASH-30' SKIP

MOT27 REVISIONS	
NAME	DATE

ILLINOIS DEPARTMENT OF TRANSPORTATION
 FAI 55 AT FAP 338 ILLINOIS ROUTE 59
 SECTION: (26, 26HB-1&114) R-2
MAINTENANCE OF TRAFFIC
STAGE 1
 STA. 98+00 TO STA. 111+00
 SCALE: 1" = 50'
 DATE: 03/14/08
 DRAWN BY: JB
 CHECKED BY: ACL
TENG
TENG & ASSOCIATES, INC.
 ENGINEERING ARCHITECTS PLANNERS
 315 N. MICHIGAN AVE. CHICAGO, IL 60611
 TELEPHONE: 312.467.2000