

CONTRACT# 60363				
F.A. RTE.	SECTION	COUNTY	TOTAL SHEETS	SHEET NO.
			608	323
STA.		TO STA.		
FED. ROAD DIST. NO.		ILLINOIS FED. AID PROJECT		
# 26HB-1BR & 114R-1				

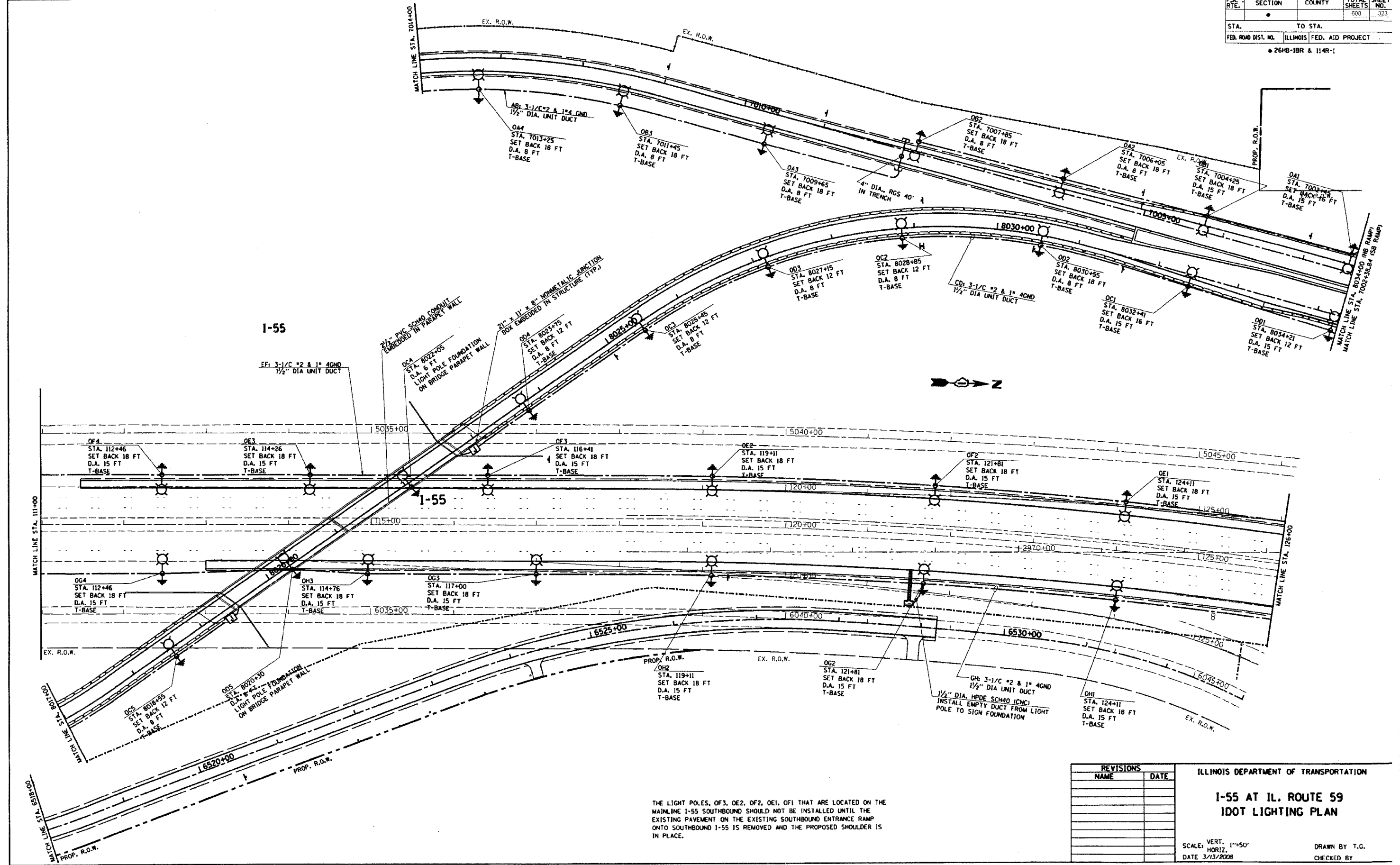

THE LIGHT POLES, OF3, OE2, OF2, OE1, OF1 THAT ARE LOCATED ON THE MAINLINE I-55 SOUTHBOUND SHOULD NOT BE INSTALLED UNTIL THE EXISTING PAVEMENT ON THE EXISTING SOUTHBOUND ENTRANCE RAMP ONTO SOUTHBOUND I-55 IS REMOVED AND THE PROPOSED SHOULDER IS IN PLACE.

REVISIONS	
NAME	DATE

ILLINOIS DEPARTMENT OF TRANSPORTATION

I-55 AT IL. ROUTE 59 IDOT LIGHTING PLAN

SCALE: VERT. 1"=50'
HORIZ. DATE 3/13/2008

DRAWN BY T.G.
CHECKED BY

3/13/2008
c:\projects\126397\sh_lighting.dgn
bauer.d