

F.A.I. R.T.E.	SECTION	COUNTY	TOTAL SHEETS	SHEET NO.
59		WILL	608	327
STA.		TO STA.		
FED. ROAD DIST. NO. 1		ILLINOIS	FED. AID PROJECT	
• 26HB-IBR AND 114R-1				
CONTRACT NO. 60363				

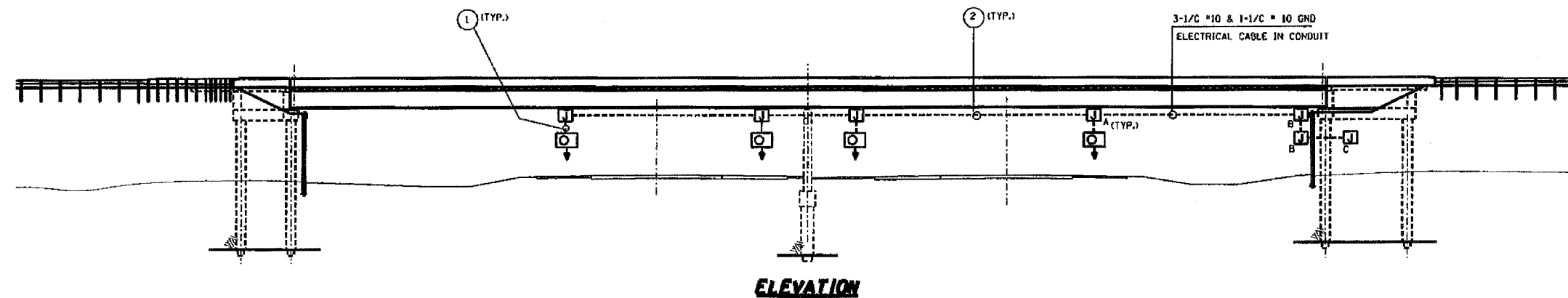

- UNDERPASS LUMINAIRE, 70 WATT, HPS, TYPE III, 240 VOLT, PENDANT MOUNTED
- 3-1/2" x 1-1/2" x 10 GND ELECTRICAL CABLE IN CONDUIT
- JUNCTION BOX, STAINLESS STEEL, ATTACHED TO STRUCTURE, 6" x 6" x 4"
- JUNCTION BOX, STAINLESS STEEL, ATTACHED TO STRUCTURE, 12" x 10" x 6"
- JUNCTION BOX, STAINLESS STEEL ATTACHED TO STRUCTURE, 16" x 14" x 6"
- 3/4" DIA. LIQUID TIGHT FLEXIBLE PVC COATED METALLIC CONDUIT
- 1" DIA. PVC COATED RIGID STEEL CONDUIT ATTACHED TO STRUCTURE

NOTES

UNDERPASS LUMINAIRES SHALL SETBACK 2 FT FROM EDGE OF TRAVELED PAVEMENT AND POSITIONED MIDPOINT BETWEEN GIRDERS 3 AND 4.

ORIENTATION OF LUMINAIRES SHALL BE PERPENDICULAR TO I-55, AS SHOWN ON THIS SHEET.

CD: 3-1/2" #2 & 1" #4 GND.
1/2" UNIT DUCT IN TRENCH

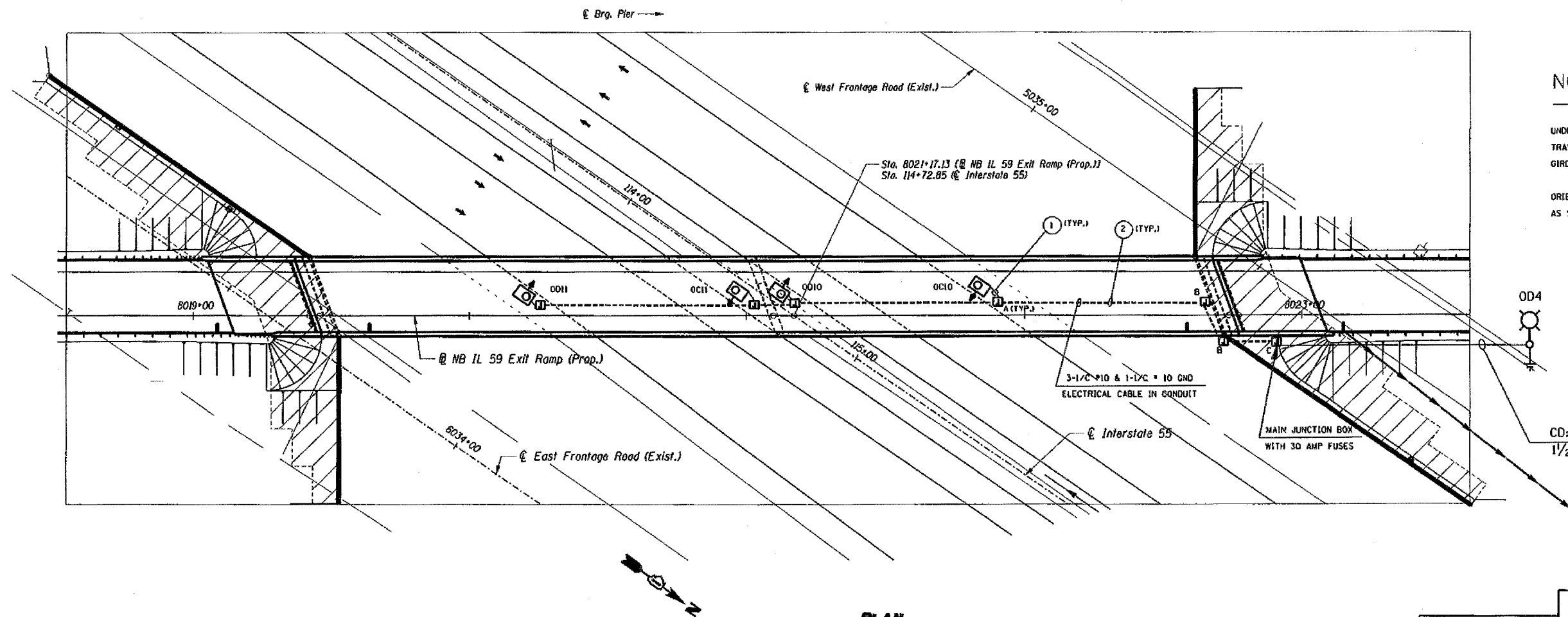

PLAN
NB IL 59 EXIT RAMP OVER I-55
UNDERPASS LIGHTING

REVISIONS	
NAME	DATE

ILLINOIS DEPARTMENT OF TRANSPORTATION

NB IL 59 EXIT RAMP OVER I-55
PROPOSED UNDERPASS LIGHTING
IDDT

DATE: 2/11/2008

DRAWN BY: TG
CHECKED BY:

2/11/2008
a:\projects\26357\electrical\wdp\grad\linc