

REVISIONS	DATE	BY

DATE	BY	REVISIONS

NO.	DATE	BY	REVISIONS

NO.	DATE	BY	REVISIONS

NO.	DATE	BY	REVISIONS

F.A.I. RTE.	SECTION	COUNTY	TOTAL SHEETS	SHEET NO.
55	•	WILL	608	591

STA. TO STA.  
FED. ROAD DIST. NO. 1 ILLINOIS FED. AID PROJECT  
• (26HB-18.114) R-2

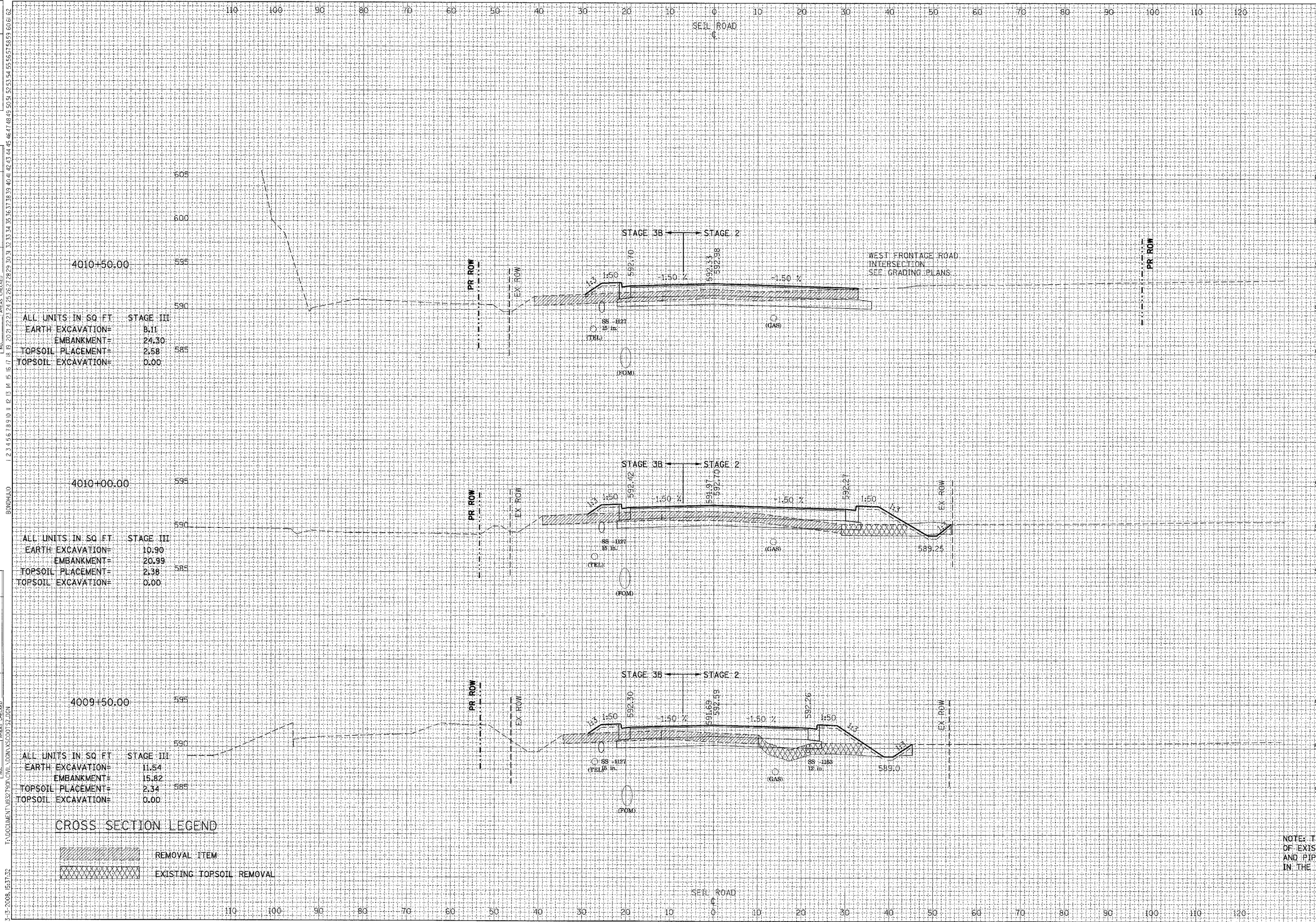

4010+50.00

ALL UNITS IN SQ FT	STAGE III
EARTH EXCAVATION=	8.11
EMBANKMENT=	24.30
TOPSOIL PLACEMENT=	2.58
TOPSOIL EXCAVATION=	0.00

4010+50.00

ALL UNITS IN SQ FT	STAGE II
EARTH EXCAVATION=	33.28
EMBANKMENT=	0.00
TOPSOIL PLACEMENT=	0.00
TOPSOIL EXCAVATION=	0.00

4010+00.00

ALL UNITS IN SQ FT	STAGE III
EARTH EXCAVATION=	10.90
EMBANKMENT=	20.99
TOPSOIL PLACEMENT=	2.38
TOPSOIL EXCAVATION=	0.00

4010+00.00

ALL UNITS IN SQ FT	STAGE II
EARTH EXCAVATION=	14.19
EMBANKMENT=	33.31
TOPSOIL PLACEMENT=	7.08
TOPSOIL EXCAVATION=	32.83

4009+50.00

ALL UNITS IN SQ FT	STAGE III
EARTH EXCAVATION=	11.54
EMBANKMENT=	15.82
TOPSOIL PLACEMENT=	2.34
TOPSOIL EXCAVATION=	0.00

4009+50.00

ALL UNITS IN SQ FT	STAGE II
EARTH EXCAVATION=	8.82
EMBANKMENT=	39.56
TOPSOIL PLACEMENT=	7.09
TOPSOIL EXCAVATION=	44.87

CROSS SECTION LEGEND

	REMOVAL ITEM
	EXISTING TOPSOIL REMOVAL

NOTE: THE EXACT LOCATION AND ELEVATION OF EXISTING STRUCTURES, UTILITIES, AND PIPING SHALL BE VERIFIED IN THE FIELD BY THE CONTRACTOR.