

F.A.I. RTE.	SECTION	COUNTY	TOTAL SHEETS	SHEET NO.
90/94	2005-066 LS	COOK	77	66
STA. 4533+00	TO STA. 4542+00			
FED. ROAD DIST. NO. 1	ILLINOIS	FED. AID PROJECT		

60A72

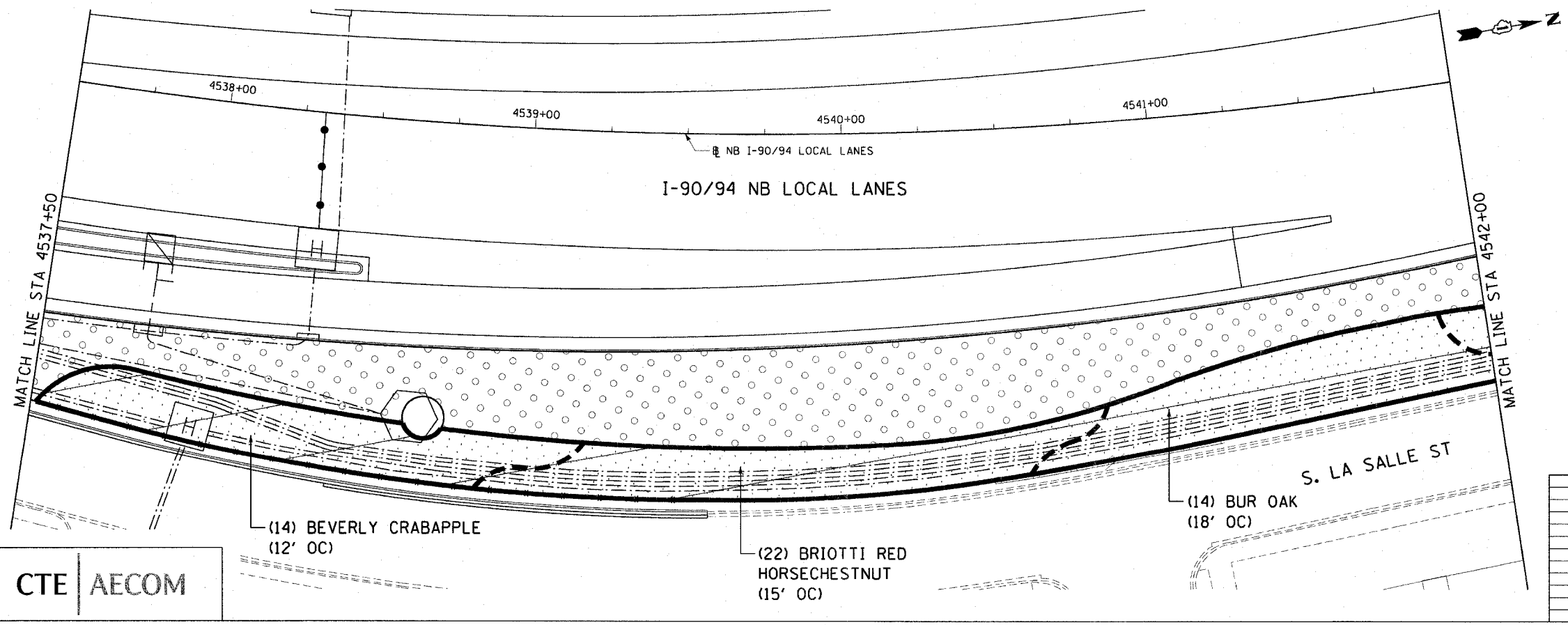
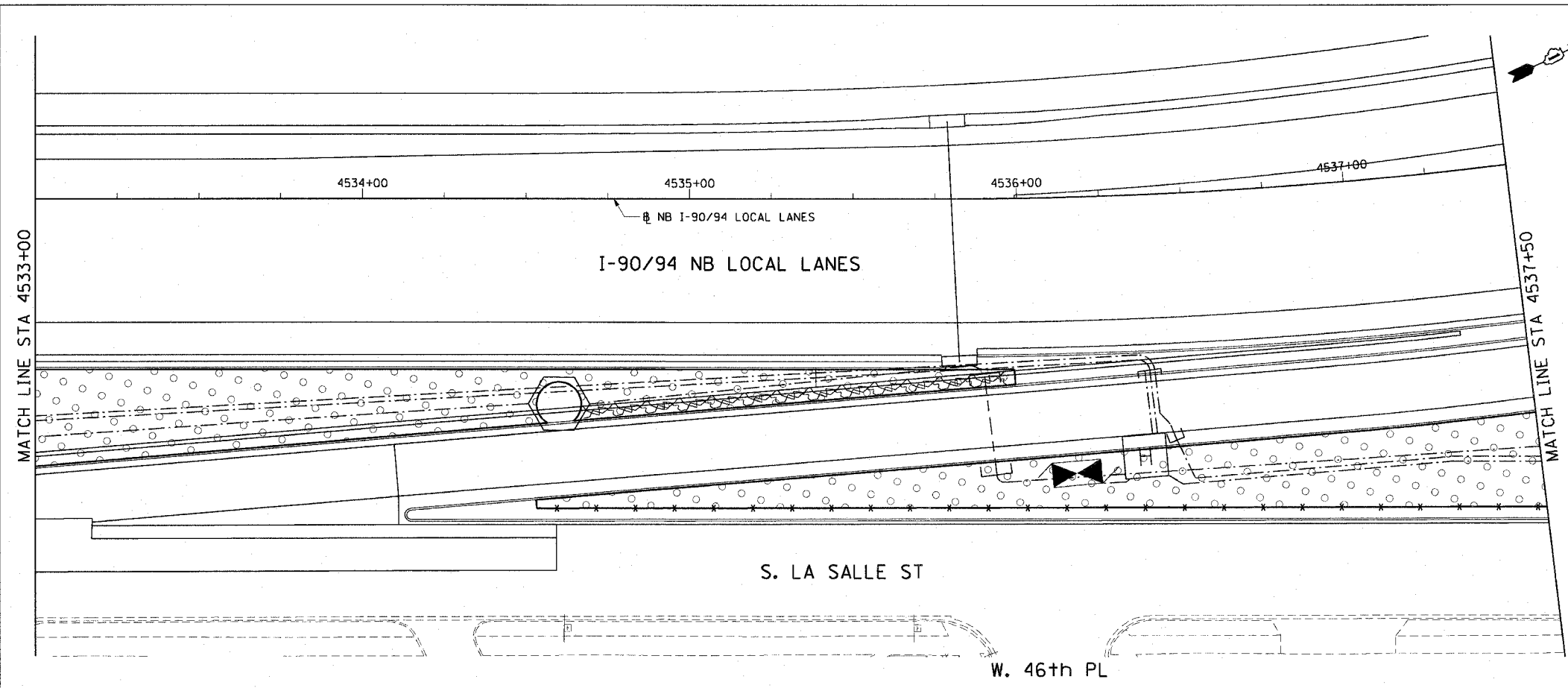

CTE | AECOM

(14) BEVERLY CRABAPPLE
(12' OC)

(22) BRIOTTI RED HORSECHESTNUT
(15' OC)

(14) BUR OAK
(18' OC)

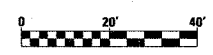

SHT-57 of 67

REVISIONS	
NAME	DATE

ILLINOIS DEPARTMENT OF TRANSPORTATION
F.A.I. 90/94 (DAN RYAN EXPRESSWAY)
NB ROADSIDE EMBANKMENT LANDSCAPE

PROPOSED IMPROVEMENT
I-57 INTERCHANGE TO 31ST STREET

SCALE: 1"=20'
DATE: JUNE 2008
DRAWN BY: LAM
CHECKED BY: RMG

P:\040468.dwg\130-roadside embankment\STA 220 10\90220057_20a.dwg 6/19/2008 6:57:55 PM