

F.A.I.	SECTION	COUNTY	TOTAL SHEETS	SHEET NO.
94/90	2005-086 I	COOK	228	10
STA.		TO STA.		
FED. ROAD DIST. NO.	ILLINOIS	FED. AID PROJECT		
60B07				

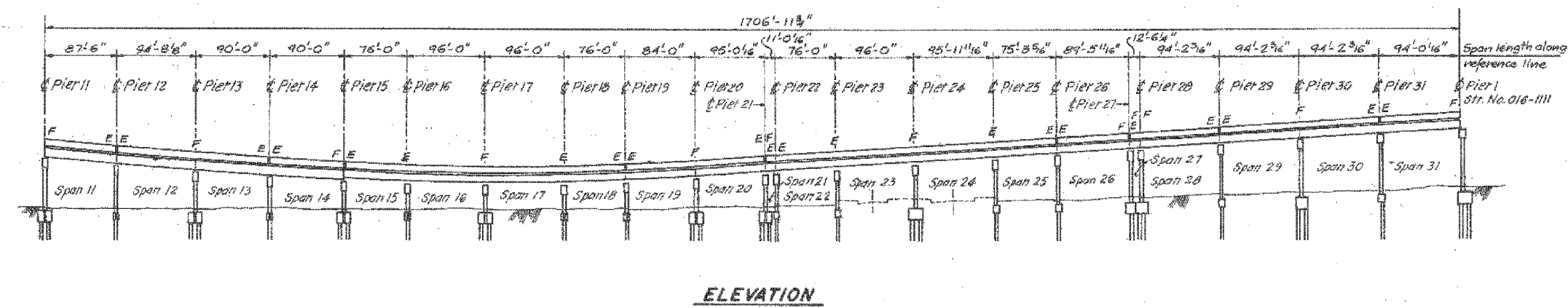

**ELEVATION**

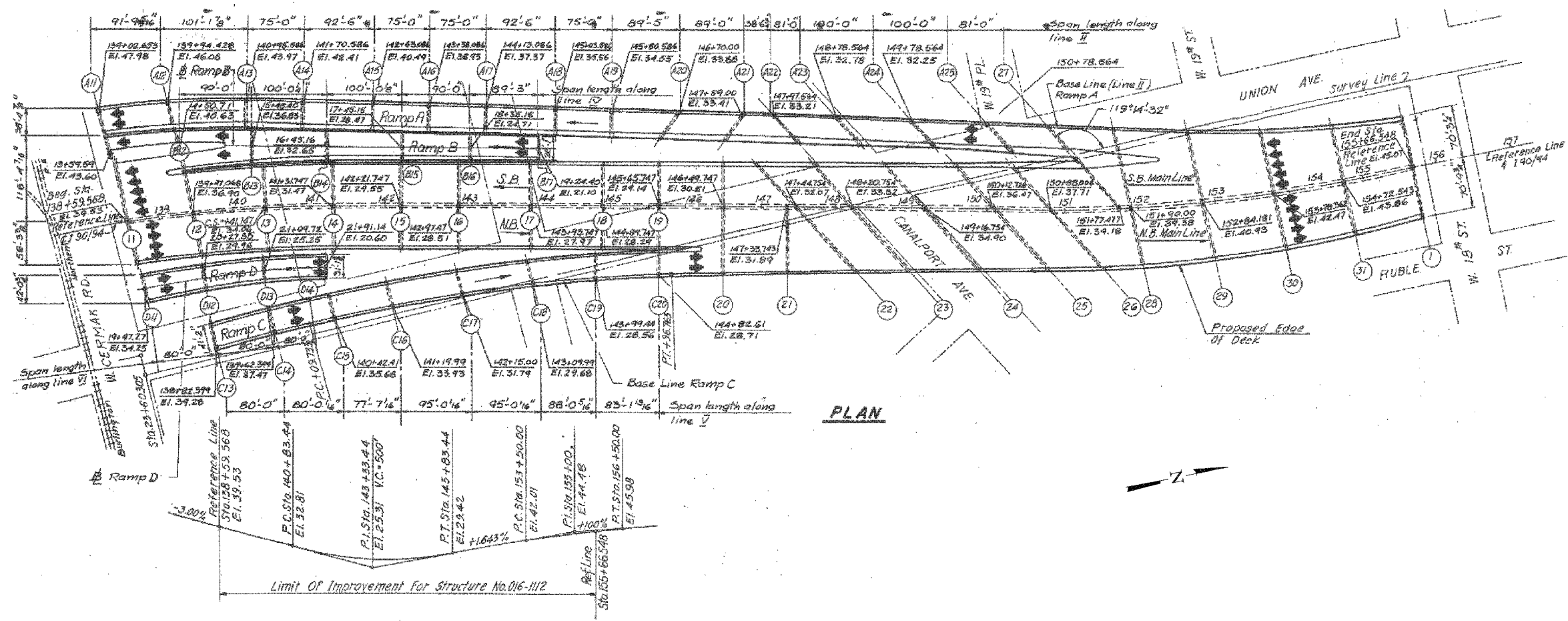

**PLAN**

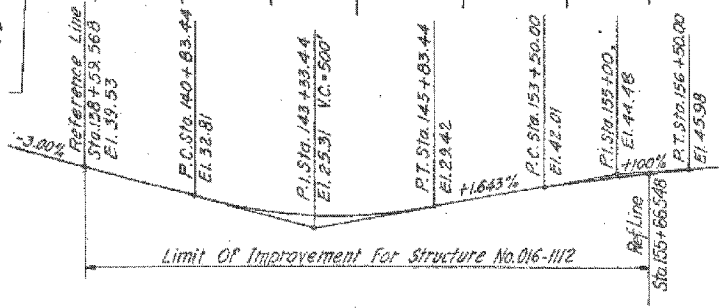

**PROFILE GRADE**

REVISIONS		NAME	DATE
NO.	DESCRIPTION		

ILLINOIS DEPARTMENT OF TRANSPORTATION  
 F.A.I. 94/90 (DAN RYAN EXPRESSWAY)  
 DAN RYAN ELEVATED BRIDGE  
 BEARING REPLACEMENT & STEEL REPAIR  
 GENERAL PLAN AND ELEVATION  
 SN 016-1112

SCALE: NTS  
 DATE: 5/18/2007

DRAWN BY: LAM  
 CHECKED BY: BLU

BOWMAN, BARRETT & ASSOCIATES INC.  
 CONSULTING ENGINEERS  
 Chicago, Illinois  
 312.228.0100  
 www.bbainc.com

Note:  
 This sheet created from original 1988-89 reconstruction as-builts. These are provided for general reference to structure number, span lengths, etc. Work Items for this contract are identified on the partial framing plans and detail sheets that follow.

5/24/2007 5:33 PM  
 W:\650\COOK\BRIDGE\2\ASHEETS\60B07.DWG(11/2-6/2007)