

F.A.I.	SECTION	COUNTY	TOTAL SHEETS	SHEET NO.
84/90	2005-086 I	COOK	228	16
STA.		TO STA.		
FED. ROAD DIST. NO.	ILLINOIS	FED. AID PROJECT		
60B07				

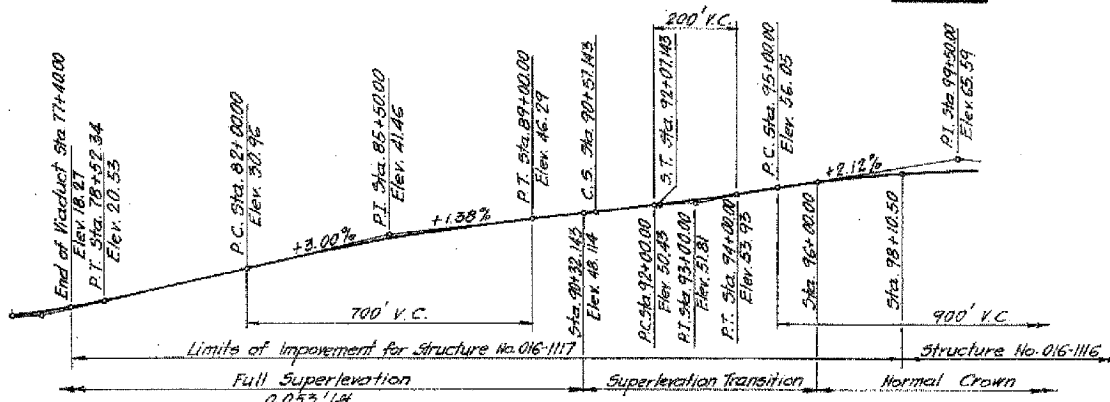
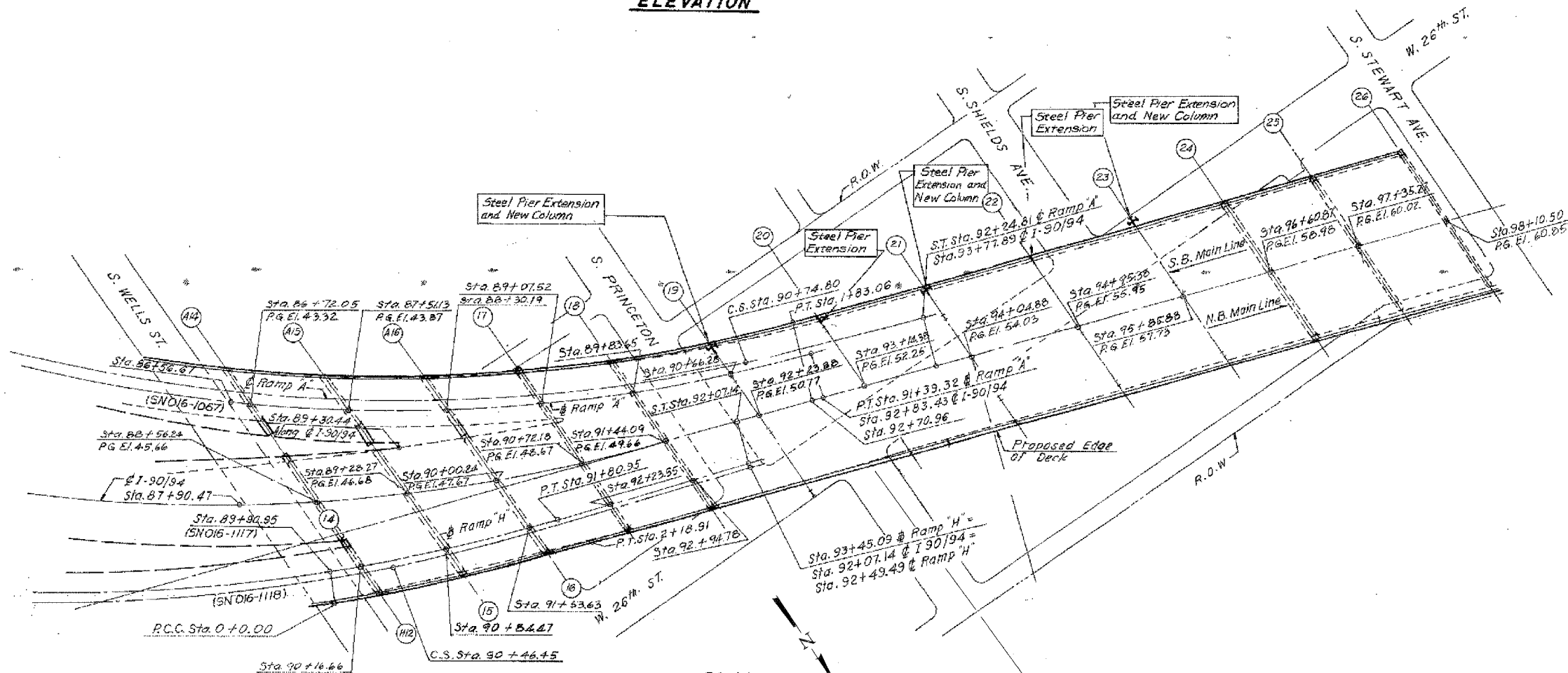
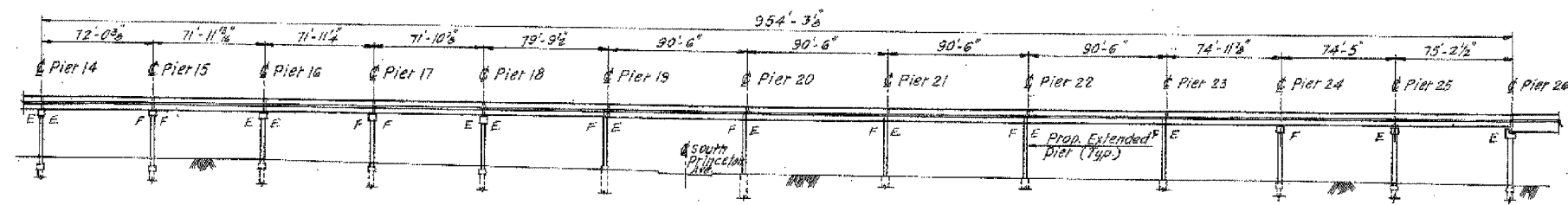

BOWMAN, BARRETT & ASSOCIATES INC.
CONSULTING ENGINEERS
Chicago, Illinois
312.228.0100
www.bbainc.com

Note:
This sheet created from original 1988-89 reconstruction as-builts. These are provided for general reference to structure number, span lengths, etc. Work Items for this contract are identified on the partial framing plans and detail sheets that follow.

REVISIONS		ILLINOIS DEPARTMENT OF TRANSPORTATION	
NAME	DATE	F.A.I. 94/90 (DAN RYAN EXPRESSWAY)	
		DAN RYAN ELEVATED BRIDGE	
		BEARING REPLACEMENT & STEEL REPAIR	
		GENERAL PLAN AND ELEVATION (CONT.)	
		SN 016-1117, SN 016-1067, SN 016-1118	
		SCALE: NTS	DRAWN BY: LAM
		DATE: 5/18/2007	CHECKED BY: BLU

N:\86000\BRIDGE\21\ASHEETS\660_21A_016-1117-CP2.dwg 5/15/07 5:24:20 PM