

F.A.I.	SECTION	COUNTY	TOTAL SHEETS	SHEET NO.
94/90	2005-086 I	COOK	228	18
STA.		TO STA.		
FED. ROAD DIST. NO.		ILLINOIS	FED. AID PROJECT	
60B07				

Note:
This sheet created from original 1988-89 reconstruction as-builts. These are provided for general reference to structure number, span lengths, etc. Work Items for this contract are identified on the partial framing plans and detail sheets that follow.

Station Equation:
P.T. Sta. 8+87.26 AND
R.T. Sta. 22+20.76 BK.

Curve F-1	Curve F-2	Curve F-3	Curve G-1
$\Delta = 4^\circ 15' 18''$	$\Delta = 32^\circ 16' 06''$	$\Delta = 38^\circ 34' 04''$	$\Delta = 82^\circ 16' 18''$
$D = 3^\circ 05' 58''$	$D = 13^\circ 12' 19''$	$D = 10^\circ 38' 36''$	$D = 14^\circ 30' 00''$
$R = 1849.69'$	$R = 453.89'$	$R = 588.35'$	$R = 393.41'$
$T = 149.71'$	$T = 125.82'$	$T = 188.35'$	$T = 345.37'$
$L = 248.77'$	$L = 244.35'$	$L = 367.37'$	$L = 567.39'$
$E = 6.05'$	$E = 17.79'$	$E = 32.00'$	$E = 124.60'$
$SE = 0.020\%$	$SE = 0.060\%$	$SE = 0.060\%$	$SE = 0.060\%$

For Superelevations attainment see Profile, Sheet No 4

RI	N	E	RC	N	E
1	1,888,133.8437	687,740.9400	1	1,887,845.4759	687,751.6044
2	1,888,272.1678	687,733.6702	2	1,887,468.2170	687,592.5740
3	1,887,988.1097	687,825.2179	3	1,887,597.9540	688,082.2080
4	1,887,925.2179	687,813.0255	4	1,887,584.4010	688,082.2080

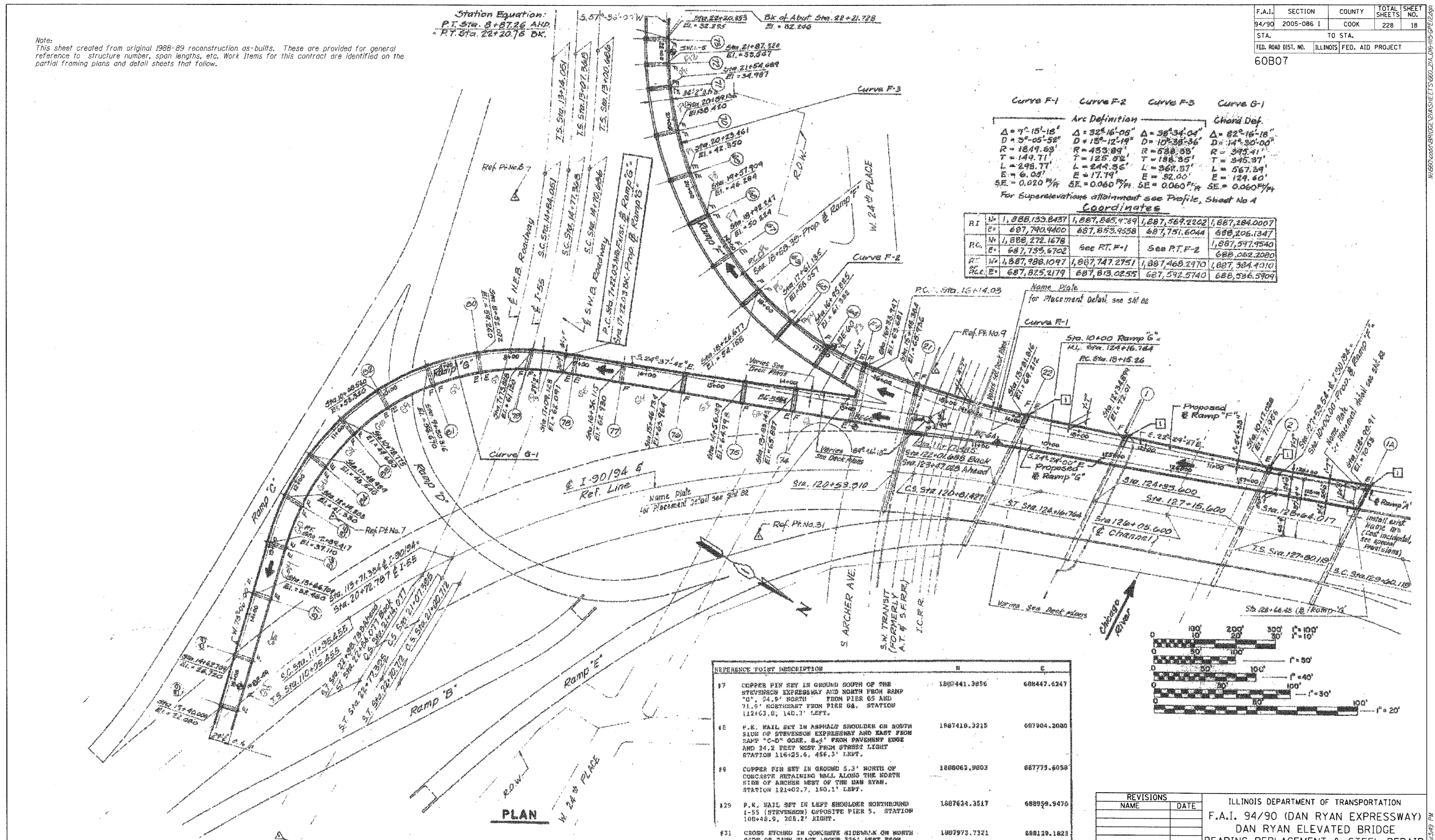

REFERENCE POINT DESCRIPTION	N	E
17 COPPER PIN SET IN GROUND SOUTH OF THE STEVENSON EXPRESSWAY AND NORTH FROM RAMP "G", 54.9' NORTH FROM PIER 65 AND 71.9' NORTHEAST FROM PIER 64. STATION 112+03.8, 140.3' LEFT.	1887441.3856	688447.6247
18 P.K. NAIL SET IN ASPHALT SHOULDER ON SOUTH SIDE OF STEVENSON EXPRESSWAY AND EAST FROM SAME "C-D" CORNER, 8.4' FROM PAVEMENT EDGE AND 34.2 FEET WEST FROM STREET LIGHT STATION 116+25.5, 456.3' LEFT.	1887418.3215	687904.2080
19 COPPER PIN SET IN GROUND 5.3' NORTH OF CONCRETE RETAINING WALL ALONG THE NORTH SIDE OF ARCHES WEST OF THE DAN RYAN. STATION 121+02.7, 150.1' LEFT.	1888062.9203	687775.6058
20 P.K. NAIL SET IN LEFT SHOULDER NORTHTHROUGH I-55 (STEVENSON) OPPOSITE PIER 5. STATION 108+48.9, 288.2' RIGHT.	1887634.3517	688958.9470
31 CROSS SETCHED IN CONCRETE SIDEWALK ON NORTH SIDE OF 24TH PLACE ABOUT 326' WEST FROM WALLACE, 7' SOUTH FROM FENCE GATE. STATION 118+14.8, 91.3' RIGHT.	1887973.7321	688129.1823

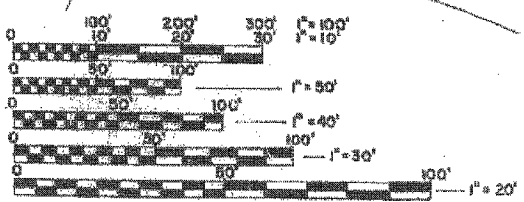

REVISIONS	
NAME	DATE

ILLINOIS DEPARTMENT OF TRANSPORTATION
F.A.I. 94/90 (DAN RYAN EXPRESSWAY)
DAN RYAN ELEVATED BRIDGE
BEARING REPLACEMENT & STEEL REPAIR
GENERAL PLAN
SN 016-1050, 1062 & 1066
SCALE: NTS
DATE: 5/18/2007
DRAWN BY: LAM
CHECKED BY: BLU

BOWMAN, BARRETT & ASSOCIATES INC.
CONSULTING ENGINEERS
Chicago, Illinois
312.228.0100
www.bbainc.com

PLAN