

F.A.I.	SECTION	COUNTY	TOTAL SHEETS	SHEET NO.
94/90	2005-086 I	COOK	228	21
STA.	TO STA.			
FED. ROAD DIST. NO.	ILLINOIS FED. AID PROJECT			

60B07

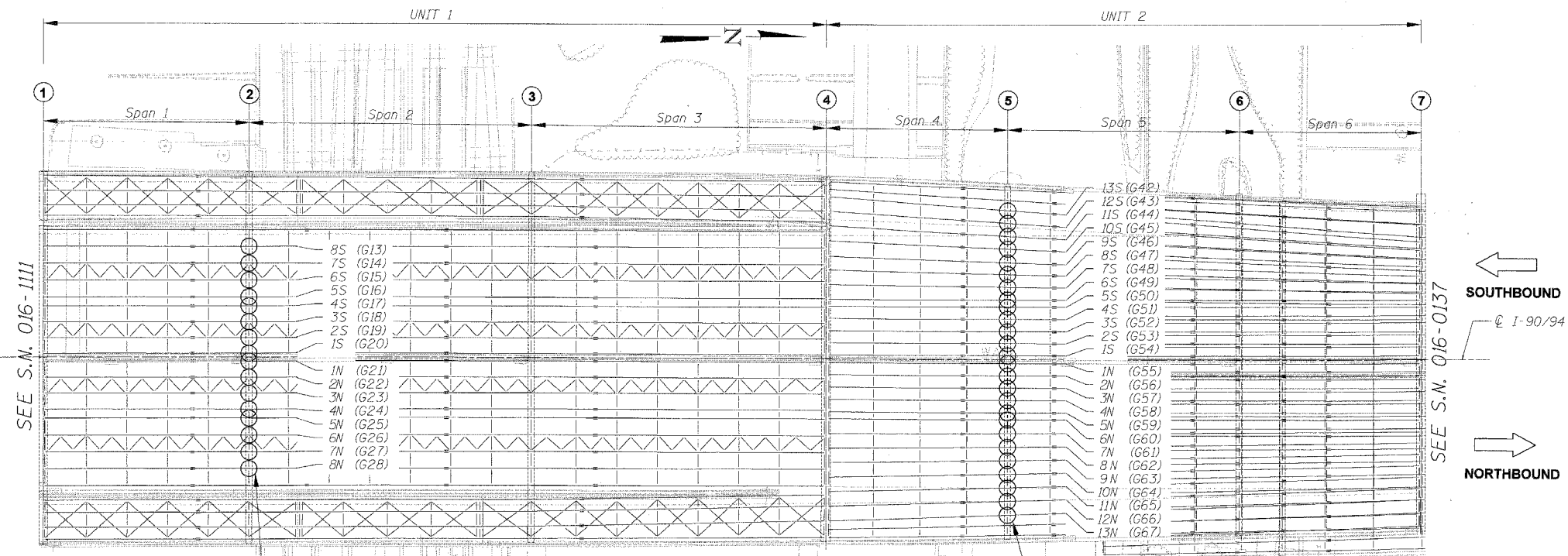

Bearing Replacements 1N thru 8N & 1S thru 8S (16 Locations)

Bearing Replacement 1N thru 13N & 1S thru 13S (26 Locations)

S.N. 016-1110 FRAMING PLAN

ELEMENT IDENTIFICATION

Elements on the Southbound Structure are identified 1S, 2S, 3S etc. starting from the centerline of I-90/94.

Elements on the Northbound Structure are identified 1N, 2N, 3N etc. starting from the centerline of I-90/94.

Numbers within () refer to as-built beam designations.

- ① = Pier No.
- = Location of Bearing Replacement
- ◊ = Location of Structural Steel Repair

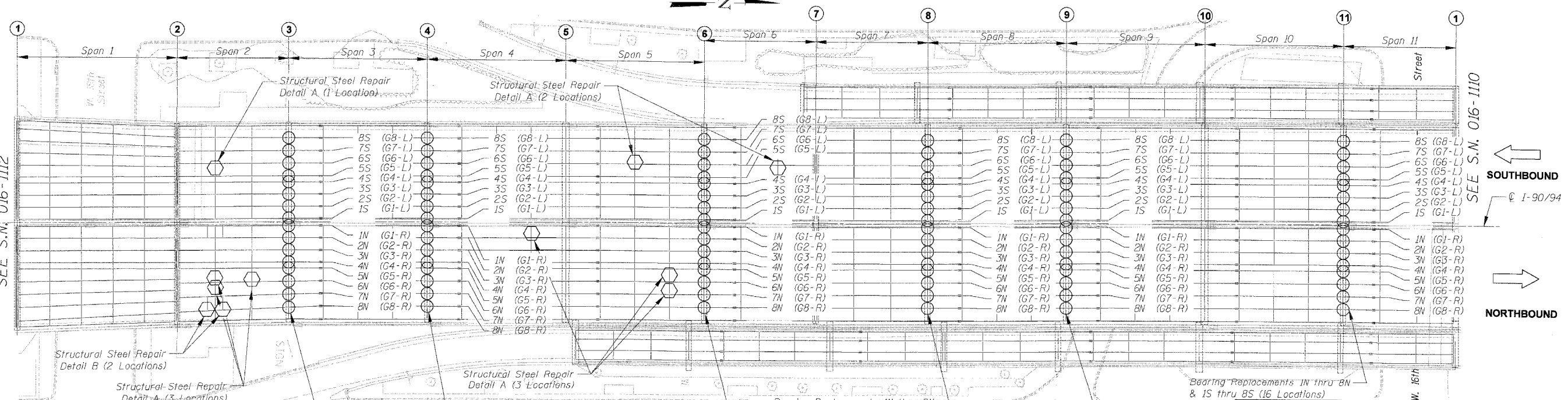
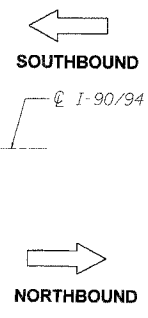

Bearing Replacements 1N thru 8N & 1S thru 8S (16 Locations)

Bearing Replacements 1N thru 8N & 1S thru 8S (16 Locations)

Bearing Replacements 1N thru 8N & 1S thru 8S (16 Locations)

Bearing Replacements 1N thru 8N & 1S thru 8S (16 Locations)

S.N. 016-1111 FRAMING PLAN

REVISIONS	
NAME	DATE

ILLINOIS DEPARTMENT OF TRANSPORTATION
 F.A.I. 94/90 (DAN RYAN EXPRESSWAY)
 DAN RYAN ELEVATED BRIDGE
 BEARING REPLACEMENT & STEEL REPAIR
 PARTIAL FRAMING PLAN
 S.N. 016-1110 & 016-1111

SCALE: NTS
 DATE: 3/1/2008

DRAWN BY: LAM
 CHECKED BY: BLU

BOWMAN, BARRETT & ASSOCIATES INC.
 CONSULTING ENGINEERS
 Chicago, Illinois
 312.228.0100
 www.bbainc.com

I:\6000\BRIDGE\21ASHEET\60B07.DWG
 60B07 AM
 3/21/2008