

F.A.I.	SECTION	COUNTY	TOTAL SHEETS	SHEET NO.
94/90	2005-086 1	COOK	228	53
STA.		TO STA.		
FED. ROAD DIST. NO.		ILLINOIS FED. AID PROJECT		
60B07				

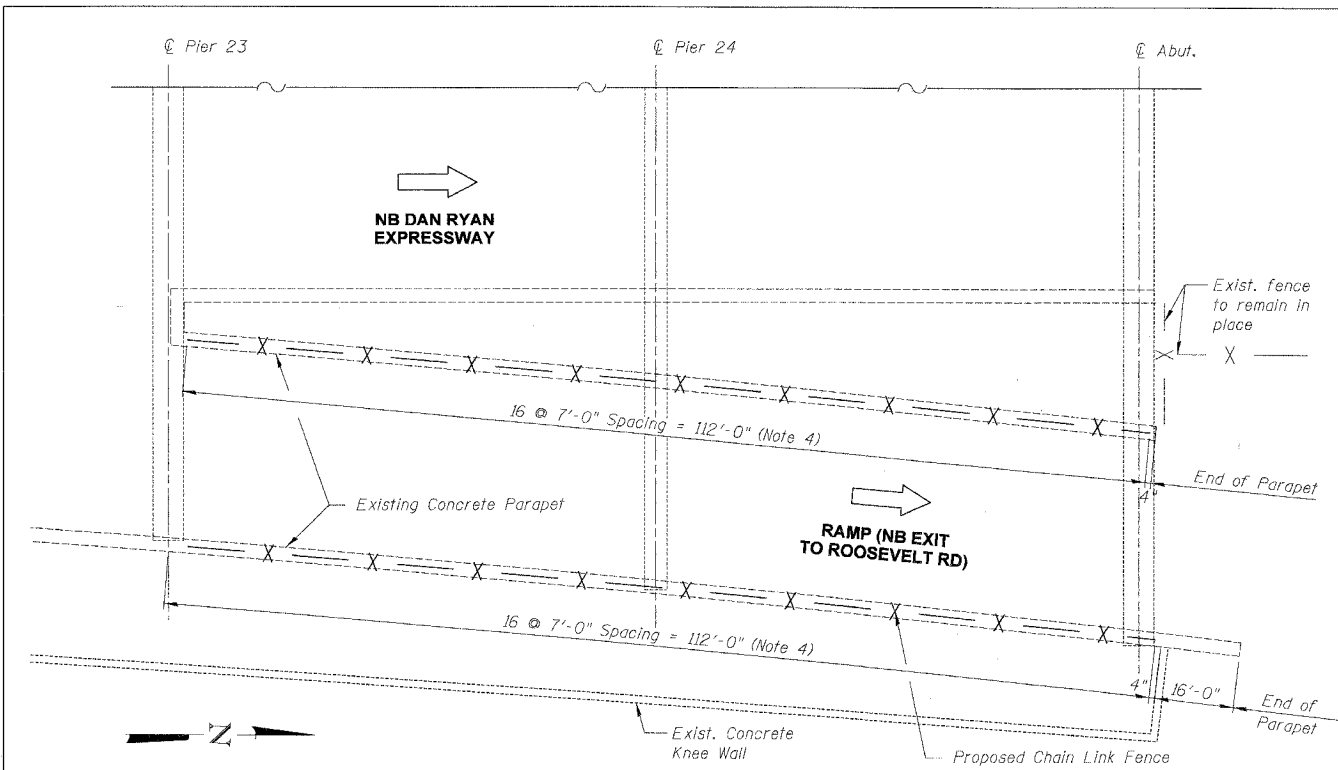

**PLAN DETAIL**  
(SN 016-0137)

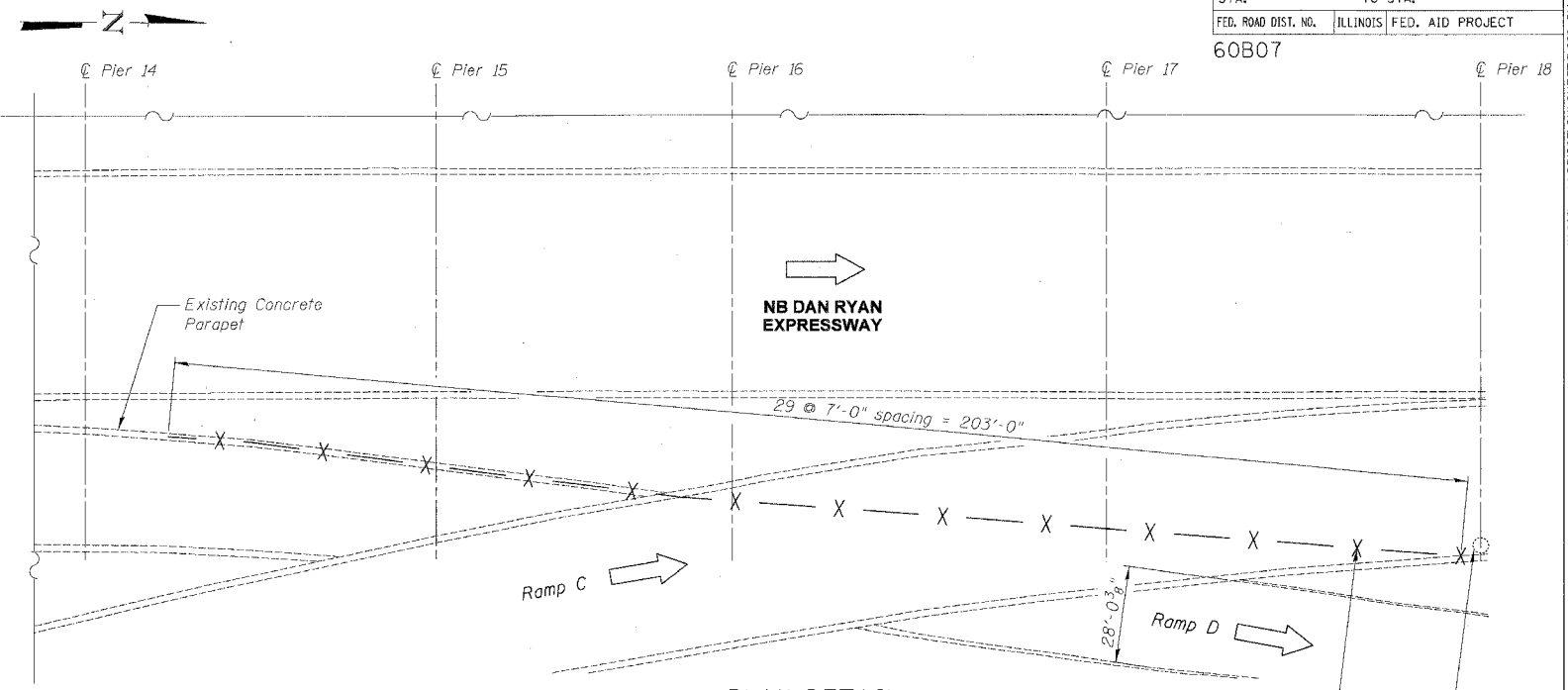

**PLAN DETAIL**  
(SN 016-1112)

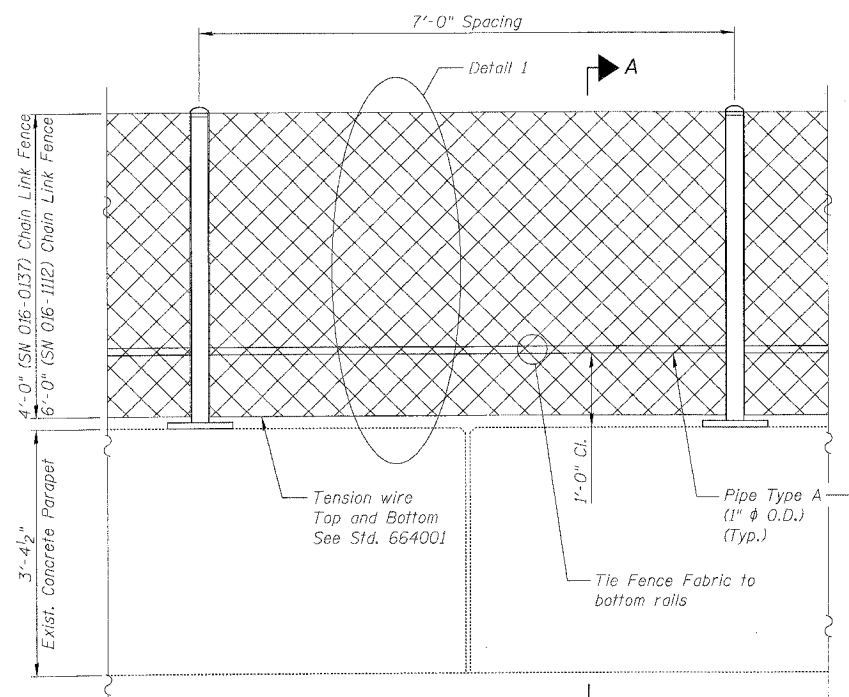

**TYPICAL CHAIN LINK FENCE**

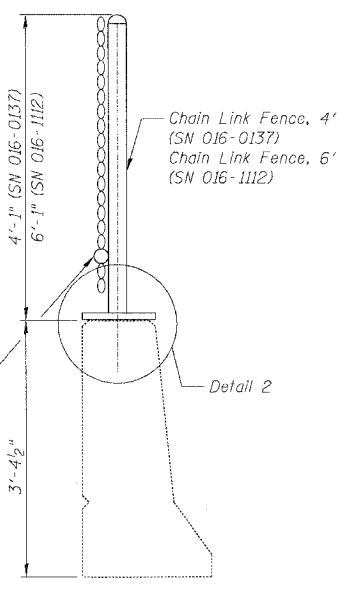

**SECTION A-A**

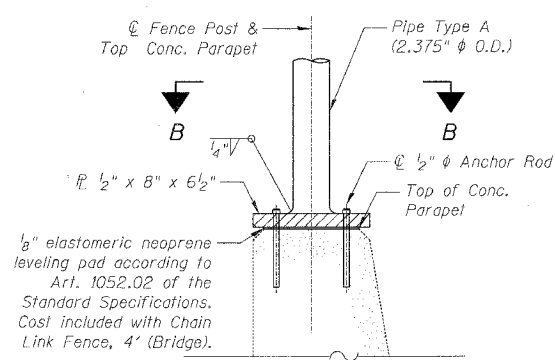

**DETAIL 2**

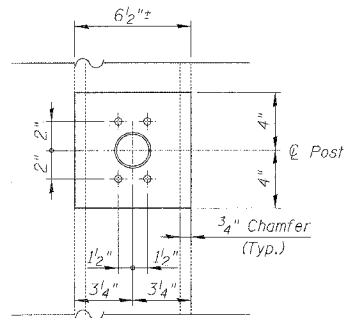

**VIEW B-B**

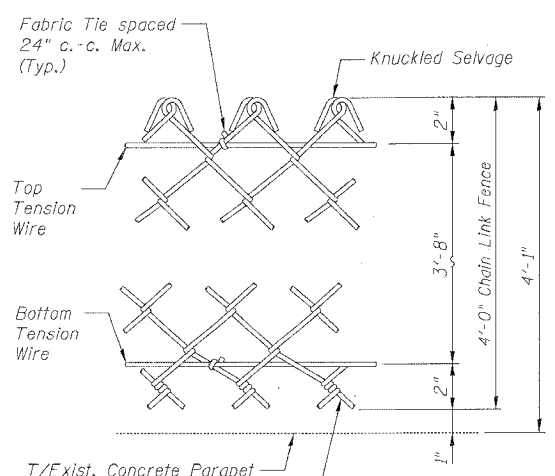

**DETAIL 1**

**BILL OF MATERIAL**

Item	Unit	Qty.
Chain Link Fence, 4' (Bridge)	Foot	224
Chain Link Fence, 6' (Bridge)	Foot	203

- Notes:
- For additional Chain Link Fence Detail see Highway Standard 664001.
  - Drill and grout 1/2" φ Anchor Rods in accordance with Art. 584 of the Standard Specifications. Provide hex nuts and washers. Galvanize rods, nuts and washers in accordance with Art. 1006.09 of the Standard Specifications. Cost included with "Chain Link Fence, 4' (Bridge)" or "Chain Link Fence, 6' (Bridge)".
  - This work shall be performed overnight using alternating shoulder closure in accordance with Hwy. Std. 701411-3. Minimum 12' lane shall be maintained for ramp traffic at all time. The cost shall be included in "Traffic Control and Protection (Expressway)".
  - At SN 016-0137, adjust post spaces to match field conditions as directed by Engineer, and to ensure proper closure with existing fences.
  - At S.N. 016-1112, install first post to be as close to Pier C18 as possible. Use brackets to ensure proper closure with Pier C18 as directed by Engineer. The cost of furnishing and erecting of closure bracket assemblies shall be included in "Chain Link Fence, 6' (Bridge)".

**REVISIONS**

NAME	DATE

ILLINOIS DEPARTMENT OF TRANSPORTATION  
 F.A.I. 94/90 (DAN RYAN EXPRESSWAY)  
 DAN RYAN ELEVATED BRIDGE  
 BEARING REPLACEMENT & STEEL REPAIR  
 CHAIN LINK FENCE DETAIL

SCALE: NTS  
 DATE: 3/7/2008

DRAWN BY: LAM  
 CHECKED BY: BLU

BOWMAN, BARRETT & ASSOCIATES INC.  
 CONSULTING ENGINEERS  
 Chicago, Illinois  
 312.228.0100  
 www.bbandainc.com

I:\9400\9400\BRIDGE\214\ASHEETS\9602\_214\_53\9400.dwg  
 3/21/2008 8:48:18 AM