

SPANS 7 THRU 11

GIRDER	B	DIMENSION					PLATE SIZE					
		Q	R	S	G	H	J	K	L			
G1-L	103'-3"	61'-11"	8'-8"	12'-0"	14'-7"	14'-7"	14'-7"	14'-7"	14'-7"	14'-7"	14'-7"	14'-7"
G2,3-(L&R)	103'-3"	63'-11"	10'-5"	9'-3"	14'-7"	14'-7"	14'-7"	14'-7"	14'-7"	14'-7"	14'-7"	14'-7"
G4,5-(L&R)	103'-3"	61'-11"	10'-5"	10'-5"	14'-7"	14'-7"	14'-7"	14'-7"	14'-7"	14'-7"	14'-7"	14'-7"
G6-L	103'-3"	63'-11"	10'-4"	9'-4"	14'-7"	14'-7"	14'-7"	14'-7"	14'-7"	14'-7"	14'-7"	14'-7"
G7-L	103'-3"	63'-11"	10'-4"	9'-4"	14'-7"	14'-7"	14'-7"	14'-7"	14'-7"	14'-7"	14'-7"	14'-7"
G8-L	103'-3"	64'-0"	10'-4"	9'-4"	14'-7"	14'-7"	14'-7"	14'-7"	14'-7"	14'-7"	14'-7"	14'-7"
G9-L	103'-3"	64'-1"	9'-8"	10'-0"	14'-7"	14'-7"	14'-7"	14'-7"	14'-7"	14'-7"	14'-7"	14'-7"
G6-R	103'-3"	63'-11"	11'-0"	8'-8"	14'-7"	14'-7"	14'-7"	14'-7"	14'-7"	14'-7"	14'-7"	14'-7"
G7-R	103'-3"	63'-11"	11'-0"	8'-8"	14'-7"	14'-7"	14'-7"	14'-7"	14'-7"	14'-7"	14'-7"	14'-7"
G8-R	103'-3"	64'-0"	11'-0"	8'-8"	14'-7"	14'-7"	14'-7"	14'-7"	14'-7"	14'-7"	14'-7"	14'-7"
G9-R	103'-3"	64'-0"	9'-8"	10'-0"	14'-7"	14'-7"	14'-7"	14'-7"	14'-7"	14'-7"	14'-7"	14'-7"
G1-R	103'-3"	61'-11"	7'-8"	13'-0"	14'-7"	14'-7"	14'-7"	14'-7"	14'-7"	14'-7"	14'-7"	14'-7"

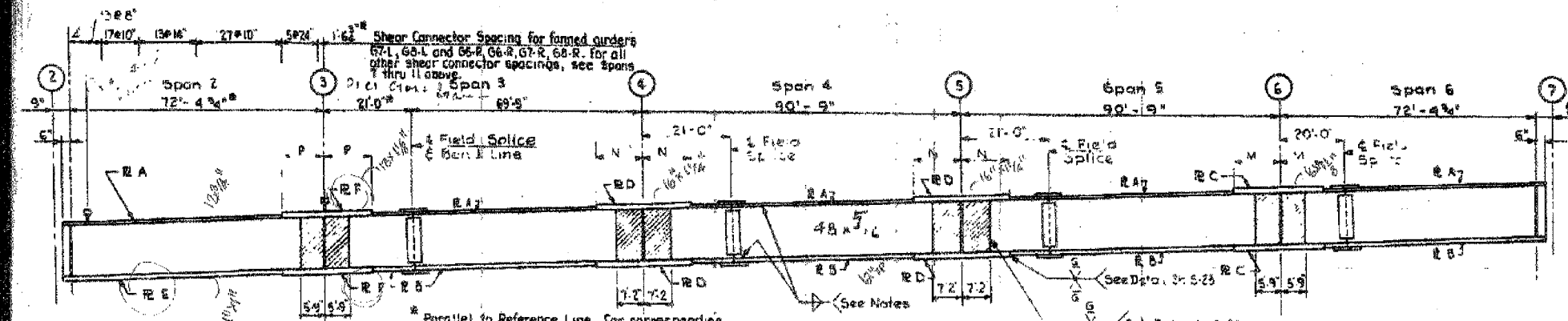

SPANS 2 THRU 6

UNIT	GIRDER	PLATE		PLATE C		PLATE D		PLATE E		PLATE F	
		A	B	SIZE	M	SIZE	N	SIZE	P	SIZE	Q
SPANS 7 THRU 11	G1-L	10'-3"	12'-2"	16'-3"	10'-2"	16'-1"	11'-2"				
	G2,3-(L&R)	12'-2"	12'-1"	16'-1"	10'-8"	16'-1"	12'-0"				
	G4,5-(L&R)	12'-2"	12'-1"	16'-1"	9'-9"	16'-1"	11'-2"				
	G6,7,8-(L&R)	12'-2"	12'-1"	16'-1"	11'-4"	16'-1"	12'-6"				
	G9-L	10'-3"	12'-2"	16'-3"	8'-9"	16'-1"	10'-0"	12'-3"	16'-1"	8'-9"	
	G1-R	10'-3"	12'-2"	16'-3"	8'-9"	16'-1"	10'-0"	12'-3"	16'-1"	8'-9"	
SPANS 2 THRU 6	G1-L	10'-2"	12'-2"	16'-3"	10'-2"	16'-1"	11'-2"	12'-3"	16'-1"	10'-2"	
	G2,3-(L&R)	12'-2"	12'-1"	16'-1"	10'-8"	16'-1"	12'-0"	12'-1"	16'-1"	16'-8"	
	G4-(L&R)	12'-2"	12'-1"	16'-1"	9'-9"	16'-1"	11'-2"	12'-1"	16'-1"	16'-8"	
	G5-L	12'-2"	12'-1"	16'-1"	9'-9"	16'-1"	11'-2"	12'-1"	16'-1"	9'-9"	
	G6-L	12'-2"	12'-1"	16'-1"	11'-4"	16'-1"	12'-6"	12'-1"	16'-1"	11'-4"	
	G7,8-L	12'-2"	12'-1"	16'-1"	11'-4"	16'-1"	12'-6"	12'-1"	16'-1"	11'-4"	
SPANS 7 THRU 11	G1-R	10'-2"	12'-2"	16'-3"	8'-9"	16'-1"	10'-0"	12'-3"	16'-1"	8'-9"	
	G2,3-(L&R)	12'-2"	12'-1"	16'-1"	10'-8"	16'-1"	12'-0"	12'-1"	16'-1"	16'-8"	
	G4-(L&R)	12'-2"	12'-1"	16'-1"	9'-9"	16'-1"	11'-2"	12'-1"	16'-1"	16'-8"	
	G5-L	12'-2"	12'-1"	16'-1"	9'-9"	16'-1"	11'-2"	12'-1"	16'-1"	9'-9"	
	G6-L	12'-2"	12'-1"	16'-1"	11'-4"	16'-1"	12'-6"	12'-1"	16'-1"	11'-4"	
	G7,8-R	12'-2"	12'-1"	16'-1"	11'-4"	16'-1"	12'-6"	12'-1"	16'-1"	11'-4"	

Continuous Span Web Plates - Spans (2 thru 11)
 Positive Moment Areas all Girders 48" x 5/8"
 Negative Moment Areas (Shown Cross-Hatched)
 Girders G2 thru G6 (L&R) 48" x 5/8"
 Girders G1-(L&R) 48" x 3/8"

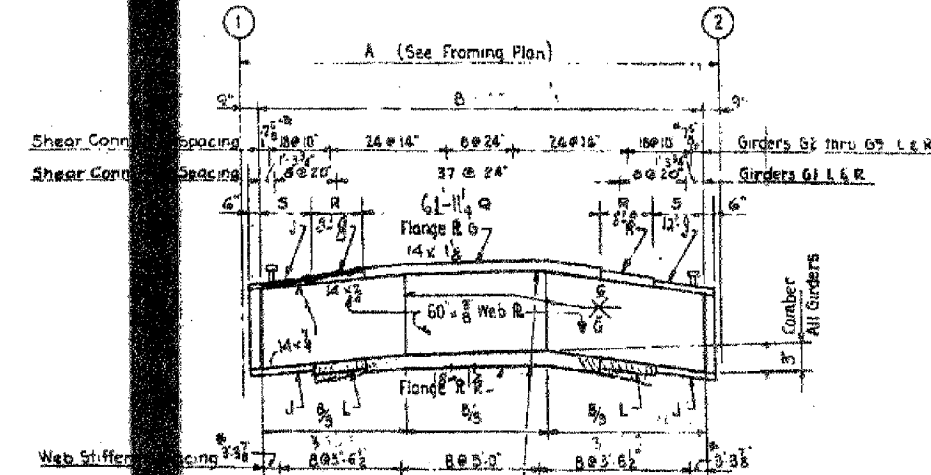

STUD SHEAR CONNECTORS

CHANNEL SHEAR CONNECTORS

3 or 4 Stud Equally spaced See Notes 2 & 3
 (1) Studs or channels may be used at the option of the contractor.
 (4) Shear Connector locations at flange splice plates

FOR INFORMATION ONLY

BOWMAN, BARRETT & ASSOCIATES INC.
 CONSULTING ENGINEERS
 Chicago, Illinois
 312.228.0100
 www.bbainc.com

Sheet S22 of 82

REVISIONS	
NAME	DATE

ILLINOIS DEPARTMENT OF TRANSPORTATION
 F.A.I. 94/90 (DAN RYAN EXPRESSWAY)
 DAN RYAN ELEVATED BRIDGE
 BEARING REPLACEMENT & STEEL REPAIR
 EXISTING PLAN INFORMATION
 SN 016-1111

SCALE: NTS
 DATE: 5/18/2007
 DRAWN BY: LAM
 CHECKED BY: BLU

CITY OF CHICAGO
 DEPARTMENT OF PUBLIC WORKS
 BUREAU OF ENGINEERING
SOUTH ROUTE SUPERHIGHWAY
 SECTION NO. 15-1553.3-JH
 15-1553.3-JH
W. 15th STREET TO W. 16th STREET
GIRDER DETAILS
 CONSER, TOWNBEND & ASSOCIATES
 CONSULTING ENGINEERS
 CHICAGO, ILLINOIS
 DRAWN BY: E.L.F. CHECKED BY: []