

FED. AID DIST. NO.	SECTION	COUNTY	TOTAL SHEETS	SHEET NO.
90/94	e	COOK	120	37
STA.		TO STA.		
FED. ROAD DIST. NO.		ILLINOIS FED. AID PROJECT		
e 1985-082 R				

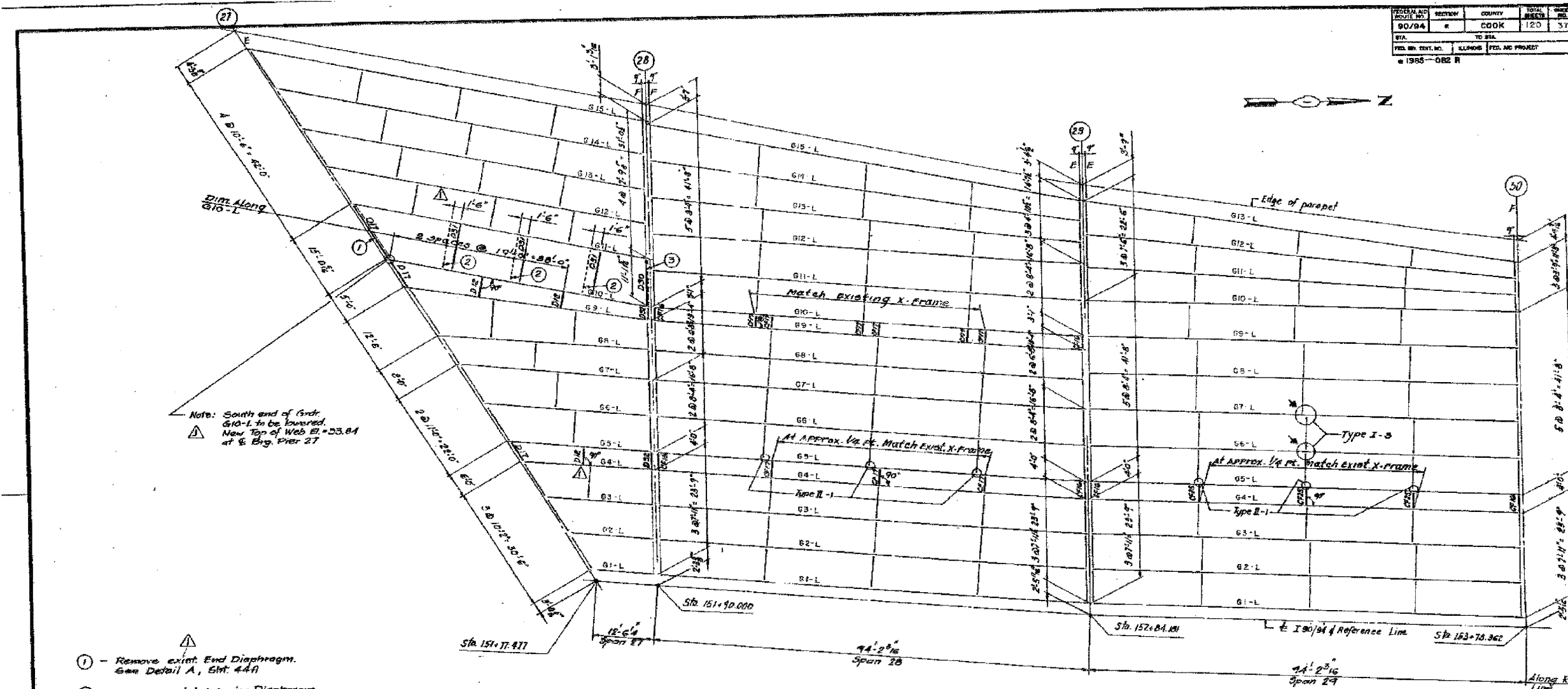

Note: South end of Gndr. G10-L to be lowered. New Top of Web E = 23.84 at E. End Pier 27

- ① - Remove exist. End Diaphragm. See Detail A, Sht. 44A
- ② - Remove exist. Interior Diaphragm. See Detail B, Sht. 44B
- ③ - Remove exist. End Diaphragm. See Detail C, Sht. 44C

Contractor to furnish End Diaphragm D17 & D30, intermediate Diaphragm D31 between Girders G10-L & G11-L.

Legend

▲ Denotes Existing Cracked. Field location at transverse stiffener to underside of Top Flange (Typ)

TYPE I-3, I-1 — Detail Number
Fatigue Retrofit Repair Cross-Frame at Top Flange (See Sht. D4B)

PLAN - SPANS 27, 28 & 29 (S.B.)

ALL NEW MATERIALS SHOWN ON THIS SHEET ARE FURNISHED UNDER A SEPARATE STEEL FABRICATION CONTRACT (SECTION 1985-0817), UNLESS NOTED OTHERWISE. Revision 12-7-87

SHEET D37 OF 120

STATE OF ILLINOIS
DEPARTMENT OF TRANSPORTATION
F.A.I. ROUTE 94/94 (DAN RYAN EXPRESSWAY)
SECTION 1985-082 R - COOK COUNTY
S.B. MAINLINE RECONSTRUCTION
STRUCTURE 018 - 112 (MAINLINE)
FRAMING PLAN SPANS 27 TO 29

Scale: NONE
Date: AUG. 14, 1987
Drawn By: J.G.
Checked By: M.M.

ENVIRONMENTAL ENGINEERS INC.
Chicago, Illinois

REVISIONS	NAME	DATE

FOR INFORMATION ONLY

BOWMAN, BARRETT & ASSOCIATES INC.
CONSULTING ENGINEERS
Chicago, Illinois
312.228.0100
www.bbainc.com

ILLINOIS DEPARTMENT OF TRANSPORTATION
F.A.I. 94/90 (DAN RYAN EXPRESSWAY)
DAN RYAN ELEVATED BRIDGE
BEARING REPLACEMENT & STEEL REPAIR
EXISTING PLAN INFORMATION
SN 016-1112

SCALE: NTS
DATE: 5/18/2007
DRAWN BY: LAM
CHECKED BY: BLU

5/24/2007 5:55:50 PM