

F.A.I.	SECTION	COUNTY	TOTAL SHEETS	SHEET NO.
94/90	2005-086 I	COOK	228	193
STA.		TO STA.		
FED. ROAD DIST. NO.		ILLINOIS FED. AID PROJECT		
60B07				

FEDERAL AID PROJECT NO.	SECTION	COUNTY	TOTAL SHEETS	SHEET NO.
90/94	1	COOK	20	6
STA.	TO STA.			
FED. ROAD DIST. NO.	ILLINOIS FED. AID PROJECT			
* 1985 - DB2 R				

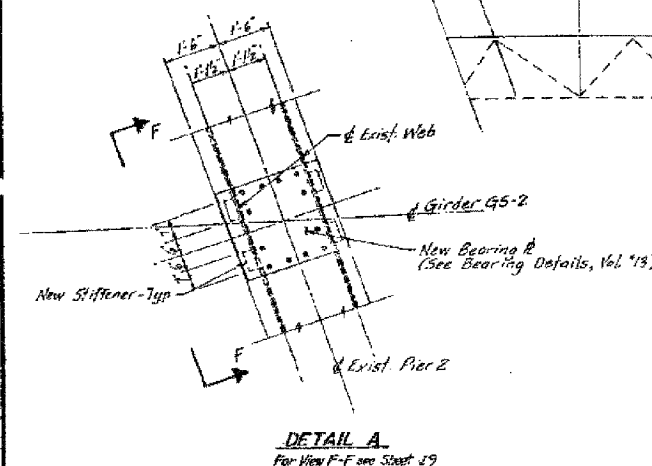
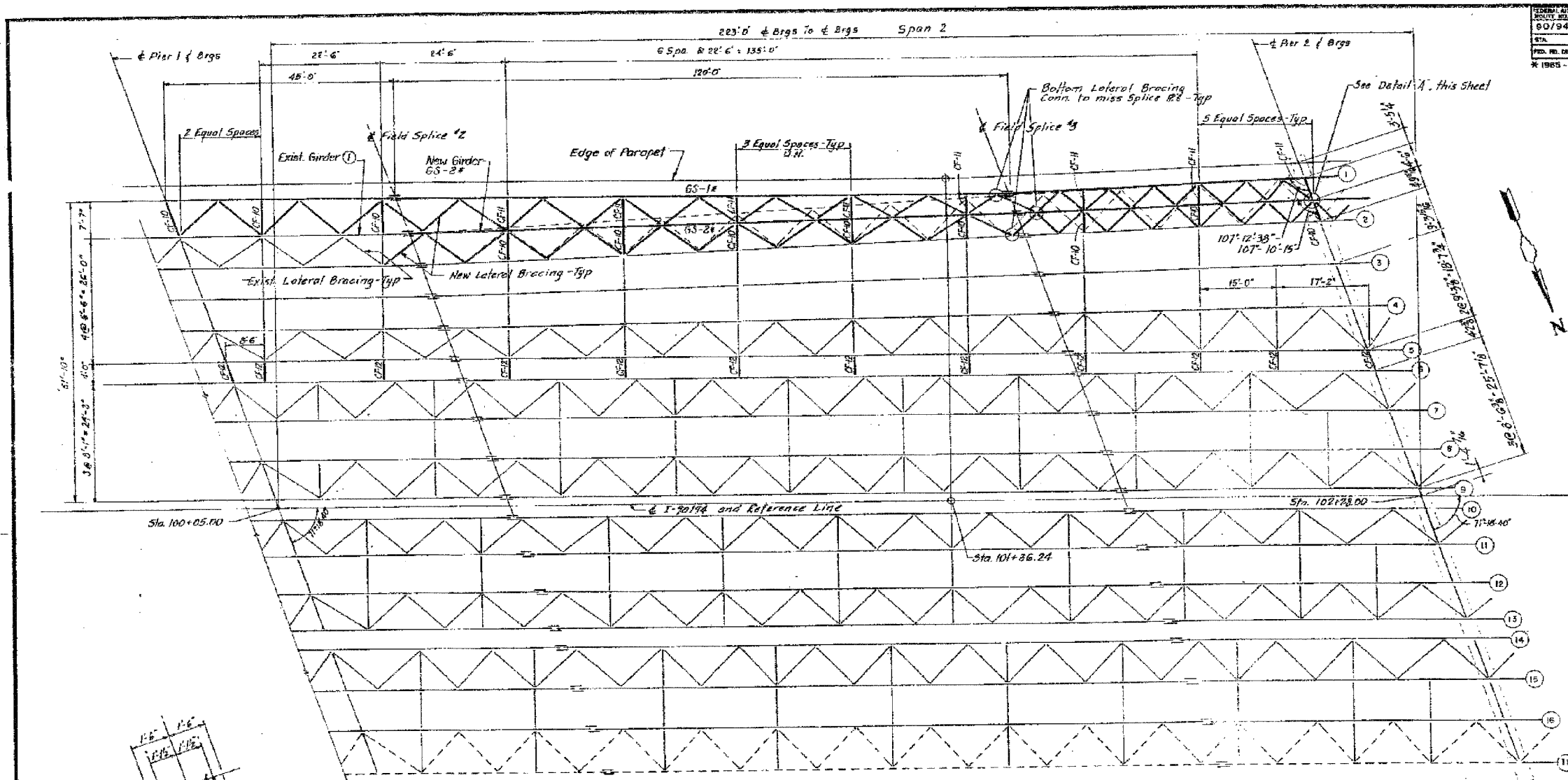

LEGEND
 - - - - - to be removed (S.B. only)
 * new plate girder (For size and length see Sheet I-8)

PLAN-SPAN 2 (S.B.)

SHEET 6 OF 20

REVISIONS	
Name	Date

STATE OF ILLINOIS
 DEPARTMENT OF TRANSPORTATION
 F.A.I. ROUTE 90/94 (DAN RYAN EXPRESSWAY)
 SECTION 905-DB2R - COOK COUNTY
 S.B. MAINLINE RECONSTRUCTION
 STRUCTURE 016-1116
 FRAMING PLAN SPAN 2
 Scale: NONE
 Date: AUG. 14, 1987
 Drawn By: A.V.P.
 Checked By: A.W.
 ENVIRONMENTAL ENGINEERS INC.
 Chicago, Illinois

ALL NEW MATERIALS SHOWN ON THIS SHEET ARE FURNISHED UNDER A SEPARATE STEEL FABRICATION CONTRACT (SECTION 1005-DB1F), UNLESS NOTED OTHERWISE.

REVISIONS	
NAME	DATE

ILLINOIS DEPARTMENT OF TRANSPORTATION
 F.A.I. 94/90 (DAN RYAN EXPRESSWAY)
 DAN RYAN ELEVATED BRIDGE
 BEARING REPLACEMENT & STEEL REPAIR
 EXISTING PLAN INFORMATION
 SN 016-1116
 SCALE: NTS
 DATE: 5/18/2007
 DRAWN BY: LAM
 CHECKED BY: BLU

FOR INFORMATION ONLY

BOWMAN, BARRETT & ASSOCIATES INC.
 CONSULTING ENGINEERS
 Chicago, Illinois
 312.228.0100
 www.bbainc.com

5/24/2007 5:46:35 PM