

F.A.I. RTE.	SECTION	COUNTY	TOTAL SHEETS	SHEET NO.
55	*	COOK	26	9
STA.		TO STA.		
FED. ROAD DIST. NO.	ILLINOIS	FED. AID PROJECT		

1818 (.31 H & .32 H) I-4  
**CONTRACT NO. 60C92**

NOTES:

1. ALL SIGN DIMENSIONS ARE SHOWN IN INCHES.
2. ALL SIGNS TO BE ORANGE BACKGROUND WITH BLACK LETTERING.



A DETOUR M4-8 (24 x 12)	B END DETOUR M4-8d (24 x 18)
C SOUTH M3-3 (21 x 9)	D INTERSTATE 55 M1-1 (24 x 24)
F ← M5-1(L) (21 x 15)	E 41 M1-4 (24 x 24)
G ← M6-1(L) (21 x 15)	H ↑ M6-3 (21 x 15)
I ↗ M6-2(R) (21 x 15)	

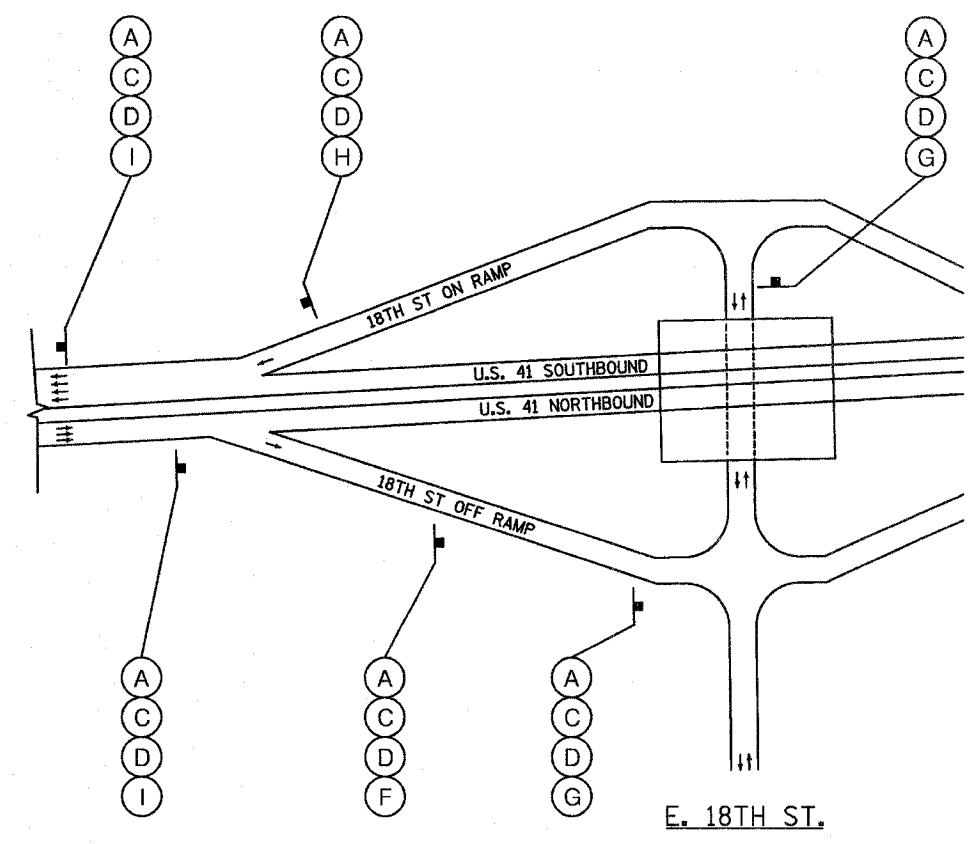
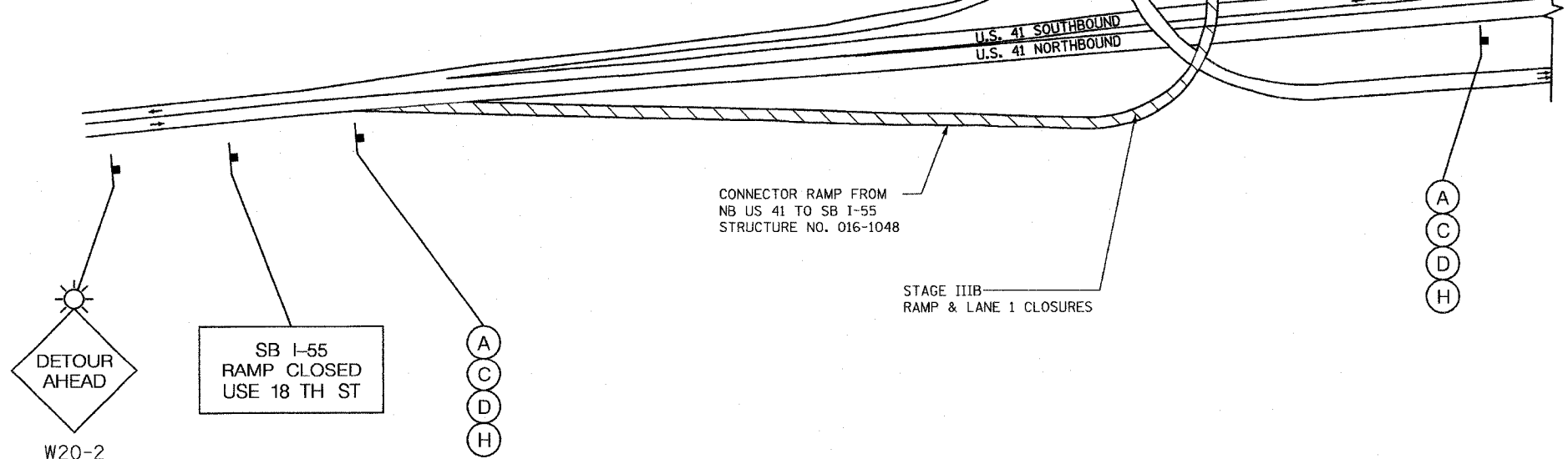

 DETOUR AHEAD W20-2 (48 x 48)	SB I-55 RAMP CLOSED USE 18 TH ST (60 x 48)
---	---

**DETOUR STAGE IIIB**  
 N.B. U.S. 41 TO S.B. I-55

REVISIONS	
NAME	DATE

ILLINOIS DEPARTMENT OF TRANSPORTATION  
 DETOUR PLAN - STAGE IIIB  
 I-55  
 OVER  
 U.S. 41/LAKE SHORE DRIVE  
 F.A.I. RTE. 55 SECTION: 1818(.31H) & .32H)I-4

SCALE: NONE  
 DATE: APRIL 18, 2008  
 DRAWN BY: D.L./F.M.  
 CHECKED BY: B.N.S./S.J.P.

**CHRISTIAN-ROGE & ASSOC., INC.**  
 CHICAGO ILLINOIS