

F.A.I. RTE.	SECTION	COUNTY	TOTAL SHEETS	SHEET NO.
55	*	COOK	26	16
STA.		TO STA.		
FED. ROAD DIST. NO.	ILLINOIS	FED. AID PROJECT		

* 1818 (.31 H & .32 H) I-4
CONTRACT NO. 60C92

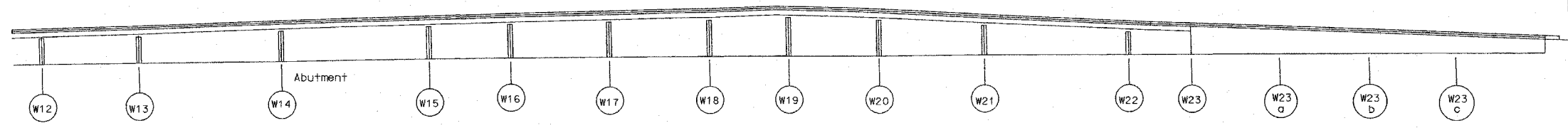

ELEVATION - S.W. ROADWAY

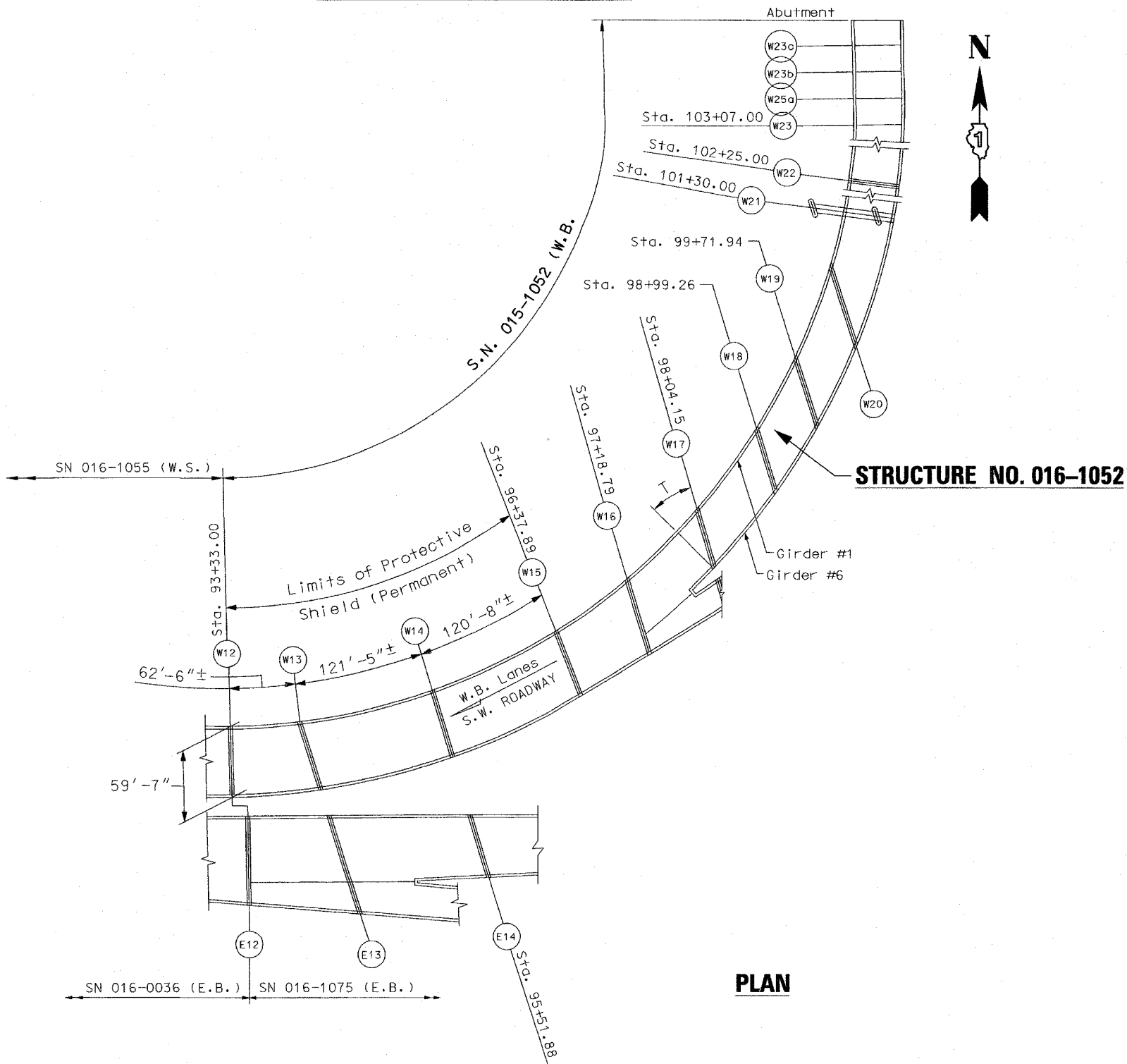

STRUCTURE NO. 016-1052

PLAN

FOR INFORMATION ONLY

REVISIONS	
NAME	DATE

ILLINOIS DEPARTMENT OF TRANSPORTATION
GENERAL PLAN & ELEVATION
I-55
OVER
U.S. 41/LAKE SHORE DRIVE
F.A.I. RTE. 55 SECTION: 1818(.31H & .32H)I-4
COOK COUNTY
STRUCTURE NO. 016-1052
SCALE: NONE
DATE: APRIL 18, 2008
DRAWN BY: D.L./F.M.
CHECKED BY: B.N.S./S.J.P.
CHRISTIAN-ROGE & ASSOC., INC.
CHICAGO ILLINOIS