

STATE OF ILLINOIS
DEPARTMENT OF TRANSPORTATION
DIVISION OF HIGHWAYS

**PROPOSED
HIGHWAY PLANS**

F.A.I. ROUTE 55 (I-55 /STEVENSON EXPWY)
WILLOW SPRINGS ROAD TO CALIFORNIA AVENUE

SECTION: 2007-046 I
SHOULDER RUMBLE STRIPS

PROJECT: *ACHSIP-055-7(275)280*
COOK COUNTY
C-91-008-08

FOR INDEX OF SHEETS, SEE SHEET NO.

PROJECT IS LOCATED IN THE CITY OF CHICAGO AND THE VILLAGES OF STICKNEY, FOREST VIEW, SUMMIT, BEDFORD PARK, HODGKINS, AND COUNTRYSIDE

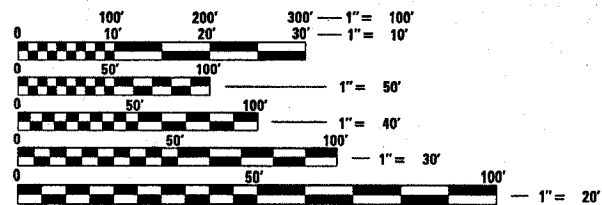

FULL SIZE PLANS HAVE BEEN PREPARED USING STANDARD ENGINEERING SCALES. REDUCED SIZED PLANS WILL NOT CONFORM TO STANDARD SCALES. IN MAKING MEASUREMENTS ON REDUCED PLANS, THE ABOVE SCALES MAY BE USED.

J.U.L.I.E.
JOINT UTILITY LOCATION INFORMATION FOR EXCAVATION
1-800-892-0123
OR 811

PROJECT ENGINEER: ANA ABREU (847) 705-4586
PROJECT MANAGER: KEN ENG (847) 705-4247

CONTRACT NO. 60D36

OMMISSIONS:

- STA. 1235+18 TO STA. 1268+14
- STA. 1362+31 TO STA. 1365+32
- STA. 1427+14 TO STA. 1433+13
- STA. 1632+38 TO STA. 1633+99
- STA. 1646+20 TO STA. 1647+91
- STA. 1746+66 TO STA. 1748+34
- STA. 1775+32 TO STA. 1777+22

PROJECT BEGINS
STA. 1175+73

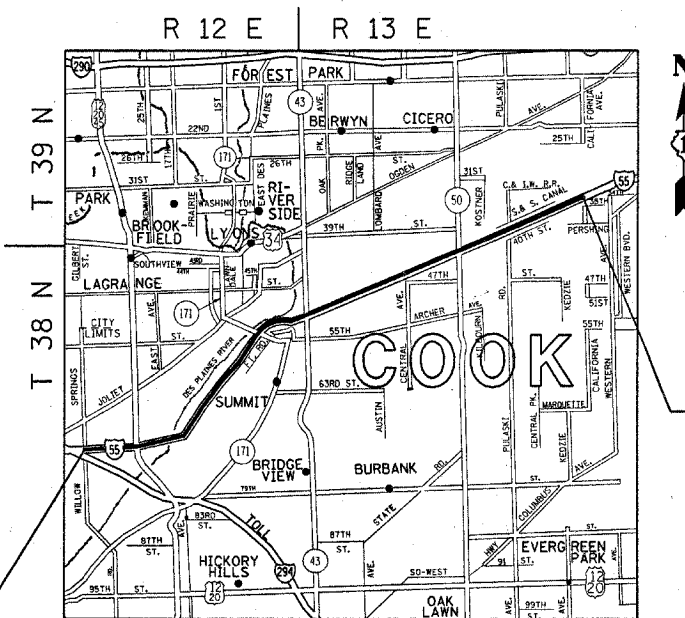

LYONS, STICKNEY, WEST
& SOUTH TOWNSHIPS

PROJECT ENDS
STA. 1780+00

TRAFFIC DATA
SPEED LIMIT: 55 MPH
2005 ADT: 176,900

GROSS LENGTH OF PROJECT = 60,427 FEET (11.4 MILES)
NET LENGTH OF PROJECT = 55,541 FEET (10.5 MILES)

F.A.I. RTE.	SECTION	COUNTY	TOTAL SHEETS	SHEET NO.
55	2007-046 I	COOK	24	1
FED. ROAD DIST. NO. 1	ILLINOIS	CONTRACT NO. 60D36		

D-91-008-08



LOCATION OF SECTION INDICATED THUS: - [black rectangle] -

STATE OF ILLINOIS
DEPARTMENT OF TRANSPORTATION
DIVISION OF HIGHWAYS

SUBMITTED *December 19 2007*
Diane O. Kuffel
DEPUTY DIRECTOR OF HIGHWAYS, REGION ENGINEER
February 1, 2008
Eric E. Harm
JULIEN ENGINEER OF DESIGN AND ENVIRONMENT
February 1, 2008
Christine M. Reed
DIRECTOR OF HIGHWAYS, CHIEF ENGINEER

PRINTED BY THE AUTHORITY
OF THE STATE OF ILLINOIS