

BILL OF MATERIAL

Bar	No.	Size	Length	Shape
a1(E)	36	#6	33'-2"	—
a2(E)	60	#6	30'-5"	—
a3(E)	36	#6	25'-0"	—
a4(E)	60	#6	32'-8"	—
a5(E)	14	#6	36'-0"	—
a6(E)	14	#6	34'-1"	—
c1(E)	16	#5	3'-8"	—
c2(E)	64	#5	2'-7"	—
c3(E)	12	#4	9'-2"	—
c4(E)	12	#4	8'-8"	—
c5(E)	12	#4	7'-8"	—
c6(E)	12	#4	6'-8"	—
d1(E)	40	#5	2'-5"	L
x1(E)	461	#5	3'-3"	—
Concrete Removal		Cu. Yd.	108.0	
Concrete Superstructure		Cu. Yd.	121.5	
Bridge Deck Grooving		Sq. Yd.	123	
Protective Coat		Sq. Yd.	200	
Reinforcement Bars		Pound	12,460	
Epoxy Coated				

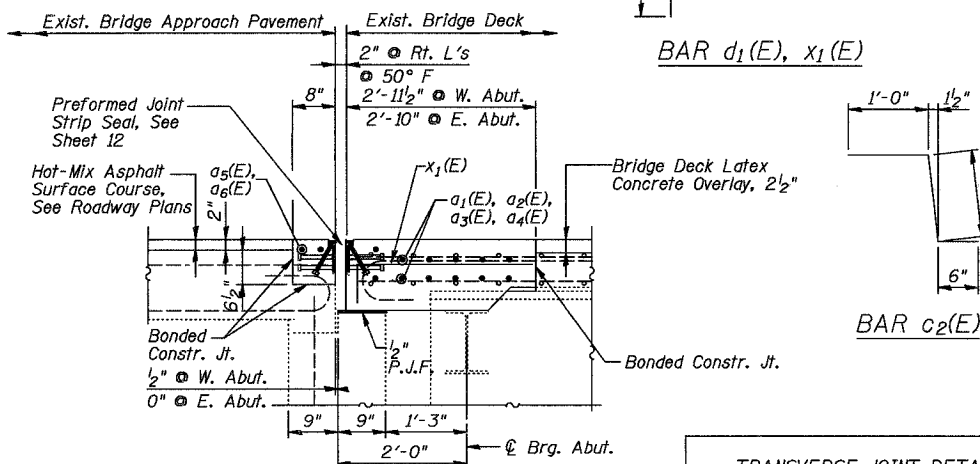
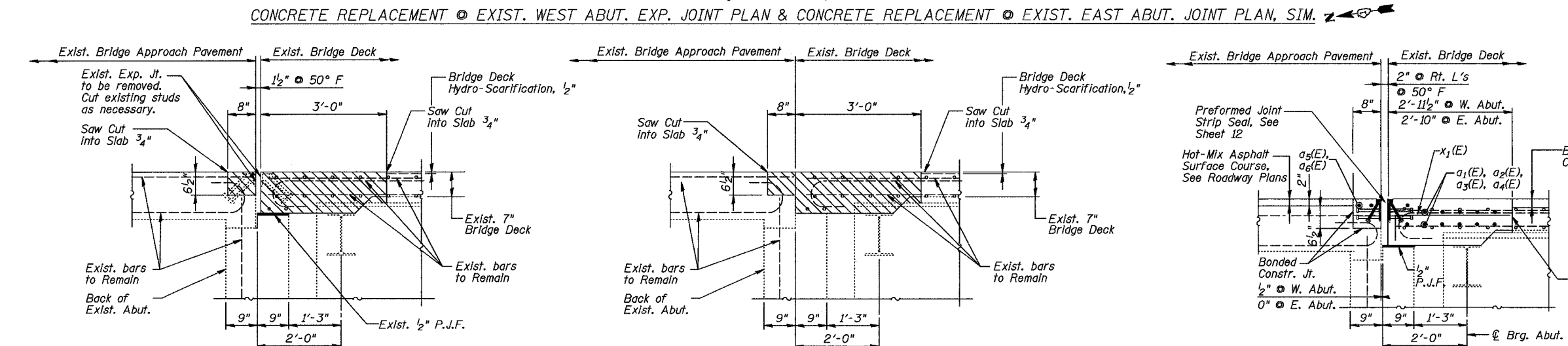
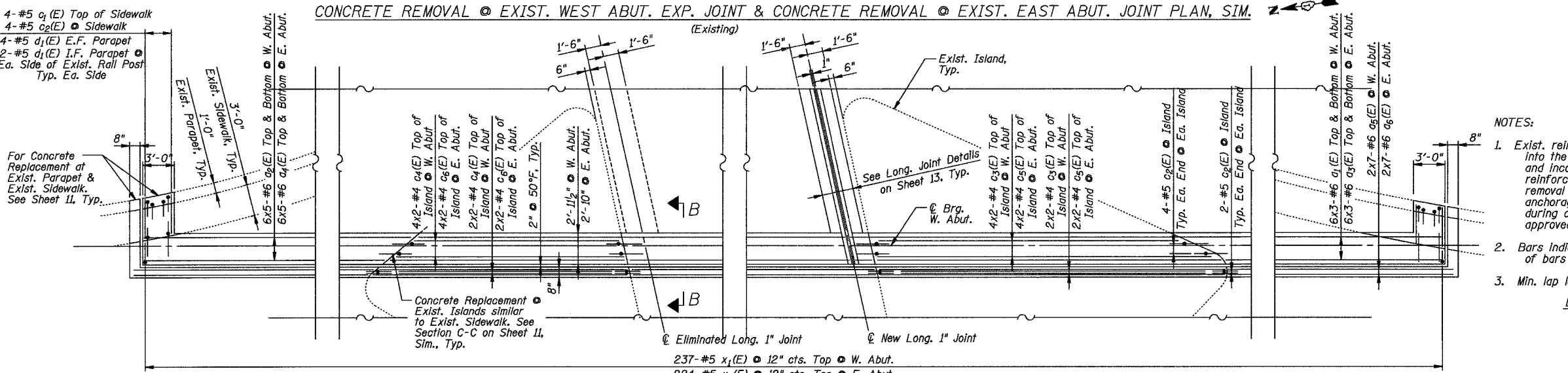
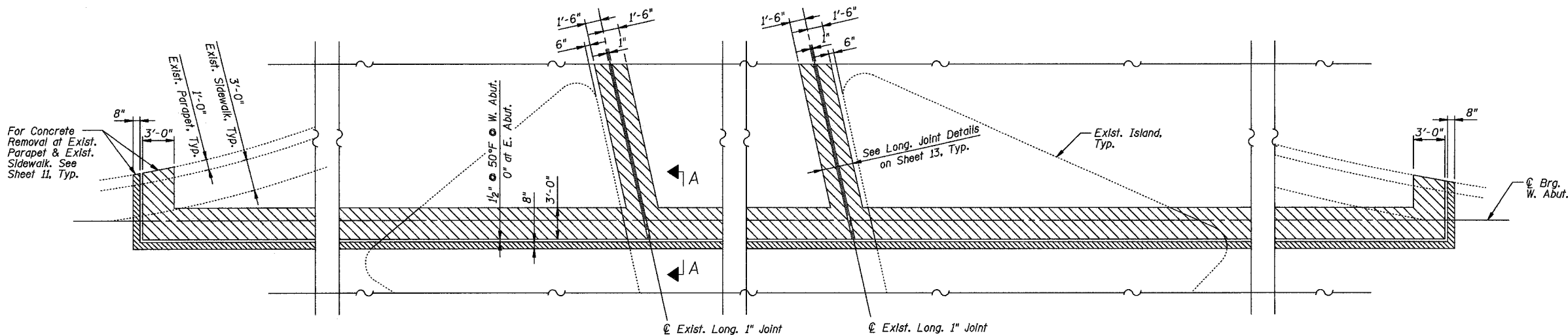

DESIGNED	S.D.H.
CHECKED	J.A.Z.
DRAWN	M.S.M.
CHECKED	S.D.H.

SECTION A-A
(West Abutment)
(Existing)

SECTION A-A
(East Abutment)
(Existing)

SECTION B-B
(West & East Abutment)

Note:
Dimensions are based on a Rolled Rail Strip Seal Joint.
If the Contractor elects to use the Welded Rail Strip Seal Joint, deck dimensions may require adjustments to satisfy the details on Base Sheet E.J-SSJ as shown on Sheet 12.

- NOTES:
1. Exist. reinforcement bars & shear studs extending into the removal areas shall be cleaned, straightened and incorporated into the new construction. Any reinforcement bars that are damaged during concrete removal shall be replaced with approved bar splicer or anchorage system. Any shear studs that are damaged during concrete removal shall be replaced with approved equal. Cost included with Concrete Removal.
 2. Bars Indicated thus 6x3-#6 etc. Indicates 6 lines of bars with 3 lengths per line.
 3. Min. lap lengths:

Bar Size	Lap
#4	1'-8"
#6	2'-7"

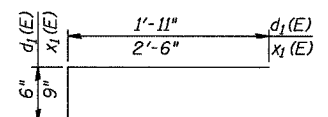

BAR d1(E), x1(E)

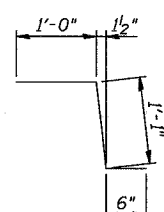

BAR c2(E)

TRANSVERSE JOINT DETAILS
FAP 541 (GRAND AVE.) OVER
IL RTE. 137 (AMSTUTZ EXPY.)
SECTION 9 HB-1-1
LAKE COUNTY
STATION 6+46.04
S.N. 049-0118
DATE: 03-27-08
GRAEF, ANHALT, SCHLOEMER & ASSOCIATES INC
CHICAGO ILLINOIS