

F.A.P. RTE.	SECTION	COUNTY	TOTAL SHEETS	SHEET NO.
351	2008-001VB	COOK	579	81
STA. 40+875		TO STA. 41+000		
FED. ROAD DIST. NO.		ILLINOIS	FED. AID PROJECT	
CONTRACT NO. 60E10				

DRAINAGE STRUCTURE TABLE STA. 40+875 TO STA. 41+000

NO.	STA.	OFFSET	STRUCTURE TYPE/SIZE			FRAME & GRATE	INVERT				RIM ELEV
			MH	CB	INL		N	S	E	W	
P04	40+902.000	8.250 LT		A3		T-24			183.856		185.074
P05	40+905.250	8.250 RT		A3		T-24			183.816	185.034	185.034
EX.MH	40+900	0.665 RT						183.680	183.733	183.774	185.246

FINAL SURVEYED	BY	DATE
SURVEY PLOTTED		
NOTE BOOK TEMPLATE		
AREAS CHECKED		
NO.		

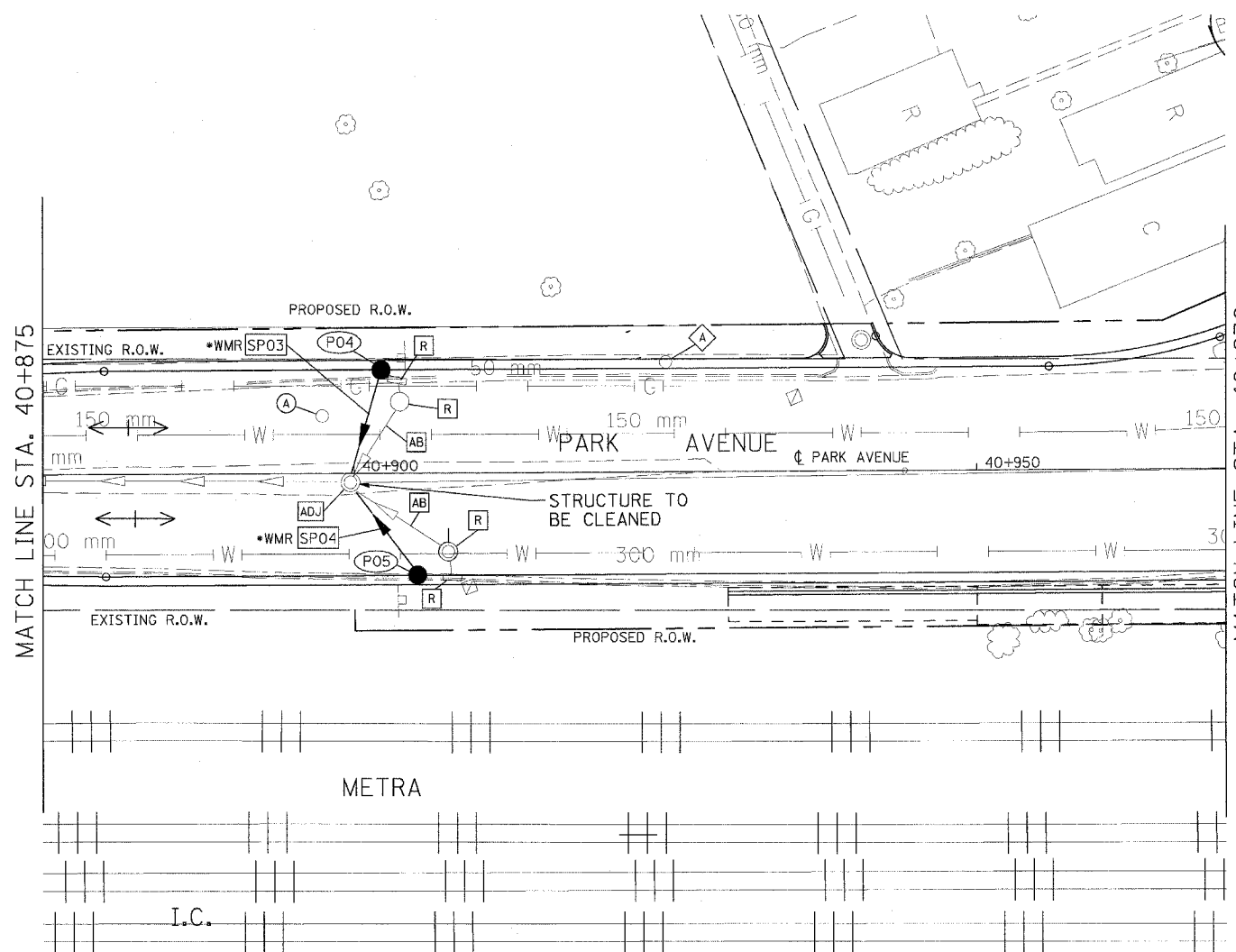

STA. 40+970 TO STA. 41+000 -  
SEE U.S. ROUTE 6 DRAINAGE  
AND UTILITIES SHEETS  
FOR PLAN DETAILS

**DRAINAGE TABLE LEGEND**  
A3 = TYPE C, 0.6m DIAMETER  
A4 = TYPE A, 1.2m DIAMETER  
A5 = TYPE A, 1.5m DIAMETER  
A6 = TYPE A, 1.8m DIAMETER  
A7 = TYPE A, 2.1m DIAMETER  
\*WMR = WATER MAIN REQUIREMENTS

**NOTE:**  
STRUCTURE OFFSET LOCATIONS GIVEN ON  
THE PLANS ARE TO THE FOLLOWING POINTS  
A) FOR STRUCTURES FALLING IN THE CURB  
LINE - TO THE EDGE OF PAVEMENT  
B) FOR ALL OTHER STRUCTURE LOCATIONS -  
TO THE CENTER OF THE STRUCTURE

PIPE TABLE STA. 40+875 TO STA. 41+000

PIPE NO.	PIPE LOCATION		DESCRIPTION	DIA. (mm)	L (M)	S (%)	TRENCH BACKFILL VOLUME (CU M)
	FROM STR. #	TO STR. #					
SP03	P04	EX MH	SS, WMR	300	8.2	1.00	3.1
SP04	P05	EX MH	SS, WMR	300	8.3	1.00	3.3

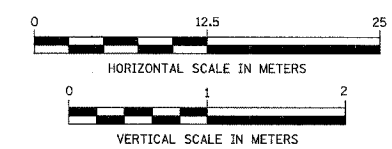

ORIGINAL SURVEYED	BY	DATE
SURVEY PLOTTED		
NOTE BOOK TEMPLATE		
AREAS CHECKED		
NO.		

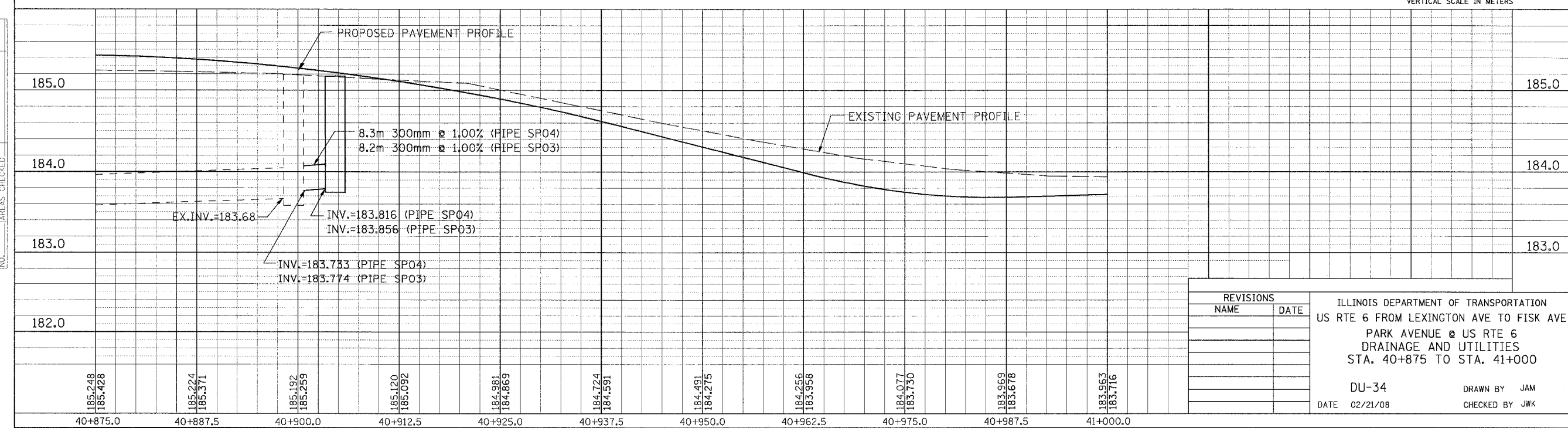

REVISIONS	
NAME	DATE

ILLINOIS DEPARTMENT OF TRANSPORTATION  
US RTE 6 FROM LEXINGTON AVE TO FISK AVE  
PARK AVENUE @ US RTE 6  
DRAINAGE AND UTILITIES  
STA. 40+875 TO STA. 41+000

DU-34  
DATE 02/21/08  
DRAWN BY JAM  
CHECKED BY JWK