



STS Consultants Ltd.
Consulting Engineers
STS PROJECT NO.: 32646

DRAWN BY: C.D. 1-10-02
CHECKED BY: SEK 1-10-02
APPROVED BY: TDB 1-10-02

BY	DATE
FINAL SURVEY	
SURVEY CORRECTED	
NOTE BOOKS RECALCULATED	
AREAS CHECKED	
NO.	

BY	DATE
ORIGINAL SURVEY	
SURVEY CORRECTED	
NOTE BOOKS RECALCULATED	
AREAS CHECKED	
NO.	

X:\PROJECTS\32646\PROFILES
2+700-2+825.dwg
04/10/2002 13:36

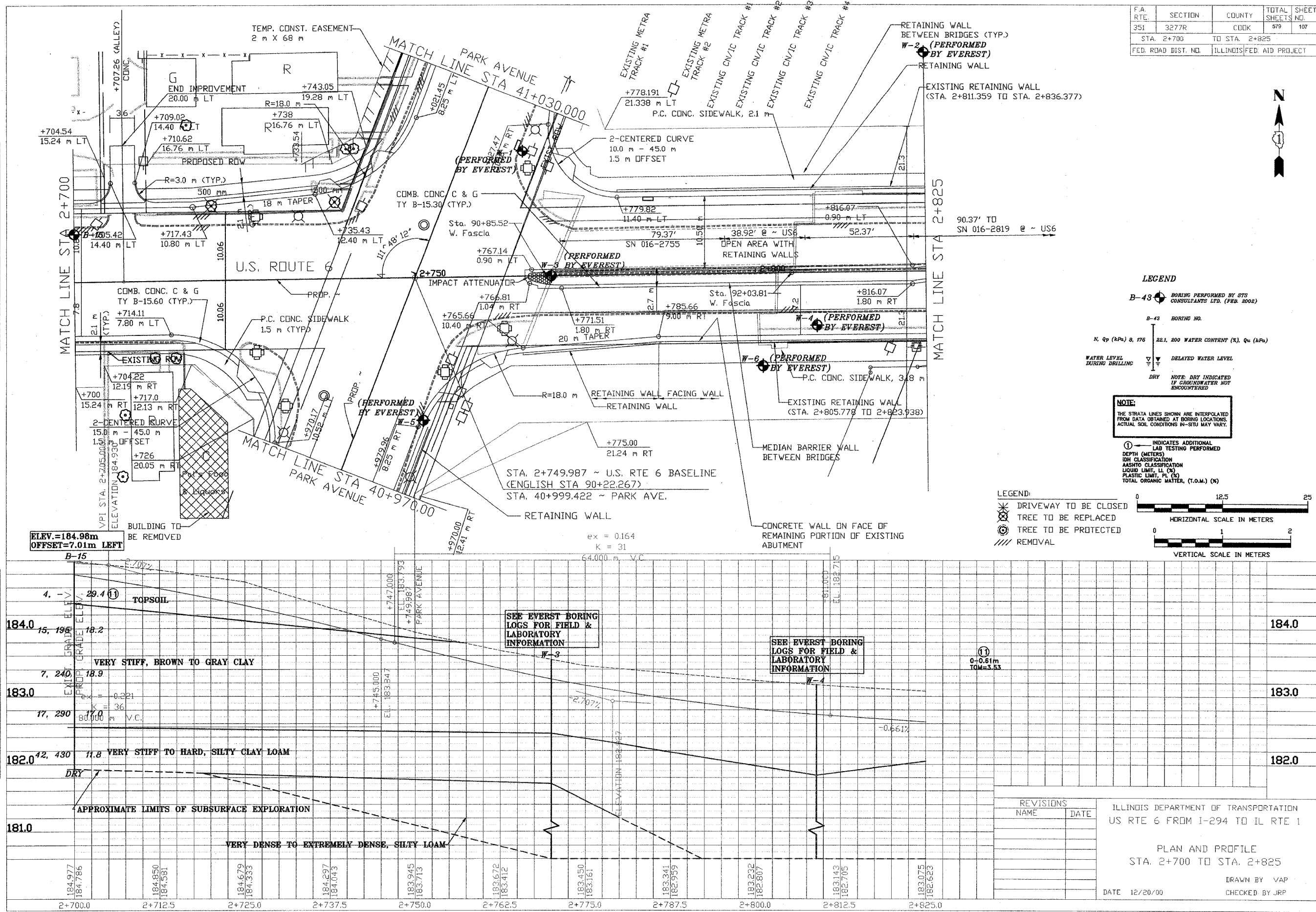

F.A. RTE.	SECTION	COUNTY	TOTAL SHEETS NO.	SHEET NO.
351	3277R	COOK	979	107
STA. 2+700		TO STA. 2+825		
FED. ROAD DIST. NO.		ILLINOIS FED. AID PROJECT		

LEGEND

B-43 BORING PERFORMED BY STS CONSULTANTS LTD. (FEB. 2002)

B-43 BORING NO.

N, Qp (APA) 8, 176 22.1, 200 WATER CONTENT (%), Qu (APA)

WATER LEVEL DURING DRILLING

DELAYED WATER LEVEL

DRY

NOTE: DRY INDICATED IF GROUNDWATER NOT ENCOUNTERED

NOTE:

THE STRATA LINES SHOWN ARE INTERPOLATED FROM DATA OBTAINED AT BORING LOCATIONS. ACTUAL SOIL CONDITIONS IN-SITU MAY VARY.

① INDICATES ADDITIONAL LAB TESTING PERFORMED

DEPTH (METERS)

SOIL CLASSIFICATION

AASHTO CLASSIFICATION

LIQUID LIMIT, LL (%)

PLASTIC LIMIT, PL (%)

TOTAL ORGANIC MATTER, (T.O.M.) (%)

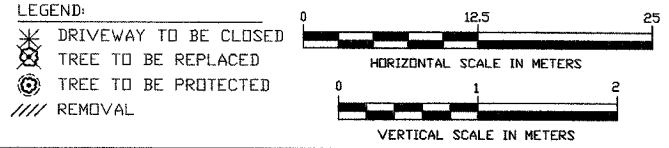

REVISIONS	NAME	DATE

ILLINOIS DEPARTMENT OF TRANSPORTATION
US RTE 6 FROM I-294 TO IL RTE 1

PLAN AND PROFILE
STA. 2+700 TO STA. 2+825

DATE 12/20/00

DRAWN BY VAP
CHECKED BY JRP