



STS Consultants Ltd.
Consulting Engineers

STS PROJECT NO.: 32646

DRAWN BY	CJD	4-10-02
CHECKED BY	SEK	4-10-02
APPROVED BY	TDB	4-10-02

BY	DATE
FINAL SURVEY	
SURVEY PLOTTED	
NOTE BOOK TEMPLATE	
AREAS CHECKED	
NO.	

BY	DATE
ORIGINAL SURVEY	
SURVEY PLOTTED	
NOTE BOOK TEMPLATE	
AREAS CHECKED	
NO.	

X:\PROJECTS\32646\PROFILES\41+030-41+130.dwg
04/09/2002 22:53

F.A. RTE.	SECTION	COUNTY	TOTAL SHEETS NO.
351	3277R	COOK	579 113
STA. 41+030	TO STA. 41+130		
FED. ROAD DIST. NO.	ILLINOIS	FED. AID PROJECT	

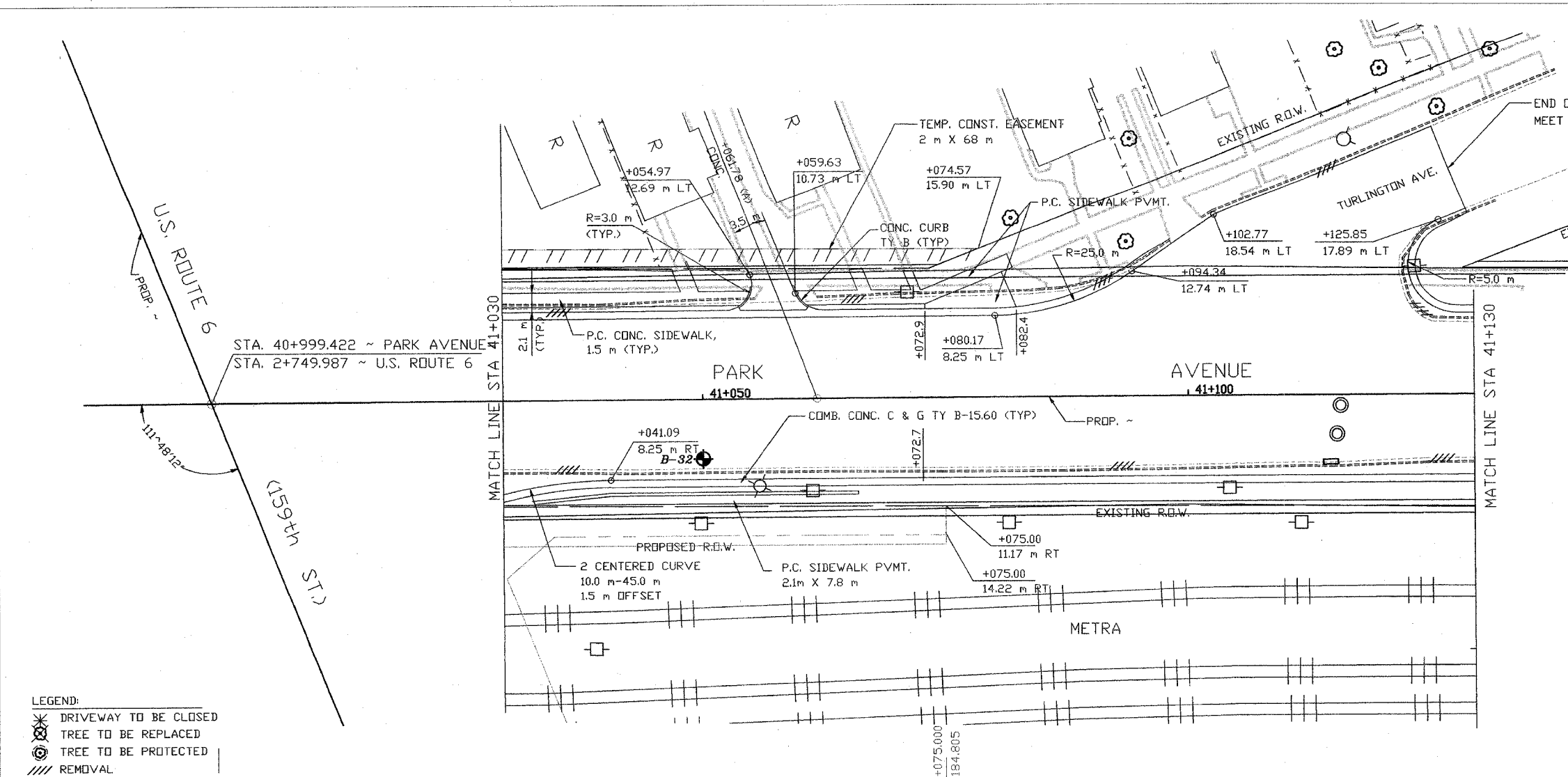

LEGEND:
 ✖ DRIVEWAY TO BE CLOSED
 ✖ TREE TO BE REPLACED
 ⊙ TREE TO BE PROTECTED
 // REMOVAL

LEGEND

B-43 BORING PERFORMED BY STS CONSULTANTS LTD (FEB. 2002)

B-43 BORING NO.

N, Qp (kPa) & 175 22.1, 200 WATER CONTENT (%), Qu (kPa)

WATER LEVEL DURING DRILLING

DELATED WATER LEVEL

DRY NOTE: DRY INDICATED IF GROUNDWATER NOT ENCOUNTERED

NOTE:
 THE STRATA LINES SHOWN ARE INTERPOLATED FROM DATA OBTAINED AT BORING LOCATIONS. ACTUAL SOIL CONDITIONS IN-SITU MAY VARY.

HORIZONTAL SCALE IN METERS: 0, 12.5, 25

VERTICAL SCALE IN METERS: 0, 1, 2

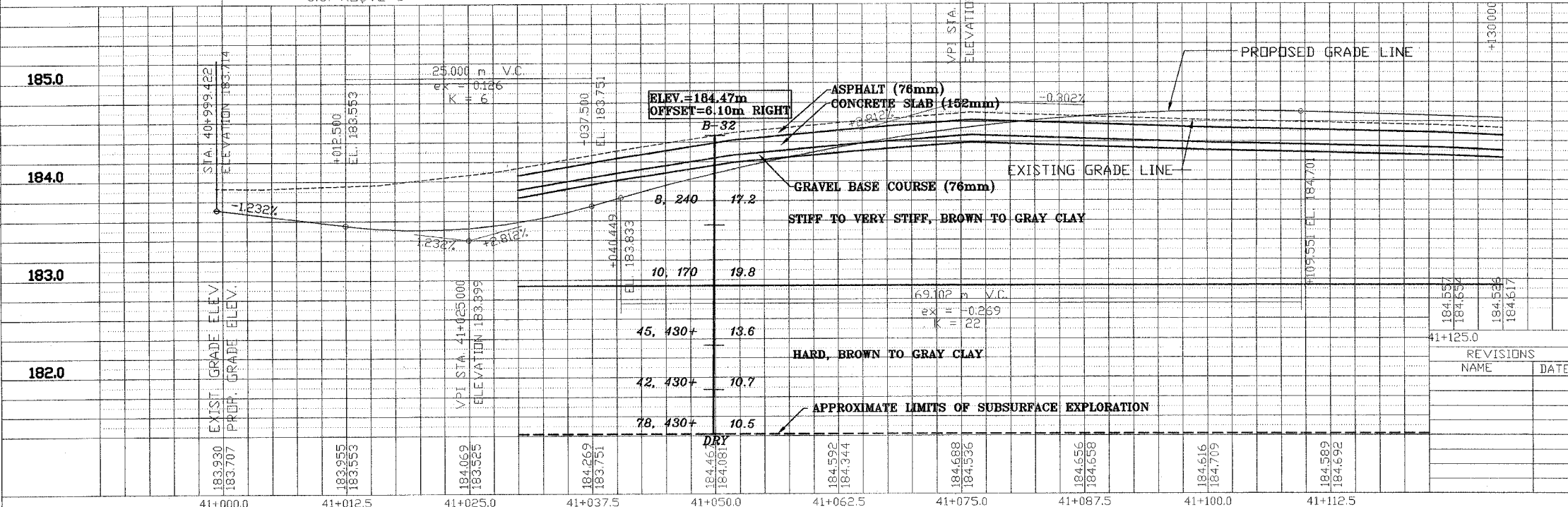

REVISIONS	
NAME	DATE

ILLINOIS DEPARTMENT OF TRANSPORTATION
 US RTE 6 FROM I-294 TO IL RTE 1
 PARK AVENUE
 PLAN AND PROFILE
 STA. 41+030 TO STA. 41+130

DRAWN BY VAP
 CHECKED BY JRP

DATE 12/20/00