

F.A.P. RTE.	SECTION	COUNTY	TOTAL SHEETS	SHEET NO.
351	2008-001VB	COOK	579	126
STA.	TO STA.			
FED. ROAD DIST. NO.	ILLINOIS	FED. AID PROJECT		
CONTRACT NO. 60E10				

**NOTES:**

1. THE LOCATION OF THE LONGITUDINAL CONSTRUCTION JOINTS MAY VARY, DEPENDING ON THE STAGE CONSTRUCTION OF THE PAVEMENT.
2. SIDE STREET PAVEMENT JOINTS SHALL LINE UP WITH THE CONTRACTION AND CONSTRUCTION JOINTS ON THE MAINLINE PAVEMENT TO AVOID MID-PANEL CRACKING.
3. ALL ELEVATIONS ARE NOTED ON A 4.5m TRANSVERSE GRID AT LANE LINES.
4. ALL ELEVATIONS NOTED ON THIS SHEET ARE 180 m + THE ELEVATION SHOWN ON THE DRAWING.
5. TRANSVERS JOINT SPACING MAY VARY FROM 3.0m TO 4.5m

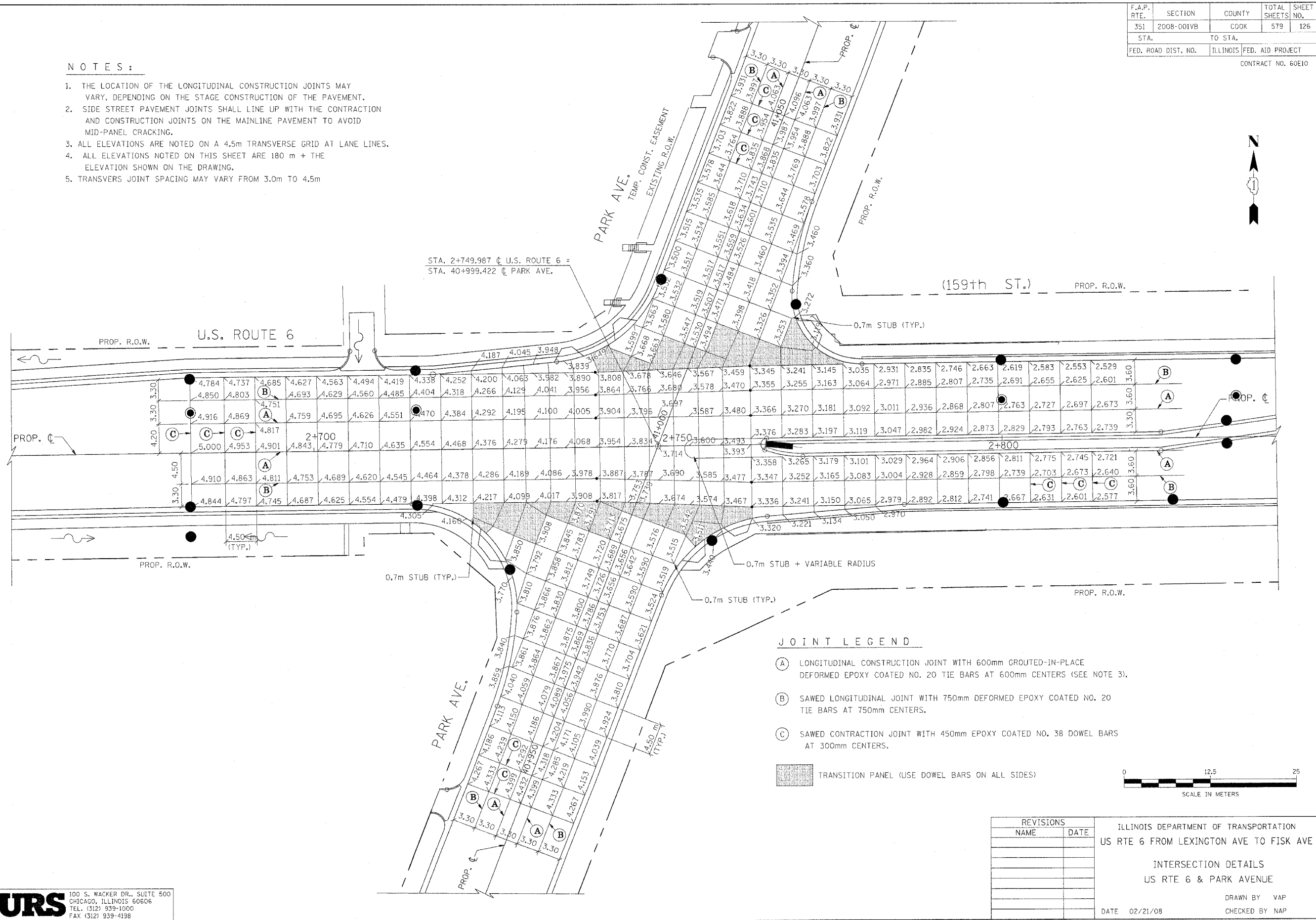

STA. 2+749.987 @ U.S. ROUTE 6 =  
STA. 40+999.422 @ PARK AVE.

**JOINT LEGEND**

- (A) LONGITUDINAL CONSTRUCTION JOINT WITH 600mm GROUTED-IN-PLACE DEFORMED EPOXY COATED NO. 20 TIE BARS AT 600mm CENTERS (SEE NOTE 3).
- (B) SAWED LONGITUDINAL JOINT WITH 750mm DEFORMED EPOXY COATED NO. 20 TIE BARS AT 750mm CENTERS.
- (C) SAWED CONTRACTION JOINT WITH 450mm EPOXY COATED NO. 38 DOWEL BARS AT 300mm CENTERS.
- [Hatched Box] TRANSITION PANEL (USE DOWEL BARS ON ALL SIDES)

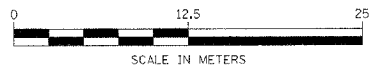

REVISIONS	
NAME	DATE

ILLINOIS DEPARTMENT OF TRANSPORTATION  
US RTE 6 FROM LEXINGTON AVE TO FISK AVE  
  
INTERSECTION DETAILS  
US RTE 6 & PARK AVENUE  
  
DRAWN BY VAP  
CHECKED BY NAP  
DATE 02/21/08