

F.A. RTE.	SECTION	COUNTY	TOTAL SHEETS	SHEET NO.
351	3277R	COOK	579	143
STA.		TO STA.		
FED. ROAD DIST. NO.		ILLINOIS	FED. AID PROJECT	60E10

TRAFFIC SIGNAL LEGEND

- | | | |
|--------------------------------------|--|--|
| CONTROLLER | | |
| SERVICE INSTALLATION | | |
| SIGNAL HEAD | | |
| SIGNAL HEAD WITH BACKPLATE | | |
| SIGNAL HEAD PEDESTRIAN | | |
| SIGNAL POST | | |
| MAST ARM ASSEMBLY AND POLE, STEEL | | |
| MAST ARM ASSEMBLY AND POLE, ALUMINUM | | |
| HANDHOLE | | |
| HEAVY DUTY HANDHOLE | | |
| DOUBLE HANDHOLE | | |
| G.S. CONDUIT IN TRENCH OR PUSHED | | |
| PEDESTRIAN PUSHBUTTON DETECTOR | | |
| DETECTOR LOOP | | |
| CAST IRON JUNCTION BOX | | |
| COMMON TRENCH | | |
| UNIT DUCT | | |
| PERFORMED DETECTORS | | |
| EXISTING R.O.W. | | |

TRAFFIC SIGNAL EQUIPMENT STATION OFFSET TABLE

ITEM	STATION	OFFSET
M1	2+725.74	18.00 R
P1	2+722.41	12.67 R
M2	2+732.62	14.71 L
P2	2+744.40	19.20 L
M3	2+772.97	19.51 L
P3	2+762.21	14.01 R
M4	2+755.15	17.75 R
CONTROLLER	2+747.68	26.71 L

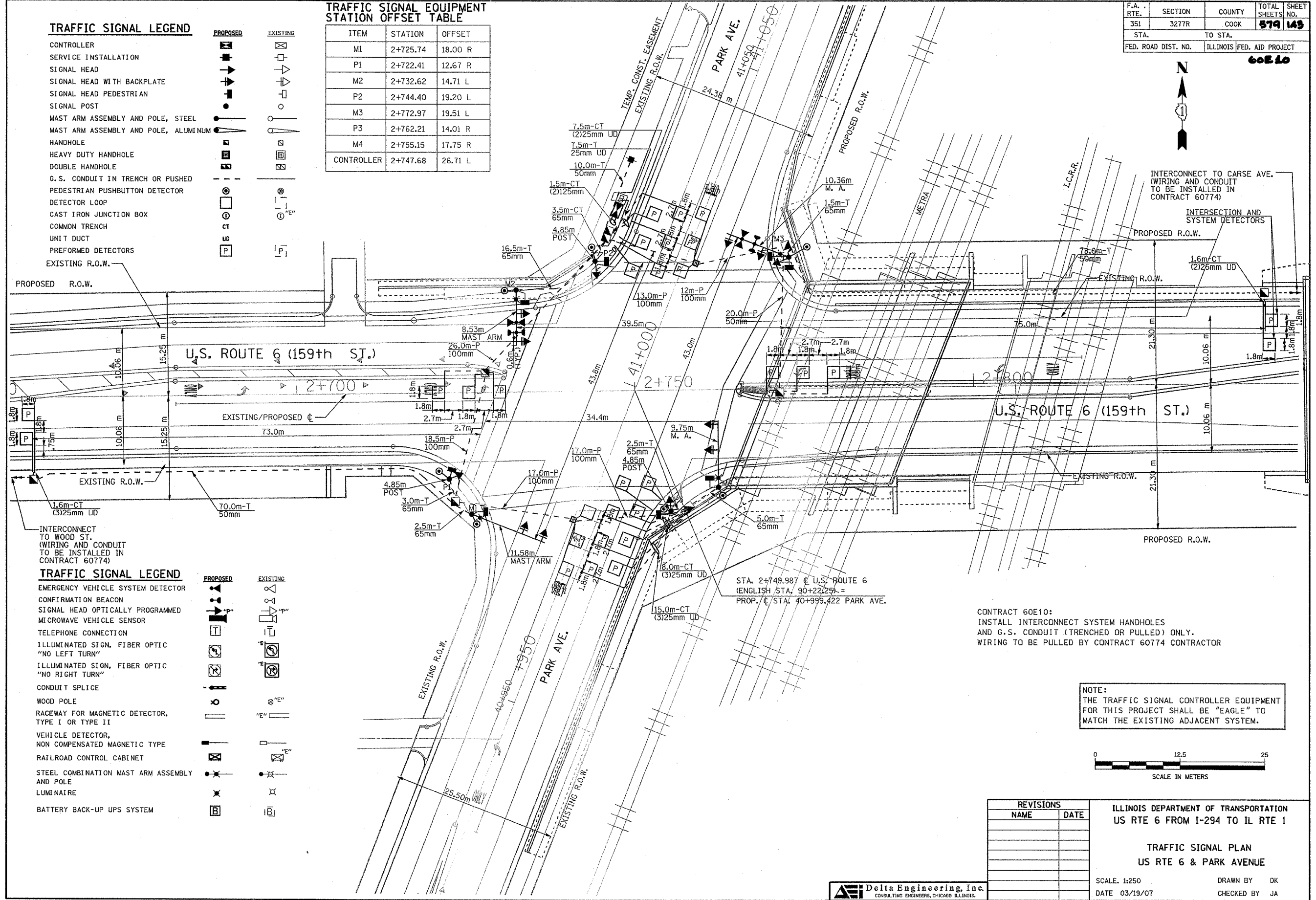

TRAFFIC SIGNAL LEGEND

- | | | |
|--|--|--|
| EMERGENCY VEHICLE SYSTEM DETECTOR | | |
| CONFIRMATION BEACON | | |
| SIGNAL HEAD OPTICALLY PROGRAMMED | | |
| MICROWAVE VEHICLE SENSOR | | |
| TELEPHONE CONNECTION | | |
| ILLUMINATED SIGN, FIBER OPTIC "NO LEFT TURN" | | |
| ILLUMINATED SIGN, FIBER OPTIC "NO RIGHT TURN" | | |
| CONDUIT SPLICE | | |
| WOOD POLE | | |
| RACEWAY FOR MAGNETIC DETECTOR, TYPE I OR TYPE II | | |
| VEHICLE DETECTOR, NON COMPENSATED MAGNETIC TYPE | | |
| RAILROAD CONTROL CABINET | | |
| STEEL COMBINATION MAST ARM ASSEMBLY AND POLE | | |
| LUMINAIRE | | |
| BATTERY BACK-UP UPS SYSTEM | | |

CONTRACT 60E10:
INSTALL INTERCONNECT SYSTEM HANDHOLES AND G.S. CONDUIT (TRENCHED OR PULLED) ONLY. WIRING TO BE PULLED BY CONTRACT 60774 CONTRACTOR

NOTE:
THE TRAFFIC SIGNAL CONTROLLER EQUIPMENT FOR THIS PROJECT SHALL BE "EAGLE" TO MATCH THE EXISTING ADJACENT SYSTEM.

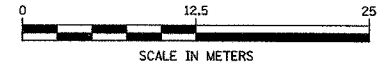

REVISIONS	
NAME	DATE

ILLINOIS DEPARTMENT OF TRANSPORTATION
US RTE 6 FROM I-294 TO IL RTE 1

TRAFFIC SIGNAL PLAN
US RTE 6 & PARK AVENUE

SCALE: 1:250
DATE 03/19/07
DRAWN BY DK
CHECKED BY JA