

60E10

LEGEND

- ⊗ EXISTING LTG. POLE TO BE REMOVED
- ⊙ EXISTING LTG. POLE TO REMAIN "AS IS" ON THE EXISTING CIRCUIT DURING CONSTRUCTION STAGE I ONLY. TO BE REMOVED DURING CONSTRUCTION STAGE II.
- ▭ EXISTING PAVEMENT, SHOULDER CURB & GUTTER TO BE REMOVED BY OTHERS
- AC-XX— TEMPORARY AERIAL CABLE 3-1/C NO. 2 ALUMINUM WITH STEEL MESSENGER WIRE XX-INDICATES LENGTH IN METERS
- ⊙ LIGHT POLE, WOOD, WITH 4.5M MAST ARM AND 400W HPS LUMINAIRES DURING CONSTRUCTION STAGE I ONLY AND TO BE REMOVED DURING CONSTRUCTION STAGE II, SEE NOTE-6 ON SHEET E-1. LETTER DENOTES CIRCUIT IN EXISTING CONTROLLER. "R" - TEMP. POLE TO REMAIN POST-CONSTRUCTION.
- LIGHT POLE, WOOD, FOR SUPPORT OF TEMPORARY AERIAL CABLE DURING CONSTRUCTION STAGE I
- ⊗ EXISTING CONTROLLER TO BE REMOVED AT COMPLETION OF PROJECT
- ▨ CONSTRUCTION STAGE-I
- ▩ TEMPORARY PAVEMENT WITH TEMP. C&G

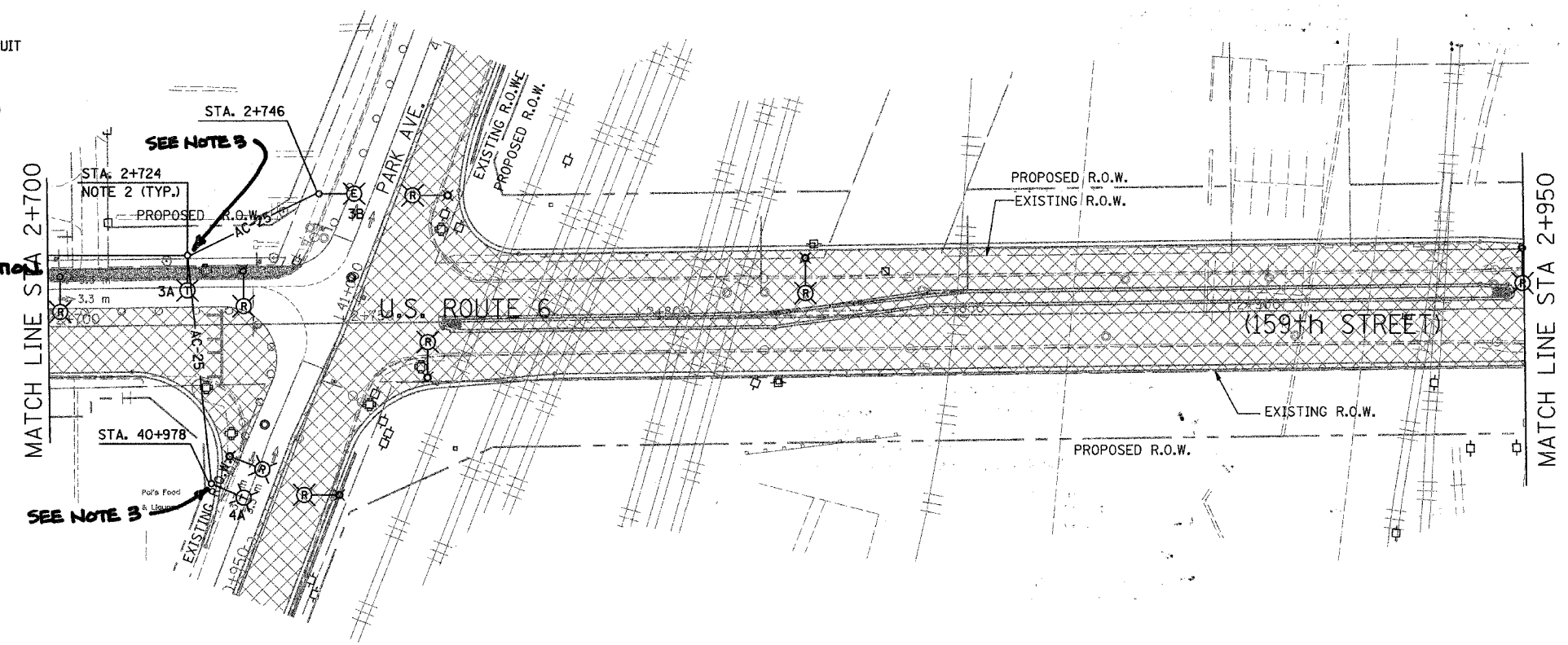

NOTES:

1. REFER TO LIGHTING NOTES ON DRAWING E-1.
2. SETBACK FOR THE TEMPORARY POLES SHALL BE 1.82 M (6') MINIMUM FROM THE BACK OF THE CURB.

3. TEMPORARY SERVICE WOOD POLE. REFER TO CONSTRUCTION AND LIGHTING DETAILS SHEET.

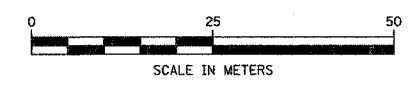
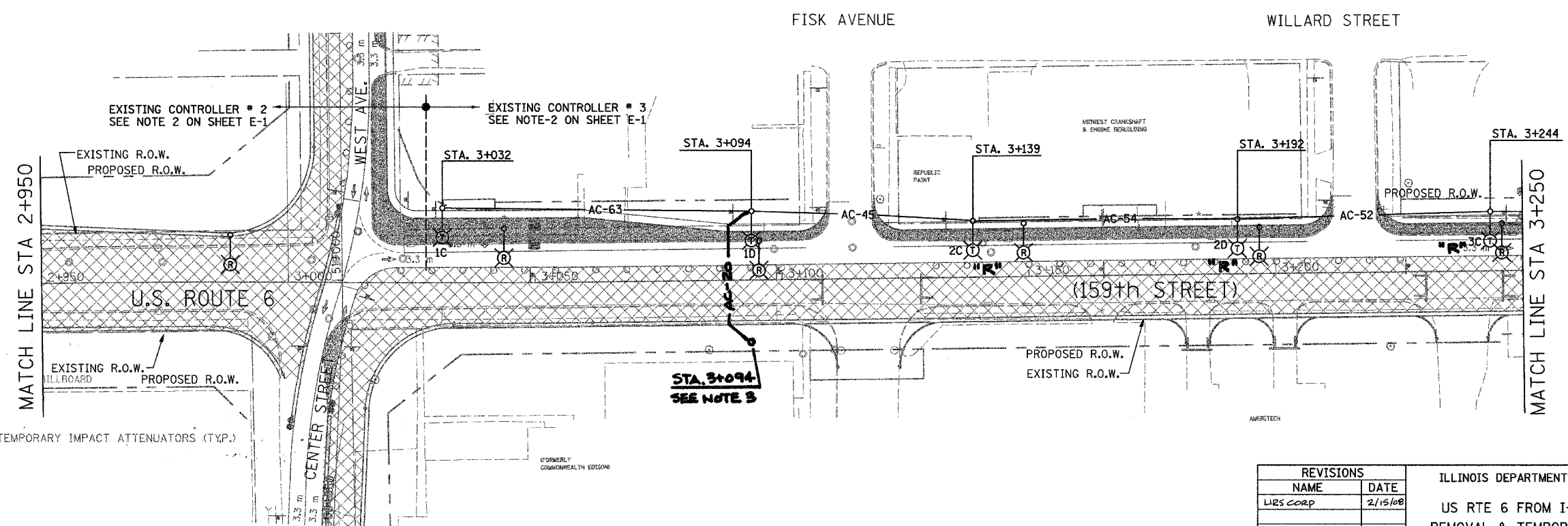

Delta Engineering, Inc.
CONSULTING ENGINEERS, CHICAGO, ILLINOIS.

REVISIONS	
NAME	DATE
LIES CORP	2/15/08

ILLINOIS DEPARTMENT OF TRANSPORTATION
US RTE 6 FROM I-294 TO IL RTE 1
REMOVAL & TEMPORARY LIGHTING PLAN
FROM STA. 2+700 TO STA. 3+250

DATE 12/12/07

DRAWN BY S.S./W.S.
CHECKED BY C.K./H.S.

DRAWING No. E-6