

ROUTE NO.	SECTION	COUNTY	TOTAL SHEETS	SHEET NO.
F.A.P. 351	2008-001VB	COOK	579	264
STA.		TO STA.		
FED. ROAD DIST. NO. 7		ILLINOIS	FED. AID PROJECT	
CONTRACT NO. 60E10				

3/13/2008 2:11:35 PM

q:\17049\track & rail main contract\final plans\ac-seeda-prerouting2.dgn

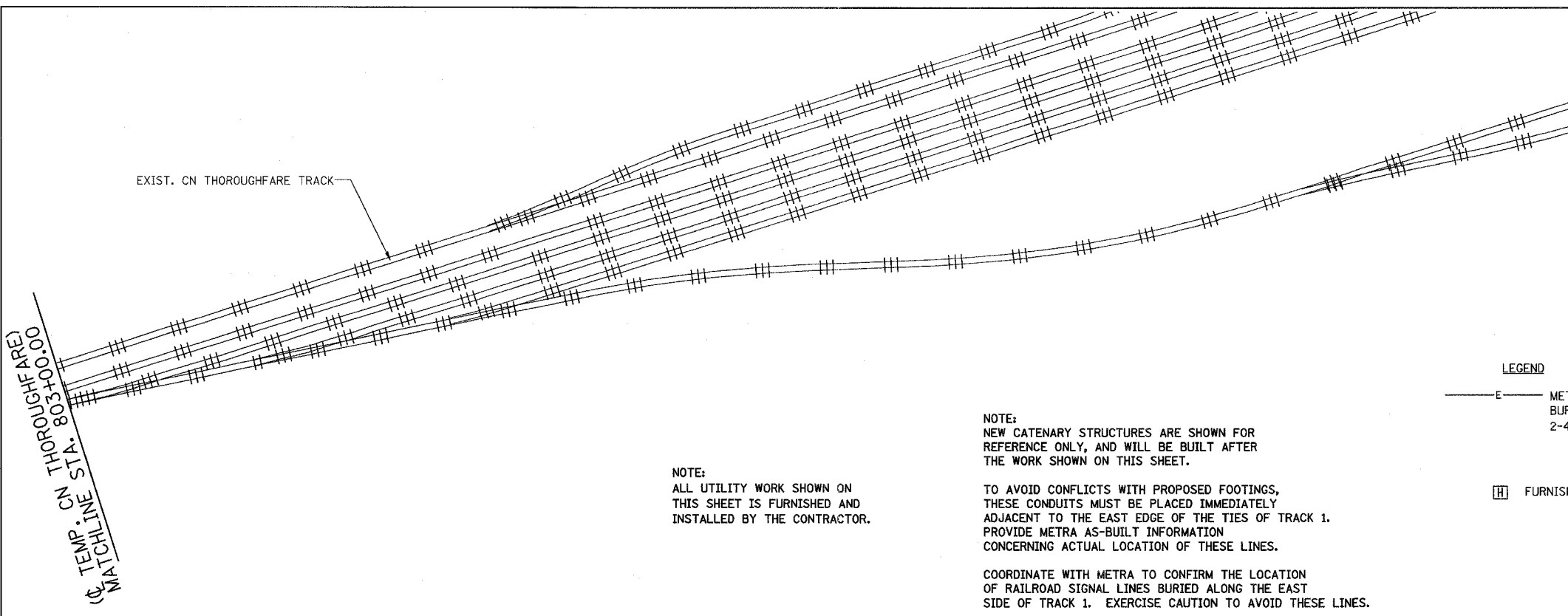

NOTE:
ALL UTILITY WORK SHOWN ON THIS SHEET IS FURNISHED AND INSTALLED BY THE CONTRACTOR.

NOTE:
NEW CATENARY STRUCTURES ARE SHOWN FOR REFERENCE ONLY, AND WILL BE BUILT AFTER THE WORK SHOWN ON THIS SHEET.

TO AVOID CONFLICTS WITH PROPOSED FOOTINGS, THESE CONDUITS MUST BE PLACED IMMEDIATELY ADJACENT TO THE EAST EDGE OF THE TIES OF TRACK 1. PROVIDE METRA AS-BUILT INFORMATION CONCERNING ACTUAL LOCATION OF THESE LINES.

COORDINATE WITH METRA TO CONFIRM THE LOCATION OF RAILROAD SIGNAL LINES BURIED ALONG THE EAST SIDE OF TRACK 1. EXERCISE CAUTION TO AVOID THESE LINES.

- LEGEND**
- E— METRA POWER BURIED UNDERGROUND
 - 2-4" RIGID GALV. STEEL CONDUITS
 - 1- METRA 4160 V, 4/C #2AWG
 - 1- METRA 2400 V, 4/C #2AWG
 - [H] FURNISH AND INSTALL HANDHOLE

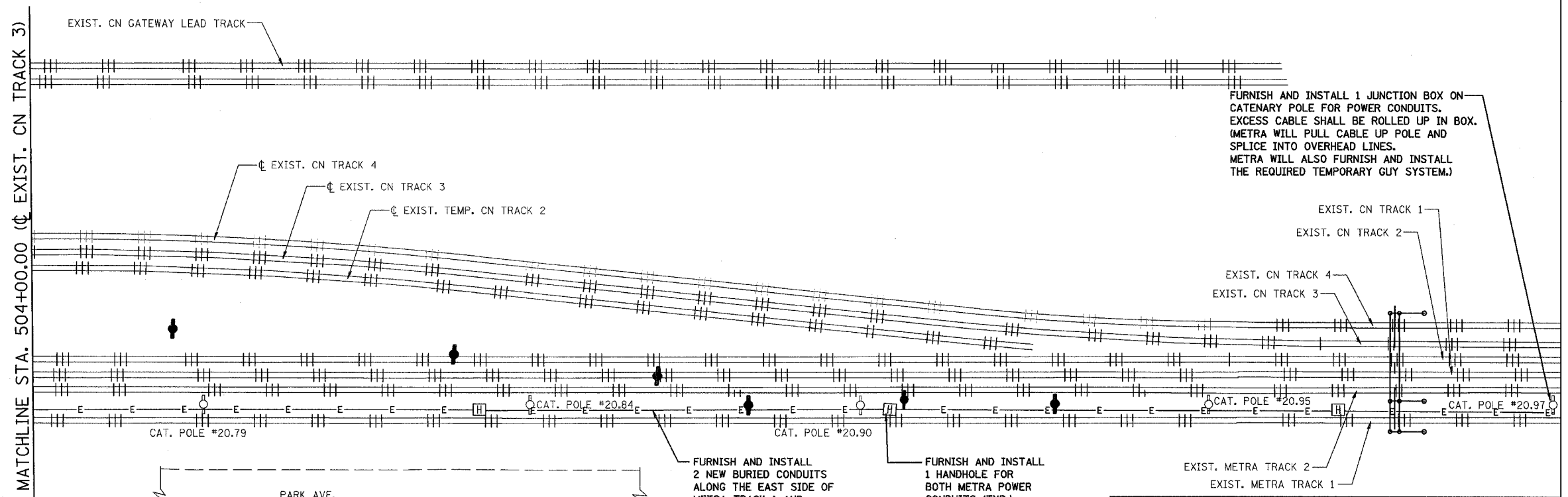

FURNISH AND INSTALL 1 JUNCTION BOX ON CATENARY POLE FOR POWER CONDUITS. EXCESS CABLE SHALL BE ROLLED UP IN BOX. (METRA WILL PULL CABLE UP POLE AND SPLICE INTO OVERHEAD LINES. METRA WILL ALSO FURNISH AND INSTALL THE REQUIRED TEMPORARY GUY SYSTEM.)

FURNISH AND INSTALL 2 NEW BURIED CONDUITS ALONG THE EAST SIDE OF METRA TRACK 1 AND PULL NEW CABLES. (FUTURE REMOVAL ALSO INCLUDED)

FURNISH AND INSTALL 1 HANDHOLE FOR BOTH METRA POWER CONDUITS (TYP.)

REVISIONS	
NAME	DATE

ILLINOIS DEPARTMENT OF TRANSPORTATION
US RTE 6 FROM I-294 TO IL RTE 1
METRA & CN OVER 159TH STREET

METRA UTILITIES
AC & SCADA ROUTING - PHASE 1

SHT. 2 OF 5
DATE 2/21/2008

DRAWN BY SOI
CHECKED BY DAD

