

ROUTE NO.	SECTION	COUNTY	TOTAL SHEETS	SHEET NO.
F.A.P. 351	2008-001VB	COOK	579	266
STA.		TO STA.		
FED. ROAD DIST. NO. 7		ILLINOIS	FED. AID PROJECT	

CONTRACT NO. 60E10

3/13/2008 2:11:36 PM

q:\17049\069\track & rail main contract\final plans\ac-scada_routing2.dgn

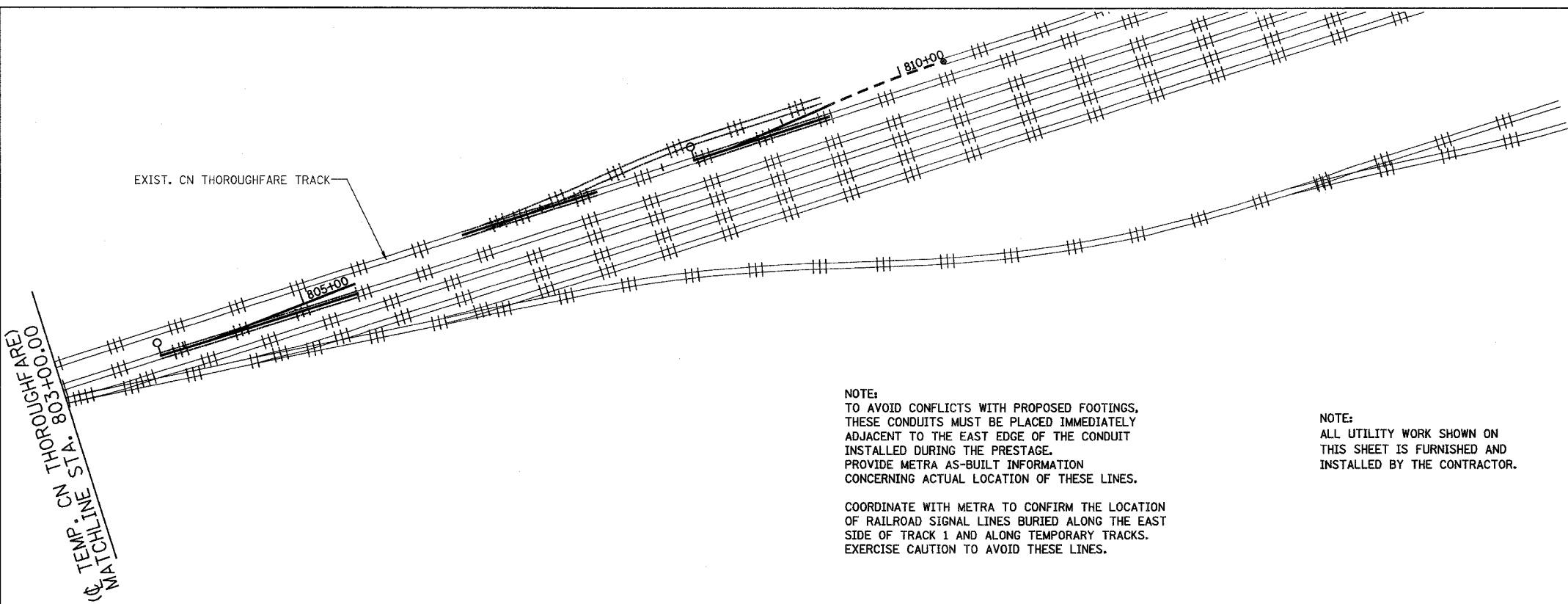

NOTE:
TO AVOID CONFLICTS WITH PROPOSED FOOTINGS, THESE CONDUITS MUST BE PLACED IMMEDIATELY ADJACENT TO THE EAST EDGE OF THE CONDUIT INSTALLED DURING THE PRESTAGE. PROVIDE METRA AS-BUILT INFORMATION CONCERNING ACTUAL LOCATION OF THESE LINES.

COORDINATE WITH METRA TO CONFIRM THE LOCATION OF RAILROAD SIGNAL LINES BURIED ALONG THE EAST SIDE OF TRACK 1 AND ALONG TEMPORARY TRACKS. EXERCISE CAUTION TO AVOID THESE LINES.

NOTE:
ALL UTILITY WORK SHOWN ON THIS SHEET IS FURNISHED AND INSTALLED BY THE CONTRACTOR.

- LEGEND**
- METRA POWER & FIBER BURIED UNDERGROUND
 - 3-4" RIGID GALV. STEEL CONDUITS
 - 1- METRA 4160 V. 4/C #2AWG
 - 1- METRA 2400 V. 4/C #2AWG
 - 1- METRA FIBER, COMMSCOPE PART #0-024-CA-8W-F12NS
 - 2 CONDUITS FOR 4160V & 2400V POWER INSTALLED DURING PRESTAGE
 - FURNISH AND INSTALL HANDHOLES
 - CATENARY SUPPORT STRUCTURE

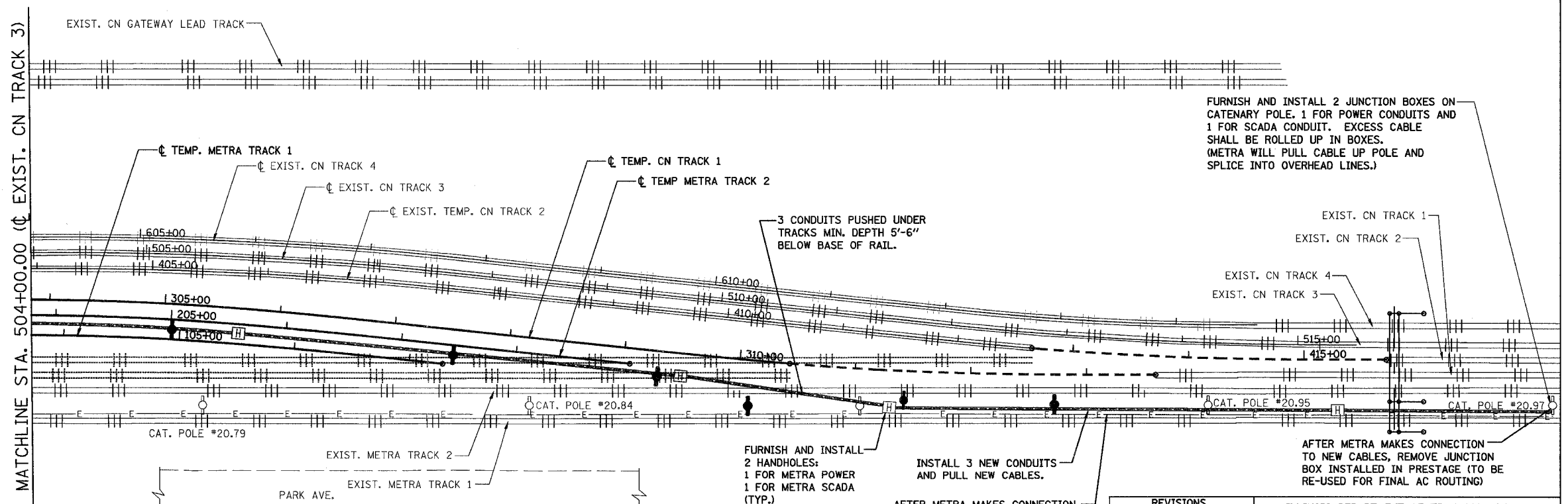

FURNISH AND INSTALL 2 JUNCTION BOXES ON CATENARY POLE. 1 FOR POWER CONDUITS AND 1 FOR SCADA CONDUIT. EXCESS CABLE SHALL BE ROLLED UP IN BOXES. (METRA WILL PULL CABLE UP POLE AND SPLICE INTO OVERHEAD LINES.)

FURNISH AND INSTALL 2 HANDHOLES: 1 FOR METRA POWER 1 FOR METRA SCADA (TYP.)

INSTALL 3 NEW CONDUITS AND PULL NEW CABLES.

AFTER METRA MAKES CONNECTION TO NEW CABLES, REMOVE 2 CONDUITS AND CABLE INSTALLED IN PRESTAGE (PORTIONS OF CONDUITS TO BE RE-USED FOR FINAL AC ROUTING)

AFTER METRA MAKES CONNECTION TO NEW CABLES, REMOVE JUNCTION BOX INSTALLED IN PRESTAGE (TO BE RE-USED FOR FINAL AC ROUTING)

REVISIONS	
NAME	DATE

ILLINOIS DEPARTMENT OF TRANSPORTATION
US RTE 6 FROM I-294 TO IL RTE 1
METRA & CN OVER 159TH STREET

METRA UTILITIES
AC & SCADA ROUTING - PHASE 2

SHT. 4 OF 5
DATE 2/21/2008

DRAWN BY SOI
CHECKED BY DAD

