

ROUTE NO.	SECTION	COUNTY	TOTAL SHEETS	SHEET NO.
F.A.P. 351	2008-001VB	COOK	579	269
STA.		TO STA.		
FED. ROAD DIST. NO. 7		ILLINOIS		FED. AID PROJECT
CONTRACT NO. 60E10				

4/14/2008 8:13:20 AM

q:\17049\069\signal work for metra\plans\02-prestage-signal-routing2.dgn

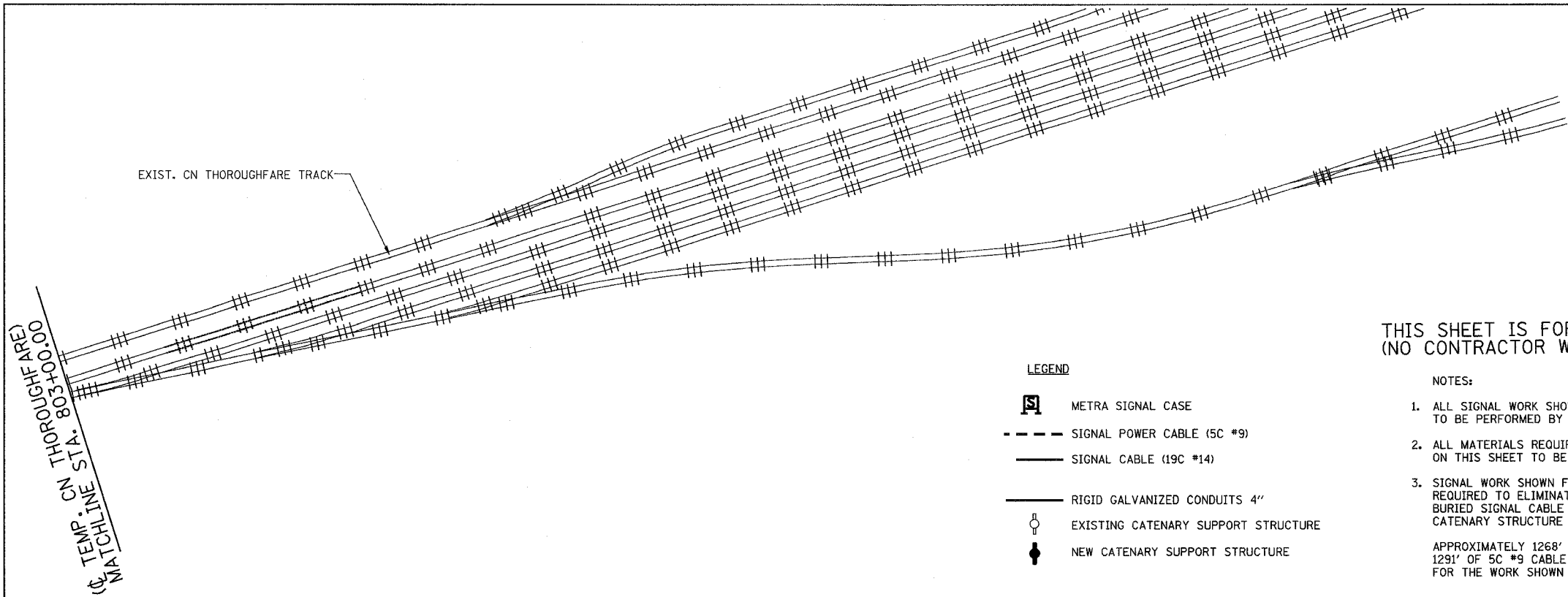

THIS SHEET IS FOR REFERENCE ONLY  
(NO CONTRACTOR WORK)

- LEGEND**
- METRA SIGNAL CASE
  - SIGNAL POWER CABLE (5C #9)
  - SIGNAL CABLE (19C #14)
  - RIGID GALVANIZED CONDUITS 4"
  - EXISTING CATENARY SUPPORT STRUCTURE
  - NEW CATENARY SUPPORT STRUCTURE

- NOTES:**
- ALL SIGNAL WORK SHOWN ON THIS SHEET TO BE PERFORMED BY METRA.
  - ALL MATERIALS REQUIRED FOR WORK SHOWN ON THIS SHEET TO BE FURNISHED BY METRA.
  - SIGNAL WORK SHOWN FOR THIS PRESTAGE IS REQUIRED TO ELIMINATE CONFLICT OF EXISTING BURIED SIGNAL CABLE WITH PROPOSED CATENARY STRUCTURE FOUNDATIONS.
- APPROXIMATELY 1268' OF 19C #14 CABLE AND 1291' OF 5C #9 CABLE SHALL BE PROVIDED BY METRA FOR THE WORK SHOWN ON THIS SHEET.

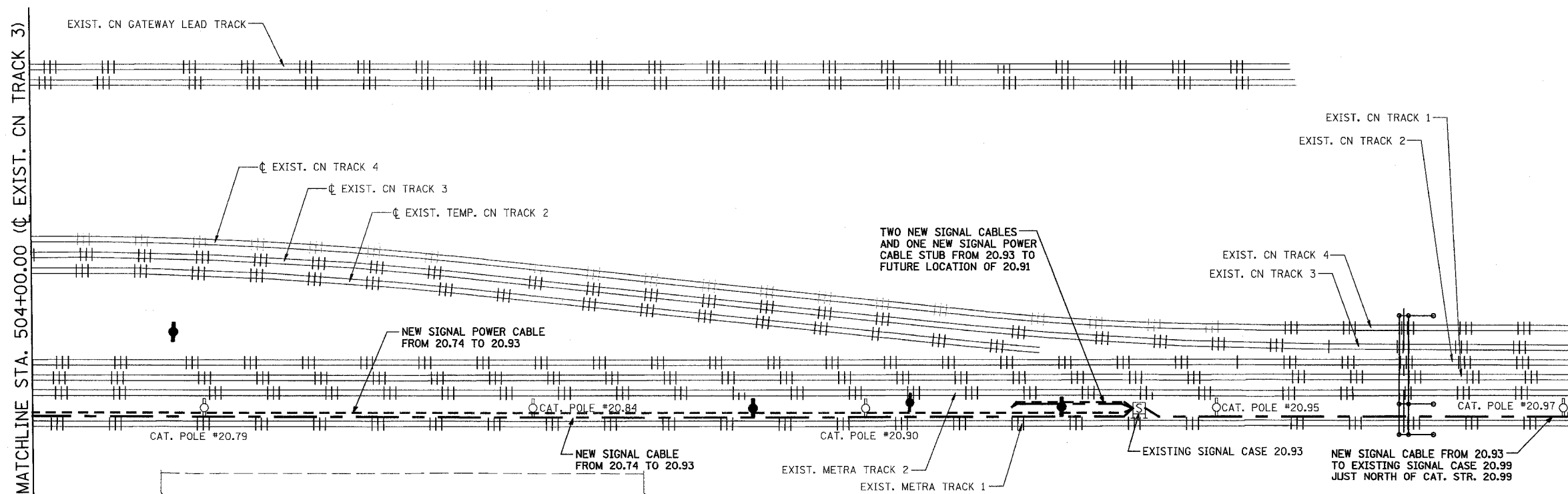

MATCHLINE STA. 504+00.00 (EXIST. CN TRACK 3)



**NOTE:**  
NEW CATENARY STRUCTURES ARE SHOWN FOR REFERENCE ONLY, AND WILL BE BUILT AFTER THE SIGNAL WORK SHOWN ON THIS SHEET.

TO AVOID CONFLICTS WITH FOOTINGS OF THESE NEW STRUCTURES, THE NEW SIGNAL CABLE MUST BE PLACED IMMEDIATELY ADJACENT TO THE EAST END OF THE TIES OF TRACK 1.

METRA TO PROVIDE AS-BUILT INFORMATION CONCERNING ACTUAL LOCATION OF THESE LINES.

REVISIONS	
NAME	DATE

ILLINOIS DEPARTMENT OF TRANSPORTATION  
US RTE 6 FROM I-294 TO IL RTE 1  
METRA OVER 159TH STREET

**METRA SIGNALS**  
TEMP SIGNAL ROUTING (PRESTAGE-SOUTH)

SHT. S6-02 OF S6-36      DRAWN BY MAD  
DATE 4/11/2008      CHECKED BY AB