

3/13/2008 5:50:11 PM

C:\17049.06\structures\retaining walls\main cent-ret walls under bridges along us 6\21 s96-97.mxd

STATE OF ILLINOIS
DEPARTMENT OF TRANSPORTATION

ROUTE NO.	SECTION	COUNTY	TOTAL SHEETS	SHEET NO.
F.A.P. 351	2008-001VB	COOK	579	523
FED. ROAD DIST. NO. 7		ILLINOIS	FED. AID PROJECT-	
CONTRACT NO. 60E10				

SHEET NO. 21
24 SHEETS

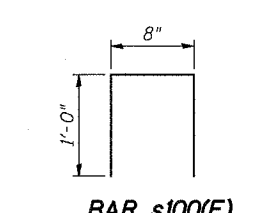
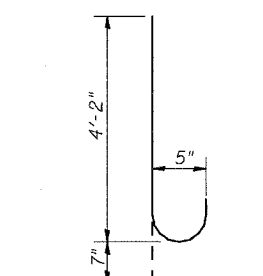
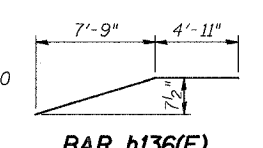
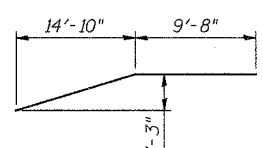
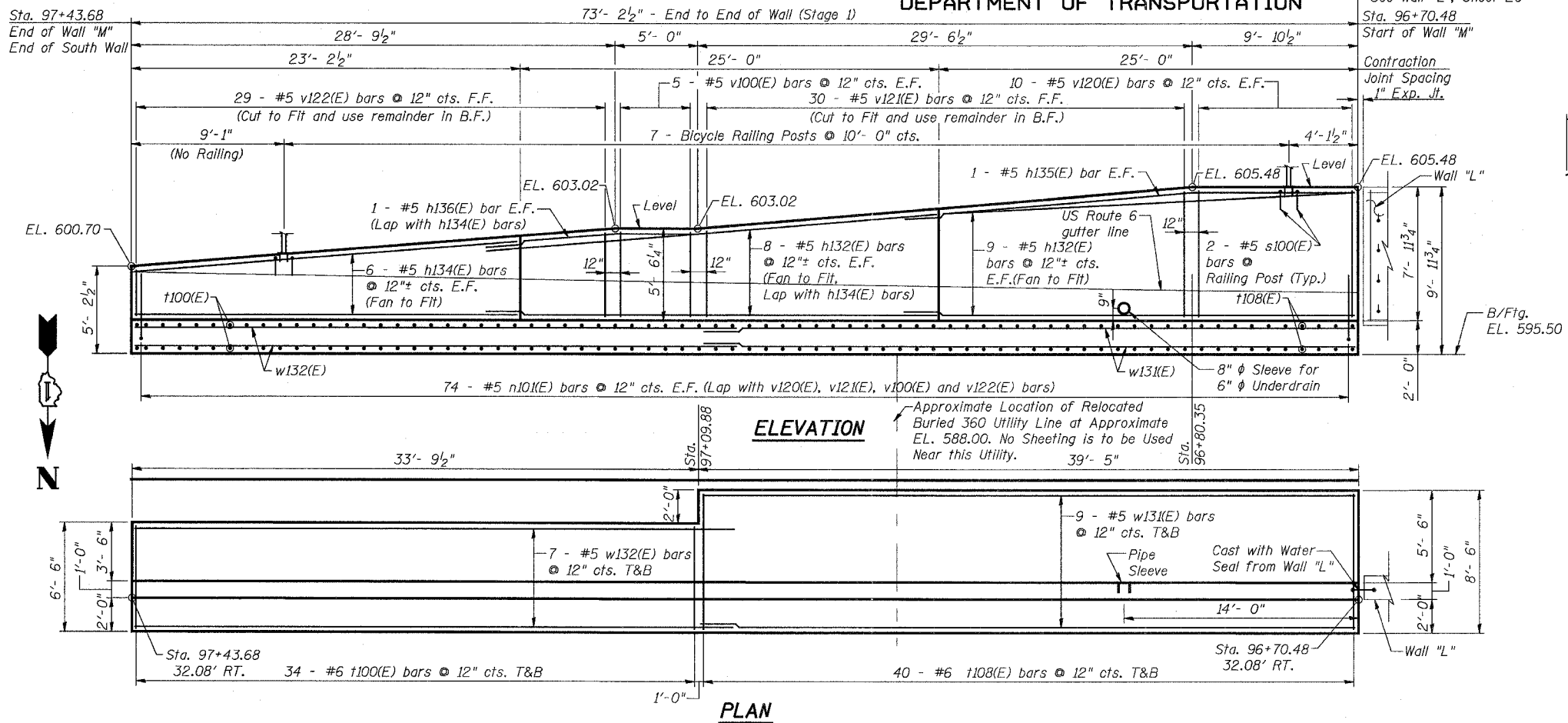

**BILL OF MATERIAL
RETAINING WALL "M"**

Bar	No.	Size	Length	Shape	
h132(E)	34	#5	27'-2"		
h134(E)	12	#5	22'-11"		
h135(E)	2	#5	24'-7"		
h136(E)	2	#5	12'-8"		
n10(E)	148	#5	4'-11"	U	
s100(E)	14	#5	2'-8"	□	
t100(E)	68	#6	6'-2"		
t108(E)	80	#6	8'-2"		
v100(E)	12	#5	5'-3"		
v120(E)	20	#5	7'-8"		
v121(E)	30	#5	13'-2"		
v122(E)	30	#5	8'-3"		
w131(E)	20	#5	39'-1"		
w132(E)	14	#5	36'-0"		
Porous Granular Embankment				Cu. Yd.	79
Structure Excavation				Cu. Yd.	241
Concrete Structures				Cu. Yd.	56.1
Reinforcement Bars, Epoxy Coated				Pound	5,980
Pipe Underdrain For Structures 6"				Foot	73
Geocomposite Wall Drain				Sq. Yd.	36
Non-Special Waste Disposal				Cu. Yd.	241.1

- Notes:
- Minimum Bar Laps are as follows:
#5 = 2'-2"
#6 = 2'-7"
 - For details of Bicycle Railing, see Sheet 23.
 - Bars indicated thus: 2x5 - #5 etc. indicates 2 lines of bars with 5 lengths of bars per line.
 - Cost of pipe sleeve is included with Concrete Structures.
 - ** Excavation for placing Porous Granular Embankment is included in cost of Braced Excavation & Structure Excavation.
 - Porous Granular Embankment shall be compacted to 95% Modified Proctor Density and its coarse aggregate gradation shall be CA 18.

Legend:
F.F. = Front Face
B.F. = Back Face
E.F. = Each Face
T&B = Top & Bottom

* See Miscellaneous Details For Retaining Walls A-M sheet for Pipe Underdrain Detail

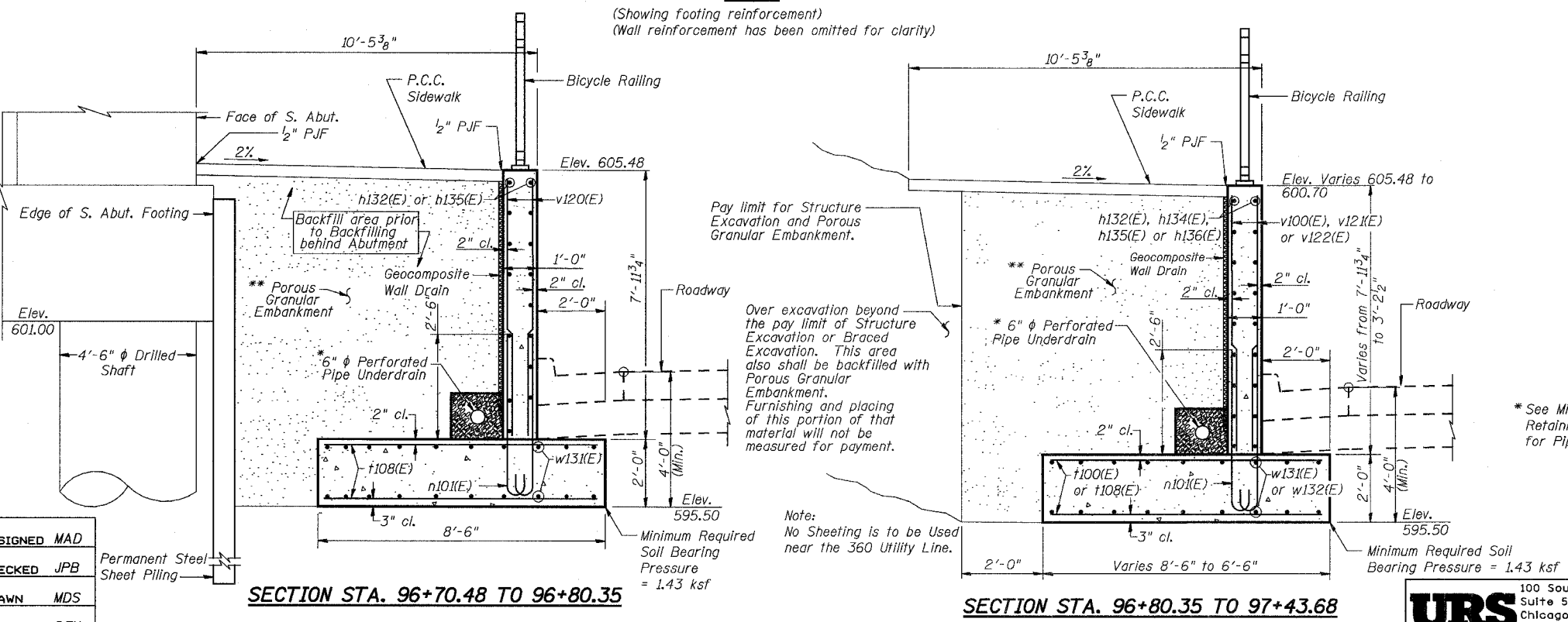

DESIGNED	MAD
CHECKED	JPB
DRAWN	MDS
CHECKED	DEY

Permanent Steel Sheet Piling

REVISIONS	
NAME	DATE

ILLINOIS DEPARTMENT OF TRANSPORTATION
US RTE 6 FROM I-294 TO IL RTE 1
RETAINING WALL "M"
STA. 96+70.48 TO 97+43.68
U.S. 6 MAINLINE RETAINING WALLS
ALONG 159TH STREET
SCALE: DATE: 2/21/2008

URS
100 South Wacker Drive,
Suite 500
Chicago, IL 60606
(312) 939-1000