

MATCH LINE STA. 300+00

MATCH LINE STA. 315+00

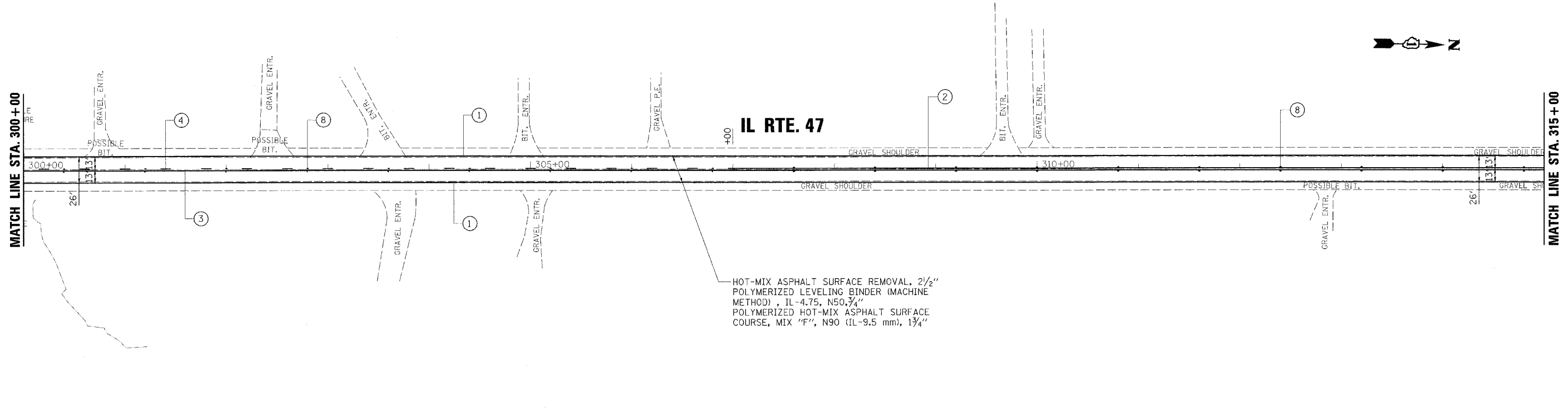

HOT-MIX ASPHALT SURFACE REMOVAL, 2 1/2"  
 POLYMERIZED LEVELING BINDER (MACHINE METHOD), IL-4.75, N50, 3/4"  
 POLYMERIZED HOT-MIX ASPHALT SURFACE COURSE, MIX "F", N90 (IL-9.5 mm), 1 3/4"

MATCH LINE STA. 315+00

MATCH LINE STA. 326+93.78

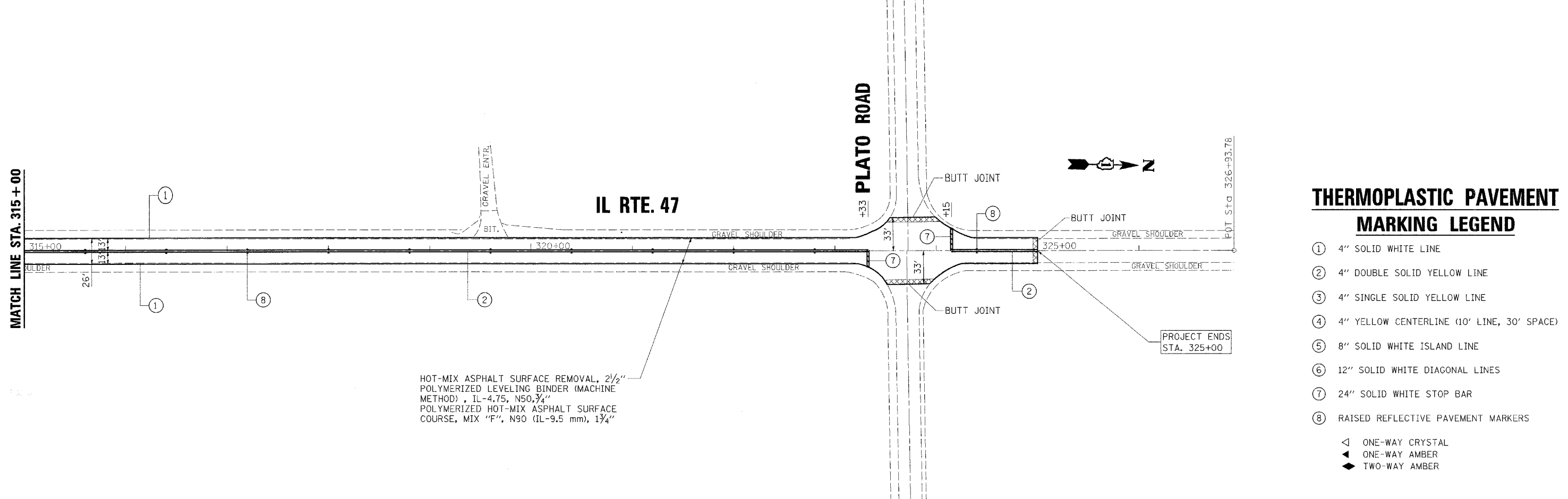

HOT-MIX ASPHALT SURFACE REMOVAL, 2 1/2"  
 POLYMERIZED LEVELING BINDER (MACHINE METHOD), IL-4.75, N50, 3/4"  
 POLYMERIZED HOT-MIX ASPHALT SURFACE COURSE, MIX "F", N90 (IL-9.5 mm), 1 3/4"

**THERMOPLASTIC PAVEMENT MARKING LEGEND**

- ① 4" SOLID WHITE LINE
  - ② 4" DOUBLE SOLID YELLOW LINE
  - ③ 4" SINGLE SOLID YELLOW LINE
  - ④ 4" YELLOW CENTERLINE (10' LINE, 30' SPACE)
  - ⑤ 8" SOLID WHITE ISLAND LINE
  - ⑥ 12" SOLID WHITE DIAGONAL LINES
  - ⑦ 24" SOLID WHITE STOP BAR
  - ⑧ RAISED REFLECTIVE PAVEMENT MARKERS
- ◀ ONE-WAY CRYSTAL  
 ▲ ONE-WAY AMBER  
 ◆ TWO-WAY AMBER

PLOT DATE = 4/23/2009  
 PLOT TIME = 11:12:55 AM  
 USER NAME = jmorris  
 MODEL =



200 West Front Street  
 Wheaton, IL 60187

DESIGNED - LCM	REVISED -
DRAWN - JMT	REVISED -
CHECKED - BLB	REVISED -
DATE - 3/28/08	REVISED -

STATE OF ILLINOIS  
 DEPARTMENT OF TRANSPORTATION

**IL ROUTE 47  
 EXISTING & PROPOSED ROADWAY PLAN**

SCALE: 1"=50' SHEET NO. 11 OF 11 SHEETS STA. 300+00 TO STA. 325+00

F.A.P. RTE.	SECTION	COUNTY	TOTAL SHEETS	SHEET NO.
326	106X-RS-6	KANE	23	16
CONTRACT NO. 60E19				

FED. ROAD DIST. NO. 1 ILLINOIS FED. AID PROJECT