 HOT-MIX ASPHALT SURFACE REMOVAL - BUTT JOINT  
TEMPORARY RAMPS

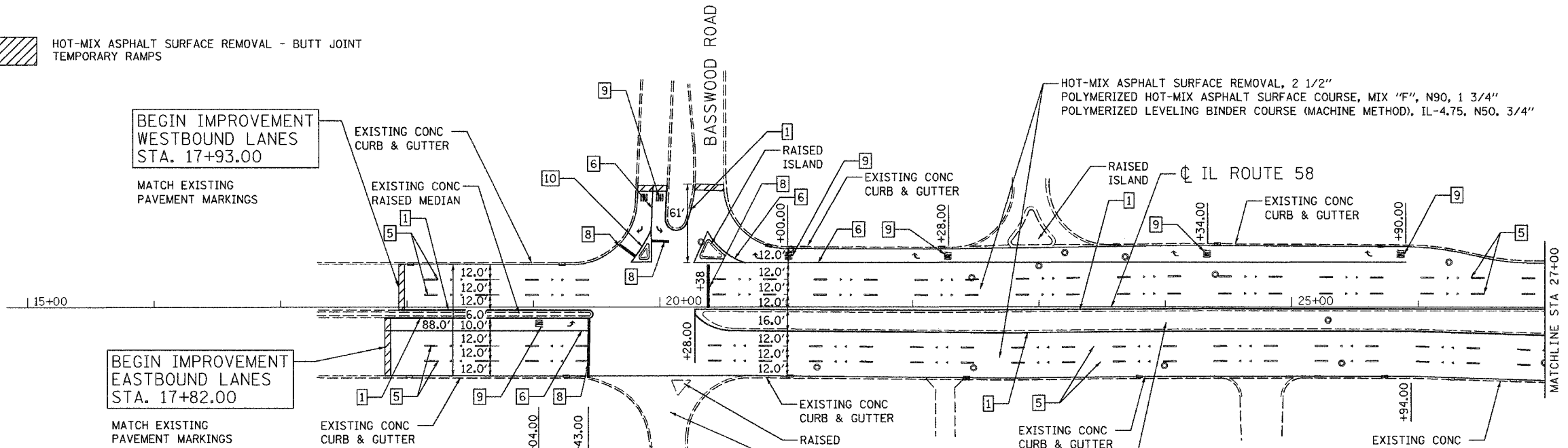

**LEGEND:**

- |   |  |
|---|--|
| 1 THERMOPLASTIC PAVEMENT MARKING - LINE 4" (YELLOW SOLID LINE)  | 6 THERMOPLASTIC PAVEMENT MARKING - LINE 6" (WHITE SOLID LINE)      |
| 2 THERMOPLASTIC PAVEMENT MARKING - LINE 4" (YELLOW SKIP DASH - 10' DASH, 30' SKIP)                          | 7 THERMOPLASTIC PAVEMENT MARKING - LINE 12" (YELLOW DIAGONAL LINE) |
| 3 THERMOPLASTIC PAVEMENT MARKING - LINE 4" (DOUBLE YELLOW SOLID LINE)                                       | 8 THERMOPLASTIC PAVEMENT MARKING - LINE 24" (WHITE STOP LINE)      |
| 4 THERMOPLASTIC PAVEMENT MARKING - LINE 6" (WHITE LANE LINE - 2' DASH, 6' SKIP)                             | 9 THERMOPLASTIC PAVEMENT MARKING - LETTERS & SYMBOLS (TYP.)        |
| 5 THERMOPLASTIC PAVEMENT MARKING - LINE 4" (WHITE LANE LINE - 10' DASH, 30' SKIP W/ 2 CRYSTAL/OPAQUE RPM'S) | 10 THERMOPLASTIC PAVEMENT MARKING - LINE 8" (WHITE SOLID LINE)     |

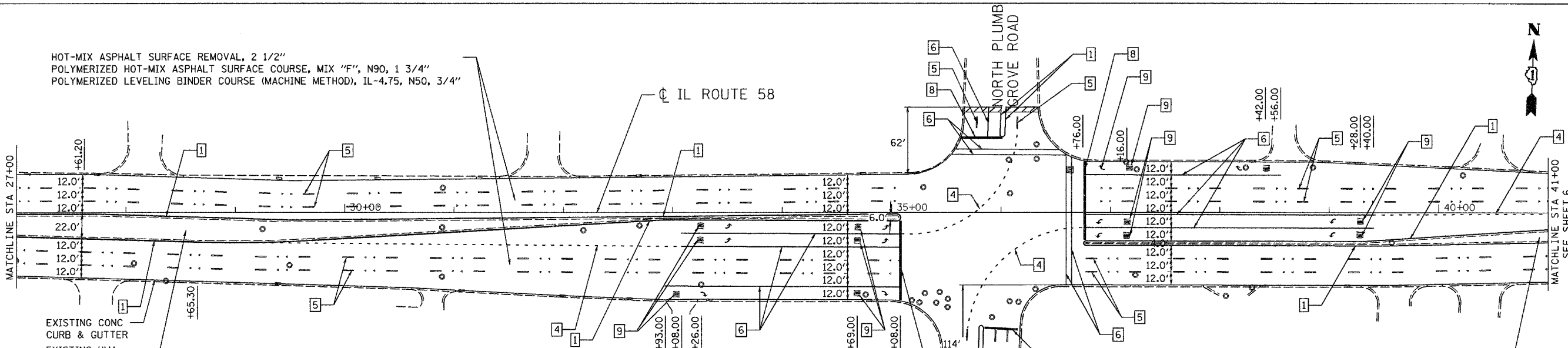

**LEGEND:**

- |   |  |
|---|--|
| 1 THERMOPLASTIC PAVEMENT MARKING - LINE 4" (YELLOW SOLID LINE)  | 6 THERMOPLASTIC PAVEMENT MARKING - LINE 6" (WHITE SOLID LINE)      |
| 2 THERMOPLASTIC PAVEMENT MARKING - LINE 4" (YELLOW SKIP DASH - 10' DASH, 30' SKIP)                          | 7 THERMOPLASTIC PAVEMENT MARKING - LINE 12" (YELLOW DIAGONAL LINE) |
| 3 THERMOPLASTIC PAVEMENT MARKING - LINE 4" (DOUBLE YELLOW SOLID LINE)                                       | 8 THERMOPLASTIC PAVEMENT MARKING - LINE 24" (WHITE STOP LINE)      |
| 4 THERMOPLASTIC PAVEMENT MARKING - LINE 6" (WHITE LANE LINE - 2' DASH, 6' SKIP)                             | 9 THERMOPLASTIC PAVEMENT MARKING - LETTERS & SYMBOLS (TYP.)        |
| 5 THERMOPLASTIC PAVEMENT MARKING - LINE 4" (WHITE LANE LINE - 10' DASH, 30' SKIP W/ 2 CRYSTAL/OPAQUE RPM'S) | 10 THERMOPLASTIC PAVEMENT MARKING - LINE 8" (WHITE SOLID LINE)     |

FILE NAME: N:\PROJECTS\3229\3229\_38\Drawings\Proposed\Plan\3229\_38proposed.dgn

**Ciorba Group, Inc.**  
CONSULTING ENGINEERS  
5507 North Cumberland Avenue, Suite 402  
Chicago, Illinois 60656  
Tel. 773.775.4009 Fax 773.775.4014

USER NAME = vlorcester	DESIGNED - RD	REVISED -
PLOT SCALE = 50.000000' / IN.	DRAWN - RD	REVISED -
PLOT DATE = 4/24/2008	CHECKED - WBL	REVISED -
	DATE - 04/7/2008	REVISED -

**STATE OF ILLINOIS  
DEPARTMENT OF TRANSPORTATION**

**ILLINOIS ROUTE 58  
BASSWOOD ROAD TO I-290  
ROADWAY AND PAVEMENT MARKING PLAN**

SCALE: SHEET NO. OF SHEETS STA. TO STA.

F.A.P. RTE. 559	SECTION 582R (1&3) RS-1	COUNTY COOK	TOTAL SHEETS 27	SHEET NO. 5
CONTRACT NO. 60E21				
FED. ROAD DIST. NO. - ILLINOIS FED. AID PROJECT				

(4-24-08)