

LEGEND:

- | | |
|---|--|
| 1 THERMOPLASTIC PAVEMENT MARKING - LINE 4" (YELLOW SOLID LINE) | 6 THERMOPLASTIC PAVEMENT MARKING - LINE 6" (WHITE SOLID LINE) |
| 2 THERMOPLASTIC PAVEMENT MARKING - LINE 4" (YELLOW SKIP DASH - 10' DASH, 30' SKIP) | 7 THERMOPLASTIC PAVEMENT MARKING - LINE 12" (YELLOW DIAGONAL LINE) |
| 3 THERMOPLASTIC PAVEMENT MARKING - LINE 4" (DOUBLE YELLOW SOLID LINE) | 8 THERMOPLASTIC PAVEMENT MARKING - LINE 24" (WHITE STOP LINE) |
| 4 THERMOPLASTIC PAVEMENT MARKING - LINE 6" (WHITE LANE LINE - 2' DASH, 6' SKIP) | 9 THERMOPLASTIC PAVEMENT MARKING - LETTERS & SYMBOLS (TYP.) |
| 5 THERMOPLASTIC PAVEMENT MARKING - LINE 4" (WHITE LANE LINE - 10' DASH, 30' SKIP W/ 2 CRYSTAL/OPAQUE RPM'S) | 10 THERMOPLASTIC PAVEMENT MARKING - LINE 8" (WHITE SOLID LINE) |

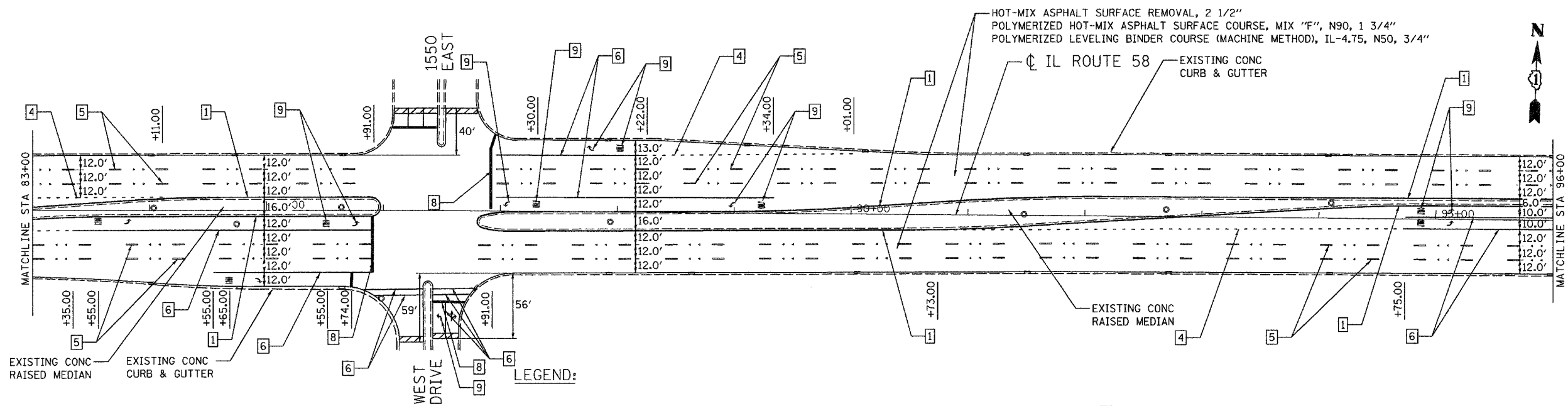

LEGEND:

- | | |
|---|--|
| 1 THERMOPLASTIC PAVEMENT MARKING - LINE 4" (YELLOW SOLID LINE) | 6 THERMOPLASTIC PAVEMENT MARKING - LINE 6" (WHITE SOLID LINE) |
| 2 THERMOPLASTIC PAVEMENT MARKING - LINE 4" (YELLOW SKIP DASH - 10' DASH, 30' SKIP) | 7 THERMOPLASTIC PAVEMENT MARKING - LINE 12" (YELLOW DIAGONAL LINE) |
| 3 THERMOPLASTIC PAVEMENT MARKING - LINE 4" (DOUBLE YELLOW SOLID LINE) | 8 THERMOPLASTIC PAVEMENT MARKING - LINE 24" (WHITE STOP LINE) |
| 4 THERMOPLASTIC PAVEMENT MARKING - LINE 6" (WHITE LANE LINE - 2' DASH, 6' SKIP) | 9 THERMOPLASTIC PAVEMENT MARKING - LETTERS & SYMBOLS (TYP.) |
| 5 THERMOPLASTIC PAVEMENT MARKING - LINE 4" (WHITE LANE LINE - 10' DASH, 30' SKIP W/ 2 CRYSTAL/OPAQUE RPM'S) | 10 THERMOPLASTIC PAVEMENT MARKING - LINE 8" (WHITE SOLID LINE) |

FILE NAME = I:\VPROJ\1329\329_38\Drawings\Proposed\1329_38\proposed5.dgn

Ciorba Group, Inc.
 CONSULTING ENGINEERS
 5507 North Cumberland Avenue, Suite 402
 Chicago, Illinois 60656
 Tel. 773.775.4099 Fax 773.775.4014

USER NAME = wlancaster	DESIGNED - RD	REVISED -
PLOT SCALE = 50:0.0000 ' / IN.	DRAWN - RD	REVISED -
PLOT DATE = 4/24/2008	CHECKED - WBL	REVISED -
	DATE - 04/7/2008	REVISED -

STATE OF ILLINOIS
DEPARTMENT OF TRANSPORTATION

ILLINOIS ROUTE 58
BASSWOOD ROAD TO I-290
ROADWAY AND PAVEMENT MARKING PLAN

F.A.P. RTE.	SECTION	COUNTY	TOTAL SHEETS	SHEET NO.
559	582R (1&3) RS-1	COOK	27	7
CONTRACT NO. 60E21				
FED. ROAD DIST. NO. - ILLINOIS FED. AID PROJECT				

SCALE: SHEET NO. OF SHEETS STA. TO STA.

(4-24-08)