

THERMOPLASTIC PAVEMENT MARKING LEGEND

- ① 4" DOUBLE SOLID YELLOW LINE (11" C-C)
 - ② 4" WHITE LANE LINE (10' LINE, 30' SPACE)
 - ③ 6" SOLID WHITE LINE
 - ④ 6" WHITE TURN LANE LINE (2' LINE, 6' SPACE)
 - ⑤ 12" SOLID YELLOW DIAGONAL LINES
 - ⑥ 24" SOLID WHITE STOP BAR
 - ⑦ LETTERS AND SYMBOLS
 - ⑧ 12" SOLID WHITE DIAGONAL LINES
 - ⑨ RAISED REFLECTIVE PAVEMENT MARKERS
- ◁ ONE-WAY CRYSTAL
 - ◄ ONE-WAY AMBER
 - ◆ TWO-WAY AMBER

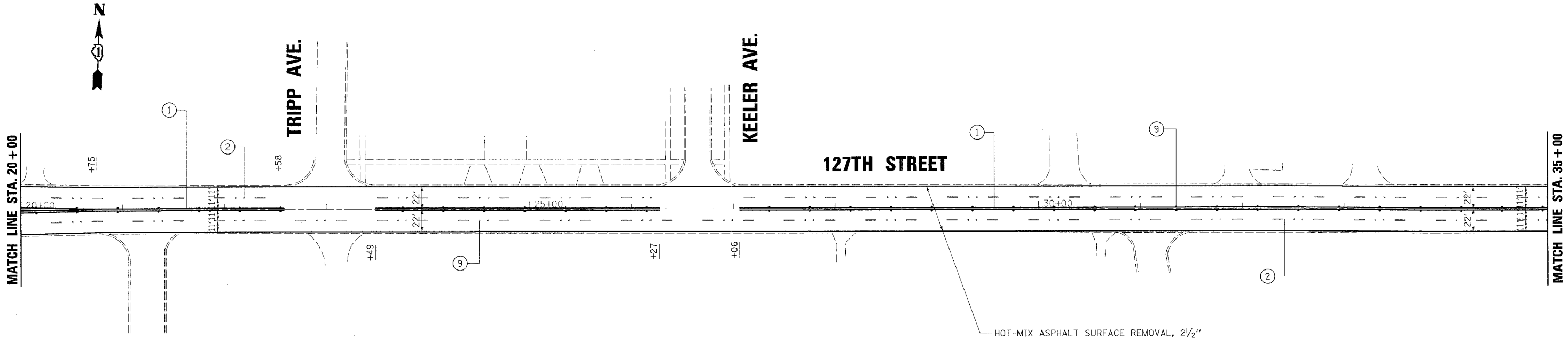
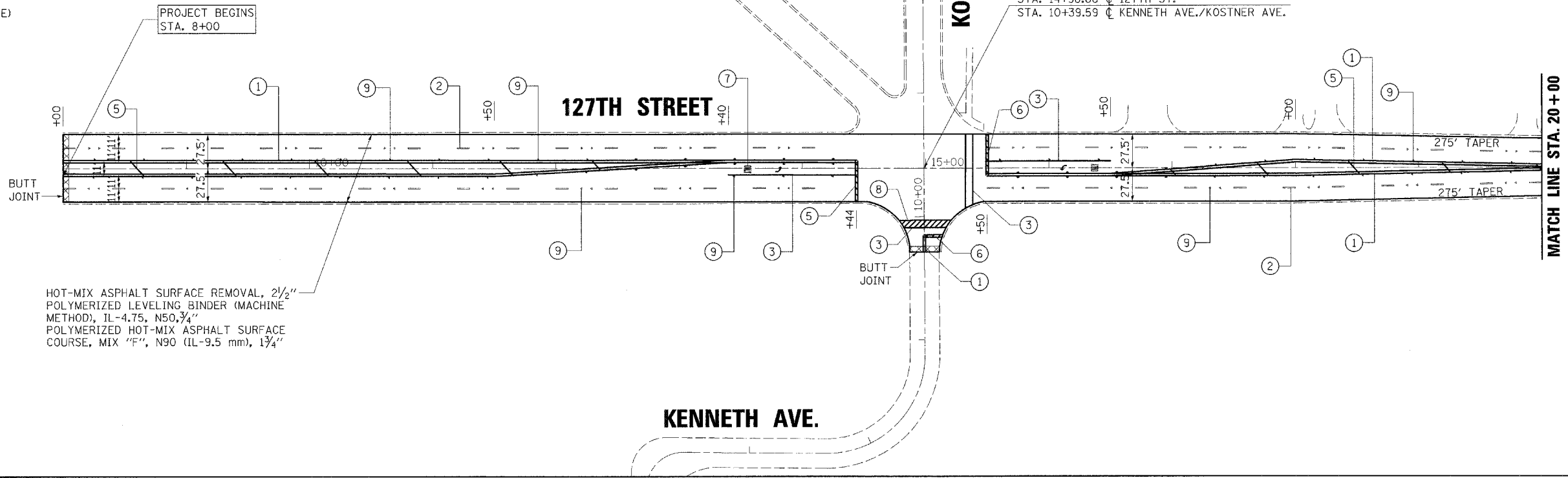

HOT-MIX ASPHALT SURFACE REMOVAL, 2 1/2"
 POLYMERIZED LEVELING BINDER (MACHINE METHOD), IL-4.75, N50, 3/4"
 POLYMERIZED HOT-MIX ASPHALT SURFACE COURSE, MIX "F", N90 (IL-9.5 mm), 1 1/4"

PLOT DATE = 4/18/2008
 FILE NAME = N:\11225505\11225505.dwg
 PLOT SCALE = 1"=50'
 PLOT NAME = 11225505.dwg
 MODEL =
 DEFLOT =



200 West Front Street
 Wheaton, IL 60187

DESIGNED - LCM	REVISED -
DRAWN - JMT	REVISED -
CHECKED - BLB	REVISED -
DATE - 3/28/08	REVISED -

**STATE OF ILLINOIS
 DEPARTMENT OF TRANSPORTATION**

**127th ST. (KOSTNER AVE. - CRAWFORD AVE.)
 EXISTING & PROPOSED ROADWAY PLAN**

SCALE: 1"=50' SHEET NO. 1 OF 2 SHEETS STA. 0+00 TO STA. 25+00

F.A.P. RTE.	SECTION	COUNTY	TOTAL SHEETS	SHEET NO.
344	3034 RS-4	COOK	21	6
CONTRACT NO. 60E30				

FED. ROAD DIST. NO. 1 [ILLINOIS] FED. AID PROJECT