

STATE OF ILLINOIS
DEPARTMENT OF TRANSPORTATION

ROUTE NO.	DISTRICT	COUNTY	SHEET NO.	SHEET TOTAL
FAU 2697	2008-018 BR	COOK	22	5
FED. ROAD DIST. NO. 7	ILLINOIS	FED. AID PROJECT		

SHEET NO. S-2
S-16 SHEETS

Contract # 60E47

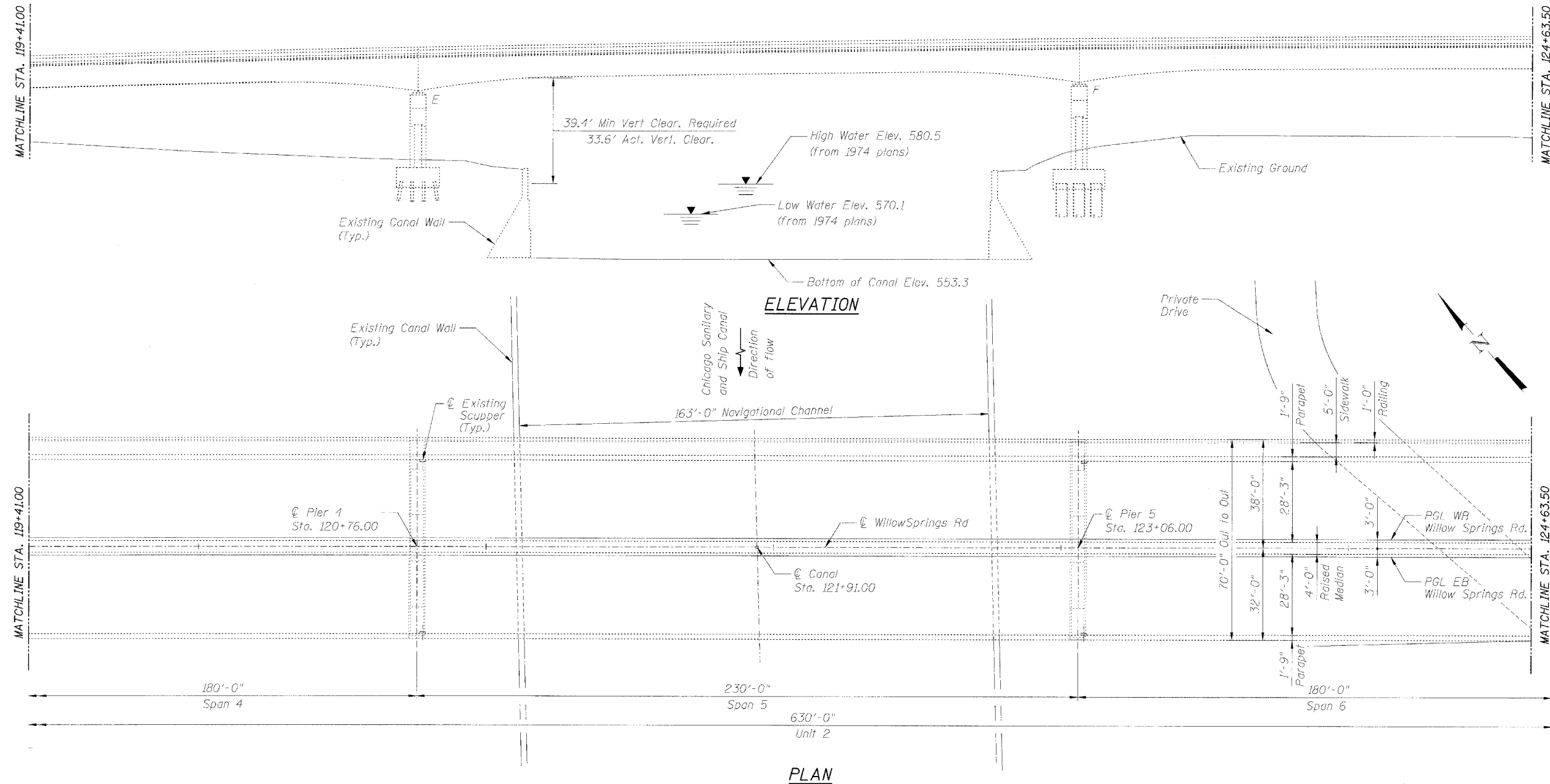

DESIGNED	B. Sauter
CHECKED	E. Mroczek
DRAWN	R. Danley
CHECKED	B. Sauter



Giorba Group, Inc.
CONSULTING ENGINEERS
5507 North Cumberland Avenue, Suite 402 Chicago, Illinois 60656
Tel. 773.775.4009 Fax 773.775.4014 Email chicago@giorba.com

GENERAL PLAN AND ELEVATION II
FAU 2697 WILLOW SPRINGS ROAD
OVER DES PLAINES RIVER,
CHICAGO SANITARY & SHIP CANAL,
ILLINOIS AND MICHIGAN CANAL,
AND ICG RAILROAD
COOK COUNTY
S.N. 016-0540

rdentley

4/16/2026

N:\P20\1\3299\3299_30\Design\Structural\CAD\Sheet\Reprint\3299_36_02 GP.sht