

EXIST. CURVE 4
 PI STA. = 74+64.80
 $\Delta = 30^\circ 19' 22''$ (LT)
 $D = 12^\circ 29' 57''$
 $R = 458.40'$
 $T = 124.21'$
 $L = 242.60'$
 $E = 16.53'$
 P.C. STA. = 73+40.59
 P.T. STA. = 75+83.19

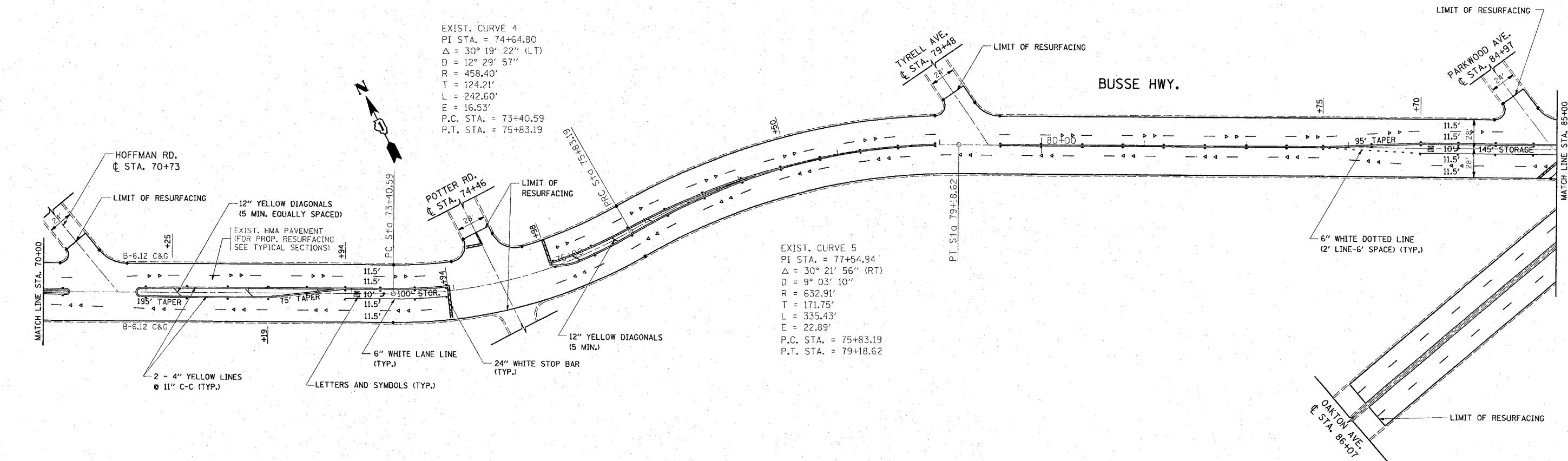

EXIST. CURVE 5
 PI STA. = 77+54.94
 $\Delta = 30^\circ 21' 56''$ (RT)
 $D = 9^\circ 03' 10''$
 $R = 632.91'$
 $T = 171.75'$
 $L = 335.43'$
 $E = 22.89'$
 P.C. STA. = 75+83.19
 P.T. STA. = 79+18.62

NOTES

- ALL DIMENSIONS ARE TO EDGE OF PAVEMENT OR LANE.
- ALL FINAL PAVEMENT MARKINGS ARE THERMOPLASTIC
- FOR PAVEMENT MARKING DETAILS ALONG PARKING LANES, SEE "TYPICAL PAVEMENT MARKING FOR PARKING SPACES" ON SHEET NO. 11.
- FOR DETAILS OF RAISED REFLECTIVE PAVEMENT MARKERS, SEE "DISTRICT ONE TYPICAL APPLICATIONS RAISED REFLECTIVE PAVEMENT MARKERS (SNOW-PLOW RESISTANT)." DUAL ONE-WAY CRYSTAL MARKERS SHALL BE USED ON SKIP-DASH LANE LINES.
- AT LOCATIONS WHERE DRIVEWAY REMOVAL AND REPLACEMENT IS NEEDED THE HOT-MIX ASPHALT SURFACE COURSE WILL BE OF THE SAME MIX USED THROUGHOUT THE ROADWAY RESURFACING IMPROVEMENT (MIX "D", N70) AT THE THICKNESS SPECIFIED IN THE DRIVEWAY DETAIL.
- IMPROVEMENT LIMITS SHOULD END WHERE THE CITY OF PARK RIDGE'S IMPROVEMENT LIMITS BEGIN, ALLOWING NO GAPS, JUST NORTHWEST OF THE INTERSECTION OF BUSSE HIGHWAY AND TOUHY AVENUE.

FILE NAME =
 c:\projects\dl31301\sh_rdw.dgn

USER NAME = bauerdl
 PLOT SCALE = 50,0000' / IN.
 PLOT DATE = 3/11/2008

DESIGNED -
 DRAWN -
 CHECKED -
 DATE -

REVISED -
 REVISED -
 REVISED -
 REVISED -

**STATE OF ILLINOIS
 DEPARTMENT OF TRANSPORTATION**

**FAU 3512 BUSSE HIGHWAY
 RESURFACING ROADWAY PLAN & PAVEMENT MARKING PLAN**

SCALE: 1"=50' SHEET NO. 3 OF 6 SHEETS STA. TO STA.

F.A.U. RTE.	SECTION	COUNTY	TOTAL SHEETS	SHEET NO.
3512	86Y-RS-3	COOK	35	11
CONTRACT NO. 62272				

FED. ROAD DIST. NO. 1 ILLINOIS FED. AID PROJECT