

\*REF-stg01  
\*REF-stg02

CONTRACT# 62296

F.A.P. RTE.	SECTION	COUNTY	TOTAL SHEETS	SHEET NO.
324	24N-1	McHENRY	22	18
STA.		TO STA.		
FED. ROAD DIST. NO.		ILLINOIS FED. AID PROJECT		

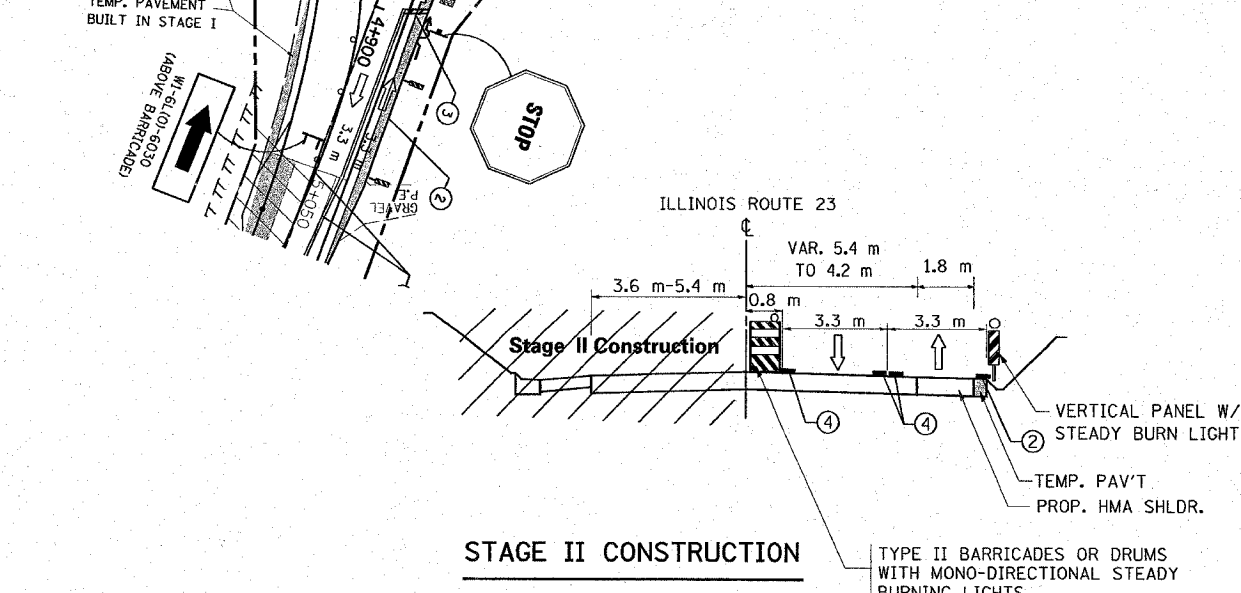
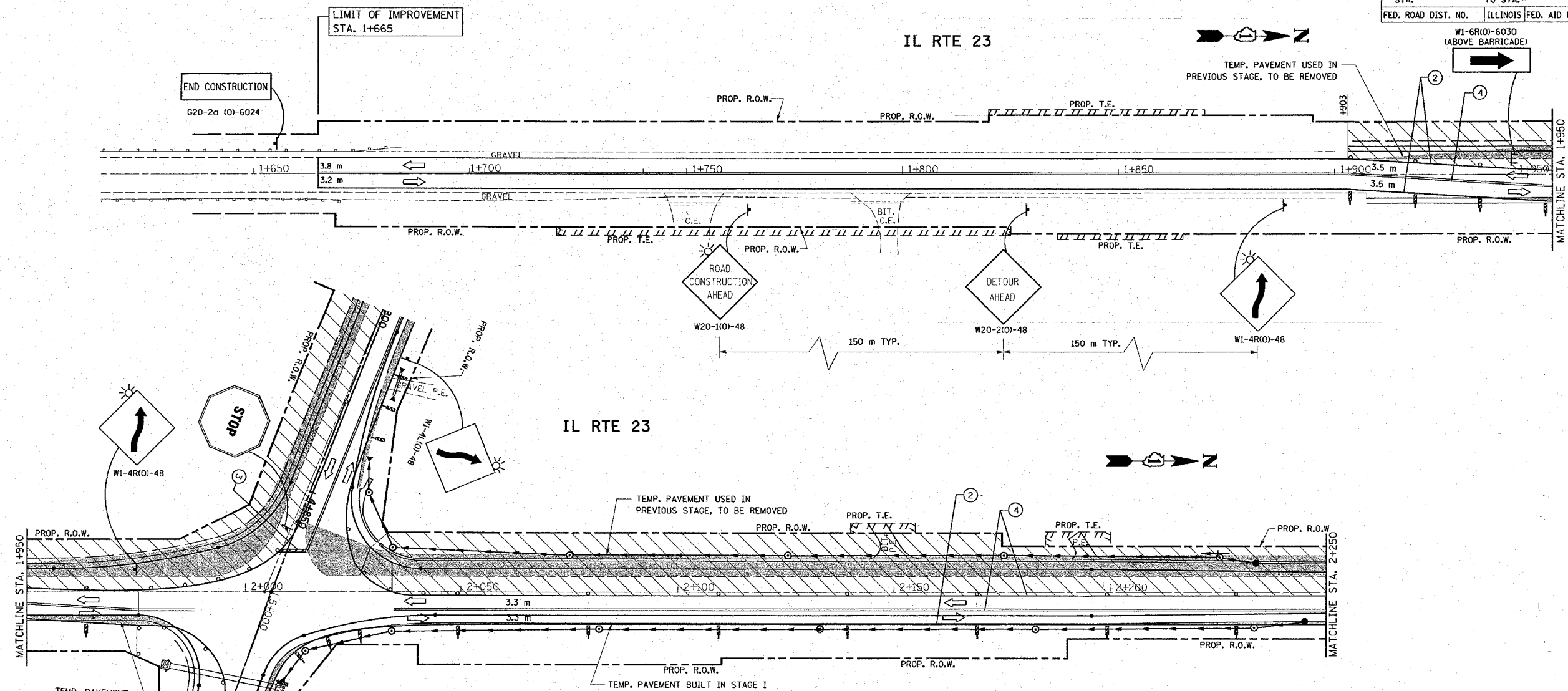

**LEGEND**

- TEMP. PAVEMENT
- TEMP. CONCRETE BARRIER
- WORK AREA
- TYPE III BARRICADES
- SIGN
- VERTICAL PANEL W/ STEADY BURN LIGHTS
- TYPE II BARRICADES OR DRUMS WITH MONO-DIRECTIONAL STEADY BURNING LIGHTS
- DIRECTION OF TRAFFIC
- ① TEMPORARY PAVEMENT MARKING, DOUBLE YELLOW CENTER LINE 100 mm @ 275 mm C-C
- ② TEMPORARY PAVEMENT MARKING, WHITE SOLID (100 mm) EDGE LINE
- ③ TEMPORARY PAVEMENT MARKING, WHITE SOLID (600 mm) STOP BAR
- ④ PAEMENT MARKING TAPE, TYPE III, 100 mm

REVISIONS	
NAME	DATE

1 OF 3

ILLINOIS DEPARTMENT OF TRANSPORTATION

**IL. RTE. 23 @ RIVER RD.  
SUGGESTED MAINTENANCE  
OF TRAFFIC PLANS  
STAGE II**

SCALE: VERT. 1:500  
DATE 2/11/2008

DRAWN BY  
CHECKED BY