

REF-10003
REF-1003
REF-1003
REF-1013

F.A.P. RTE.	SECTION	COUNTY	TOTAL SHEETS	SHEET NO.
324	24N-1	McHENRY	82	25
STA. 324 TO STA. 325				
FED. ROAD DIST. NO.		ILLINOIS FED. AID PROJECT		
CONTRACT NO. 62296				

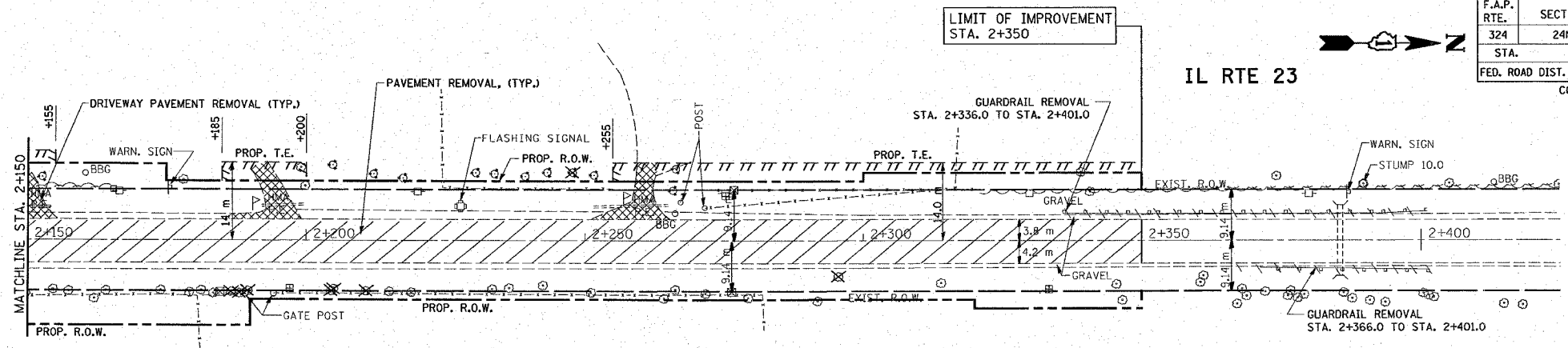

EXISTING

* P.E.
PROP. HMA BASE COURSE, 150 mm
PROP. HMA SURFACE COURSE,
MIX "C", N50, 50 mm

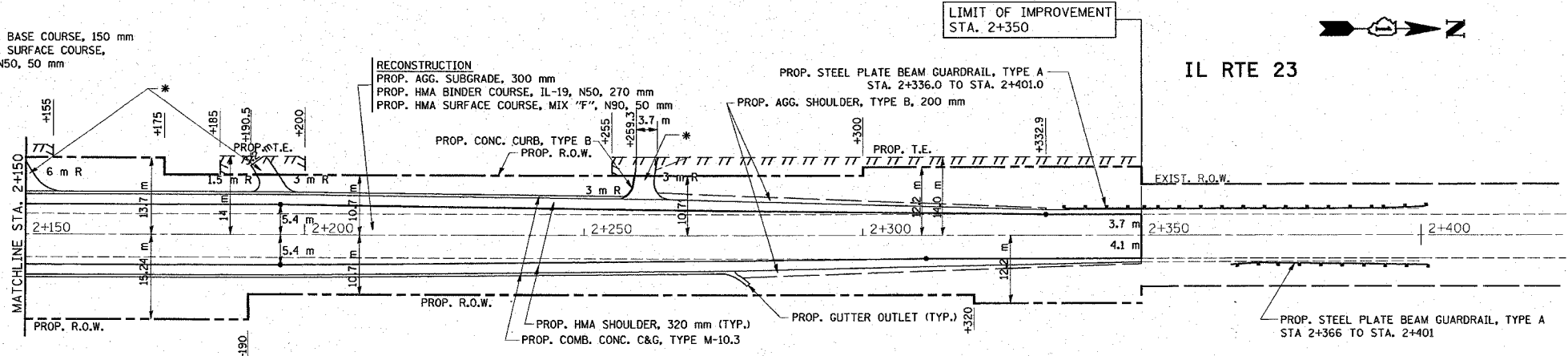

PROPOSED

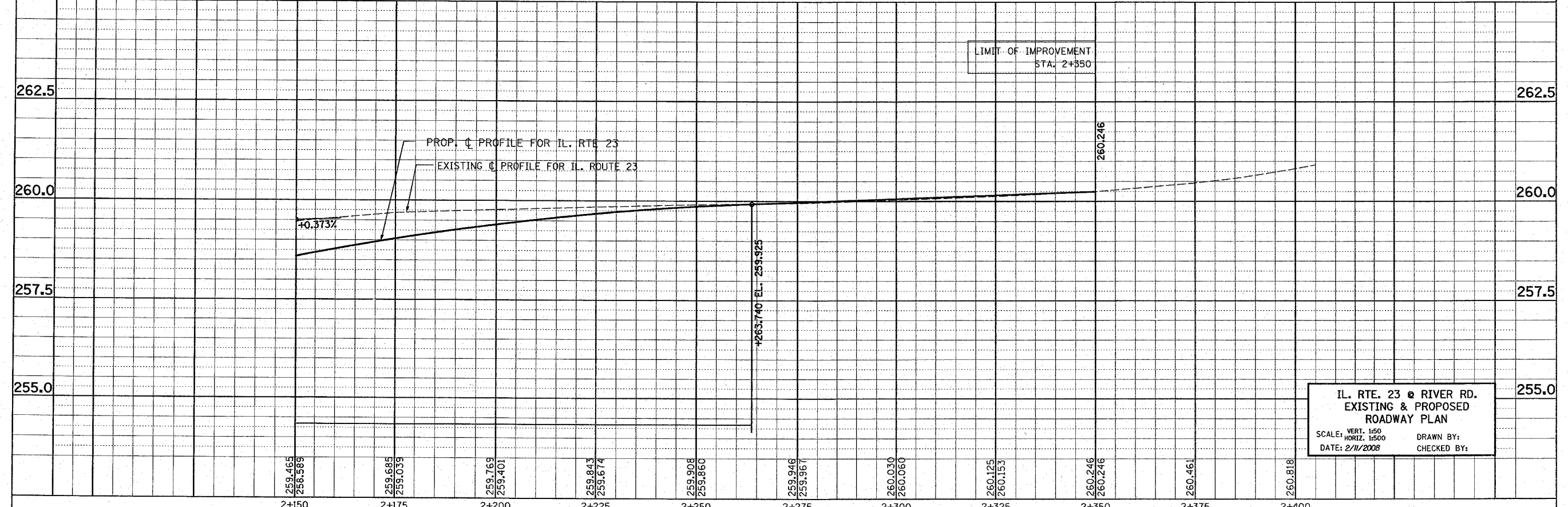

IL. RTE. 23 @ RIVER RD.
EXISTING & PROPOSED
ROADWAY PLAN
SCALE: VERT. 1:50
HORIZ. 1:500
DATE: 2/11/2008
DRAWN BY:
CHECKED BY: