

\*REF-pmk1  
\*REF-pmk2  
\*REF-pmk3

| F.A.P. RTE.         | SECTION | COUNTY                    | TOTAL SHEETS | SHEET NO. |
|---------------------|---------|---------------------------|--------------|-----------|
| 324                 | 24N-1   | McHENRY                   | 82           | 38        |
| STA.                |         | TO STA.                   |              |           |
| FED. ROAD DIST. NO. |         | ILLINOIS FED. AID PROJECT |              |           |

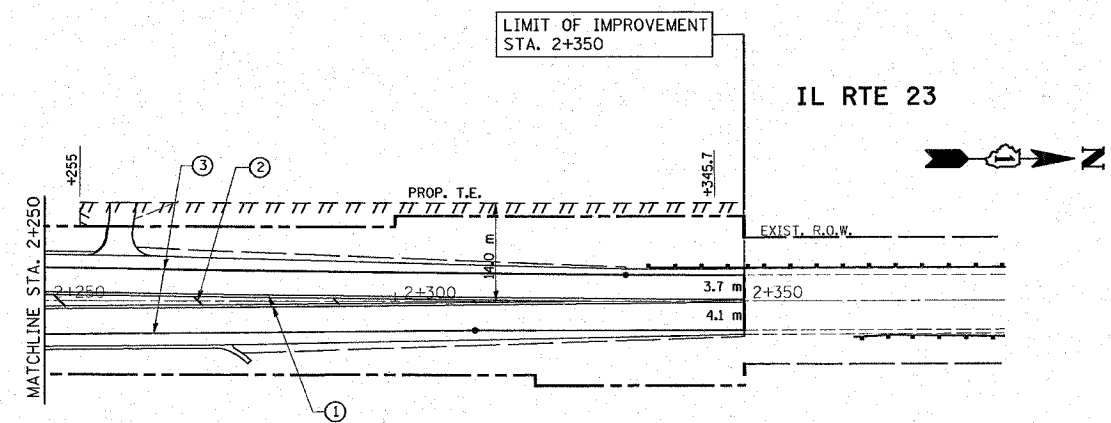
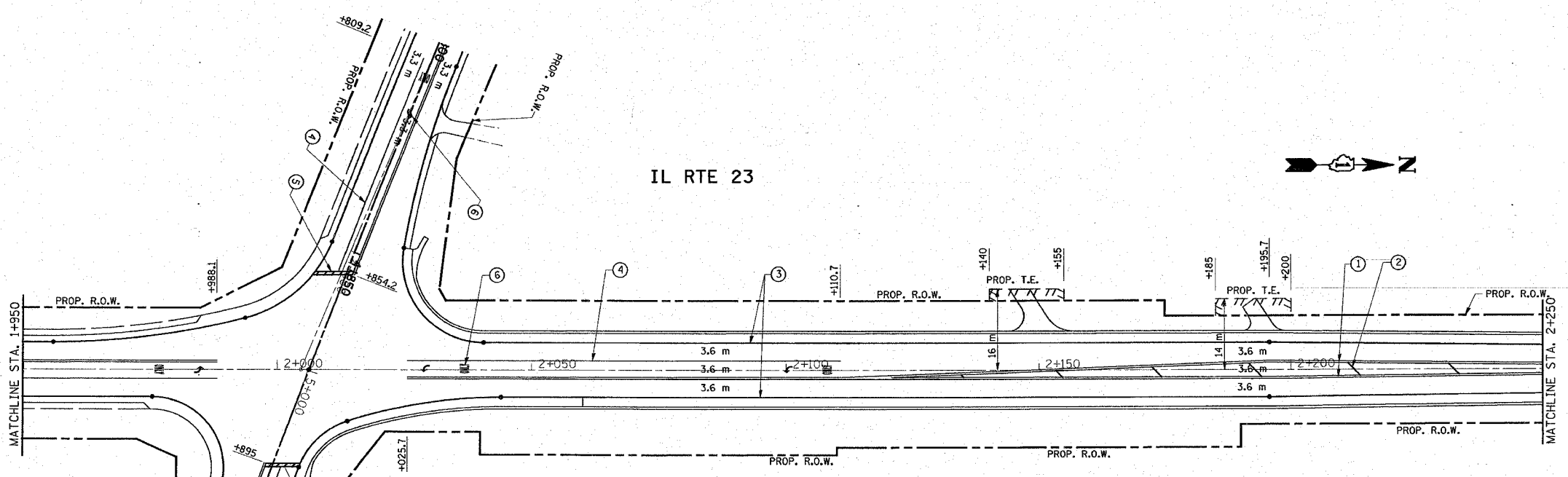
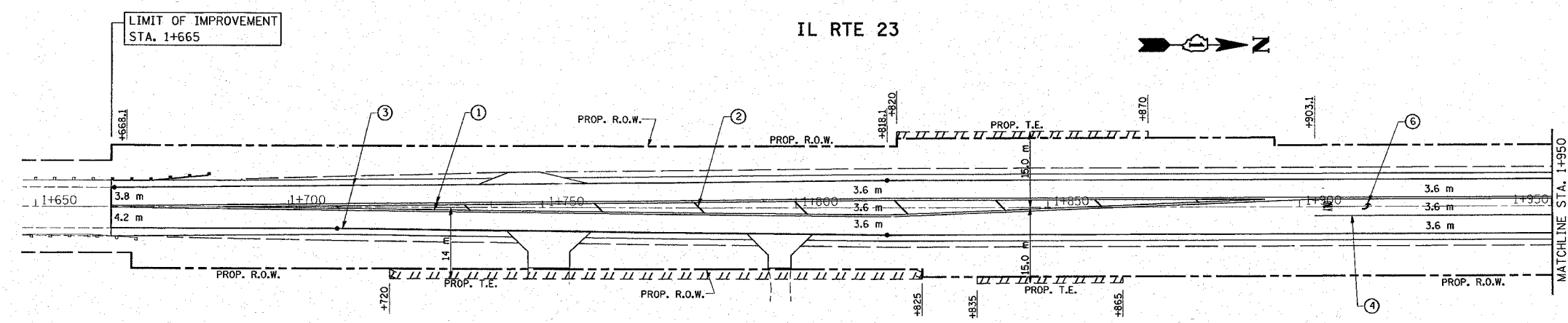

- LEGEND**
- ① PROP. THERMOPLASTIC PAVEMENT MARKING LINE 100 mm, DOUBLE YELLOW LINE
  - ② PROP. THERMOPLASTIC PAVEMENT MARKING LINE 300 mm, YELLOW DIAGONAL @ 45°, 6 m (20') C-C
  - ③ PROP. THERMOPLASTIC PAVEMENT MARKING LINE 100 mm, WHITE SOLID EDGE LINE
  - ④ PROP. THERMOPLASTIC PAVEMENT MARKING LINE 150 mm, WHITE SOLID TURN LANE LINE
  - ⑤ PROP. THERMOPLASTIC PAVEMENT MARKING LINE 600 mm, WHITE STOP BAR
  - ⑥ PROP. THERMOPLASTIC PAVEMENT MARKING LETTERS & SYMBOLS, WHITE

| REVISIONS |      |
|-----------|------|
| NAME      | DATE |
|           |      |
|           |      |
|           |      |
|           |      |
|           |      |

ILLINOIS DEPARTMENT OF TRANSPORTATION  
**IL. RTE. 23**  
**PROPOSED**  
**PAVEMENT MARKING PLAN**

SCALE: VERT: 1:500  
 HORIZ: 1:500  
 DATE 2/11/2008

DRAWN BY  
 CHECKED BY