

2/13/2008  
 c:\projects\pl36796\vs-priv-cc\_design.dgn  
 shiran/sb

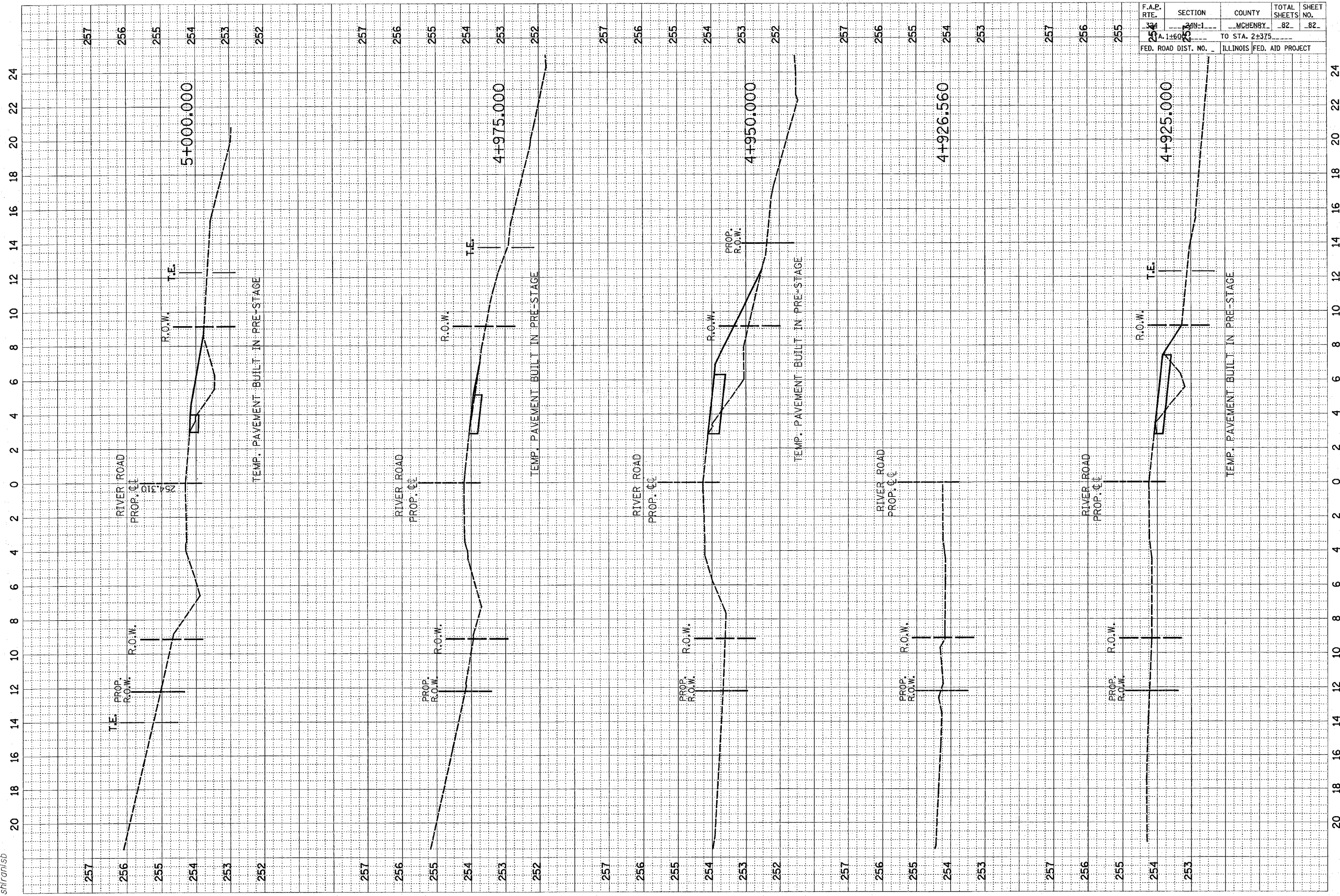

F.A.P. RTE.	SECTION	COUNTY	TOTAL SHEETS NO.
254	254-1	MCHENRY	82
254	254-1	TO STA. 2+375	82
FED. ROAD DIST. NO.	ILLINOIS FED. AID PROJECT		