

F.A.P. RTE.	SECTION	COUNTY	TOTAL SHEETS	SHEET NO.
348	*	COOK	86	15
STA. 360+59		TO STA. 387+00		
FED. ROAD DIST. NO.		ILLINOIS FED. AID PROJECT		

\* (1214 & 3127-1) RS-1

\*REF-plan01  
\*REF-plan02

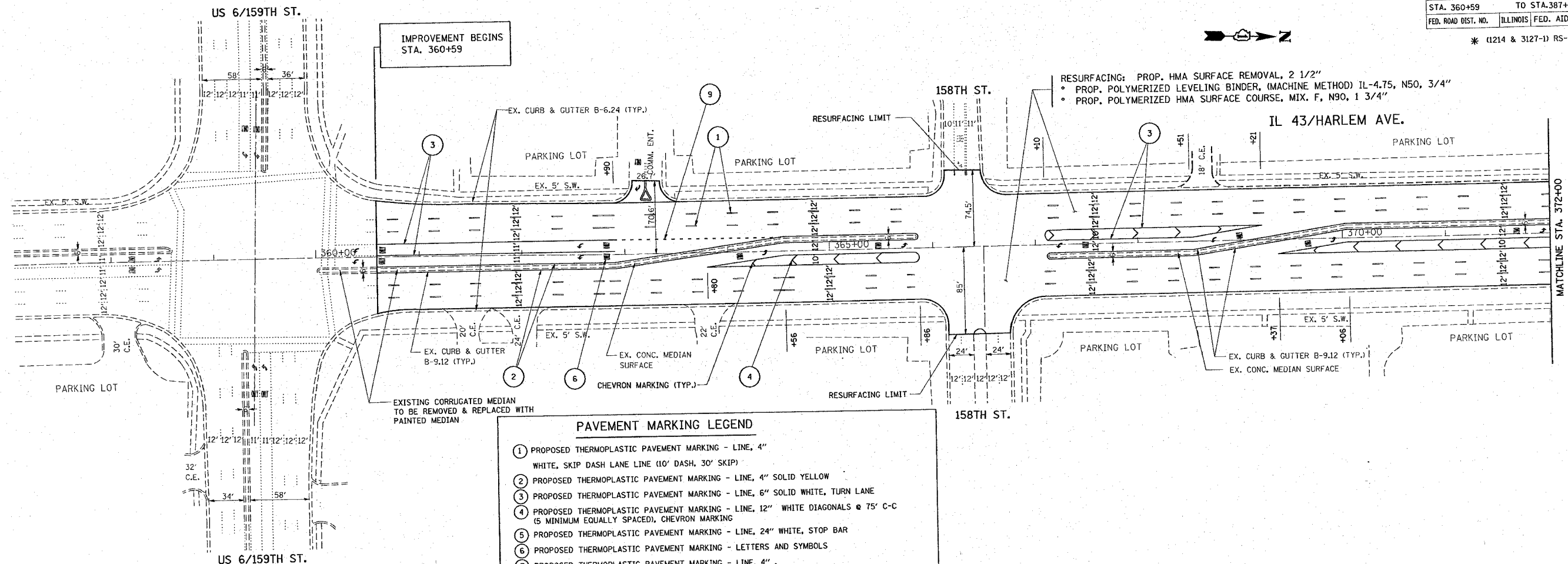

**PAVEMENT MARKING LEGEND**

- 1 PROPOSED THERMOPLASTIC PAVEMENT MARKING - LINE, 4" WHITE, SKIP DASH LANE LINE (10' DASH, 30' SKIP)
- 2 PROPOSED THERMOPLASTIC PAVEMENT MARKING - LINE, 4" SOLID YELLOW
- 3 PROPOSED THERMOPLASTIC PAVEMENT MARKING - LINE, 6" SOLID WHITE, TURN LANE
- 4 PROPOSED THERMOPLASTIC PAVEMENT MARKING - LINE, 12" WHITE DIAGONALS @ 75' C-C (5 MINIMUM EQUALLY SPACED), CHEVRON MARKING
- 5 PROPOSED THERMOPLASTIC PAVEMENT MARKING - LINE, 24" WHITE, STOP BAR
- 6 PROPOSED THERMOPLASTIC PAVEMENT MARKING - LETTERS AND SYMBOLS
- 7 PROPOSED THERMOPLASTIC PAVEMENT MARKING - LINE, 4" SOLID DOUBLE YELLOW @ 11" C-C, FOR PAINTED MEDIAN
- 8 PROPOSED THERMOPLASTIC PAVEMENT MARKING - LINE, 12" YELLOW DIAGONALS @ 75' C-C
- 9 PROPOSED THERMOPLASTIC PAVEMENT MARKING - LINE, 4" WHITE, SKIP-DASH (2' DASH, 6' SKIP)

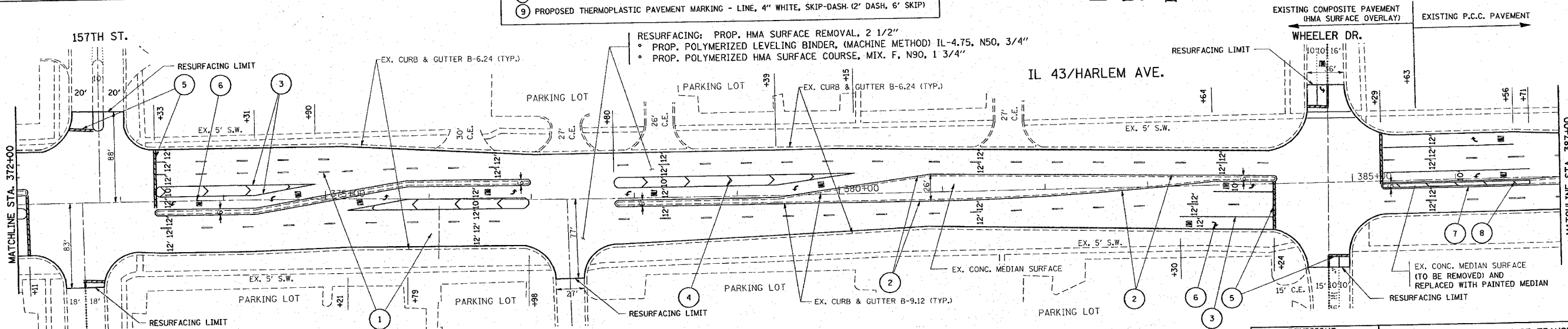

RESURFACING: PROP. HMA SURFACE REMOVAL, 2 1/2"  
 • PROP. POLYMERIZED LEVELING BINDER, (MACHINE METHOD) IL-4.75, N50, 3/4"  
 • PROP. POLYMERIZED HMA SURFACE COURSE, MIX. F, N90, 1 3/4"

REVISIONS	
NAME	DATE

ILLINOIS DEPARTMENT OF TRANSPORTATION  
 IL. RTE. 43 (HARLEM AV.)  
 EXISTING AND PROPOSED  
 ROADWAY AND PAVEMENT MARKING PLAN  
 U.S. 6 TO IL. RTE. 7  
 SCALE: VERT. 1" = 50'  
 HORIZ. 1" = 50'  
 DATE 12/5/2007  
 DRAWN BY  
 CHECKED BY

PLOT DATE = 12/5/2007  
 PLOT SCALE = 50.0000 / IN.  
 USER NAME = dr-velocsign