

*REF-plan15
*REF-plan16

CONTRACT NO. 62343

F.A.P. RTE.	SECTION	COUNTY	TOTAL SHEETS	SHEET NO.
348	*	COOK	86	22
STA. 100+00		TO STA. 130+00		
FED. ROAD DIST. NO.		ILLINOIS FED. AID PROJECT		

* (1214 & 3127-1) RS-1

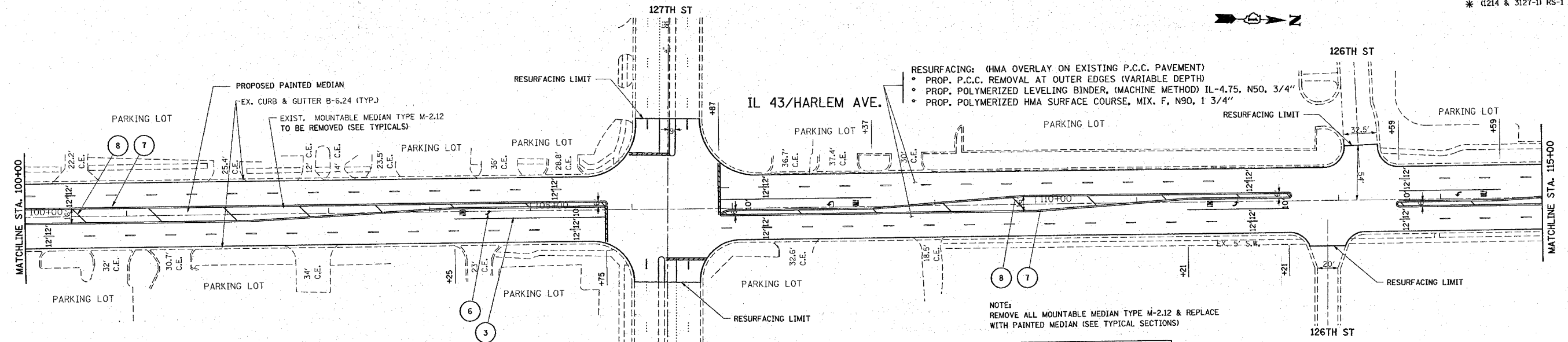

RESURFACING: (HMA OVERLAY ON EXISTING P.C.C. PAVEMENT)
 • PROP. P.C.C. REMOVAL AT OUTER EDGES (VARIABLE DEPTH)
 • PROP. POLYMERIZED LEVELING BINDER, (MACHINE METHOD) IL-4.75, N50, 3/4"
 • PROP. POLYMERIZED HMA SURFACE COURSE, MIX. F, N90, 1 3/4"

NOTE:
 REMOVE ALL MOUNTABLE MEDIAN TYPE M-2.12 & REPLACE WITH PAINTED MEDIAN (SEE TYPICAL SECTIONS)

PAVEMENT MARKING LEGEND

- ① PROPOSED THERMOPLASTIC PAVEMENT MARKING - LINE, 4" WHITE, SKIP DASH LANE LINE (10' DASH, 30' SKIP)
- ② PROPOSED THERMOPLASTIC PAVEMENT MARKING - LINE, 4" SOLID YELLOW
- ③ PROPOSED THERMOPLASTIC PAVEMENT MARKING - LINE, 6" SOLID WHITE, TURN LANE
- ④ PROPOSED THERMOPLASTIC PAVEMENT MARKING - LINE, 12" WHITE DIAGONALS @ 75' C-C
- ⑤ PROPOSED THERMOPLASTIC PAVEMENT MARKING - LINE, 24" WHITE, STOP BAR
- ⑥ PROPOSED THERMOPLASTIC PAVEMENT MARKING - LETTERS AND SYMBOLS
- ⑦ PROPOSED THERMOPLASTIC PAVEMENT MARKING - LINE, 4" SOLID DOUBLE YELLOW @ 11" C-C, FOR PAINTED MEDIAN
- ⑧ PROPOSED THERMOPLASTIC PAVEMENT MARKING - LINE, 12" YELLOW DIAGONALS @ 75' C-C

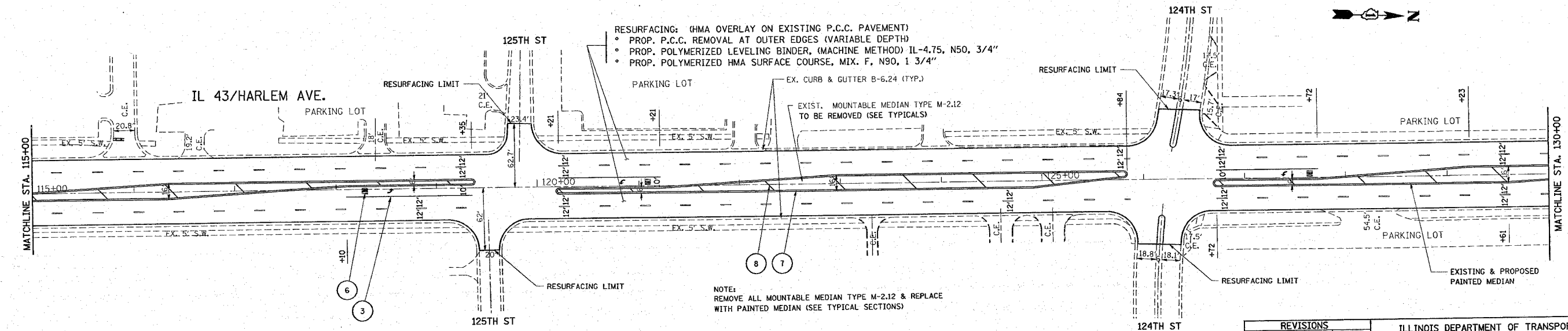

RESURFACING: (HMA OVERLAY ON EXISTING P.C.C. PAVEMENT)
 • PROP. P.C.C. REMOVAL AT OUTER EDGES (VARIABLE DEPTH)
 • PROP. POLYMERIZED LEVELING BINDER, (MACHINE METHOD) IL-4.75, N50, 3/4"
 • PROP. POLYMERIZED HMA SURFACE COURSE, MIX. F, N90, 1 3/4"

NOTE:
 REMOVE ALL MOUNTABLE MEDIAN TYPE M-2.12 & REPLACE WITH PAINTED MEDIAN (SEE TYPICAL SECTIONS)

REVISIONS	DATE

ILLINOIS DEPARTMENT OF TRANSPORTATION
 IL. RTE. 43 (HARLEM AV.)
 EXISTING AND PROPOSED
 ROADWAY AND PAVEMENT MARKING PLAN
 U.S. 6 TO IL. RTE. 7

SCALE: VERT. 1" = 50'
 HORIZ. 1" = 50'
 DATE 12/5/2007
 DRAWN BY
 CHECKED BY

PLOT DATE = 12/05/2007
 FILE NAME = I:\projects\1214\1214_115-130.dwg
 PLOT SCALE = 50.000000 / IN.
 USER NAME = drvelo@design