

F.A.D. RTE.	SECTION	COUNTY	TOTAL SHEETS	SHEET NO.
348	*	COOK	88	63
STA.		TO STA.		
FED. ROAD DIST. NO. 1		ILLINOIS FED. AID PROJECT		

*(1214&3127-1)RS-1

ARTERIAL-VOLUME DENSITY ("FAR BACK" DETECTION)
CROSS STREET-NON VOLUME DENSITY ("UPTIGHT" PRESENCE DETECTION)

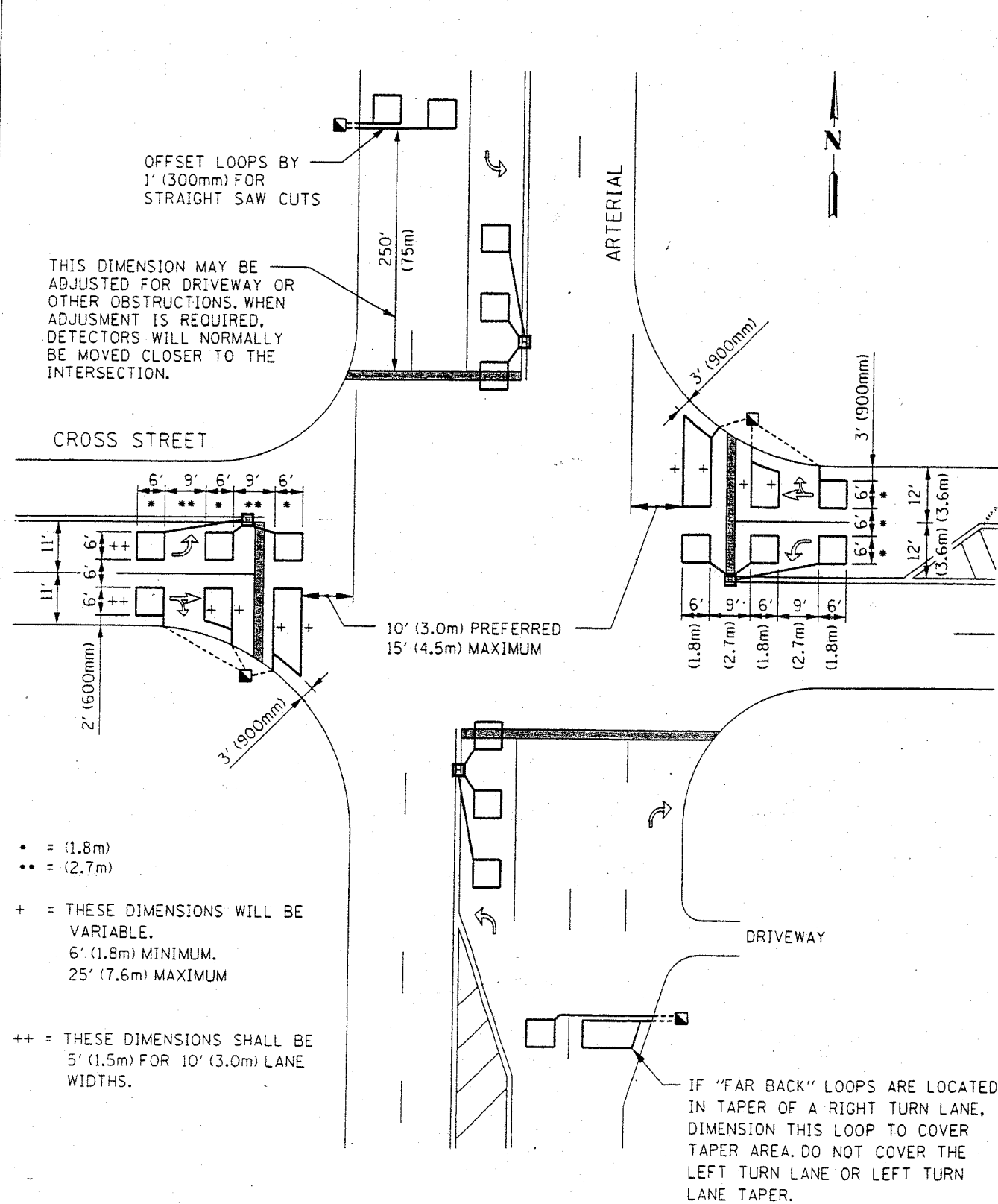

N.T.S.

ARTERIAL-VOLUME DENSITY ("FAR BACK" DETECTION)
CROSS STREET-VOLUME DENSITY ("FAR BACK" DETECTION)

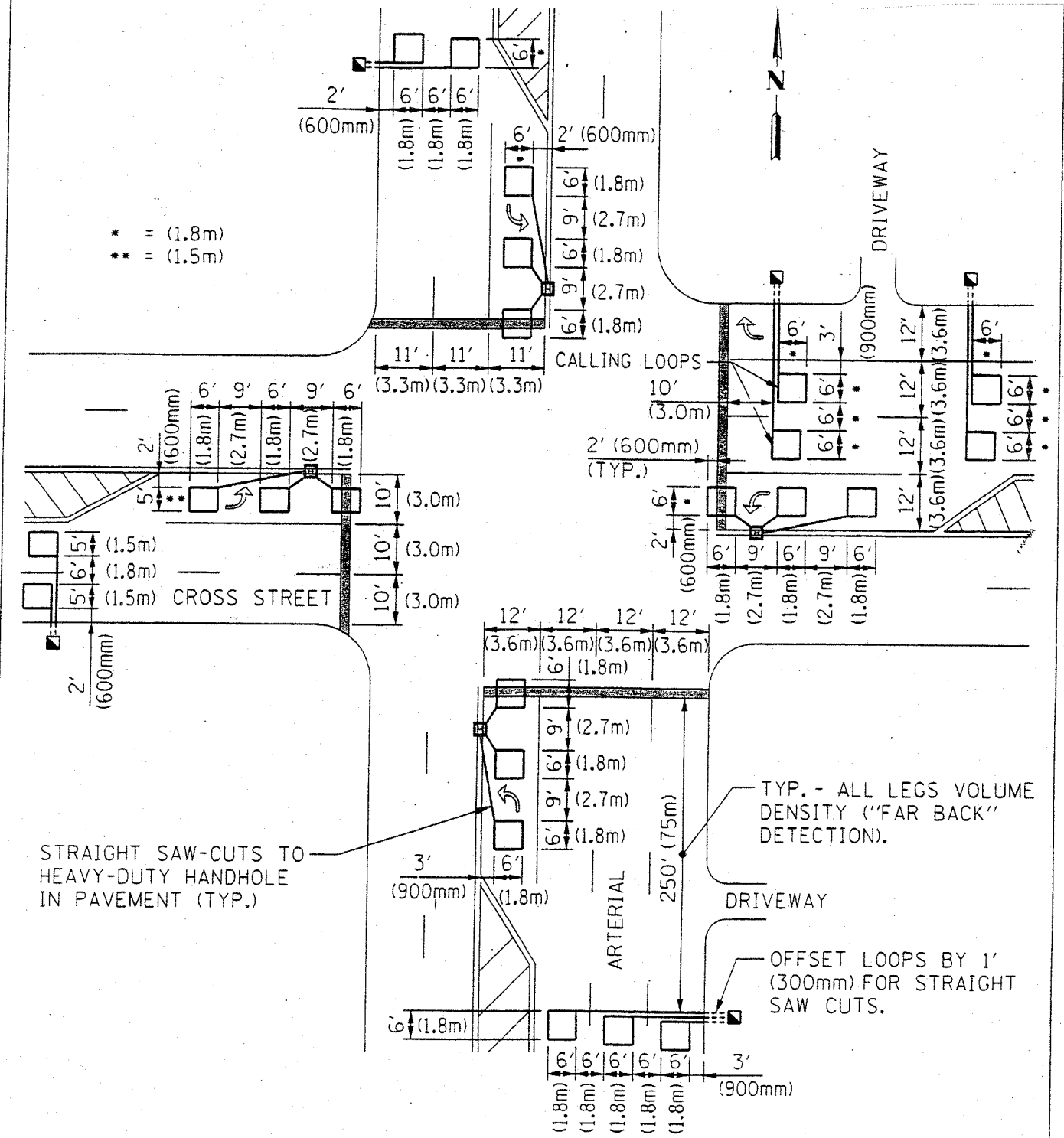

LOOPS ARE SAW-CUT TO THE EDGE OF PAVEMENT. 1" (25mm) UNIT DUCT IS RUN BETWEEN EDGE OF PAVEMENT AND HANDHOLE, (TYP. FOR LOOPS THAT TERMINATE IN HANDHOLES OUTSIDE PAVEMENT).

N.T.S.